

**CONVENTIONAL SIGNS**

STATE LINE	-----	TIMBER	-----
COUNTY LINE	-----	BRUSH	-----
TOWNSHIP OR RANGE LINE	-----	ORCHARD	-----
SECTION LINE	-----	ROCK LEDGE	-----
QUARTER LINE	-----	SAND	-----
SIXTEENTH LINE	-----	EDGE OF CUT	-----
RIGHT-OF-WAY LINE	-----	TOE OF EMBANKMENT	-----
PRESENT ROAD 1/4 LINE	-----	CATCH BASIN	-----
LIMITED ACCESS	-----	MANHOLE	-----
PROPERTY LINE (Except Land Lines)	-----	DROP INLET	-----
VACATED PLATTED PROPERTY	-----	FIRE HYDRANT	-----
CORPORATE OR CITY LIMITS	-----	ARC LAMP	-----
TRUNK HIGHWAY CENTER LINE	-----	OTHER LAMPS (Flak Kind)	-----
RETAINING WALL	-----	RAILROAD CROSSING SIGN	-----
STEAM RAILROAD	-----	RAILROAD CROSSING BELL	-----
ELECTRIC RAILROAD	-----	ELECTRIC WARNING SIGN	-----
RAILROAD RIGHT-OF-WAY LINE	-----	CROSSING GATE	-----
CREEK	-----	CATTLE GUARD	-----
RAPIDS OR WATERFALL	-----	OVERHEAD (Highway Over)	-----
DRY RUN	-----	UNDERPASS (Highway Under)	-----
DRAINAGE DITCH	-----	ABUTMENT, WALL & PIER	-----
HIGH TENSION LINE	-----	BRIDGE	-----
POWER POLE LINE	-----	CULVERT	-----
TELEPHONE OR TELEGRAPH LINE	-----	BUILDING (One Story Frame)	-----
TELEPHONE CONDUIT	-----	C-CONCRETE S-STONE T-TILE B-BRICK ST-STUCCO	-----
GUARD RAIL	-----	HEDGE	-----
WIRE FENCE	-----	IRON PIPE	-----
RAILROAD SNOW FENCE	-----	STONE MONUMENT	-----
BOARD OR HIGHWAY SNOW FENCE	-----	WOOD STAKE OR HUB	-----
STONE WALL OR FENCE	-----	MEANDER CORNER	-----
GAS MAIN	-----		
WATER PIPE	-----		
SEWER PIPE	-----		
DRAIN TILE	-----		
GRAVEL PIT	-----		
SAND PIT	-----		
CLAY PIT	-----		
ROCK QUARRY	-----		
SPRINGS	-----		
MARSH	-----		

PLATE NO.	STANDARD DETAIL PLATES
9001 A	BITUMINOUS SURFACE ROAD APPROACH-ENT.

ESTIMATED QUANTITIES			
SPEC. NO.	ITEM	UNIT	TOTAL ESTIMATED QUANTITIES
	BIT MATERIAL FOR TACKCOAT	GAL.	1722.
	BIT MATERIAL FOR WEARING COURSE	TONS	1463

**OFFICE OF COUNTY ENGINEER  
RAMSEY COUNTY**  
CONSTRUCTION PLAN FOR BITUMINOUS SURFACING  
**CENTERVILLE ROAD**  
RAMSEY COUNTY PROJECT NO. 57-19A  
FROM EDGERTON ST. TO LABORE ROAD

GROSS LENGTH	7600	FEET	1.439	MILES
BRIDGES-LENGTH	0	FEET	0	MILES
EXCEPTIONS-LENGTH	147	FEET	0.028	MILES
NET LENGTH	7747	FEET	1.467	MILES

SCALES  
 PLAN, 1 inch = 100 Feet  
 PROFILE, Horiz. 1 inch = 100 Feet. Vert. 1 inch = 10 Feet.  
 WORKING PLANS - Horiz. 1 inch = 100 Feet  
 Vert. 1 inch = 10 Feet  
 Cross-Sections 1 inch = Feet  
 LAYOUT, 1 inch = Feet

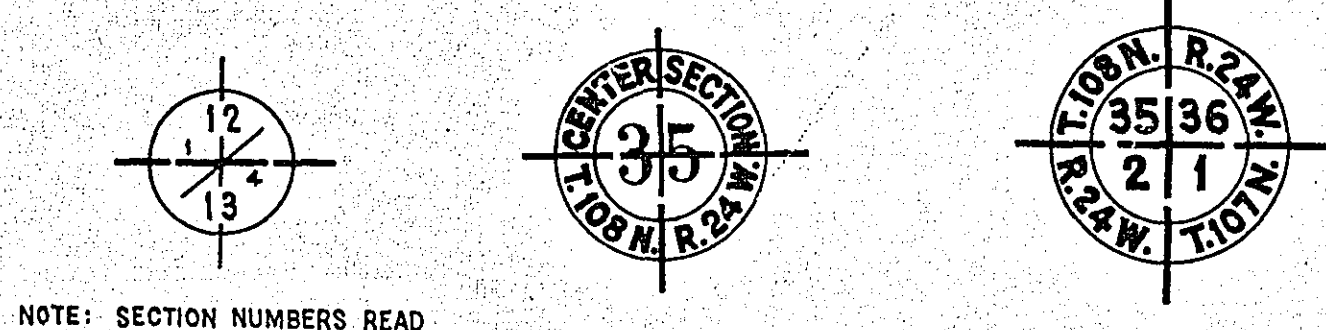

NOTE: SECTION NUMBERS READ FROM THE SOUTH

**PIT DATA**

PIT NO.	Located in Dead Haul
PIT NO.	Located in Dead Haul
PIT NO.	Located in Dead Haul
PIT NO.	Located in Dead Haul

**BASIS FOR PLANNED QUANTITIES**

BIT MATERIAL FOR TACK COAT 0.10 GAL. PER SQ. YD.  
 BIT MATERIAL FOR WEARING COURSE 170 LBS. PER SQ. YD.

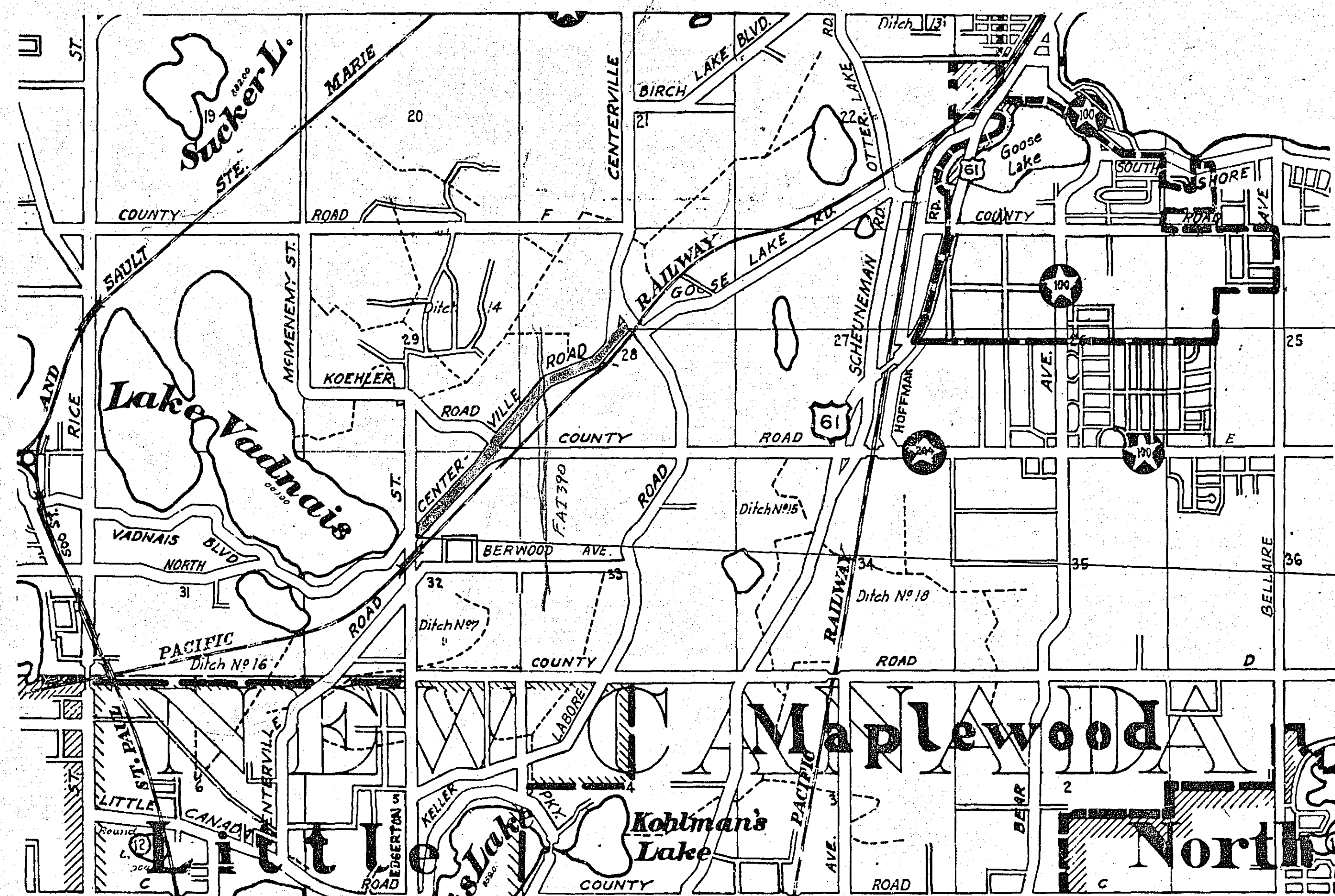

**END OF PROJ.**  
STA. 83+00

**BEG. PROJ.**  
STA. 7+00

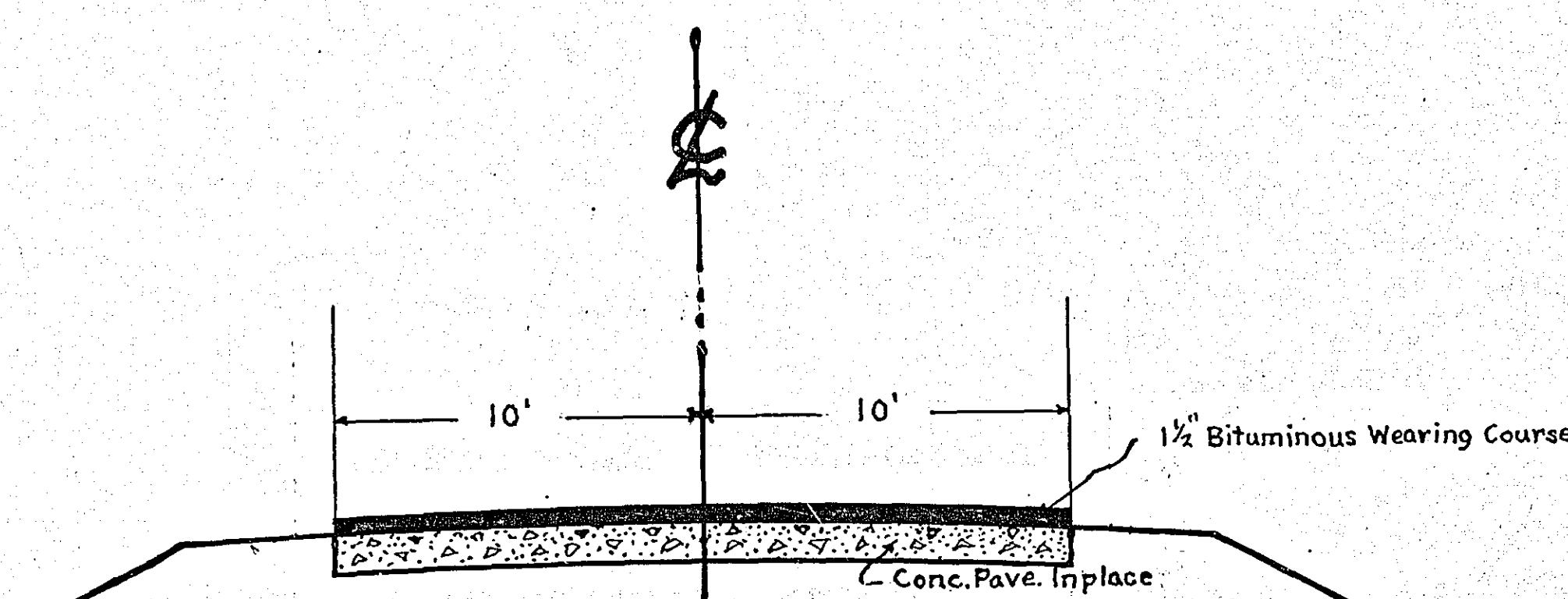

**TYPICAL SURFACE SECTIONS**

Sta. 7+00 To Sta. 83+00

I HEREBY CERTIFY THAT THIS PLAN WAS PREPARED BY ME OR UNDER MY DIRECT SUPERVISION AND THAT I AM A DULY REGISTERED PROFESSIONAL ENGINEER UNDER THE LAWS OF THE STATE OF MINNESOTA.  
 COUNTY ENGINEER REG. NO. 818 DATE 5/23/57

RECOMMENDED FOR APPROVAL COUNTY ENGINEER DATE 5/23/57

APPROVED CHAIRMAN OF RAMSEY COUNTY BOARD DATE 6/3/57

RECOMMENDED FOR APPROVAL DISTRICT ENGINEER DATE 7-25-57

APPROVED ENGINEER OF COUNTY DIVISION DATE 7-25-57

PLAN	SURVEYED	DATE
NOTE BOOK	PLOTTED	BY
NO.	CHECKED	
	BY	

PROFILE	SURVEYED	DATE
NOTE BOOK	PLOTTED	BY
NO.	CHECKED	
	BY	

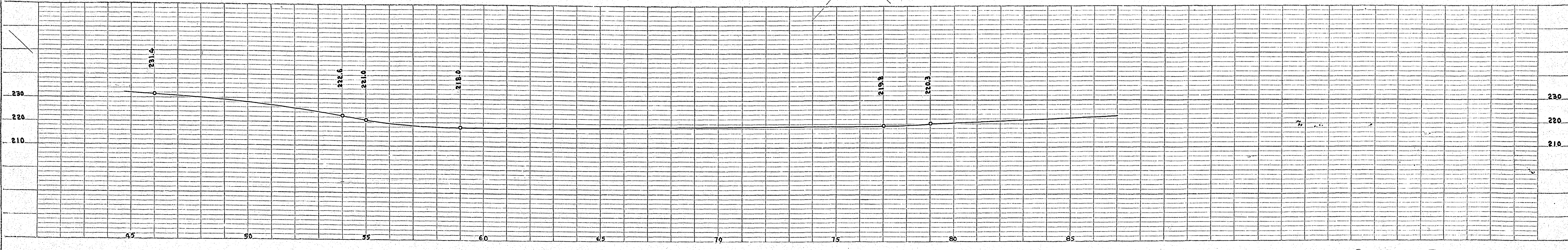
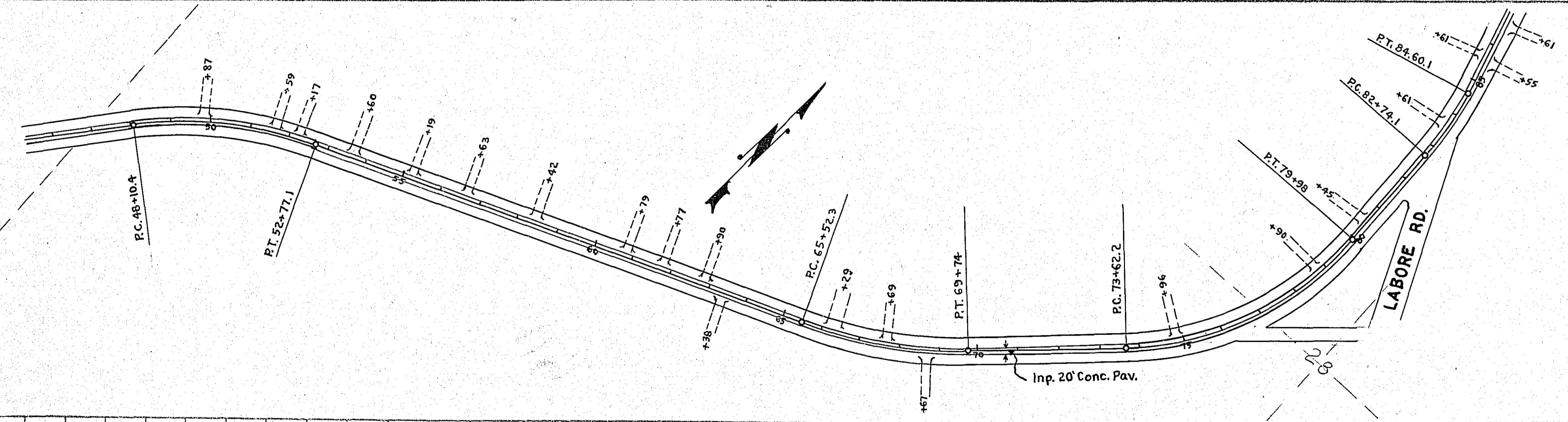
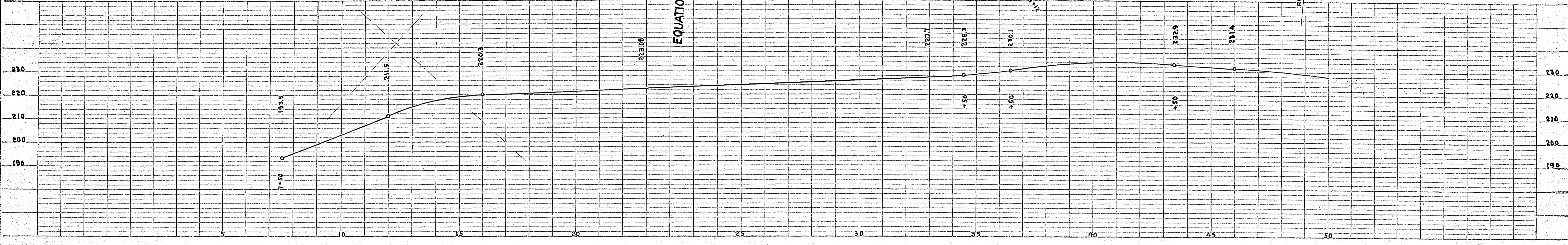
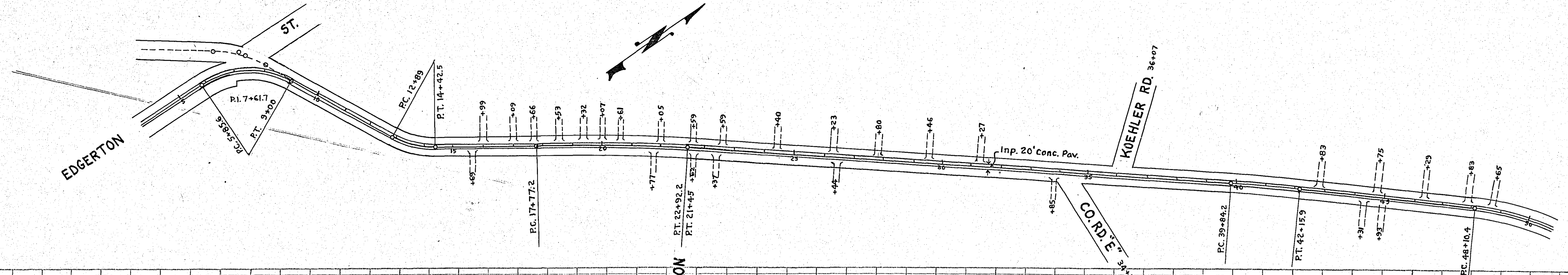

PLATE 2 PLAN PROFILE B P R STANDARD  
EUGENE CHITZEN CO., Chicago-New York