

FULL TRAFFIC ACTUATED TRAFFIC SIGNAL SYSTEM AT INTERSECTION OF LEXINGTON AVE. (T.H.10) & COUNTY ROAD B

SCALE: 1" = 20'

ESTIMATED QUANTITIES				
PROJECT NO.	ITEM NO.	ITEM	UNIT	TOTAL ESTIMATED QUANTITIES
56-59	565.502	FULL TRAFFIC ACTUATED TRAFFIC CONTROL SIGNAL SYSTEM (INCLUDES CONCRETE CURBING APPROX. 260')	SIGNAL SYSTEM	1

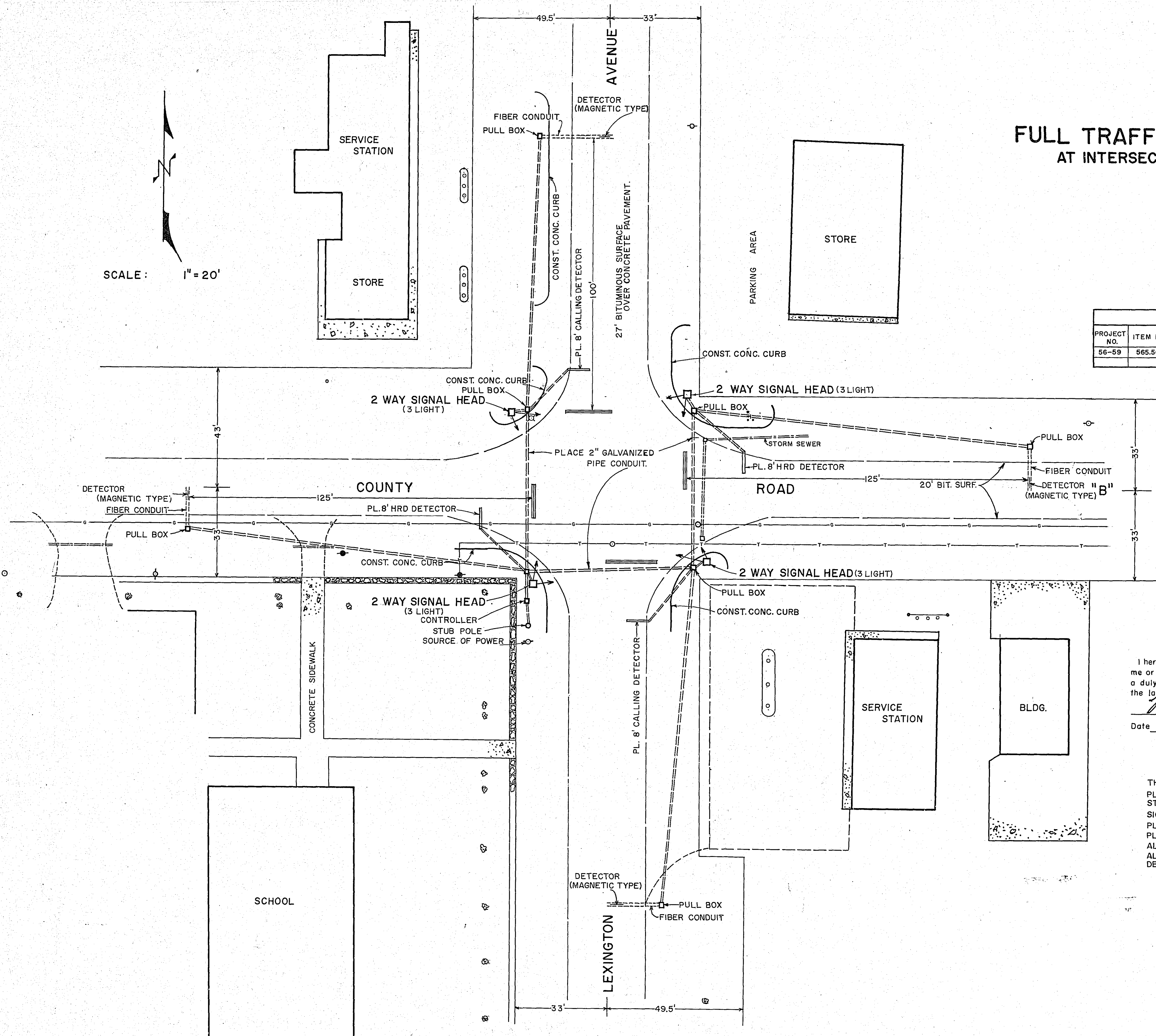

I hereby certify that this plan was prepared by me or under my direct supervision and that I am a duly Registered Professional Engineer under the laws of the State of Minnesota.
Harry S. Bruner
 Date July 1956 Reg. No. 818

APPROVED *Harry S. Bruner*
 RAMSEY COUNTY ENGINEER
 APPROVED *W. H. Goodrich*
 VICE-CHAIRMAN RAMSEY COUNTY BOARD

NOTES:
 THE DETECTOR RUNS SHALL BE ENCASED IN 1" GALVANIZED PIPE CONDUIT.
 PLACE PRECAST PULL BOXES AT ALL FOUR SIGNAL LOCATIONS. TERMINAL STRIPS TO BE PLACED IN ALL BOXES.
 SIGNAL HEADS TO BE EQUIPPED WITH 8" TUNNEL VISORS.
 PLACE PEDESTRIAN PUSH BUTTON ON ALL SIGNAL PEDESTALS.
 PLACE CONCRETE CURB AS SHOWN.
 ALL UNDERGROUND CABLE TO BE PLACED AT A MINIMUM DEPTH OF 18"
 ALL LOCATIONS SHOWN ARE APPROXIMATE. EXACT LOCATIONS WILL BE DETERMINED IN THE FIELD.

APPROVED *[Signature]* 11-21-56
 By *[Signature]*
 Traffic Engineer
 Department of Highways