

CONVENTIONAL SIGNS

STATE LINE	TIMBER
COUNTY LINE	BRUSH
TOWNSHIP OR RANGE LINE	ORCHARD
SECTION LINE	ROCK LEDGE
QUARTER LINE	SAND
SIXTEENTH LINE	EDGE OF CUT
RIGHT-OF-WAY LINE	TOE OF EMBANKMENT
PRESENT ROAD 1/4" LINE	CATCH BASIN
LIMITED ACCESS	MANHOLE
PROPERTY LINE (except Lake Lines)	DROP INLET
VACATED PLATTED PROPERTY	FIRE HYDRANT
CORPORATE OR CITY LIMITS	ARC LAMP
TRUNK HIGHWAY CENTER LINE	OTHER LAMPS (State Kind)
RETAINING WALL	RAILROAD CROSSING SIGN
STEAM RAILROAD	RAILROAD CROSSING BELL
ELECTRIC RAILROAD	ELECTRIC WARNING SIGN
RAILROAD RIGHT-OF-WAY LINE	CROSSING GATE
CREEK	CATTLE GUARD
RAPIDS OR WATERFALL	OVERHEAD (Highway Over)
DRY RUN	UNDERPASS (Highway Under)
DRAINAGE DITCH	ABUTMENT, WALL & PIER
HIGH TENSION LINE	BRIDGE
POWER POLE LINE	CULVERT
TELEPHONE OR TELEGRAPH LINE	BUILDING (One Story Frame)
TELEPHONE CONDUIT	C-CONCRETE S-STONE T-TILE B-BRICK ST-STUCCO
GUARD RAIL	HEDGE
WIRE FENCE	IRON PIPE
RAILROAD SNOW FENCE	STONE MONUMENT
BOARD OR HIGHWAY SNOW FENCE	WOOD STAKE OR HUB
STONE WALL OR FENCE	MEANDER CORNER
GAS MAIN	
WATER PIPE	
SEWER PIPE	
DRAIN TILE	
GRAVEL PIT	
SAND PIT	
CLAY PIT	
ROCK QUARRY	
SPRINGS	
MARSH	

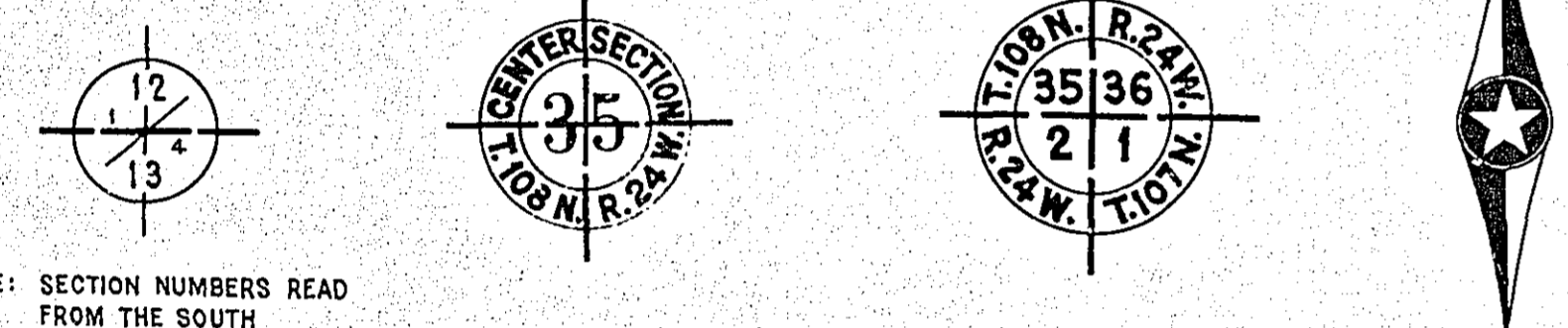

PIT DATA

PIT NO. _____	Located in _____
_____	Dead Haul _____
PIT NO. _____	Located in _____
_____	Dead Haul _____
PIT NO. _____	Located in _____
_____	Dead Haul _____
PIT NO. _____	Located in _____
_____	Dead Haul _____

SPECIFICATIONS

THE "SPECIFICATIONS FOR HIGHWAY CONSTRUCTION" DATED JULY 1, 1947 AND SUBMITTED FOR APPROVAL BY THE DIVISION ENGINEER OF THE BUREAU OF PUBLIC ROADS ON OCTOBER 15, 1947, AS MODIFIED BY "SUPPLEMENT 1" THERE TO DATED APRIL 15, 1953 AND SUBMITTED FOR APPROVAL BY THE DIVISION ENGINEER OF THE BUREAU OF PUBLIC ROADS ON MARCH 25, 1953, SHALL GOVERN.

**OFFICE OF COUNTY ENGINEER
RAMSEY COUNTY
CONSTRUCTION PLAN FOR GRADING
RACE TRACK
COUNTY FAIR GROUNDS**

INDEX

SHEET NO.	DESCRIPTION
1	LAYOUT MAP AND TITLE SHEET
2	PLAN SHEET
3-6	CROSS SECTIONS

SCALES

PLAN, 1 inch = 100 Feet
 PROFILE, Horiz. 1 inch = 100 Feet. Vert. 1 inch = 10 Feet.
 WORKING PLANS - Horiz. 1 inch = Feet
 Vert. 1 inch = Feet
 Cross-Sections (See Cross-Section Sheets.)
 LAYOUT, 1 inch = 2640 Feet

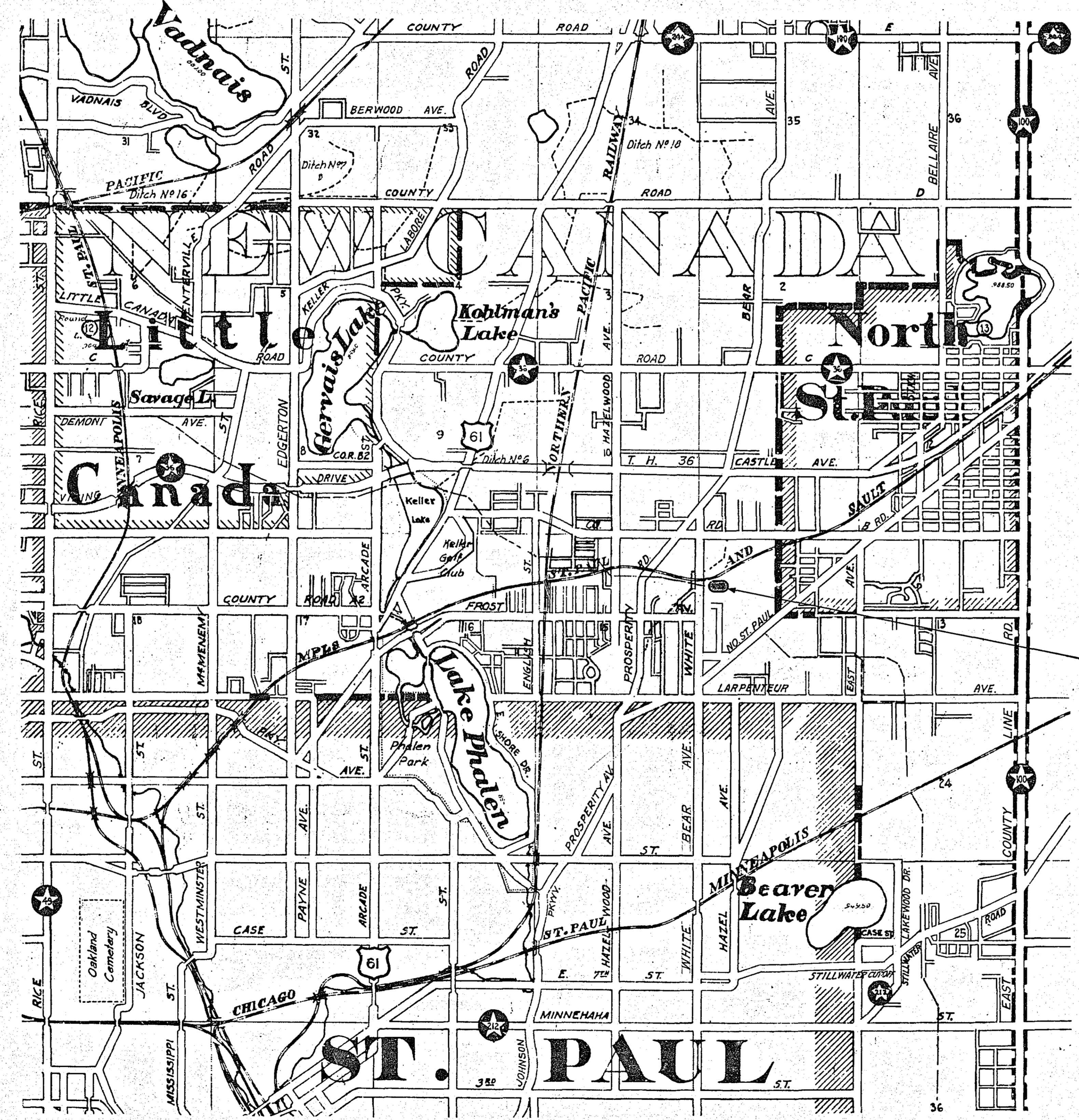

I HEREBY CERTIFY THAT THIS PLAN WAS PREPARED BY ME OR UNDER MY DIRECT SUPERVISION AND THAT I AM A DULY REGISTERED PROFESSIONAL ENGINEER UNDER THE LAWS OF THE STATE OF MINNESOTA.

Barry A. Brown COUNTY ENGINEER REG. NO. 818 DATE 4/12/56

RECOMMENDED FOR APPROVAL *Barry A. Brown* COUNTY ENGINEER DATE 4/12/56

APPROVED *Joseph E. Chilton* DATE 5/7/56
CHAIRMAN OF RAMSEY COUNTY BOARD

APPROVED *W. L. Johnson* DATE 4/12/56
CHAIRMAN, RAMSEY COUNTY AGRICULTURAL SOCIETY

STA. 7+55 ±
F. & I. 15" X 90' S.C. PIPE CULV.

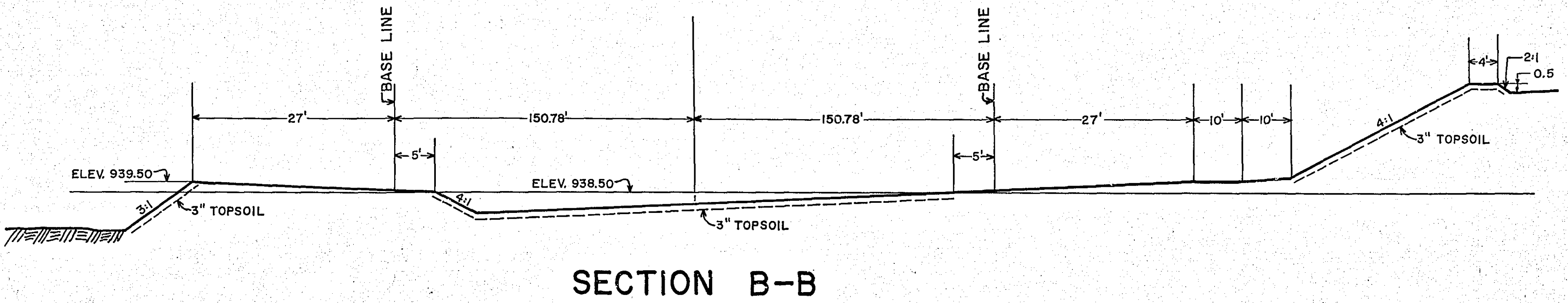
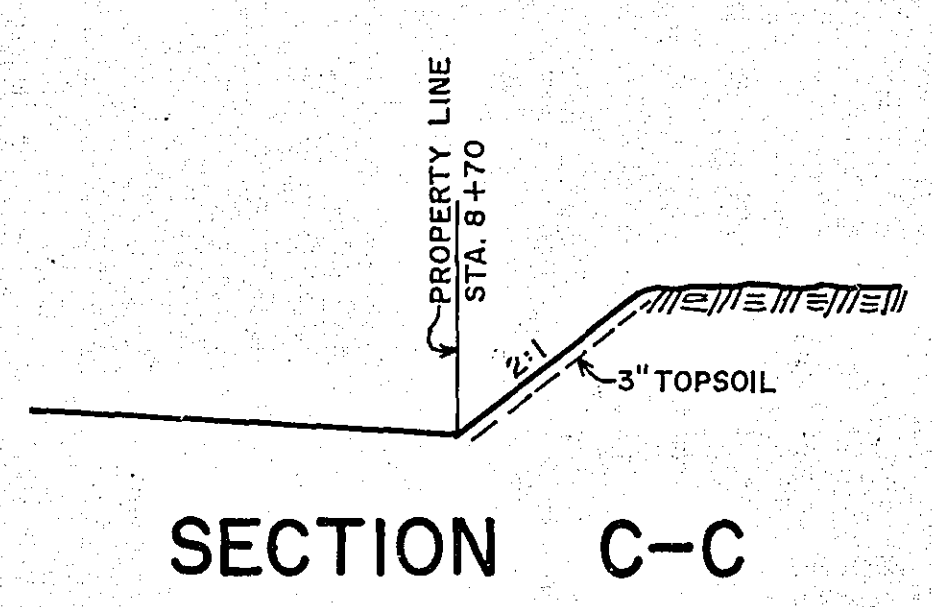
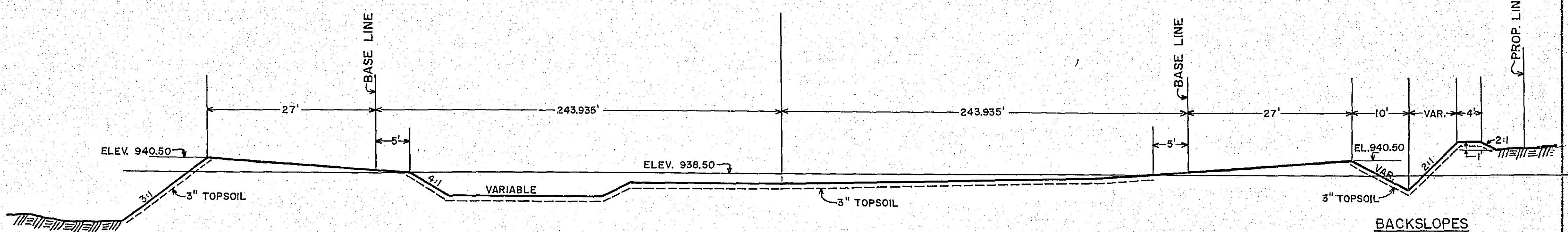
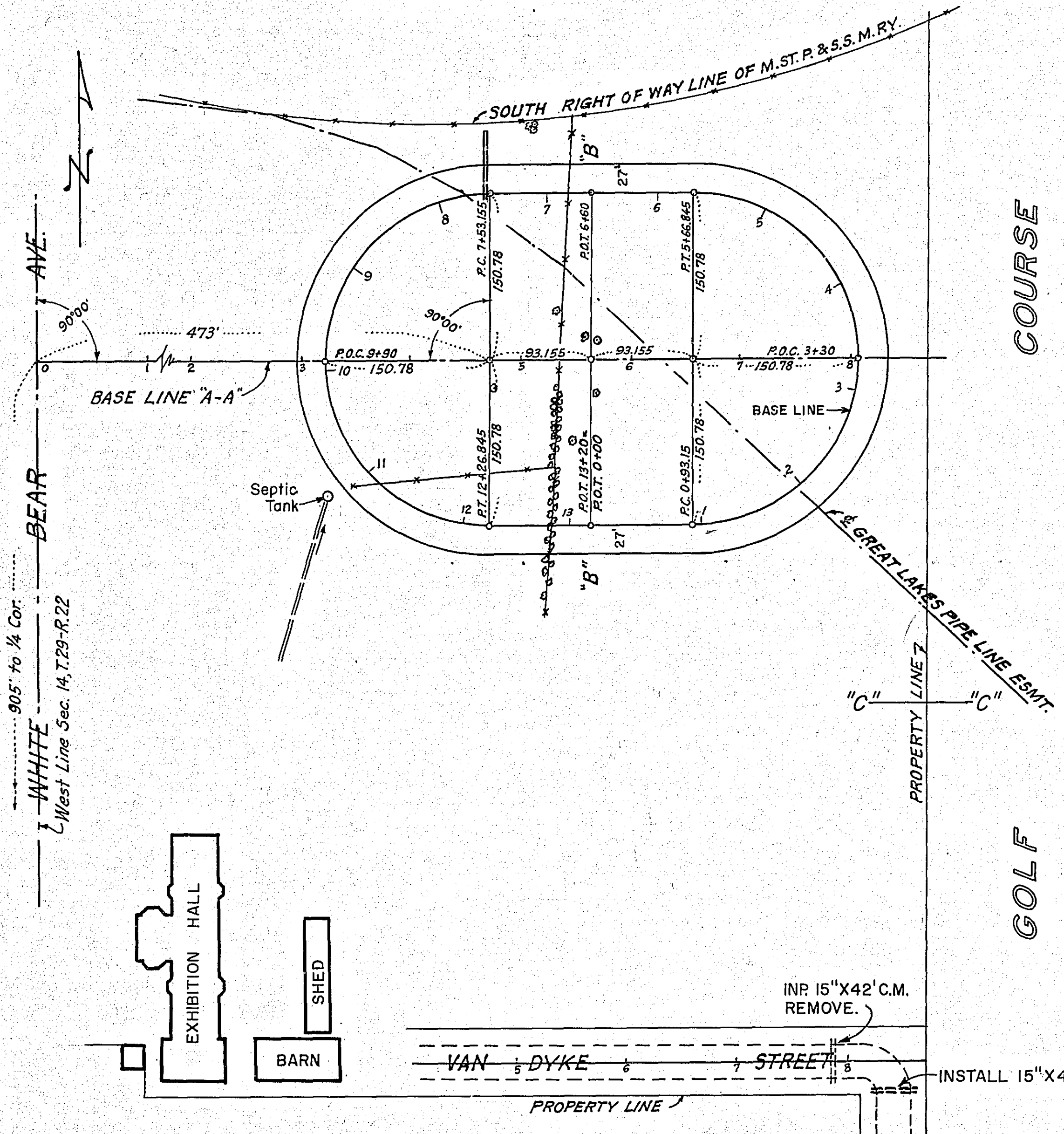

B.M. Spike in Power Pole at North end of Barn Elev. 964.32

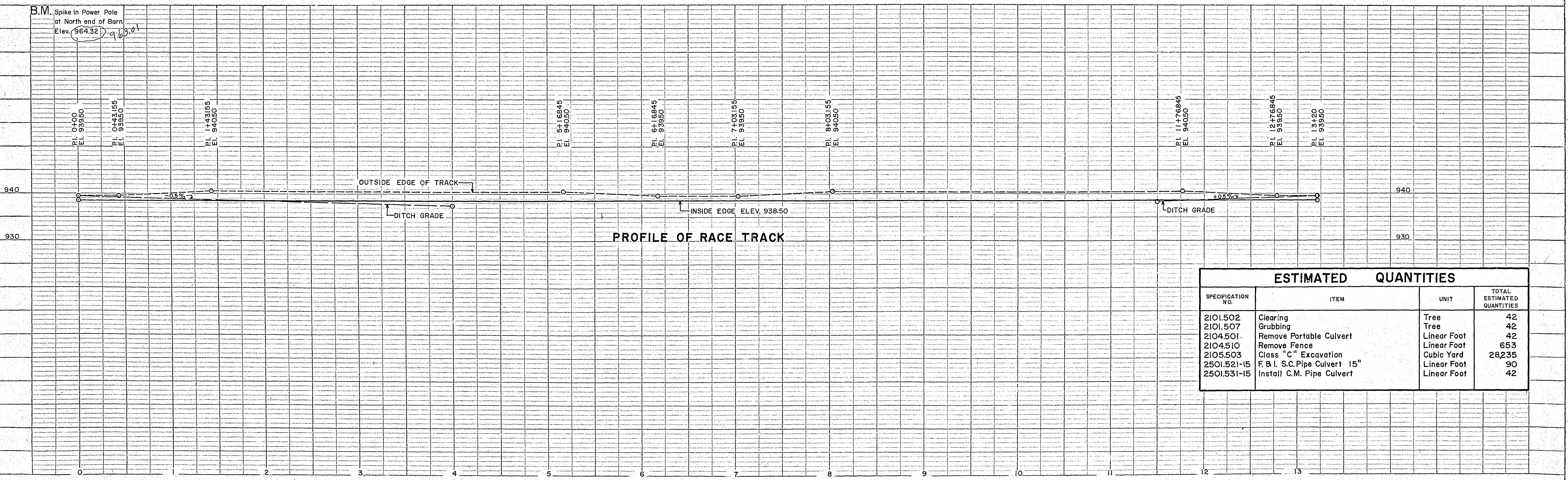

ESTIMATED QUANTITIES			
SPECIFICATION NO.	ITEM	UNIT	TOTAL ESTIMATED QUANTITIES
2101.502	Clearing	Tree	42
2101.507	Grubbing	Tree	42
2104.501	Remove Portable Culvert	Linear Foot	42
2104.510	Remove Fence	Linear Foot	653
2105.503	Class "C" Excavation	Cubic Yard	28235
2501.521-15	F. & I. S.C. Pipe Culvert 15"	Linear Foot	90
2501.531-15	Install C.M. Pipe Culvert	Linear Foot	42

STATION-ELEVATION

EXCAVATION | EMBANKMENT
SUB-TOTALS - CU. YDS. | CU. YDS. | SUB-TOTALS

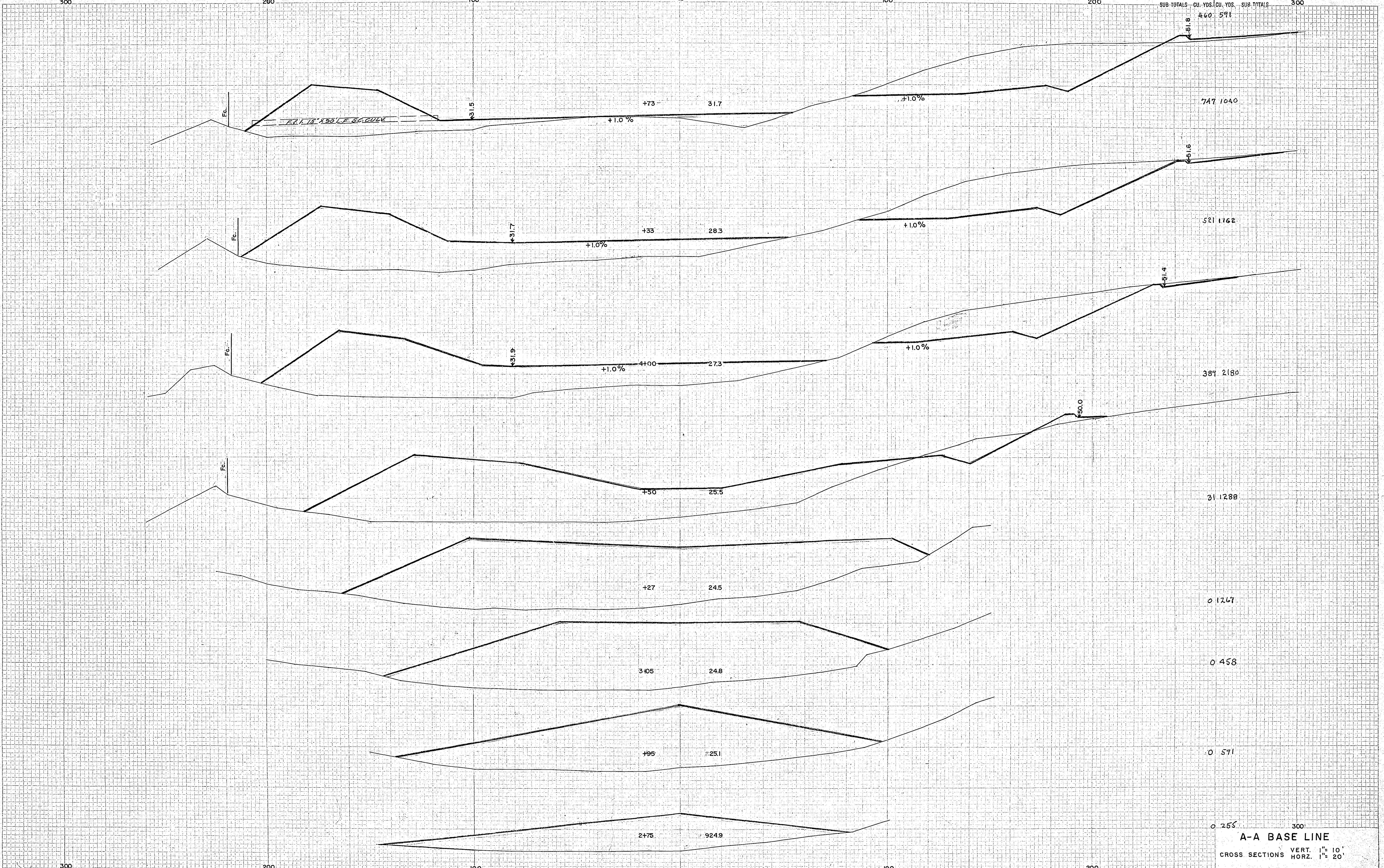

DATE: 10/15/54
PROJECT: RACE TRACK
DRAWN BY: J. W. BROWN
CHECKED BY: J. W. BROWN

DATE: 10/15/54
PROJECT: RACE TRACK
DRAWN BY: J. W. BROWN
CHECKED BY: J. W. BROWN

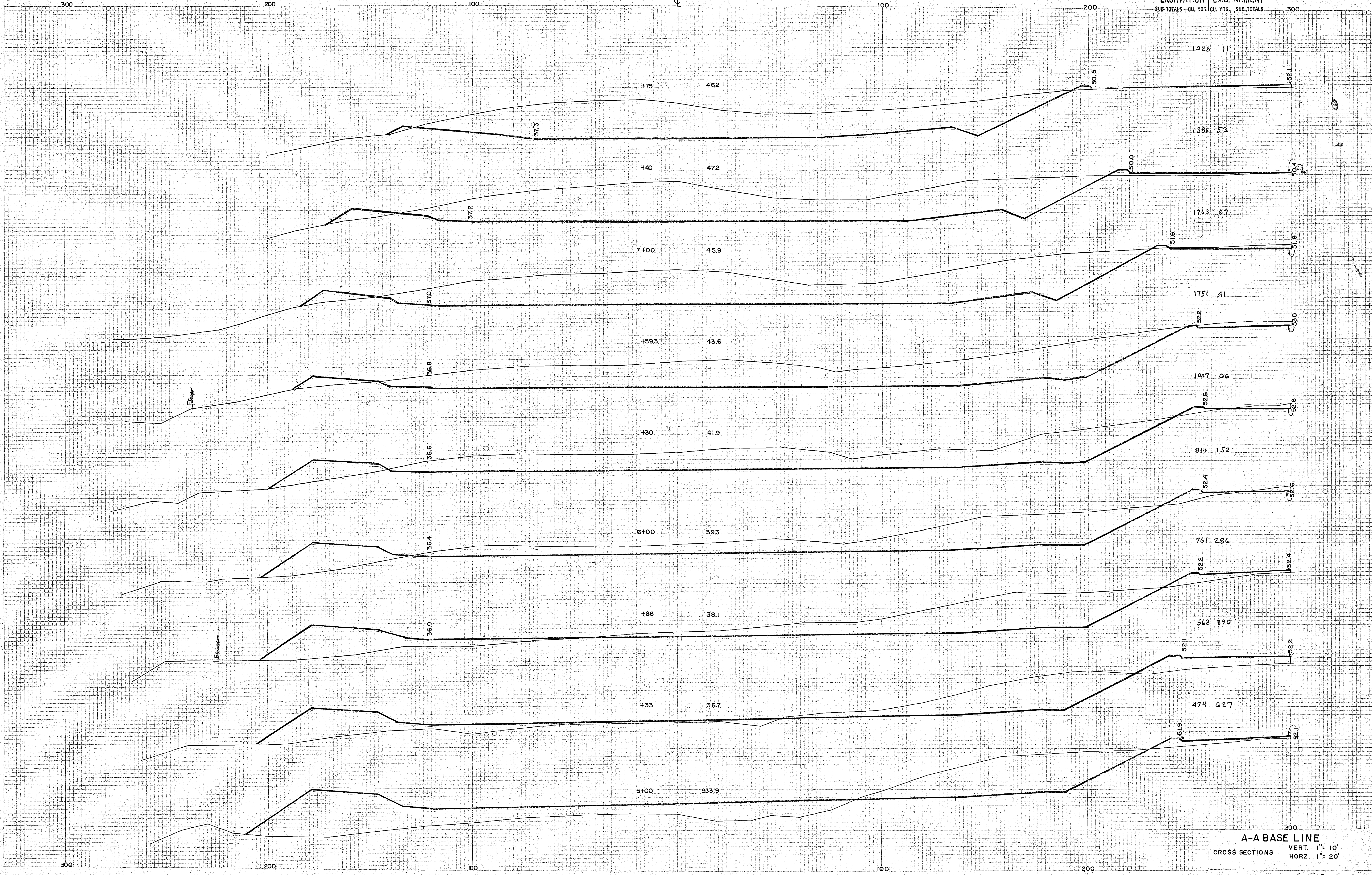

NO. 1
 SCALE DRAWN: [unclear]
 SURVEY: [unclear]
 LIMIT: [unclear]

NO. 2
 SCALE DRAWN: [unclear]
 SURVEY: [unclear]
 LIMIT: [unclear]

A-A BASE LINE
 CROSS SECTIONS VERT. 1" = 10'
 HORZ. 1" = 20'

DATE	
BY	
CHECKED	
APPROVED	
PROJECT	
LOCATION	
SCALE	
DATE	
BY	
CHECKED	
APPROVED	
PROJECT	
LOCATION	
SCALE	

DATE	
BY	
CHECKED	
APPROVED	
PROJECT	
LOCATION	
SCALE	
DATE	
BY	
CHECKED	
APPROVED	
PROJECT	
LOCATION	
SCALE	

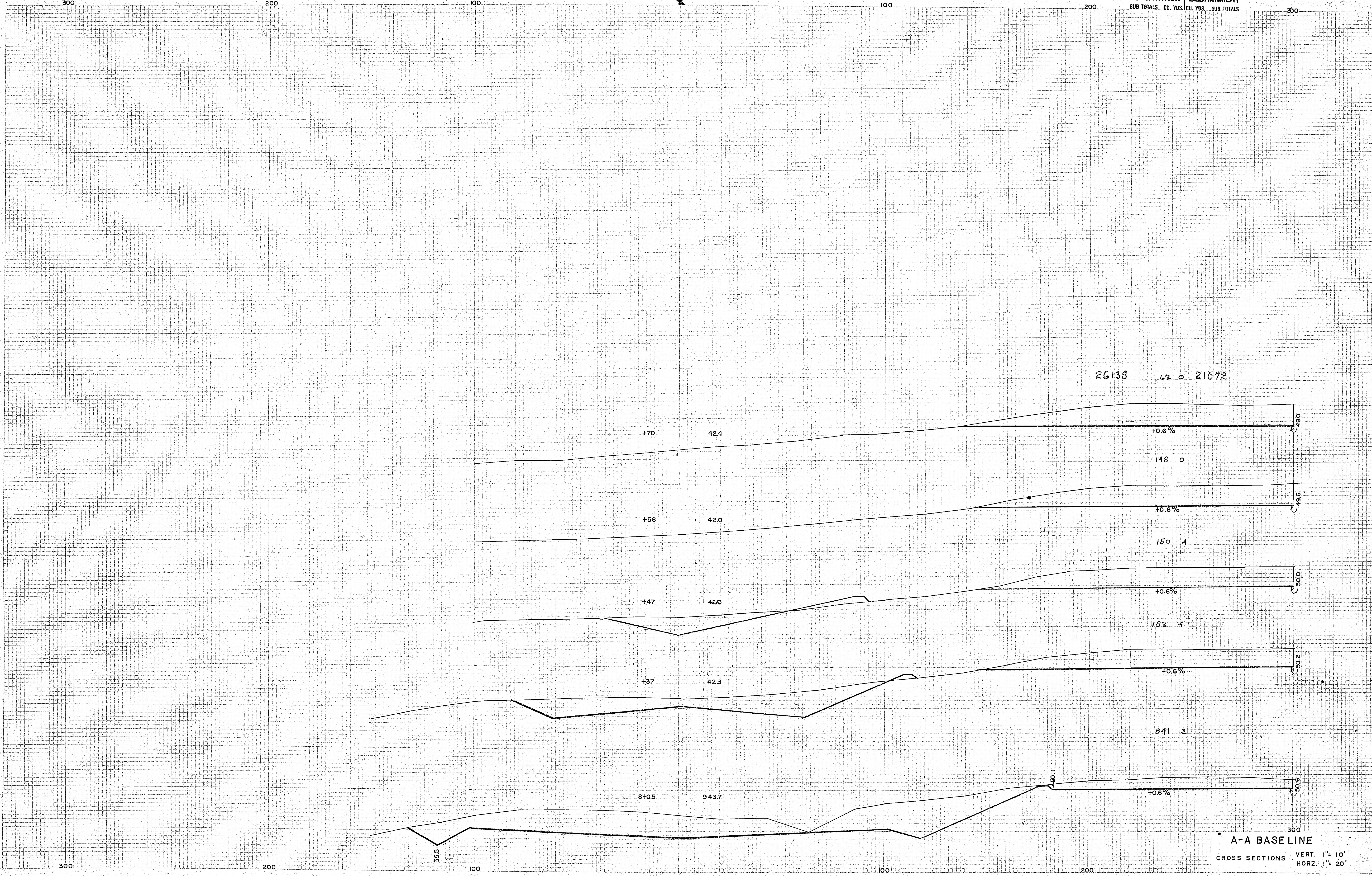

A-A BASELINE
 CROSS SECTIONS VERT. 1" = 10'
 HORZ. 1" = 20'

NO. 5
 DATE BOOKED
 SHEET NO. 11
 PROJECT NO. 11
 DRAWN BY
 CHECKED BY

DATE
 NAME
 POSITION
 PROJECT NO.
 SHEET NO.
 DRAWN BY
 CHECKED BY

EXCAVATION EMBARKMENT
 SUB TOTALS CU. YDS. CU. YDS. SUB TOTALS
 2097 191 0 711

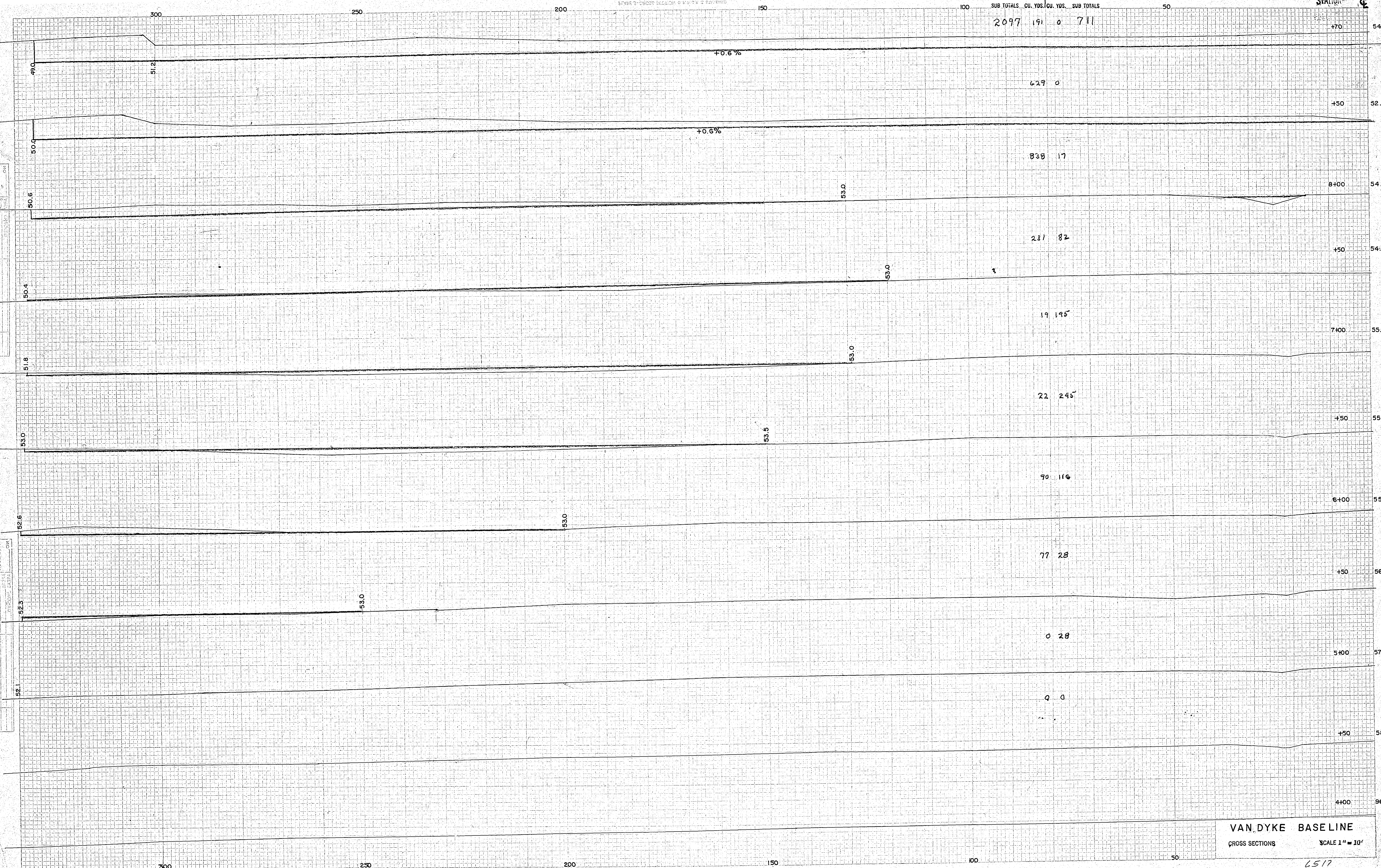

VAN DYKE BASELINE
 CROSS SECTIONS SCALE 1" = 10'
 RACE TRACK
 Sheet No. 6 of 6 Sheets