

CONVENTIONAL SIGNS

STATE LINE	=====	TIMBER	
COUNTY LINE	=====	BRUSH	
TOWNSHIP OR RANGE LINE	=====	ORCHARD	
SECTION LINE	=====	ROCK LEDGE	
QUARTER LINE	=====	SAND	
SIXTEENTH LINE	=====	EDGE OF CUT	
RIGHT-OF-WAY LINE	=====	TOE OF EMBANKMENT	
PRESENT ROAD 1/4 LINE	=====	CATCH BASIN	
LIMITED ACCESS	=====	MANHOLE	
PROPERTY LINE (Except Land Lines)	=====	DROP INLET	
VACATED PLATTED PROPERTY	=====	FIRE HYDRANT	
CORPORATE OR CITY LIMITS	=====	ARC LAMP	
TRUNK HIGHWAY CENTER LINE	=====	OTHER LAMPS (state kind)	
RETAINING WALL		RAILROAD CROSSING SIGN	
STEAM RAILROAD		RAILROAD CROSSING BELL	
ELECTRIC RAILROAD		ELECTRIC WARNING SIGN	
RAILROAD RIGHT-OF-WAY LINE	=====	CROSSING GATE	
CREEK		CATTLE GUARD	
RAPIDS OR WATERFALL		OVERHEAD (Highway Over)	
DRY RUN		UNDERPASS (Highway Under)	
DRAINAGE DITCH		ABUTMENT, WALL & PIER	
HIGH TENSION LINE		BRIDGE	
POWER POLE LINE		CULVERT	
TELEPHONE OR TELEGRAPH LINE		BUILDING (One Story Frame)	
TELEPHONE CONDUIT		C-CONCRETE S-STONE T-TILE B-BRICK ST-STUCCO	
GUARD RAIL		EDGE	
WIRE FENCE		IRON PIPE	
RAILROAD SNOW FENCE		STONE MONUMENT	
BOARD OR HIGHWAY SNOW FENCE		WOOD STAKE OR HUB	
STONE WALL OR FENCE		MEANDER CORNER	
GAS MAIN			
WATER PIPE			
SEWER PIPE			
DRAIN TILE			
GRAVEL PIT			
SAND PIT			
CLAY PIT			
ROCK QUARRY			
SPRINGS			
MARSH			

**OFFICE OF COUNTY ENGINEER
RAMSEY COUNTY**
CONSTRUCTION PLAN FOR BITUMINOUS SURFACING
WHITE BEAR AVENUE
RAMSEY COUNTY PROJECT NO. 55-30
FROM LARPEUR AVENUE TO COUNTY ROAD E

GROSS LENGTH	21,885 FEET	4.145 MILES
BRIDGES-LENGTH	0 FEET	0 MILES
EXCEPTIONS-LENGTH	2,173 FEET	0.412 MILES
NET LENGTH	19,712 FEET	3.733 MILES

SCALES

PLAN, 1 inch = 100 Feet
PROFILE, Horiz. 1 inch = 100 Feet. Vert. 1 inch = 10 Feet.
WORKING PLANS, Horiz. 1 inch = 100 Feet. Vert. 1 inch = 10 Feet.
LAYOUT, 1 inch = 5 Feet

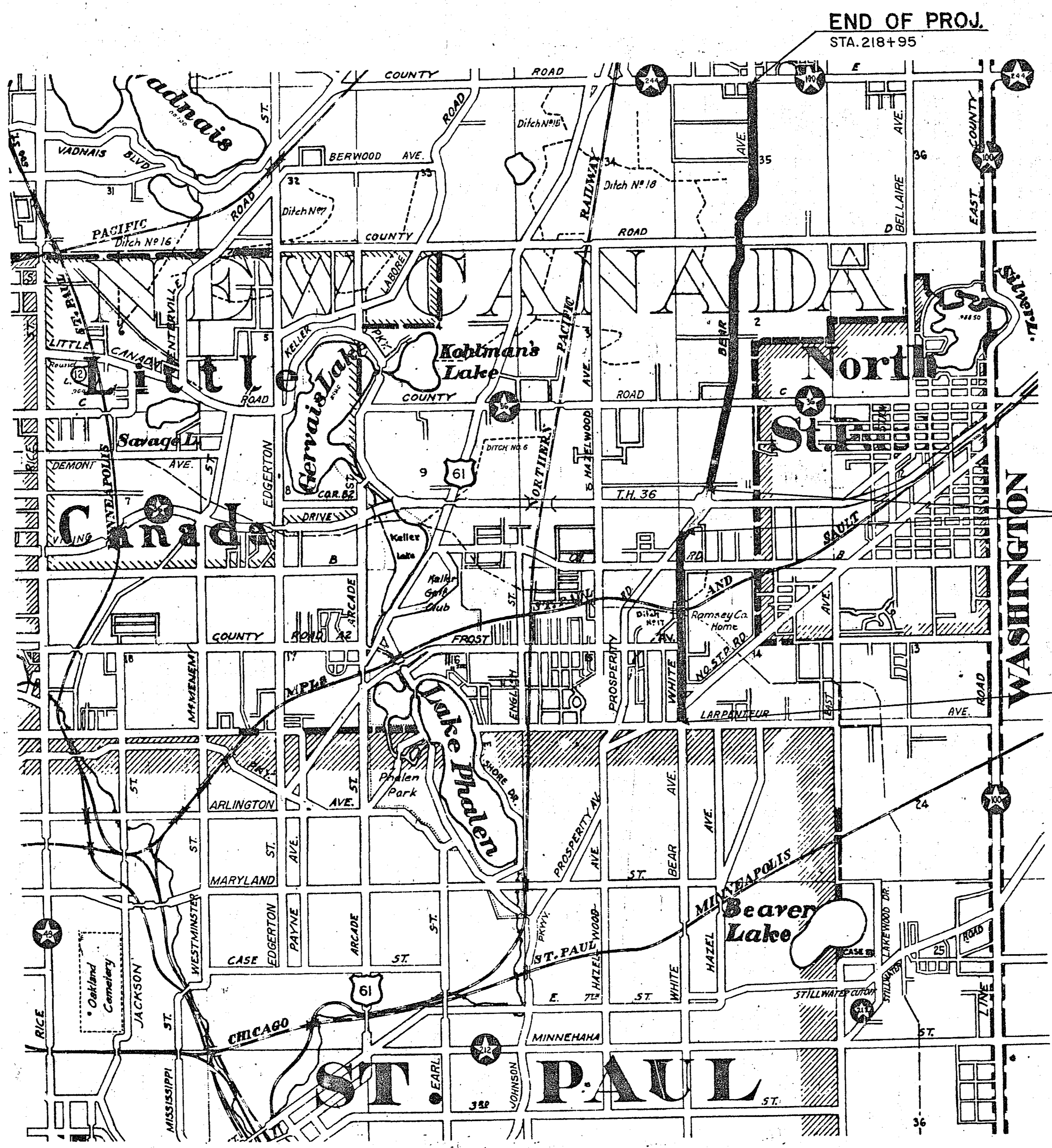

EXCEPTION
STA. 63+96 TO STA. 85+69

BEG. PROJ.
STA. 0+10

END OF PROJ.
STA. 218+95

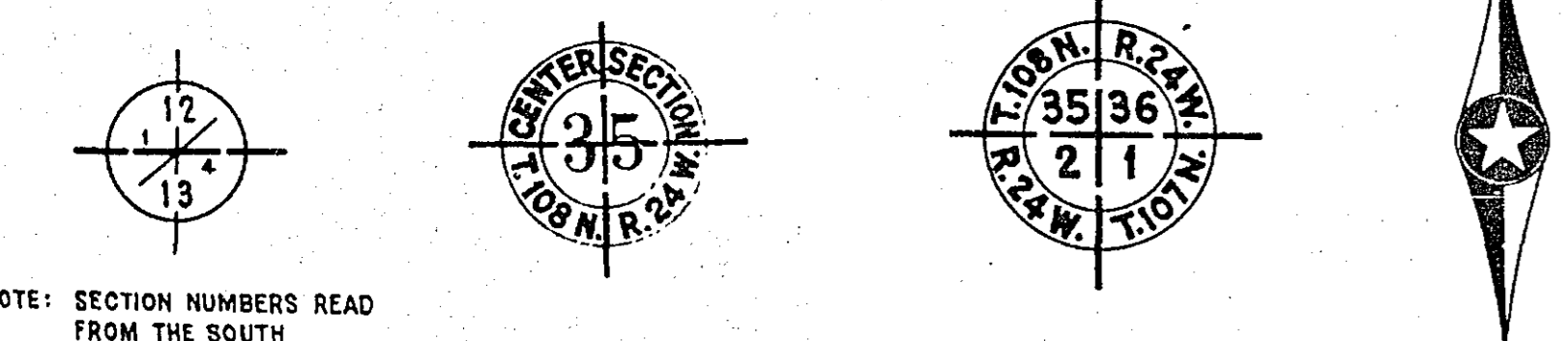

NOTE: SECTION NUMBERS READ FROM THE SOUTH

PIT DATA

PIT NO. _____	Located in _____
PIT NO. _____	Located in _____
PIT NO. _____	Located in _____
PIT NO. _____	Located in _____

SPECIFICATIONS

THE "SPECIFICATIONS FOR HIGHWAY CONSTRUCTION" DATED JULY 1, 1947 AND SUBMITTED FOR APPROVAL BY THE DIVISION ENGINEER OF THE BUREAU OF PUBLIC ROADS ON OCTOBER 15, 1947, AS MODIFIED BY "SUPPLEMENT 1" THERETO DATED APRIL 15, 1953 AND SUBMITTED FOR APPROVAL BY THE DIVISION ENGINEER OF THE BUREAU OF PUBLIC ROADS ON MARCH 25, 1953, SHALL GOVERN.

I HEREBY CERTIFY THAT THIS PLAN WAS PREPARED BY ME OR UNDER MY DIRECT SUPERVISION AND THAT I AM A DULY REGISTERED PROFESSIONAL ENGINEER UNDER THE LAWS OF THE STATE OF MINNESOTA.

Barry J. Brown COUNTY ENGINEER REG. NO. 818 DATE 6/20/55

RECOMMENDED FOR APPROVAL *Barry J. Brown* COUNTY ENGINEER DATE 6/20/55

APPROVED *Joseph E. Sullivan* CHAIRMAN OF RAMSEY COUNTY BOARD DATE 6/21/55

APPROVED _____ ENGINEER OF COUNTY DIVISION DATE _____

APPROVED _____ ENGINEER OF PLANS AND SURVEYS DATE _____

PLAN	SURVEYED	DATE
	PLOTTED	BY
	ALIGNMENT CHECKED	
	RET. OF WAY CHECKED	
	NO.	

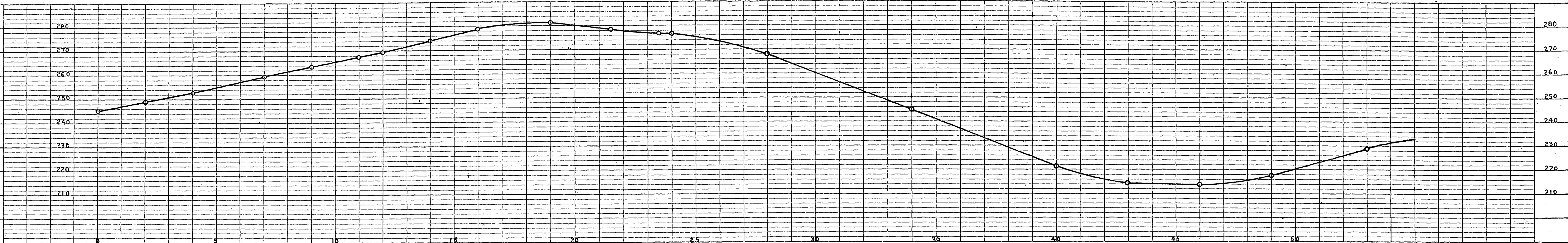
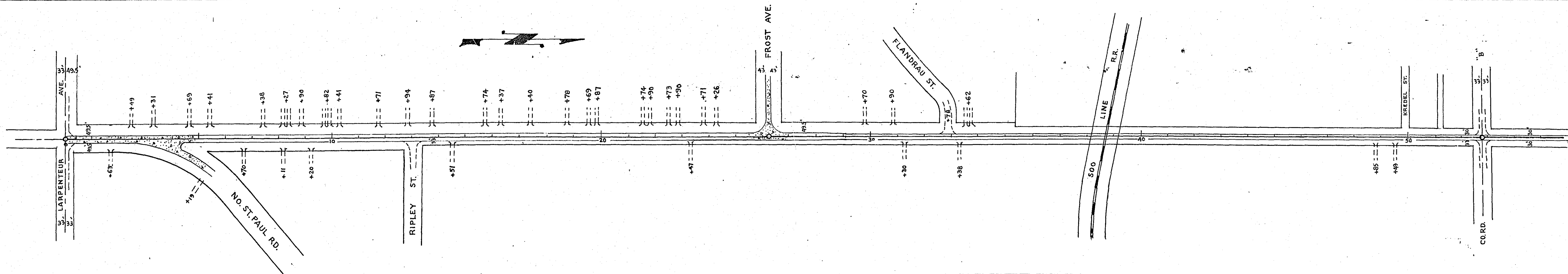

PROFILE	SURVEYED	DATE
	PLOTTED	BY
	GRADES CHECKED	
	B. M. NOTED	
	STRUCTURE NOTATIONS CHECKED	
	NO.	

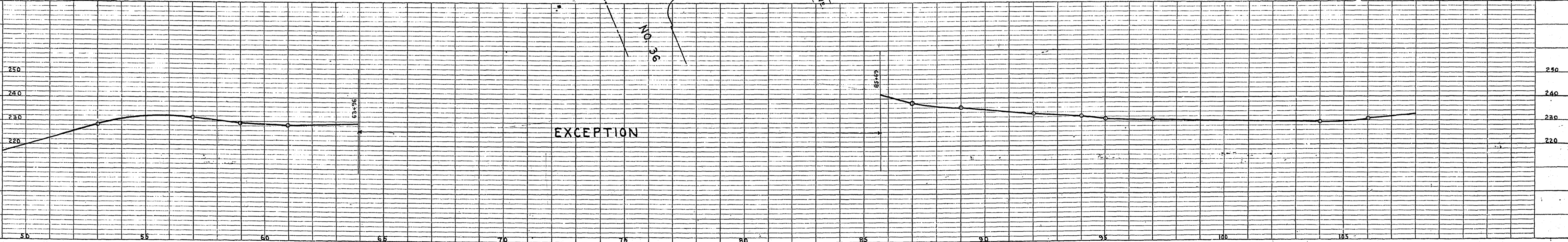
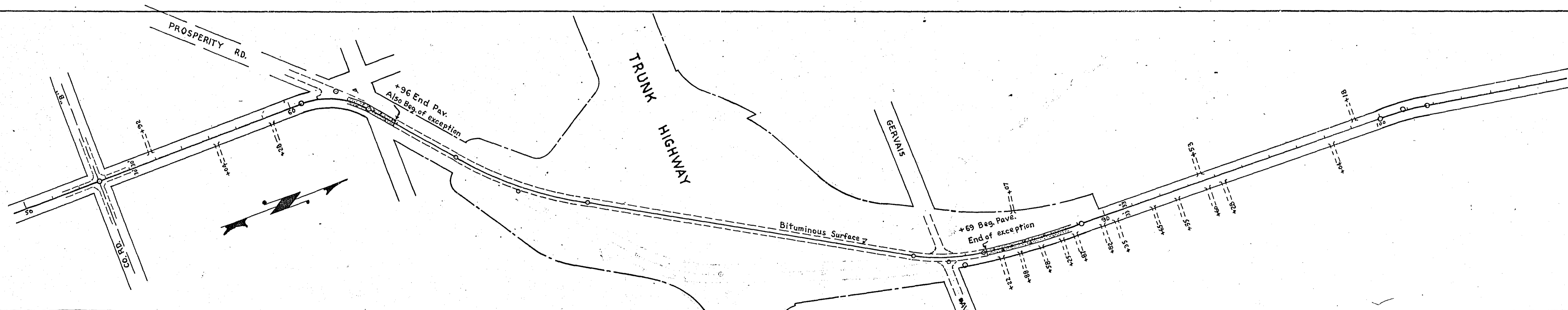

6515

PLAN SURVEYED _____
 PLOTTED _____
 NOTE BOOK NO. _____
 CHECKED _____
 R.T. OF WAY CHECKED _____

PROFILE SURVEYED _____
 PLOTTED _____
 NOTE BOOK NO. _____
 GRADES CHECKED _____
 STRUCTURE NOTATIONS CH'VD _____

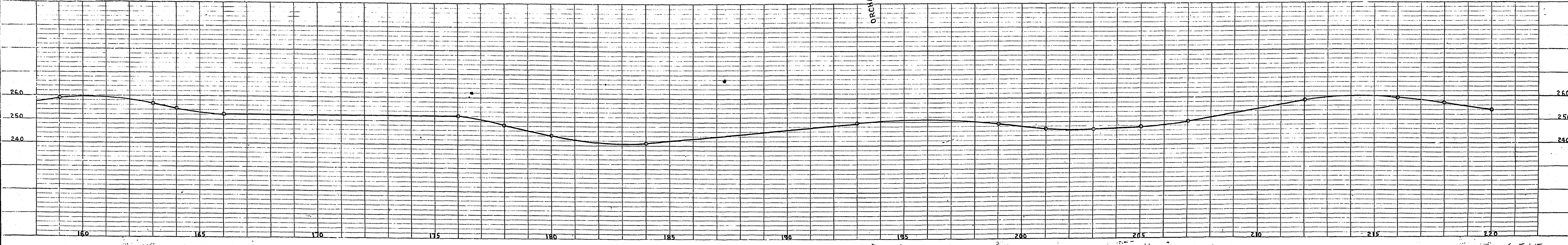
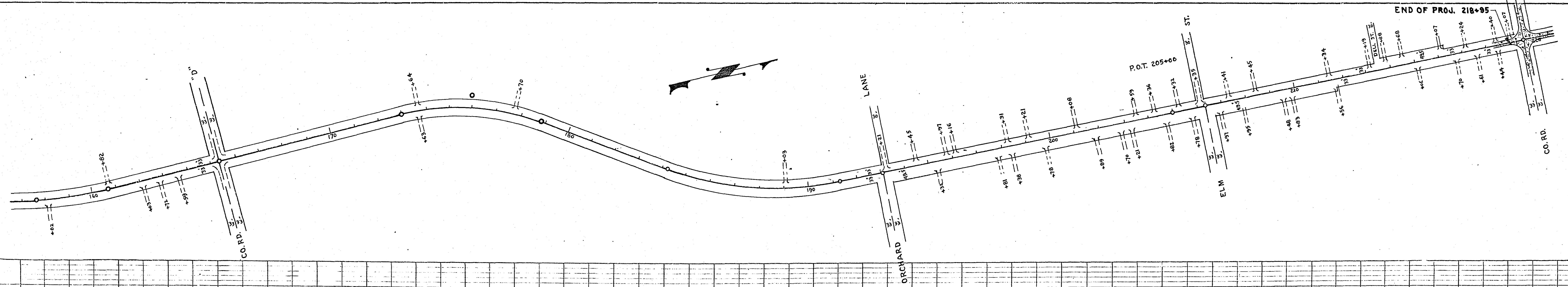
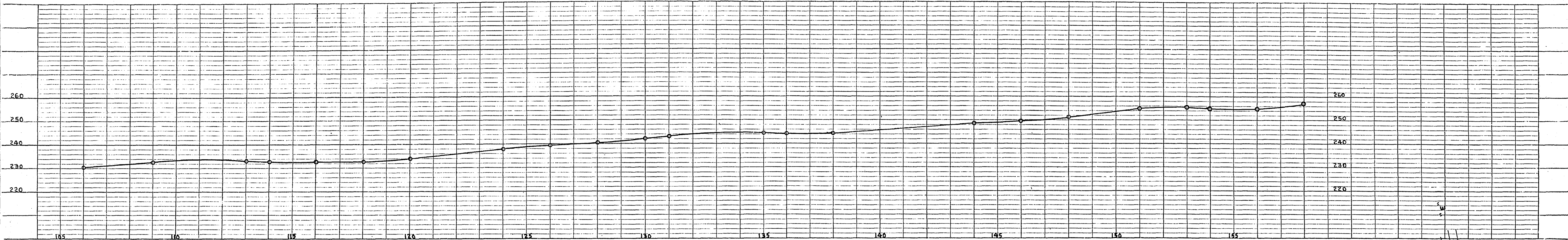
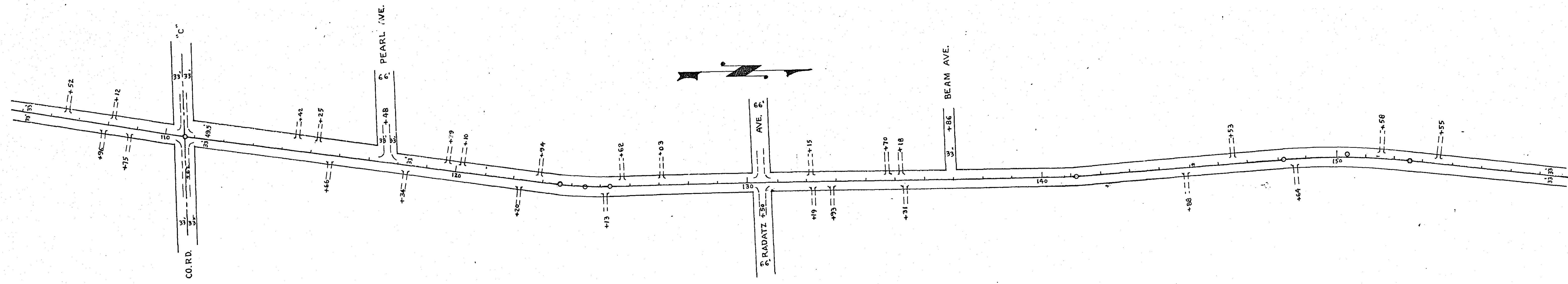

6.515