

CONVENTIONAL SIGNS & ABBREVIATIONS

STATE LINE	-----	EXCAVATION	-----	F
COUNTY LINE	-----	EMBANKMENT	-----	F
TOWNSHIP LINE	-----	OVERHAUL	-----	H
SECTION LINE	-----	SURFACING	-----	S
CITY, VILLAGE, OR BOROUGH	-----	GUARD RAIL	-----	GR
FENCE LINE	-----	INTERSECTION ANGLE	-----	A
RIGHT-OF-WAY LINE	-----	RADIUS	-----	R
TRAVELLED WAY	-----	ELEVATION	-----	EL
RAILROADS	-----	VERTICAL CURVE	-----	VC
RETAINING WALL	-----	BENCH MARK	-----	B.M.
BASE OR SURVEY LINE	-----	SECTIONAL CONCRETE CULVERT	-----	P.C.
LEVEE	-----	CORRUGATED METAL CULVERT	-----	C.M.
GRAVEL PIT	-----	CULVERT HAUL	-----	P.L.H.
SAND PIT	-----	TON MILES	-----	T.M.
CLAY PIT	-----	PLACE	-----	P
ROCK QUARRY	-----	IN PLACE	-----	Imp.
CULVERTS	-----	REPLACE	-----	Rep.
PLAIN	-----	RIGHT	-----	R
WITH FACEWALLS	-----	LEFT	-----	L
WITH WINGWALLS	-----	HAND DITCHING	-----	H.D.
DROP INLET	-----	POINT OF CURVE	-----	P.C.
POWER POLE LINE	-----	POINT OF TANGENT	-----	P.T.
TELEPHONE OR TELEGRAPH LINE	-----	POINT OF INTERSECTION	-----	P.I.
MARSH	-----	SPECIAL EXCAVATION	-----	S.E.
HEDGE, BRUSH, OR TIMBER	-----	SPECIAL FLOWING	-----	S.P.
GROUND ELEVATION	-----	TELEPHONE POLE	-----	Tel.P.

OFFICE OF COUNTY SURVEYOR
RAMSEY COUNTY

Plan and Profile of County Project No. 33-M18

From a point 1320.07 ft. S. & 50 ft. W. of the N. 1/4 Cor. of Sec. 25-30-23, to a point 1319.30 ft. S. & 16.75 ft. W. of the NE. Cor. of Sec. 25-30-23
Give proper reference to Sections, Township and Range

GROSS LENGTH- 2671.0 FEET 0.507 MILES
LENGTH OF EXCEPTIONS- FEET MILES
NET LENGTH- 2671.0 FEET 0.507 MILES
PLAN, 1 Inch = 100 Feet
PROFILE, Horiz. 1 Inch = 100 Feet. Vert. 1 Inch = 10 Feet
WORKING PLANS { Horiz. 1 Inch = 100 Feet
Vert. 1 Inch = 10 Feet
Cross-Sections, 1 Inch = 10 Feet

LAYOUT
SCALE, 1 Inch = 2640 Feet

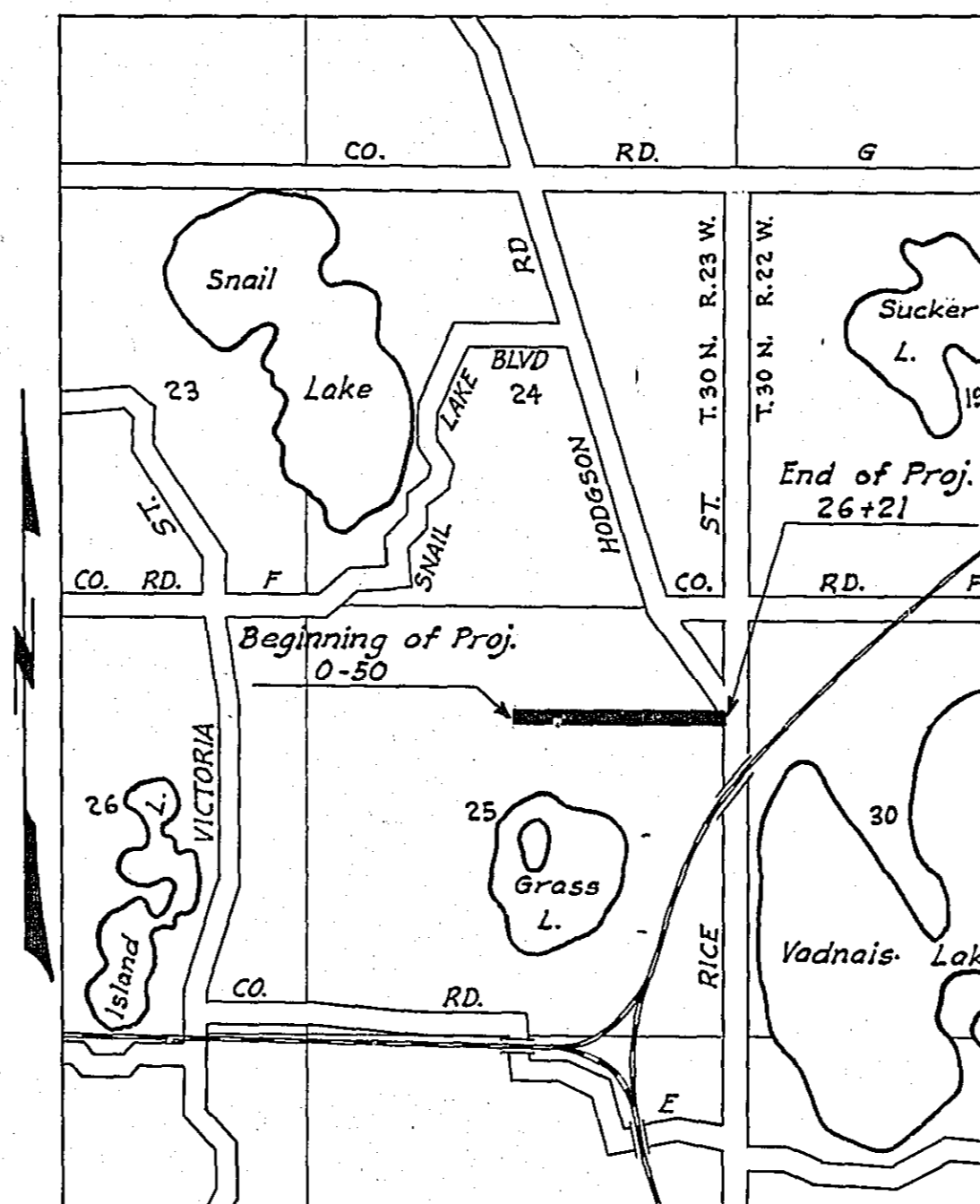

INDEX OF SHEETS

Sheet No. 1. Title Sheet and Layout Map
" No. 2. Typical Cross-Sections and Statement
" No. 3. Plan and Profile, Sta. 0+50 to Sta. 26+21
" No. 4-6. Cross Sections

Date of Resolution for Preparation of Plans 7/17 1933
Planned by W.W. Coffey ASSISTANT ENGINEER
Recommended for Approval [Signature] ASSISTANT ENGINEER
Planned and Recommended for Consideration [Signature] COUNTY SURVEYOR
Approved 8/3 1933 [Signature] CHAIRMAN OF TOWN BOARD
Approved by County Board 8-7-33 1933 [Signature] CHAIRMAN OF COUNTY BOARD

STATEMENT OF ESTIMATED QUANTITIES

CLASS	ITEM	UNIT	MILE From To	MILE From To	MILE From To	MILE From To	MILE From To	MILE From To	MILE From To	MILE From To	MILE From To	MILE From To	TOTAL ESTIMATED QUANTITIES
GRADING	1	Clearing	Trees	30									30
	2	Grubbing	Trees	42									42
	3	Clearing	Acres	0 1/2									0 1/2
	4	Grubbing	Acres	0 1/2									0 1/2
	5	Excavation Earth	Cu. Yds.	4576									4576
	6	Excavation Loose Rock	Cu. Yds.	20									20
	7	Excavation Solid Rock	Cu. Yds.	10									10
	8	Excavation Overhaul	Cu. Yds.										
	9	Excavation Special	Cu. Yds.										
	10	Excavation Hand Ditch	Cu. Yds.										
	11	Install 12" C.M.	Lin. Ft.										
	12	Install 15" C.M.	Lin. Ft.	100									100
	13	Install 18" C.M.	Lin. Ft.										
	14	Install 24" C.M.	Lin. Ft.										
	15	Install	Lin. Ft.										
	16	Install 15" P.	Lin. Ft.	24									24
	17	Install 18" P.	Lin. Ft.										
	18	Install 24" P.	Lin. Ft.	78									78
	19	Install 30" P.	Lin. Ft.										
	20	Install 36" P.	Lin. Ft.										
	21	Install	Lin. Ft.										
	22	Install	Lin. Ft.										
	23	Remove Old Culvert	Lin. Ft.	40									40
	24	Replace Old Culvert	Lin. Ft.	20									20
	25	Finishing and Seeding	100 Sq.Yds.										
	26	Rubble Gutter	Cu. Yds.										
	27	Headwall Concrete	Cu. Yds.										
	28	Headwall Steel	Lbs.										
	29												
	30												
	31												
	32												
C.M. CULVERTS	1	Furnish 12" C.M.	Lin. Ft.	100									100
	2	Furnish 15" C.M.	Lin. Ft.										
	3	Furnish 18" C.M.	Lin. Ft.										
	4	Furnish 24" C.M.	Lin. Ft.										
	5	Furnish	Lin. Ft.										
	6	Furnish	Lin. Ft.										
	7	Furnish 12" C.M. Band	Each										
	8	Furnish 15" C.M. Band	Each										
	9												
	10												
P ₃ CULVERTS	1	Furnish 18" P ₃	Lin. Ft.	78									78
	2	Furnish 24" P ₃	Lin. Ft.										
	3	Furnish 30" P ₃	Lin. Ft.										
	4	Furnish 36" P ₃	Lin. Ft.										
	5	Furnish 15" P ₁	Lin. Ft.	24									24
	6												
GUARD RAIL	1	Guard Rail - Cable	Lin. Ft.	450									450
	2	Guard Rail Anchors	Each	4									4
	3	Dummy Posts	Each										
	4												
SIDEWALKS AND CURBING	1	Concrete Curb - Straight	Lin. Ft.										
	2	Concrete Curb - Radius	Lin. Ft.										
	3	Remove Old Curb	Lin. Ft.										
	4	Remove Old Curb and Gutter	Lin. Ft.										
	5	Remove Old Sidewalk	Sq. Ft.										
	6	Replace Old Sidewalk	Sq. Ft.										
	7	Construct New Sidewalk	Sq. Ft.										
	8	Curb Inlet	Each										
	9	Catch Basin Complete	Each										
	10												
	11												
	12												
SEWER	1	12" Vitrified Sewer Pipe	Lin. Ft.										
	2	15" Vitrified Sewer Pipe	Lin. Ft.										
	3	18" Vitrified Sewer Pipe	Lin. Ft.										
	4	20" Vitrified Sewer Pipe	Lin. Ft.										
	5	24" Vitrified Sewer Pipe	Lin. Ft.										
	6	Manholes Complete	Each										
	7	Catch Basin Complete	Each										
	8												
	9												
	10												
PAVEMENT	1	Pavement - 1 Course Conc.	Sq. Yds.										
	2	Pavement - Asphaltic Conc.	Sq. Yds.										
	3	Integral Curb 8"	Lin. Ft.										
	4	Integral Curb 12"	Lin. Ft.										
	5	Surface Drain	Each										
	6	Surface Drain Basin	Each										
	7	Shoulders - Earth	Lin. Ft.										
	8												
STRUCTURES	1	Concrete	Cu. Yds.										
	2	Reinforcing Steel	Lbs.										
	3	Excavation	Cu. Yds.										
	4	Filing	Lin. Ft.										
	5												
6													
7													
8													
9													
10													

DETAILS

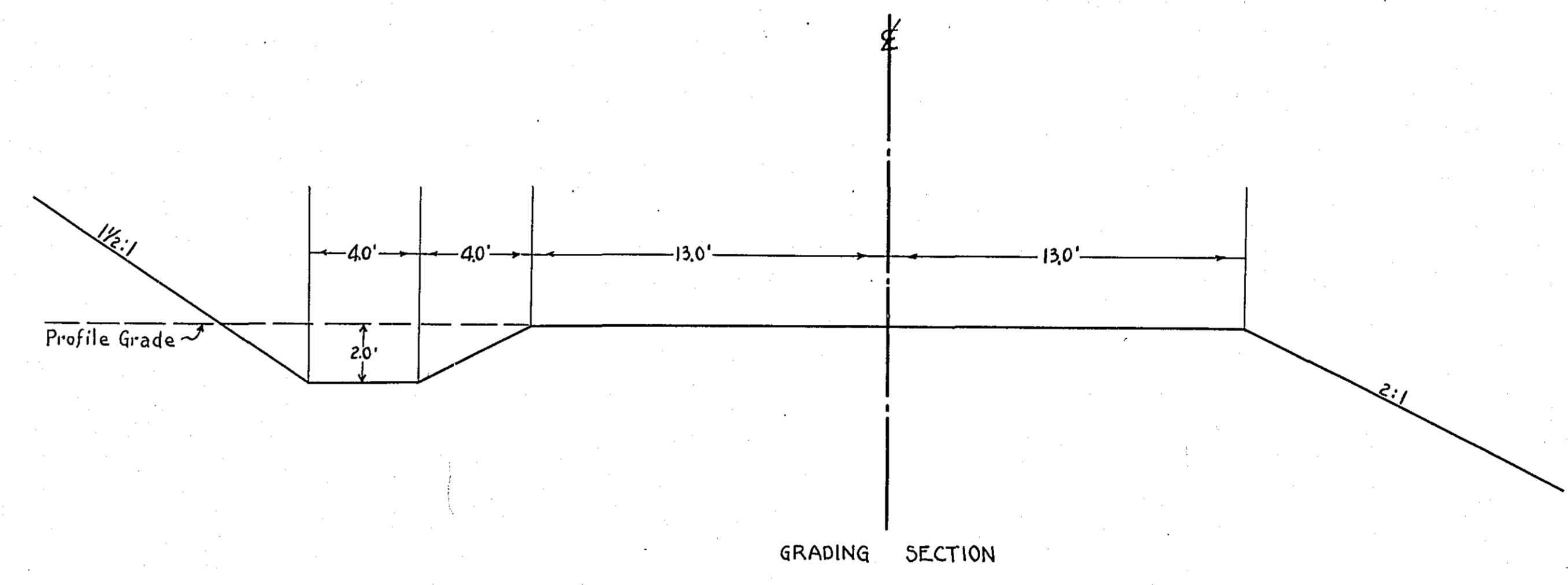

620f

PLAN	SURVEYED	DATE
	PLOTTED	BY
	CHECKED	
	REVISIONS	
	NOTES	
	NO.	

PROFILE	SURVEYED	DATE
	PLOTTED	BY
	CHECKED	
	REVISIONS	
	NOTES	
	NO.	

2+20 P 24'x42' Ps
 3+15 Inp. 15'x20' C.M. Remove
 6+82 Inp. 12'x20' C.M. Remove No Culv. Reqd.
 9+35 L P-15'x20' C.M.
 12+25 R 24'x36' Ps
 14+00 Lt R 15'x20' C.M.
 14+00 Rt P 15'x20' C.M.
 19+73 Lt R 15'x20' C.M.
 19+81 Rt No Culv. Reqd.
 23+27 Lt R 15'x20' C.M.
 26+16 Inp. 15'x25' P, Ext 15'x24' P, Rt
 24+50 Rt No Culv. Reqd.

Beginning of Project Sta. 0+50

End of Project Sta. 26+21

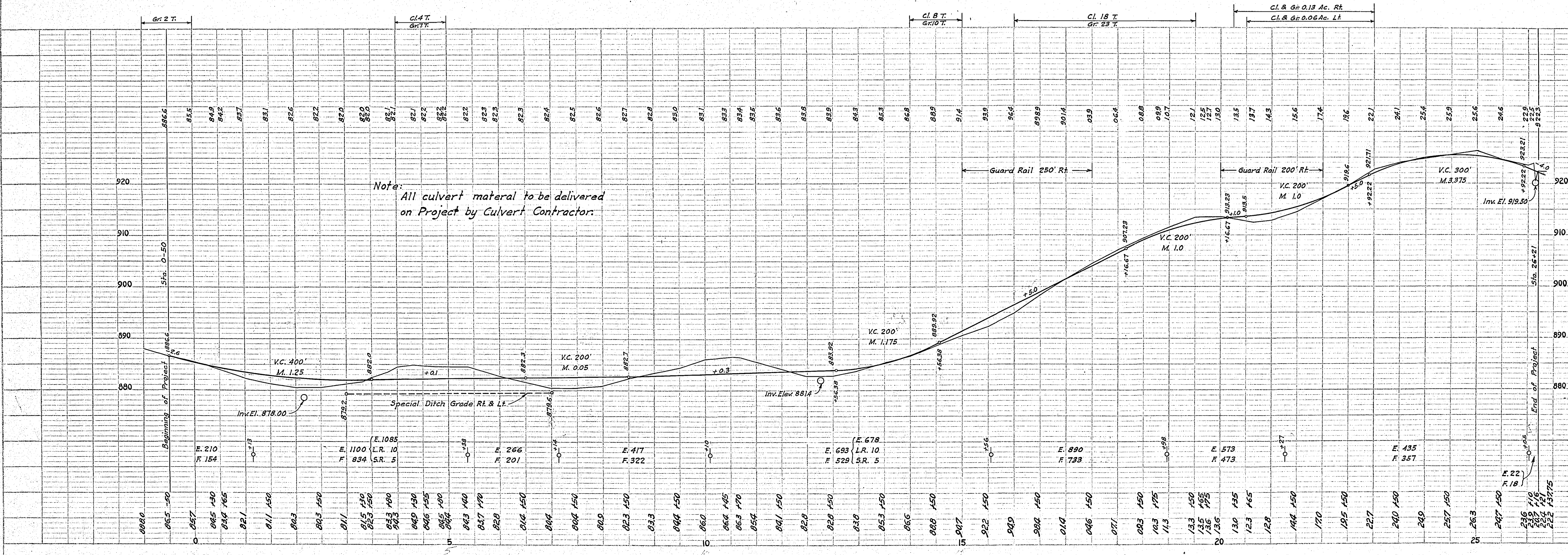
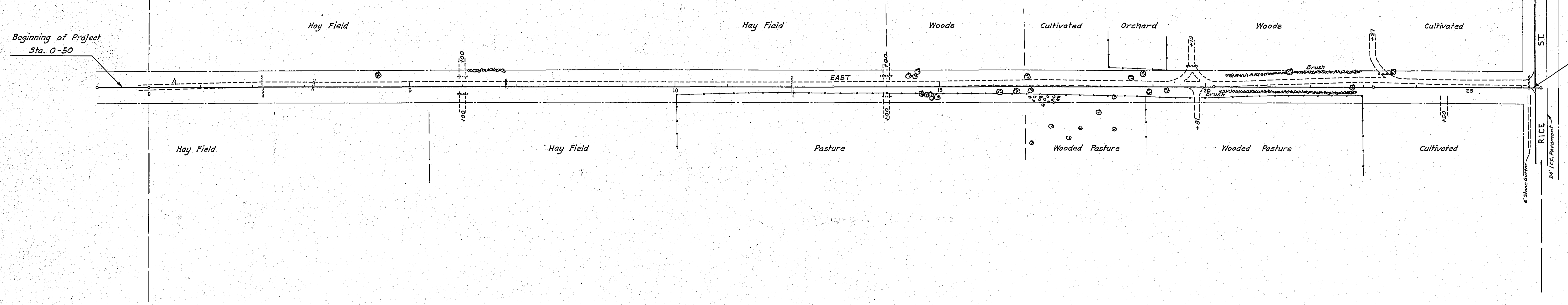

Note: All culvert material to be delivered on Project by Culvert Contractor.

PROJ. 33-M18

ESTIMATED QUANTITIES

Clearing Trees	30
Grubbing "	42
Clearing Acres	19
Grubbing "	19
Exc. Earth Cuv. Yds	4576
L.R.	20
S.R.	10
Install 15' C.M. Lin. Ft.	100
15' P	24
24' Ps	78
Remove Old Cuv. Lin. Ft.	40
Replace "	20
Guard Rail Cable	450
Anchors Each	4