

CONVENTIONAL SIGNS & ABBREVIATIONS

STATE LINE	-----	EXCAVATION	-----	E
COUNTY LINE	-----	EMBANKMENT	-----	F
TOWNSHIP LINE	-----	OVERHAUL	-----	H
SECTION LINE	-----	SURFACING	-----	S
CITY, VILLAGE, OR BOROUGH	-----	GUARD RAIL	-----	GR
FENCE LINE	-----	INTERSECTION ANGLE	-----	A
RIGHT-OF-WAY LINE	-----	RADIUS	-----	R
TRAVELLED WAY	-----	ELEVATION	-----	EL
RAILROADS	-----	VERTICAL CURVE	-----	V.C.
RETAINING WALL	-----	BENCH MARK	-----	B.M.
BASE OR SURVEY LINE	-----	SECTIONAL CONCRETE CULVERT	-----	P.C.
LEEVE	-----	CORRUGATED METAL CULVERT	-----	C.M.
GRAVEL PIT	-----	CULVERT HAUL	-----	P.H.
SAND PIT	-----	TON MILES	-----	T.M.
CLAY PIT	-----	PLACE	-----	P
ROCK QUARRY	-----	IN PLACE	-----	INP
CULVERTS	-----	REPLACE	-----	REP
PLAIN	-----	RIGHT	-----	R
With FACEWALLS	-----	LEFT	-----	L
With WINGWALLS	-----	HAND DITCHING	-----	H.D.
DROP IN SET	-----	POINT OF CURVE	-----	P.C.
POWER POLE LINE	-----	POINT OF TANGENT	-----	P.T.
TELEPHONE OR TELEGRAPH LINE	-----	POINT OF INTERSECTION	-----	P.I.
MARSH	-----	SPECIAL EXCAVATION	-----	S.E.
HEDGE, BRUSH, OR TIMBER	-----	SPECIAL FLOWING	-----	S.P.
GROUND ELEVATION	-----	TELEPHONE POLE	-----	T.P.
GRADE ELEVATION	-----			

OFFICE OF COUNTY SURVEYOR

RAMSEY COUNTY

Plan and Profile of County Project No. 33-M17

From A point 106' N. of the N.E. Cor. Sec. 6-30-23 To A point 202' N. of the N.E. Cor. Sec. 5-30-23
Give proper reference to Sections, Township and Range

GROSS LENGTH - 5462 FEET 1.03 MILES
 LENGTH OF EXCEPTIONS - FEET MILES
 NET LENGTH - 5462 FEET 1.03 MILES
 PLAN, 1 Inch = 100 Feet
 PROFILE, Horz. 1 Inch = 100 Feet. Vert. 1 Inch = 10 Feet
 WORKING PLANS { Horz. 1 Inch = 100 Feet
 Vert. 1 Inch = 10 Feet
 Cross-Sections, 1 Inch = 10 Feet

LAYOUT
 SCALE, 1 Inch = 2640 Feet

INDEX OF SHEETS

Sheet No. 1. Title Sheet and Layout Map
 " No. 2. Typical Cross-Sections and Statement
 " No. 3. Plan and Profile, Sta. 0+00 to Sta. 52+76.
 " No. 4. to 8. Cross Sections

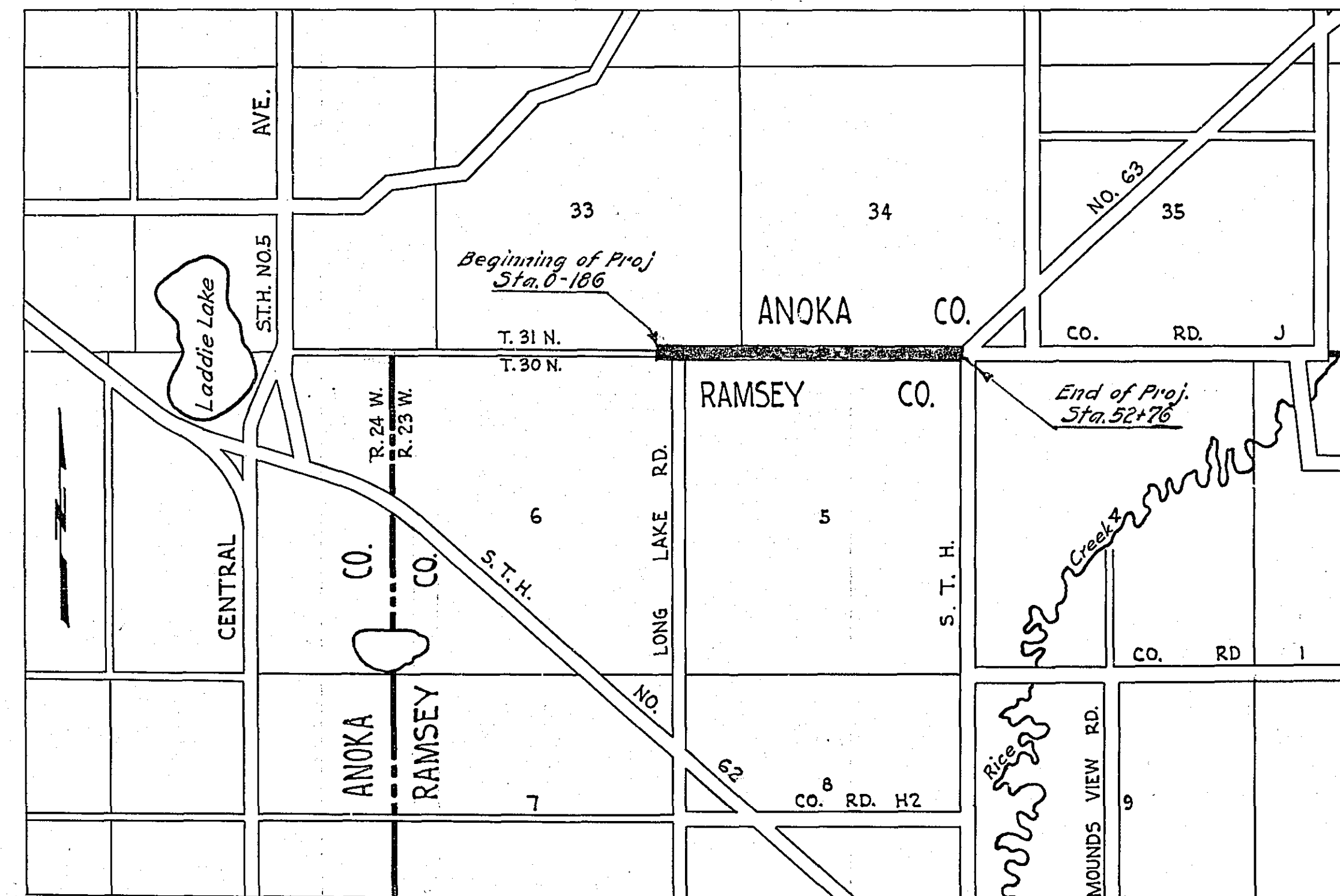

Date of Resolution for Preparation of Plans Jan. 16 1933

Planned by *M.W. Carlson* ASSISTANT ENGINEER

Recommended for Approval *[Signature]* ASSISTANT ENGINEER

Plans Approved and Recommended for Consideration *[Signature]* COUNTY SURVEYOR

Approved by County Board *[Signature]* CHAIRMAN OF COUNTY BOARD

APPROVED *[Signature]* 27/7 1933
 CHAIRMAN MOUNDS VIEW TOWN BOARD

