

4 MILES NORTH OF ST. PAUL
(Lexington Ave.)
S.A.R. No. 3

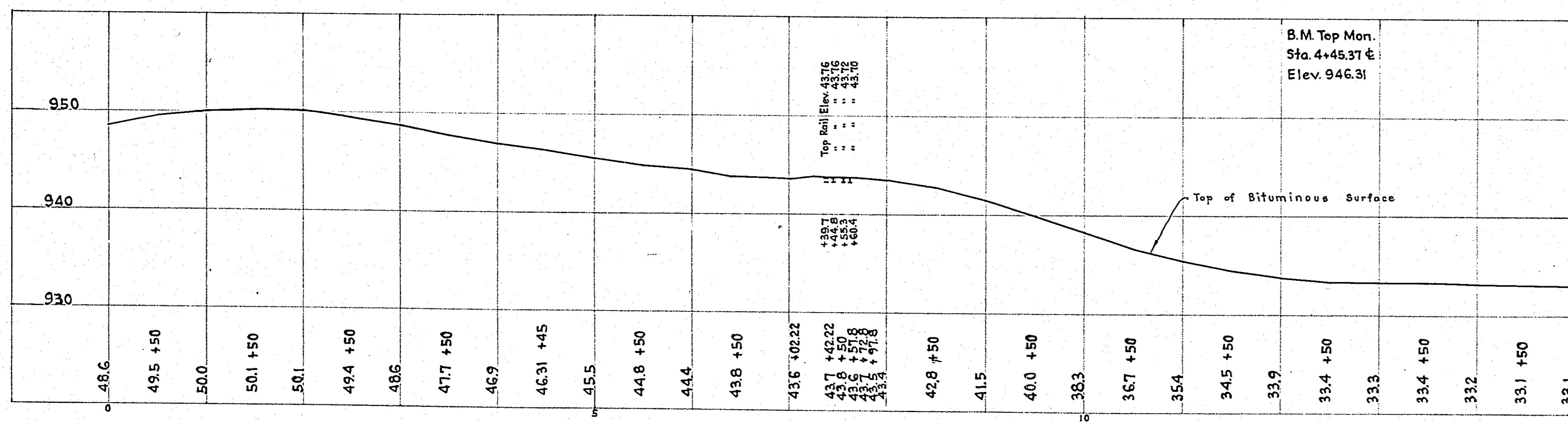
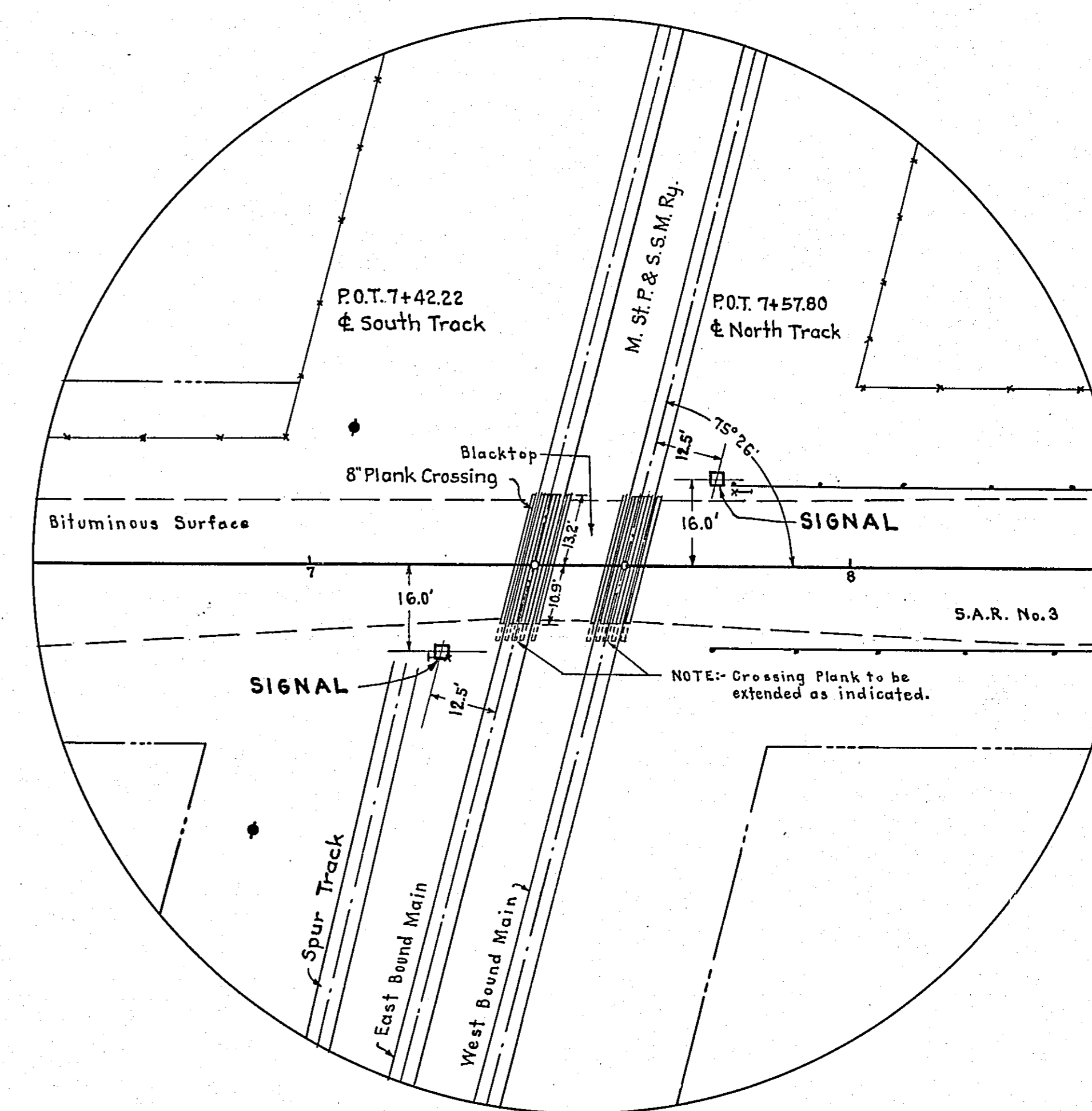
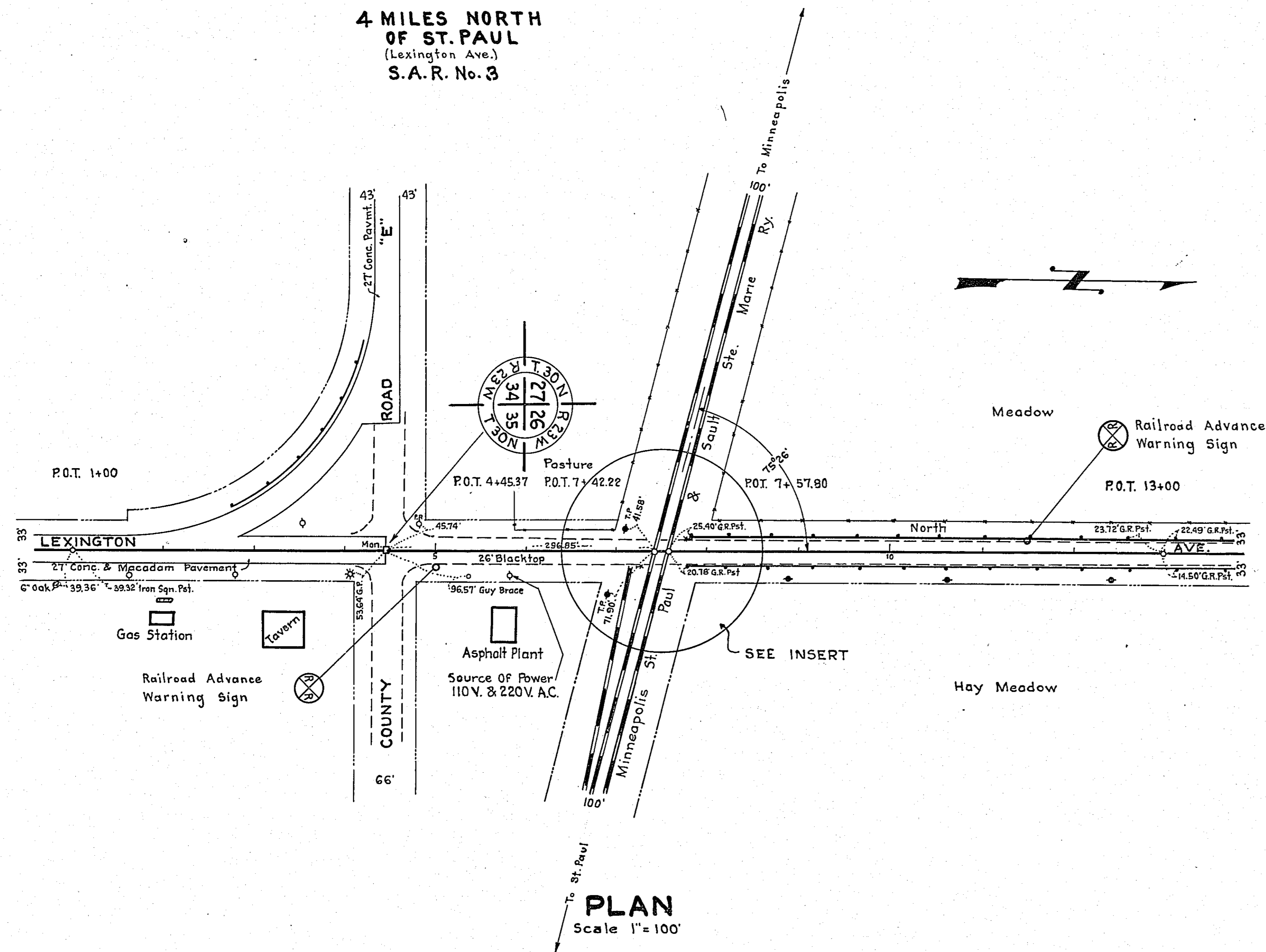

ESTIMATED QUANTITIES			
SPECIFICATIONS No.	ITEM	UNIT	TOTAL ESTIMATED QUANTITIES
2560.5	Highway-Railroad Grade Crossing Signal System (includes 2 Signals & 2 R.R. Adv. Warning Signs) in place	Signal System	1.
2561.5	do.	do	1.
2562.5	do.	do	1.

SIGNALS:

- The locations at which signals are to be placed will be determined at the site. Those indicated on the plans are only approximate.
- The "Number of Tracks" signs shall bear the message "2 Tracks."

- The Contractor shall stencil the Federal Aid Project Number F.A.G.S. 157A on roadway side of each signal case using U.S.P.R.A. Joint Board Standard 2" Series "C" Black Letters.

RAILROAD ADVANCE WARNING SIGNS:

- Each sign shall be erected on two steel posts in accordance with details shown on sheet No. 3 of the plans.

Sheets 3-6 out

St. Paul (4 Miles North)
Lexington Ave.
M.St.P. & S.S.M. Ry.

STATE OF MINNESOTA
DEPARTMENT OF HIGHWAYS
CONSTRUCTION PLAN FOR HIGHWAY-RAILROAD

CROSSING SIGNALS
RAMSEY COUNTY S.A.R. NO. 3
FOUR MILES NORTH OF ST. PAUL
M. ST.P. & S.S.M. RY.

MINNESOTA F.A.G.S. NO. 157 SEC. A(1) (41) STATE PROJECT NO. 62-509-01

GROSS LENGTH Feet Miles
BRIDGES LENGTH Feet Miles
EXCEPTIONS-LENGTH Feet Miles
NET LENGTH Feet Miles

GROSS LENGTH FEET MILES
BRIDGES-LENGTH FEET MILES
EXCEPTIONS-LENGTH FEET MILES
NET LENGTH FEET MILES

SCALES { PLAN. 1 inch = ... Feet
PROFILE. Horz. 1 inch = ... Feet. Vert. 1 inch = ... Feet

LAYOUT
Scale 1 inch = 400.0 Feet

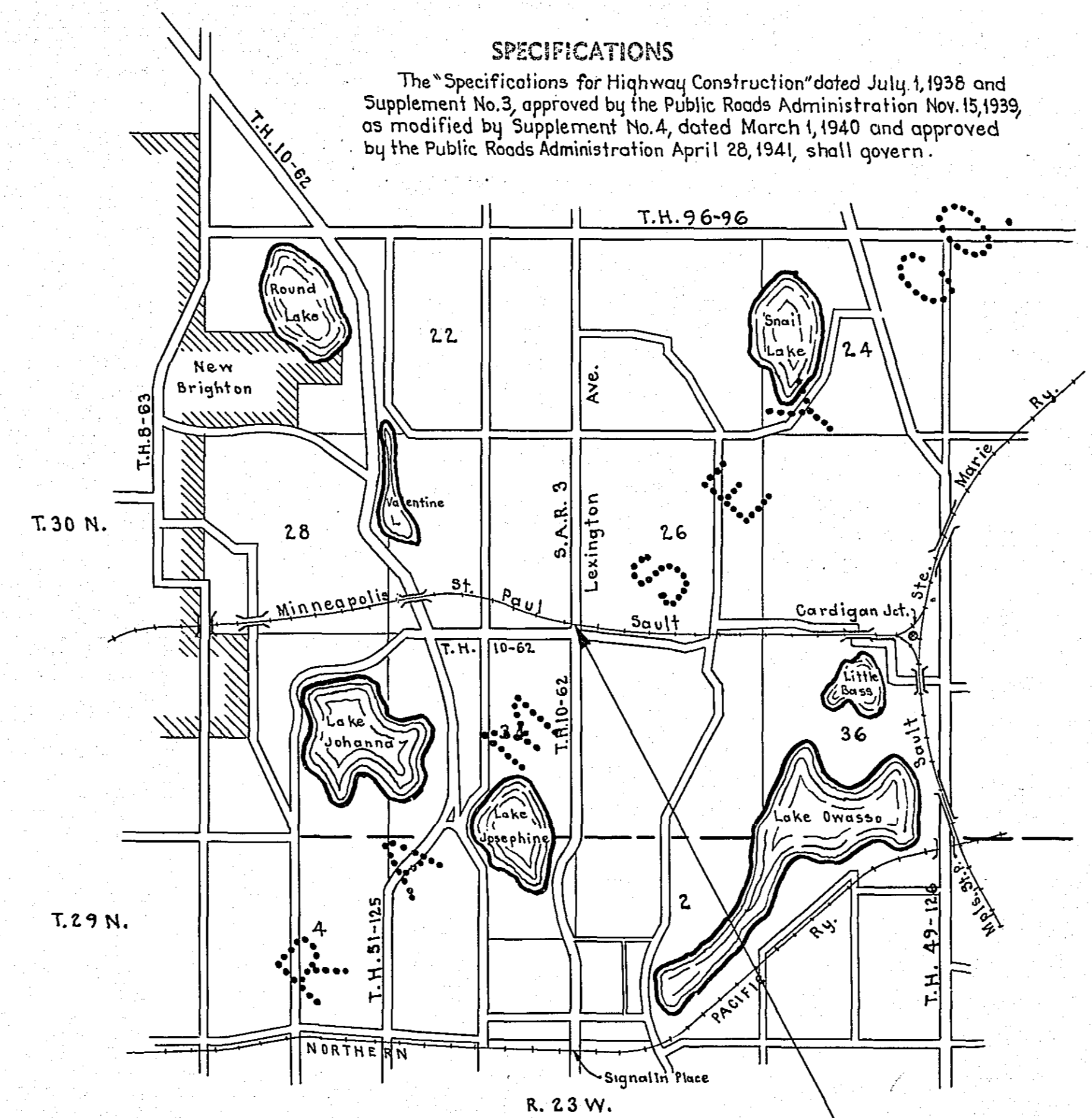

The approximate location of the Signal System is 304.6 feet North of the S.W. Cor. of Sec. 26 T. 30 N. R. 30 W.

HIGHWAY-RAILROAD CROSSING SIGNALS

CONVENTIONAL SIGNS

- STATE LINE
- COUNTY LINE
- TOWNSHIP OR RANGE LINE
- SECTION LINE
- QUARTER LINE
- SIXTEENTH LINE
- RIGHT-OF-WAY LINE
- PROPERTY LINE (Except Land Lines)
- VACATED PLATTED PROPERTY
- CORPORATE OR CITY LIMITS
- TRUNK HIGHWAY CENTER LINE
- RETAINING WALL
- STEAM RAILROAD
- ELECTRIC RAILROAD
- RAILROAD RIGHT-OF-WAY LINE
- CREEK
- RAPIDS OR WATERFALL
- DRY RUN
- DRAINAGE DITCH
- HIGH TENSION LINE
- POWER POLE LINE
- TELEPHONE OR TELEGRAPH LINE
- CULVERT
- DROP INLET
- GUARD RAIL
- WIRE FENCE
- RAILROAD SNOW FENCE
- BOARD OR HIGHWAY SNOW FENCE
- STONE WALL OR FENCE
- HEDGE
- WATER PIPE
- SEWER PIPE
- DRAIN TILE
- GRAVEL PIT
- SAND PIT
- CLAY PIT
- ROCK QUARRY
- SPRINGS
- MARSH
- TRUNK HIGHWAY R/W
- RAILROAD R/W
- PRESENT ROAD R/W
- TIMBER
- BRUSH
- ORCHARD
- ROCK LEDGE
- SAND
- EDGE OF CUT
- TOE OF EMBANKMENT
- CATCH BASIN
- MANHOLE
- FIRE HYDRANT
- ARC LAMP
- OTHER LAMPS (State Kind)
- RAILROAD CROSSING SIGN
- RAILROAD CROSSING BELL
- ELECTRIC WARNING SIGN
- CROSSING GATE
- CATTLE GUARD
- OVERHEAD (Highway Over)
- UNDERPASS (Highway Under)
- ABUTMENT, WALL & PIER
- BRIDGE
- BUILDING (One Story Frame)
- F-FRAME C-CONCRETE
- S-STONE T-TILE
- B-BRICK ST-STUCCO
- IRON PIPE
- STONE MONUMENT
- WOOD STAKE OR HUB
- MEANDER CORNER

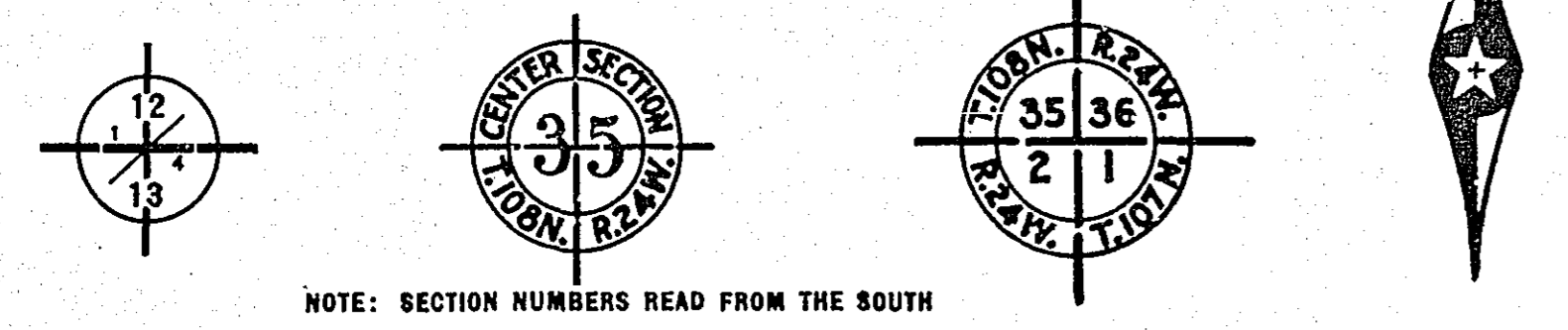

NOTE: SECTION NUMBERS READ FROM THE SOUTH

PIT DATA

- PIT NO. Located in
- Dead Haul
- PIT NO. Located in
- Dead Haul
- PIT NO. Located in
- Dead Haul
- PIT NO. Located in
- Dead Haul

Recommended for Approval H. E. Guard 7/29 1941
ENGINEER OF RY. NEGOTIATIONS

Right of Way Approval S. C. Green 8-5 1941
ENGINEER OF LANDS & RIGHT-OF-WAY

Planned By C. W. Lilly 7/29 1941
ENGINEER OF PLANS

Recommended for Approval H. E. Guard 7/30 1941
DISTRICT ENGINEER

Recommended for Approval F. J. Tharion 7/29 1941
ENGINEER OF SURVEYS & DESIGN

Recommended for Approval O. L. Kipp 7-30-1941
CONSTRUCTION ENGINEER

Approved 7-31 1941 J. J. Beinn
CHIEF ENGINEER

RECOMMENDED FOR APPROVAL
DISTRICT ENGINEER
PUBLIC ROADS ADMINISTRATION
FEDERAL WORKS AGENCY

APPROVED
COMMISSIONER
PUBLIC ROADS ADMINISTRATION
FEDERAL WORKS AGENCY