

STATEMENT OF ESTIMATED QUANTITIES AND COSTS.

ITEM	UNIT	MILE		MILE		MILE		MILE		MILE		MILE		MILE		MILE		TOTAL ESTIMATED QUANTITIES	ESTIMATED UNIT PRICES	AMOUNTS	TOTALS
		Sta.	to Sta.	Sta.	to Sta.	Sta.	to Sta.	Sta.	to Sta.	Sta.	to Sta.	Sta.	to Sta.	Sta.	to Sta.	Sta.	to Sta.				
1	Clearing	Acre																			
2	Clearing	Tree	41																		
3	Grubbing	Acre																			
4	Grubbing	Tree	78																		
5	Excavation - Earth	Cu. Yd.	5529																		
6	Excavation - Loose Rock	Cu. Yd.	20																		
7	Excavation - Solid Rock	Cu. Yd.	10																		
8	Excavation - Overhaul	Cu. Yd.	13775																		
9	Special Excavation	Lin. Ft.																			
10	Hand Ditching	Cu. Yd.																			
11	Tile Drain	in.																			
12	Tile Drain	in.																			
13	Tile Drain	in.																			
14	Porous Back Fill Material	Cu. Yd.																			
15	Stone Rip-Rap	Cu. Yd.																			
16	Install 15" C.M.	Lin. Ft.	36																		
17	Install	Lin. Ft.																			
18	Install	Lin. Ft.																			
19	Install	Lin. Ft.																			
20	Install	Lin. Ft.																			
21	Install	Lin. Ft.																			
22	Install	Lin. Ft.																			
23	Install	Lin. Ft.																			
24	Install	Lin. Ft.																			
25	Install 24" P3	Lin. Ft.																			
26	Install 30" P3	Lin. Ft.																			
27	Install 36" P3	Lin. Ft.																			
28	P1 Culvert Haul	Ton Mile																			
29	P2 Culvert Haul	Ton Mile																			
30	Remove old culv.	Lin. Ft.	216																		
31	Remove old G.R.	Lin. Ft.	56																		
32	Remove Conc. Sidewalk	Sq. Ft.	276																		
TOTAL ESTIMATED COST OF GRADING (IN 'TOTALS' COLUMN)																					
33	C.M. Culv. Material 15"	Lin. Ft.	36																		
34	Culv. Material	Lin. Ft.																			
35	Culv. Material	Lin. Ft.																			
36	Culv. Material	Lin. Ft.																			
37	Culv. Material	Lin. Ft.																			
38	Culv. Material	Lin. Ft.																			
39	P3 Culv. Material 24"	Lin. Ft.																			
40	P3 Culv. Material 30"	Lin. Ft.																			
41	P3 Culv. Material 36"	Lin. Ft.																			
TOTAL ESTIMATED COST OF PORTABLE CULVERT MATERIAL (IN 'TOTALS' COLUMN)																					
42	Gravel Pit Stripping	Cu. Yd.																			
43	Screening	Cu. Yd.																			
44	Loading	Cu. Yd.																			
45	Hauling	Cu. Yd. Mile																			
46	Shaping & Compacting	Man Hour																			
47	Shaping & Compacting	Man Hour																			
48																					
49																					
50																					
51																					
TOTAL ESTIMATED COST OF GRAVEL HAUL (IN 'TOTALS' COLUMN)																					
52	Gravel Material F.O.B. PH	Cu. Yd.																			
53	Freight (if any)	Cu. Yd.																			
54	Unloading from Cars	Cu. Yd.																			
TOTAL ESTIMATED COST OF GRAVEL MATERIAL (IN 'TOTALS' COLUMN)																					
55	Fine Grading - Exc. & Emb.	Cu. Yd.																			
56	Shoulders - Earth	Cu. Yd.																			
57																					
58																					
59	Pavement	Sq. Yd.																			
60	Integral Curb / One Course Concrete	Lin. Ft.																			
61	Sloping Curb	Lin. Ft.																			
62	Surface Drain	Lin. Ft.																			
63	Surface Drain Basins	Basin																			
64	Bridge Approach Slabs (Concrete)	Slab																			
65	Bridge Approach Slabs (Steel)	Slab																			
66																					
67																					
68																					
TOTAL ESTIMATED COST OF PAVEMENT CONSTRUCTION (IN 'TOTALS' COLUMN)																					
69	Concrete	Cu. Yd.																			
70	Reinforcing Steel	Lb.																			
71	Excavation - Earth	Cu. Yd.																			
72	Excavation - Loose Rock	Cu. Yd.																			
73	Excavation - Solid Rock	Cu. Yd.																			
74	Bridge	* Bridge No.	Br. No.	Br. No.	Br. No.	Br. No.	Br. No.	Br. No.	Br. No.	Br. No.	Br. No.	Br. No.	Br. No.	Br. No.	Br. No.	Br. No.	Br. No.	Br. No.	Br. No.	Br. No.	Br. No.
75	Station																				
76	Concrete	Cu. Yd.																			
77	Reinforcing Steel	Lb.																			
78	Structural Steel	Lb.																			
79	Piling	Lin. Ft.																			
80	Temporary Crossing	Lump Sum																			
81	Removing old Bridge	Lump Sum																			
82	Bituminous Surface	Sq. Yd.																			
83																					
84																					
TOTAL ESTIMATED COST OF STRUCTURES (IN 'TOTALS' COLUMN)																					
85	Guard Rail	Lin. Ft.																			
86	Gutter	Lin. Ft.																			
87	Excavation for Gutter	Cu. Yd.																			
TOTAL ESTIMATED COST OF MISCELLANEOUS ITEMS (IN 'TOTALS' COLUMN)																					

TYPICAL CROSS SECTIONS AND DETAILS

FED. ROAD DIST. NO.	STATE	FED. AID PROJ. NO.	SEC.	FISCAL YEAR	SHEET No.	TOTAL SHEETS
4	MINN.					

EUSTIS STREET

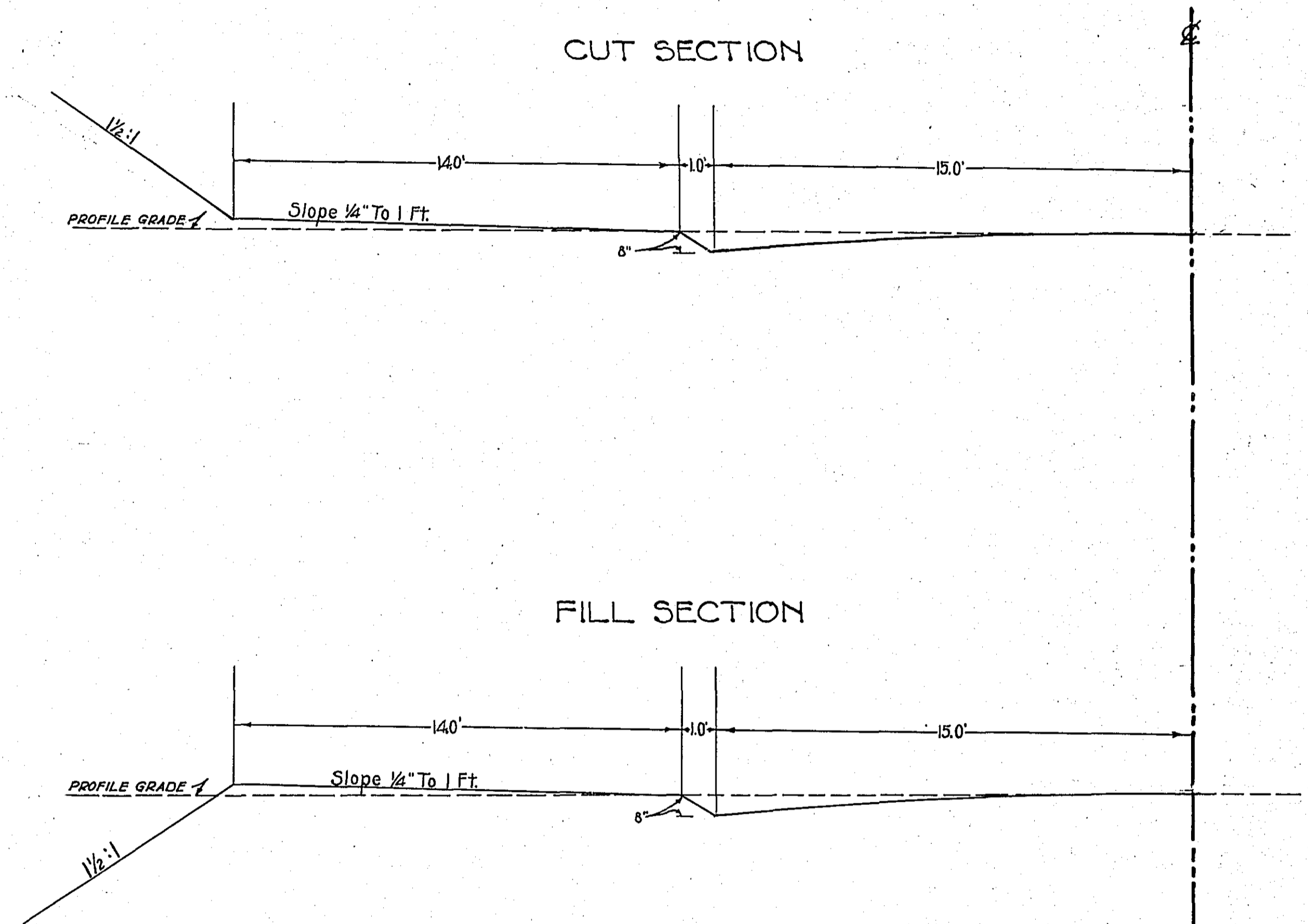

* NOTE: BRIDGE ITEMS LISTED UNDER BRIDGE NUMBERS IN MILE COLUMNS REGARDLESS OF LOCATION

PLAN SURVEYED BY DATE
 NOTE: BOOK NO. COMMENTS CHECKED
 RT. OF WAY CHECKED
 NO.

PROFILE SURVEYED BY DATE
 NOTE: BOOK NO. GRADES CHECKED
 B.M. NOTED
 STRUCTURE ROTATING CHECKED
 NO.

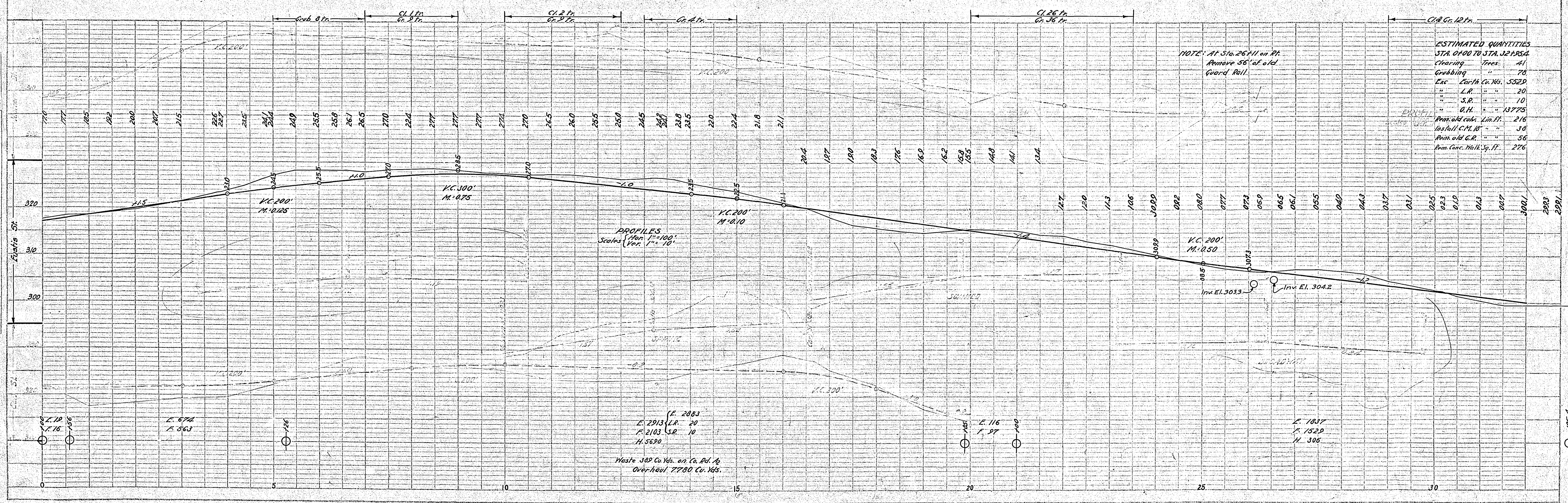
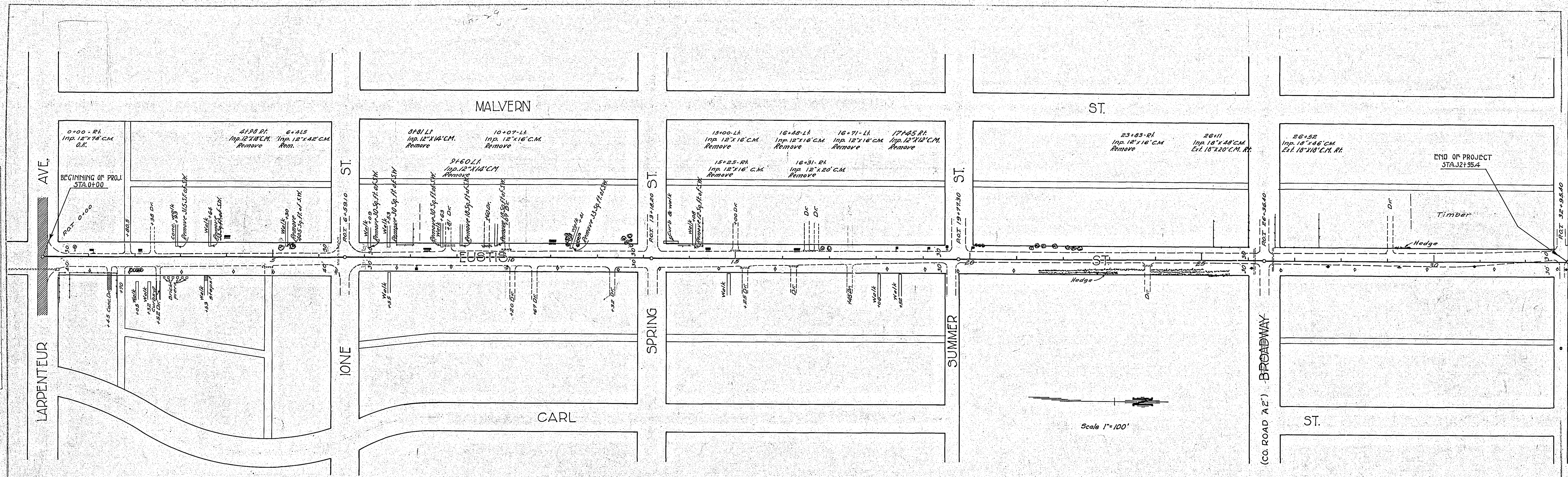

ESTIMATED QUANTITIES
 STA. 0+00 TO STA. 32+54.4

Clearing	Trees	41
Grubbing	"	78
Exc. Earth	Cu. Yds.	5529
"	L.R.	20
"	S.R.	10
"	O.H.	13775
Rem. old conc.	Lim. Ft.	216
Inst. full C.M. 18"	"	38
Rem. old G.R.	"	56
Rem. Conc. Walk	Sq. Ft.	276

CONVENTIONAL SIGNS & ABBREVIATIONS

STATE LINE	-----	EXCAVATION	-----	E
COUNTY LINE	-----	EMBANKMENT	-----	F
TOWNSHIP LINE	-----	OVERHAUL	-----	H
SECTION LINE	-----	SURFACING	-----	S
CITY, VILLAGE, OR BOROUGH	-----	GUARD RAIL	-----	GR
FENCE LINE	-----	INTERSECTION ANGLE	-----	Δ
RIGHT-OF-WAY LINE	-----	RADIUS	-----	R
TRAVELLED WAY	-----	ELEVATION	-----	EL
RAILROADS	-----	VERTICAL CURVE	-----	V.C.
RETAINING WALL	-----	BENCH MARK	-----	B.M.
BASE OR SURVEY LINE	-----	SECTIONAL CONCRETE CULVERT	-----	P.C.
LEVEE	-----	CORRUGATED METAL CULVERT	-----	C.M.
GRAVEL PIT	-----	CULVERT HAUL	-----	P.H.
SAND PIT	-----	TOW MILES	-----	T.M.
CLAY PIT	-----	PLACE	-----	P
ROCK QUARRY	-----	IN PLACE	-----	Imp.
CULVERTS	-----	REPLACE	-----	Rep.
PLAIN	-----	RIGHT	-----	R
WITH FACEWALLS	-----	LEFT	-----	L
WITH WINGWALLS	-----	HAND DITCHING	-----	H.D.
DROP INLET	-----	POINT OF CURVE	-----	P.C.
POWER POLE LINE	-----	POINT OF TANGENT	-----	P.T.
TELEPHONE OR TELEGRAPH LINE	-----	POINT OF INTERSECTION	-----	P.I.
MARSH	-----	SPECIAL EXCAVATION	-----	S.E.
HEDGE, BRUSH, OR TIMBER	-----	SPECIAL FLOWING	-----	S.F.
GROUND ELEVATION	-----	TELEPHONE POLE	-----	Tel.P.
GRADE ELEVATION	-----			

OFFICE OF COUNTY SURVEYOR
RAMSEY COUNTY

Plan and Profile of County Project No. 27-64

From A point 100' N and 1320.4' W of S. 1/4 Cor. Sec. 17-29-23 To A point 1320.4' W and 6380' N of Center, Sec. 17-29-23
Give proper reference to Sections, Township and Range

GROSS LENGTH - 3285.4 FEET 0.624 MILES
LENGTH OF EXCEPTIONS - FEET MILES
NET LENGTH - 3285.4 FEET 0.624 MILES
PLAN, 1 Inch = 100 Feet
PROFILE, Horz. 1 Inch = 100 Feet. Vert. 1 Inch = 10 Feet
SCALES WORKING PLANS Horz. 1 Inch = 100 Feet. Vert. 1 Inch = 10 Feet
Cross-Sections, 1 Inch = 10 Feet
LAYOUT
SCALE, 1 Inch = 2640 Feet

INDEX OF SHEETS

Sheet No. 1.	Title Sheet and Layout Map
" No. 2.	Typical Cross-Sections and Statement
" No. 3.	Plan and Profile, Sta. 2+00 to Sta. 32+95.4
" No. 4.	Cross Sections

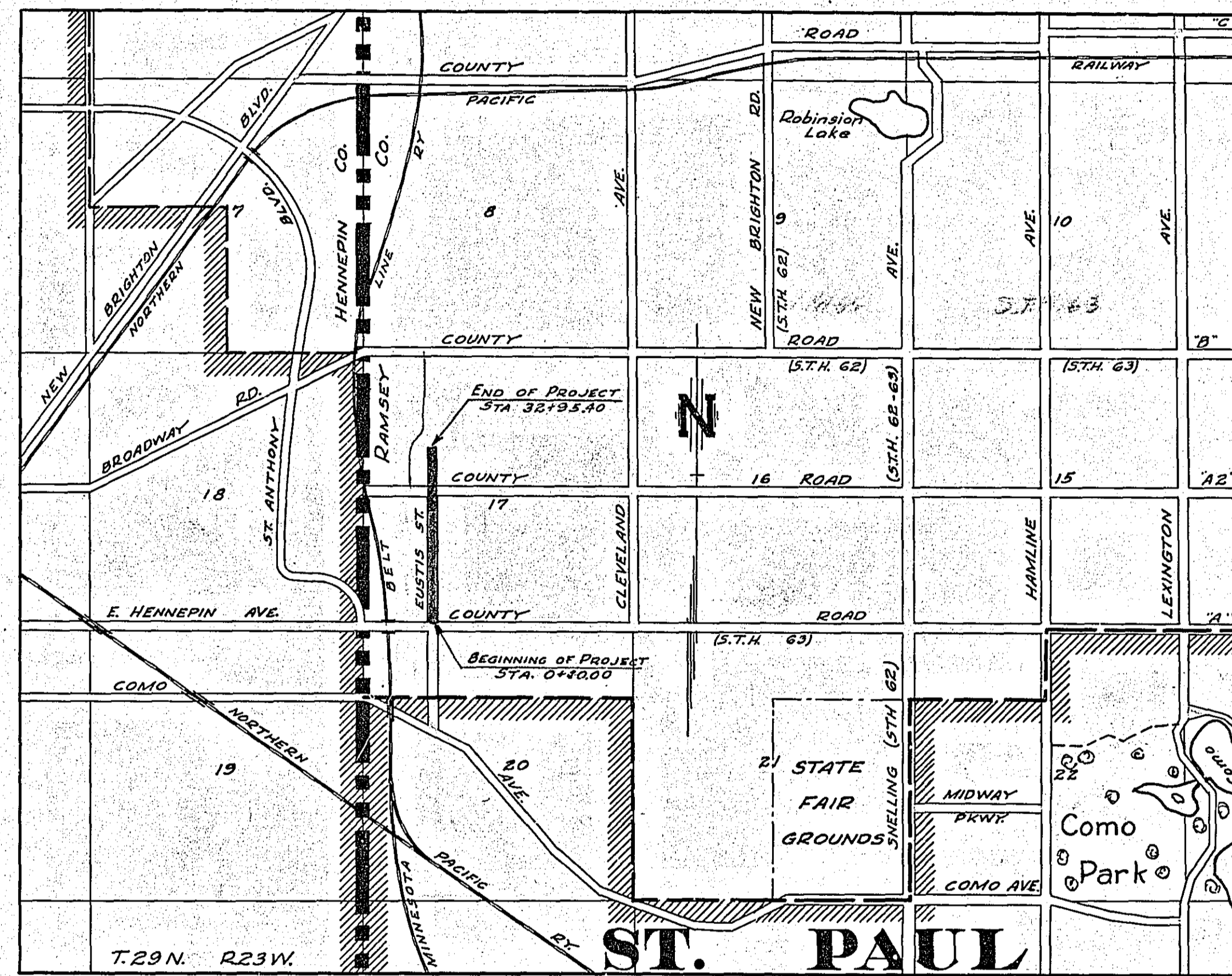

Date of Resolution for Preparation of Plans 9/13 1926
Planned by [Signature] ASSISTANT ENGINEER
Recommended for Approval [Signature] CONSTRUCTION ENGINEER
Plans Approved and Recommended for Consideration [Signature] COUNTY SURVEYOR
Approved by County Board 19 CHAIRMAN OF COUNTY BOARD