

PLAN  
 DATE \_\_\_\_\_ BY \_\_\_\_\_  
 SURVEYED \_\_\_\_\_ PLOTTED \_\_\_\_\_  
 NOTE BOOK \_\_\_\_\_ ALIGNMENT CHECKED \_\_\_\_\_  
 NO. \_\_\_\_\_ RT. OF WAY CHECKED \_\_\_\_\_

PROFILE  
 DATE \_\_\_\_\_ BY \_\_\_\_\_  
 SURVEYED \_\_\_\_\_ GRADES CHECKED \_\_\_\_\_  
 NO. \_\_\_\_\_ STRUCTURE NOTED (AS SHOWN)

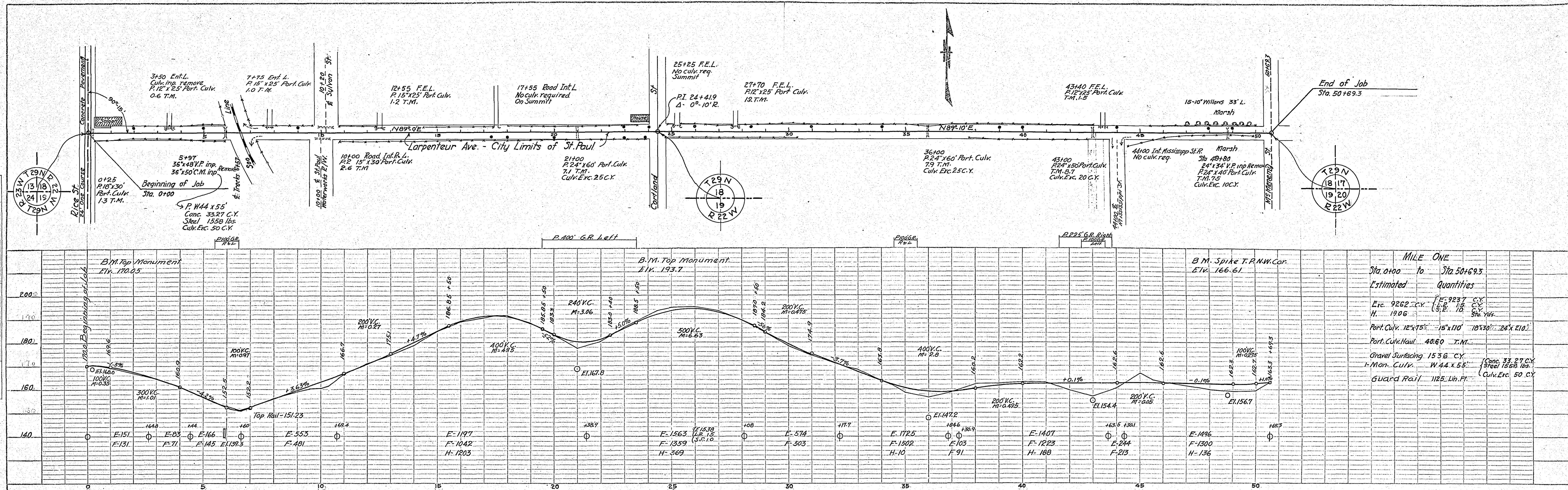



CONVENTIONAL SIGNS & ABBREVIATIONS

STATE LINE	-----	EXCAVATION	----	E
COUNTY LINE	-----	EMBANKMENT	----	F
TOWNSHIP LINE	-----	OVERHAUL	----	H
SECTION LINE	-----	SURFACING	----	S
CITY, VILLAGE, OR BOROUGH	-----	GUARD RAIL	----	GR
FENCE LINE	-----	INTERSECTION ANGLE	----	A
RIGHT-OF-WAY LINE	-----	RADIUS	----	R
TRAVELLED WAY	-----	ELEVATION	----	EL
RAILROADS	-----	VERTICAL CURVE	----	VC
RETAINING WALL	-----	BENCH MARK	----	B.M.
BASE OF SURVEY LINE	-----	SECTIONAL CONCRETE CULVERT	----	P.C.
LEVEE	-----	CORRUGATED METAL CULVERT	----	C.M.
GRAVEL PIT	⊙	CULVERT HAUL	----	P.H.
SAND PIT	⊙	TON MILES	----	T.M.
CLAY PIT	⊙	PLACE	----	P
ROCK QUARRY	⊙	IN PLACE	----	INP
CULVERTS	-----	REPLACE	----	REP
PLAIN	-----	RIGHT	----	R
WITH FACEWALLS	-----	LEFT	----	L
WITH WINGWALLS	-----	HAND DITCHING	----	H.D.
DROP INLET	⊠	POINT OF CURVE	----	P.C.
POWER POLE LINE	-----	POINT OF TANGENT	----	P.T.
TELEPHONE OR TELEGRAPH LINE	-----	POINT OF INTERSECTION	----	P.I.
MARSH	-----	SPECIAL EXCAVATION	----	SE
HEDGE, BUSH, OR TIMBER	-----	SPECIAL FLOWING	----	SP
GROUND ELEVATION	-----	TELEPHONE POLE	----	T.P.
GRADE ELEVATION	-----			

OFFICE OF COUNTY SURVEYOR  
RAMSEY COUNTY

Plan and Profile of County Project No. 23-66

From SW. Cor. Sec. 18-T.29 N.-R.22 W. To SE. Cor. Sec. 18-T.29 N.-R.22 W.

GROSS LENGTH-5069.3 FEET 0.96 MILES  
LENGTH OF EXCEPTIONS-0 FEET 0 MILES  
NET LENGTH-5069.3 FEET 0.96 MILES  
PLAN, 1 Inch = 200 Feet  
PROFILE, Horz. 1 Inch = 200 Feet. Vert. 1 Inch = 20 Feet  
WORKING PLANS { Horz. 1 Inch = 100 Feet  
Vert. 1 Inch = 10 Feet  
Cross-Sections, 1 Inch = 10 Feet  
LAYOUT  
SCALE, 1 Inch = 1320 Feet

INDEX OF SHEETS

Sheet No. 1.	Title Sheet and Layout Map
" No. 2.	Typical Cross-Sections and Statement
" No. 3.	Plan and Profile, Sta. 0+00 to Sta. 50+69.3
" No. 4.	Cross-Sections Sta. 0+00 to Sta. 50+69.3

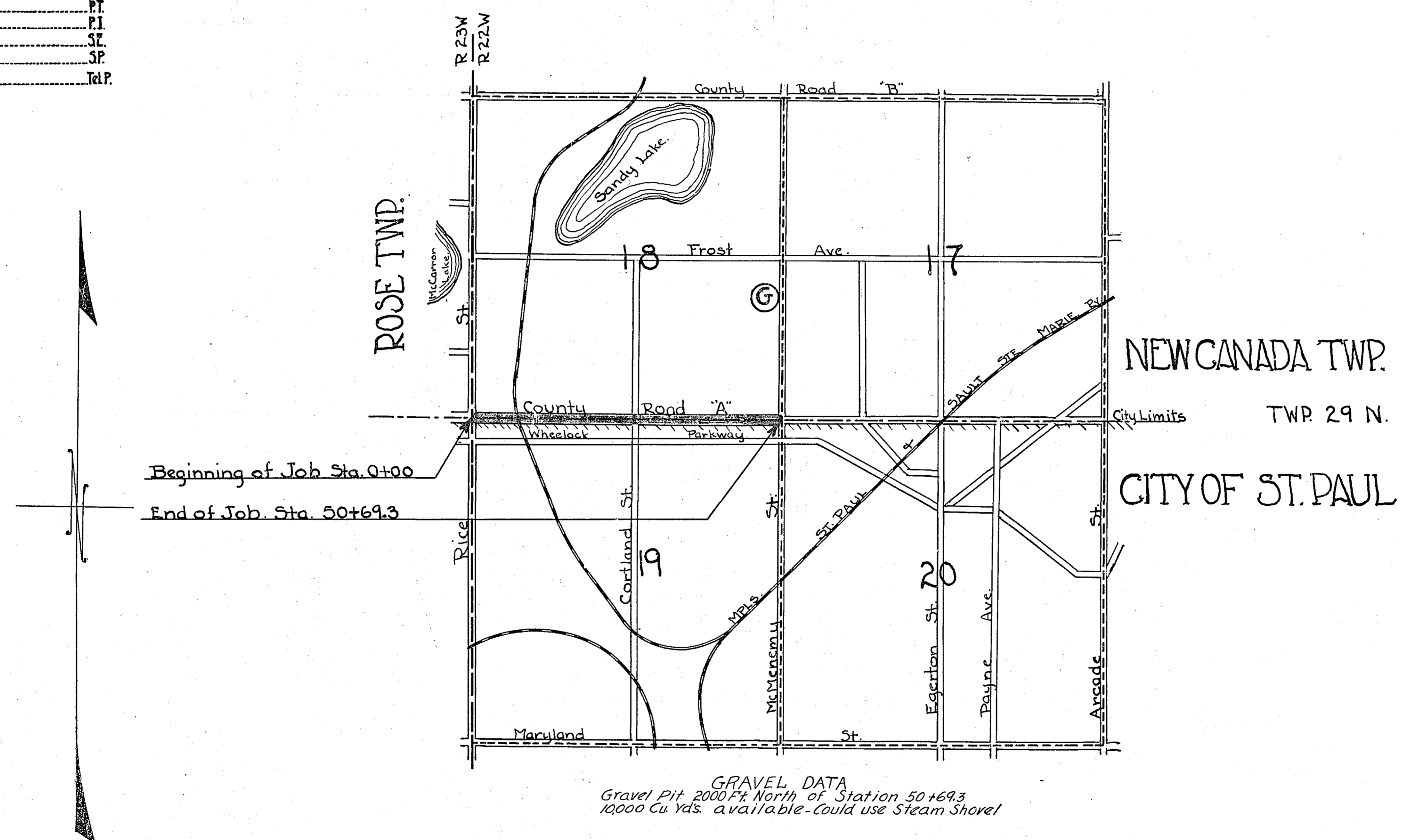

Date of resolution for preparation of plans Mar. 6, 1923  
 Planned by R. J. Holland HIGHWAY ENGINEER  
 Recommended for Approval E. J. Reiff CONSTRUCTION ENGINEER  
 Plans Approved and Recommended for Consideration Paul W. Coates COUNTY SURVEYOR  
 Approved by County Board \_\_\_\_\_ 19\_\_\_\_ CHAIRMAN OF COUNTY BOARD