

When it is let contact Mr. Carlson-Power Co.: Elec. Eng. regards to contemplated work they are going to do

| FED. ROAD DIST. NO. | STATE | FID. AID PROJ. NO. | SEC. | FISCAL YEAR | SHEET NO. | TOTAL SHEETS |
|---------------------|-------|--------------------|------|-------------|-----------|--------------|
|                     | MINN. |                    |      |             | 1         |              |

### CONVENTIONAL SIGNS

|                                   |  |                            |  |
|-----------------------------------|--|----------------------------|--|
| STATE LINE                        |  | TIMBER                     |  |
| COUNTY LINE                       |  | BRUSH                      |  |
| TOWNSHIP OR RANGE LINE            |  | ORCHARD                    |  |
| SECTION LINE                      |  | ROCK LEDGE                 |  |
| QUARTER LINE                      |  | SAND                       |  |
| SIXTEENTH LINE                    |  | EDGE OF CUT                |  |
| RIGHT-OF-WAY LINE                 |  | TOE OF EMBANKMENT          |  |
| PROPERTY LINE (Except Land Lines) |  | CATCH BASIN                |  |
| VACATED PLATTED PROPERTY          |  | MANHOLE                    |  |
| CORPORATE OR CITY LIMITS          |  | FIRE HYDRANT               |  |
| TRUNK HIGHWAY CENTER LINE         |  | ARC LAMP                   |  |
| RETAINING WALL                    |  | OTHER LAMPS (State Kind)   |  |
| STEAM RAILROAD                    |  | RAILROAD CROSSING SIGN     |  |
| ELECTRIC RAILROAD                 |  | RAILROAD CROSSING BELL     |  |
| RAILROAD RIGHT-OF-WAY LINE        |  | ELECTRIC WARNING SIGN      |  |
| CREEK                             |  | CROSSING GATE              |  |
| RAPIDS OR WATERFALL               |  | CATTLE GUARD               |  |
| DRY RUN                           |  | OVERHEAD (Highway Over)    |  |
| DRAINAGE DITCH                    |  | UNDERPASS (Highway Under)  |  |
| HIGH TENSION LINE                 |  | ABUTMENT, WALL & PIER      |  |
| POWER POLE LINE                   |  | BRIDGE                     |  |
| TELEPHONE OR TELEGRAPH LINE       |  | BUILDING (One Story Frame) |  |
| CULVERT                           |  | F-FRAME C-CONCRETE         |  |
| DROP INLET                        |  | S-STONE T-TILE             |  |
| GUARD RAIL                        |  | B-BRICK ST-STUCCO          |  |
| WIRE FENCE                        |  | IRON PIPE                  |  |
| RAILROAD SNOW FENCE               |  | STONE MONUMENT             |  |
| BOARD OR HIGHWAY SNOW FENCE       |  | WOOD STAKE OR HUB          |  |
| STONE WALL OR FENCE               |  | MEANDER CORNER             |  |
| HEDGE                             |  |                            |  |
| WATER PIPE                        |  |                            |  |
| SEWER PIPE                        |  |                            |  |
| DRAIN TILE                        |  |                            |  |
| GRAVEL PIT                        |  |                            |  |
| SAND PIT                          |  |                            |  |
| CLAY PIT                          |  |                            |  |
| ROCK QUARRY                       |  |                            |  |
| SPRINGS                           |  |                            |  |
| MARSH                             |  |                            |  |
| TRUNK HIGHWAY R/W                 |  |                            |  |
| RAILROAD R/W                      |  |                            |  |
| PRESENT ROAD R/W                  |  |                            |  |

## OFFICE OF COUNTY SURVEYOR

RAMSEY COUNTY

### CONSTRUCTION PLAN OF LARPENTEUR AVENUE - PROJ. 48-50

From St. Mary's St. (Sta. 99+00) To Snelling Ave. (Sta. 105+10)

GROSS LENGTH 610.0 FEET 0.115 MILES  
 LENGTH OF EXCEPTIONS 0 FEET 0 MILES  
 NET LENGTH 610.0 FEET 0.115 MILES

PLAN, 1 Inch = 50 Feet  
 PROFILE, Horz. 1 Inch = 50 Feet. Vert. 1 Inch = 5 Feet  
 WORKING PLANS { Horz. 1 Inch = 100 Feet  
 Vert. 1 Inch = 10 Feet  
 Cross-Sections, 1 Inch = 10 Feet

#### LAYOUT

SCALE, 1 Inch = 2640 Feet

#### SPECIFICATIONS

The Specification for Highway Construction dated July 1, 1947, and submitted for approval by the Division Engineer of the Public Roads Administration, October 15, 1947, shall govern.

### INDEX

|             |                          |
|-------------|--------------------------|
| SHEET NO. 1 | TITLE SHEET & LAYOUT MAP |
| " 2         | PLAN & DETAIL SHEET      |
| " 3         | CROSS-SECTIONS           |

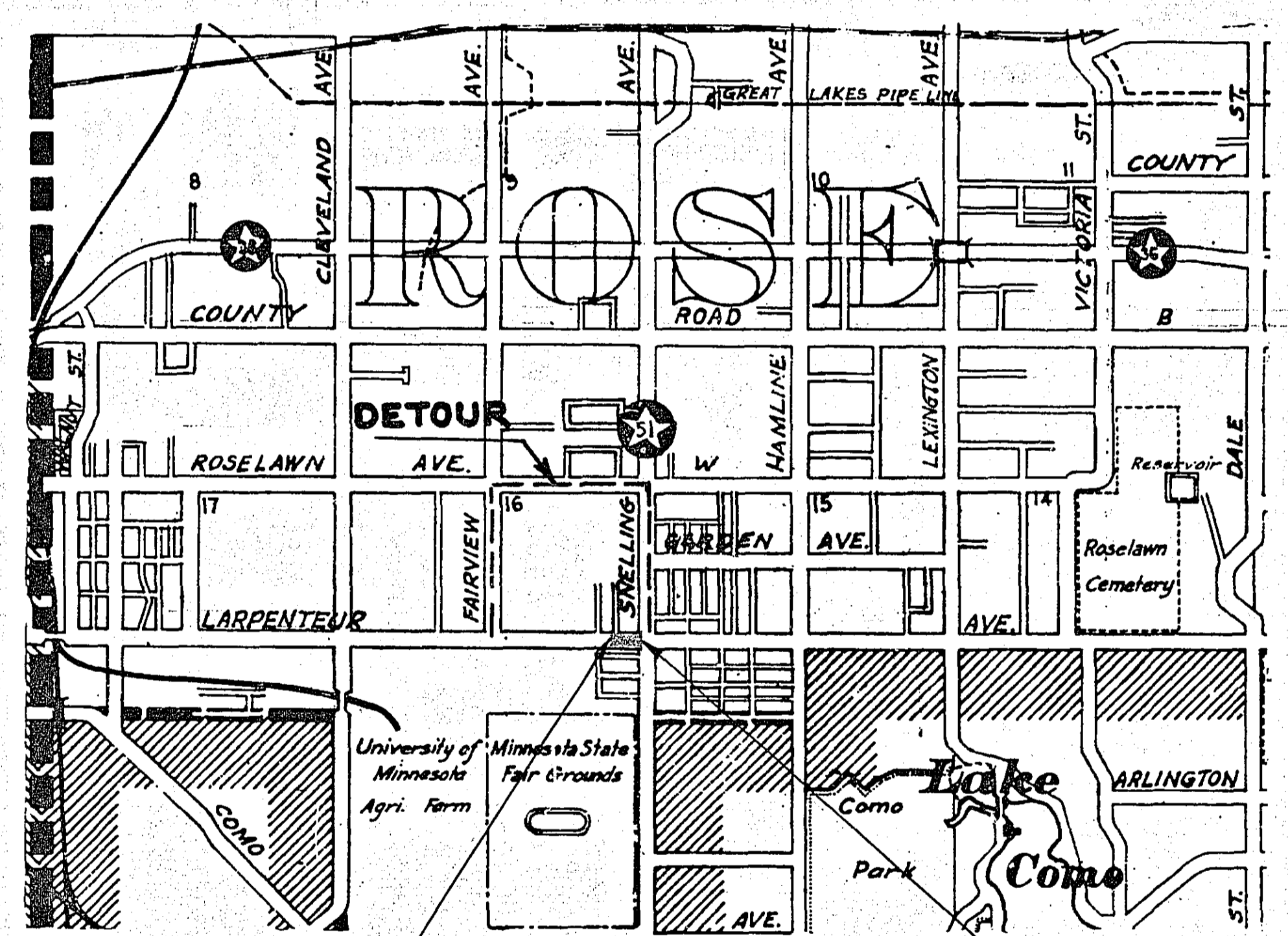

BEG. PROJ. 48-50  
STA. 99+00

END PROJ. 48-50  
STA. 105+10

PLANS APPROVED *Frank S. Branson*  
COUNTY SURVEYOR  
APPROVED *Walter C. ...* MAY 1948  
CHAIRMAN RAMSEY COUNTY BOARD

I HEREBY CERTIFY THAT THIS PLAN WAS PREPARED BY ME OR UNDER MY DIRECT SUPERVISION AND THAT I AM A DULY REGISTERED PROFESSIONAL ENGINEER UNDER THE LAWS OF THE STATE OF MINNESOTA.  
*Walter C. ...*  
DATE: 4/30/48 REG. NO. 2555

99+00 to 100+00 Rt. Impl. Concrete Apron. Do Not Disturb.  
 100+05 Lt. Impl. 15" x 36" C.M. Remove. No Culvert Required.  
 101+72 Rt. Remove Sidewalk 9 Sq.Yds.  
 103+22 Rt. Remove Sidewalk 9 Sq.Yds.  
 103+59 Rt. 0' to 9' Rt. Impl. Signal Control. To Be Removed & Replaced By Others.  
 103+91 Rt. Remove Sidewalk 9 Sq.Yds.

Standard Detail Plates Issued October 1, 1947, and submitted for approval by the Division Engineer of the Public Roads Administration, October 15, 1947, shall govern.

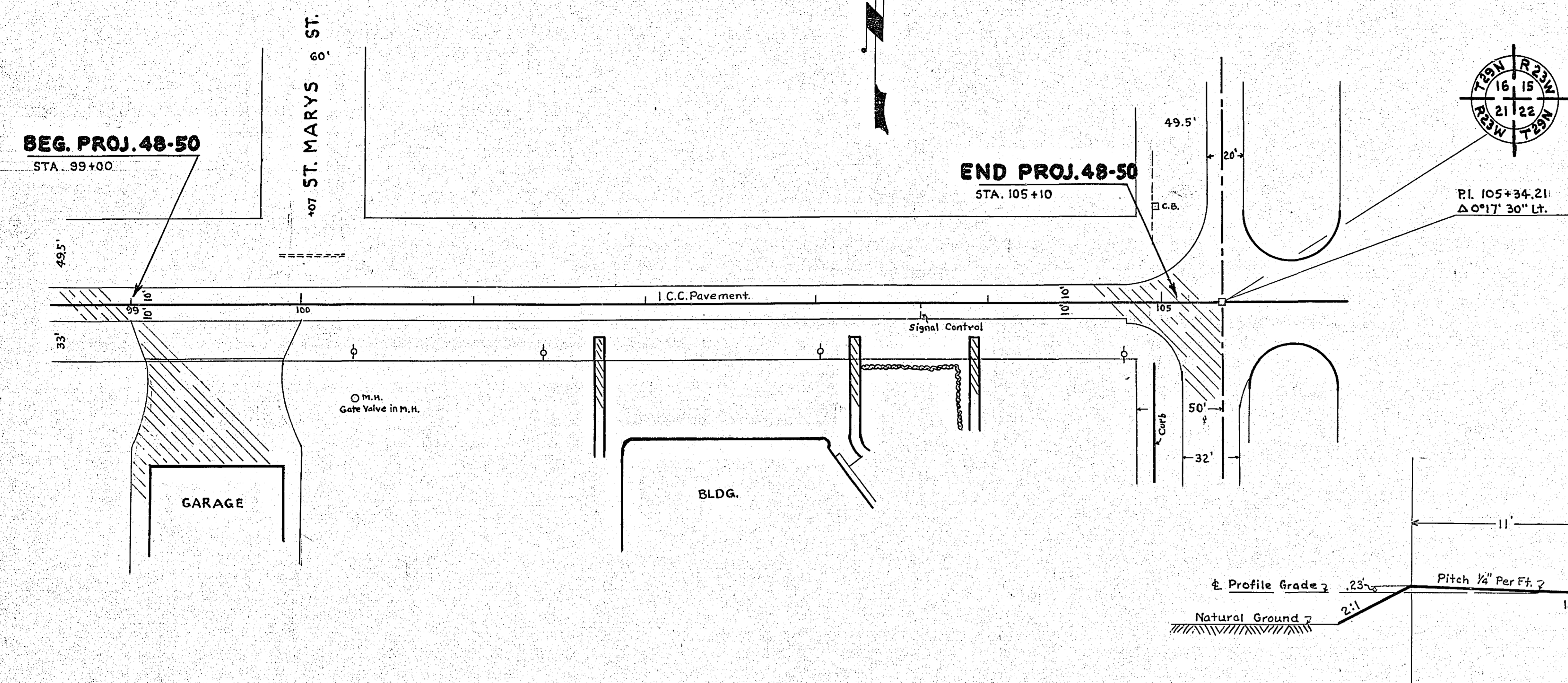

TYPICAL STREET SECTION

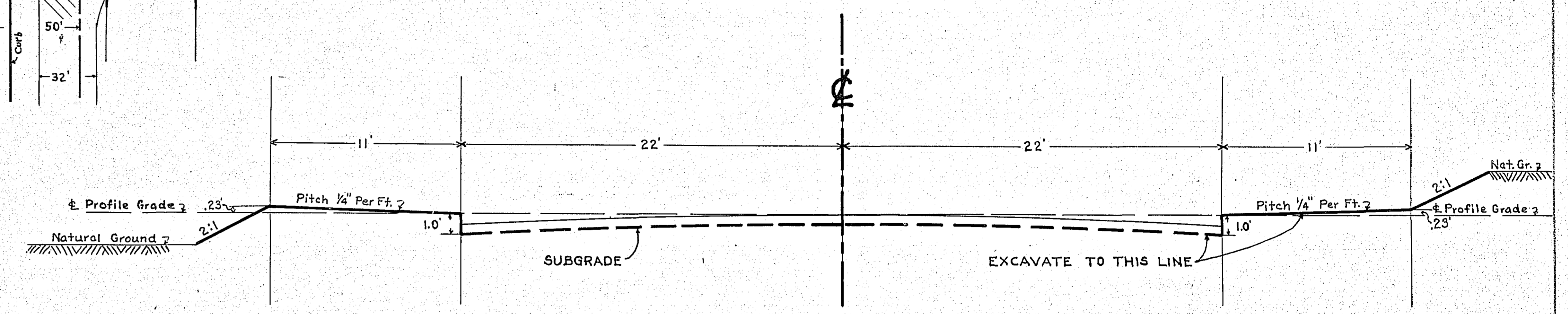

PLAN SURVEYED BY DATE  
 FLOTTED BY DATE  
 NOTE BOOK NO. OF WAY CHECKED BY DATE  
 NO. OF WAY CHECKED BY DATE

PROFILE SURVEYED BY DATE  
 NOTE BOOK NO. OF GRADES CHECKED BY DATE  
 B.L.M. NOTES BY DATE  
 STRUCTURE NOTATIONS CHANGED BY DATE

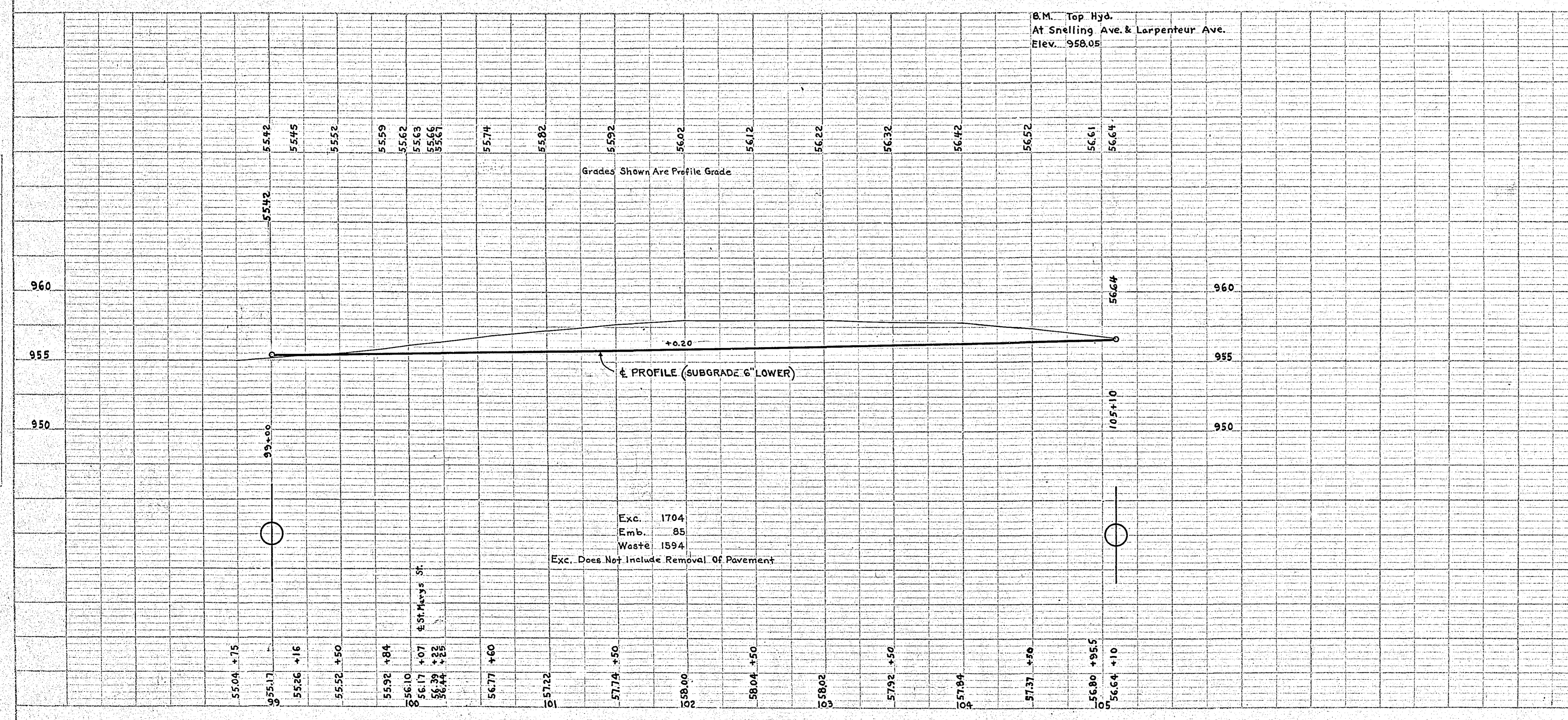

ESTIMATED QUANTITIES

|          |                         |          |      |
|----------|-------------------------|----------|------|
| 2104.501 | Remove Portable Culvert | Lin. Ft. | 36   |
| 2104.502 | Remove Pavement         | Sq. Yds. | 1998 |
| 2104.506 | Remove Sidewalk         | Sq. Yds. | 27   |
| 2104.503 | Class 'C' Excavation    | Cu. Yds. | 1704 |

Exc. 1704  
 Emb. 85  
 Waste 1594  
 Exc. Does Not Include Removal Of Pavement