

Sta. 2+05 Lt. 18' Pl. Catch Basin Type No. 2 Frame "A" Cover "D"  
 Sta. 2+05 Rt. 23' Pl. Manhole Frame "A" Cover "B"  
 Sta. 2+05 Lt. 18' to 23' Rt. Furn. & Inst. 12" x 38" C.M.  
 Sta. 2+05 Rt. 23' to 29' Rt. Furn. & Inst. 12" x 6" C.M.  
 Sta. 2+05 Rt. 23' to Sta. 3+27 Rt. 23' Furn. & Inst. 15" x 120" C.M.  
 Sta. 3+27 Rt. 23' to Sta. 5+00 Rt. 23' Const. Ditch  
 S+04 4 Inp. 15" x 46" C.M. O.K. Leave  
 S+49 Rt. 25' Inp. 18" x 26" C.M. O.K. Leave

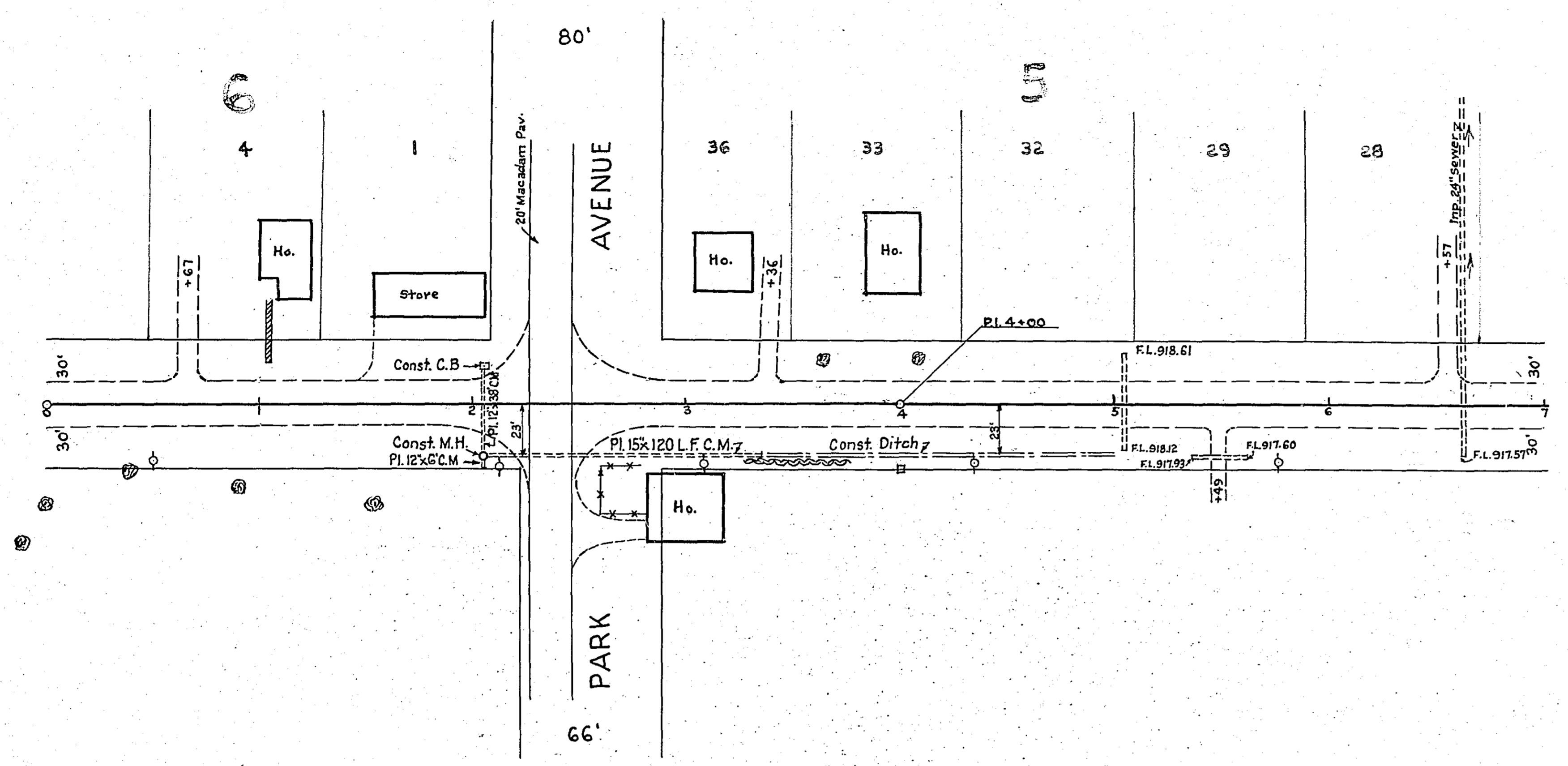

PLAN	SURVEYED	DATE
	PLOTTED	BY
	ALIGNED CHECKED	
	NOTE BOOK NO.	
	STRUCTURE NO. AT NE. CORNER	

PROFILE	SURVEYED	DATE
	GRADES CHECKED	BY
	STRUCTURE NO. AT NE. CORNER	
	NOTE BOOK NO.	
	STRUCTURE NO. AT NE. CORNER	

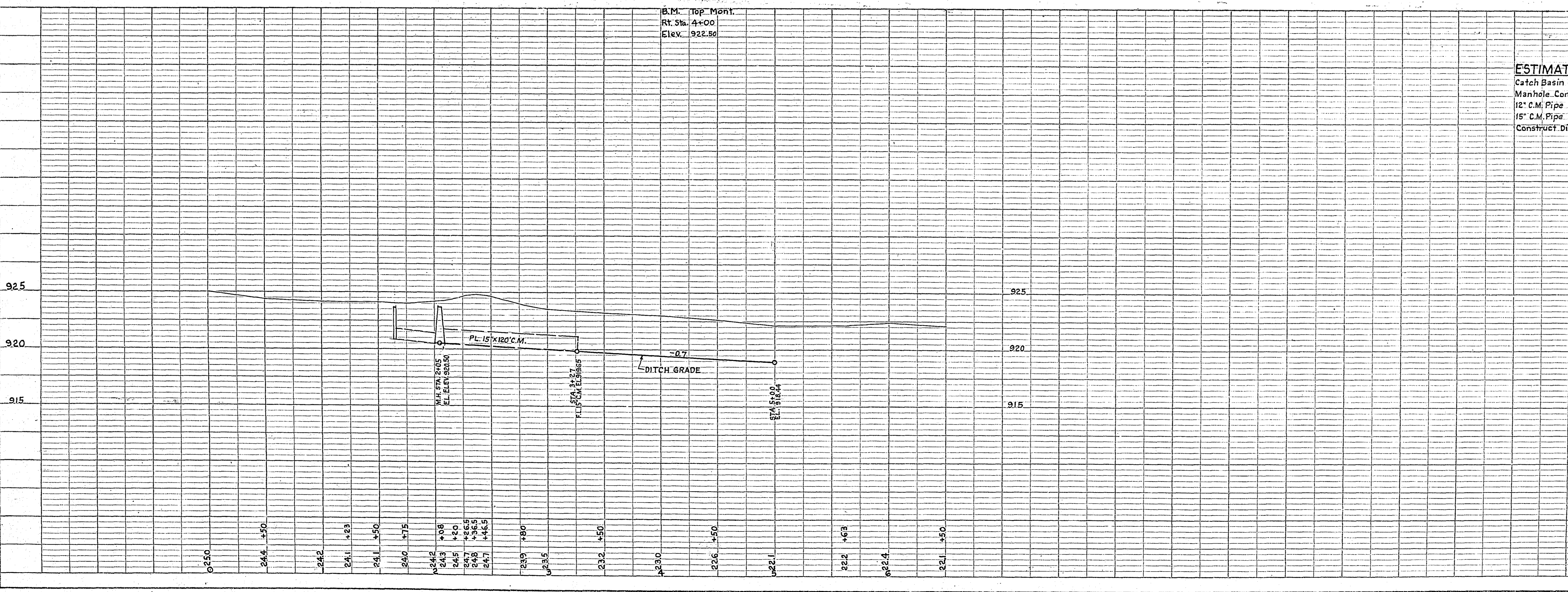

**ESTIMATED QUANTITIES**

Catch Basin Complete	Each	1
Manhole Complete	"	1
12" C.M. Pipe	Lin. Ft.	44
15" C.M. Pipe	"	120
Construct Ditch	"	273

OFFICE OF  
 RAMSEY COUNTY SURVEYOR  
 HARRY S. BRONSON  
 DRAINAGE PLAN  
**EAGLE AVE.**  
 FROM PARK AVE. TO 450' NORTH  
 OCT. 1946 SCALE AS SHOWN  
 APPROVED COUNTY ENGINEER