

DATE	
BY	
SURVEYED	
ALIGNED	
CHECKED	
NOTE BOOK	
NO.	

DATE	
BY	
SURVEYED	
PLOTTED	
CHECKED	
NOTE BOOK	
NO.	

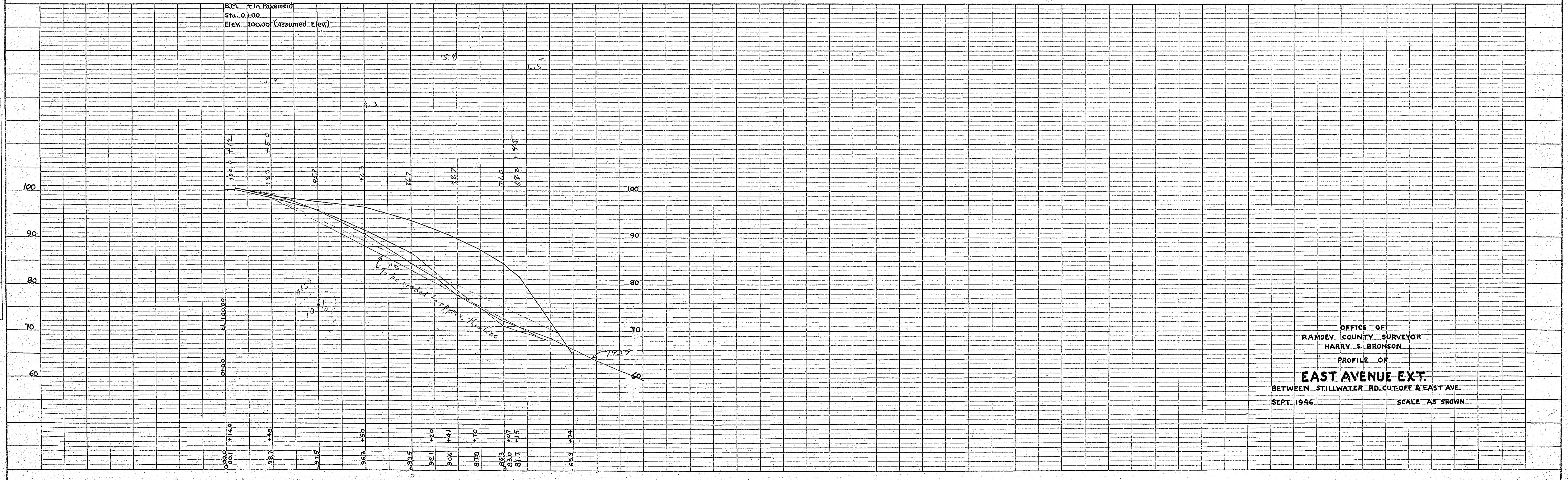
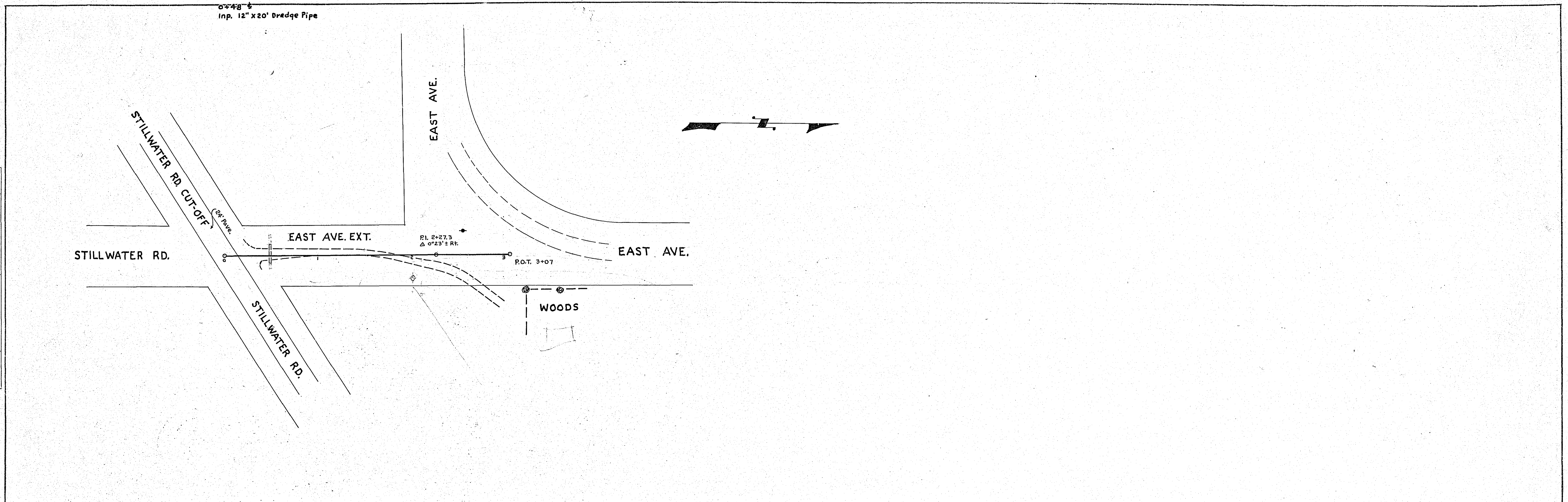

OFFICE OF
 RAMSEY COUNTY SURVEYOR
 HARRY S. BRONSON
 PROFILE OF
EAST AVENUE EXT.
 BETWEEN STILLWATER RD. CUT-OFF & EAST AVE.
 SEPT. 1946 SCALE AS SHOWN