

707

0+23.4
Inp. 15% 46' C.M.

3+80 Lt.
Inp. 15% 23' V.H.P.

4+84.4
Inp. 24% 46' Conc. P.

9+82 Lt.
Inp. 15% 51' Conc. P.

10+84 Lt.
Inp. 12% 27' C.M.

13+10 Lt.
Inp. 15% 31' C.M.

14+20 Lt.
Inp. 15% 20' C.M.

15+66 Lt.
Inp. 12% 8' C.M.

16+46 Lt.
Inp. 12% 30' C.M.

18+43 Lt.
Inp. 12% 20' C.M.
Rem. & Repl.

19+86 Lt.
Inp. 15% 20' C.M.
Rubble Hdwall Rt End.

22+60 Lt.
Inp. 15% 31' C.M.

24+26 Lt.
Inp. 12% 25' C.M.

PLAN
BY: []
DATE: []
SOURCE: []
SCALE: []
NOTE: []

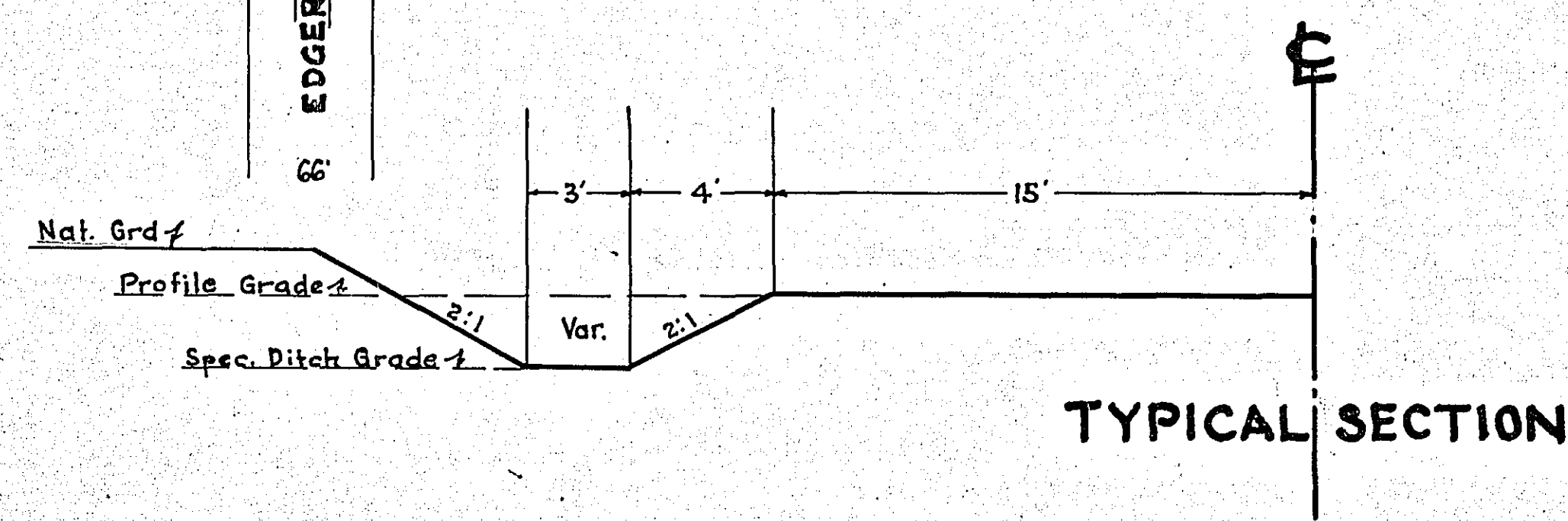
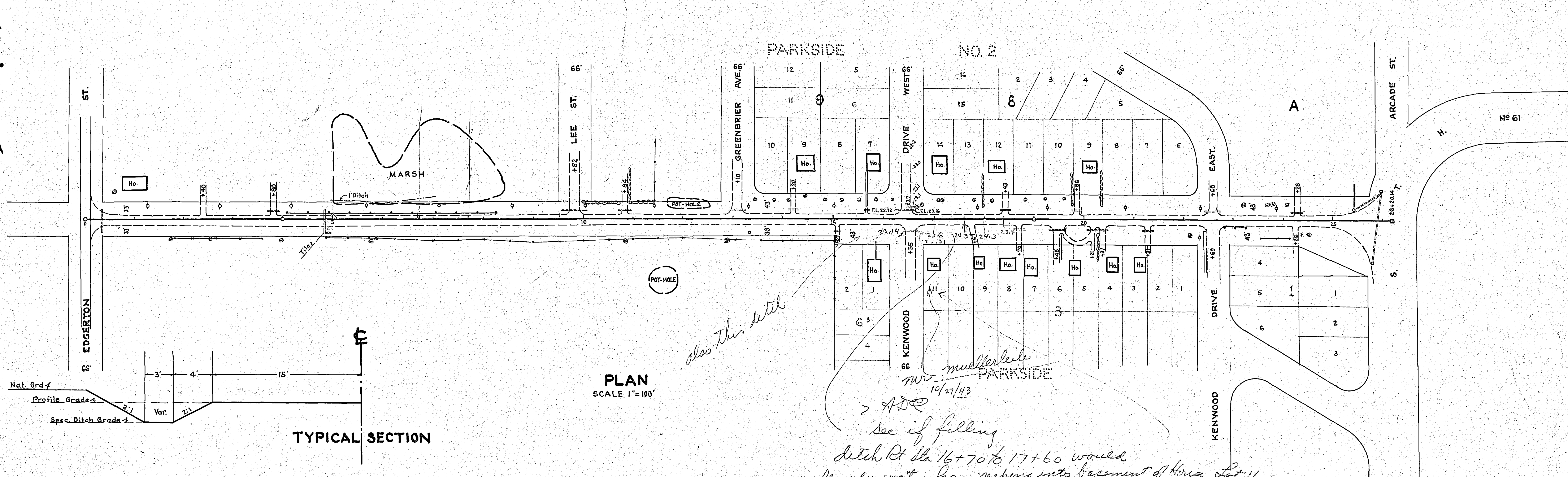

PLAN
SCALE 1"=100'

also this ditch

mullerleite

10/27/43

> ADD

see if felling

ditch Rt Sta 16+70 to 17+60 would

remedy water from seeping into basement of house Lot 11

PROFILE
BY: []
DATE: []
SOURCE: []
SCALE: []
NOTE: []

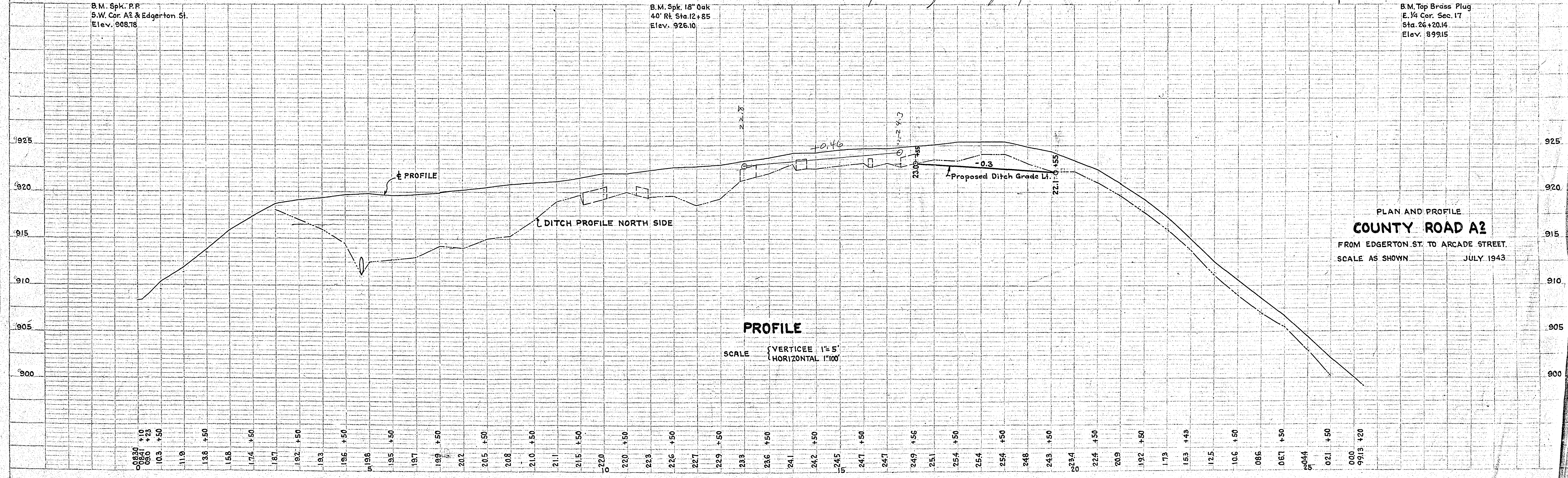

PROFILE
SCALE { VERTICEE 1"=5'
HORIZONTAL 1"=100'

PLAN AND PROFILE
COUNTY ROAD A2
FROM EDGERTON ST. TO ARCADE STREET.
SCALE AS SHOWN JULY 1943

3336 3336