

0+00 E 0+08 RT. 0+98 RT. 1+00 LT. 2+09 RT. 2+36 LT. 4+04 LT. 5+94 RT. 6+67 LT. 6+86 RT. 7+38 RT. 8+14 RT. 9+08 RT. 9+18 LT. 10+22 LT. 10+72 LT. 11+04 RT. 11+39 LT. 12+29 RT.

Inp. 36x36 C.M. Inp. 2-12x15 C.M. Inp. 15x20 C.M. Inp. 15x20 C.M. Inp. 15x20 C.M. Inp. 15x20 C.M. Inp. 15x20 C.M. Inp. 15x66 C.M. Inp. 15x20 C.M. Inp. 15x20 C.M. Inp. 15x20 C.M. Inp. 12x13 C.M. Inp. 15x22 C.M. Inp. 15x6 C.M. Inp. 15x40 C.M. Inp. 15x20 C.M. Inp. 12x14 C.M.

NOTE  
CULVERTS FROM STA. 1+00 RT. & LT. TO STA. 13+00 RT. & LT. TO BE REMOVED & RELAYED.

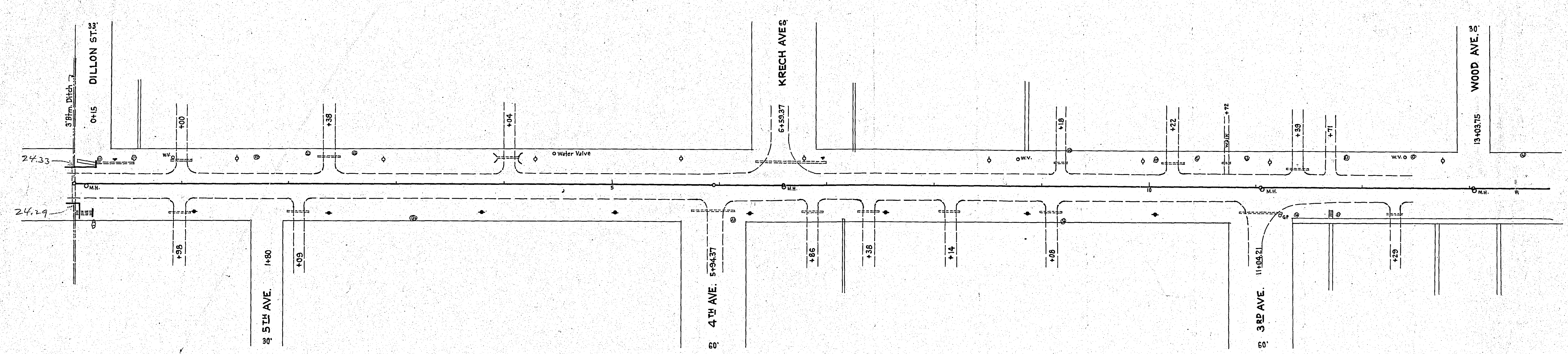

B.M. Top Hyd.  
24' Lt. Sta 0+36  
Elev. 933.74

B.M. Top Hyd.  
24' Lt. Sta. 6+96  
Elev. 934.66

B.M. Top Hyd.  
24' Lt. Sta 11+39  
Elev. 934.86

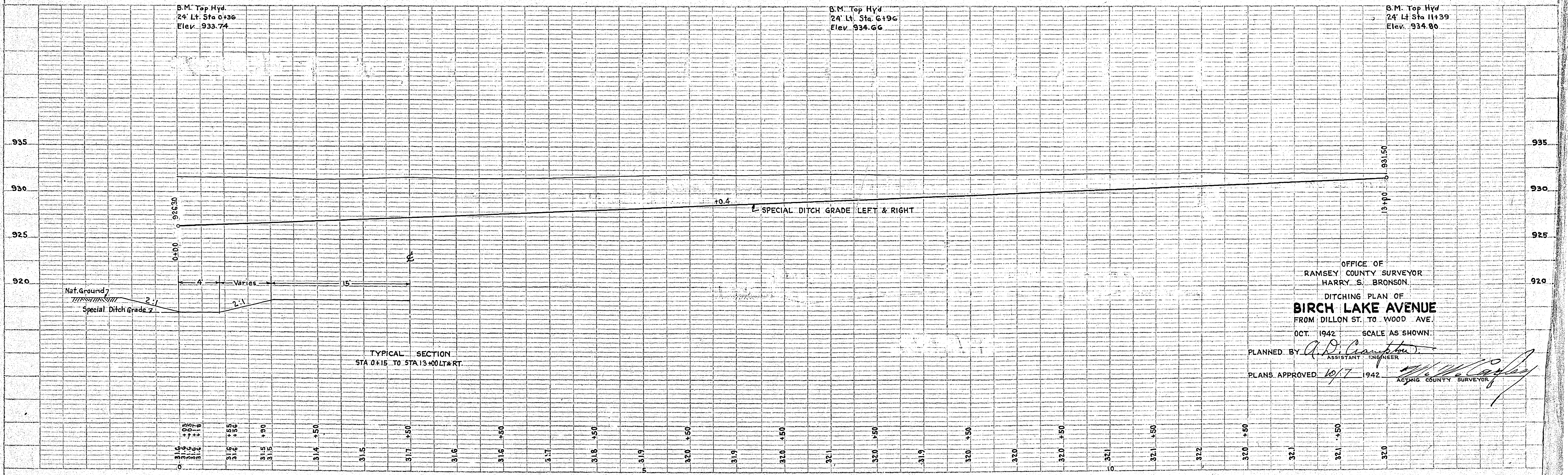

TYPICAL SECTION  
STA 0+15 TO STA 13+00 LT. & RT.

OFFICE OF  
RAMSEY COUNTY SURVEYOR  
HARRY S. BRONSON

DITCHING PLAN OF  
**BIRCH LAKE AVENUE**  
FROM DILLON ST. TO WOOD AVE.

OCT. 1942 SCALE AS SHOWN

PLANNED BY *A. D. Campbell*  
ASSISTANT ENGINEER

PLANS APPROVED *10/17* 1942 *W. W. Coffey*  
ACTING COUNTY SURVEYOR

PLAN	DRAWN	DATE
NOTED	DATE	
NOTE BOOK	NO.	
NO.		

PROFILE	DRAWN	DATE
NOTED	DATE	
NOTE BOOK	NO.	
NO.		

PRINTED IN U.S.A.  
BY THE UNIVERSITY OF MINNESOTA PRESS

PLATE I-PLAN-PROFILE IS P.T. STANDARD  
ENGINEERING CO., CHICAGO, ILL.