

PLAN	REVISIONS
NO.	DATE
1	
2	
3	
4	
5	
6	
7	
8	
9	
10	

0+31 Lt. Inp. 15'x24" C.M. Remove No Culvert Required

2+55 Lt. 2+55 ± Inp. 24'x18" C.M. Pl. 30'x52' Conc. P. Remove No Culvert Req'd.

5+62 ± Inp. 12'x16" C.M. Remove No Culv. Req'd.

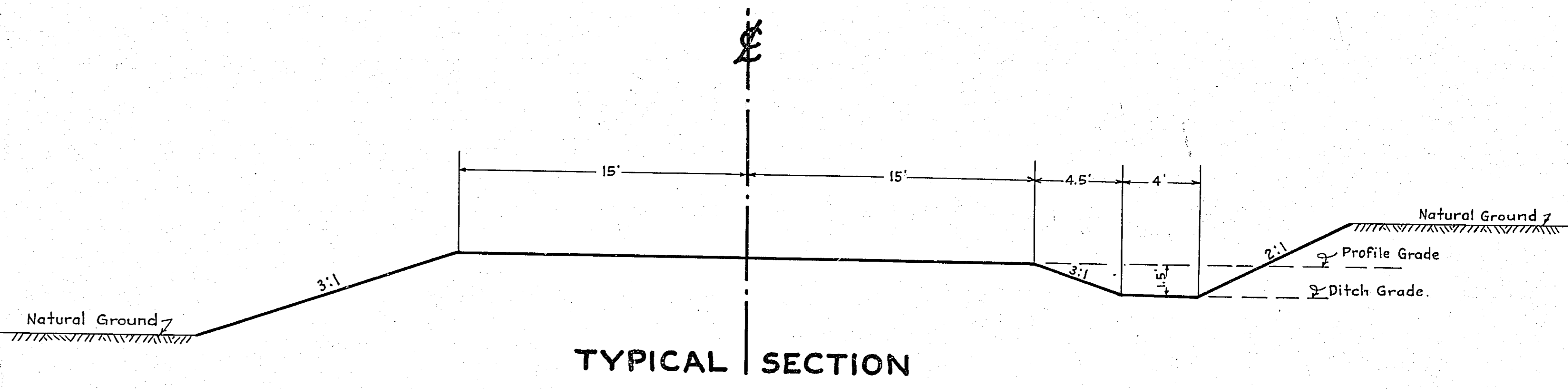
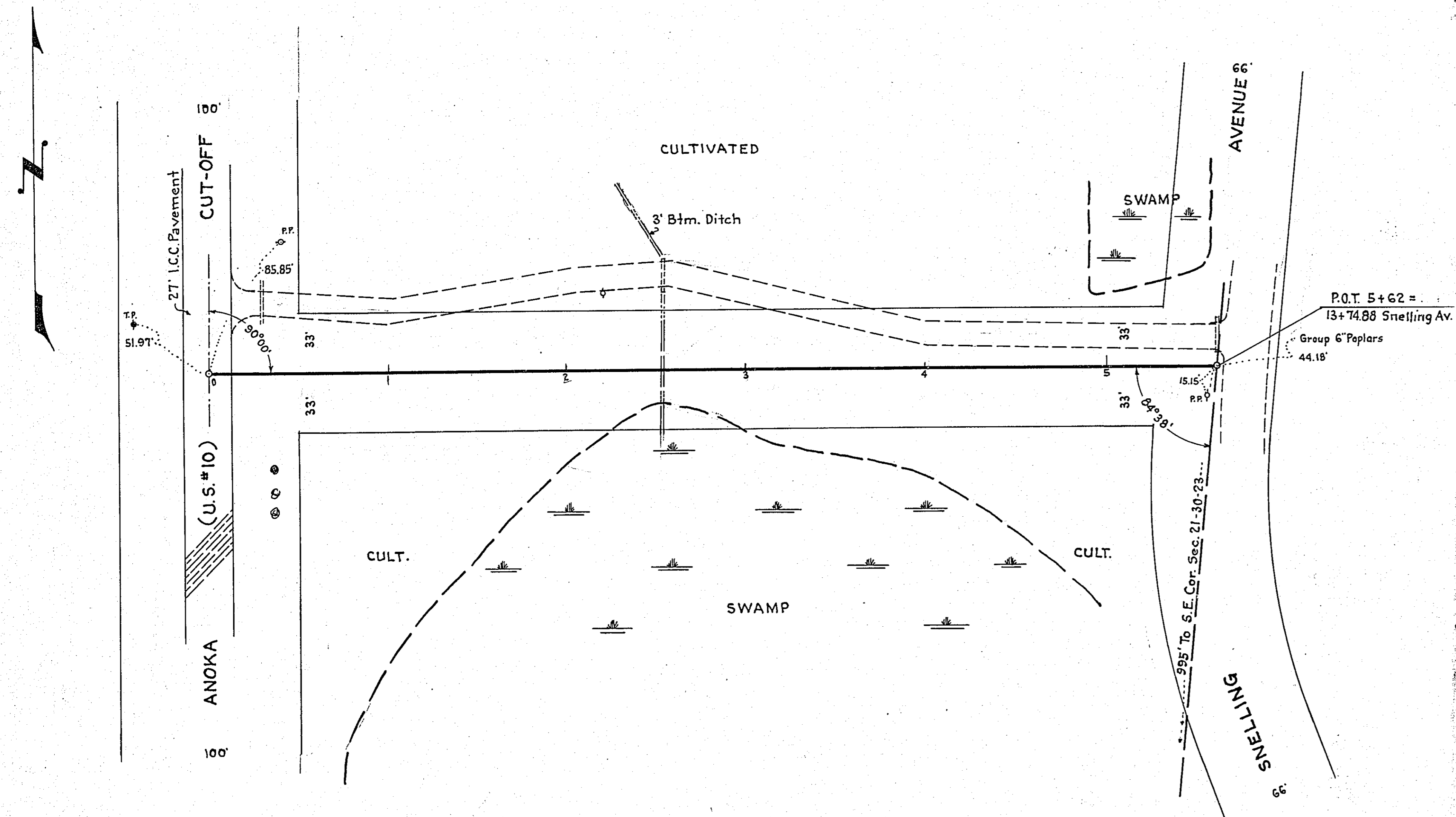

PROFILE	REVISIONS
NO.	DATE
1	
2	
3	
4	
5	
6	
7	
8	
9	
10	

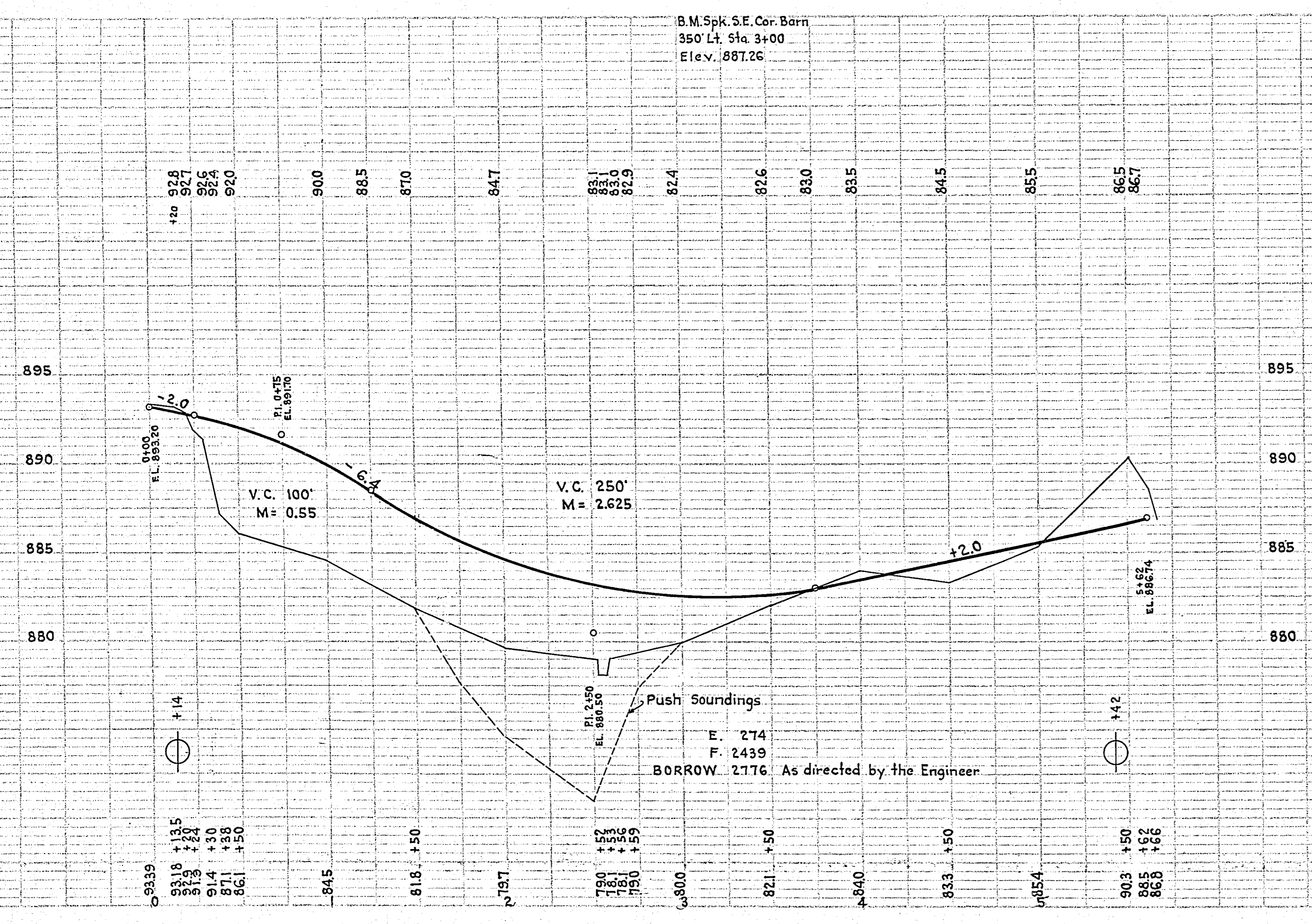

ESTIMATED QUANTITIES

Excavation	Cu. Yds.	274
Excavation Borrow	Cu. Yds.	2776
Remove Old Culvert	Lin. Ft.	58
Furnish 30" Concrete Pipe	Lin. Ft.	52
Finishing	Sq. Yds.	4200
Oil Stabilization	Sq. Yds.	1400
Gravel On Site	Cu. Yds.	53

OFFICE OF
RAMSEY COUNTY SURVEYOR
HARRY S. BRONSON
GRADING PLAN OF
COUNTY ROAD "F"
FROM ANOKA CUT-OFF TO SNELLING AVE.
OCTOBER 1941 SCALE AS SHOWN

PLANNED BY *R. D. Cammerton*
ASSISTANT ENGINEER

PLANS APPROVED *10/13 1941* *[Signature]*
ACTING COUNTY SURVEYOR

APPROVED *10/13 1941* *[Signature]*
CHAIRMAN COUNTY BOARD

APPROVED *10/13 1941* *[Signature]*
CHAIRMAN MOUNDS VIEW TOWNSHIP BOARD