

PLAN SURVEYED BY DATE
 PLOTTED BY
 NOTE BOOK NO.
 FT. OF WAY CHECKED

PROFILE SURVEYED BY DATE
 PLOTTED BY
 NOTE BOOK NO.
 STRUCTURE NOTED AS CHYD

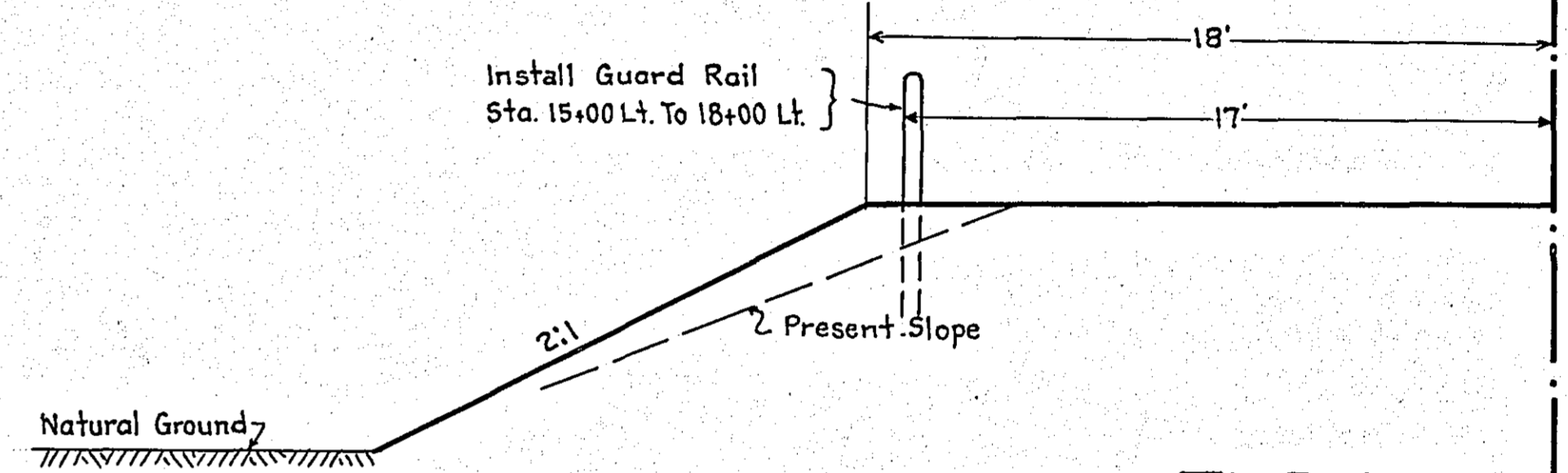
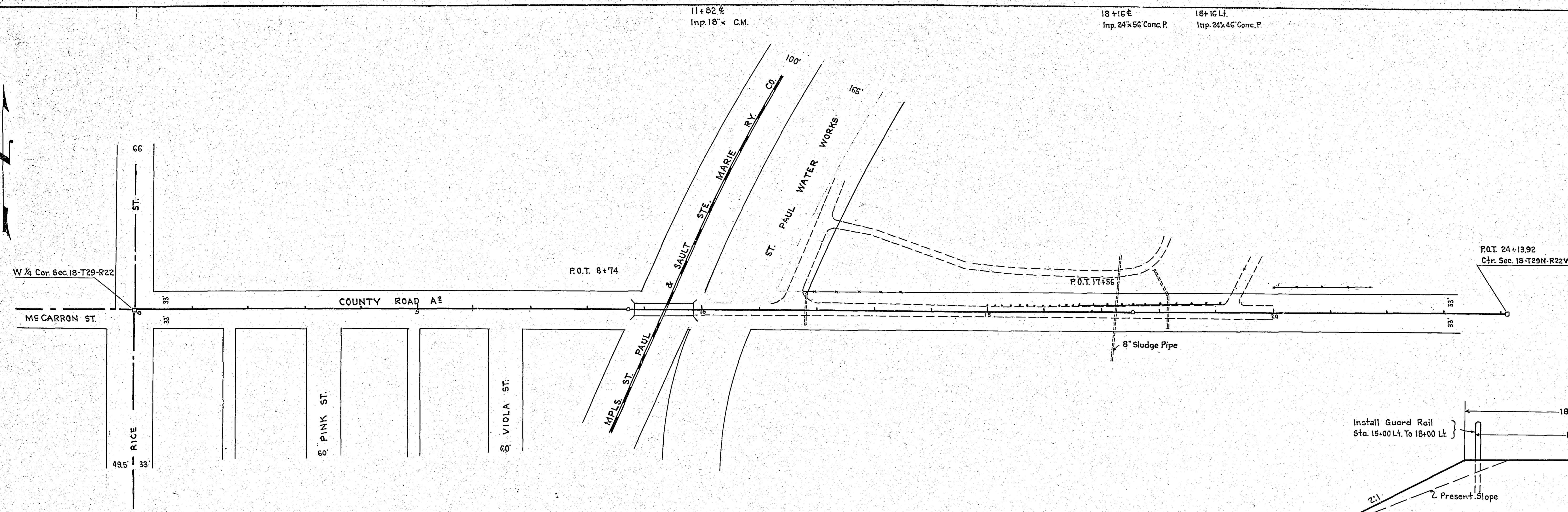

TYPICAL SECTION

Sta. 15+27 Lt. To Sta. 19+00 Lt.
 NOTE: Sta. 11+82 Lt. To Sta. 15+27 Lt. See Cross Section Sheet

B.M. Top Man
 Chr. Rice St. & Co. Rd. A2
 Elev. 862.28

B.M. Top 18' Q.M.
 31' Lt. Sta. 11+82
 Elev. 887.4'

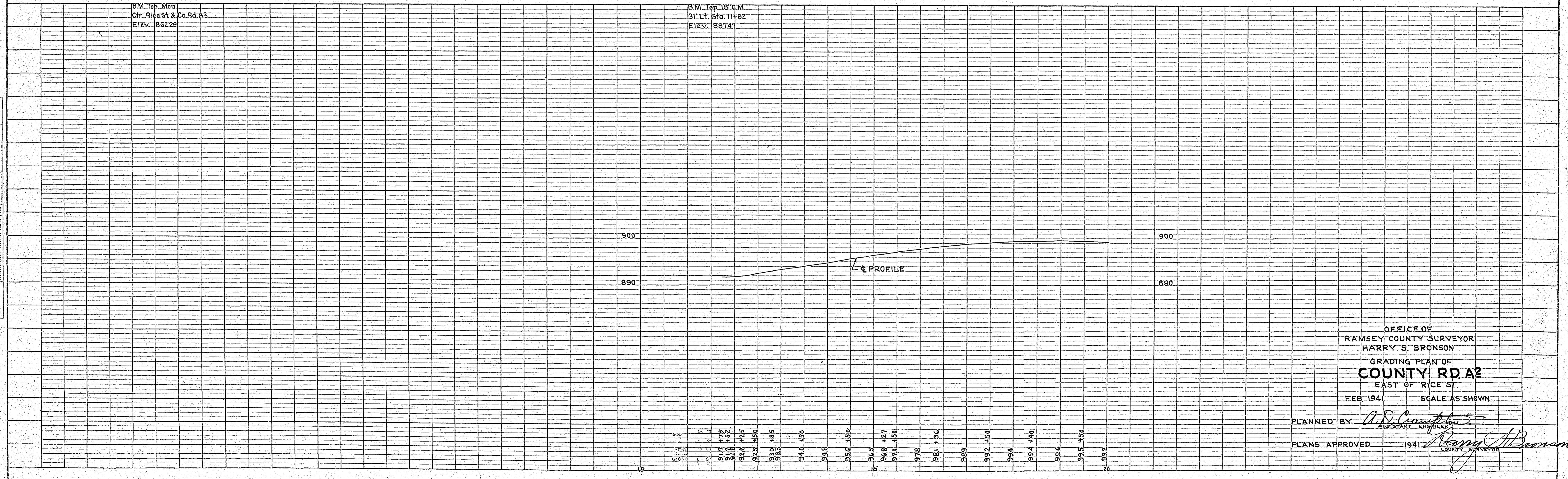

PLATE 1—PLAN—PROFILE O. P. & R. E. STANDARD
 KEUFFEL & ESSER CO. NEW YORK

K & E CO. No. 345-1

OFFICE OF
 RAMSEY COUNTY SURVEYOR
 HARRY S. BRONSON
 GRADING PLAN OF
COUNTY RD. A2
 EAST OF RICE ST.
 FEB. 1941 SCALE AS SHOWN

PLANNED BY *A.D. Crouton*
 ASSISTANT ENGINEER
 PLANS APPROVED 941 *Harry S. Bronson*
 COUNTY SURVEYOR