

RAMSEY COUNTY

HIGHWAY MAP

OFFICE OF COUNTY ENGINEER,

ST. PAUL-MINN.

PAUL N. COATES
COUNTY ENGINEER.

EALY G. BRIGGS
CONSTRUCTION ENGINEER.

St. Paul, Minnesota, January 19th, 1925.

Approved and adopted by the Board of County Commissioners of Ramsey County, Minnesota, at regular meeting held January 19th, 1925, and ordered placed of record in the office of the Register of Deeds of Ramsey County, Minnesota.

(SEAL).

County Auditor.

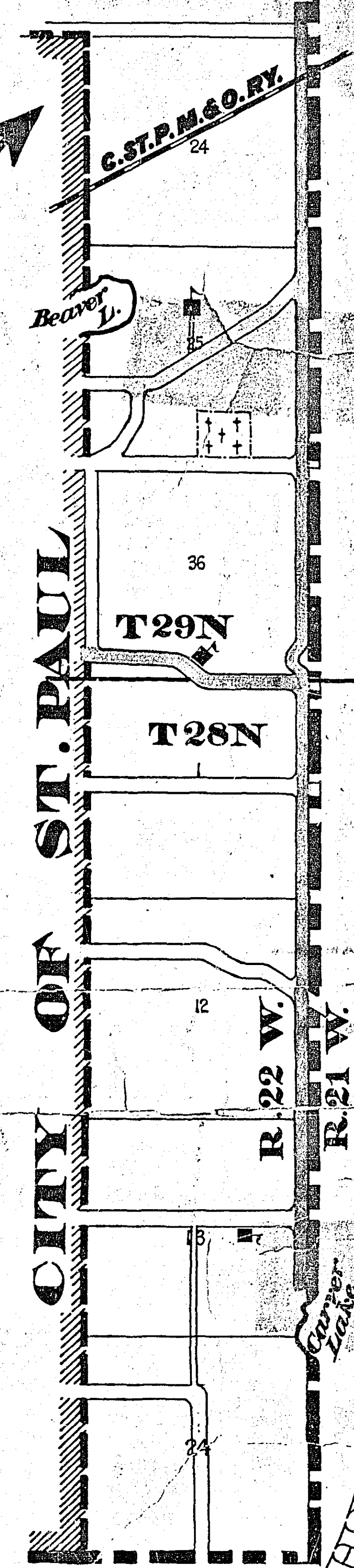
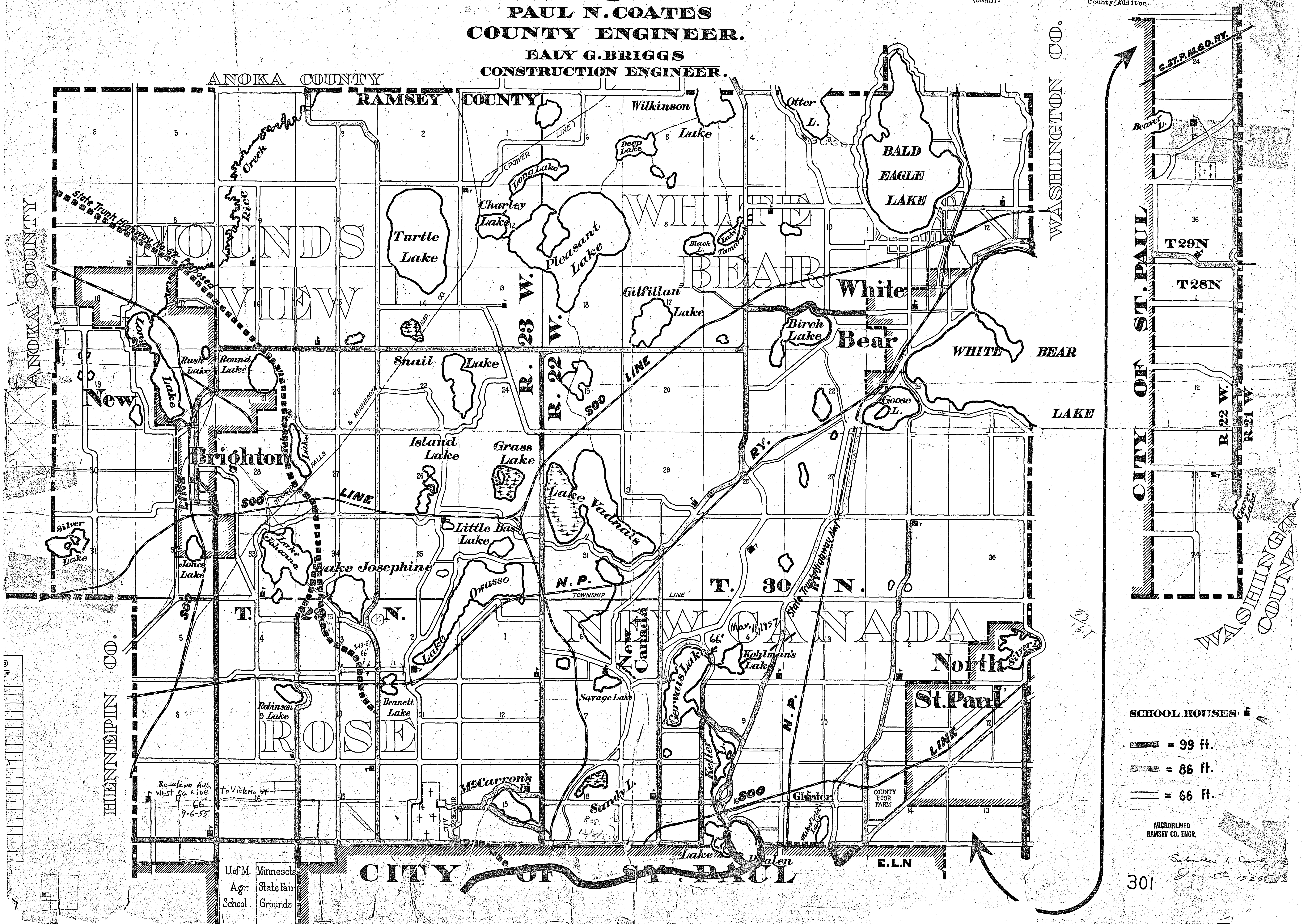

SCHOOL HOUSES

- = 99 ft.
- = 86 ft.
- = 66 ft.

MICROFILMED
RAMSEY CO. ENGR.

Submitted to County 102
Jan 5th 1925