

9+93.6+97 ± 11+50 Rt.
 Inp. 2'-36" x 34' C.M. Inp. 15" x 20' C.M.

PLAN	BY	DATE
SURVEYED		
NOTED		
NOTED		
NO.		

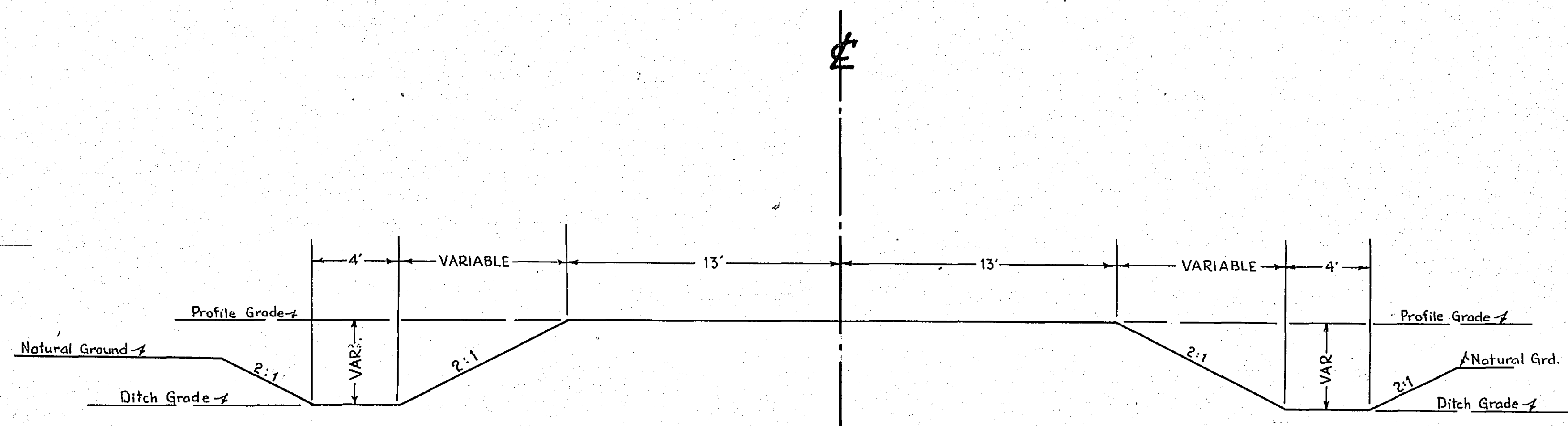
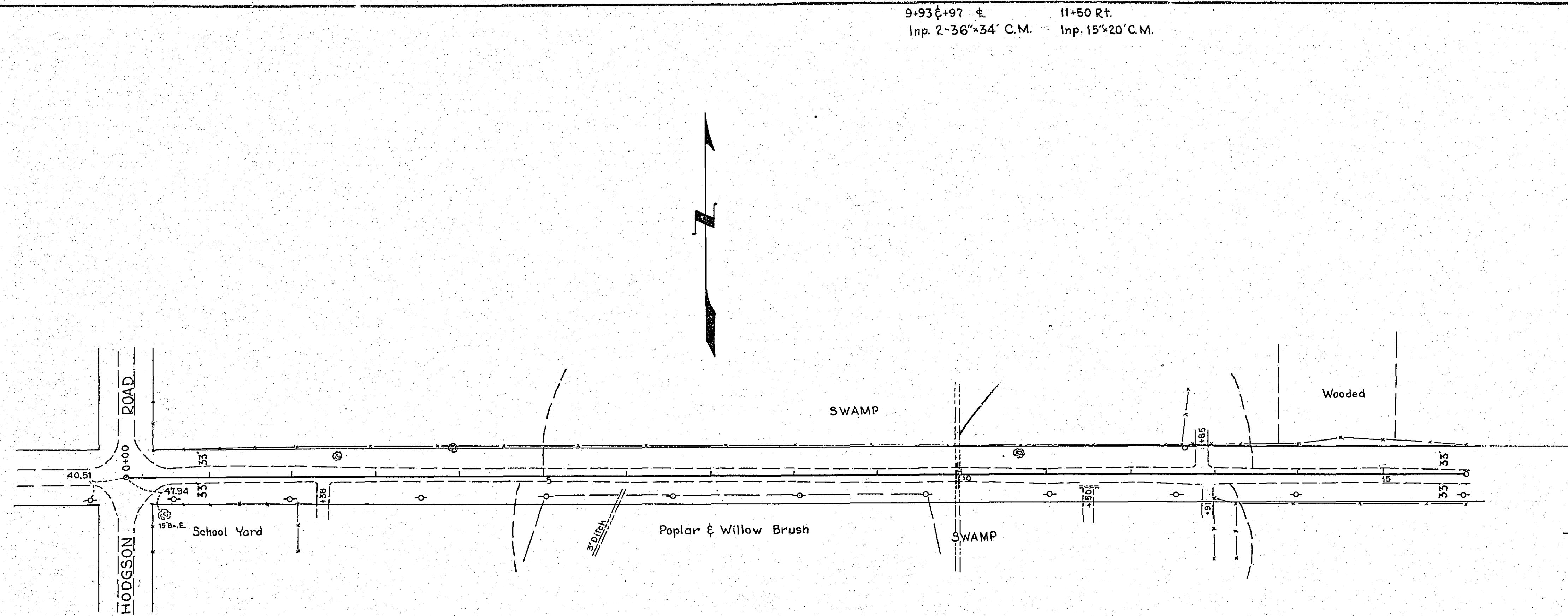

SPECIAL SECTION
 STA. 5+00 TO 12+00 RT. & LT.

PROFILE	BY	DATE
SURVEYED		
NOTED		
NOTED		
NO.		

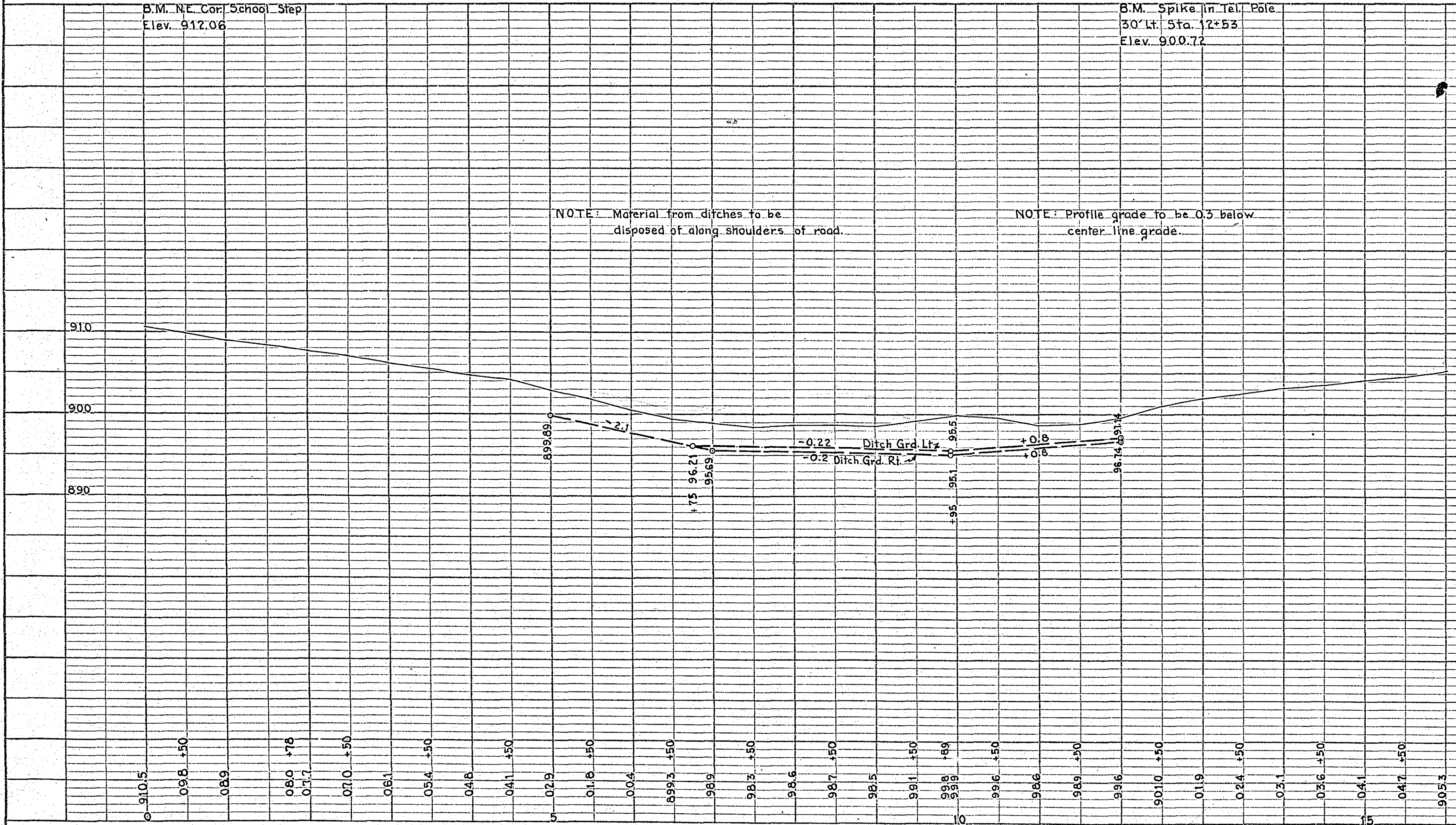

NOTE: Material from ditches to be disposed of along shoulders of road.

NOTE: Profile grade to be 0.5 below center line grade.

OFFICE OF
 RAMSEY COUNTY SURVEYOR
 HARRY S. BRONSON
 DITCHING PLAN
TURTLE LAKE ROAD
 HODGSON ROAD - 1600' EAST
 SCALE AS SHOWN AUG. 1938

PLANS APPROVED *[Signature]* 8/30 1938
 COUNTY SURVEYOR