

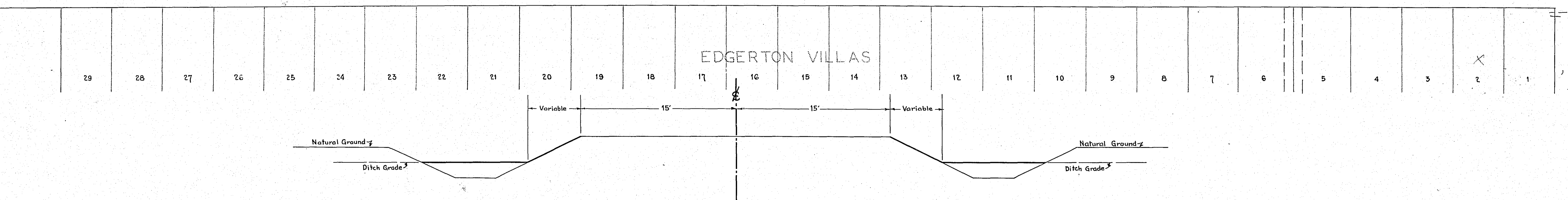

POT 131+54.2
CTR. SEC. 5-125N-R22W

POT 160+40.45
N $\frac{1}{2}$ SEC. 5-125N-R22W

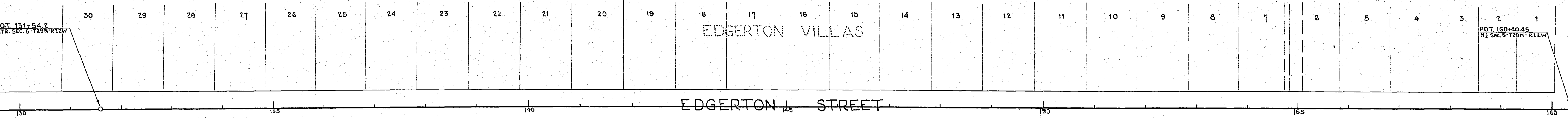

TYPICAL SECTION
SCALE 1"=5'

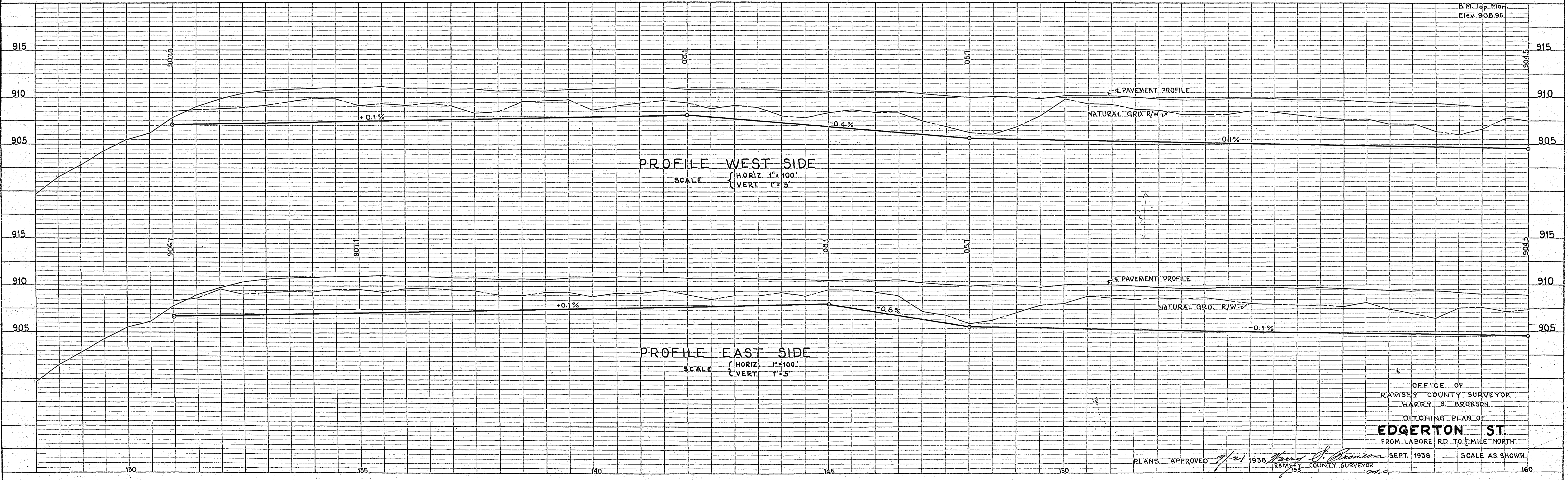

PROFILE WEST SIDE
SCALE { HORIZ. 1"=100'
VERT. 1"=5'

PROFILE EAST SIDE
SCALE { HORIZ. 1"=100'
VERT. 1"=5'

OFFICE OF
RAMSEY COUNTY SURVEYOR
HARRY S. BRONSON
DITCHING PLAN OF
EDGERTON ST.
FROM LABORE RD. TO $\frac{1}{2}$ MILE NORTH

PLANS APPROVED 9/21 1938 *Harry S. Bronson* RAMSEY COUNTY SURVEYOR SEPT. 1938 SCALE AS SHOWN

Sheet 1

2709

DATE	
BY	
SURVEYED	
PLANNED	
NOTED	
ALIGNED	
CHECKED	
NO.	

DATE	
BY	
SURVEYED	
PLANNED	
NOTED	
GRADES	
CHECKED	
B. M. NOTED	
STRUCTURE	
CONTAINS	
CHANGED	
NO.	

EDGERTON ST.

130" Standard Oil Pipe Line

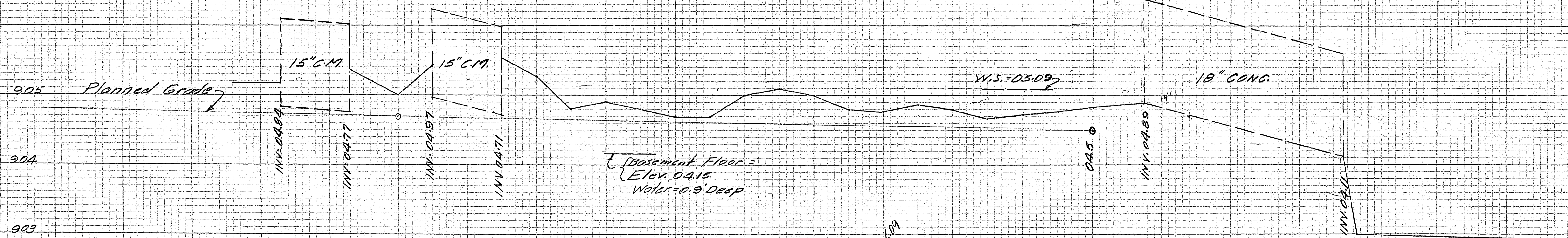
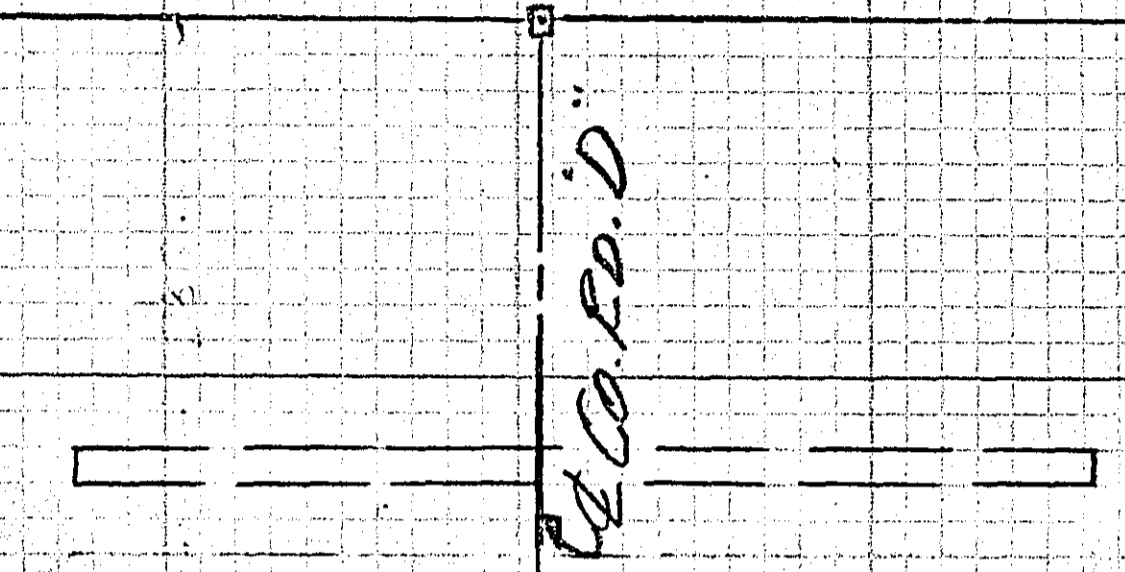
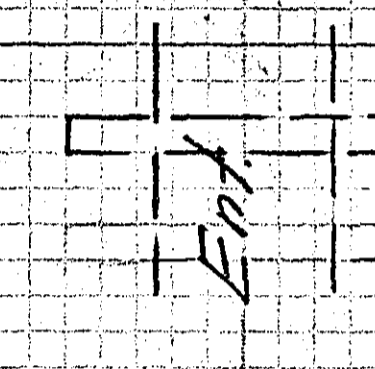
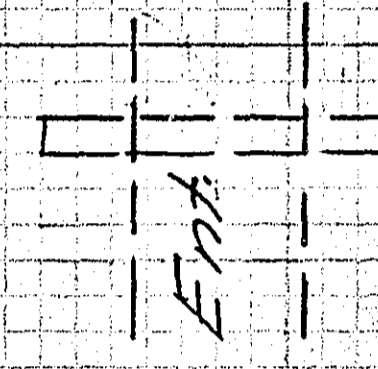

905
904
903

INV. 04.84

INV. 04.77

INV. 04.97

INV. 04.71

04.50

INV. 04.85

INV. 04.11

157
0.50
05.42 +19
158
05.52 +30
05.27 +40
04.8 +30
04.9 +60
04.8 +70
04.7 +80
04.7 +90
05.0
05.1 +10
05.0 +20
04.8 +30
04.77 +40 W.S. 05.09
04.87 +50
04.8 +60
04.67 +70
04.72 +80
04.77 +90
04.92
05.0 +10
04.89 +126
160

EDGERTON ST.
Right Ditch Profile
7/18/56

Sheet 2

2709