

PLAN	DATE
BY	
CHECKED	
NOTED	
NO.	

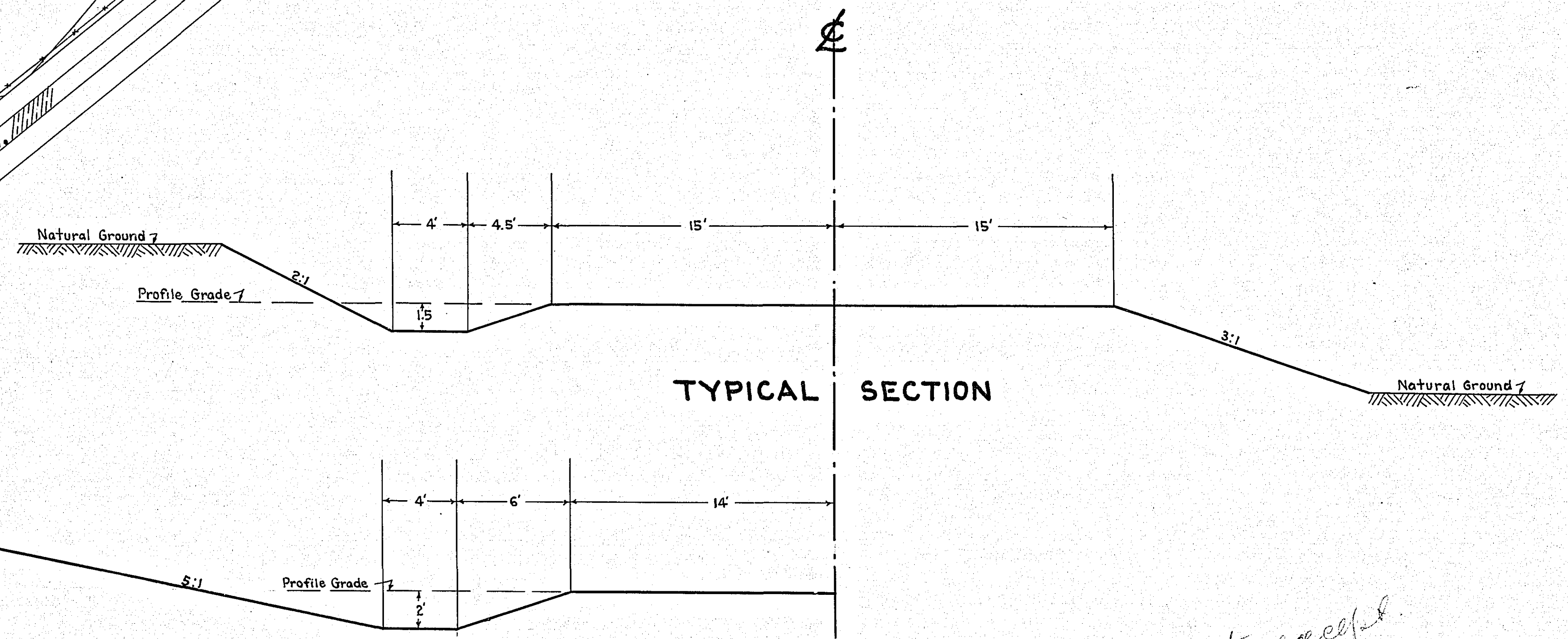
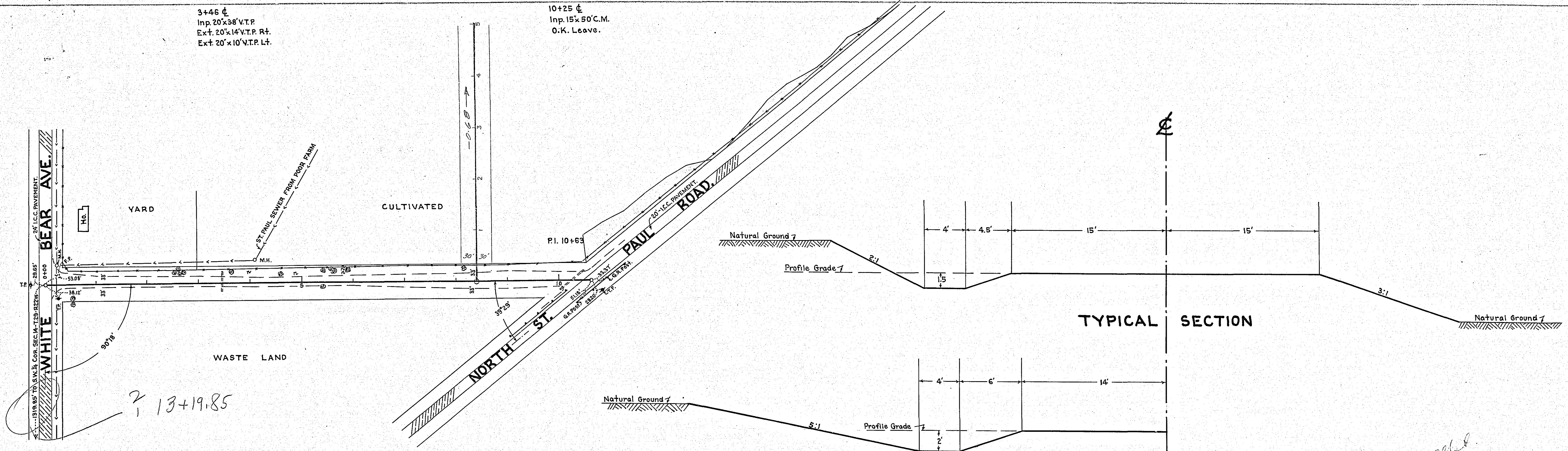

NOTE: 2600 C.Y. OF BORROW TO BE OBTAINED FROM STA. 10+63 TO 825' EAST ON THE NORTH SIDE OF THE NO. ST. PAUL ROAD.

*Complete except
Signatures
H.S.
4-4-38*

PROFILE	DATE
BY	
CHECKED	
NOTED	
NO.	

B.M. Spike in T.P. West Side White Bear Ave. & No. St. Paul Rd. Conn. Elev. 969.30
 B.M. Spike in T.P. East Side No. St. Paul Rd. At No. St. Paul Rd. Conn. Elev. 973.80

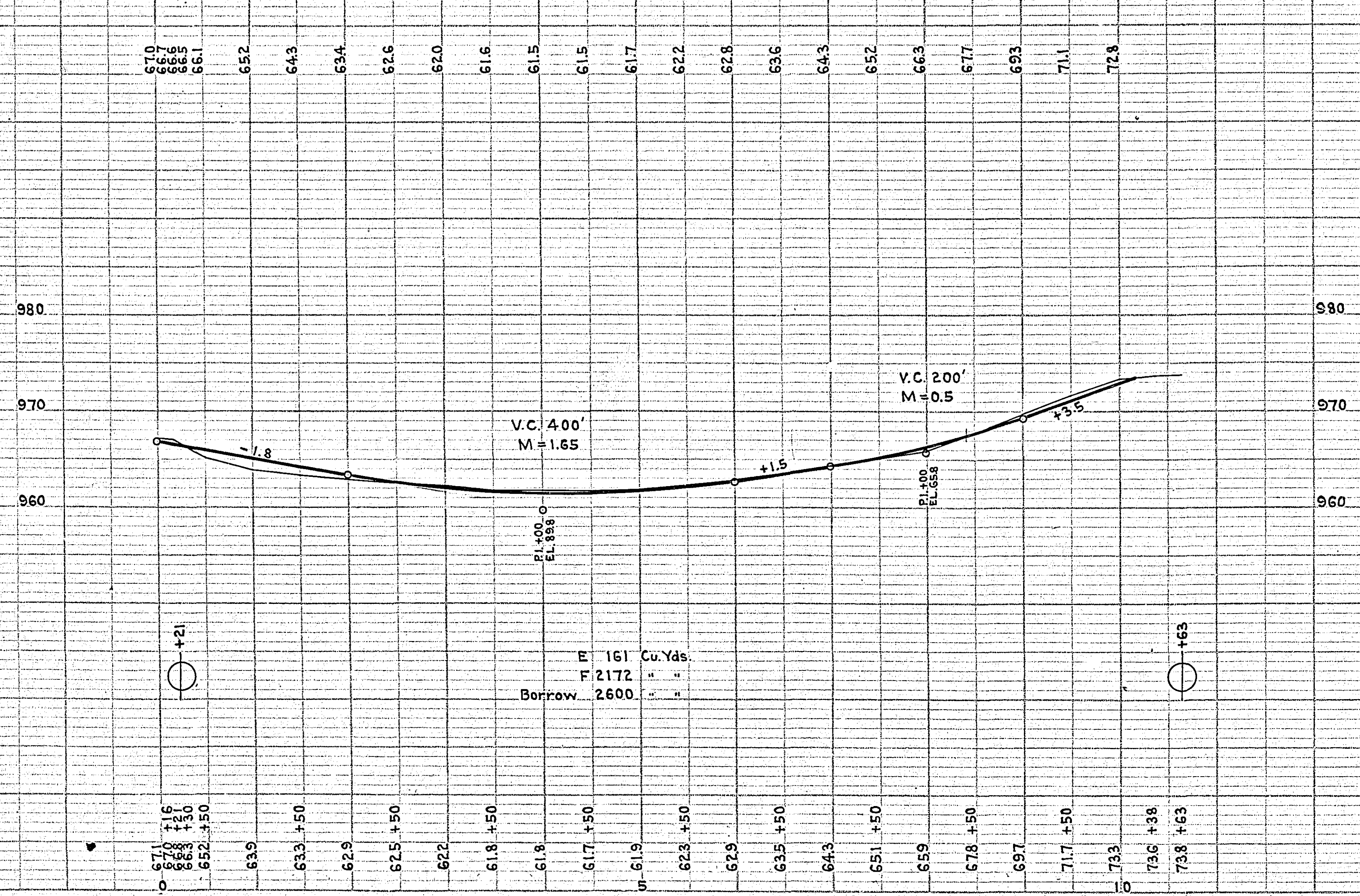

OFFICE OF
 RAMSEY COUNTY SURVEYOR
 HARRY S. BRONSON.
 GRADING PLAN OF
NORTH ST. PAUL ROAD CONNECTION
 FROM WHITE BEAR AVE. TO NORTH ST. PAUL ROAD.
 MARCH 1938 SCALE AS SHOWN

PLANS APPROVED 1938 COUNTY SURVEYOR
 APPROVED 1938 CHAIRMAN OF COUNTY BOARD