

STATEMENT OF ESTIMATED QUANTITIES

CLASS	ITEM	UNIT	MILE From To	MILE From To	MILE From To	MILE From To	MILE From To	MILE From To	MILE From To	MILE From To	MILE From To	MILE From To	TOTAL ESTIMATED QUANTITIES
GRADING	1	Clearing	Trees										
	2	Grubbing	Trees										
	3	Clearing	Acres										
	4	Grubbing	Acres										
	5	Excavation Earth	Cu. Yds.										
	6	Excavation Loose Rock	Cu. Yds.										
	7	Excavation Solid Rock	Cu. Yds.										
	8	Excavation Overhaul	Cu. Yds.										
	9	Excavation Special	Cu. Yds.										
	10	Excavation Hand Ditch	Cu. Yds.										
	11	Install 12" C.M.	Lin. Ft.										
	12	Install 15" C.M.	Lin. Ft.										
	13	Install 18" C.M.	Lin. Ft.										
	14	Install 24" C.M.	Lin. Ft.										
	15	Install	Lin. Ft.										
	16	Install	Lin. Ft.										
	17	Install 18" Ps	Lin. Ft.										
	18	Install 24" Ps	Lin. Ft.										
	19	Install 30" Ps	Lin. Ft.										
	20	Install 36" Ps	Lin. Ft.										
	21	Install	Lin. Ft.										
	22	Install	Lin. Ft.										
	23	Remove Old Culvert	Lin. Ft.										
	24	Replace Old Culvert	Lin. Ft.										
	25	Finishing and Seeding	100 Sq. Yds.										
	26	Rubble Gutter	Cu. Yds.										
	27	Headwall Concrete	Cu. Yds.										
	28	Headwall Steel	Lbs.										
	29												
	30												
	31												
	32												
C.M. CULVERTS	1	Furnish 12" C.M.	Lin. Ft.										
	2	Furnish 15" C.M.	Lin. Ft.										
	3	Furnish 18" C.M.	Lin. Ft.										
	4	Furnish 24" C.M.	Lin. Ft.										
	5	Furnish	Lin. Ft.										
	6	Furnish	Lin. Ft.										
	7	Furnish 12" C.M. Band	Each										
	8	Furnish 15" C.M. Band	Each										
	9												
	10												
P ₃ CULVERTS	1	Furnish 18" Ps	Lin. Ft.										
	2	Furnish 24" Ps	Lin. Ft.										
	3	Furnish 30" Ps	Lin. Ft.										
	4	Furnish 36" Ps	Lin. Ft.										
	5												
	6												
GUARD RAIL	1	Guard Rail - Cable	Lin. Ft.										
	2	Guard Rail Anchors	Each										
	3	Dummy Posts	Each										
	4												
SIDEWALKS AND CURBING	1	Concrete Curb - Straight	Lin. Ft.										
	2	Concrete Curb - Radius	Lin. Ft.										
	3	Remove Old Curb	Lin. Ft.										
	4	Remove Old Curb and Gutter	Lin. Ft.										
	5	Remove Old Sidewalk	Sq. Ft.										
	6	Replace Old Sidewalk	Sq. Ft.										
	7	Construct New Sidewalk	Sq. Ft.										
	8	Curb Inlet	Each										
	9	Catch Basin Complete	Each										
	10												
	11												
	12												
SEWER	1	12" Vitrified Sewer Pipe	Lin. Ft.										
	2	15" Vitrified Sewer Pipe	Lin. Ft.										
	3	18" Vitrified Sewer Pipe	Lin. Ft.										
	4	20" Vitrified Sewer Pipe	Lin. Ft.										
	5	24" Vitrified Sewer Pipe	Lin. Ft.										
	6	Manhole - Complete	Each										
	7	Catch Basin - Complete	Each										
8													
9													
10													
PAVEMENT	1	Pavement - 1 Course Conc.	Sq. Yds.										
	2	Pavement - Asphaltic Conc.	Sq. Yds.										
	3	Integral Curb 8"	Lin. Ft.										
	4	Integral Curb 12"	Lin. Ft.										
	5	Surface Drain	Each										
	6	Surface Drain Basin	Each										
	7	Shoulders - Earth	Lin. Ft.										
	8												
STRUCTURES	1	Concrete	Cu. Yds.										
	2	Reinforcing Steel	Lbs.										
	3	Excavation	Cu. Yds.										
	4	Piling	Lin. Ft.										
	5												
6													
7													
8													
9													
10													

DETAILS

TYPICAL SECTION
33' R.O.W.

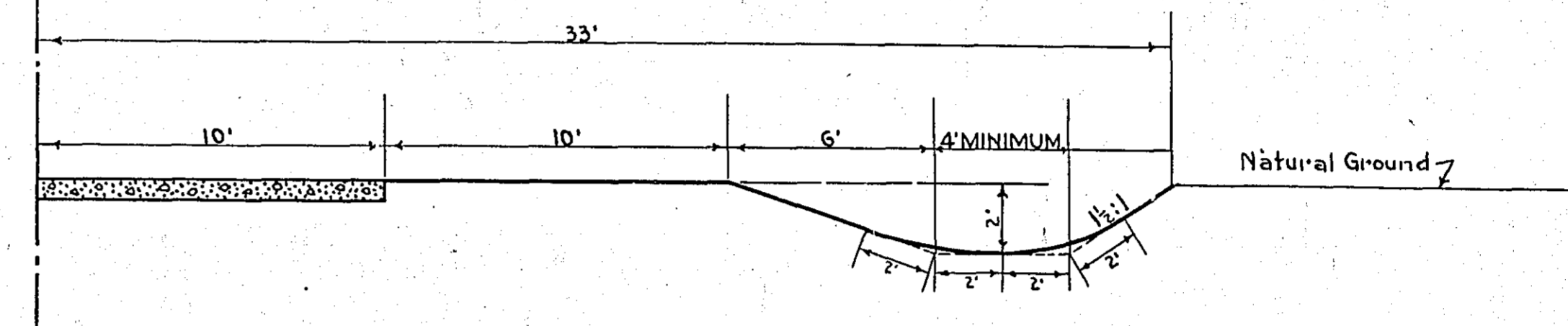

TYPICAL SECTION
49.5' R.O.W.

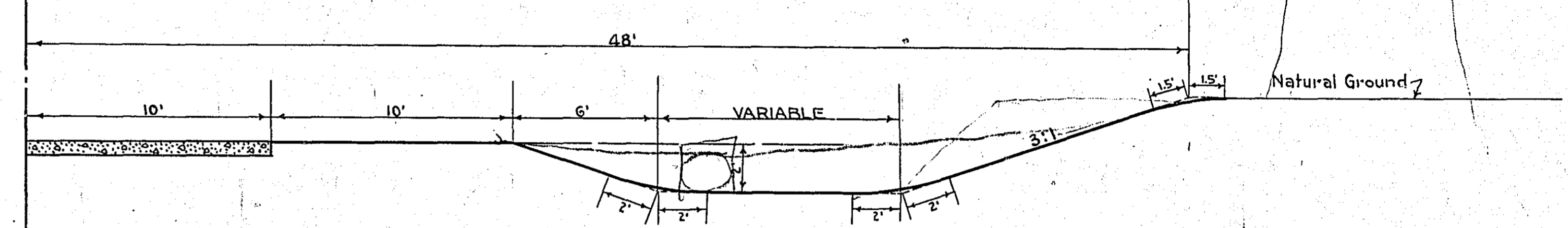

SPECIAL SECTION
132+00 To 137+00 LT.
132+00 To 135+00 RT.
145+50 To 148+50 RT.
146+00 To 154+00 LT.
150+00 To 155+00 RT.
20+00 To 24+50 Lt.

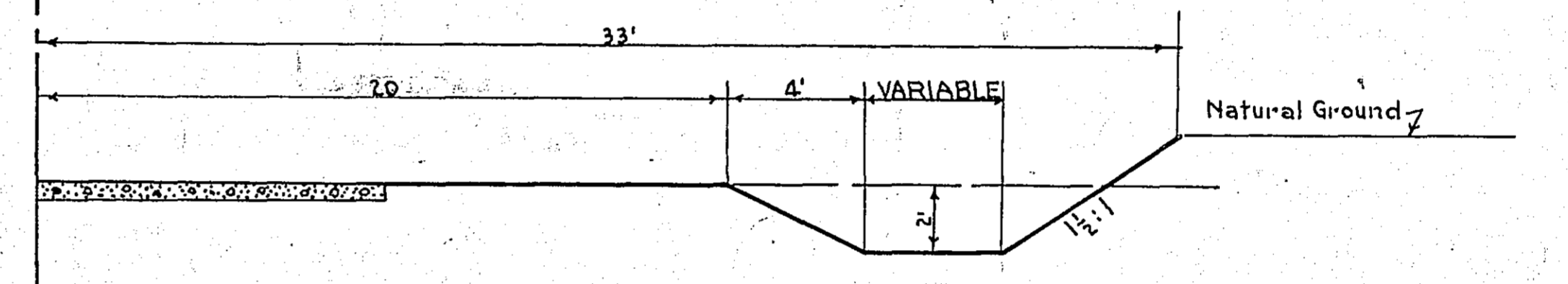

SPECIAL SECTION
144+00 To 145+50 RT.
45+50 To 47+25 Rt. & Lt.
26+50 To 31+00 Lt.
177+00 To 190+50 Lt.

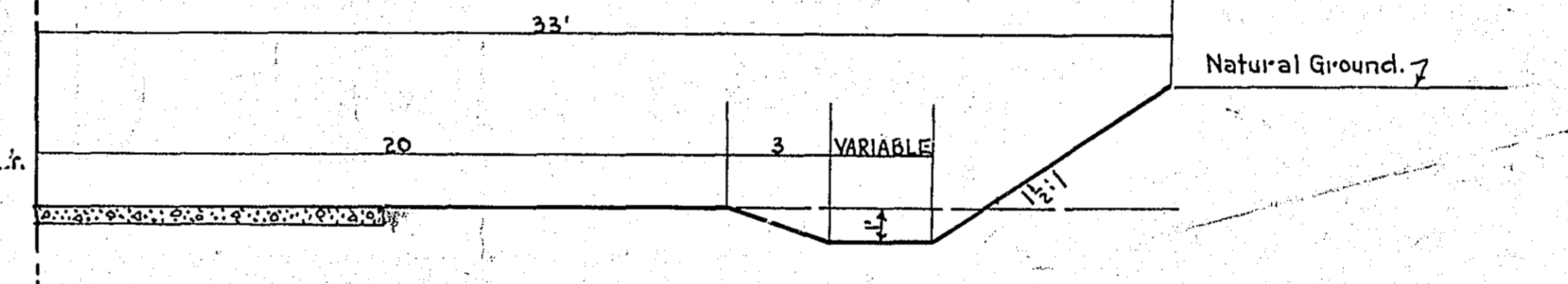

SPECIAL SECTION
0+00 To 13+00 Rt.

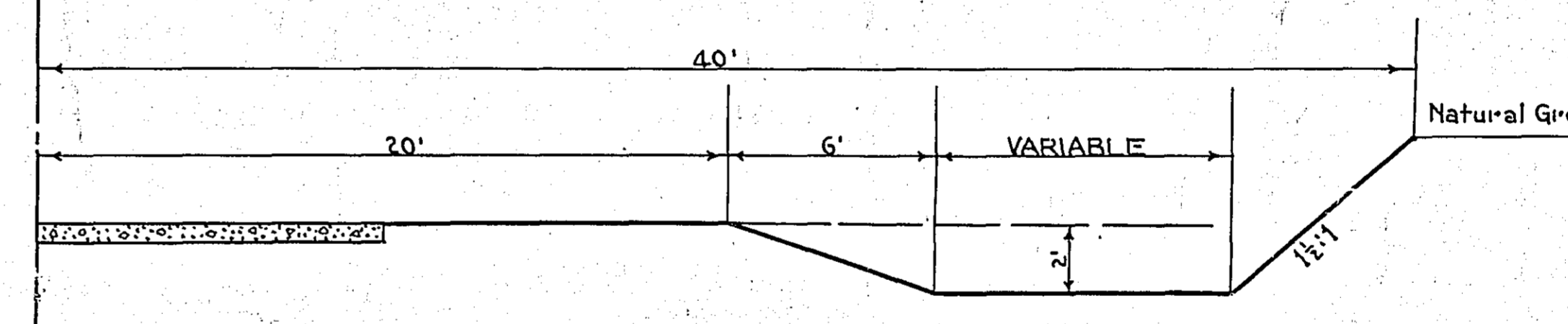

SPECIAL SECTION
164+70 To 168+00 Lt.

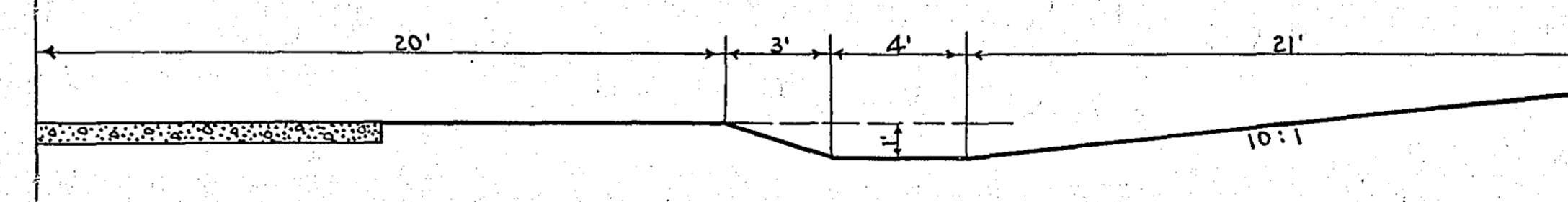

NOTE: NO DITCH ON LEFT
0+00 To 19+50

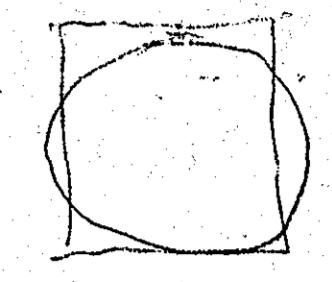

OFFICE OF
RAMSEY COUNTY SURVEYOR
EMIL H. SCHULZ
GRADING PLAN
LARPENTEUR AVE.
FROM WEST CO. LINE TO DALE ST.

PLAN
 DRAWN BY
 CHECKED BY
 DATE

PROFILE
 DRAWN BY
 CHECKED BY
 DATE

CITY OF
 HENNEPIN
 RAMSEY

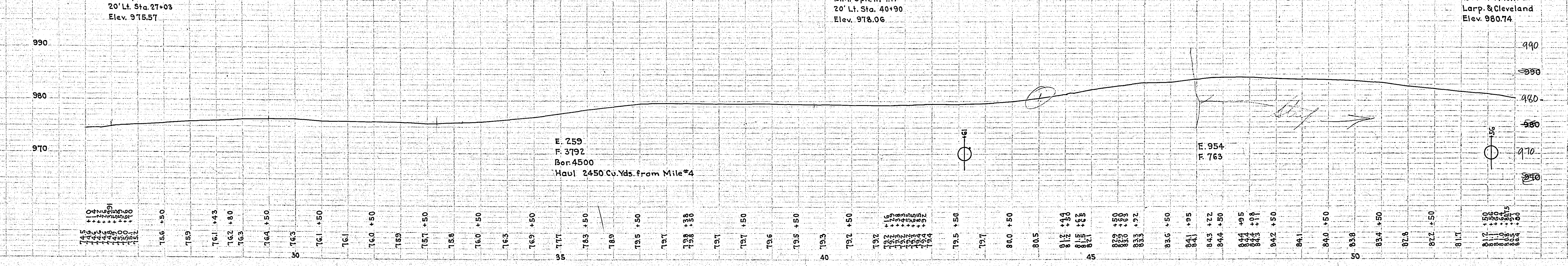
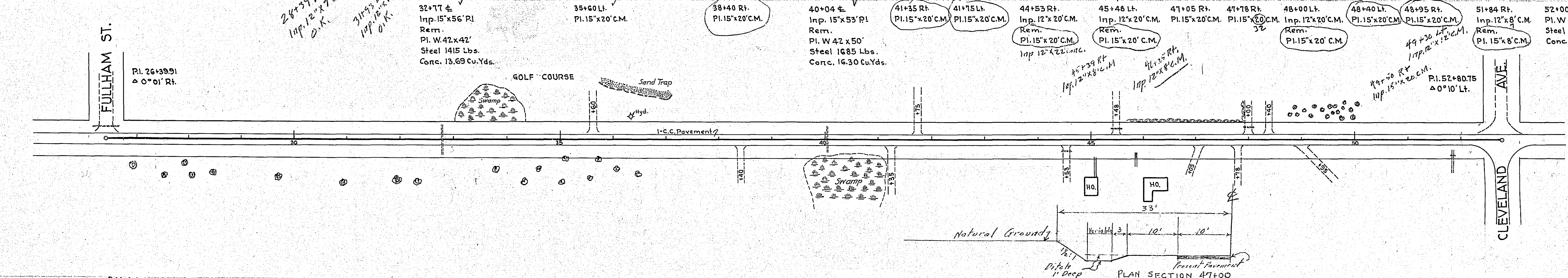
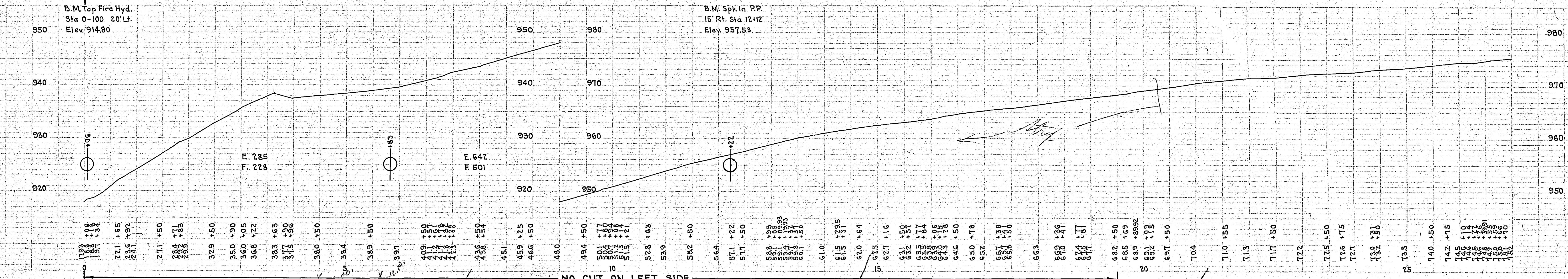

MILE - 1
 ESTIMATED QUANTITIES

Excav.	Cu.Yds.	2140
15' C.M.	Lin.Ft.	268
Monolithic Culv. Conc.	Cu.Yds.	57.27
	Steel Lbs.	5930
Borrow	Cu.Yds.	4500

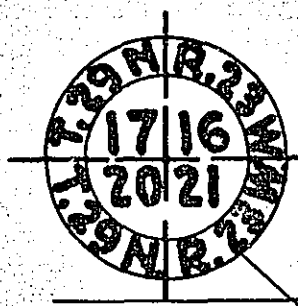

CLEVELAND AVE.

P.I. 52+80.75
Δ 0° 10' Lt.

59+46 E
Imp. 12' x 42' P.I.
Rem.
Pl. W 42 x 42'
Steel 1415 Lbs.
Conc. 13.69 Cu.Yds.

59+96 Lt.
P.I. 15' x 20' C.M.

62+53 Lt.
Imp. 12' x 20' C.M.
Rem.
P.I. 15' x 20' C.M.

64+60 Lt.
Imp. 12' x 32' C.M.
Rem.
P.I. 15' x 20' C.M.

68+48 Lt.
P.I. 15' x 20' C.M.

69+10 Lt.
Imp. 12' x 20' C.M.
Rem.
P.I. 15' x 20' C.M.

72+65 Lt.
Imp. 12' x 8' C.M.
Rem.
P.I. 15' x 8' C.M.

74+03 Lt.
Imp. 12' x 20' C.M.
Rem.
P.I. 15' x 20' C.M.

74+86 Rt.
Imp. 12' x 20' C.M.
Rem.
P.I. 15' x 20' C.M.

76+48 Lt.
Imp. 12' x 20' C.M.
Rem.
P.I. 15' x 20' C.M.

79+10 Lt.
Imp. 18' Conc. Culv.
O.K. Leave

P.I. 79+06.90
Δ 0° 05' Lt.

NEW BRIGHTON RD.

S 1/4 Cor. Sec. 16-29-23

B.M. Ctr. Mont.
Larp. & Cleveland
Elev. 980.74

B.M. Steel Spk. In T.P.
20' Lt. Sta. 64+15
Elev. 976.05

B.M. Top Bolt
At 1/4 Cor. Sta. 79+06.9
Elev. 966.48

OK
as is

shy

Special Ditch Lt. Only

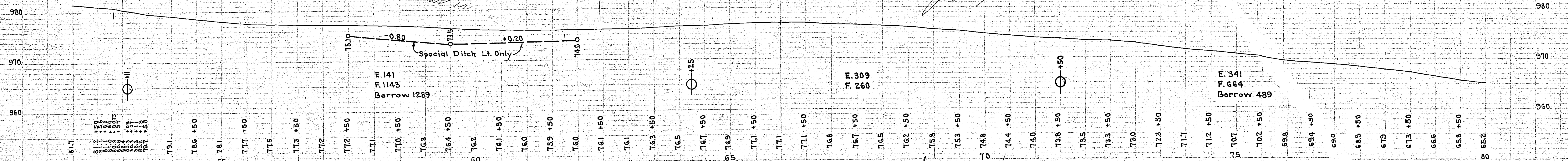

NEW BRIGHTON RD.

79+20 Rt.
Imp. 12' x 20' C.M.
Rem.
P.I. 15' x 20' C.M.
P.I. 79+06.90
Δ 0° 05' Lt.

81+50 E
Pl. W 42 x 42'
Steel 1415 Lbs.
Conc. 13.69 Cu.Yds.

81+70 Rt.
Imp. 12' x 20' C.M.

84+33 Rt.
Imp. 15' x 20' C.M.

85+33 Rt.
Imp. 15' x 20' C.M.

87+16 Rt.
Imp. 12' x 20' C.M.
Rem.
P.I. 15' x 20' C.M.

88+55 Rt.
Imp. 12' x 30' C.M.
Rem.
P.I. 15' x 20' C.M.

89+02 Rt.
Rem. & Rep.
Imp. 12' x 20' C.M.

89+84 Rt.
Imp. 12' x 20' C.M.
Rem.
P.I. 15' x 20' C.M.

91+87 Rt.
Imp. 12' x 20' C.M.
Rem.
P.I. 15' x 20' C.M.

94+25 Lt.
Imp. 12' x 16' Plank Brg.
Rem.
P.I. 15' x 20' C.M.

96+51 E
Imp. 12' x 44' P.I.
Rem.
Pl. W 42 x 42'
Steel 1415 Lbs.
Conc. 13.69 Cu.Yds.

96+76 Lt.
Imp. 12' x 20' C.M.
Rem.
P.I. 15' x 20' C.M.

98+48 Lt.
Imp. 12' x 20' C.M.
Rem.
P.I. 15' x 20' C.M.

99+96 Rt.
Imp. 12' x 20' C.M.
Rem.
P.I. 15' x 20' C.M.

100+07 Lt.
Imp. 12' x 20' C.M.
Rem.
P.I. 15' x 20' C.M.

108+08 E
Imp. 12' x 60' P.I. & C.M.
O.K. Leave

ST. MARY'S AVE.

SNELLING AVE.

P.I. 105+32.95
Δ 0° 18' Lt.

S.E. Cor. Sec. 16-29-23

B.M. N.E. Cor. Mont.
1/4 Cor. Sta. 92+20
Elev. 959.41

B.M. N.W. Cor. Mont.
Larp. & Snelling
Elev. 956.64

MILE - 2
ESTIMATED QUANTITIES

Excav.	Cu.Yds.	1880
Monolithic Concr.		4107
Steel	Lbs.	4245
15' C.M.	Lin.Ft.	408

LEFT SIDE
NOT TO BE
DISTURBED

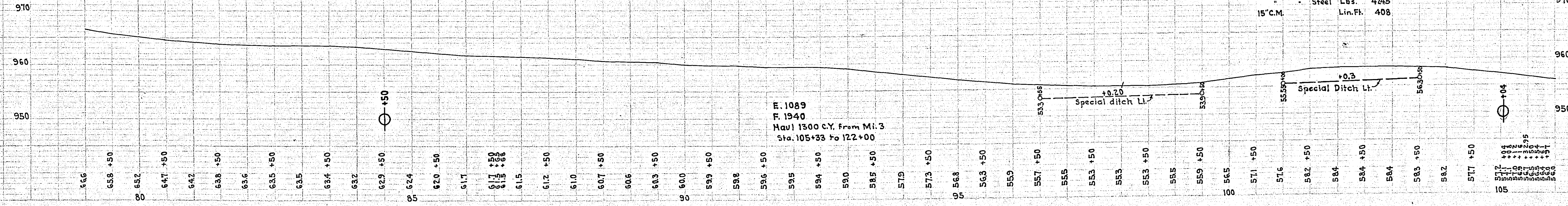

E. 1089
F. 1940
Haul 1300 C.Y. From Mi. 3
Sta. 105+33 to 122+00

Special ditch Lt.

Special Ditch Lt.

PLAN
EXPLAINED
NOTED
NO.

TABLE
NOTED
NO.

PLAN
 SHEET NO. 42
 DATE: 1910
 DRAWN BY: [Name]
 CHECKED BY: [Name]

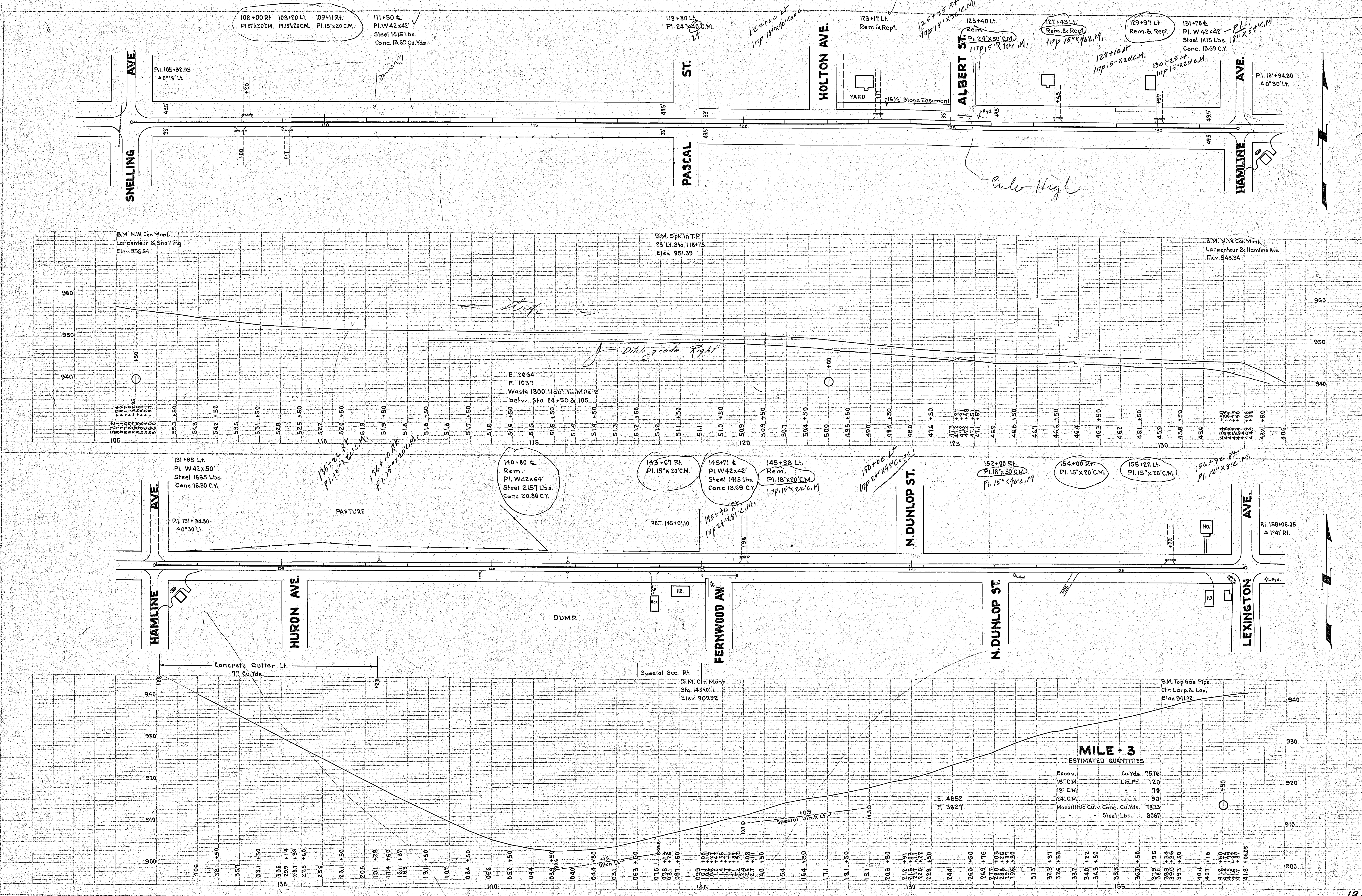

MILE - 3
ESTIMATED QUANTITIES

Excav.	Cu. Yds.	7516
15' C.M.	Lin. Ft.	120
18' C.M.		70
24' C.M.		90
Monolithic Culv. Conc.	Cu. Yds.	1823
	Steel Lbs.	8087

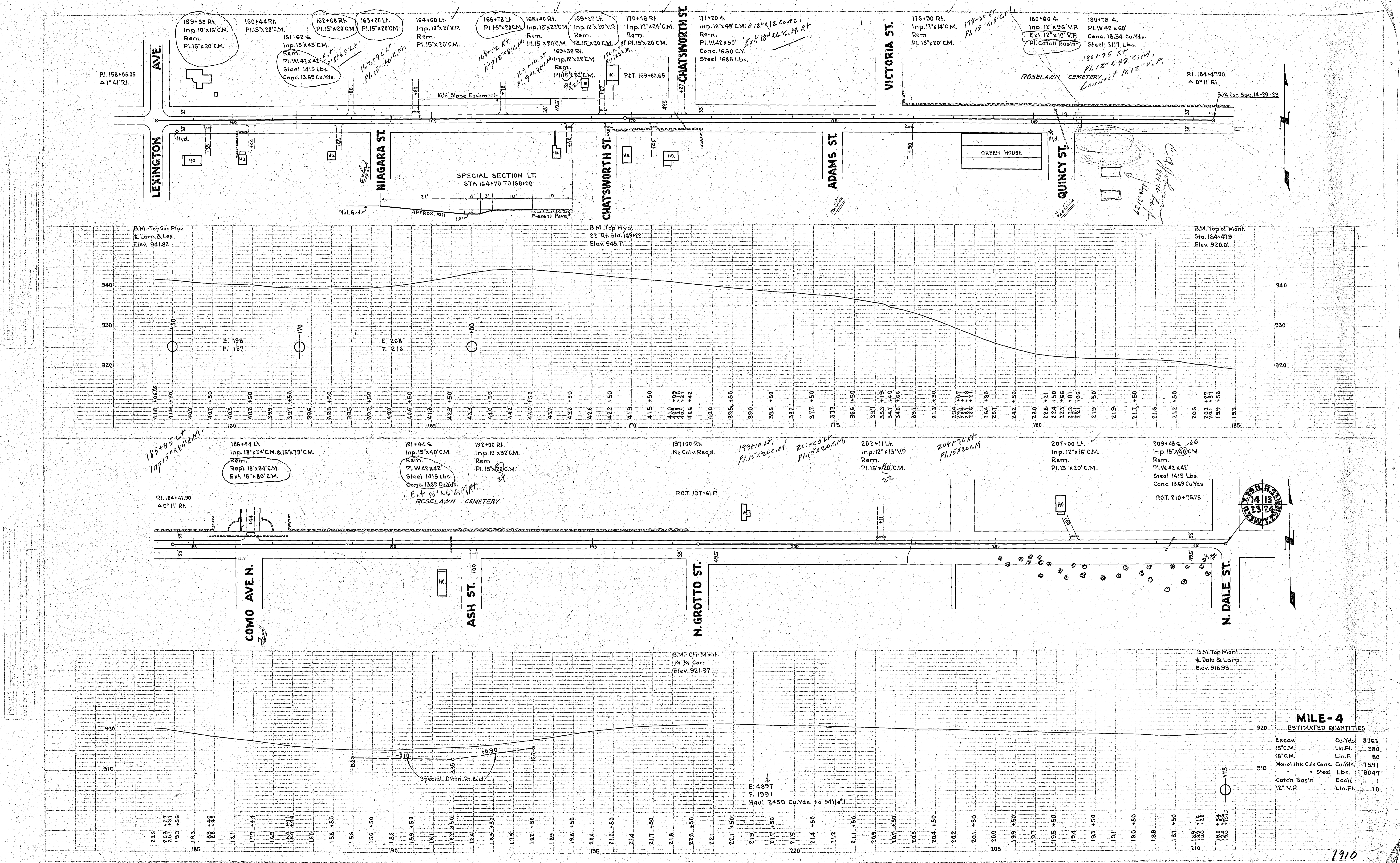

PLAN
 PROFILE
 NOTE: SEE SHEET 4 FOR DETAILS
 NOTE: SEE SHEET 5 FOR DETAILS
 NOTE: SEE SHEET 6 FOR DETAILS
 NOTE: SEE SHEET 7 FOR DETAILS
 NOTE: SEE SHEET 8 FOR DETAILS
 NOTE: SEE SHEET 9 FOR DETAILS
 NOTE: SEE SHEET 10 FOR DETAILS
 NOTE: SEE SHEET 11 FOR DETAILS
 NOTE: SEE SHEET 12 FOR DETAILS
 NOTE: SEE SHEET 13 FOR DETAILS
 NOTE: SEE SHEET 14 FOR DETAILS
 NOTE: SEE SHEET 15 FOR DETAILS
 NOTE: SEE SHEET 16 FOR DETAILS
 NOTE: SEE SHEET 17 FOR DETAILS
 NOTE: SEE SHEET 18 FOR DETAILS
 NOTE: SEE SHEET 19 FOR DETAILS
 NOTE: SEE SHEET 20 FOR DETAILS
 NOTE: SEE SHEET 21 FOR DETAILS
 NOTE: SEE SHEET 22 FOR DETAILS
 NOTE: SEE SHEET 23 FOR DETAILS
 NOTE: SEE SHEET 24 FOR DETAILS
 NOTE: SEE SHEET 25 FOR DETAILS
 NOTE: SEE SHEET 26 FOR DETAILS
 NOTE: SEE SHEET 27 FOR DETAILS
 NOTE: SEE SHEET 28 FOR DETAILS
 NOTE: SEE SHEET 29 FOR DETAILS
 NOTE: SEE SHEET 30 FOR DETAILS
 NOTE: SEE SHEET 31 FOR DETAILS
 NOTE: SEE SHEET 32 FOR DETAILS
 NOTE: SEE SHEET 33 FOR DETAILS
 NOTE: SEE SHEET 34 FOR DETAILS
 NOTE: SEE SHEET 35 FOR DETAILS
 NOTE: SEE SHEET 36 FOR DETAILS
 NOTE: SEE SHEET 37 FOR DETAILS
 NOTE: SEE SHEET 38 FOR DETAILS
 NOTE: SEE SHEET 39 FOR DETAILS
 NOTE: SEE SHEET 40 FOR DETAILS
 NOTE: SEE SHEET 41 FOR DETAILS
 NOTE: SEE SHEET 42 FOR DETAILS

MILE-4

ESTIMATED QUANTITIES		
Excav.	Cu.Yds.	3363
15" C.M.	Lin.Ft.	280
18" C.M.	Lin.Ft.	80
Monolithic Culk Conc.	Cu.Yds.	1591
Catch Basin	Each	1
12" V.P.	Lin.Ft.	10

1910