

PROFILE OF LOWEST ELEVATIONS OF OWASSO- JOSEPHINE CONNECTION

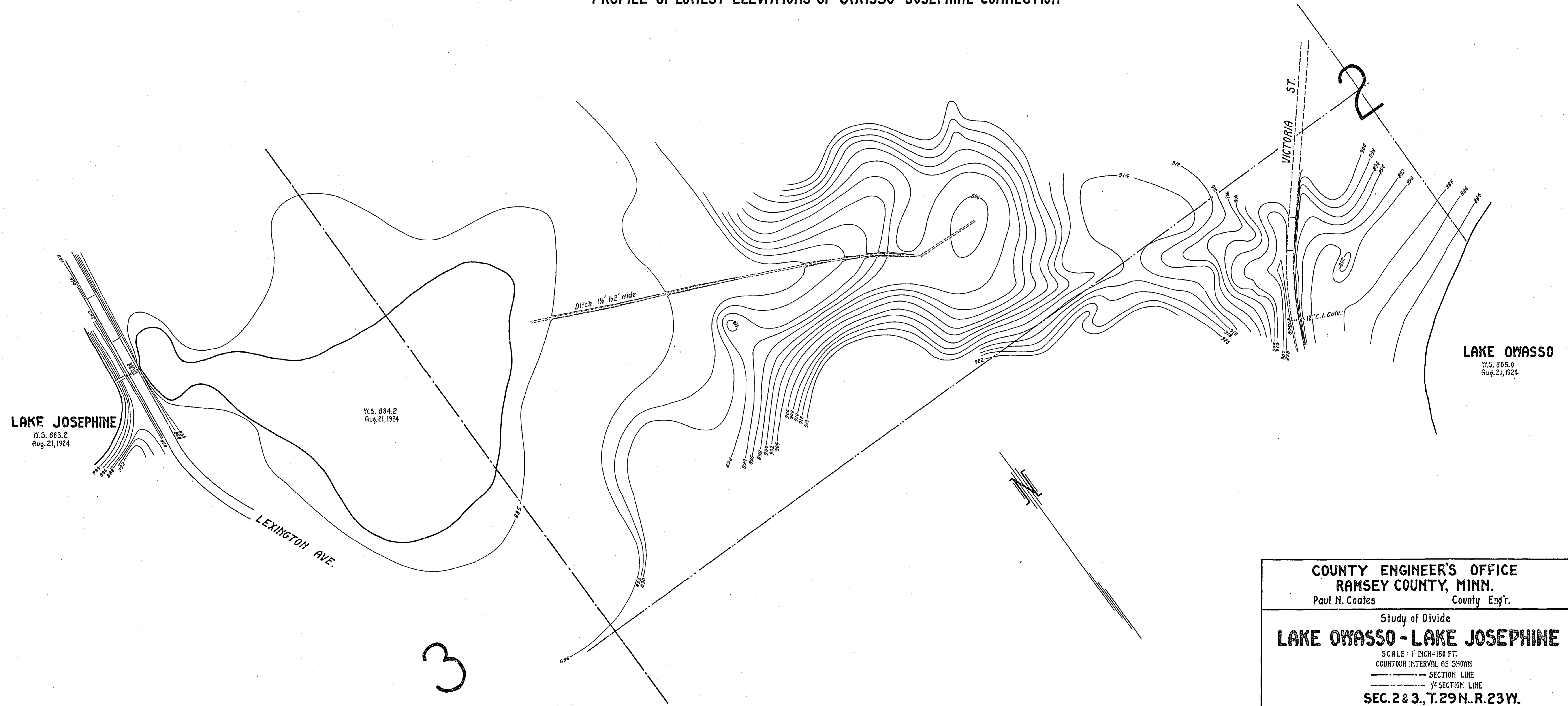

LAKE JOSEPHINE
W.S. 883.2
Aug. 21, 1924

W.S. 884.2
Aug. 21, 1924

LAKE OWASSO
W.S. 885.0
Aug. 21, 1924

COUNTY ENGINEER'S OFFICE RAMSEY COUNTY, MINN. Paul N. Coates County Engr.	
Study of Divide LAKE OWASSO - LAKE JOSEPHINE SCALE: 1" INCH = 150 FT. CONTOUR INTERVAL AS SHOWN --- SECTION LINE - - - - - 1/4 SECTION LINE SEC. 2 & 3, T. 29 N., R. 23 W. Date of Survey, Aug. 22, 1924	
Approved _____ Revised _____	FILED