

CONVENTIONAL SIGNS & ABBREVIATIONS

STATE LINE.....	EXCAVATION.....	E
COUNTY LINE.....	EMBANKMENT.....	F
TOWNSHIP LINE.....	OVERHAUL.....	H
SECTION LINE.....	SURFACING.....	S
CITY, VILLAGE, OR BOROUGH.....	GUARD RAIL.....	GR
FENCE LINE.....	INTERSECTION ANGLE.....	A
RIGHT-OF-WAY LINE.....	RADIUS.....	R
TRAVELLED WAY.....	ELEVATION.....	EL
RAILROADS.....	VERTICAL CURVE.....	VC
RETAINING WALL.....	BENCH MARK.....	B.M.
BASE OR SURVEY LINE.....	SECTIONAL CONCRETE CULVERT.....	P.1
LEVEE.....	CONJUGATED METAL CULVERT.....	C.M.
GRAVEL PIT.....	CULVERT HAUL.....	P.L.H.
SAND PIT.....	TON MILES.....	T.M.
CLAY PIT.....	PLACE.....	P
ROCK QUARRY.....	IN PLACE.....	INP
CULVERTS.....	REPLACE.....	Rep
PLAIN.....	RIGHT.....	R
WITH FACEWALLS.....	LEFT.....	L
WITH WINGWALLS.....	HAND DITCHING.....	H.D.
DROP INLET.....	POINT OF CURVE.....	P.C.
POWER POLE LINE.....	POINT OF TANGENT.....	P.T.
TELEPHONE OR TELEGRAPH LINE.....	POINT OF INTERSECTION.....	P.I.
MARSH.....	SPECIAL EXCAVATION.....	S.E.
HEDGE, BRUSH, OR TIMBER.....	SPECIAL FLOWING.....	S.P.
GROUND ELEVATION.....	TELEPHONE POLE.....	Tel.P.
GRADE ELEVATION.....		

OFFICE OF COUNTY SURVEYOR
 RAMSEY COUNTY
 Plan and Profile of County Project No. 48-1
 CLEANING COUNTY DITCH No 16
 From STA. 70+50 To STA. 109+00

GROSS LENGTH 3850 FEET 0.73 MILES
 LENGTH OF EXCEPTIONS 0 FEET 0 MILES
 NET LENGTH 3850 FEET 0.73 MILES
 PLAN, 1 Inch = 200 Feet
 PROFILE, Horz. 1 Inch = 200 Feet. Vert. 1 Inch = 10 Feet
 SCALES } WORKING PLANS { Horz. 1 Inch = 200 Feet
 Vert. 1 Inch = 10 Feet
 Cross-Sections, 1 Inch = 10 Feet

LAYOUT
 SCALE, 1 Inch = 2640 Feet

INDEX OF SHEETS
 Sheet No. 1. Title Sheet and Layout Map
 " No. 2. Plan and Profile, Sta. 70+50 to Sta. 109+00
 " No. 3 & 4. Cross Sections

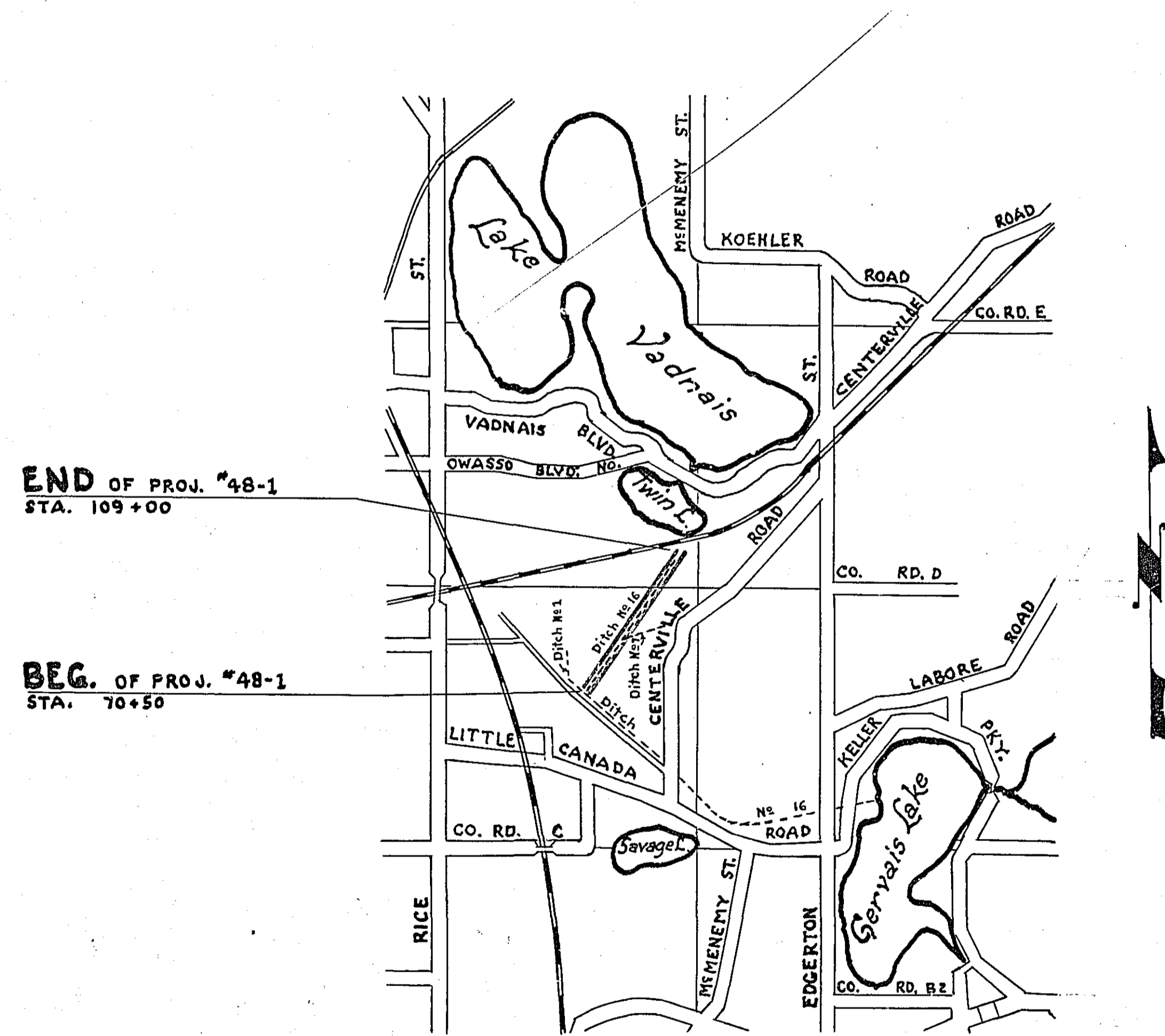

Recommended for Approval _____ ASSISTANT ENGINEER

Plans Approved and Recommended for Consideration _____ COUNTY SURVEYOR

Approved by County Board _____ 19 _____ CHAIRMAN OF COUNTY BOARD

106+18 to 106+44.6 ±
Inp. 42" x 26" C.M.
Remove, Clean & Relay

92+75.5 to 93+06 ±
Inp. 36" x 30" C.M.
Remove, Clean & Relay

90+27.5 to 90+68.2 ±
Inp. 36" x 40" C.M.
Remove, Clean & Relay

89+85 to 89+99 ±
Inp. 48" x 14" C.M.
Remove, Clean & Relay.

84+10.3 to 84+30.8 ±
Inp. 48" x 20" C.M.
Remove, Clean & Relay

PLAN SURVEYED
PLOTTED
NOTE BOV...
NO. 10

PLAN SURVEYED
PLOTTED
NOTE BOV...
NO. 10

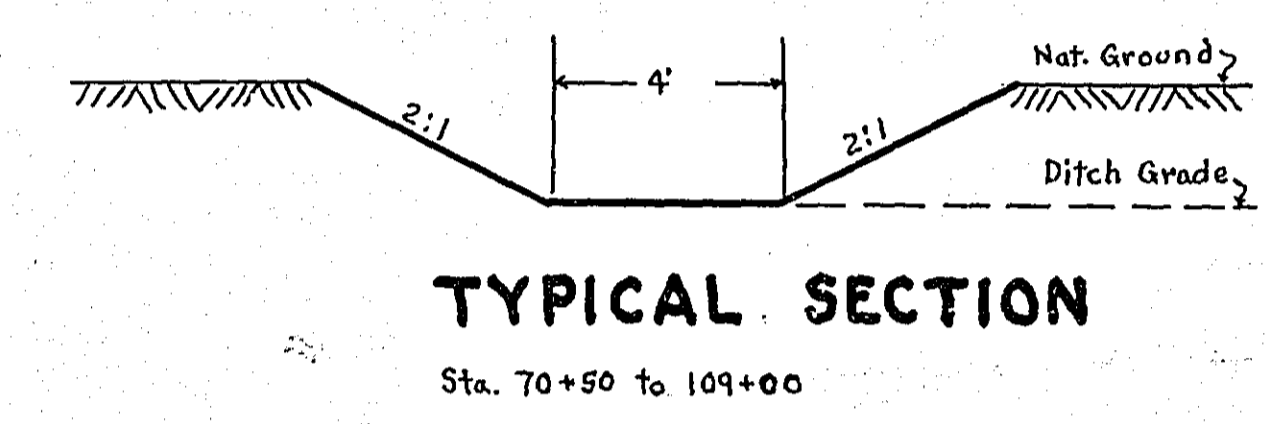
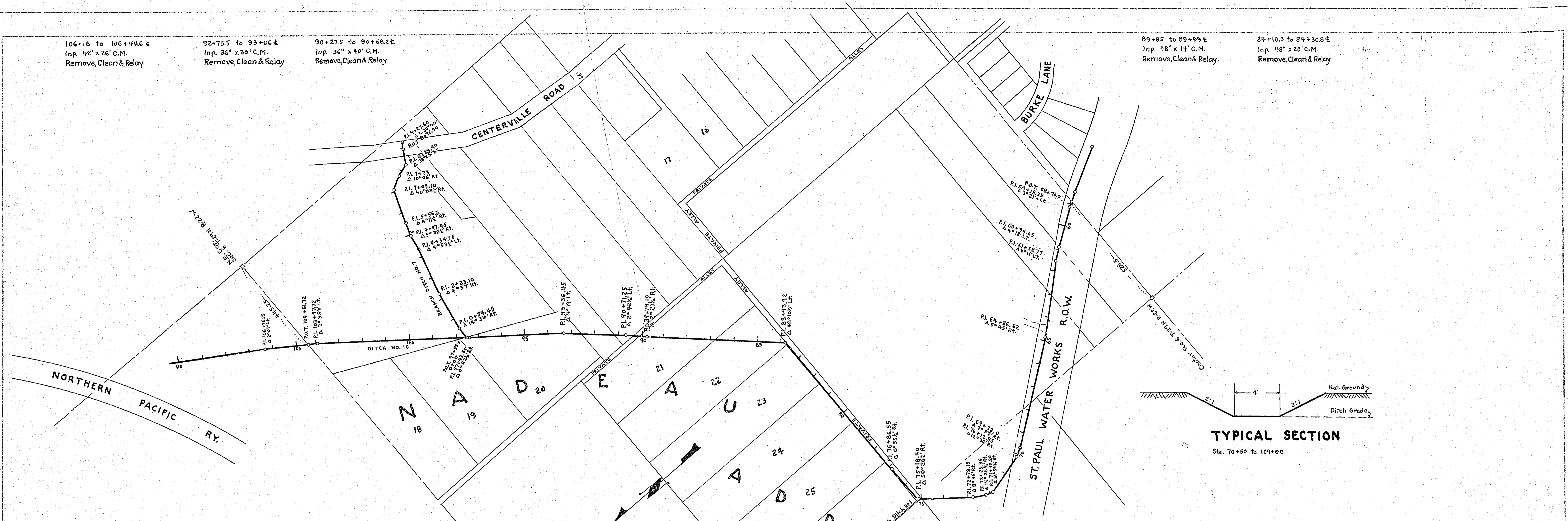

B.M. Top Breather Pipe
35' N.E. of High Line Tower
N.E. Cor. Int. Ditch 7 & Ditch 16
Elev. 882.54

B.M. R.R. Spk. in 24" Tw. Cotton
Lt. Sta. 84+57 at Branch Ditch
Elev. 877.70

B.M. Top & end of
48" C.M. Culv
At Sta. 84+10.3
Elev. 874.37

B.M. R.R. Spk. in 30" Cottonwood
Rt. Sta. 75+50
Elev. 876.20

ESTIMATED QUANTITIES

Clearing Trees	Trees	30
Grubbing Trees	"	41
Ditch Excavation	Cu. Yds.	3744
Remove Portable Culverts	Lin. Ft.	70
Install Corrugated Metal Culverts 36"	"	26
" " " " 42"	"	26
" " " " 48"	"	34

