

PLANS SURVEY

SILVER LAKE ROAD

ALONG SOUTH SIDE OF SILVER LAKE
From W. County Line to Fairchild Ave.

RAMSEY COUNTY PROJ 27-100

Road a/c N^o 100

File N^o 12

Office of Ramsey Co. Engineer
ST. PAUL, MINN.

1/5/27

12

SILVER LAKE ROAD

SOUTH SIDE OF SILVER LAKE
FROM WEST COUNTY LINE TO FAIRCHILD AVE.

ROAD No 100

PROJECT 27-100

INDEX

Alignment	STA. 0+00 - 24+89.12	P. 1-4
Topography	" "	P. 5-9
± Elevations	" "	P. 10-13
Cross-sections	" "	P. 14-19

Approved 1-17-27
City Engineer

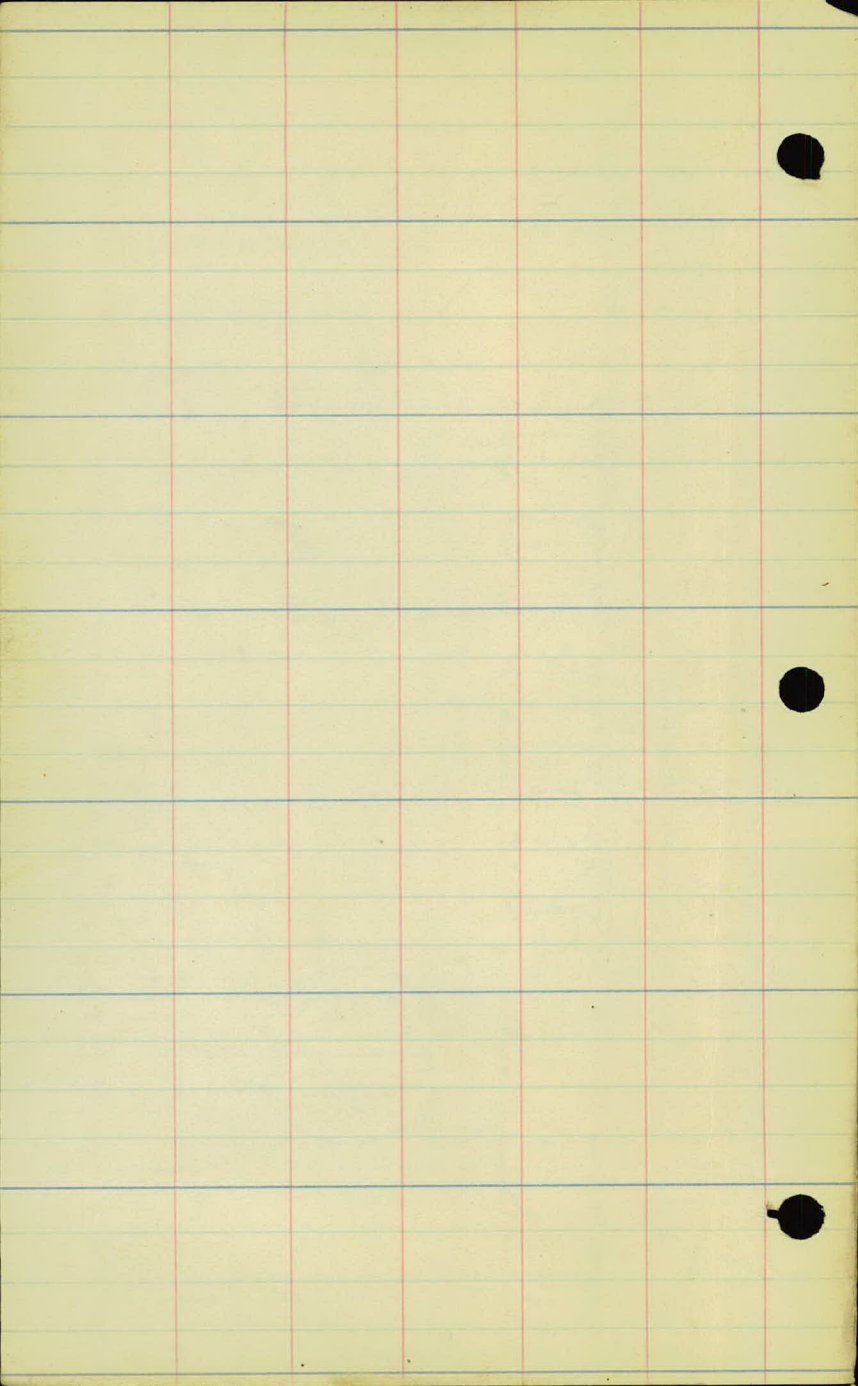

SOUTH SILVER LAKE ROAD

①

PROJ. 27-100

FROM W. COUNTY LINE TO FAIRCHILD AVE.

STA. PT. LT. RT. BEAR.

N48°37'E

13+66.63 ✓ P.T. 9°-20' 12°C
 Δ 18°-40' L
 13+50 8°-20' ~~P.I. 12+92.95~~
 13+00 5°-20' T. 78.621 ✓
 12+50 2°-20' L. 155.56 ✓
 12+11.070 ✓ P.C. 0°-00' R. 478.34 ✓

N67°17'E

7+58.354 ✓ P.T. 11°-17' 10°C
 Δ 22°-34' L
 7+00 8°-22'
 +50 5°-52' P.I. 6+47.15
 6+00 3°-22' T. 114.463 ✓
 +50 0°-52' L. 225.667 ✓
 5+32.687 ✓ P.C. 0°-00' R. 573.686 ✓

N89°51'E

0+00 BEGINNING OF PROJ. 27-100

T A.W. LINDAHL
 A.L. PERSONS
 W.G. ALEXANDER
 E.T. SINCLAIR

JAN. 8, 1926

(2)

12+8969

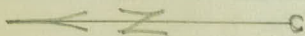
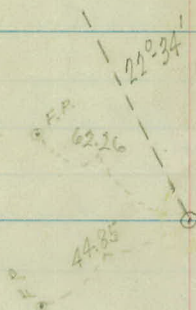
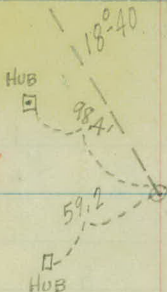

RAMSEY Co.

COUNTY LINE
 471.30

NDAKA Co.

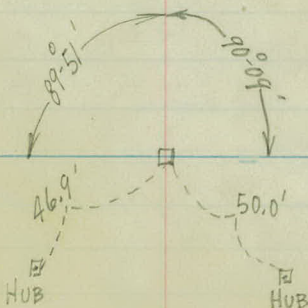

1828.55'

Co. Rd. "D"

STA. PT. LT. RT. BEAR.

N 89° 37' E

21+59.942 ✓ P.T.		21°-43'	24° C
21+50		20°-31'	Δ 43°-26' R
21+00		19°-31'	P.I. 20+79.73
20+50		8°-31'	T. 95.782 ✓
20+00		2°-31'	L. 180.97 ✓
19+78.972 ✓ P.C.		0°-00'	R. 240.485 ✓

N 46° 11' E

			2° C
			Δ 2°-26' L
16+91.015 ✓ P.T.	1°-13'		P.I. 16+35.14
16+50	0°-48'		T. 60.851 ✓
16+00	0°-18'		L. 121.667 ✓
15+69.348 ✓ P.C.	0°-00'		R. 2864.93 ✓

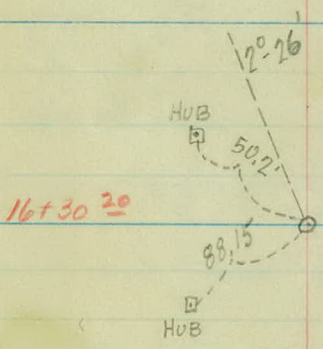
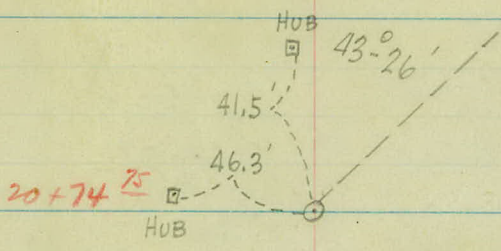

STA.

PT.

LT.

RT.

BEAR.

24+89.12^v END PROJECT

FAIRCHILD AVE.

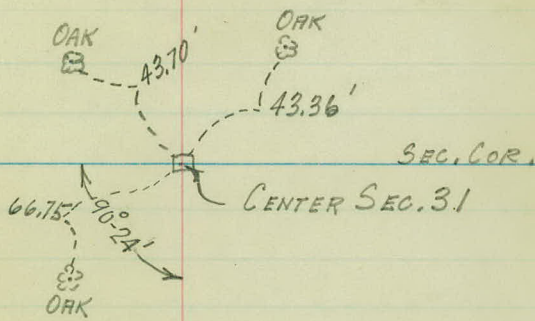

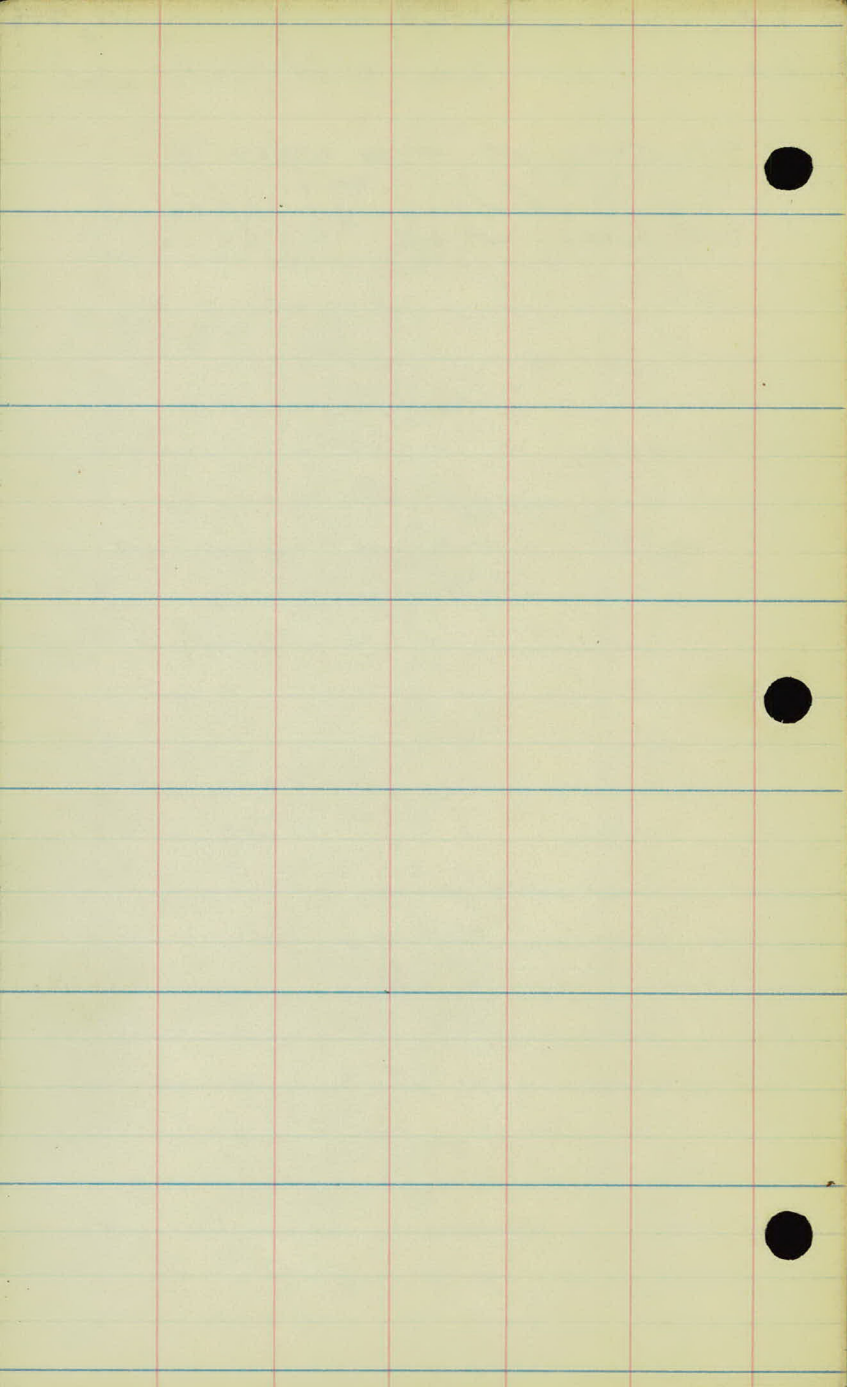

PROJECT 27-100
TOPOGRAPHY

5+00

4+00

+16 $\frac{1}{2}$ FARM ENT. LT.

3+00

+16 $\frac{1}{2}$ FARM ENT. LT.

2+00

1+00

0+00

+50 F.L. 26.7'

+38 F.L. 25'

F.L. 19'

PASTURE

HAY MEADOW

F.L. 16'

+26 F.C. 16'

+06 F.C. 25'

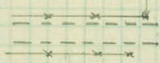

+37 Row TREES 25'

10" C.M. 22' lg. (old)

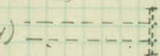

YARD

YARD

12+00

+40 10" C.M. 24' Lg. (New)

11+00

10+00

9+00

8+00

7+00

6+00

HAY MEADOW



+46.5 F.C. 6'

+00 F.L. 2'

+72 F.L. 0.0'

+50 F.L. 0.0'

+00 F.L. 9'

+58.3 F.L. 17.6'

+00 F.L. 25.8

+50 F.L. 29'

+00 F.L. 28'

PASTURE

HAY MEADOW

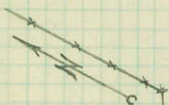

19+00

18+00

+54 10" C.M. 30' Lg. (New)

17+00

16+00

15+00

14+00

13+00

HAY MEADOW

HAY MEADOW



24+89.12 ϕ FAIRCHILD AVE.
+73.41 15" C.M. 40' LG.

24+00

23+00

22+00

21+00

20+00

+72.4 T.P. 20'



HAY MEADOW

HAY MEADOW

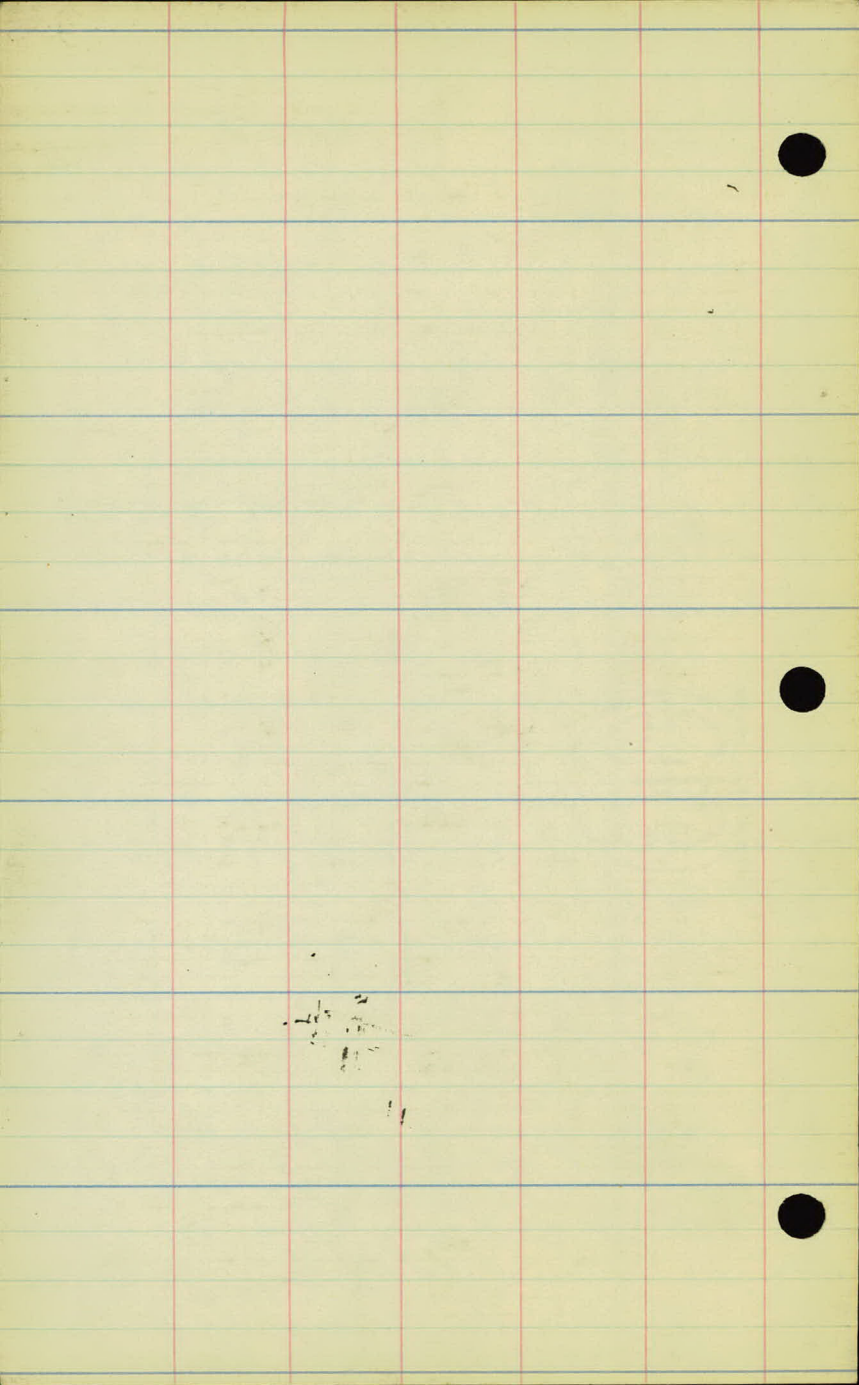

SILVER LAKE ROAD

South Side of Silver Lake

From West Collins to Fairchild Ave.

ROAD # 100

PROJ 27-100

INDEX

Alignment	Sta. 0+00 - 2+48.37	P. 2 - P. 4
Topography	" "	P. 5 - P. 9
Elevs	" "	P. 10 - P. 13
Cross Sections	" "	P. 14 - P. 19
Drainage	" "	P. 20 - P. 22

December 1936

Office of Plans & Engineering
ST. PAUL, MINN.

1-5-37
12

Recd. 12/31-26
T.D. [unclear]

Date Filed
File No.

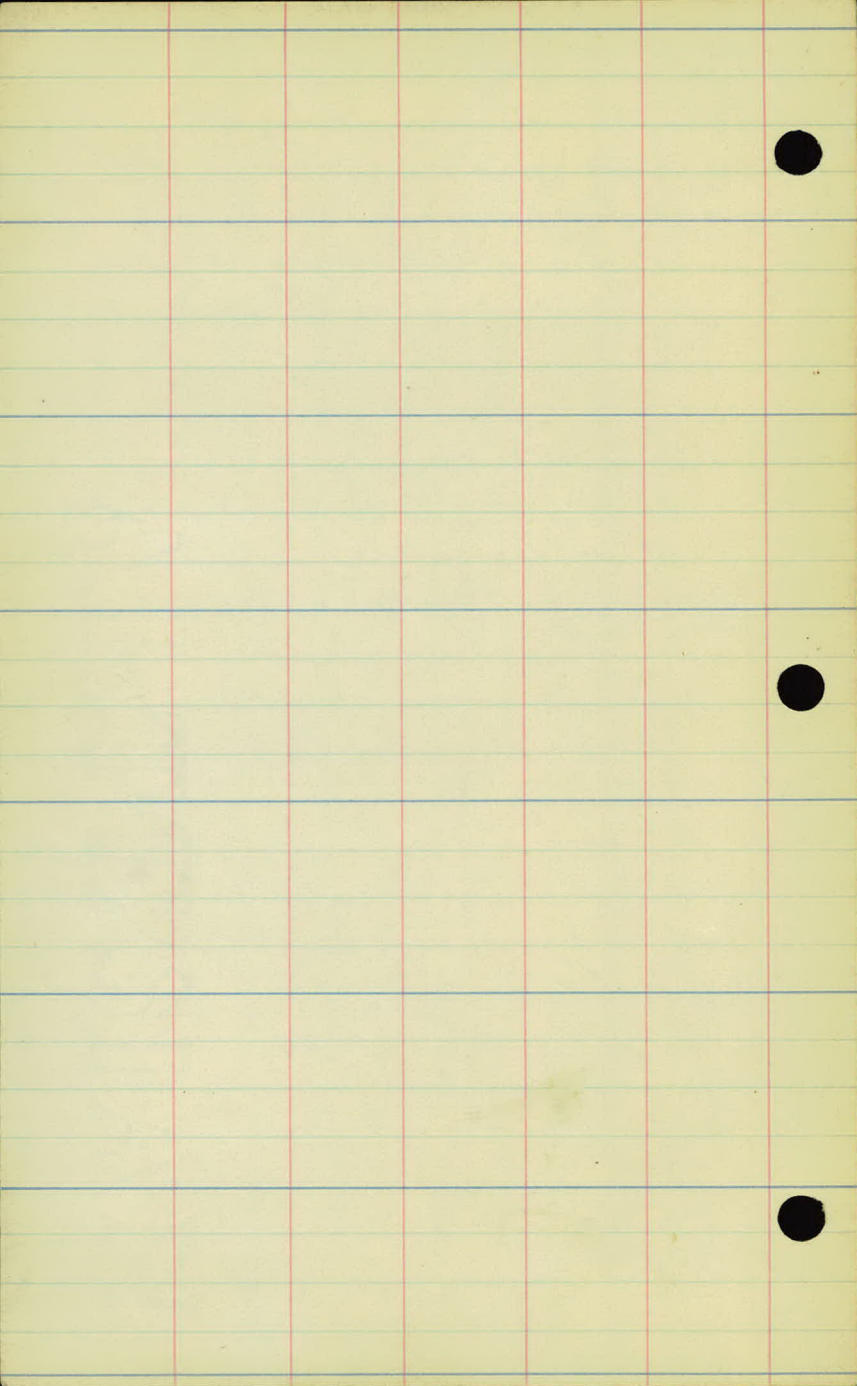

Alignment.

Station Point Lt. A Pt. Bear.

N. 63° 35' E.

8494.97 ✓ P.T. 8° 20' 14° C. Lt.
 8450 5° 11.1' Δ 16° 40'
 8400 1° 41.1' P.I. 8436.03
 7475.93 ✓ P.C. 0° 00' T. 60.10 ✓
 L. 119.04 ✓
 P. 410.28 ✓

N. 80° 15' E.

5493.24 ✓ P.T. 4° 48' 6° C. Lt.
 5450 32° 30.2' Δ 9° 36'
 5 2° 00.2' P.I. 5413.45
 450 0° 30.2' T. 80.21 ✓
 4433.24 ✓ P.C. 0° 00' L. 166° 00' ✓
 P. 955.37 ✓

N. 89° 31' E.

0400 Beg.

W.H. Carlson
A.L. Peterson
W.G. Alexander
E.T. Sinclair

Dec. 27, 1926

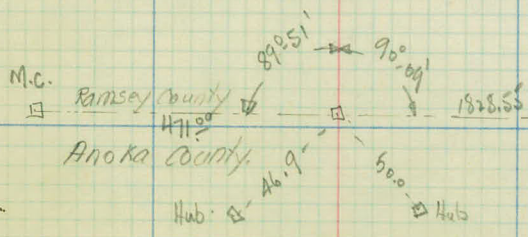
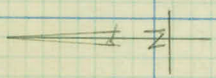
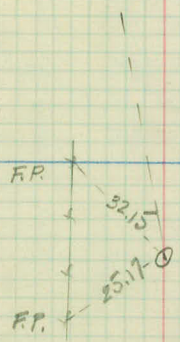
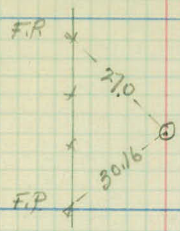

--- Co. Road "D"

Station	Point	Lt. Δ	Rt.	Bear.
---------	-------	--------------	-----	-------

24+83.71	End.			
----------	------	--	--	--

N. 89° 44' E.

21+99.24 ✓	P.T.		21° 45'	
------------	------	--	---------	--

+50

17° 48.6'

16° - C. Rt.

21

13° 48.6'

Δ 43° 30'

+50

9° 48.6'

P.J. 20+70.7

20

5° 48.6'

T. 143.33 ✓

+50

1° 48.6'

L. 271.87 ✓

19+27.37 ✓	P.C.		0° 00'	R. 359.26 ✓
------------	------	--	--------	-------------

N. 46° 14' E.

14+97.15 ✓	P.T.		8° 40.5'	
------------	------	--	----------	--

+50

7° 15.6'

6° - C. Lt.

14

5° 45.6'

Δ 17° 21'

+50

4° 15.6'

P.J. 13+53.75

13

2° 45.6'

T. 145.77 ✓

12+50

1° 15.6'

L. 289.17 ✓

12+07.98 ✓	P.C.		0° 00'	R. 955.37 ✓
------------	------	--	--------	-------------

N. 63° 25' E.

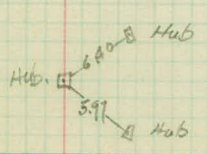
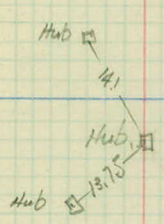
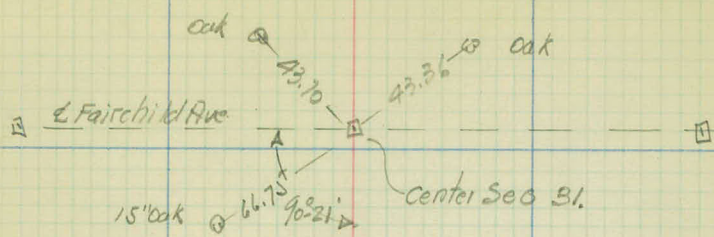

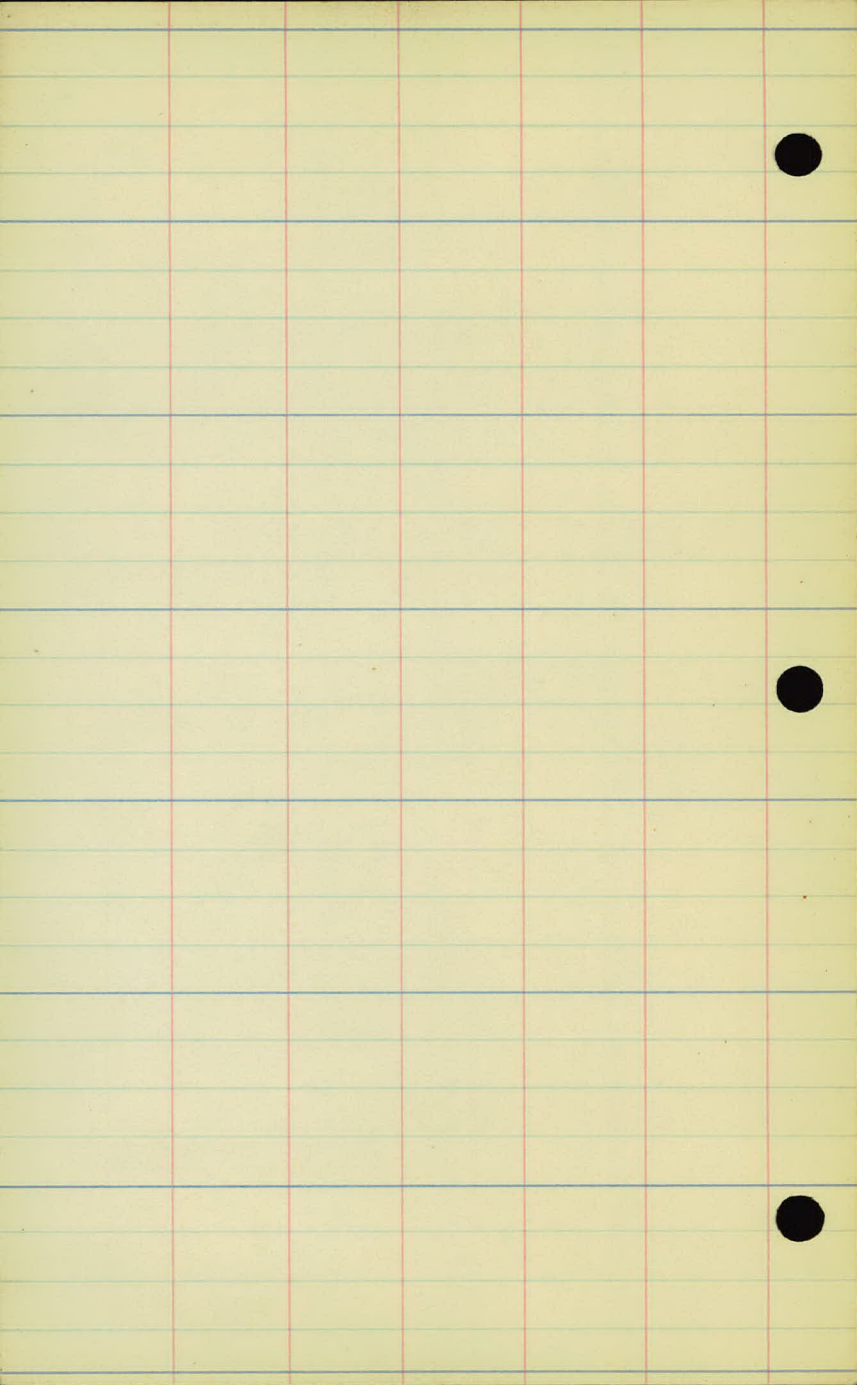

Topography

Station

5+00

4+00

+ 16 - F. Ent Lt.

3+00

+ 16 $\frac{1}{2}$ Farm Ent Lt.

2+00

1+00

0+00

F-17'

F-19'

Pasture

My Meadow

F-16'

+16 - F. Cor. 16
+06 - F. Line 73

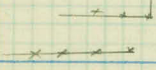

+37 - Row 160 25'

10" x 22' CM
(old)



Station

12

+40

10" x 24' cM. (new)

11

10

9400

8400

7400

6400

Meadow



Meadow

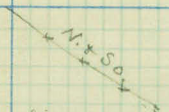

+48 - F. Cor. 21'

F-19'

+50 - F. 17'

F-21'

F-19'

Pasture

+57

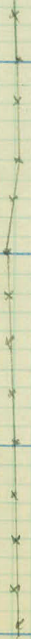

station

19

18

+56- 10' x 30' c.M. (flew)

17

16

15

14

13

To Lake



15.5

25

183.71 £Fairchild.

468 15" x 40' C.M.

24

23

22

21

20

+67 T.R.20'



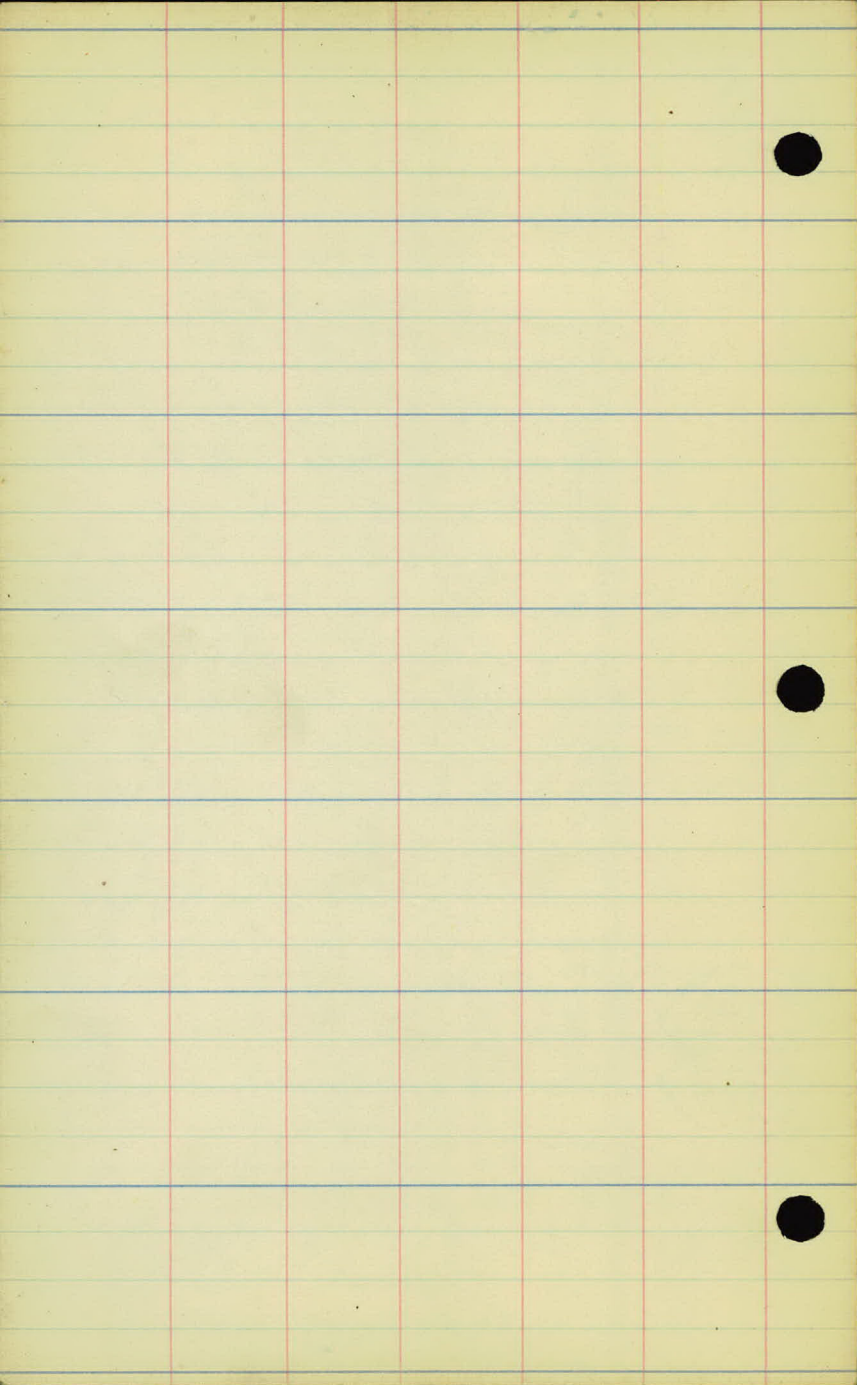

£ Levels.

Station + H.I - Elev.

Bench Levels.

B.M.	1.70	959.30		957.60
T.P.	7.03	964.46	1.87	957.43
✓	12.67	976.53	0.60	963.86
B.M.			4.80	971.73
✓	3.29	975.05		971.76
T.P.	2.91	970.39	7.57	967.48
✓	0.57	959.40	11.56	958.83
✓	2.08	956.21	5.27	954.13
✓	1.04	946.95	10.30	945.91
✓	3.83	944.57	6.21	940.74
B.M.	3.82	948. ²⁴ 26	0.15	944.42
T.P.	10.99	958. ³⁵ 37	0.88	947. ³⁶ 38
T.P.	10.74	968. ⁷⁷ 79	0.32	958. ⁰³ 05
B.M.	5.70	968. ²⁹ 31	5.68	963. ⁰⁹ 11
T.P.	2.05	961. ⁷⁹ 81	8.55	959. ⁷⁴ 76
B.M.	0.24	961. ⁷⁹ 81	0.24	961. ⁵⁵ 57

Levels

-0+10			15.2	46.6
0+00			12.9	48.9
0+30			12.0	49.8
1+00			7.6	54.2
1+50			4.7	57.1
2+00			3.6	58.2

R.R. spike 116 P. N.W. cor. Co Rd "D" & Fairchild

R.R. spike 10" Oak N.W. cor. Silver Lake Rd. & Fairchild

R.R. spike cor. F.P. 21' Lt. Sta. 9+48

Top S.W. cor. bottom Brick Stop House 125' Lt. Sta 1+50

0+00 = W. edge of Road N. & S.

Station	+	H.I	-	Elev.
3400		961.81 ⁷⁹	2.0	959.8.
+50			1.8	960.0.
4100			0.2	61.6.
T.P.	7.32	968.35 ³³	0.78	961.03 ⁰¹
+33.24			6.1	62.3 ²
5400			5.8	62.6 ⁵
+50			5.3	63.1 ⁰
6			5.2	63.2 ¹
7			4.8	63.6 ⁵
+75.93			4.3	64.7 ⁰
8			3.8	64.6 ⁵
+50			3.2	65.2 ¹
9			3.9	64.5 ⁴
B.M.	5.78	968.70 ⁸⁸	5.23	963.12 ¹⁰
10			6.9	63.0 ^{62.0}
11			7.2	61.7.
+40			9.0	59.6 ^{59.9}
+40			7.5	61.4.
12			6.3	62.6.
+50			5.0	63.9.
13			4.9	64.0.
+50			4.9	64.0.
14			4.8	64.1.
+50			4.9	64.0.
15			5.4	63.5.

Invert culv.

Station	+	H.I	-	Elev.
		968. ⁸⁸ ₉₀		
16			8.4	960.5.
T.P.	0.48	958. ⁴⁷ ₅₁	10.87	958. ⁰¹ ₀₃
+50			1.5	57.0.
17			5.1	53.4.
+56			11.6	46.9.
+56			6.4	52.1.
18			5.8	52.7.
19			4.9	53.6.
+27			5.1	52.4.
+50			5.4	53.1.
20			7.1	51.4.
+50			9.7	48.8.
21			10.7	47.8.
+50			11.9	46.6.
T.P.	1.60	947. ⁸⁹ ₉₄	12.20	946. ²⁹ ₃₄
22			2.8	45.1.
+50			4.4	43.5.
23			4.8	43.1.
24			5.0	42.9.
+83.71			6.10	941. ⁷⁹ ₈₄
B.M.			3.52	944. ³⁷ ₃₉

Invert Culv.

7.9- Inv. Culv. = 940.0

Top stone Mon. & Fairchild Ave.

R.R. Spike 10" oak NW. cor. Silver Lake Rd & Fairchild

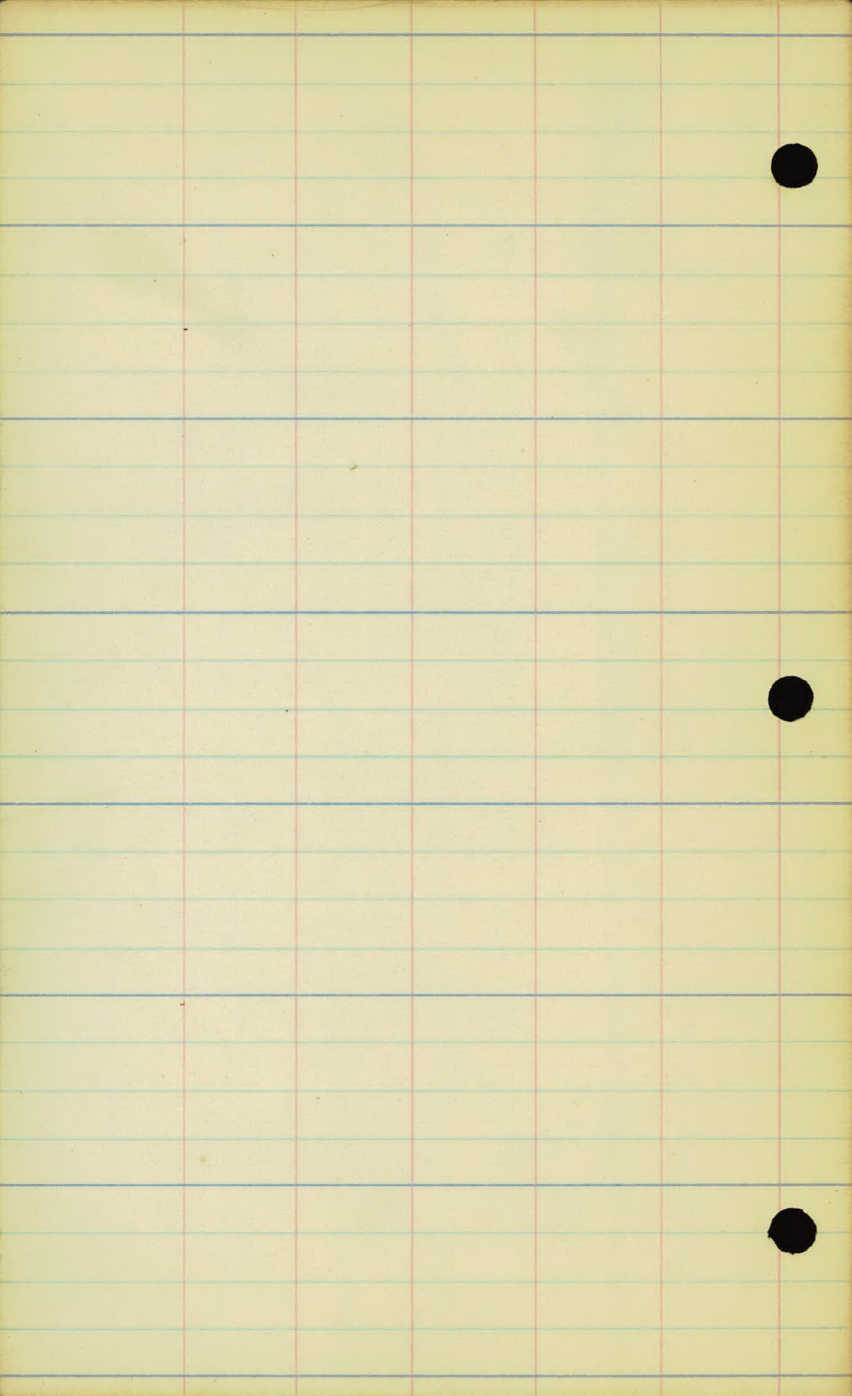

X-Sections.

station

Elev.

5+00

96.6⁵

4+33

62.3²

4+00

61.6

+50

60.0

3+00

59.8

+74

+13

59.5

2+00

58.2

+50

57.1

1+00

54.2

0+30

49.8

0+00

48.9

-0+10

46.6

L.

Z

X.

15

$$\begin{array}{cccc|cccc} -\frac{4.1}{33} & -\frac{3.2}{22} & -\frac{0.9}{9} & 46 & -\frac{0.8}{10} & -\frac{0.4}{13} & +\frac{1.8}{15} & +\frac{3.1}{33} \end{array}$$

$$\begin{array}{cccc|cccc} -\frac{2.6}{33} & -\frac{2.0}{21} & -\frac{0.4}{8} & 49 & -\frac{0.2}{11} & -\frac{0.6}{14} & +\frac{2.2}{17} & +\frac{3.3}{33} \end{array}$$

$$\begin{array}{cccc|cccc} -\frac{2.3}{33} & -\frac{1.6}{18} & -\frac{0.2}{7} & 55 & \frac{0.0}{11} & -\frac{0.7}{15} & +\frac{2.2}{18} & +\frac{3.4}{33} \end{array}$$

$$\begin{array}{cccc|cccc} -\frac{3.0}{33} & -\frac{1.6}{12} & -\frac{0.4}{6} & 71 & -\frac{0.2}{11} & -\frac{0.1}{15} & +\frac{0.7}{23} & +\frac{2.5}{33} \end{array}$$

$$\begin{array}{cccc|cccc} -\frac{1.8}{33} & -\frac{0.8}{12} & -\frac{0.2}{6} & 71 & -\frac{0.1}{9} & -\frac{0.4}{13} & +\frac{2.1}{16} & +\frac{2.8}{33} \end{array}$$

$$\begin{array}{cccc|cccc} -\frac{2.3}{33} & -\frac{1.5}{18} & -\frac{0.9}{12} & -\frac{0.2}{6} & 77 & \frac{0.0}{9} & -\frac{0.8}{13} & +\frac{2.0}{17} & +\frac{5.1}{33} \end{array}$$

$$\begin{array}{cccc|cccc} -\frac{1.7}{33} & -\frac{1.9}{16} & -\frac{1.0}{11} & -\frac{0.1}{6} & 90 & \frac{0.0}{8} & -\frac{0.8}{12} & -\frac{0.1}{15} & +\frac{2.0}{23} & +\frac{2.4}{33} \end{array}$$

$$\begin{array}{cccc|cccc} -\frac{1.4}{33} & -\frac{2.0}{19} & -\frac{2.7}{17} & -\frac{2.0}{14} & -\frac{0.2}{6} & 33 & -\frac{0.1}{9} & -\frac{0.3}{13} & +\frac{3.8}{24} & +\frac{4.0}{33} \end{array}$$

$$\begin{array}{cccc|cccc} -\frac{0.1}{33} & -\frac{2.4}{17} & -\frac{2.0}{15} & -\frac{2.0}{13} & -\frac{0.2}{6} & 62 & -\frac{0.4}{10} & -\frac{1.1}{14} & -\frac{1.1}{16} & +\frac{2.1}{24} & +\frac{2.7}{33} \end{array}$$

$$\begin{array}{cccc|cccc} \frac{2.0}{33} & -\frac{0.4}{16} & -\frac{1.2}{12} & -\frac{1.0}{9} & -\frac{0.3}{6} & 106 & -\frac{0.4}{11} & -\frac{1.6}{16} & -\frac{2.3}{18} & -\frac{2.2}{19} & -\frac{1.5}{21} & -\frac{2.2}{33} \end{array}$$

$$\begin{array}{cccc|cccc} & & & & & 115 & & & & & & -\frac{1.3}{33} \end{array}$$

$$\begin{array}{cccc|cccc} & & & & & 100 & & & & & & -\frac{2.2}{33} \end{array}$$

station

Elev.

11+00

961.7

+50

0.0

~~62.0~~
~~63.0~~

10+00

→

~~62.0~~
~~63.0~~

+50

-1.4

⁰
63.7

9+00

→

⁴
64.5

+50

¹
65.7

8

⁵
64.6

+50

+0.5

⁰
64.7

7+00

→

⁵
63.6

+50

+0.2

⁷
63.8

6+00

¹
63.7

5+00

⁰
63.7

Lt.

E

Rt.

16

$$\frac{-3.5}{33} \quad \frac{-2.1}{24} \quad \frac{-1.1}{18} \quad \frac{-0.2}{11}$$

85

$$\frac{-0.3}{8} \quad \frac{-0.9}{10} \quad \frac{-0.9}{12} \quad \frac{+2.8}{15} \quad \frac{+6.0}{33}$$

$$\frac{-3.4}{33} \quad \frac{-2.4}{23} \quad \frac{-0.3}{11}$$

82

$$\frac{-0.3}{6} \quad \frac{-0.7}{9} \quad \frac{-0.7}{9} \quad \frac{+2.2}{15} \quad \frac{+4.5}{33}$$

$$\frac{-2.0}{33} \quad \frac{-1.6}{16} \quad \frac{-0.5}{11}$$

82

$$\frac{-0.2}{6} \quad \frac{-0.8}{10} \quad \frac{-0.8}{12} \quad \frac{+0.2}{14} \quad \frac{+1.3}{33}$$

$$\frac{-0.9}{33} \quad \frac{-0.9}{14} \quad \frac{-0.3}{10}$$

73

$$\frac{-0.2}{8} \quad \frac{-0.9}{12} \quad \frac{-0.9}{14} \quad \frac{+0.2}{16} \quad \frac{0.0}{33}$$

$$\frac{0.0}{33} \quad \frac{-0.2}{22} \quad \frac{-0.4}{16} \quad \frac{-1.2}{13} \quad \frac{-0.4}{9}$$

59

$$\frac{0.0}{10} \quad \frac{-0.6}{13} \quad \frac{-0.9}{14} \quad \frac{+0.6}{11} \quad \frac{+0.9}{33}$$

$$\frac{-0.6}{33} \quad \frac{-0.3}{21} \quad \frac{+0.5}{13} \quad \frac{-0.5}{12} \quad \frac{-0.5}{7}$$

54

$$\frac{-0.1}{12} \quad \frac{-0.4}{18} \quad \frac{+1.1}{22} \quad \frac{+2.6}{33}$$

$$\frac{-4.3}{33} \quad \frac{-3.6}{24} \quad \frac{-0.2}{8}$$

53

$$\frac{0.0}{10} \quad \frac{-0.1}{15} \quad \frac{+0.2}{18} \quad \frac{+3.0}{33}$$

$$\frac{-5.2}{33} \quad \frac{-4.0}{24} \quad \frac{-0.6}{8}$$

13

$$\frac{-0.5}{11} \quad \frac{-0.3}{14} \quad \frac{+2.1}{16} \quad \frac{+6.4}{33}$$

$$\frac{-4.2}{33} \quad \frac{-3.6}{22} \quad \frac{-0.5}{7}$$

68

$$\frac{0.0}{10} \quad \frac{-0.6}{14} \quad \frac{+0.2}{26} \quad \frac{+5.0}{33}$$

$$\frac{-3.3}{33} \quad \frac{-2.6}{21} \quad \frac{-0.4}{6}$$

62

$$\frac{-0.4}{12} \quad \frac{0.0}{17} \quad \frac{+3.8}{19} \quad \frac{+7.0}{33}$$

$$\frac{-2.3}{33} \quad \frac{-1.8}{18} \quad \frac{-0.2}{5}$$

10

$$\frac{0.0}{12} \quad \frac{-0.8}{16} \quad \frac{+0.9}{18} \quad \frac{+3.6}{33}$$

$$\frac{-3.9}{33} \quad \frac{-2.8}{22} \quad \frac{-0.3}{7}$$

11

$$\frac{-0.1}{10} \quad \frac{-0.4}{13} \quad \frac{+1.5}{15} \quad \frac{+2.6}{33}$$

Station

Elev.

17 * 534.

+50 +3.7 57.1.

16 605.

+50 -1.1 62.4.

15 635.

+50 640.

14 641.

+50 640.

13 640.

+50 639.

12+00 62.6.

11+50 -1.1 61.5.

27.

28

29.

17

$$\frac{4.2}{33} \quad -\frac{3.6}{20} \quad -\frac{0.5}{8} \quad 57$$

$$-\frac{0.2}{6} \quad -\frac{3.0}{16} \quad -\frac{4.6}{33}$$

$$\frac{1.3}{33} \quad -\frac{0.2}{16} \quad -\frac{0.8}{14} \quad -\frac{1.1}{12} \quad -\frac{1.3}{7} \quad 10$$

$$-\frac{0.3}{8} \quad \frac{7.4}{12} \quad -\frac{1.4}{14} \quad -\frac{0.5}{17} \quad \frac{0.0}{33}$$

$$\frac{0.6}{33} \quad +\frac{0.7}{16} \quad -\frac{0.4}{15} \quad -\frac{0.4}{11} \quad -\frac{0.3}{7} \quad 10.1$$

$$\frac{0.0}{9} \quad -\frac{1.0}{12} \quad -\frac{1.0}{14} \quad -\frac{1.7}{16} \quad -\frac{2.4}{33}$$

$$\frac{1.8}{33} \quad +\frac{0.2}{18} \quad -\frac{0.8}{15} \quad -\frac{0.8}{13} \quad -\frac{0.6}{9} \quad 8.2$$

$$\frac{0.0}{6} \quad -\frac{0.2}{9} \quad -\frac{0.2}{11} \quad +\frac{4.2}{17} \quad +\frac{4.6}{33}$$

$$-\frac{2.6}{33} \quad -\frac{0.1}{10} \quad 7.1$$

$$\frac{0.0}{6} \quad -\frac{0.3}{8} \quad +\frac{2.3}{12} \quad +\frac{5.1}{33}$$

$$-\frac{2.5}{33} \quad -\frac{1.6}{18} \quad \frac{0.0}{10} \quad 6.6$$

$$-\frac{0.3}{5} \quad -\frac{0.2}{7} \quad +\frac{0.4}{10} \quad +\frac{5.5}{33}$$

$$+\frac{0.6}{33} \quad -\frac{0.5}{15} \quad \frac{0.0}{8} \quad 6.5$$

$$\frac{0.0}{10} \quad -\frac{1.4}{11} \quad -\frac{1.4}{13} \quad +\frac{0.6}{15} \quad +\frac{3.8}{33}$$

$$-\frac{1.4}{33} \quad -\frac{1.4}{12} \quad -\frac{0.1}{5} \quad 6.6$$

$$\frac{0.0}{11} \quad -\frac{0.5}{13} \quad -\frac{0.5}{15} \quad +\frac{1.6}{16} \quad +\frac{5.3}{33}$$

$$-\frac{0.4}{33} \quad -\frac{1.1}{15} \quad -\frac{0.5}{6} \quad 6.7$$

$$+\frac{0.2}{11} \quad -\frac{0.1}{15} \quad +\frac{3.0}{20} \quad +\frac{6.4}{33}$$

$$-\frac{0.4}{33} \quad -\frac{1.7}{12} \quad -\frac{0.3}{5} \quad 6.7$$

$$-\frac{0.2}{11} \quad -\frac{0.5}{15} \quad +\frac{2.3}{19} \quad +\frac{4.8}{33}$$

$$-\frac{2.0}{33} \quad -\frac{2.0}{18} \quad -\frac{0.4}{8} \quad 7.6$$

$$-\frac{0.4}{11} \quad -\frac{0.6}{14} \quad -\frac{0.6}{16} \quad +\frac{3.0}{19} \quad +\frac{5.8}{33}$$

$$-\frac{3.7}{12} \quad -\frac{3.1}{19} \quad -\frac{0.4}{9} \quad 8.7$$

$$-\frac{0.7}{9} \quad -\frac{1.1}{12} \quad -\frac{1.1}{14} \quad +\frac{0.7}{16} \quad +\frac{5.1}{33}$$

station

Elev.

73 43.1

+50 +0.6 43.5

22 45.1

+50 46.6

21+00 47.8

+50 48.8

20+00 51.4

+50 53.1

19+00 53.6

+50 -0.2 53.4

18+00 52.7

17+56 52.1

$$\begin{array}{r} -7.4 \\ 33 \end{array} \quad \begin{array}{r} -5.8 \\ 20 \end{array} \quad \begin{array}{r} -1.3 \\ 11 \end{array} \quad \begin{array}{r} -0.4 \\ 6 \end{array}$$

60

$$\begin{array}{r} 0.0 \\ 10 \end{array} \quad \begin{array}{r} -0.4 \\ 14 \end{array} \quad \begin{array}{r} +1.3 \\ 19 \end{array} \quad \begin{array}{r} +3.2 \\ 33 \end{array}$$

$$\begin{array}{r} -7.1 \\ 33 \end{array} \quad \begin{array}{r} -4.8 \\ 19 \end{array} \quad \begin{array}{r} -1.1 \\ 12 \end{array} \quad \begin{array}{r} -0.4 \\ 7 \end{array}$$

54

$$\begin{array}{r} 0.0 \\ 8 \end{array} \quad \begin{array}{r} -0.2 \\ 12 \end{array} \quad \begin{array}{r} -0.2 \\ 14 \end{array} \quad \begin{array}{r} +2.2 \\ 17 \end{array} \quad \begin{array}{r} +5.0 \\ 33 \end{array}$$

X

$$\begin{array}{r} -5.1 \\ 33 \end{array} \quad \begin{array}{r} -2.1 \\ 18 \end{array} \quad \begin{array}{r} -0.9 \\ 11 \end{array} \quad \begin{array}{r} -0.3 \\ 7 \end{array}$$

91

$$\begin{array}{r} 0.0 \\ 8 \end{array} \quad \begin{array}{r} -0.2 \\ 12 \end{array} \quad \begin{array}{r} -0.2 \\ 14 \end{array} \quad \begin{array}{r} +3.3 \\ 18 \end{array} \quad \begin{array}{r} +5.4 \\ 33 \end{array}$$

$$\begin{array}{r} -4.1 \\ 33 \end{array} \quad \begin{array}{r} -3.6 \\ 21 \end{array} \quad \begin{array}{r} -0.5 \\ 14 \end{array} \quad \begin{array}{r} 0.0 \\ 6 \end{array}$$

77

$$\begin{array}{r} 0.0 \\ 8 \end{array} \quad \begin{array}{r} -0.4 \\ 12 \end{array} \quad \begin{array}{r} -0.4 \\ 14 \end{array} \quad \begin{array}{r} +3.1 \\ 17 \end{array} \quad \begin{array}{r} +4.8 \\ 33 \end{array}$$

$$\begin{array}{r} -5.2 \\ 33 \end{array} \quad \begin{array}{r} -3.7 \\ 24 \end{array} \quad \begin{array}{r} -1.2 \\ 15 \end{array} \quad \begin{array}{r} -0.1 \\ 6 \end{array}$$

65

$$\begin{array}{r} 0.0 \\ 8 \end{array} \quad \begin{array}{r} -0.7 \\ 12 \end{array} \quad \begin{array}{r} -0.7 \\ 14 \end{array} \quad \begin{array}{r} +2.3 \\ 16 \end{array} \quad \begin{array}{r} +4.0 \\ 33 \end{array}$$

100

$$\begin{array}{r} -7.3 \\ 33 \end{array} \quad \begin{array}{r} -5.8 \\ 24 \end{array} \quad \begin{array}{r} -0.9 \\ 14 \end{array} \quad \begin{array}{r} -0.1 \\ 8 \end{array}$$

99

$$\begin{array}{r} 0.0 \\ 7 \end{array} \quad \begin{array}{r} -0.2 \\ 15 \end{array} \quad \begin{array}{r} +2.6 \\ 18 \end{array} \quad \begin{array}{r} +3.4 \\ 33 \end{array}$$

$$\begin{array}{r} -2.4 \\ 33 \end{array} \quad \begin{array}{r} -0.3 \\ 19 \end{array} \quad \begin{array}{r} -0.8 \\ 17 \end{array} \quad \begin{array}{r} -0.4 \\ 14 \end{array} \quad \begin{array}{r} +0.2 \\ 9 \end{array}$$

7

$$\begin{array}{r} -0.5 \\ 7 \end{array} \quad \begin{array}{r} -0.5 \\ 12 \end{array} \quad \begin{array}{r} +2.2 \\ 14 \end{array} \quad \begin{array}{r} +2.3 \\ 33 \end{array}$$

$$\begin{array}{r} +0.4 \\ 33 \end{array} \quad \begin{array}{r} +0.8 \\ 20 \end{array} \quad \begin{array}{r} -0.6 \\ 17 \end{array} \quad \begin{array}{r} -0.3 \\ 13 \end{array} \quad \begin{array}{r} 0.0 \\ 7 \end{array}$$

56

$$\begin{array}{r} 0.0 \\ 8 \end{array} \quad \begin{array}{r} -0.5 \\ 12 \end{array} \quad \begin{array}{r} +2.2 \\ 15 \end{array} \quad \begin{array}{r} +2.5 \\ 33 \end{array}$$

$$\begin{array}{r} +0.2 \\ 33 \end{array} \quad \begin{array}{r} +1.6 \\ 18 \end{array} \quad \begin{array}{r} -0.8 \\ 12 \end{array} \quad \begin{array}{r} -0.1 \\ 6 \end{array}$$

51

$$\begin{array}{r} 0.0 \\ 8 \end{array} \quad \begin{array}{r} -0.9 \\ 12 \end{array} \quad \begin{array}{r} -0.9 \\ 14 \end{array} \quad \begin{array}{r} +2.1 \\ 17 \end{array} \quad \begin{array}{r} +2.5 \\ 33 \end{array}$$

$$\begin{array}{r} -0.3 \\ 33 \end{array} \quad \begin{array}{r} -0.4 \\ 16 \end{array} \quad \begin{array}{r} -1.2 \\ 14 \end{array} \quad \begin{array}{r} -1.2 \\ 12 \end{array} \quad \begin{array}{r} 0.0 \\ 6 \end{array}$$

50

$$\begin{array}{r} -0.2 \\ 8 \end{array} \quad \begin{array}{r} -1.2 \\ 13 \end{array} \quad \begin{array}{r} +0.2 \\ 15 \end{array} \quad \begin{array}{r} +0.5 \\ 33 \end{array}$$

$$\begin{array}{r} -2.2 \\ 33 \end{array} \quad \begin{array}{r} -2.4 \\ 16 \end{array} \quad \begin{array}{r} -0.4 \\ 8 \end{array}$$

41

$$\begin{array}{r} -0.2 \\ 8 \end{array} \quad \begin{array}{r} -2.6 \\ 14 \end{array} \quad \begin{array}{r} -2.3 \\ 33 \end{array}$$

$$\begin{array}{r} -4.8 \\ 33 \end{array} \quad \begin{array}{r} -5.1 \\ 15 \end{array} \quad \begin{array}{r} -0.5 \\ 7 \end{array}$$

66

$$\begin{array}{r} -0.6 \\ 8 \end{array} \quad \begin{array}{r} -4.8 \\ 16 \end{array} \quad \begin{array}{r} -4.1 \\ 33 \end{array}$$

Station

Elev.

123

Fairchild
94.8
79

+65

-1.0

419.

24+00

+0.0

429.

23+50

0.0

429.

4.

2

Pt.

19

$$\frac{+0.7}{50}$$

$$\frac{+0.5}{33}$$

73

$$\frac{-0.3}{33}$$

$$\frac{-0.8}{50}$$

$$\frac{+0.1}{33}$$

$$\frac{0.0}{18}$$

$$\frac{0.0}{16}$$

72

$$\frac{-0.3}{9}$$

$$\frac{-1.5}{20}$$

$$\frac{-2.1}{33}$$

$$\frac{-0.6}{33}$$

$$\frac{+0.9}{14}$$

$$\frac{-0.1}{11}$$

$$\frac{0.0}{9}$$

62

$$\frac{-0.2}{9}$$

$$\frac{-1.3}{14}$$

$$\frac{+0.5}{16}$$

$$\frac{-0.3}{33}$$

$$\frac{-4.6}{33}$$

$$\frac{-2.4}{18}$$

$$\frac{-1.0}{11}$$

$$\frac{-0.5}{5}$$

62

$$\frac{0.0}{10}$$

$$\frac{-0.1}{15}$$

$$\frac{+2.0}{18}$$

$$\frac{+1.5}{33}$$

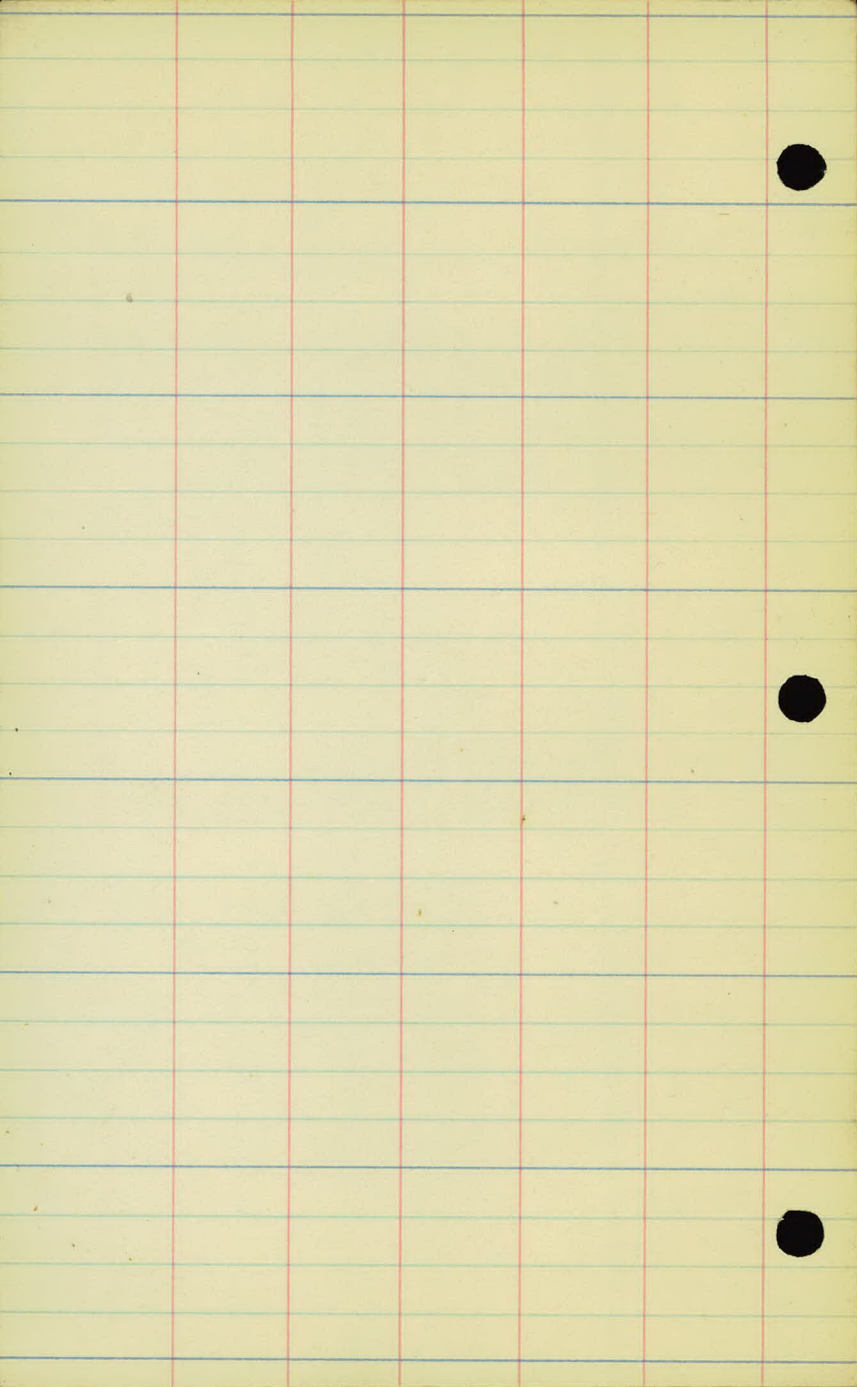

Drainage.

station Kind culv.

11+40 10" X 24' C.M.
Extends 9' Rt & 15' Lt.

17+56 10" X 30' C.M.
Extends 15' Rt. & 14.5' Lt.

24+68 15" X 40' C.M.
Extends 18' Rt & 22' Lt.

Inv. Elev. 959.0
Drains Lt.

Inv. Elev. 946.9
Drains Lt.

Inv. Elev. 940.0
Drains Rt.

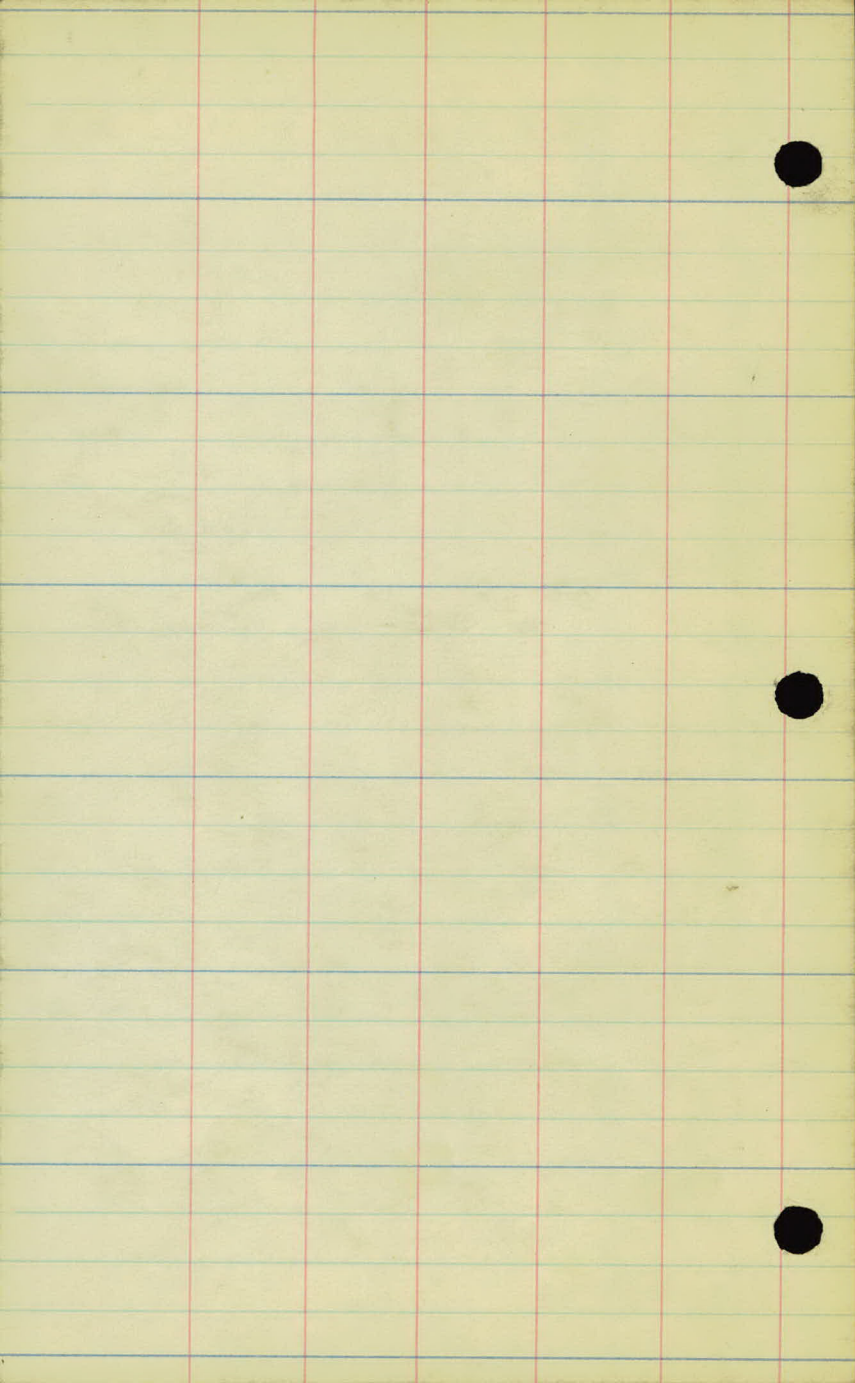

Alignment PI to PI
From Farchild Ave
To
West Co Line.

Office of Ramsey Co. Engineer
ST. PAUL, MINN.
Date Filed 6/23/26
10

Sta.	Point	Lt	Rt	Calc Bearing
------	-------	----	----	-----------------

16+66	P.I		16°-40'	
-------	-----	--	---------	--

11+47 ¹²	P.I		17°-21'	
---------------------	-----	--	---------	--

4+27 ⁸	P.I	43°-30'		
-------------------	-----	---------	--	--

0+00	Mont. E. Fairchild Ave.			
------	-------------------------	--	--	--

Soukup
 Skoglund
 Fritz
 Messenberg

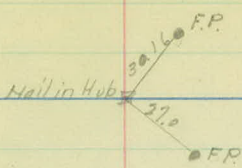

3rd Ex.

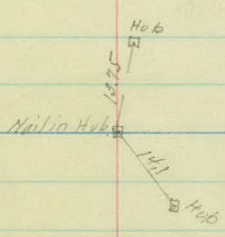
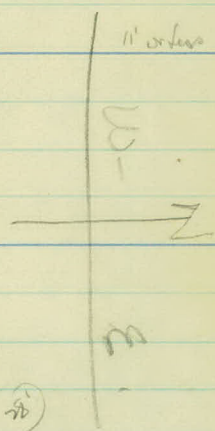
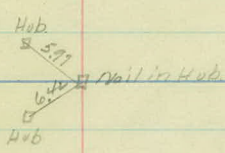

90° 21'

Mont Co Rd E.

center

sec. 31-30-23

43.4

43.7-83

Sta.	Point	Lt	Rt	Cote Bearing.
------	-------	----	----	------------------

25+02 ⁴⁵	End of Proj			
---------------------	-------------	--	--	--

23+50	P.O.T.			
-------	--------	--	--	--

19+89 ⁰⁰	PI.		92.36'	
---------------------	-----	--	--------	--

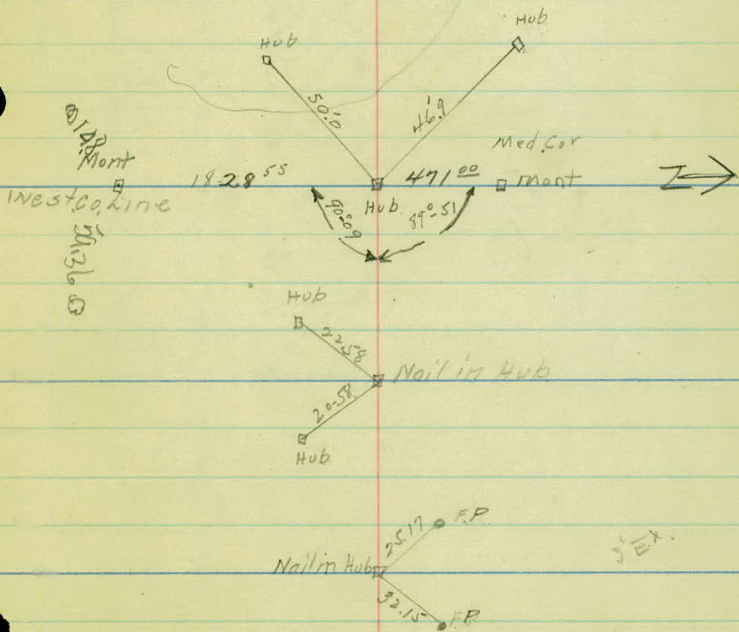

on D

D.C. Co. F. S.

-971.76 Spikes in G.P.

PROJ. 27-100

± ELEVATIONS

E ELEVATIONS

STATION	+	H.I.	-	ELEV
B.M.	1.61	963.16		961.55
0-10			16.5	946.66
0+00			14.2	948.96
0+30			13.2	949.96
1+00			9.0	954.16
1+50			6.2	956.96
2+00			5.0	958.16
2+50			4.3	958.86
3+00			3.5	959.66
3+50			3.1	960.06
4+00			1.5	961.66
T.P.	6.88	968.61	1.43	961.73
4+50			6.4	962.21
5+00			6.1	962.51
5+50			5.8	962.81
6+00			5.7	962.91
6+50			5.4	963.21
7+00			5.3	963.31
7+58.35			4.9	963.71
8+00			5.1	963.51
8+50			3.5	965.11
9+00			4.5	964.11
9+50			6.1	962.51
B.M.	5.57	968.65	5.53	963.08
10+00			6.8	961.85

TOP S.W. COR. BOTTOM BRICK STEP HO. 125' STA. 1+50

R.R. SPIKE COR. F.P. 21' LT. STA. 9+48

STA.	+	H.I.	-	ELEV.
10+50		968.65	6.6	962.05
11+00			7.0	961.65
11+50			7.2	961.45
12+00			6.1	962.55
12+50			4.7	963.95
13+00			4.6	964.05
13+50			4.6	964.05
14+00			4.5	964.15
14+50			4.6	964.05
15+00			5.2	963.45
T.P.	0.20	963.65	5.20	963.45
15+50			1.2	962.45
16+00			3.2	960.45
16+50			6.6	957.05
17+00			10.2	953.45
17+50			11.7	951.95
18+00			11.1	952.55
18+50			10.3	953.35
19+00			10.2	953.45
19+50			10.5	953.15
20+00			12.0	951.65
T.P.	0.35	951.35	12.65	951.00
20+50			2.6	948.75
21+00			3.7	947.65
21+50			4.6	946.75
22+00			6.0	945.35

STA.	+	H.I.			
22+50		951.35	7.5	943.85	•
23+00			8.3	943.05	•
23+50			8.4	942.95	•
24+00			8.3	943.05	•
24+50			9.1	942.25	•
24+89.12			9.50	941.85	•
B.M.			6.97	944.38	✓

R.R. SPIKE 10" OAK. N.W. COR. SILVER L. RD. & FAIRCHILD

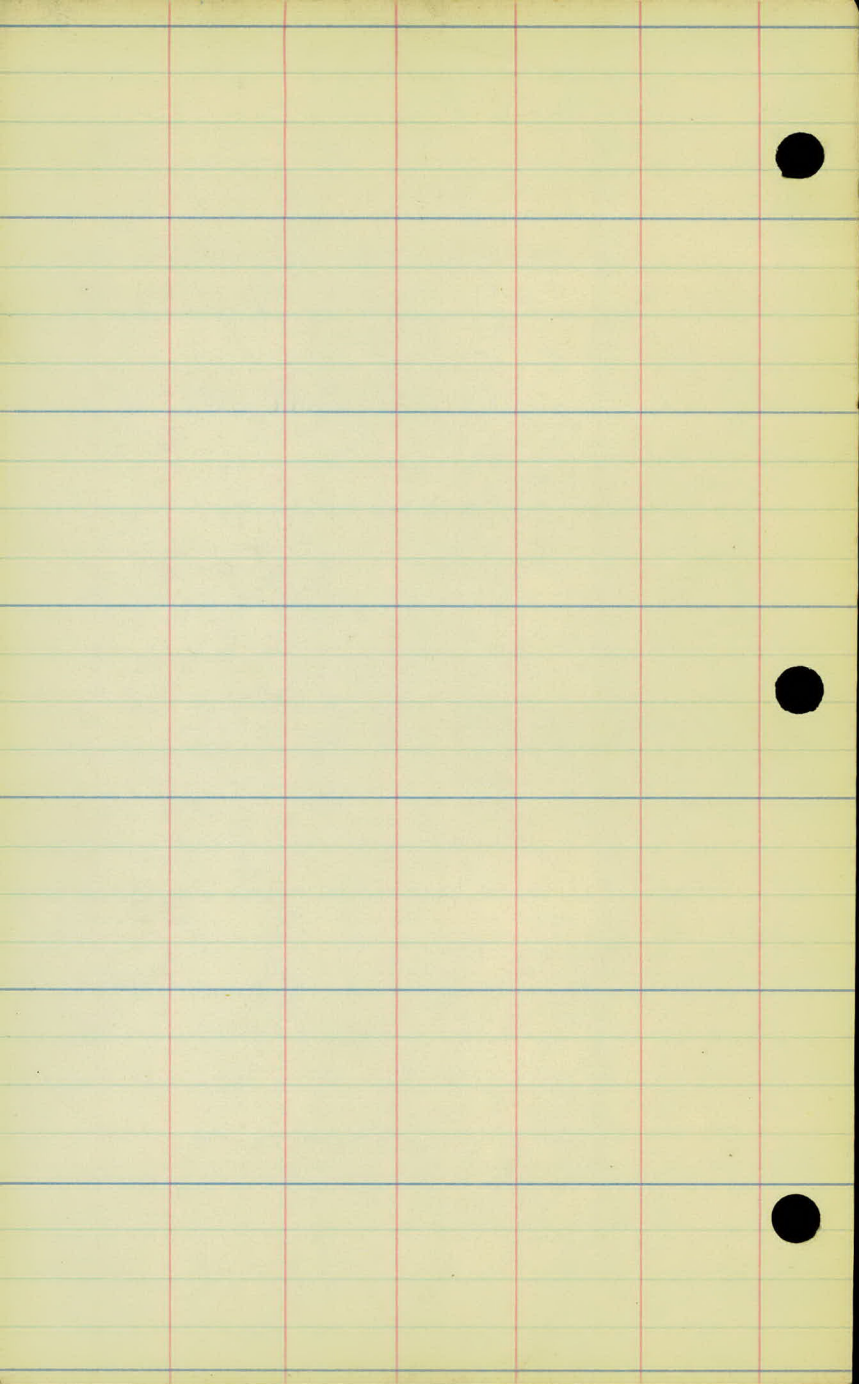

PROJECT 27-100
X-SECTIONS

ELEV.

5+50

962.81

5+00

962.51

4+33

962.26

4+00

961.66

3+50

960.06

3+00

959.66

2+50

958.86

2+00

958.16

1+50

956.96

1+00

954.16

0+30

949.96

0+00

948.96

0-10

946.66

L.T.

Z

R.T.

$$\frac{10.2}{33} \quad \frac{9.3}{25} \quad \frac{6.9}{13} \quad \frac{7.1}{5} \quad \frac{7.8}{5} \quad \frac{7.8}{7} \quad \frac{5.0}{9} \quad \frac{4.3}{16} \quad \frac{4.6}{33}$$

$$\frac{-4.1}{33} \quad \frac{-3.3}{23} \quad \frac{-0.9}{9} \quad \frac{4.6}{10} \quad \frac{-0.3}{13} \quad \frac{-0.4}{15} \quad \frac{+1.8}{15} \quad \frac{+3.1}{33}$$

$$\frac{-2.6}{33} \quad \frac{-3.0}{21} \quad \frac{-0.4}{8} \quad \frac{4.9}{11} \quad \frac{-0.2}{14} \quad \frac{-0.6}{17} \quad \frac{+2.2}{17} \quad \frac{+3.3}{33}$$

$$\frac{-3.3}{33} \quad \frac{-1.6}{18} \quad \frac{-0.2}{7} \quad \frac{5.5}{11} \quad \frac{0.0}{15} \quad \frac{-0.7}{18} \quad \frac{+2.3}{18} \quad \frac{+3.4}{33}$$

$$\frac{-3.0}{33} \quad \frac{-1.6}{12} \quad \frac{-0.4}{6} \quad \frac{7.1}{11} \quad \frac{-0.3}{15} \quad \frac{-0.1}{33} \quad \frac{+0.7}{33} \quad \frac{+2.5}{33}$$

$$\frac{-1.8}{33} \quad \frac{-0.8}{12} \quad \frac{-0.2}{6} \quad \frac{7.4}{9} \quad \frac{-0.1}{13} \quad \frac{-0.4}{16} \quad \frac{+2.1}{16} \quad \frac{+2.8}{33}$$

$$\frac{-3.3}{33} \quad \frac{-1.5}{18} \quad \frac{-0.9}{12} \quad \frac{-0.2}{6} \quad \frac{7.7}{9} \quad \frac{-0.8}{13} \quad \frac{-0.8}{17} \quad \frac{+3.0}{17} \quad \frac{+5.1}{33}$$

$$\frac{-1.7}{33} \quad \frac{-1.9}{16} \quad \frac{-1.0}{11} \quad \frac{-0.1}{6} \quad \frac{9.9}{8} \quad \frac{-0.0}{12} \quad \frac{-0.8}{15} \quad \frac{-0.1}{33} \quad \frac{+2.0}{33} \quad \frac{+3.4}{33}$$

$$\frac{-1.4}{33} \quad \frac{-2.0}{19} \quad \frac{-2.7}{17} \quad \frac{-2.0}{14} \quad \frac{-0.2}{6} \quad \frac{3.3}{9} \quad \frac{-0.1}{13} \quad \frac{-0.3}{13} \quad \frac{+3.8}{24} \quad \frac{+4.0}{33}$$

$$\frac{-0.1}{33} \quad \frac{-2.4}{17} \quad \frac{-2.0}{15} \quad \frac{-2.0}{19} \quad \frac{-0.2}{6} \quad \frac{6.2}{10} \quad \frac{-0.4}{14} \quad \frac{-1.1}{14} \quad \frac{-1.1}{16} \quad \frac{+3.1}{24} \quad \frac{+2.7}{33}$$

$$\frac{+2.0}{33} \quad \frac{-0.4}{16} \quad \frac{-1.3}{12} \quad \frac{-1.0}{9} \quad \frac{-0.3}{6} \quad \frac{10.6}{11} \quad \frac{-0.4}{16} \quad \frac{-1.6}{16} \quad \frac{-2.3}{18} \quad \frac{-2.2}{19} \quad \frac{-1.5}{21} \quad \frac{-2.2}{33}$$

$$\frac{+0.8}{33} \quad \frac{11.5}{11} \quad \frac{-1.3}{33}$$

$$\frac{+2.0}{33} \quad \frac{17.0}{17} \quad \frac{-1.2}{33}$$

CARLSON'S NOTES.

ELEV.

12+00

962.55 .

11+50

961.45 .

11+00

961.65 .

10+50

962.05 .

10+00

961.85 .

9+50

962.51 .

9+00

964.11 .

8+50

965.11 .

8+00

963.51 .

7+58.35

963.71 .

7+00

963.31 .

6+50

963.21 .

6+00

962.91 .

L

Q

R

(16)

$\frac{9.2}{33}$	$\frac{9.0}{20}$	$\frac{8.0}{13}$	$\frac{7.2}{-}$	$\frac{6.9}{8}$	$\frac{7.3}{10}$	$\frac{7.3}{13}$	$\frac{4.4}{15}$	$\frac{0.7}{33}$
------------------	------------------	------------------	-----------------	-----------------	------------------	------------------	------------------	------------------

$\frac{12.0}{33}$	$\frac{11.7}{19}$	$\frac{9.6}{13}$	$\frac{8.5}{6}$	$\frac{8.4}{-}$	$\frac{8.4}{8}$	$\frac{9.4}{12}$	$\frac{9.4}{14}$	$\frac{7.5}{16}$	$\frac{3.7}{33}$
-------------------	-------------------	------------------	-----------------	-----------------	-----------------	------------------	------------------	------------------	------------------

$\frac{11.8}{33}$	$\frac{11.1}{25}$	$\frac{9.2}{15}$	$\frac{8.5}{10}$	$\frac{8.0}{4}$	$\frac{8.2}{-}$	$\frac{8.0}{8}$	$\frac{9.1}{14}$	$\frac{9.1}{16}$	$\frac{5.3}{18}$	$\frac{3.2}{33}$
-------------------	-------------------	------------------	------------------	-----------------	-----------------	-----------------	------------------	------------------	------------------	------------------

$\frac{11.2}{33}$	$\frac{9.3}{12}$	$\frac{7.7}{4}$	$\frac{7.7}{-}$	$\frac{7.8}{9}$	$\frac{8.0}{15}$	$\frac{8.0}{17}$	$\frac{5.6}{20}$	$\frac{4.0}{33}$
-------------------	------------------	-----------------	-----------------	-----------------	------------------	------------------	------------------	------------------

$\frac{9.8}{33}$	$\frac{9.2}{5}$	$\frac{8.0}{-}$	$\frac{7.9}{2}$	$\frac{7.7}{14}$	$\frac{7.3}{19}$	$\frac{8.2}{22}$	$\frac{6.5}{20}$	$\frac{6.8}{33}$
------------------	-----------------	-----------------	-----------------	------------------	------------------	------------------	------------------	------------------

$\frac{7.4}{33}$	$\frac{7.3}{10}$	$\frac{7.7}{-}$	$\frac{7.0}{5}$	$\frac{7.0}{18}$	$\frac{7.4}{24}$	$\frac{8.2}{27}$	$\frac{7.5}{30}$	$\frac{7.3}{33}$
------------------	------------------	-----------------	-----------------	------------------	------------------	------------------	------------------	------------------

$\frac{4.8}{33}$	$\frac{5.6}{17}$	$\frac{5.5}{-}$	$\frac{6.0}{3}$	$\frac{6.7}{5}$	$\frac{6.7}{8}$	$\frac{5.8}{9}$	$\frac{5.2}{23}$	$\frac{5.8}{29}$	$\frac{5.8}{31}$
------------------	------------------	-----------------	-----------------	-----------------	-----------------	-----------------	------------------	------------------	------------------

$\frac{6.9}{33}$	$\frac{6.0}{12}$	$\frac{4.7}{-}$	$\frac{4.3}{4}$	$\frac{4.9}{6}$	$\frac{4.8}{10}$	$\frac{4.8}{13}$	$\frac{4.4}{26}$	$\frac{4.5}{30}$
------------------	------------------	-----------------	-----------------	-----------------	------------------	------------------	------------------	------------------

$\frac{10.8}{33}$	$\frac{8.6}{8}$	$\frac{6.2}{-}$	$\frac{5.5}{6}$	$\frac{5.2}{21}$	$\frac{5.5}{25}$	$\frac{5.5}{28}$	$\frac{5.5}{30}$	$\frac{4.8}{33}$
-------------------	-----------------	-----------------	-----------------	------------------	------------------	------------------	------------------	------------------

$\frac{7.3}{33}$	$\frac{9.2}{18}$	$\frac{7.6}{11}$	$\frac{6.1}{3}$	$\frac{6.1}{-}$	$\frac{5.8}{12}$	$\frac{6.4}{15}$	$\frac{6.4}{18}$	$\frac{3.5}{20}$	$\frac{0.9}{33}$
------------------	------------------	------------------	-----------------	-----------------	------------------	------------------	------------------	------------------	------------------

$\frac{10.2}{33}$	$\frac{9.5}{26}$	$\frac{6.6}{11}$	$\frac{6.5}{-}$	$\frac{6.7}{4}$	$\frac{6.9}{6}$	$\frac{6.9}{8}$	$\frac{4.9}{10}$	$\frac{3.0}{21}$	$\frac{3.0}{26}$	$\frac{3.0}{33}$
-------------------	------------------	------------------	-----------------	-----------------	-----------------	-----------------	------------------	------------------	------------------	------------------

$\frac{8.9}{33}$	$\frac{8.4}{28}$	$\frac{6.5}{17}$	$\frac{6.1}{3}$	$\frac{6.6}{-}$	$\frac{5.9}{6}$	$\frac{2.2}{8}$	$\frac{1.8}{12}$	$\frac{0.5}{17}$	$\frac{0.0}{33}$
------------------	------------------	------------------	-----------------	-----------------	-----------------	-----------------	------------------	------------------	------------------

$\frac{8.3}{33}$	$\frac{8.2}{28}$	$\frac{6.8}{15}$	$\frac{6.6}{3}$	$\frac{6.9}{-}$	$\frac{7.4}{5}$	$\frac{5.8}{7}$	$\frac{4.6}{15}$	$\frac{3.8}{33}$
------------------	------------------	------------------	-----------------	-----------------	-----------------	-----------------	------------------	------------------

ELEV.

18+50	953.35 .
18+00	952.55 .
17+50	951.95 .
17+00	953.45 .
16+50	957.05 .
16+00	960.45 .
15+50	962.45 .
15+00	963.45 .
14+50	964.05 .
14+00	964.15 .
13+50	964.05 .
13+00	964.05 .
12+50	963.95 .

L

C

R

(17)

$$\frac{7.2}{33} \quad \frac{7.2}{19} \quad \frac{7.4}{17} \quad \frac{7.2}{9} \quad \frac{7.0}{-} \quad \frac{7.1}{6} \quad \frac{8.1}{10} \quad \frac{6.4}{12} \quad \frac{6.2}{33}$$

$$\frac{10.0}{33} \quad \frac{10.2}{18} \quad \frac{8.4}{11} \quad \frac{7.7}{-} \quad \frac{8.2}{6} \quad \frac{9.6}{12} \quad \frac{9.8}{19} \quad \frac{9.6}{33}$$

$$\frac{13.1}{33} \quad \frac{12.6}{20} \quad \frac{8.8}{10} \quad \frac{8.4}{-} \quad \frac{8.7}{5} \quad \frac{12.3}{13} \quad \frac{11.8}{17} \quad \frac{12.7}{33}$$

$$\frac{10.4}{33} \quad \frac{10.1}{21} \quad \frac{7.1}{9} \quad \frac{6.9}{-} \quad \frac{6.9}{4} \quad \frac{9.7}{11} \quad \frac{10.0}{33}$$

$$\frac{3.4}{33} \quad \frac{2.8}{18} \quad \frac{3.8}{15} \quad \frac{3.1}{8} \quad \frac{3.2}{-} \quad \frac{3.2}{6} \quad \frac{5.0}{12} \quad \frac{3.3}{14} \quad \frac{3.5}{33}$$

$$\frac{11.0}{33} \quad \frac{9.8}{18} \quad \frac{11.8}{16} \quad \frac{11.8}{14} \quad \frac{10.9}{7} \quad \frac{10.8}{-} \quad \frac{10.7}{6} \quad \frac{11.6}{10} \quad \frac{11.8}{12} \quad \frac{8.6}{16} \quad \frac{8.3}{33}$$

$$\frac{10.9}{33} \quad \frac{8.7}{17} \quad \frac{9.7}{15} \quad \frac{9.7}{13} \quad \frac{9.1}{6} \quad \frac{8.9}{-} \quad \frac{8.7}{6} \quad \frac{9.6}{12} \quad \frac{9.6}{14} \quad \frac{4.4}{18} \quad \frac{4.0}{33}$$

$$\frac{10.3}{33} \quad \frac{9.7}{15} \quad \frac{8.0}{6} \quad \frac{7.9}{-} \quad \frac{7.7}{6} \quad \frac{8.1}{10} \quad \frac{8.1}{12} \quad \frac{5.6}{14} \quad \frac{2.5}{33}$$

$$\frac{9.8}{33} \quad \frac{9.2}{15} \quad \frac{7.3}{6} \quad \frac{7.3}{-} \quad \frac{7.3}{6} \quad \frac{7.3}{10} \quad \frac{7.3}{12} \quad \frac{5.6}{14} \quad \frac{2.9}{33}$$

$$\frac{6.3}{33} \quad \frac{7.4}{19} \quad \frac{8.5}{17} \quad \frac{8.5}{14} \quad \frac{7.0}{6} \quad \frac{7.2}{-} \quad \frac{7.0}{6} \quad \frac{8.2}{9} \quad \frac{7.0}{12} \quad \frac{6.8}{14} \quad \frac{3.5}{33}$$

$$\frac{8.8}{33} \quad \frac{9.2}{18} \quad \frac{7.4}{9} \quad \frac{7.3}{-} \quad \frac{7.3}{6} \quad \frac{7.2}{9} \quad \frac{7.2}{11} \quad \frac{5.4}{13} \quad \frac{1.6}{33}$$

$$\frac{8.4}{33} \quad \frac{9.0}{18} \quad \frac{7.5}{11} \quad \frac{7.3}{-} \quad \frac{7.0}{2} \quad \frac{7.3}{7} \quad \frac{7.3}{11} \quad \frac{4.8}{14} \quad \frac{0.3}{33}$$

$$\frac{7.6}{33} \quad \frac{8.7}{13} \quad \frac{7.3}{2} \quad \frac{7.4}{-} \quad \frac{7.2}{10} \quad \frac{8.0}{13} \quad \frac{8.0}{15} \quad \frac{5.6}{18} \quad \frac{2.4}{33}$$

ELEV.

24+70 942.15'

24+50 942.25'

24+00 943.05'

23+50 942.95'

23+00 943.05'

22+50 ~~943.85~~'

22+00 945.35'

21+50 946.75'

21+00 947.65'

20+50 948.75'

20+00 951.65'

19+50 953.15'

19+00 953.45'

L

C

R

(18)

$$\frac{6.0}{33} \quad \frac{5.8}{13} \quad \frac{6.1}{8} \quad \frac{6.1}{9} \quad \frac{6.2}{9} \quad \frac{6.9}{15} \quad \frac{8.2}{33}$$

$$\frac{6.2}{33} \quad \frac{6.0}{15} \quad \frac{6.7}{12} \quad \frac{6.7}{10} \quad \frac{5.8}{4} \quad \frac{6.0}{9} \quad \frac{5.9}{8} \quad \frac{7.0}{12} \quad \frac{7.4}{14} \quad \frac{6.5}{15} \quad \frac{7.8}{33}$$

$$\frac{5.9}{33} \quad \frac{4.6}{14} \quad \frac{5.9}{12} \quad \frac{5.3}{9} \quad \frac{5.1}{4} \quad \frac{5.2}{9} \quad \frac{5.3}{10} \quad \frac{6.6}{13} \quad \frac{6.6}{15} \quad \frac{4.6}{17} \quad \frac{5.5}{33}$$

$$\frac{10.6}{33} \quad \frac{6.2}{14} \quad \frac{5.3}{4} \quad \frac{5.3}{9} \quad \frac{5.3}{9} \quad \frac{5.8}{12} \quad \frac{5.8}{14} \quad \frac{8.5}{16} \quad \frac{3.4}{33}$$

$$\frac{12.6}{33} \quad \frac{11.3}{23} \quad \frac{6.3}{11} \quad \frac{5.3}{6} \quad \frac{5.2}{9} \quad \frac{4.4}{9} \quad \frac{5.8}{12} \quad \frac{5.2}{14} \quad \frac{3.9}{16} \quad \frac{1.6}{33}$$

$$\frac{19.2}{33} \quad \frac{16.5}{21} \quad \frac{13.2}{13} \quad \frac{11.9}{7} \quad \frac{11.5}{9} \quad \frac{11.2}{5} \quad \frac{11.6}{12} \quad \frac{11.6}{14} \quad \frac{9.4}{16} \quad \frac{6.2}{33}$$

$$\frac{15.2}{33} \quad \frac{13.2}{18} \quad \frac{11.1}{11} \quad \frac{10.3}{6} \quad \frac{10.1}{9} \quad \frac{10.0}{9} \quad \frac{10.5}{13} \quad \frac{10.5}{15} \quad \frac{6.6}{17} \quad \frac{4.6}{33}$$

$$\frac{13.0}{33} \quad \frac{8.6}{12} \quad \frac{8.7}{9} \quad \frac{8.6}{12} \quad \frac{9.3}{15} \quad \frac{9.3}{17} \quad \frac{5.3}{19} \quad \frac{4.3}{33}$$

$$\frac{14.2}{33} \quad \frac{8.7}{8} \quad \frac{7.7}{9} \quad \frac{7.4}{2} \quad \frac{7.4}{15} \quad \frac{8.3}{19} \quad \frac{8.3}{21} \quad \frac{5.6}{23}$$

41
33

$$\frac{15.4}{33} \quad \frac{12.3}{18} \quad \frac{7.1}{7} \quad \frac{6.6}{9} \quad \frac{6.3}{14} \quad \frac{6.6}{18} \quad \frac{6.6}{21} \quad \frac{4.0}{24} \quad \frac{3.1}{33}$$

$$\frac{12.0}{33} \quad \frac{9.7}{17} \quad \frac{9.2}{12} \quad \frac{8.4}{7} \quad \frac{8.7}{9} \quad \frac{8.7}{8} \quad \frac{9.6}{12} \quad \frac{9.6}{14} \quad \frac{6.7}{17} \quad \frac{6.7}{33}$$

$$\frac{6.5}{33} \quad \frac{6.1}{20} \quad \frac{7.5}{17} \quad \frac{7.5}{14} \quad \frac{6.9}{8} \quad \frac{7.2}{9} \quad \frac{7.2}{7} \quad \frac{7.9}{10} \quad \frac{7.9}{11} \quad \frac{4.8}{13} \quad \frac{4.7}{33}$$

$$\frac{6.4}{33} \quad \frac{5.2}{19} \quad \frac{7.1}{16} \quad \frac{7.1}{14} \quad \frac{6.5}{8} \quad \frac{6.8}{9} \quad \frac{6.8}{6} \quad \frac{7.5}{8} \quad \frac{7.5}{10} \quad \frac{3.8}{14} \quad \frac{4.1}{33}$$

STA.

ELEV.

24+89.12

941.85

L

Q

R

(19)

$$\frac{5.9}{33}$$

$$\frac{6.4}{33}$$

$$\frac{6.6}{33}$$

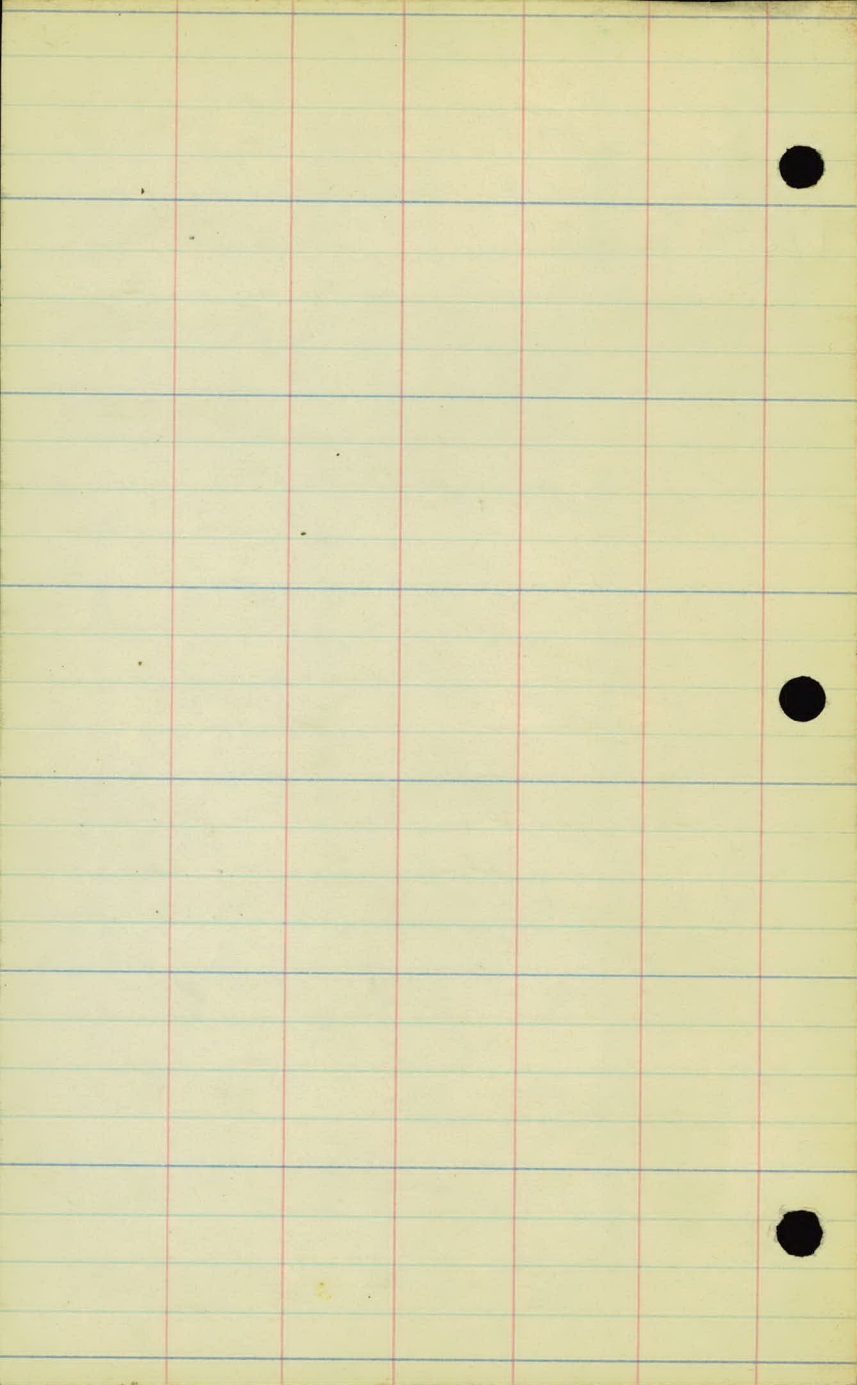

SILVER LAKE ROAD

PROJ. 27-100

- ✓ Plans in hand inspection - 5-4-27 G.R. & P.P.E.
- ✓ 2+16 F.E. Lt. - Remove - P-15" X 24" C.M.
- ✓ 3+16 " " " " " "
- ✓ 3+16 " Rt. - " " "
- ✓ 11+40 - Remove - No curb req.
- ✓ 17+54 - " - P-18" C.M.
- ✓ 16+25 to 18+25 - Rt. & Lt. - G.R.
- ✓ 20+00 to 23+75 - Lt. - G.R.
- ✓ 24+73 - Leave.

179 60
22°-34'
157 24

Description of a road on south
side of Silver Lake Sec. 31-30-23

Beginning at the center of Section 31-30-23

thence westerly along center line of said section a
distance of 427.8 ft., thence S 46° 30' W a distance of
719.32 ft., thence S 63° 51' W, a distance of 518.88 ft.
thence S 80° 31' W a distance of 322 ft., thence N. 89° 53' W
a distance of 513.45 ft. to a point on the west county
line which is 1828.55 ft. north of the southwest cor of sec 31-30-23

1000
2 corners

427.8
719.32
1147.12 ✓ = 1147.12 ✓
518.88
1666 00.
322
1989
513.45
2502.45

P.C. @

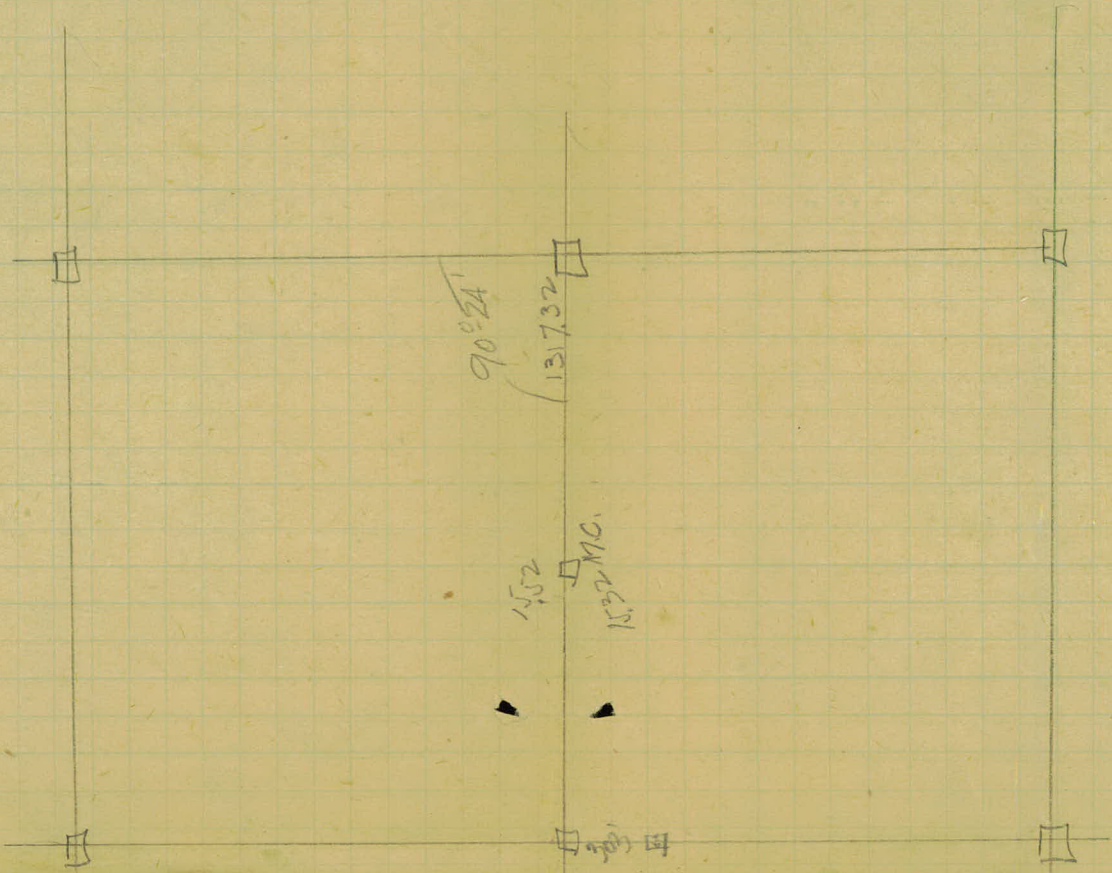

58.25
41.25

247291
78.62
241033

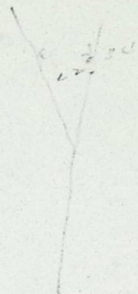

U 2505