

242

24-56

Sta. 0+00 to Sta. 98+87.9
City Limits to Burns Ave

Final Topography

Project 24-56

Upper Afton Road

H. L. Wilshusen

A. G. Briggs

R. Pearson

M. Hackney

5+00

4+00

3+00

2+00

1+00

0+00

+12-TP-29
+06-PP-28'
FL. 40'

FL-30'

FL. 34

FL 33

+79-TP-29
+76-PP-28'

FL. 34

FL 33

+46-PP-28'
+41-TP-28'

+55-Tree-25
+50-Tree-23'

FL. 31

FL. 32

FL 31 P.P. +15-30
+100-TP 30'

Cultivated

FL. 31

+55-Tree-26

+77-PP-28'
+14-TP-28'
+50-PP

Woods

+55-m. by 1/2
FL. 32

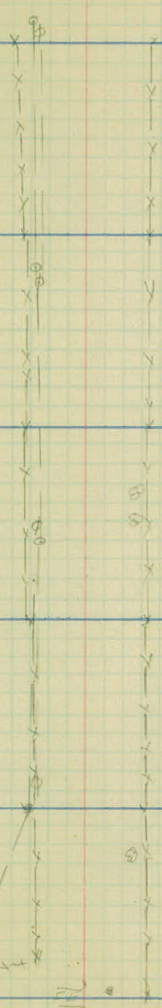

11+00

10+00

9+00

8+00

7+00

6+00

5+00

Lt. # Rt.

+90. M.A. 15'

+93. F.E.

+94. P.P. 28'
+63 House



120' appx.

+98. House

+92. F.E.

form yard

F-44'

+64. T.P. 30'

+37. P.P. 28'

F-36'

F-36

+18. T.P. 30'

+05. P.P. 28'

Pasture

F-33'

Cultivated

+80. T.P. 30'

+69. P.P. 29'

F-31'

F.L. 31'

+08. V.S. 37'

+41. T.P. 30'
+34. P.P. 28'

Cultivated

Woods

F-37'

F-35'

+12. T.P. 30'
+06. P.P. 28'
F-40'

F-35'

17+00

16+00

15+00

14+00

13+00

12+00

11+00

LF E PF

+158 - T.P. 29'

+112 - P.P. 28'

+114 - T.P. 29'

+177 - P.P. - 28'

+74 - T.P. 28'

+112 - P.P. 25'

+35 - T.P. 30'

PC 18-28'

+09 - P.P. 27'

+06 - T.P. 28'

+03

+174 - P.P. 25'

+63

+33 - P.P. 28'

P.C. 17-36'

Cultivated

Meadowland

Cultivated

Pasture

Woods

E-34
1700 - P.E

F-34

245 - T.P. 28'

F-34

F-34

F-33

F-35
490 - T.P. 28'

9988-120'

TP1 → → → →

F-44



PP →

PP

8



2300

2400

2500

2600

2700

2800

2900

Lt Z

Rt

F-34

+83-P.P. 29'

φ

X

+53-E.E.

FE

X

F34

+93-T.P. 29'

φ

X

+50-P.P. 21'

φ

X

F34

Cultivated

Woods

+57-T.P. 29'

φ

X

+12-P.P.

φ

X

F-34

+22-T.P. 30'

φ

X

E34'

+27-P.P. 29'

φ

X

Cultivated

Woods Pasture

+84-T.P. 29'

φ

X

F34

+46-P.P. 28'

φ

X

F34

Woods

+48-T.P. 29'

φ

X

+22-P.P. 29'

φ

X

FE

Wood - F34

29

28

27

26

25

24

23

LT. # RT.

+80-T.P. 26'

+79 E. Colv.

+23-29-PP
E27

+41-T.P. 26'

E28'

+56-PP. 28'

Meadow

+09-T.P. 26'
E.L. 25'

+57 P.P. 28'
+55
+47-FE

FC. 26-29'
E. 27

+10-T.P. 26'

E. 28'

+28-P.P. 28'

Cultivated

+35-T.P. 26'

+83-P.P. 28'

+83-FE

JL

+125-FC. 34

Cultivated

E 34

+13-FC. 36
+07-FE.

Jarvis
yard

HOUSE
Barn

+47-FE
FC. 25-30'
+26-M. bro 17'

E 34

Woods Stumps Pasture

E 34

E 34

E 34

35

34

33

32

31

30

29

+77 - P.P. 29

E 35'

+50 - T.P. 31
+41 - F.F.
+30 - P.P. 28'

F 39'

+60 - T.P. 29

F 42'
F.F. 24'

E.C. 110'

+47 - P.P. 27'

F.C. 100'

+23 - T.P. 25'

F 60'

+47 - P.P. 34'

+100 - T.P. 36
E 36'

+54 - P.P. 35'

E 36'

+80 - T.P. 26'

+13 - P.P. 39'

F 27'

Meadow

Meadow

Meadow

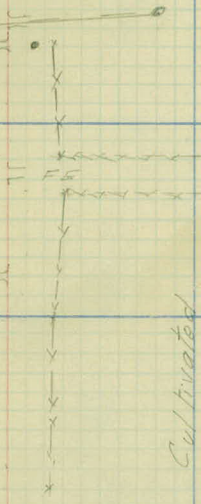
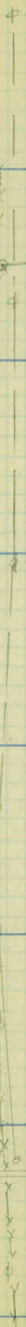

F.F. 154
+41 - F.C. 24'
+40 - T.P. 24'

+82 - F.C. 29
+73 - F.F.
+66 - P.P. 31

F 22'

F 23'

Cultivated

Cultivated

+77 - E.C. 110'

41

40

39

38

37

36

35

+77-M-bv 14'
+59-FE
+97-E Gutter

+57-FE
+43-E gutter
+23-PP 28'
RQ-15'
+88-FC 55'

FE FE
Gutter 6" W.
10" D.

RQ-15' F35'

F 38' RQ-15'
+90-P.P. 29'

TC-15'

F.39-RQ-15'

RQ-15'

+50-P.P. 29'

2.38' RQ-15'

RQ-15'

+13-GR 29'
F.35-RQ-15'

RQ-15'

+50-F48'

F.34 RQ-15' 100' 100'

6" W
10" D

+77-P.P. 29'

Cultivated

F.35'

Meadow Meadow



47+00

46+00

45+00

44+00

43+00

42+00

41+00

+22-PP 24

+200 M.P.V. -16'

+23- F.E.

NO USA
+60-T.P. 20'

+84-PP 26

FE

Pasture

Pasture

+33-PP 24'

+22-T.P. = 25'

+56-Gr. Cdv



416
L-105'
W-8'
D-6'

S/S from 4 W 68
W-8'
D-6'

+91-PP 24'

Bottle Creek Box

Note
Gutter W
W D

+26-F
+26-Gutter -15'

+10-E Gutter -15'

+140-PP 24'

Woods

S/P BOX

+20-F-36
+14-T.P. 25'

+171-R-15 Gutter 15'

+17-F.E. 190-SP 10'
+18-F-Gutter 15'

+23-PP 28'

FE
FS x 4'



+20-R-9 Gutter
+59-F.E.
+41-F-Gutter 15'

R. 35'

53400

52400

51400

50400

49400

48400

47400

+23 + P.P. 41'

Meadow

Meadow

Cultivated

Cultivated

Cultivated

+47 - P.P. 30'

+49 - FF
+48 - P.P. 39'

Cont. 789L
W-5
D-3.5

Rubblestone 51"
width 5'
Depth 3.8
+10 8

Creek
roads

Creek

roads

+62 - P.P. 24'

+700 - M. by - 1'

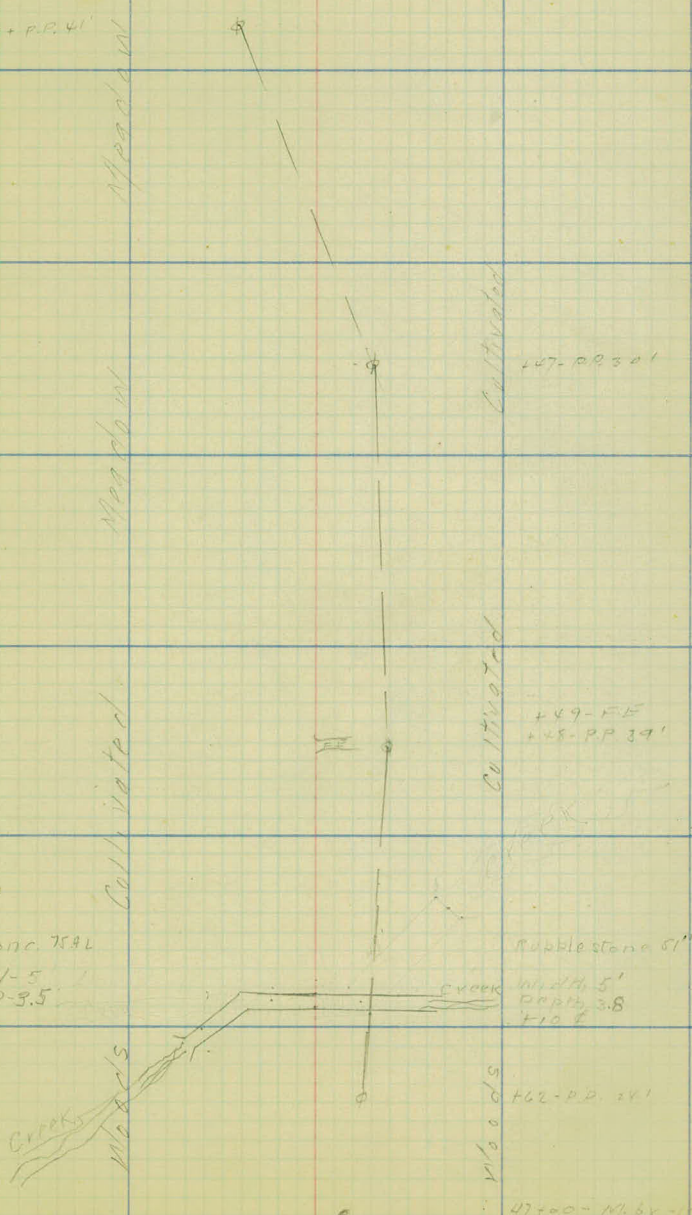

59+00

58+00

57+00

56+00

55+00

54+00

53+00

F-75

7-33'

+76-P.P. 42

F-47

7-31'

+65-P.P. 31

F-32

F-27

+97-P.P. 29

F-36

7-32'

+04-P.P. 33

P-34

7-35'

F.C. 33 +50

P.B. 37

+50-F.C. 33

White Bear Ave

+25-P.P. 41

Meadow Meadow



65+00

64+00

63+00

62+00

61+00

60+00

59+00

+20-PP-80

+73-F.C.75'

+102-PP-35'
F38

F35'

F-34

F.E.+22
F35

F-90'
+91-PP-90'

F-35'

Cultivated

PASTURE

Woods



X - Y +43-FE
+26-F.C. 35'

F-57'

FE +30

F-65'

+11-PP-42'
F-80'

F-50'

F-47'

F-33'

Woods

PASTURE

Woods



71+00

70+00

69+00

68+00

67+00

66+00

65+00

77x10

76x100

75x100

74x100

73x100

72x100

71x100

LF + RT

X93-PP-21'
X97-PP-20'
X65B Fence-31'

X10-PP
F-35'

X30-PP-22'
X16-PP-30'
F-30'

F-28'

F30'

F30'

X74-PP-25'
X67-PP-35'
X50-PP-29'
X47-PP

X60-PP-30'
X43 small 3/16

X84-PP-23'

past 1/2

F-16
T-22'

X92-PP-23'

X52-PP-24'

Fence 32'

X86-3/16-25 A

X33-PP-26'
X11-PP-27'

Estimated

83x00

83x00

81x00

80x00

79x00

78x00

77x00

+30-PP. 27'

F-31'

+35-FE.

+40-FC. 25'

+20-F-35'

F 28

+43-PP. 38

81400-FE
+59-711. 6x-15'

+48

Wa

Yard

P-31

+19-FC. 25
+80-FE.
+71-FC. 29'

+77-M. DV-14'

+62 House

+33

+15. F

Yard

+55-PP. 39

+30

P31.

Cultivated

Cultivated

F-31

+95-PP. 27'
+71-TR. 29'

F35'

89+00

98+00

97+00

96+00

95+00

84+00

83+00

103-PP-2F'

101-F33

Tennis Court

+61-E of Fence

+30-PP-27'

2-30'

+20-F.E.

- +71-2-Koo-26'
- +50-Tree-26'
- +38-Tree-30'
- +26-Tree-27'
- +16-Tree-26'
- +03-Tree-27'

+60-Koo-26'

+60-Tree-27'

4-30

- +59-PP-29'
- +44-Tree-28'
- +38-Tree-27'
- +23-FE

+15-MBK-15'

11-27



- +57-Tree-24'
- +42-Tree-24'
- +13-Tree-24'

Cultivated

Cultivated Woods yard

F27

+50-PP-27'

F-31

95+00

94+00

93+00

92+00

91+00

90+00

89+00

+16 P.P. -

Meadow

Meadow

F-28'

+11 P.P. 32'

Meadow

Woods

F-28

F-23

+11

9400 P.P. 28'

Cultivated

Meadow

F-25'

F-27

136 P.P. 32'

Cultivated

Cultivated

+16 P.P. 30

+80 T.P.P. 32'

+05 P.P. 28'

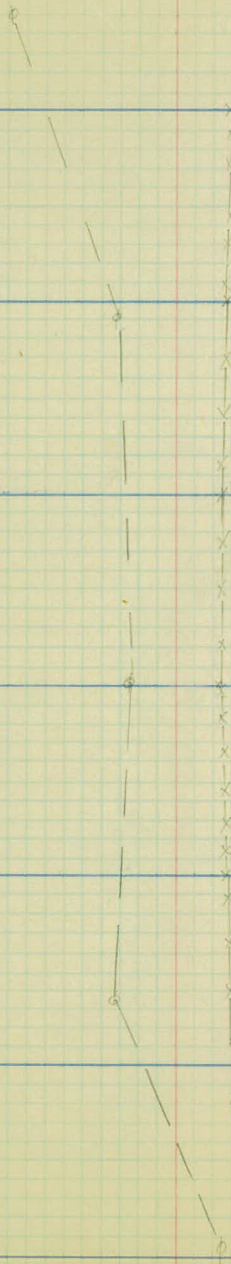

99+00

98+00

97+00

96+00

95+00

Burns Ave

784 87.9 End of Project

174-P.P. 24

Burns-410-25'
+59-P.P. 17
17-32
+18-E-30° 03'-22" curv
+60-P.P. 18'

+34-P.P. 24

+32-Burns Ave
124-38' F
P. 32

+50-P.P. 100'

Pasture

15-31'

+50-P.P. 51'

Pasture

P. 28

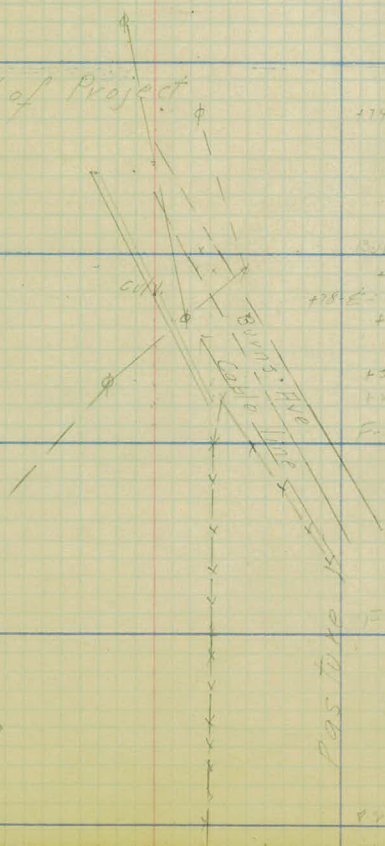

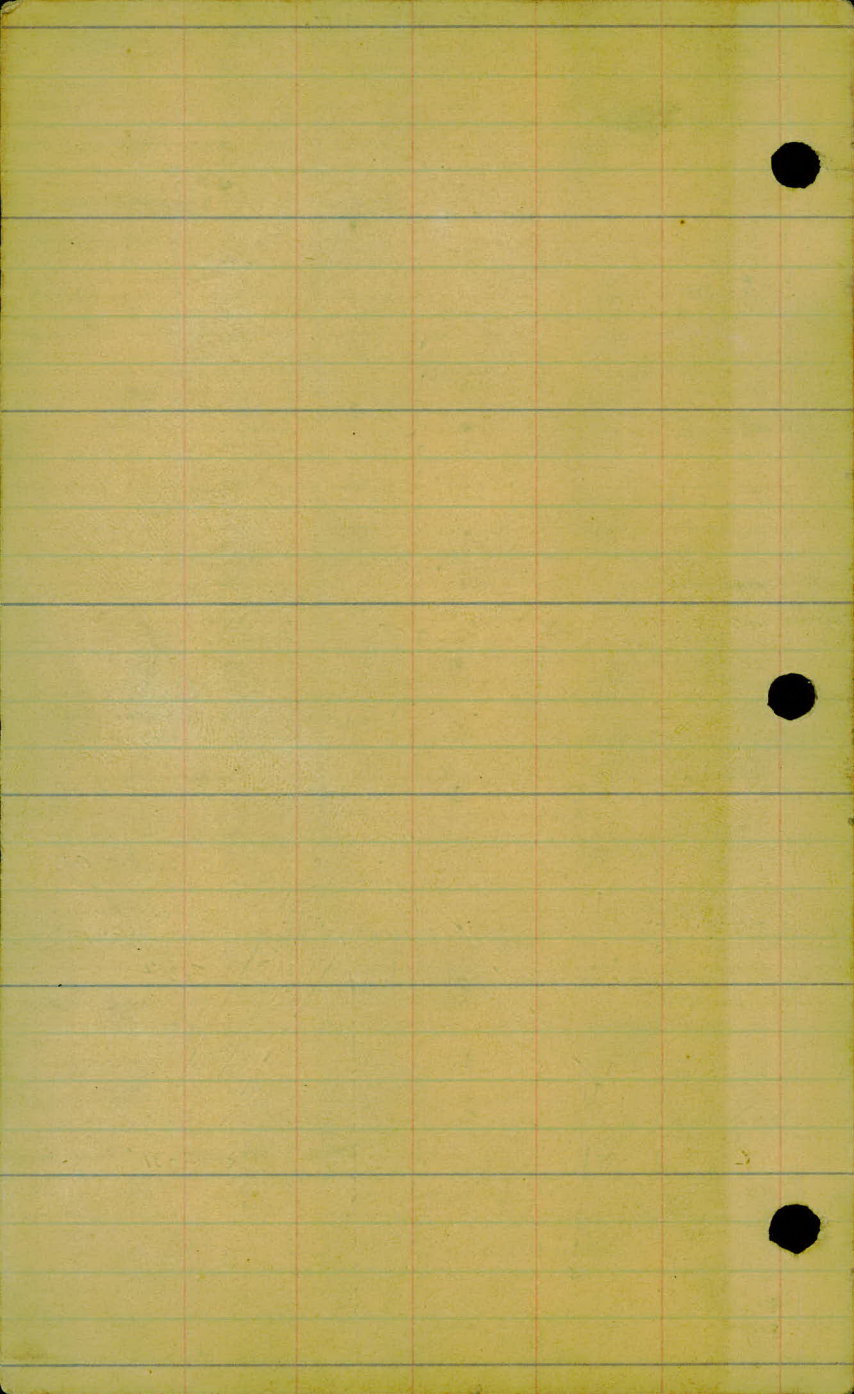

U2469