

TOPOGRAPHIC SURVEY
RICE - CENTERVILLE (RC. LINE)

FILE NO. 4

FIELD BOOK

360

No. 4

Centerville Road

KEUFFEL & ESSER CO.

DRAWING MATERIALS AND SURVEYING INSTRUMENTS. NEW YORK.

CHICAGO. ST. LOUIS. SAN FRANCISCO. MONTREAL.

TABLES FOR EXCAVATIONS AND EMBANKMENTS.

DISTANCES FROM CENTER OF ROADWAY FOR CROSS-SECTIONING.

ROADWAY 18 FEET WIDE. SIDE SLOPES 1 TO 1.

FOR SINGLE TRACK EXCAVATION.

"Copyright, 1895, by Keuffel & Esser Co."

	0	.1	.2	.3	.4	.5	.6	.7	.8	.9	
0	9.0	9.1	9.2	9.3	9.4	9.5	9.6	9.7	9.8	9.9	0
1	10.0	10.1	10.2	10.3	10.4	10.5	10.6	10.7	10.8	10.9	1
2	11.0	11.1	11.2	11.3	11.4	11.5	11.6	11.7	11.8	11.9	2
3	12.0	12.1	12.2	12.3	12.4	12.5	12.6	12.7	12.8	12.9	3
4	13.0	13.1	13.2	13.3	13.4	13.5	13.6	13.7	13.8	13.9	4
5	14.0	14.1	14.2	14.3	14.4	14.5	14.6	14.7	14.8	14.9	5
6	15.0	15.1	15.2	15.3	15.4	15.5	15.6	15.7	15.8	15.9	6
7	16.0	16.1	16.2	16.3	16.4	16.5	16.6	16.7	16.8	16.9	7
8	17.0	17.1	17.2	17.3	17.4	17.5	17.6	17.7	17.8	17.9	8
9	18.0	18.1	18.2	18.3	18.4	18.5	18.6	18.7	18.8	18.9	9
10	19.0	19.1	19.2	19.3	19.4	19.5	19.6	19.7	19.8	19.9	10
11	20.0	20.1	20.2	20.3	20.4	20.5	20.6	20.7	20.8	20.9	11
12	21.0	21.1	21.2	21.3	21.4	21.5	21.6	21.7	21.8	21.9	12
13	22.0	22.1	22.2	22.3	22.4	22.5	22.6	22.7	22.8	22.9	13
14	23.0	23.1	23.2	23.3	23.4	23.5	23.6	23.7	23.8	23.9	14
15	24.0	24.1	24.2	24.3	24.4	24.5	24.6	24.7	24.8	24.9	15
16	25.0	25.1	25.2	25.3	25.4	25.5	25.6	25.7	25.8	25.9	16
17	26.0	26.1	26.2	26.3	26.4	26.5	26.6	26.7	26.8	26.9	17
18	27.0	27.1	27.2	27.3	27.4	27.5	27.6	27.7	27.8	27.9	18
19	28.0	28.1	28.2	28.3	28.4	28.5	28.6	28.7	28.8	28.9	19
20	29.0	29.1	29.2	29.3	29.4	29.5	29.6	29.7	29.8	29.9	20
21	30.0	30.1	30.2	30.3	30.4	30.5	30.6	30.7	30.8	30.9	21
22	31.0	31.1	31.2	31.3	31.4	31.5	31.6	31.7	31.8	31.9	22
23	32.0	32.1	32.2	32.3	32.4	32.5	32.6	32.7	32.8	32.9	23
24	33.0	33.1	33.2	33.3	33.4	33.5	33.6	33.7	33.8	33.9	24
25	34.0	34.1	34.2	34.3	34.4	34.5	34.6	34.7	34.8	34.9	25
26	35.0	35.1	35.2	35.3	35.4	35.5	35.6	35.7	35.8	35.9	26
27	36.0	36.1	36.2	36.3	36.4	36.5	36.6	36.7	36.8	36.9	27
28	37.0	37.1	37.2	37.3	37.4	37.5	37.6	37.7	37.8	37.9	28
29	38.0	38.1	38.2	38.3	38.4	38.5	38.6	38.7	38.8	38.9	29
30	39.0	39.1	39.2	39.3	39.4	39.5	39.6	39.7	39.8	39.9	30
31	40.0	40.1	40.2	40.3	40.4	40.5	40.6	40.7	40.8	40.9	31
32	41.0	41.1	41.2	41.3	41.4	41.5	41.6	41.7	41.8	41.9	32
33	42.0	42.1	42.2	42.3	42.4	42.5	42.6	42.7	42.8	42.9	33
34	43.0	43.1	43.2	43.3	43.4	43.5	43.6	43.7	43.8	43.9	34
35	44.0	44.1	44.2	44.3	44.4	44.5	44.6	44.7	44.8	44.9	35
36	45.0	45.1	45.2	45.3	45.4	45.5	45.6	45.7	45.8	45.9	36

Calculated by Julien A. Hall, M. Am. Soc. C. E.

For Keith's Railroad Curve Tables see end of book.

A-11-899-23

INDEX

<u>Job</u>	<u>Class Notes</u>	<u>Sta. to Sta</u>	<u>Page</u>
RC Rice-Centerville line	Artificial Topog	200-249	1 to 5
" " " "	" "	249 to 347	5 to 12
" " " "	" "	347 to 412+	12 to 18
E line - Edgerton Extra.	" "	0 to 52+	20 to 28
RC LINE DRAINAGE Notes		0 to 412+	31-33

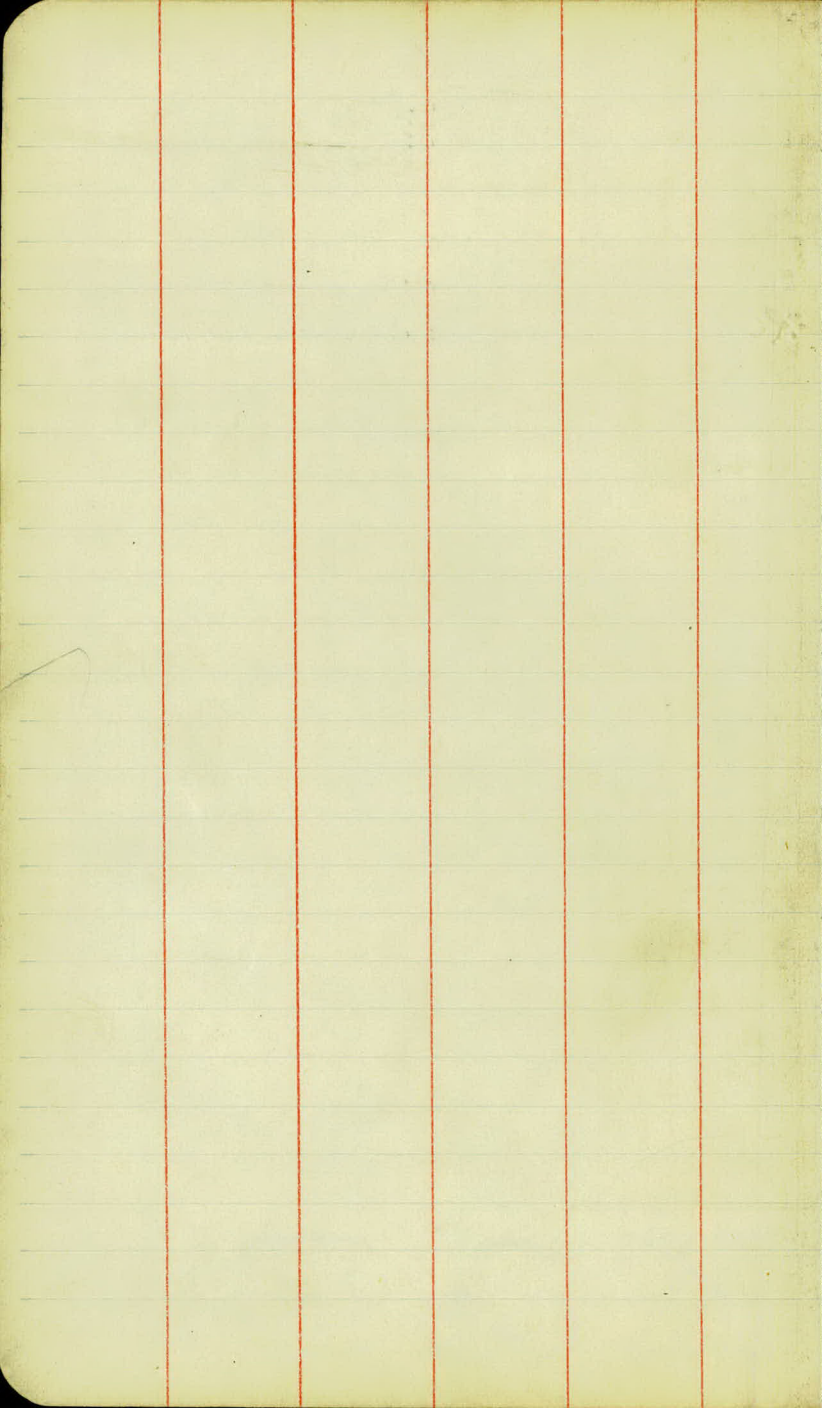

11
10
09
08
07
06
05
04
03
02
01
00

CLEARED

TIMBER

STUMPS.

+82 Fence - 30'R

PASTURE

+42 ♀ 12' Road & 16' gate
+30 - Fence Cor.

+21 Milk Pl/m
3'6" - 12'R

+51 Sign LOOK OUT FOR CARS
15' L.
SWAMP

CULTIVATED

+100 Fence - 31'R.

Telegraph Line →

+05 ♀ 10' x 12' Sign - 23'L

+60 Pole - 98'L.
+48 Fence Cor 21'L.

+18 Pole 25'L.

+88 Pole - 28'R.
+80 Fence - 40'R.

160 ♀ 500 Xing.
+25 Sign LOOK OUT FOR CARS
12'R.

+61 - Fence Cor - 15'R

+12' Gate

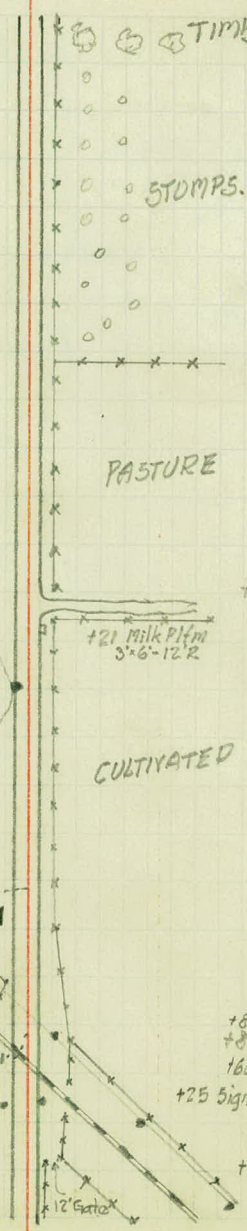

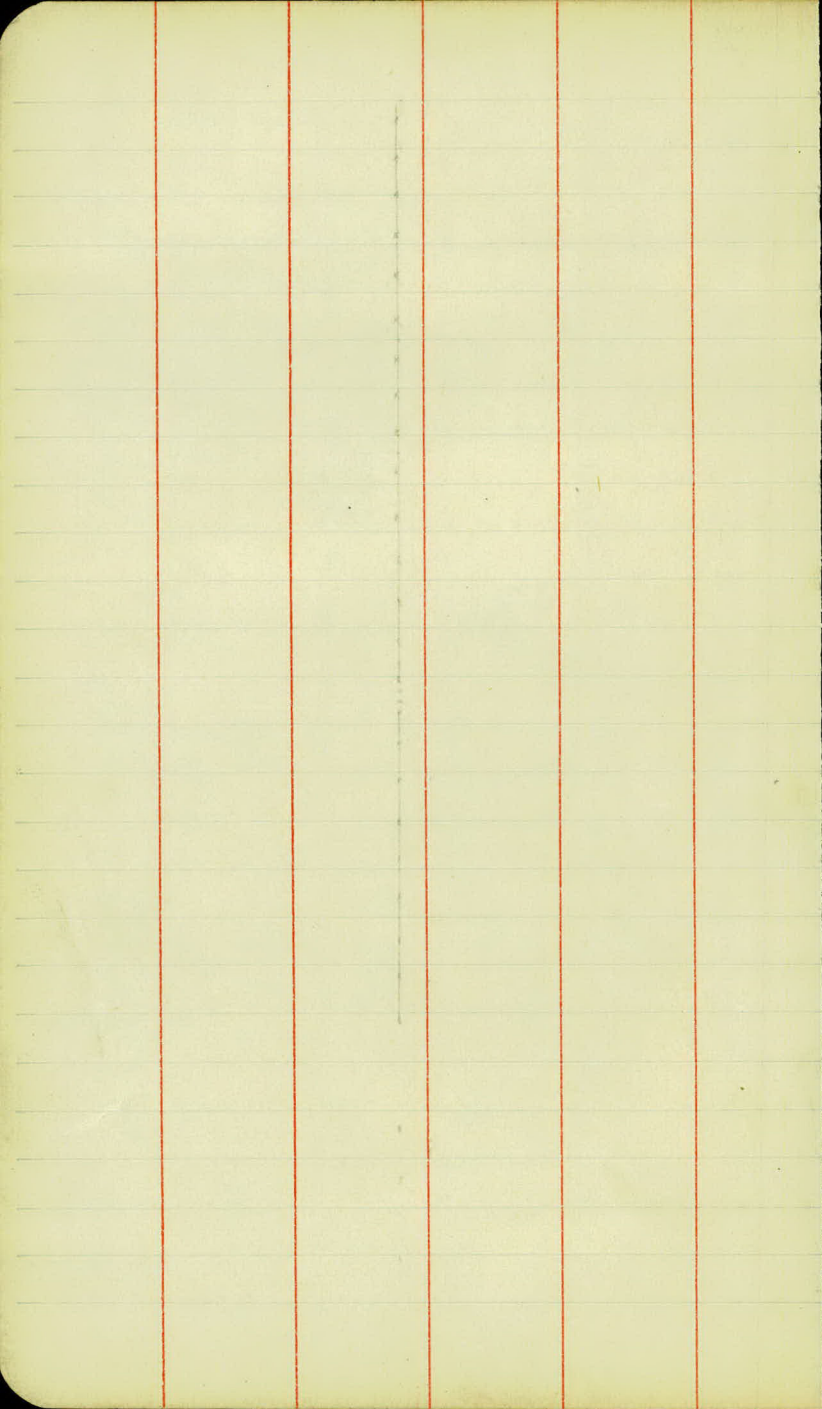

R.C. LINE

L

E

R

PRB
4/6/23

(2)

224.

+59 End Fence-30'L.

223

222

221.

220

219

218

217

216

215

214

213

212

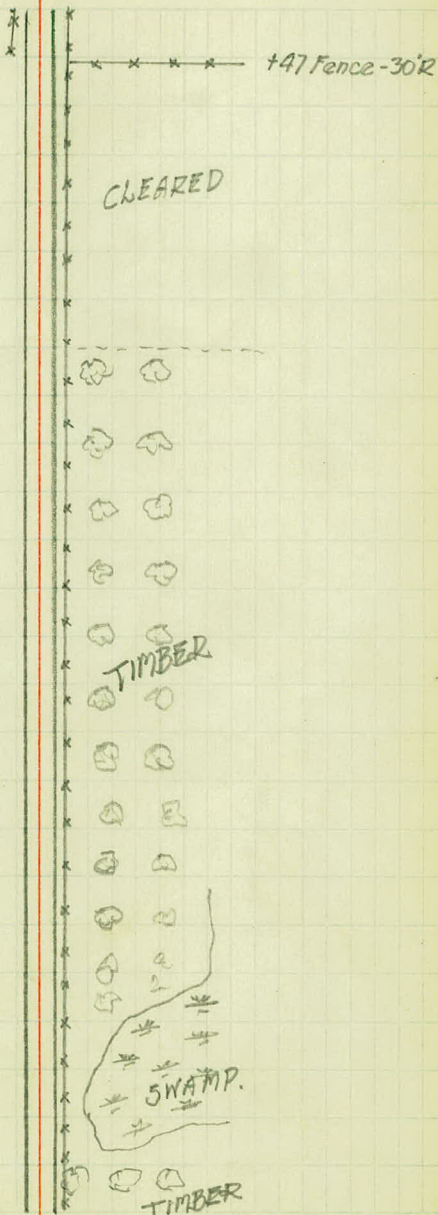

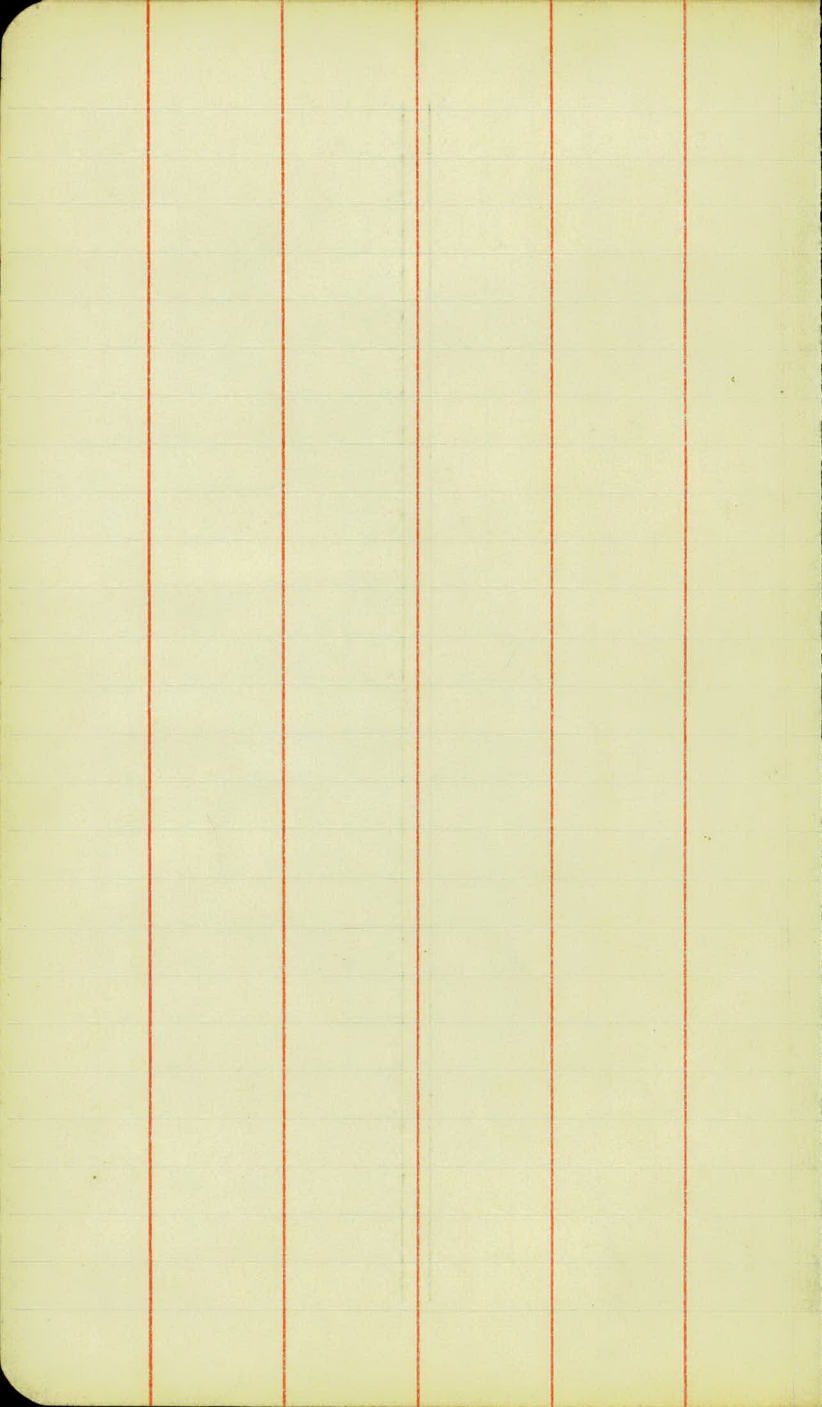

36
35
34
33
32
31
30
29
28
27
26
25
24

+15 $\frac{1}{2}$ Priv. Road.
Fence-40'.

MEADOW

+75 End Fence-39'

+78 Fence-18'.

+50 " 27'.

Fence-27'.

CLEARED

+18 $\frac{1}{2}$ 10' Road &
16' Gate

+90 End Fce-30'

+10 End Fce-31'

SWAMP.

SWAMP.

TIMBER

BROSH

CLEARED

SWAMP.

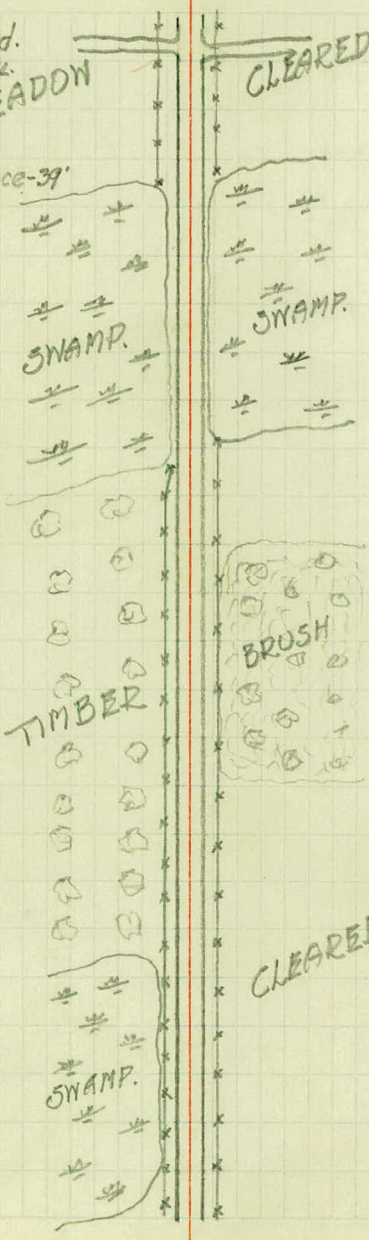

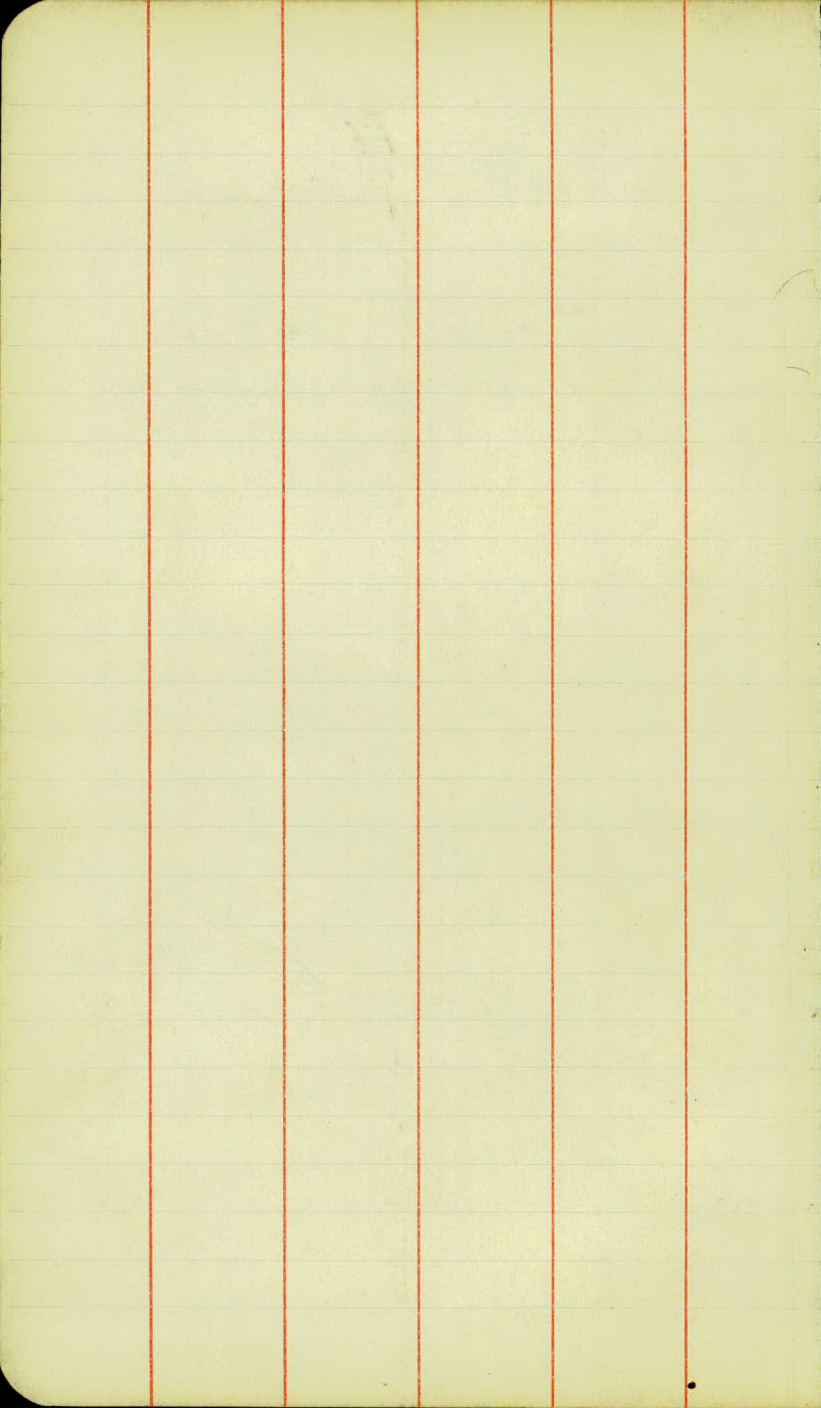

2006. 67.

RD-15'R

CULT. FIELD

CULT. FIELD

- +39-Fence-21'L
- +30-Fence-33'L
- +12-Fence-24'L

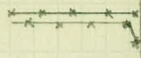

CULTIVATED

CULTIVATED

+72 Fence-27'L

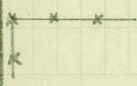
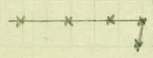

+06 Fence 30'R

GULV-260175 - 15" XTR 55'
El. Lower Int - 252.0

L.

R.

61
60
59
58
57
56
55
54
53
52
51
50
249

+45 Pole-18'L
Fcc-28'L

+40 Pole-18'L
Fcc-28'L

+56 Pole 18'2
Fcc-27'L

+48 Fcc-28'L
+5A Pole-18'L

+54 Pole 18'L

+40 Pole-18'L (2 wires)
Fcc-26'L

+50 Pole-25'L
CULT. FIELD
+40 Pole-20'L

+80 Pole-23'L
+50 End Fcc-31'L

+86 Pole-10'L

20° C. Left
Road, Fence + Pole Lines
follow S. to Corner. (Mory)

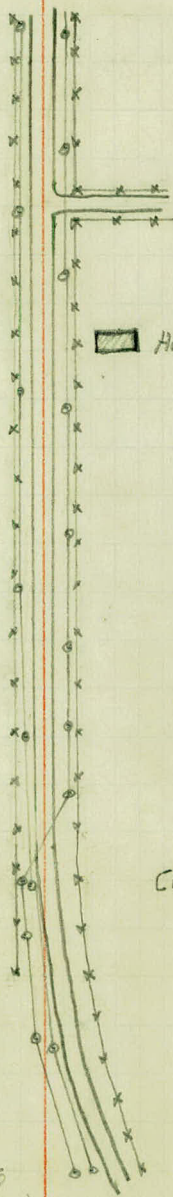

Pole-25'R +40

Pole 25'R +12
Road SW +60
Fcc Cor 27'R +69
Fcc. Cor-27'R +50

Pole 25'R +85
27' END Fcc +70

1/2" x 20' SW Cor-56'R +102
End Fcc +60
Pole-25'R +42

Fcc-27'R
Pole-25'R +20

-32- Intersect Fcc-
Fcc 33'R.
Pole 27'R +96

Pole-29'R +12
(24 Wires)
Pole 30'R +32

CULT. FIELD
Fcc-37'L +100

Fcc-40'L +57.8

Pole-2'R +33

Begin -

CULY-265+43 50'12" VTR
El. Low Inv. - 254.2

R.C. LINE

L.

RR Boxister
2/1/33

R

(6)

- +00 - Poles 25' x 27' L
- +35 Pole - 23' L
- +82 End Fce 21' L
- +84 Iron Sign 15' L
- +33 Pole - 27' L
- +00 Fce - 21' L
- +00 Pole - 21' L

- +95 Fce - 23' L
- +95 Pole 27' L
- +40 Pole 21' L

- +53 Pole 33' L
- +79 Pole 24' L

- +10 Pole - 33' L
- +75 Pole 24' L
- +12 End Fce 30' L

- +57 Pole 33' L
- End Fce - 30' L
- +45 Pole - 23' L

- +100 Pole - 33' L
- +55 Fce Cor 24' L
- +73 Pole 23' L
- +52 Pole 33' L

- +12 Pole 19' L
- +90 Milk Pilm - 13' L - 3' x 6'
- +65 Fce Triv Rd - 10' Wide
- +98 Fce Cor. 28' L

- +262

CULT. FIELD

PASTURE

CULT. FIELD

CULT. FIELD
(2 wires)

PASTURE

CULT.

To White Bear →

- Fce Cor - 31' R +79
- Iron Sign R 25' R +75
- +25 Pole - 30' R
- Fce - 31' R
- Pole 28' R +82

- Cor. Fce 31' R +85
- Pole - 25' R +58
- Fce Triv Rd +23' 10' W
- Mail Box 12' R +15
- Tree Line 25' R +00

- 500'
- 500'
- 5 Evergreens
- 30' x 24' House - N.W. Cor.
- Conc. Walk + Steps
- 67' R @ +52
- +42 Fce Conc. Steps 15' R
- +12 Pole 25' R
- Fce Cor +80 - 25' R

- Pole + Fce 24' R +05

- Fce Cor 23' R +88
- Pole - 23' R +82
- (26 Wires)

- Pole 23' R +58
- Fce - 28' R +50

- Pole - +30

- Pole - 20' R +03

- Fce - 29' R +50

- Pole - 20' R +83
- Mail Box - 14' R +62

- Fce Cor (29' R +90)
- (35' R)

(2 wires) →

(2 wires) →

45'

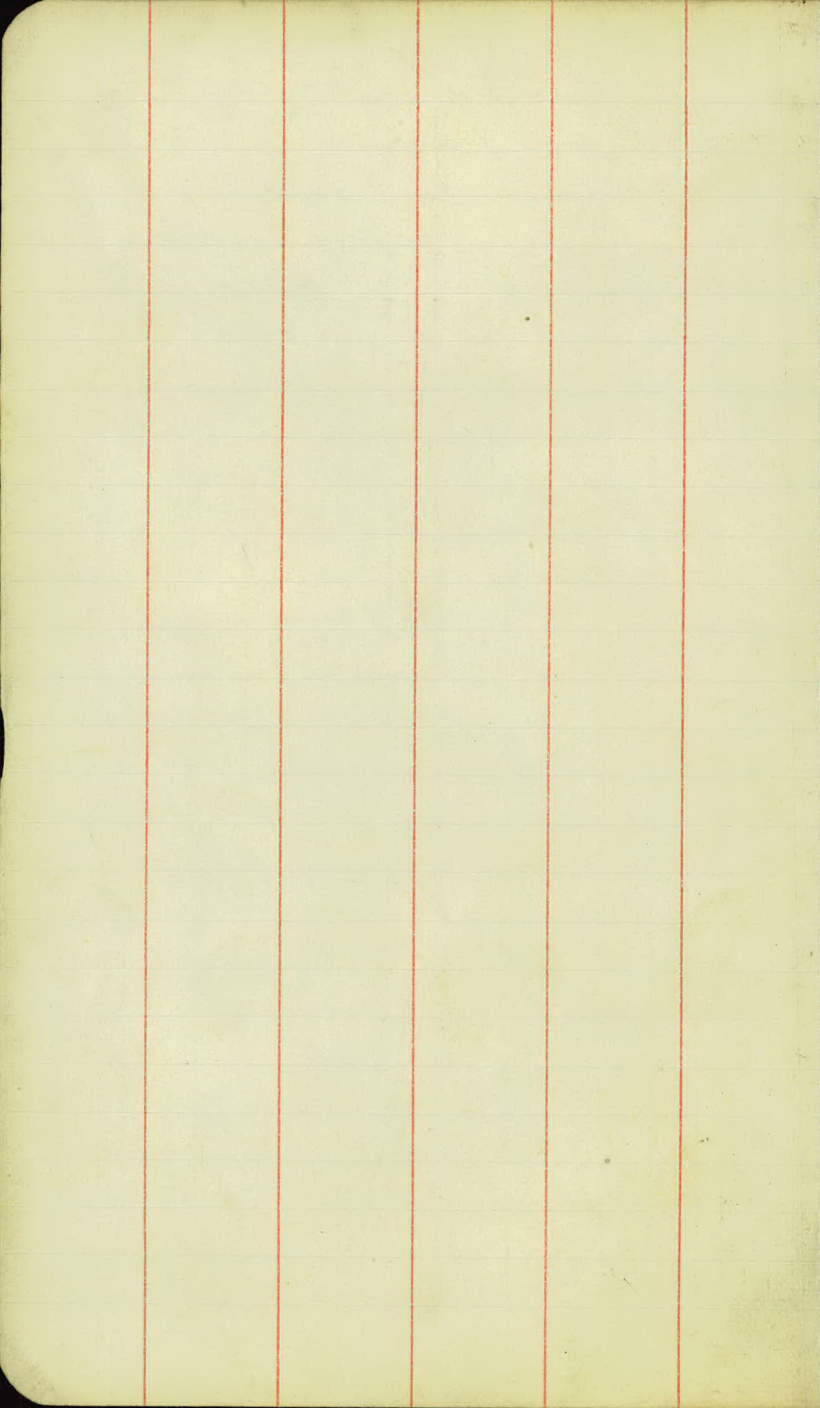

286
285
284
283
282
281
280
279
278
277
276
275
274

Fce-32'L

Fce-33'R

CULT. FIELD

PASTURE

+18 Danger Sign-12'L

+70 Fce-Intersect-29'L

Fce Cor. 33'R +51
£-12' Prin. Rd +36
Mail Box 12'R +15
Fce Cor 19'R +05

PASTURE

CULT. FIELD

Fce Cor 20'R +10

+54 Fce Cor-27'L

Fce Cor-96'R +15

+22 Wood Xing Sign-12'L
+15 £ 500 Xing
16' Xing Plank
+58-Pole 33'L
+56-Fce End 24'L

Tel. Pole-92'R +40
Iron Xing Sign-15'R +06
Conc. Battered Wall-19'R +06
Pole-70'R +85
Fce Cor (W. Wire) 36'R +00
Pole-27'R +70
Pole-18'R +62

+75 Pole-20'L Gog.
+40 Pole-23'L

Pole-33'R +70

+90-SE Cor. 22'L +62
+48 £ 3'x6' Milk Sign-20'L
+45 Iron Sign P-21'L

Pole-27'R +57
£ 6 Mail Boxes 15'x16'
Danger Sign 16'x40'
Iron Sign 22'x15'
Fce Cor. 29' +32
Pole 41'R +36



Small Trees

+60 Pole 31'R

CROSS ROADS

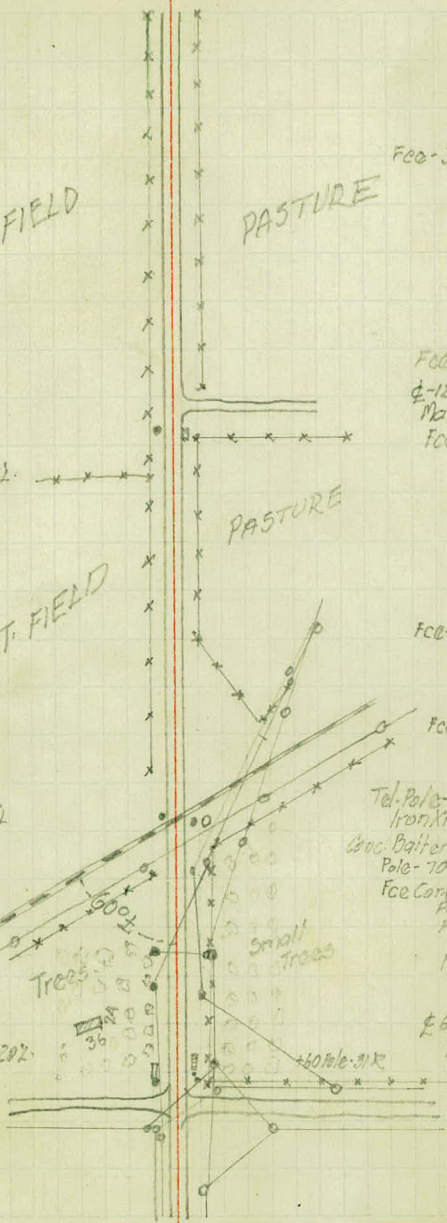

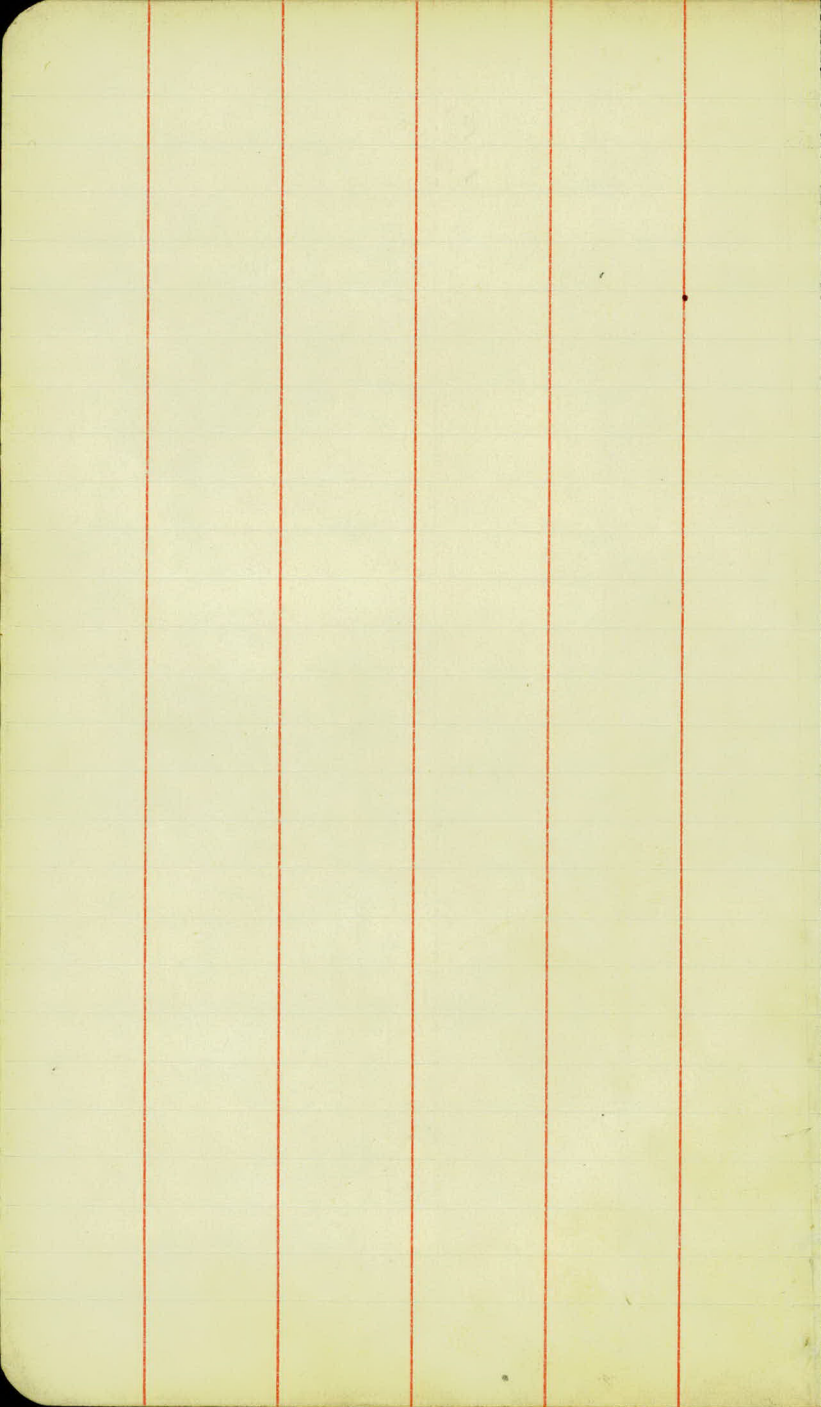

L.

£

R

PR: Barnister

2/2/23

Ⓟ

299

298

297

296

295

294

293

292

291

290

289

288

287

+23 £ Road & gate
to Field - 10' Road
21' to Fce

£ Farm Rd - 16' W + 42
Mail Box 12' R + 27
Fce. Cor - 30' R + 25

+40 Temp. Farm Rd - £
to Field - 6' wide

+36 Fce - 22' L + 33' R

+36 Fce - 32' R

CULT. FIELD

CULT. FIELD

CULT. FIELD

PASTURE

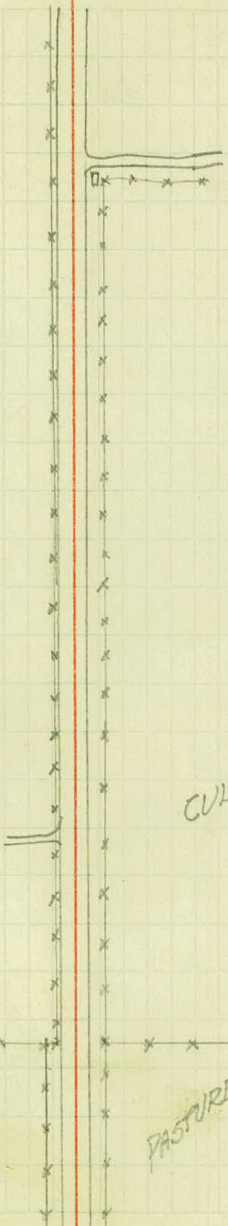

CULY-311786-35' of 24" Cor. I.P.

El. lower 12Y-203.7

RC-LINE

L

±

R

PRB
2/2/23

(9)

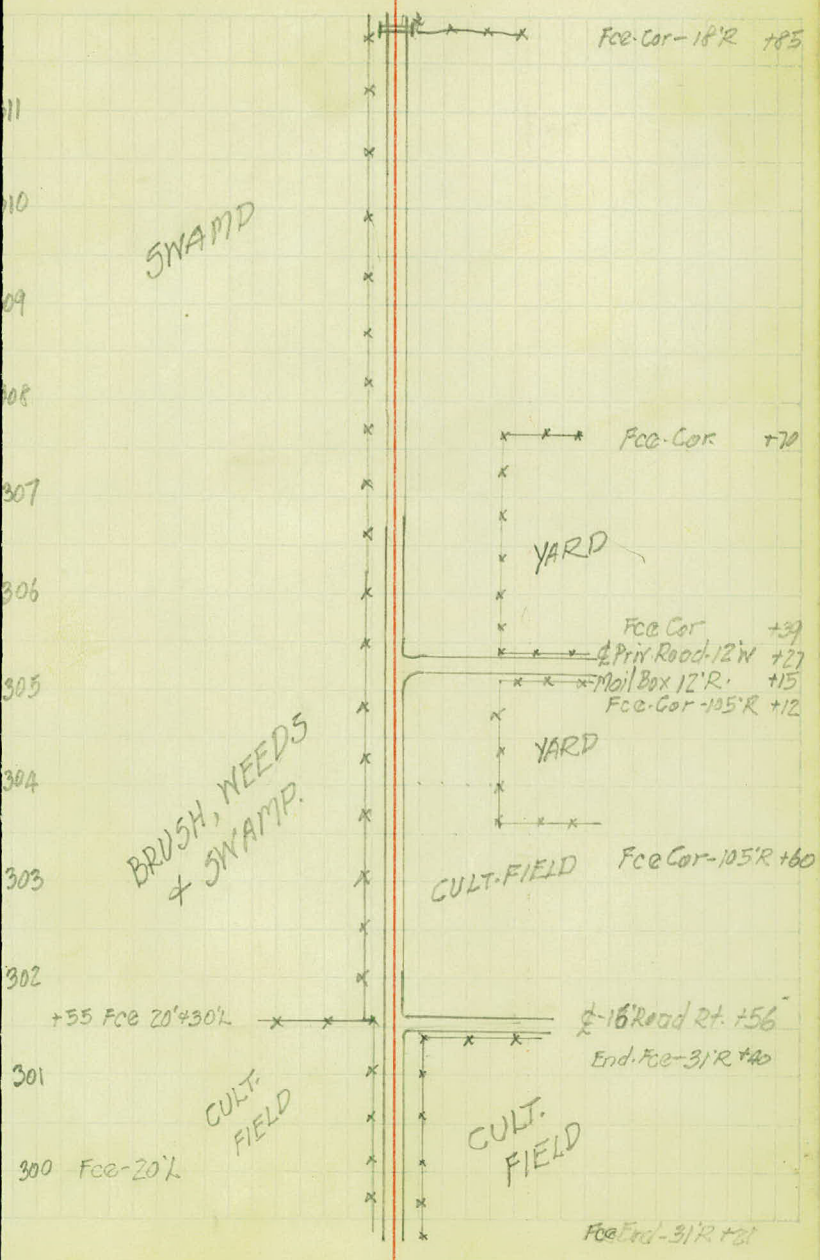

CULY- 314+76 ϕ - 30' of 24" Cor. I.P.
El. Lower Invert - 206.3

L E R

23

CULT.
FIELD

322 Fce-32'L

FceCor-25'R +05

321

BRUSH

320

PASTURE

319

318

BRUSH

317

AND

Fce-24'R +92

316

SWAMP

CULT. FIELD

315

Fce-32'L

Fce-24'R
FceCor-16'R+28'R +75

Ditch $\frac{5}{10}$

314

313

SWAMP

CULT.
FIELD

312

BRUSH

FceCor-18'R +85

CULY- ?

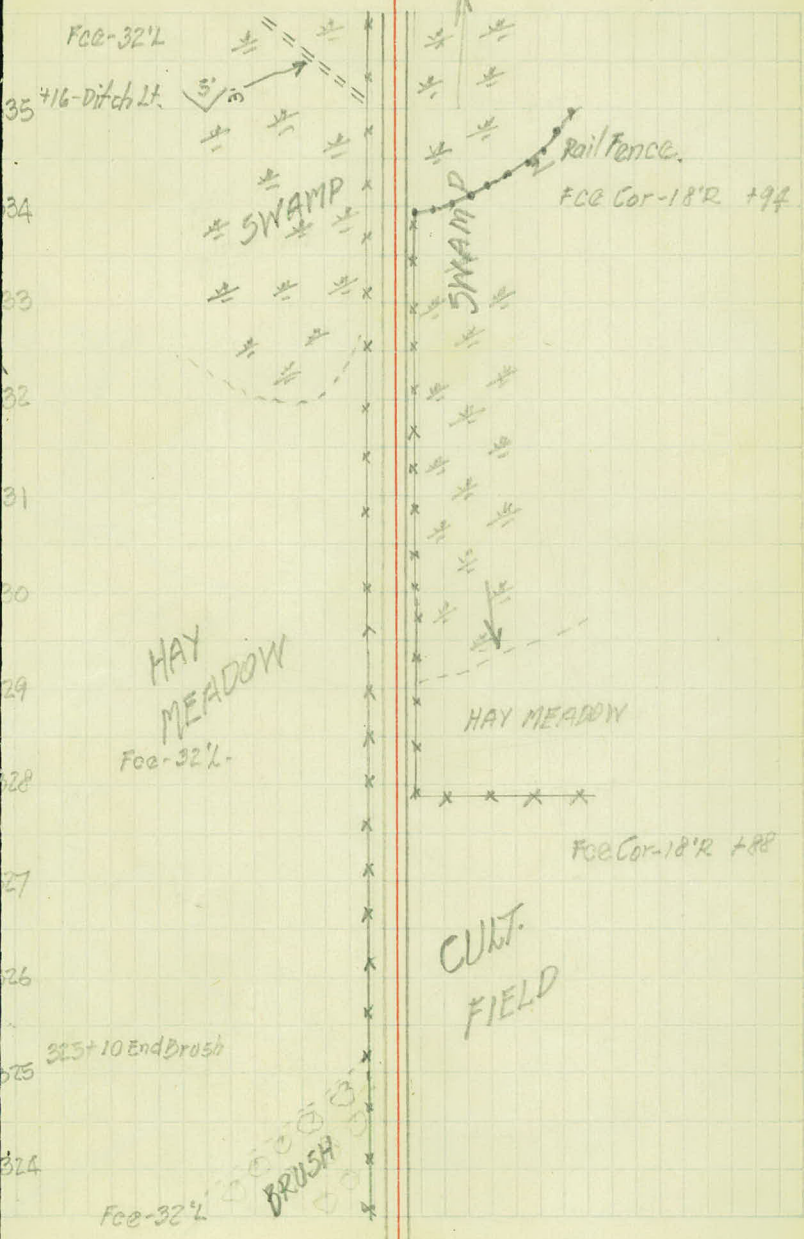

Quit sto 347+00

2/2/23

PRBanister

48
47
46
45
44
43
42
41
40
39
38
37
36

Fce-32'L

CULT.
FIELD

+100 Mail Box-16'

+22 Iron Sign P. 15'L

Fce-32'L

CULT.
FIELD

Fce-32'L

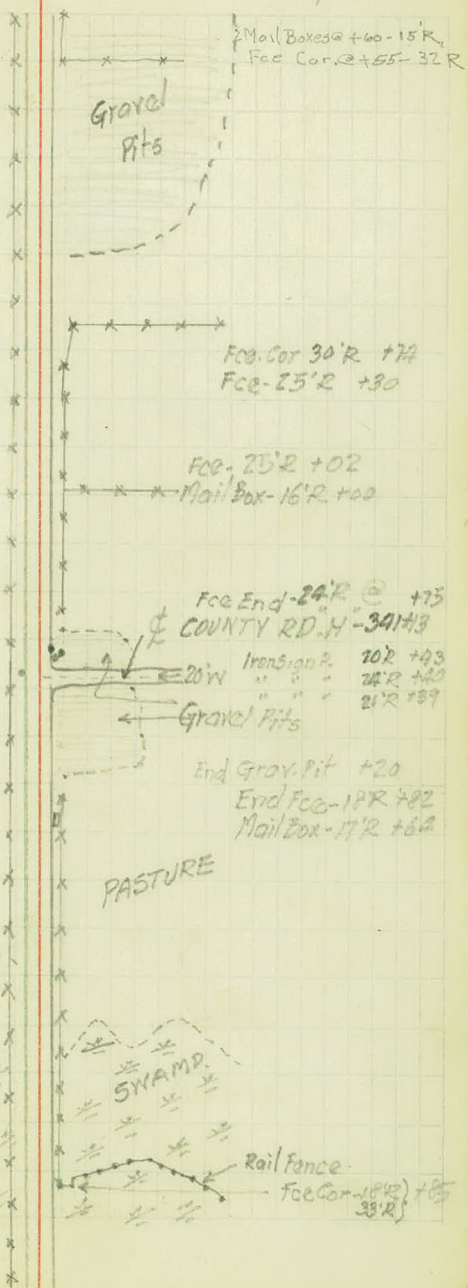

2-5-23
G. W.

L

R

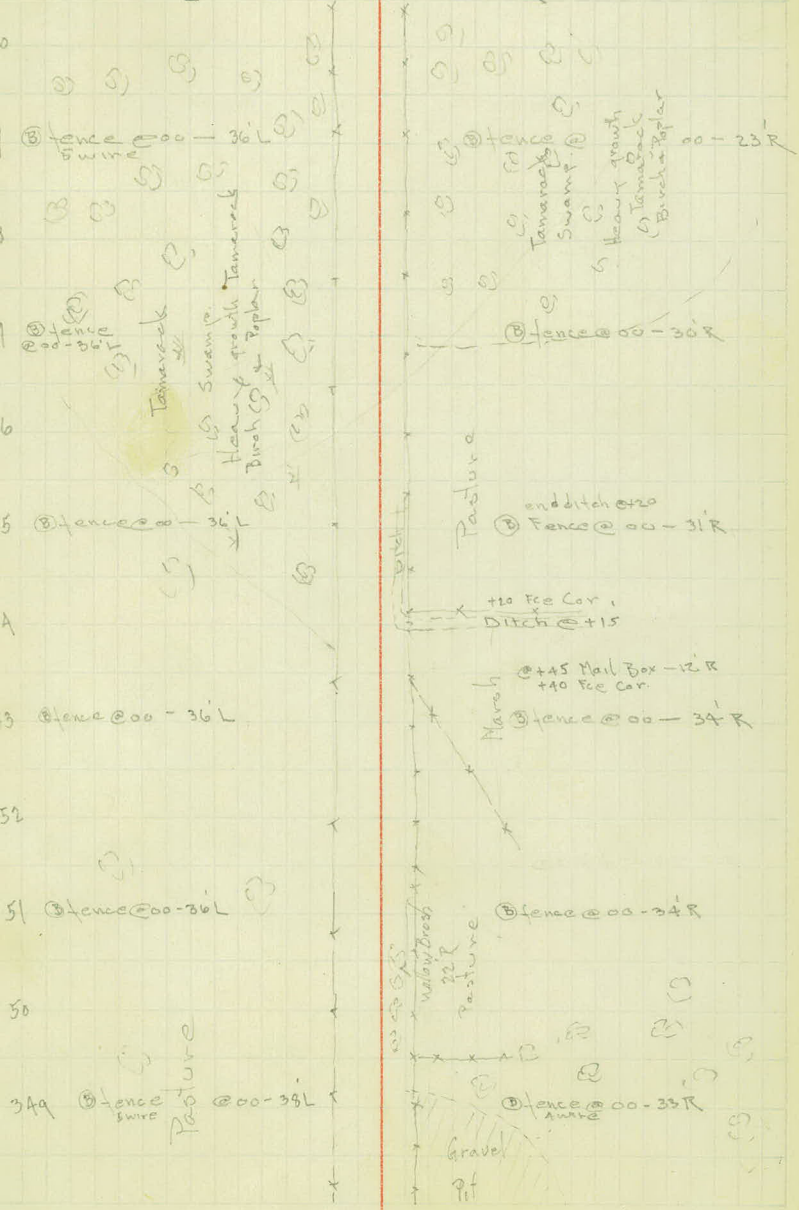

2-5-23

GR

367 + 50 15" C.I. under Rd

R.G. Line

L E R

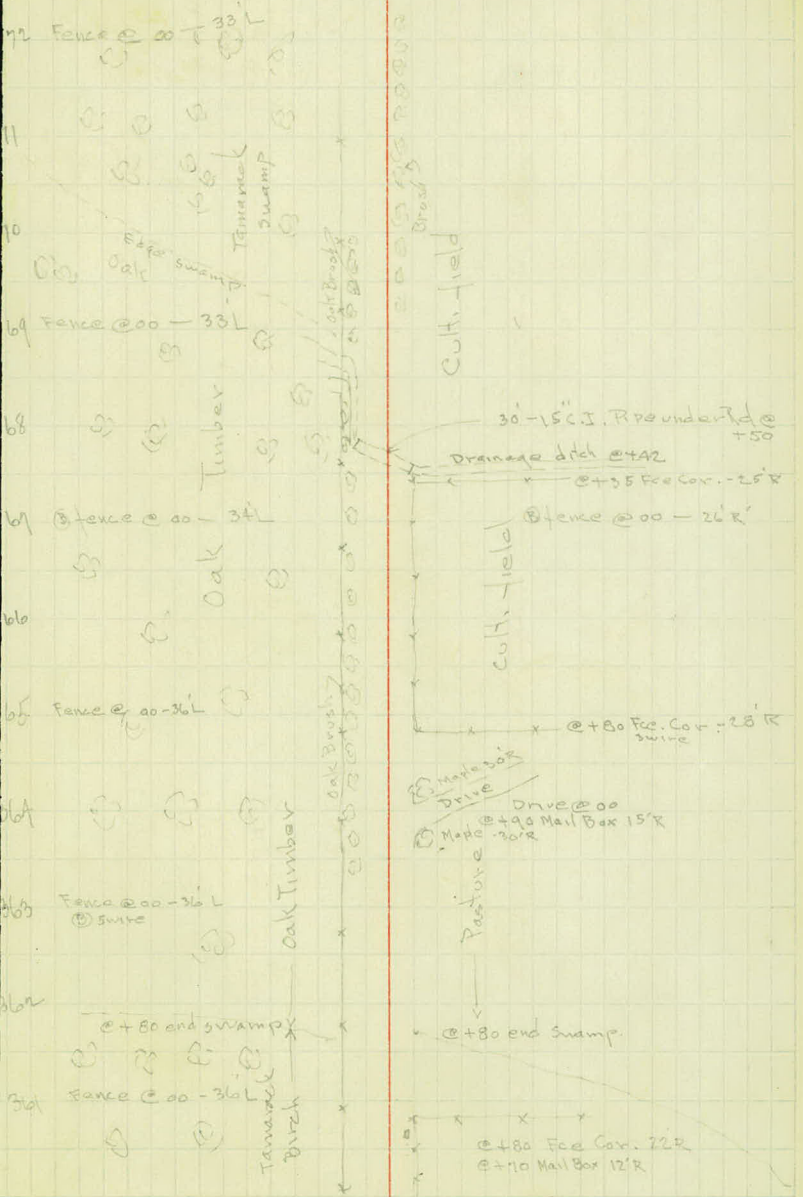

2-5-23
G.R.

Cilme L E R

64 Fence @ 00-35 L

63 Cult. field

Drive @ 00

62 Fence @ 00-35 L
swire @

@ 30 Mail Box 14 R

Drive @ + 00

60 Fence @ 00-35 L

Cult. field

Cult. field

58 Fence @ 00-35 L

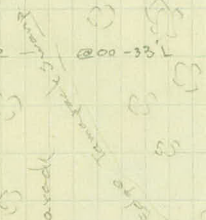

Oak Brush + Timber

76 Fence @ 00-35 L

Tamarack

Cult. field

74 Fence @ 00-35 L
swire @

oak Brush

Drive @ + 55
@ + 45 Mail Box 15 R

373 Tamarack Swamp

Willow Brush

Cult. field

2-5-23
G. R.

290710 15" vit. C (w. under Rd.)

R.C. Line

396 Fence @ 00
6 wire @

Cult. field

Cult. field

394 Fence @ 00 - 32' L

@ + 50 Road

392 Fence @ 00 - 34' L

Willows

Cult. field

Cult. field

Fence @ 00 - 35' L

Willow Brush

Cult. field

388 Fence @ 00 - 35' L

Fce. Cor @ 00 - 17' R

Pasture

386 Fence @ 00 - 34' L
4 wire

Fce. Cor @ + 25 - 17' R 3 wire

Pasture

385 Cult. field

2-5-23
G.R.

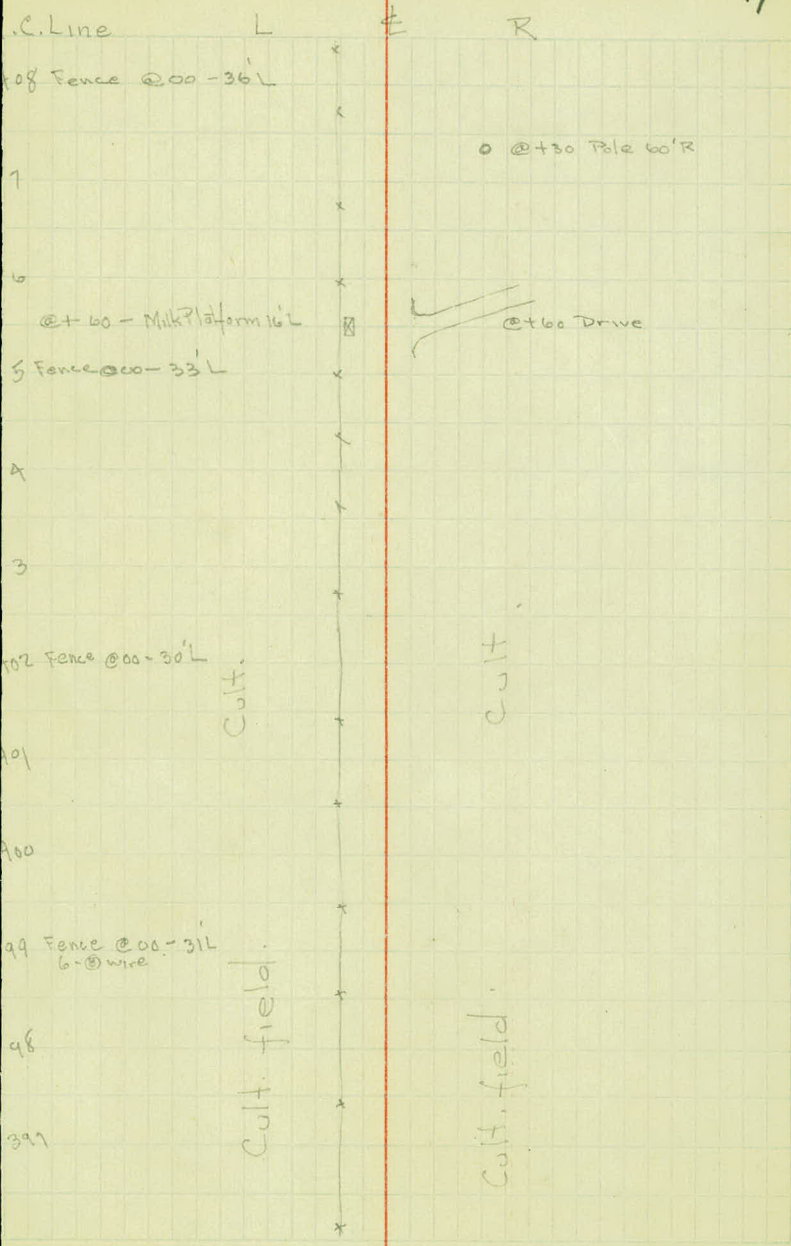

2-5-23
G.R.

R.C. line L C E R

Cult. field

Anoka Co

Anoka Co

12 +95 Fce Cor. 22'L

+25' Otter Lake Rd
• +80 Pole - 35'R

11 Fence @ 00-24'L

• Cult. field Pole @ +80 - 33'R

10 North Oaks Farm Cult. field

Light oak

A09 Fence @ 00-24'L
6 wire @

• @ +45 Pole - 35'R

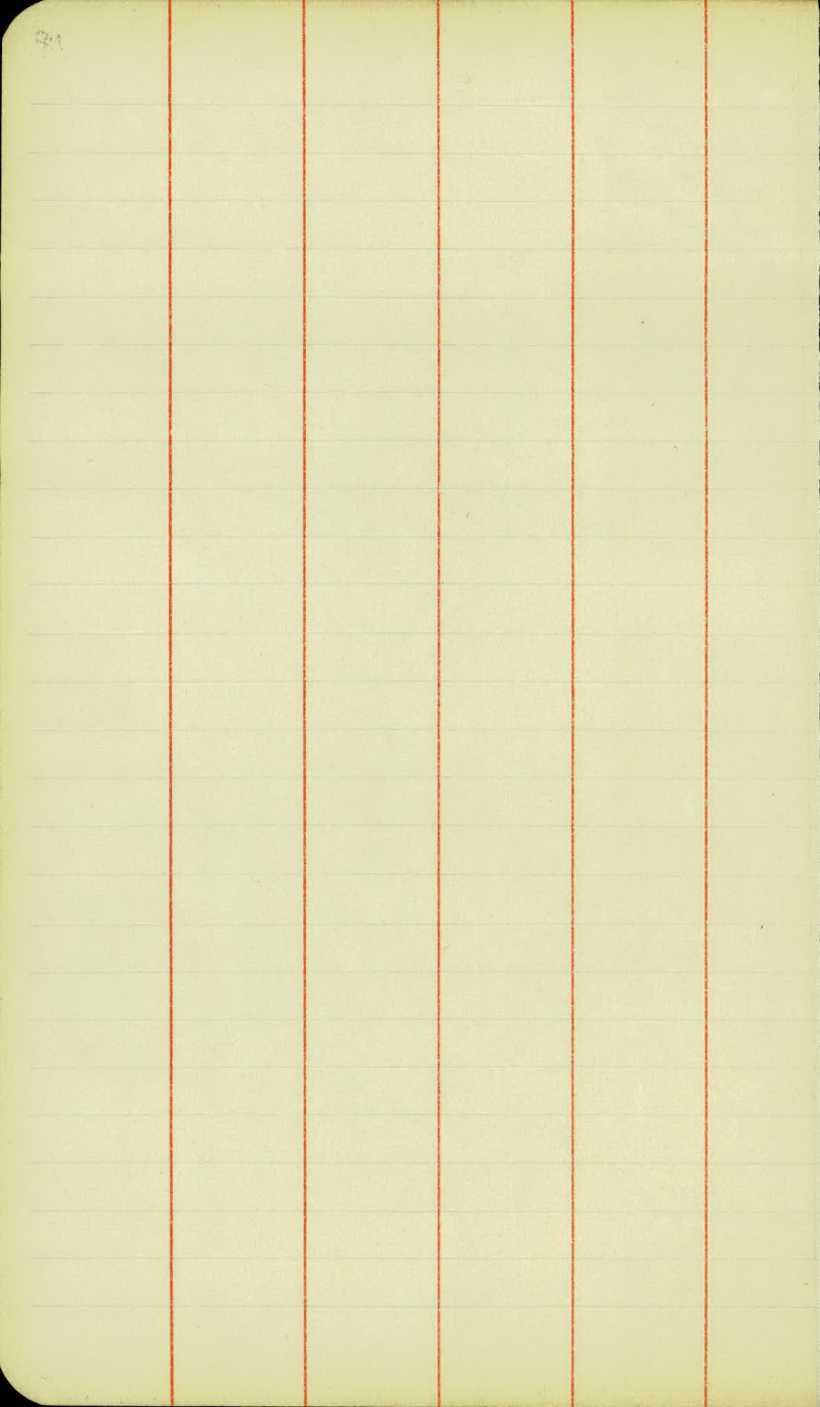

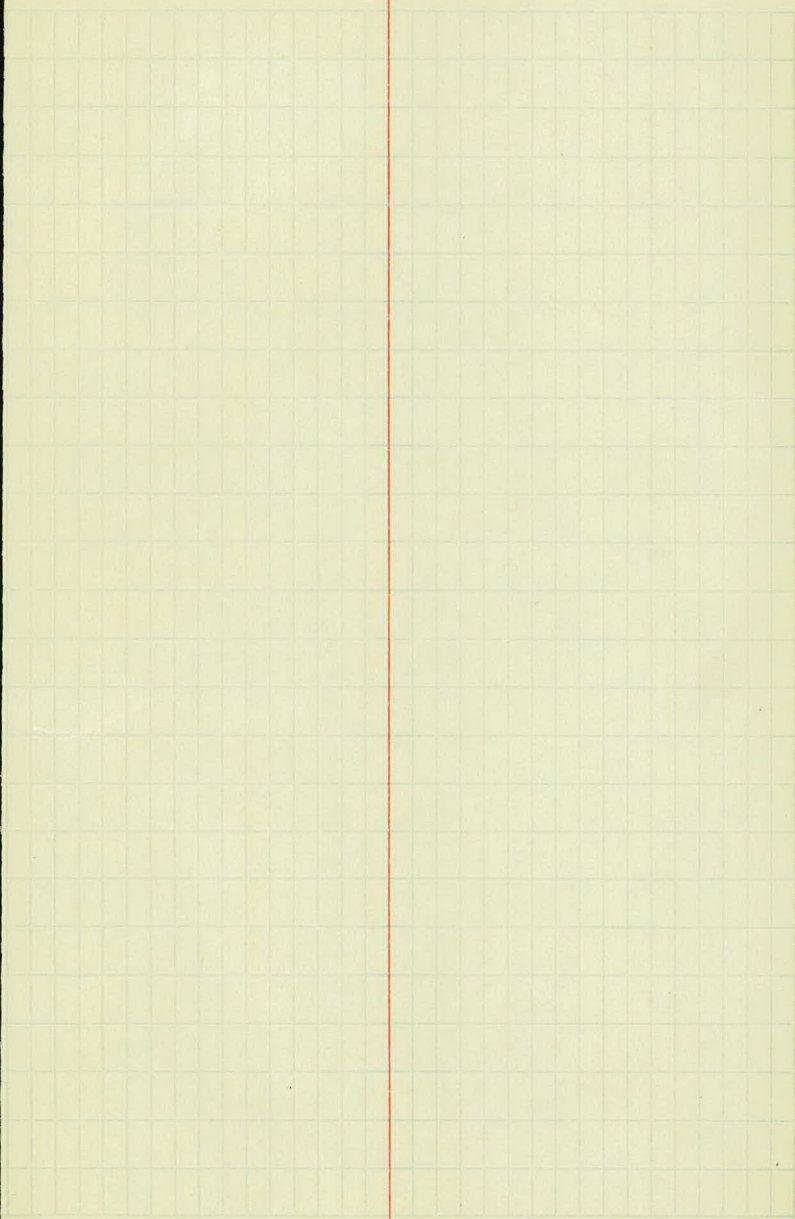

ELINE

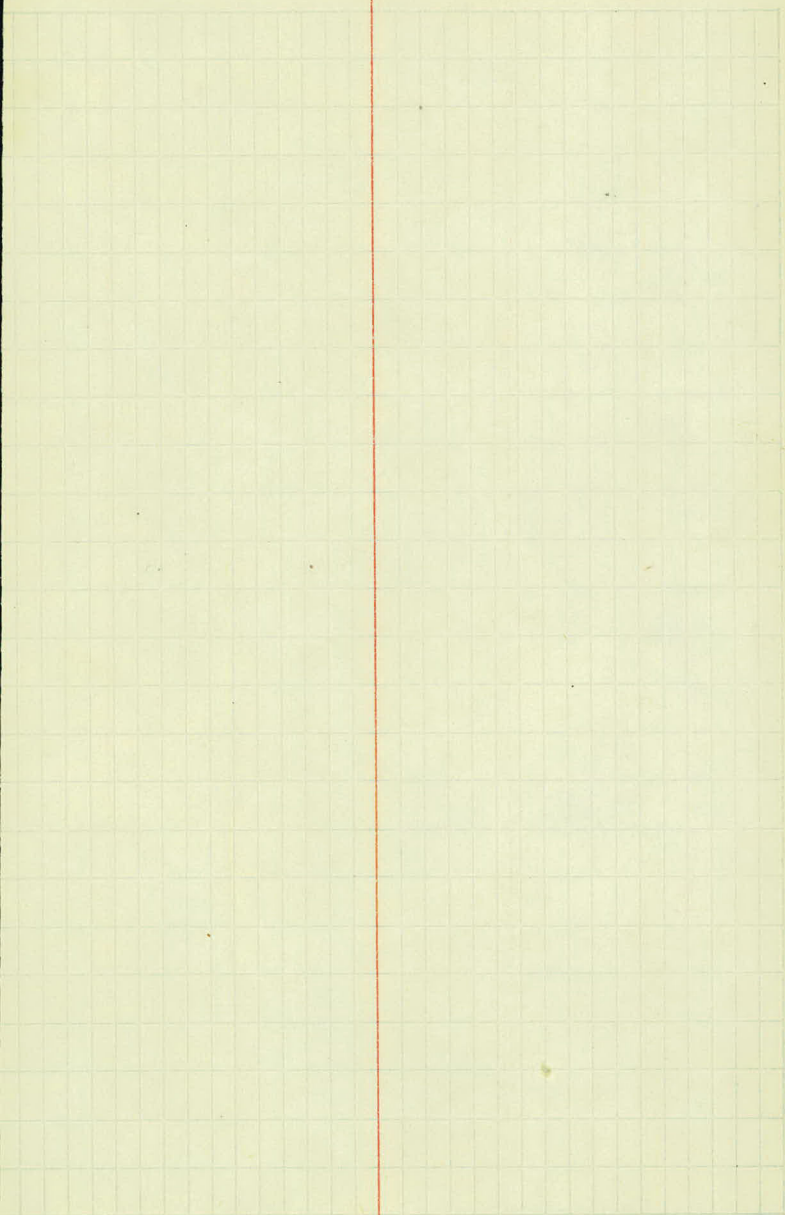

RC LINE

DATE	1923	Job	N ^o
Sta.	PRESENT	Culv.	Recommended
28+40	32'-15"	Vit. P.	

40+21 (2) 58'-18" Vit. Pipe

91+10 47'-15" Vit. Pipe

108+15 44'-12" Vit. P.

144+35

172+37 37'-15" Cor. 1. Pipe

181+35 45'-12" Cor. Pipe

193+33 40'-15" Cor. Pipe

IV. El. 186.15

DRAINS R.

IV. El. 186.40

DRAINS R.

IV. El. 209.1

DRAINS R.

IV. El. 197.4

DRAINS R.

IV. El. 187.80

DRAINS R

St. Paul City Water Main

IV. El. 218.3

DRAINS L.

IV. El. 216.3

DRAINS L.

IV. El. 218.2

DRAINS L

RC LINE

Date 1923 Job No

Sta. PRESENT Culv. Recommended Culv.

196+85 38'-15" C.I.

221+51 50'-15" Cor. Pipe

224+48 48'-15" Cor. Pipe

232+12 50'-15" Cor. Pipe

260+75 55'-15" V.T.P.

265+43 50'-12" V.T.P.

311+86 35'-24" Cor. 1 Pipe

314+76 30'-24" Cor. 1 Pipe

NY. El. 219.0

DRAINS L

NY. El. 236.9

DRAINS R

NY. El. 240.05

DRAINS L

NY. El. 247.8

DRAINS R

NY. El. 252.0

DRAINS R

NY. El. 254.2

DRAINS R

NY. El. 203.7

DRAINS L

NY. El. 206.3

DRAINS L

RC LINE

Date 1923 Job No

Sta. PRESENT Culv Recommended Culv

367+50 30'-15" C.I.

390+10 35'-15" Vit. Pipe

MacDonald - Notes
Maloney - H. Level.
Reiling - Rod.
Carr. - Chain.

39

IV. El. 260.3

DRAINS L

2/7/23

IV. El. 227.9

DRAINS

NOTE

RECOMMEND Culv. at Sta. 65+35

" " at " 120+75

This List Does Not Include
Private Rd. X-ings or Intersecting Rd. X-ings

ARTIFICIAL Topography
ON SC LINE

Began 2/8/23

Persons Notes

W. Maloney - Ch.

L

R

FLP.
W. M. HLOVY

START - 2-8-23. $\frac{1}{2}$



+80 TREE 30'

+66 TREE 30' R

+21 T.P. 21-L

+21 T.P. 30' R

FENCE COR - 25' L
+94 FENCE COR
+85 T.P. 21'

+10 TREE 25' R

+21 MAIL BOX + FENCE COR

VOID

Fence 30' PRB

+70 T.P.

+09 MAIL BOX
+90 T.P. 18' L 15'

+76 TREE 30' L

+80 IRON SIGN POST - 22' L

+72 IRON SIGN POST 20' L

+

+11 IRON SIGN POST

+00

+91 Fce - 19' R

+88 Wood Sign 20' R

+63 IRON SIGN 17' R

+51 T.P. - 22' R

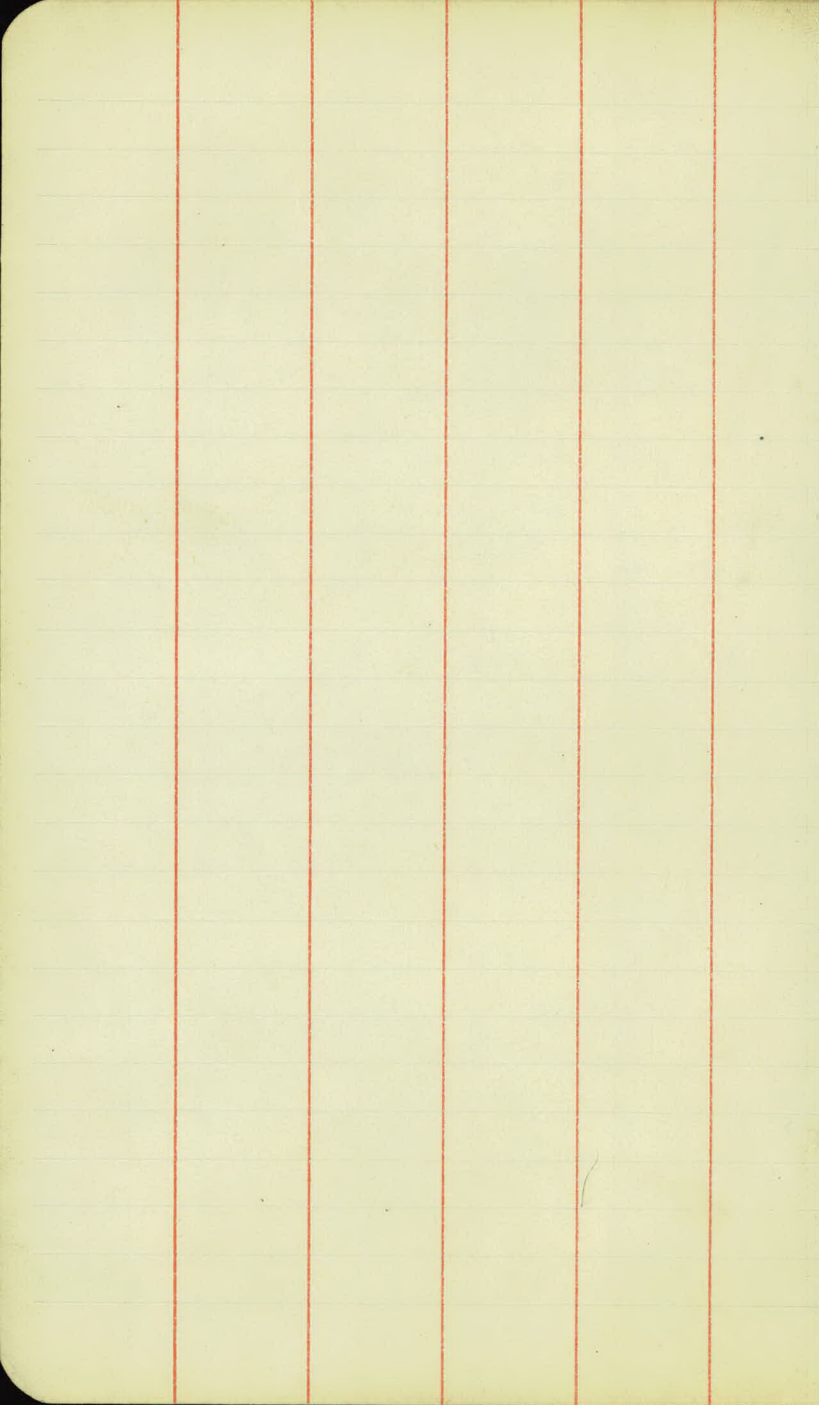

L

E

R

+45 Xing sign 21'

+85 Guard Rail 10'

+60 Guard Rail 10'

+60 Fence Cor 20'

+18 T.P. 18'

+45 Fence Cor 40'

+45 Fence Cor 30'

+84 T.P. 21'

+50 T.P. 21'

N.P. RR. +22 Xing sign 18' R
+20.75 North Track
+22 South Track

+95 Guard Rail 10'

+39 Guard Rail 10'
+39 Fence Cor 30'

VOID

PRB

Fence 30'

+5 Tree 30'

Fence 30'

+68-FENCE 30'

+50 TREE 30'

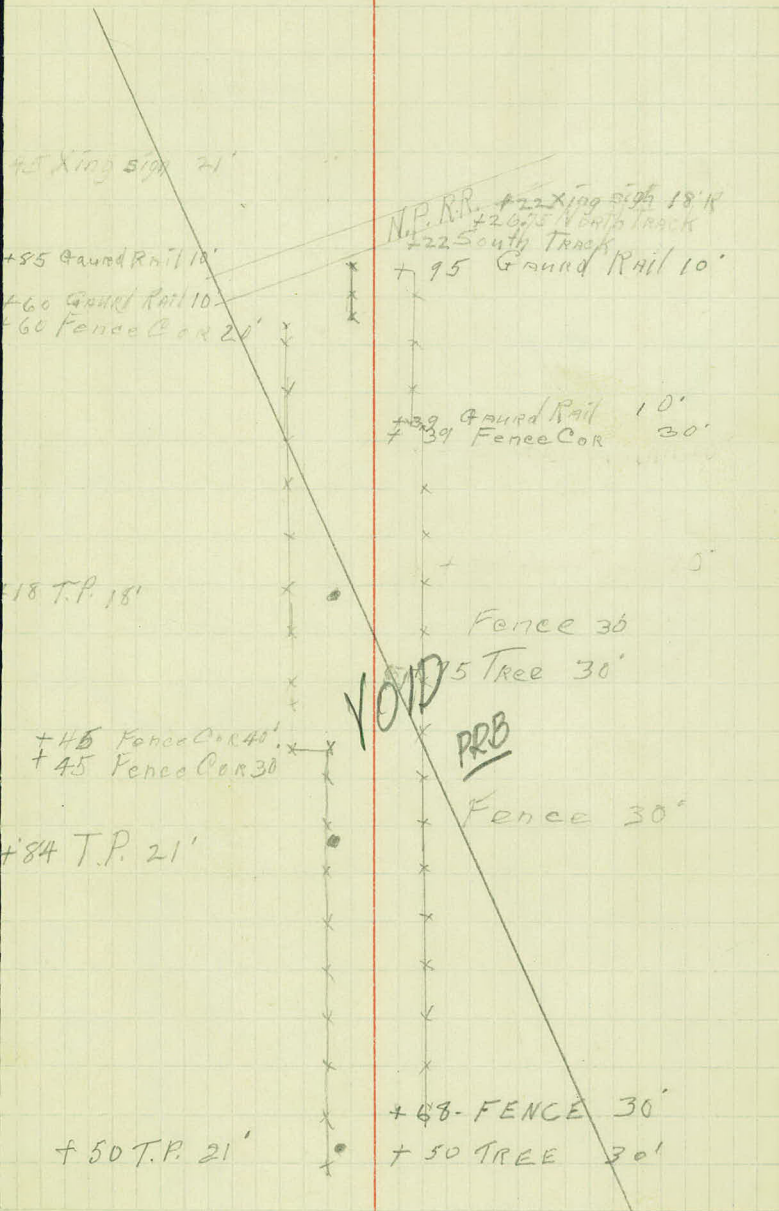

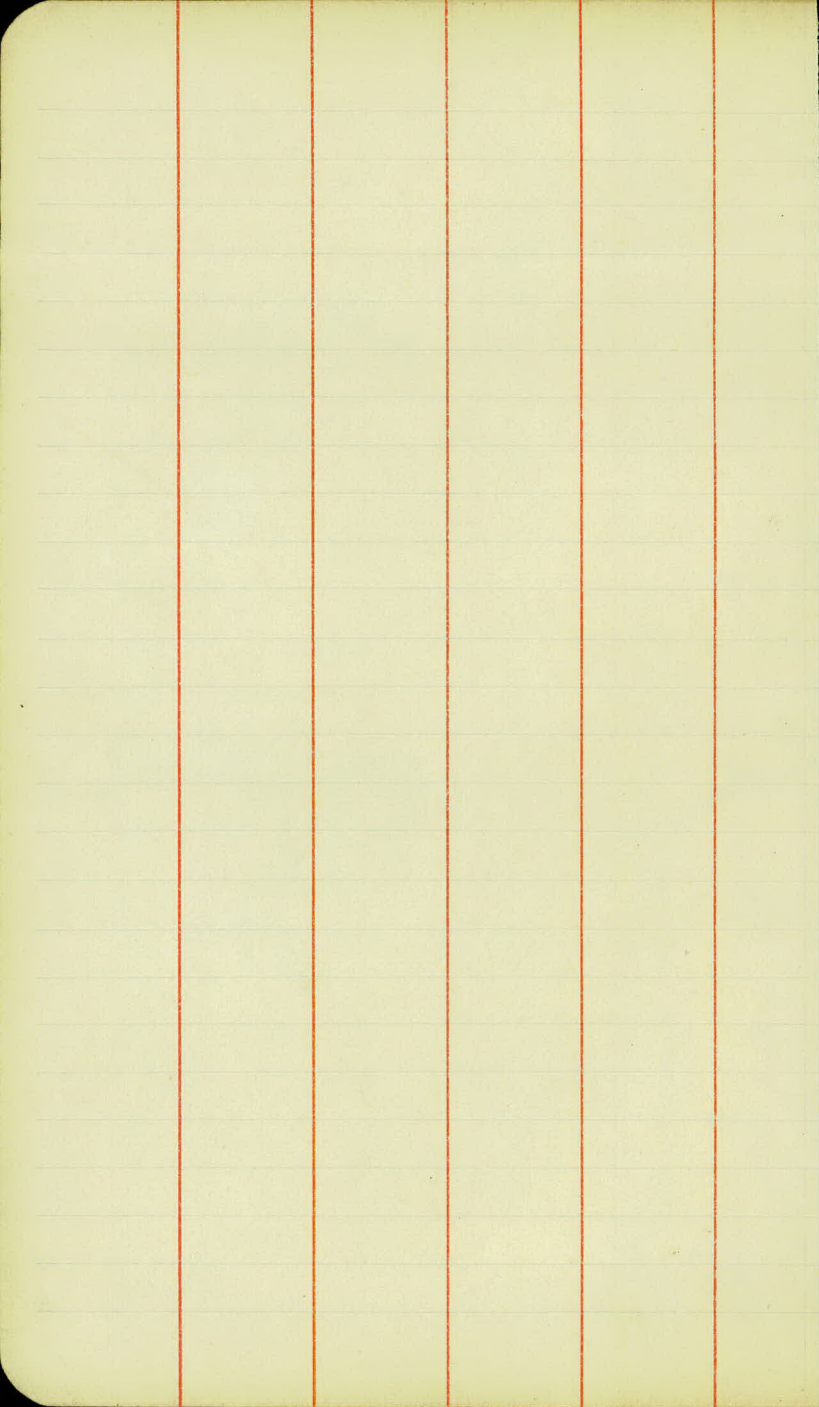

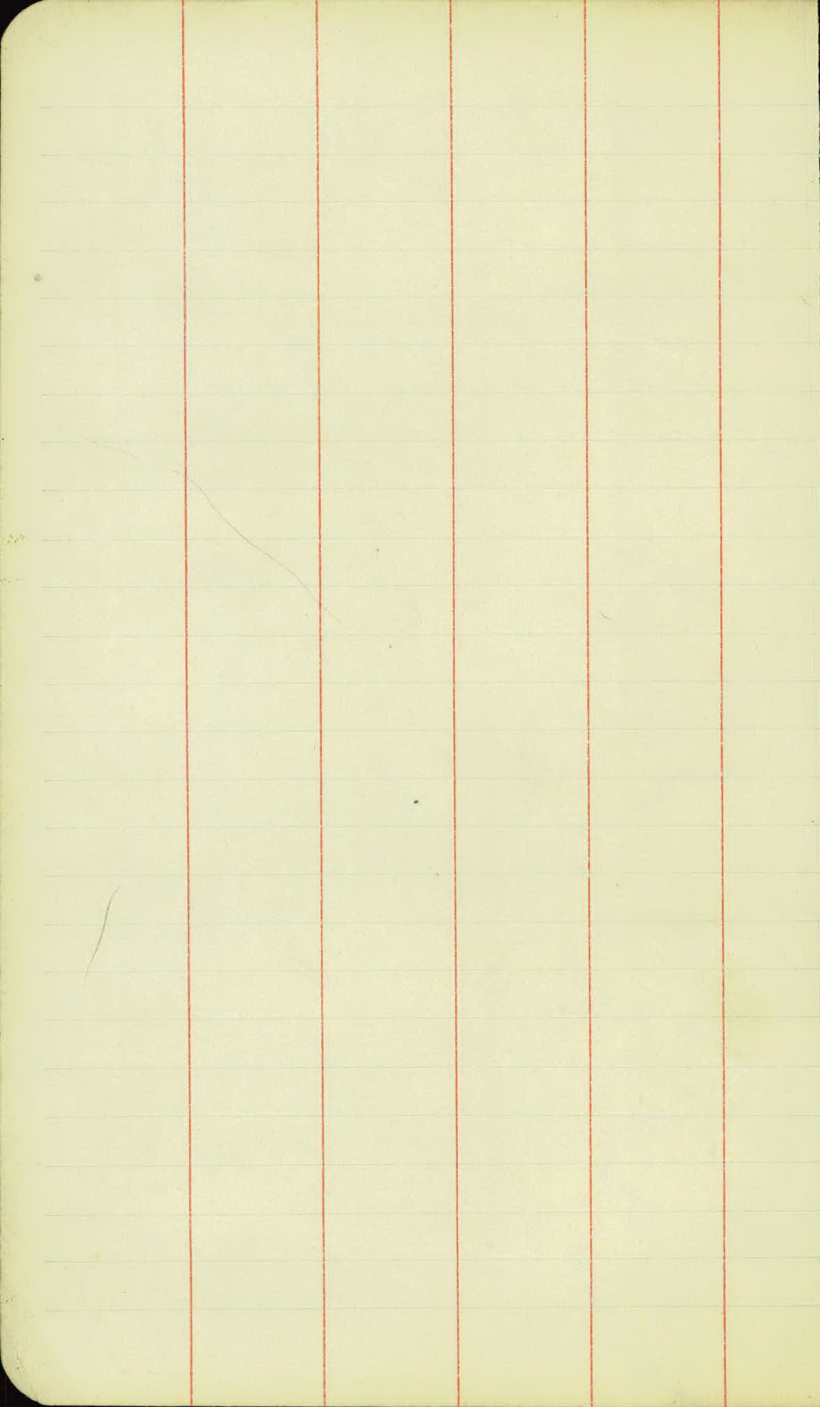

L

E

R



• +85 T.P. 21'

FENCE 30'

• +50 T.P. 21'

FENCE 30'

95 MAIL BOX 8'

⊙ 35 TREE 21'

VOID

• +24 T.P. 18'

PRB

8 TREE 21'

○ +55 TREE 21'

FENCE 28'

• +85 T.P. 18'

+60.G.P. 18'

• +60 T.P. 15'

08 COR FENCE Post 28'

19.5
15

54.5

HLP

R

L

STARTED. 2-9-23.

FENCE 30'

FENCE 39'

+60-HIGHWAY-SIGN.

FENCE 33.

T.P. 21'

VOID
PRB

+75 T.P. 21'

+33 FENCE COR. 33'

FENCE 33'

+40 T.P. 21'

+76 TREE 21'

+10 T.P. 21'

+86 MAIL BOX 12'

+60 TREE 21'

+30 TREE 21'

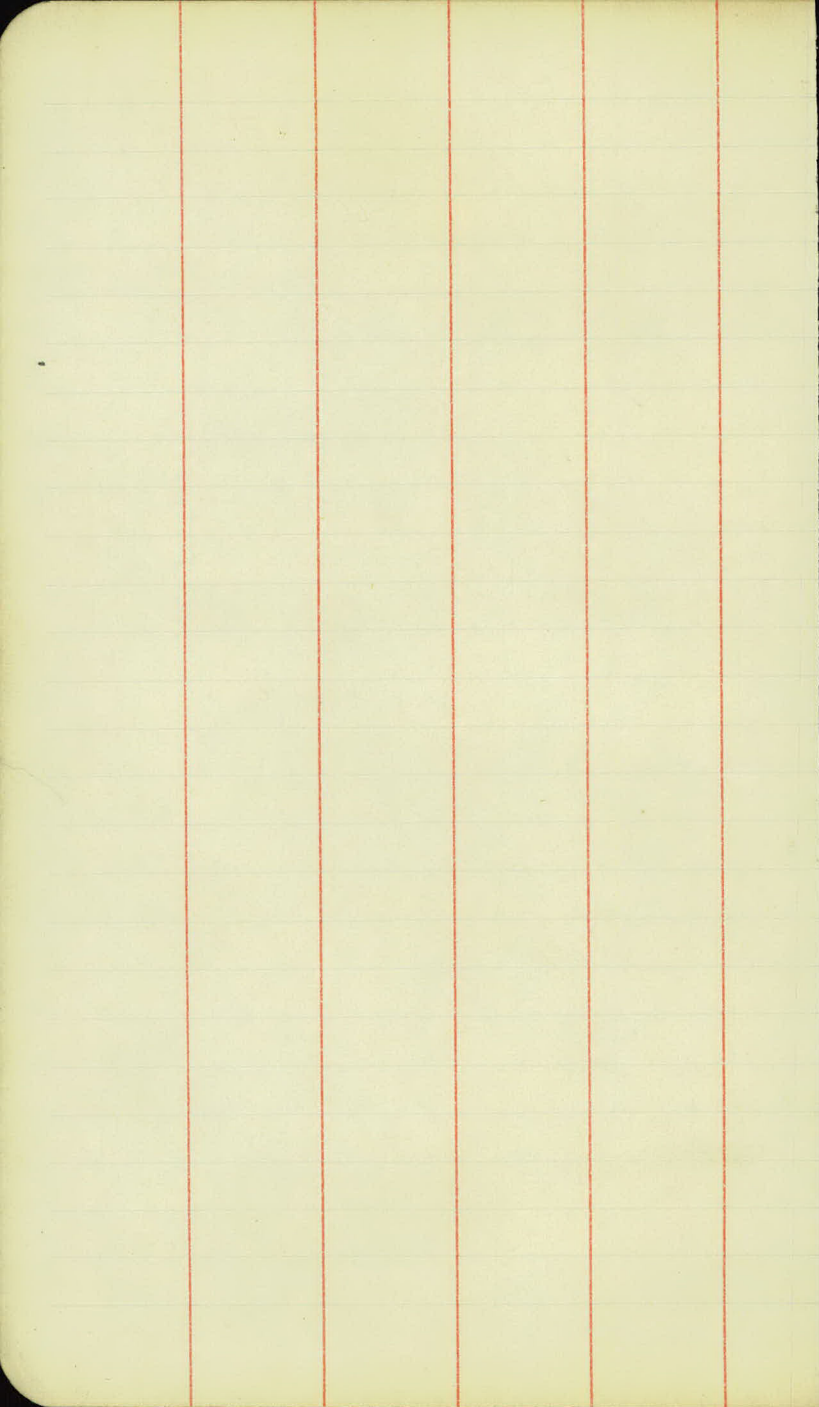

L

E

R.

~~KOEHLER ROAD.~~

66. END OF FENCE 30'

60. MAIL BOX 15' * * *

FENCE 30'

+20 T.P. 21'

12. IRON SIGN POST 15'

+21. COUNTY ROAD E.

* * FENCE COR. 34'

* +94. T.P. 21'

~~VOID~~

~~PRB~~

FENCE 30'

FENCE 34'

* +81. T.P. 21'

FENCE 30'

FENCE 34'

* +54 T.P. 21'

FENCE 30'

FENCE 34'

* +24 T.P. 21'

3

L

R

FENCE 28'

T.P. 22'

99 FENCE COR. 28'
98 T.P. 22'

• T.P. 20'
+ 60 SHRUB 21'

+ 21 T.P. 21'

VOID

27 TREE LINE 33'

+ 18 SHRUB LINE 21'
+ 07 T.P. 30'

+ 88 END OF FENCE 30'

FENCE 30'

• + 88 T.P. 21'

FENCE 30'

+ 56 IRON SIGN POST 18'

30 FENCE COR. 30'
30 IRON SIGN POST 22'

• 43 T.P. 21'

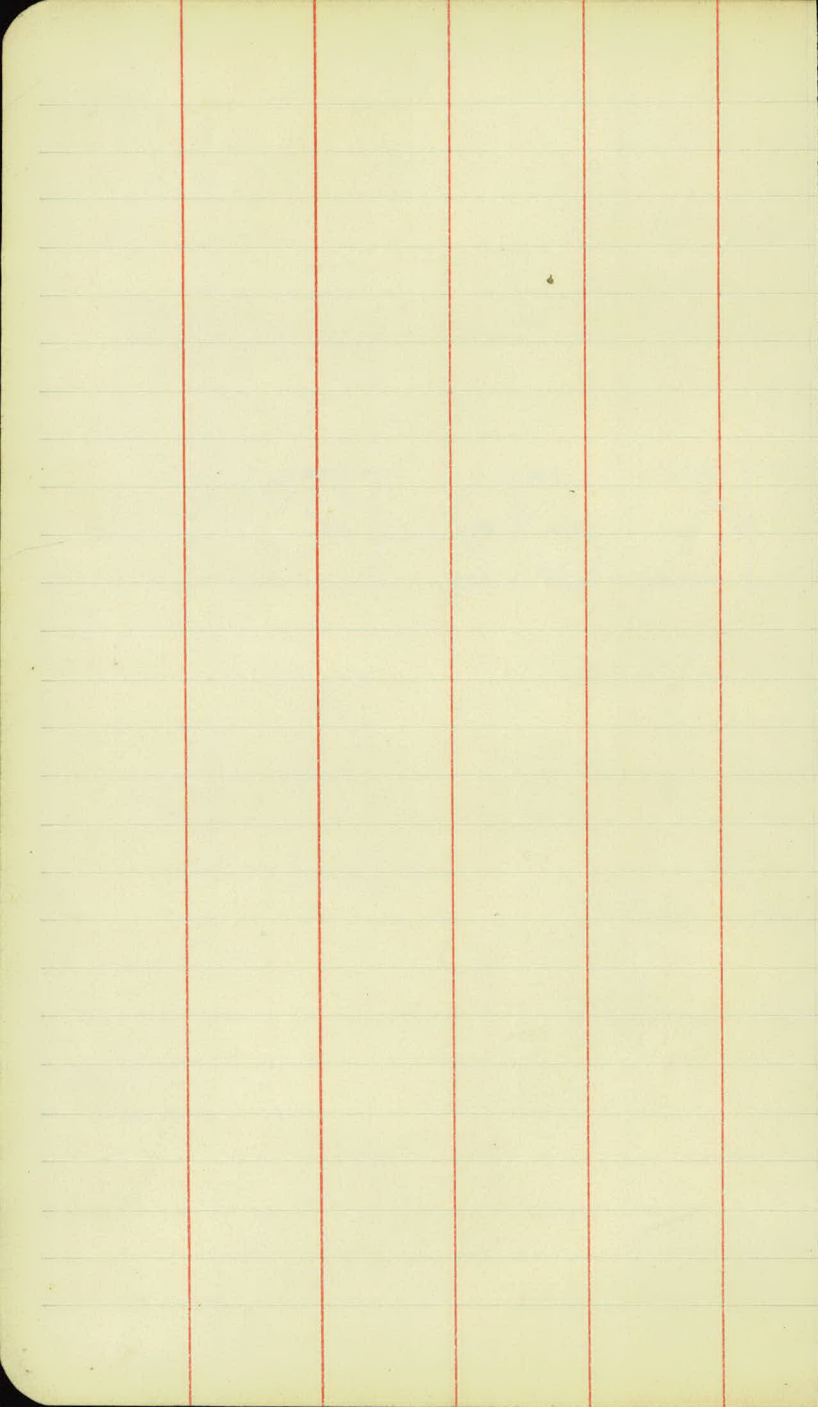

L

R

FENCE 28'

FENCE 28'

FENCE 28'

+12 IRON SIGN POST 12'
FENCE 28'

VOID PRB

+87 T.P. 21'
+75 END OF FENCE

DRIVEWAY TO HOUSE

+63 T.P. 21'

FENCE 22'

+40 FENCE COR 22
+39 T.P. 21'

+21 T.P. 21'

(C) TREE 29'

(C) +45 TREE 29'

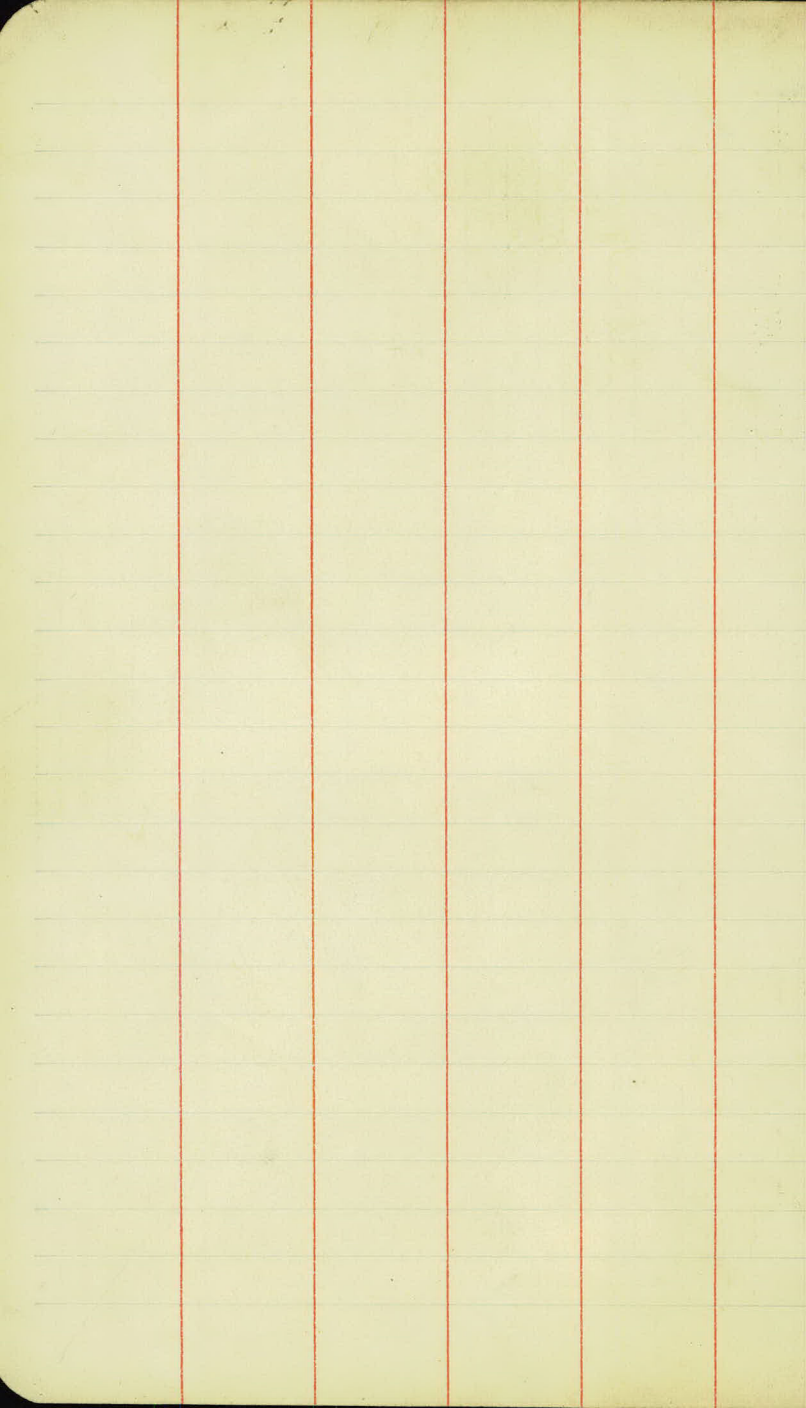

± Road 97
± Road-95
60 T.P. 84

± Road-75
Fce 105
82 T.P. 47

± Rd
60 T.P. 16 L

± Old Rd-29 L
Fce 65 L

± T.P. 4 L
± T.P. 41 L
± Old Rd-16 L
Fce 48 L

± Old Rd-6 L
+90 Fce-35 L

+ 33 T.P. 18
- FIELD -

+ 12 T.P. 21

VOID PRB

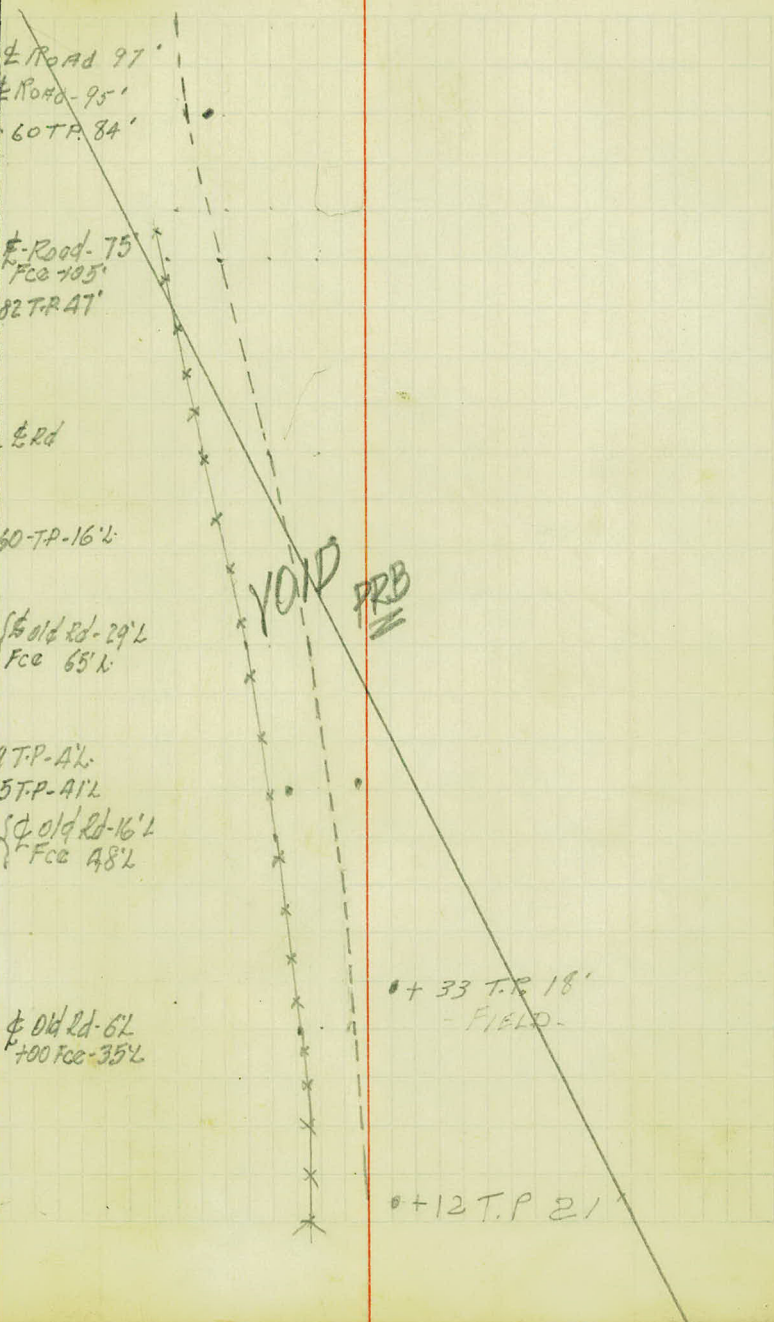

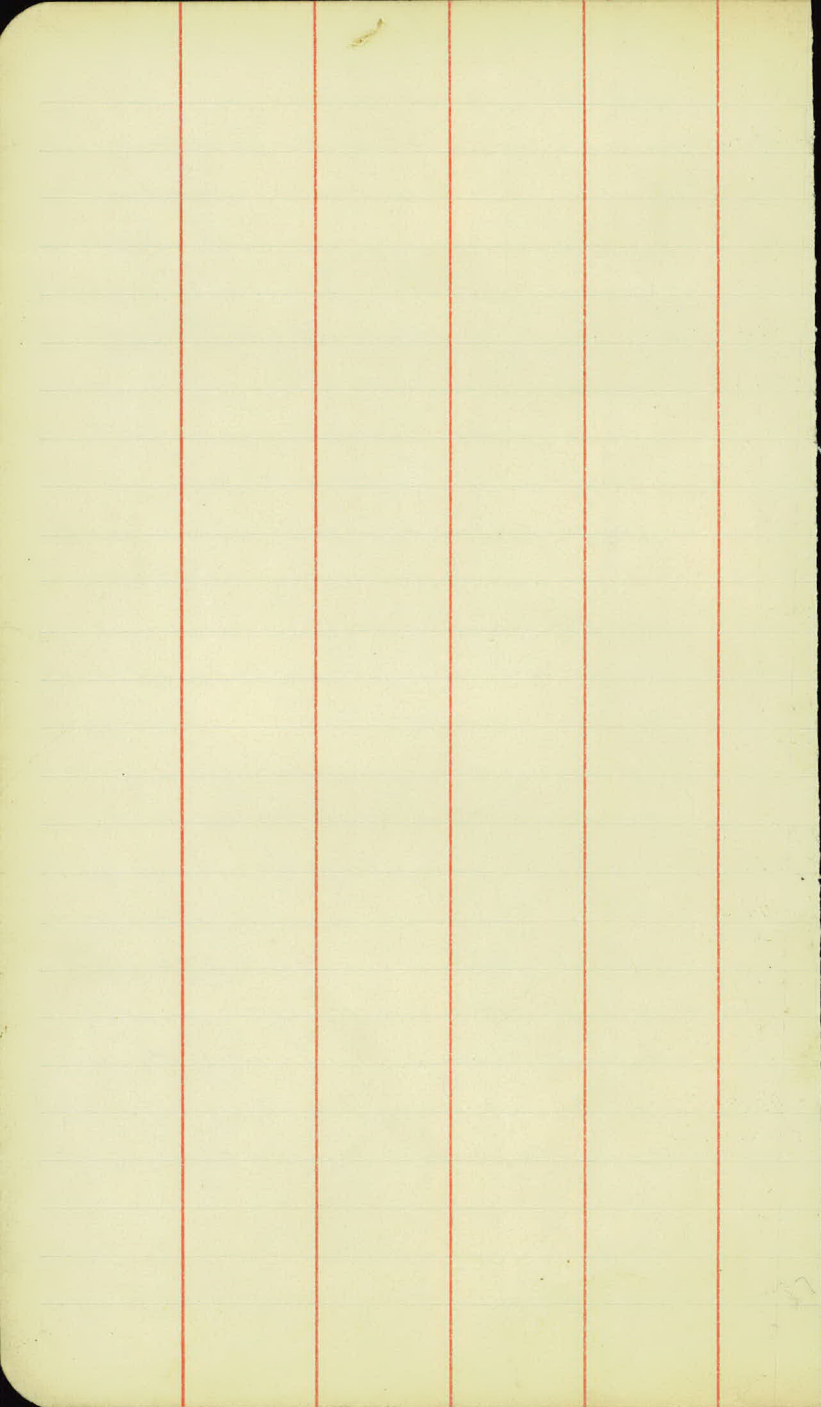

L

R

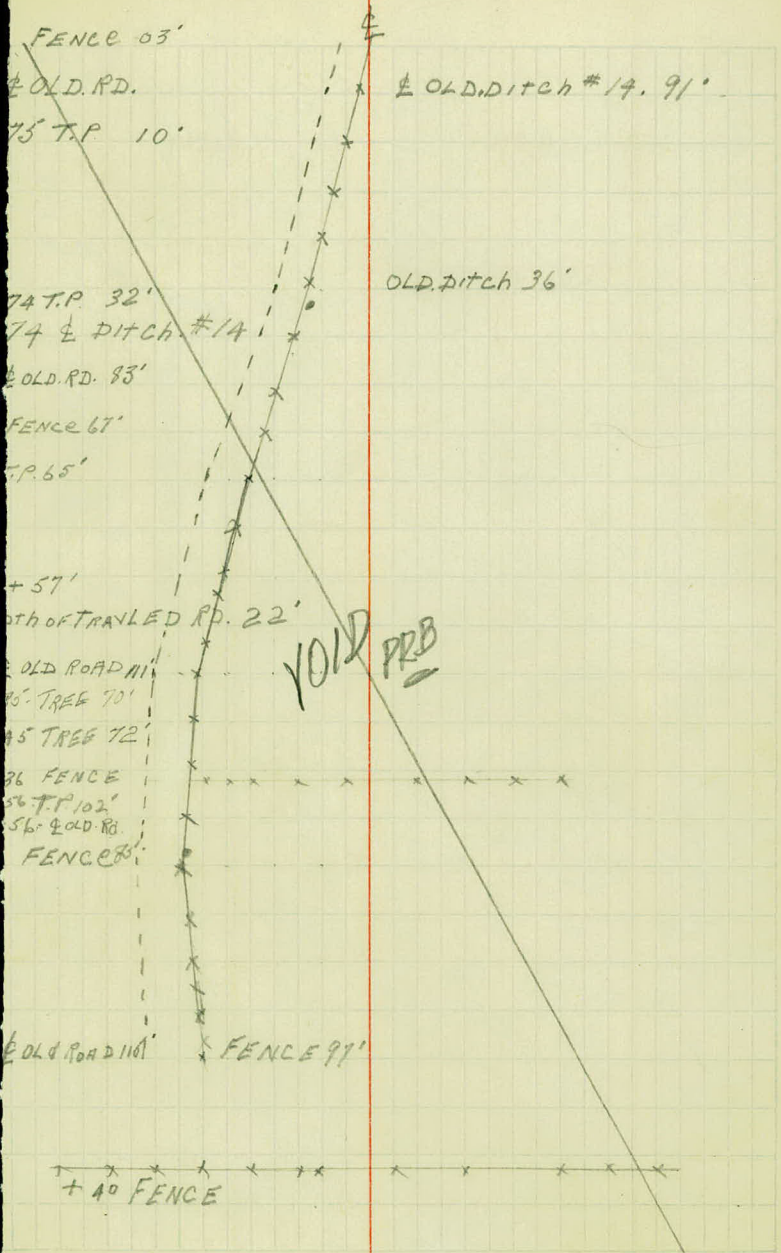

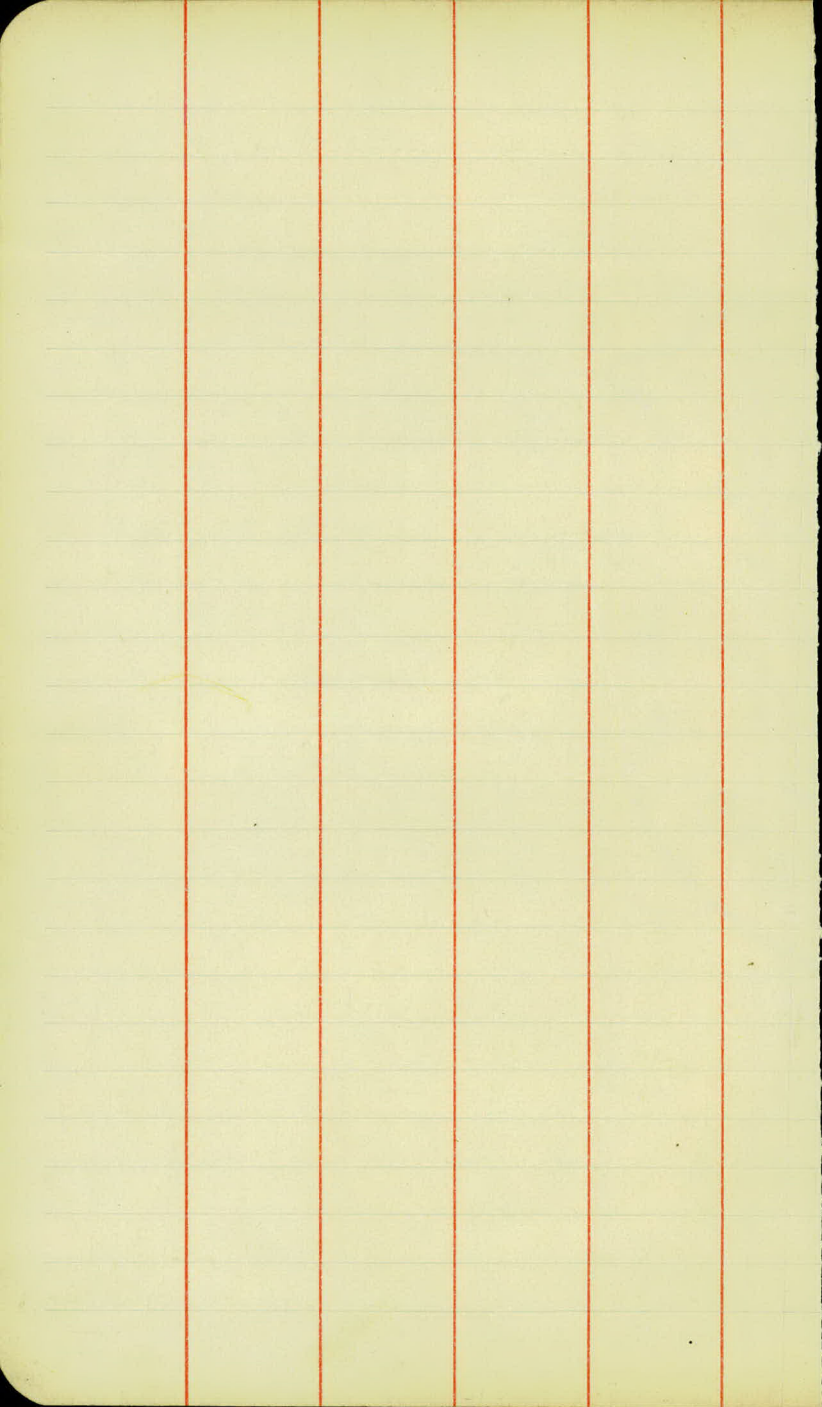

L

R

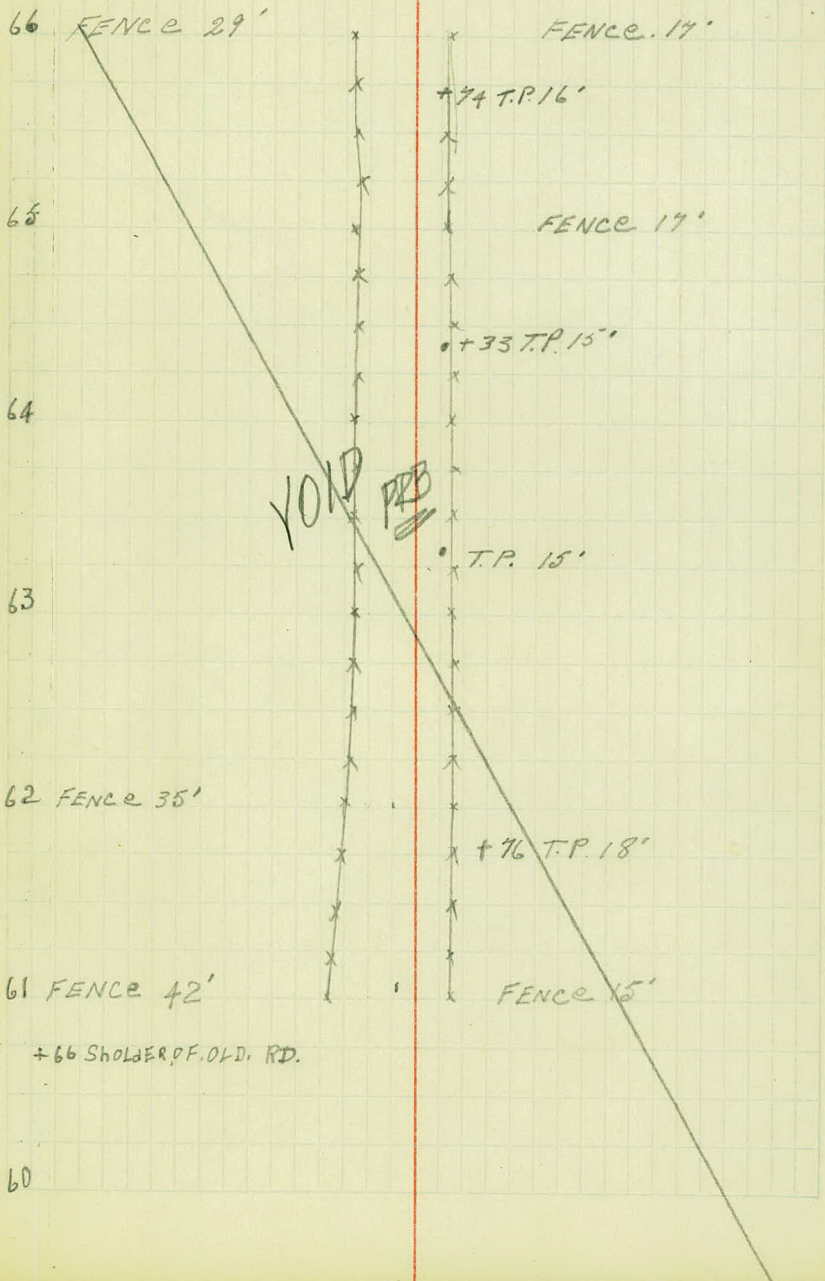

66 FENCE 29'

FENCE 17'

+74 T.P. 16'

65

FENCE 17'

+33 T.P. 15'

64

YOLD RD
PRD

T.P. 15'

63

62 FENCE 35'

+76 T.P. 18'

61 FENCE 42'

FENCE 15'

+66 SHOULDER OF OLD RD.

60

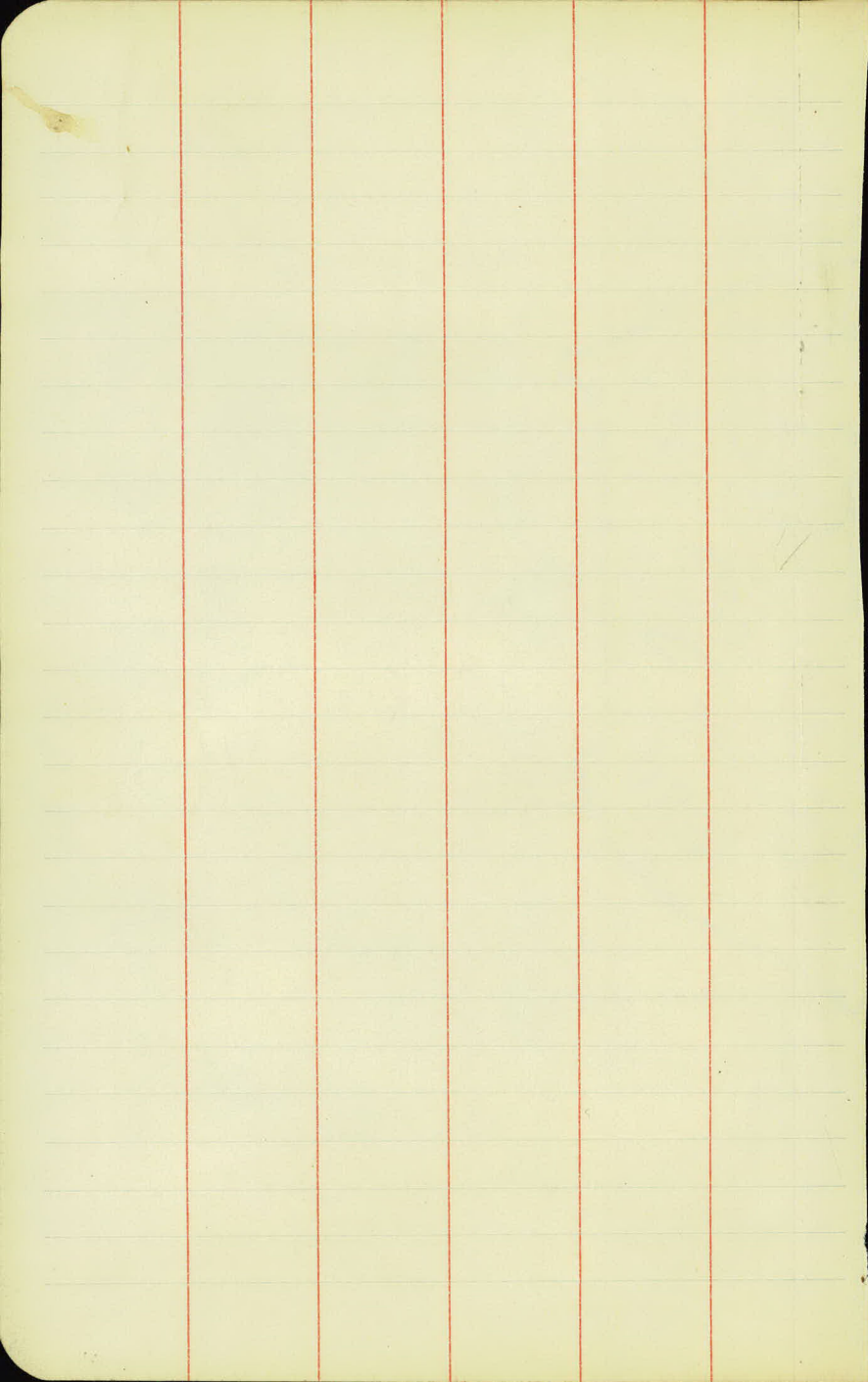

L

R

HLP.
WM

2-10-23

72 FENCE 28'

+24 LINE OF TREES 12'

FENCE 21'

+88 TREE 12'

+78 " 12

TREE 22'

70 FENCE 27'

69 FENCE 30'

68 FENCE 32'

67 FENCE 30'

66

FENCE 30'

+95 T.P. 21'

+78 T.P. 24'

FENCE 27'

+62 T.P. 21'

FENCE 30'

+35 T.P. 27'

FENCE 40'

+60 FENCE 40'

+60 T.P. 29

FENCE 50'

+89 T.P. 25

VOID PRB

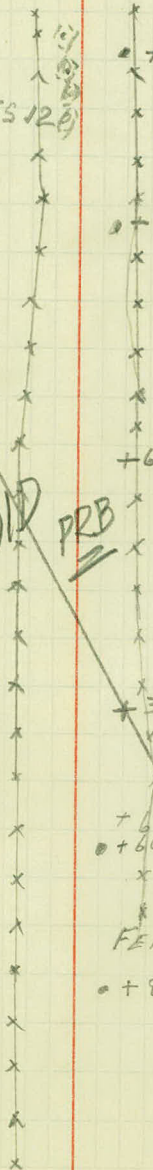

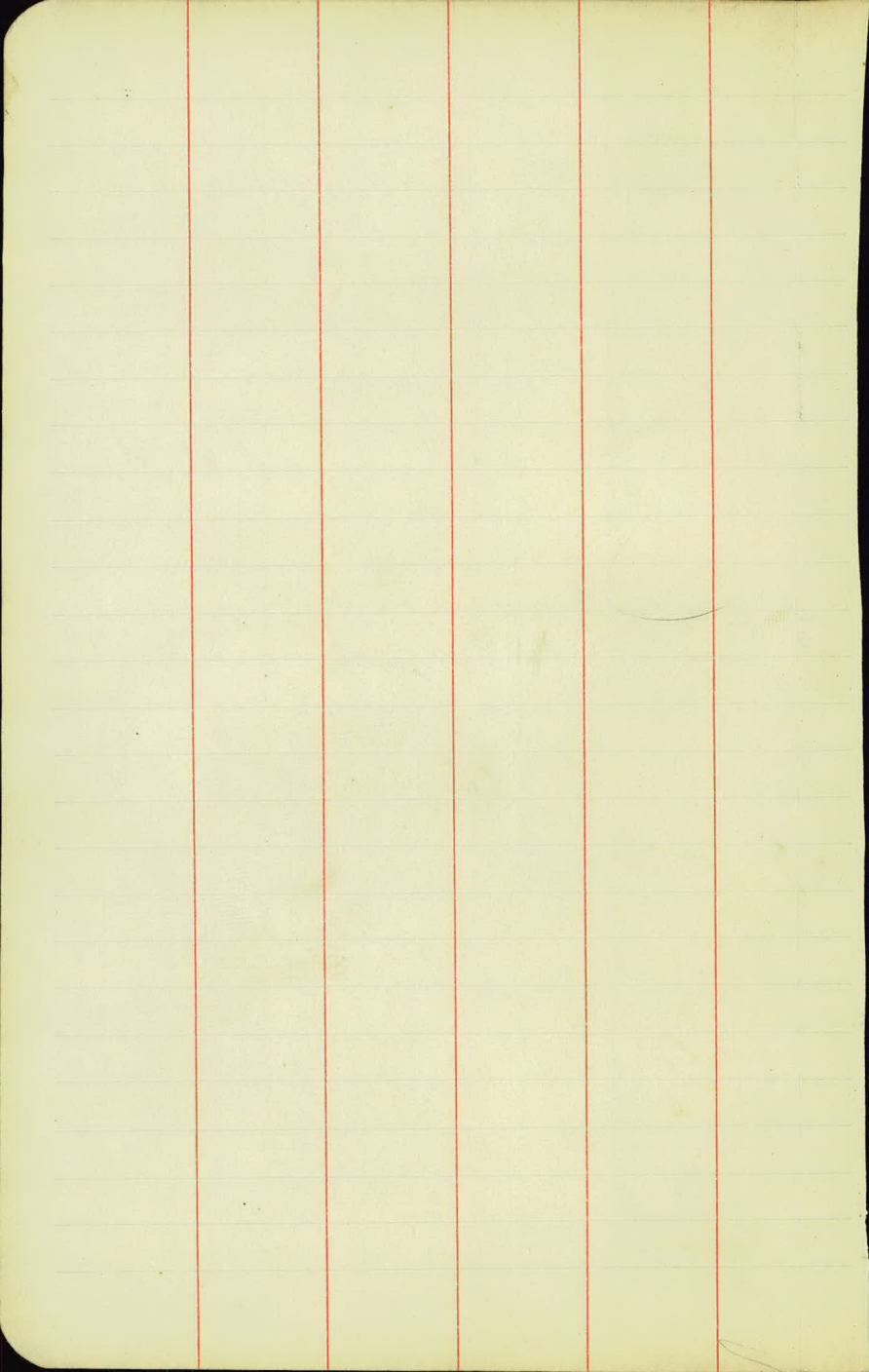

L

R

78. FENCE 23'

TREE 35'

77 FENCE 38'
+ 77. TREE 33'
+ 37. FENCE 37'
+ 37. TREE 24'

FENCE 75'
41'

+ 37 FCG 52'
+ 37 TP 50

76 FENCE 34'

FENCE 40'

+ 33. T.P. 28'
+ 30. IRON SIGN Post 28'

33 T.P. 21'

75

VOID

FENCE 22'

+ 22 T.P. 14'
& OLD RD. 9'
FENCE 22'

74 FENCE 38'

73 FENCE 27'

FENCE 30'
+ 94 T.P. 24'

72

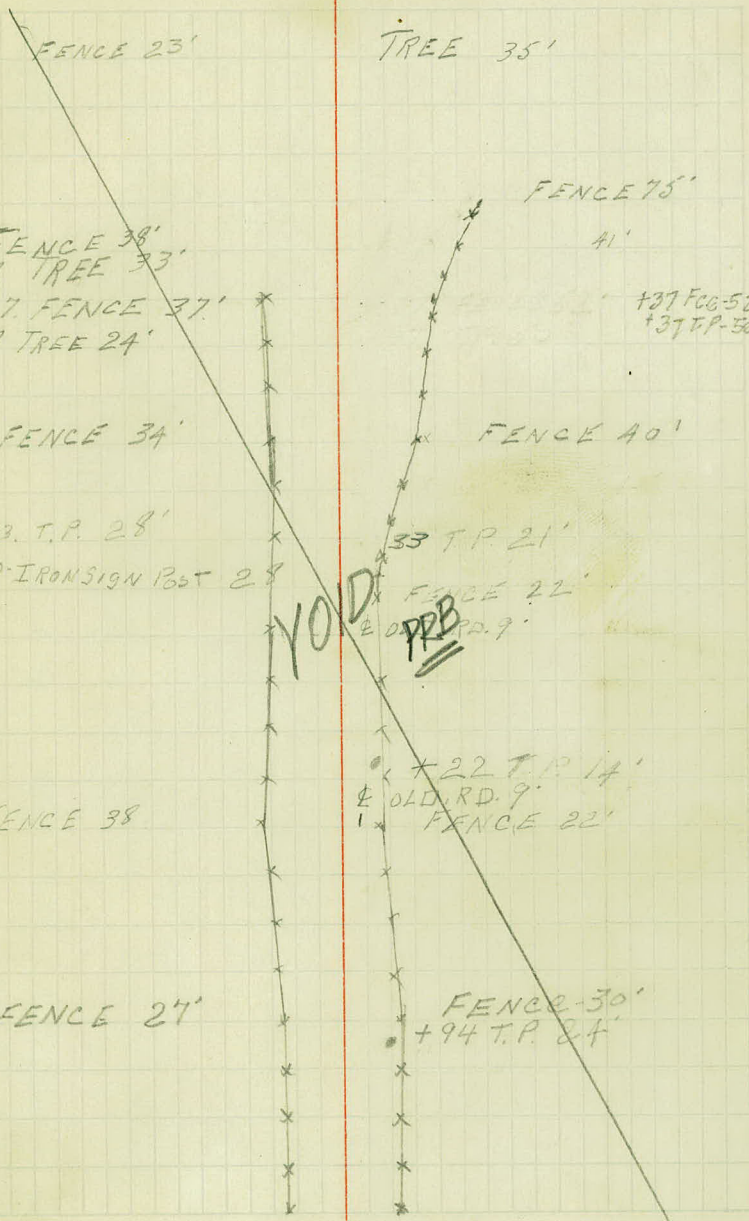

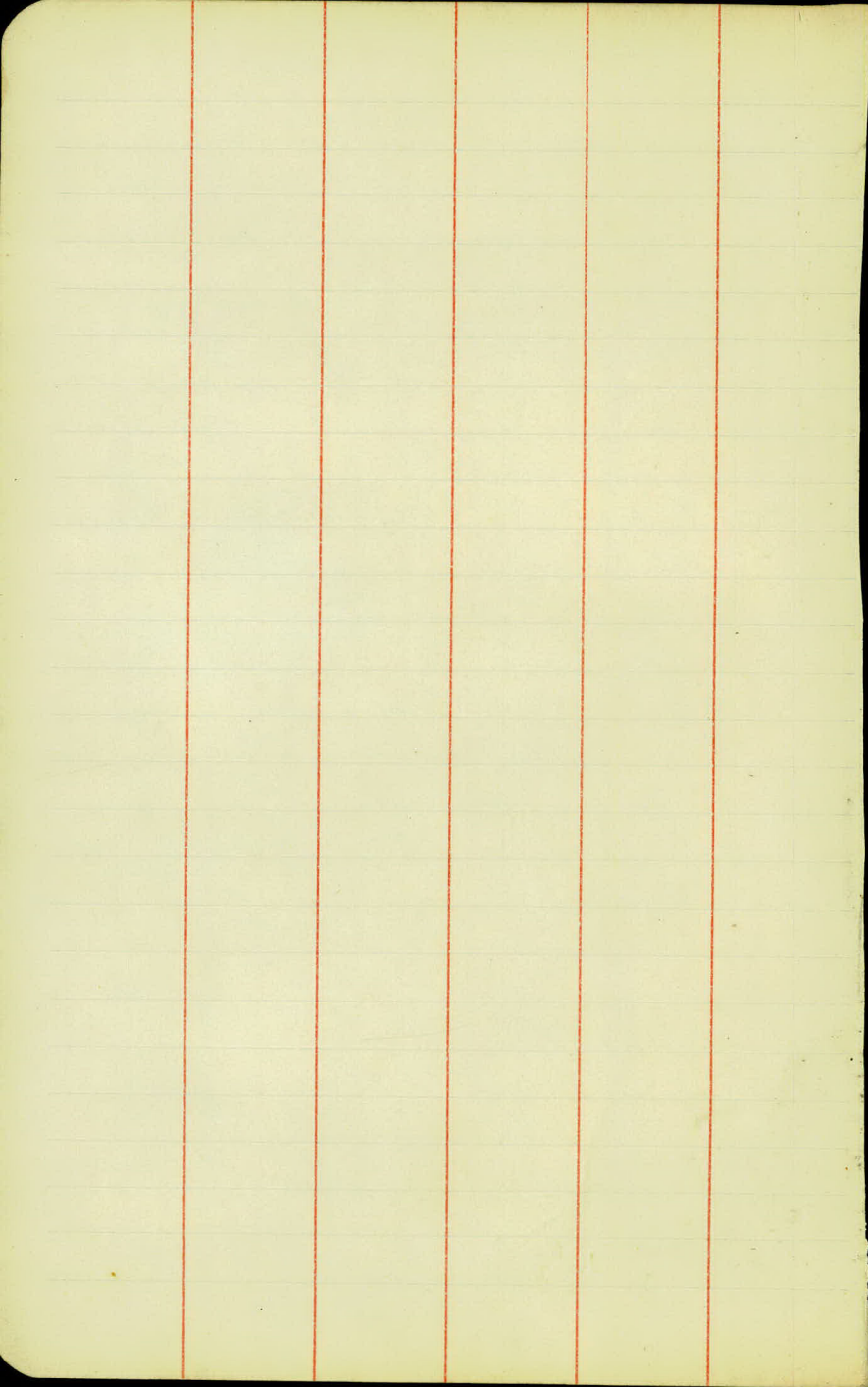

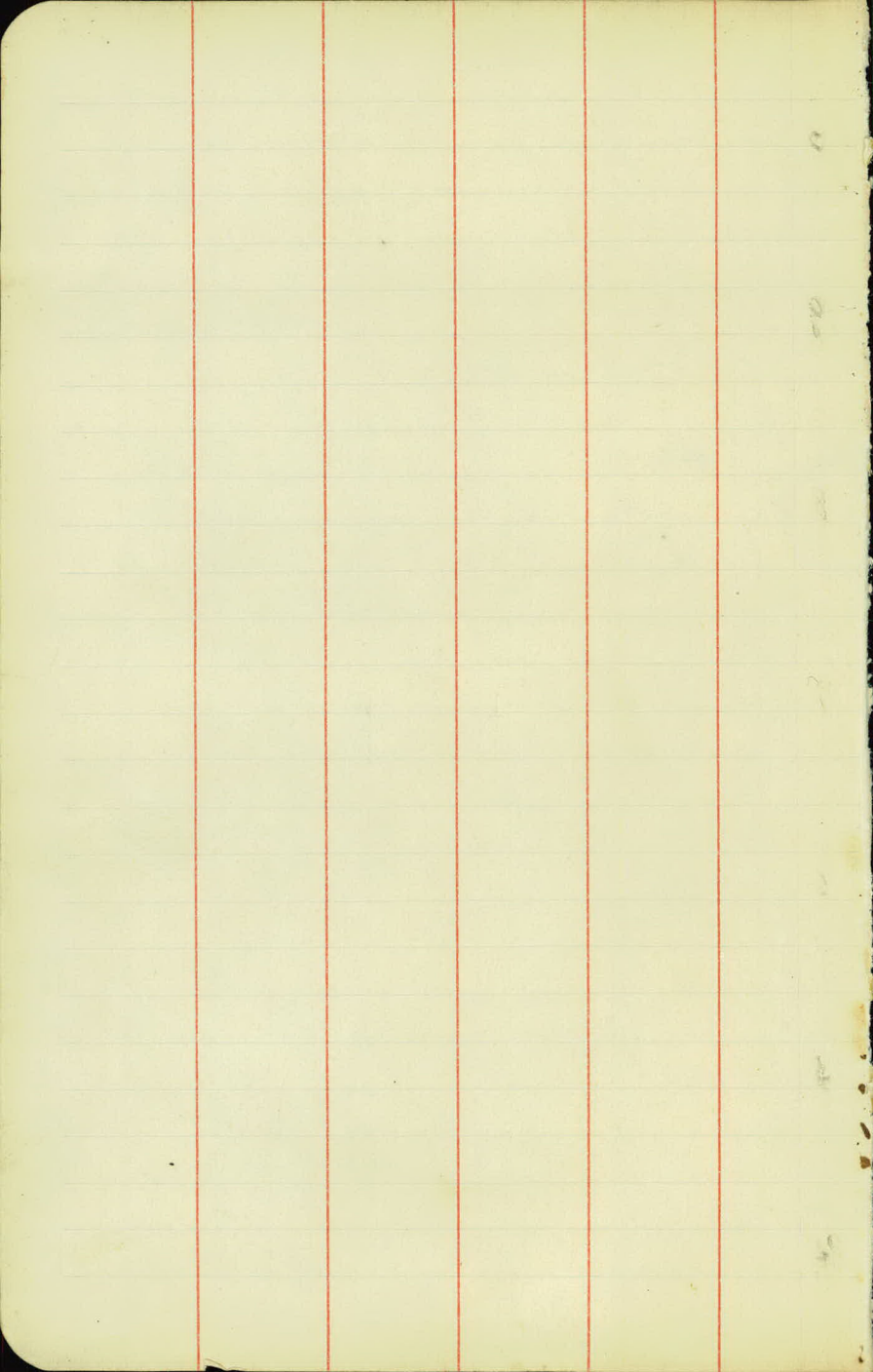

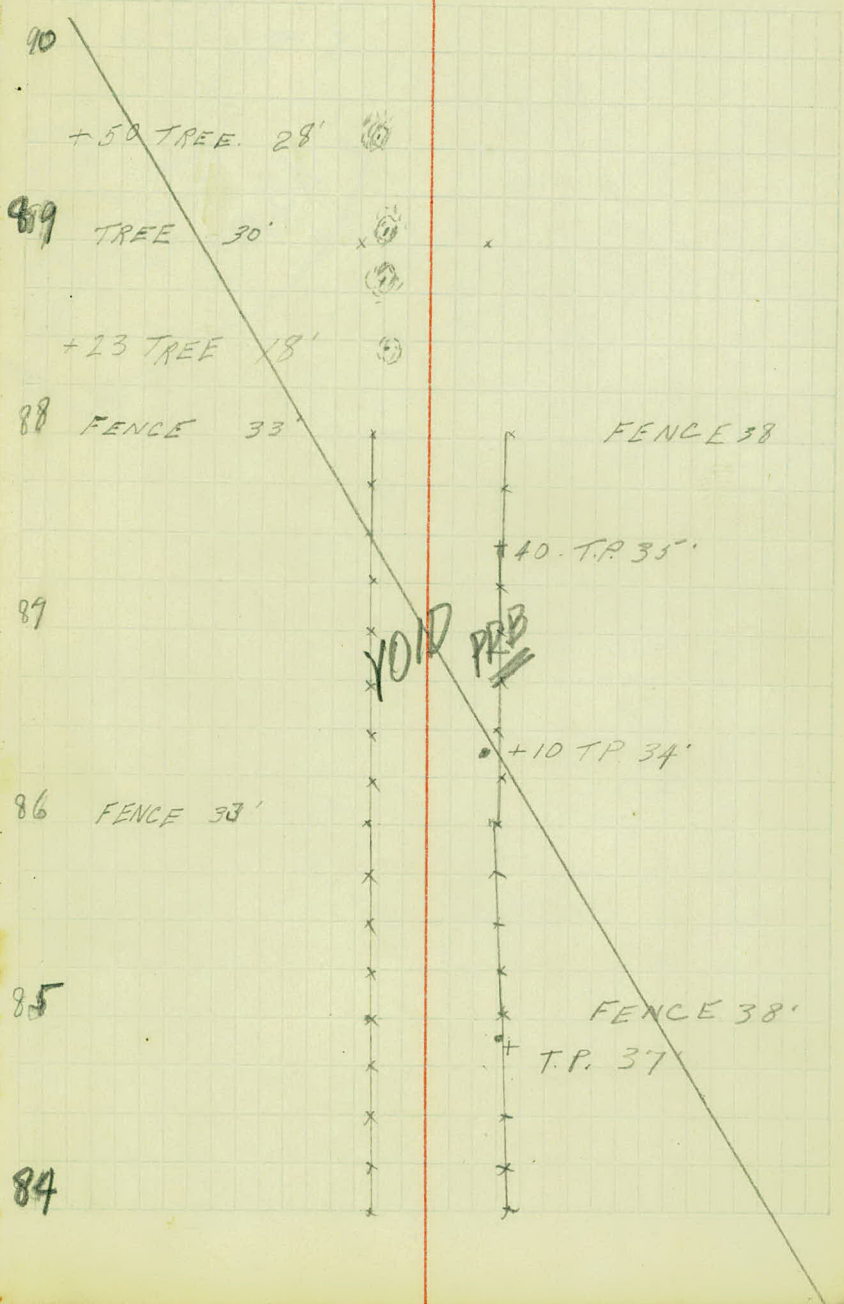

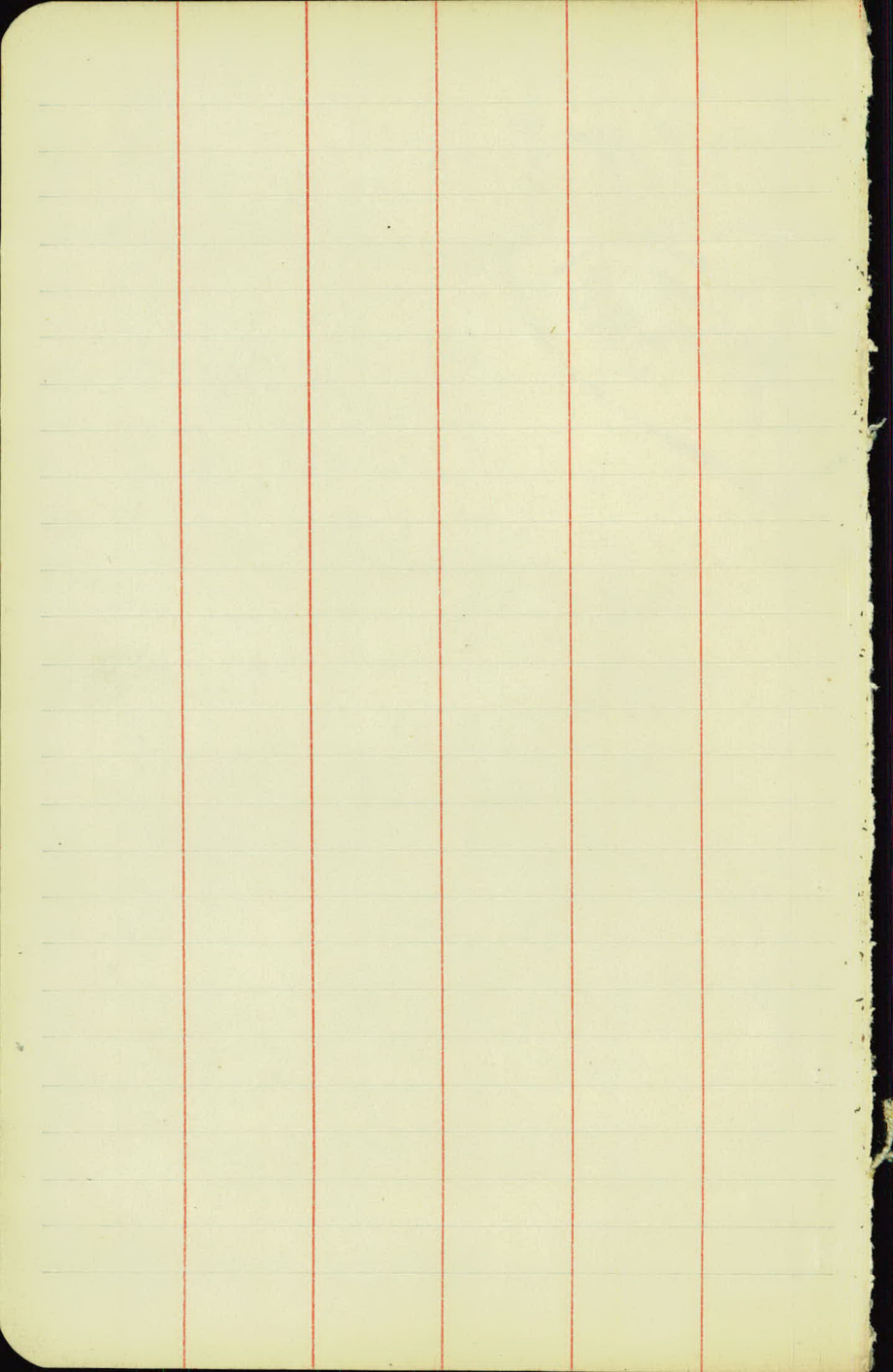

L

R.

The image shows a page of graph paper with a grid pattern. A vertical red line runs down the center of the page, dividing it into two equal columns. At the top of the left column, there is a handwritten letter 'L'. At the top of the right column, there is a handwritten letter 'R.' with a period. The grid consists of small squares, and the paper has a slightly aged, yellowish tint. There is some dark, irregular staining or damage along the left edge of the page.

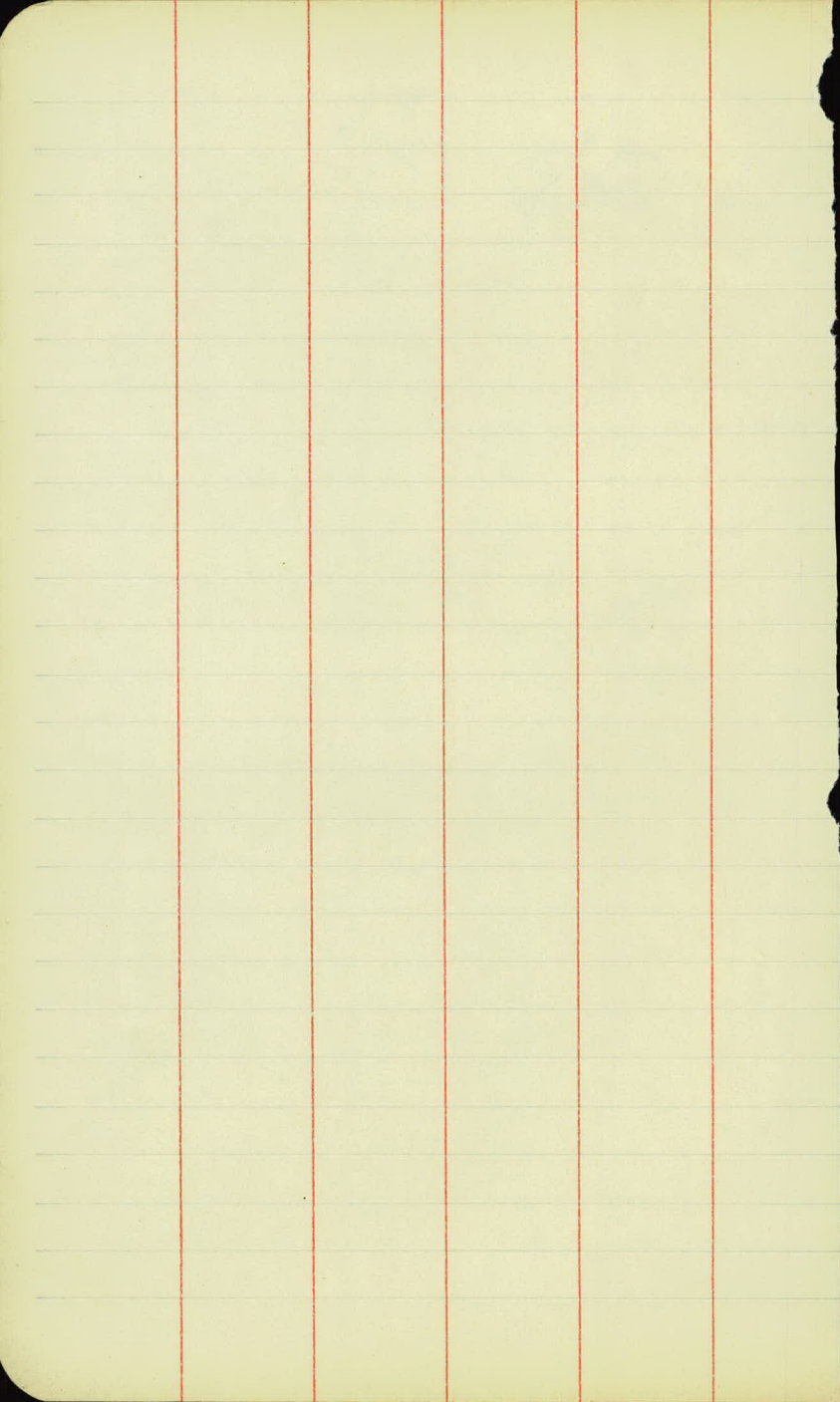

L

R

The image shows a page of graph paper with a grid of small squares. A vertical red line runs down the center of the page, dividing it into two equal halves. The left half is labeled 'L' and the right half is labeled 'R'. The grid consists of 20 columns and 30 rows of squares. The red line is positioned between the 10th and 11th columns from the left edge.

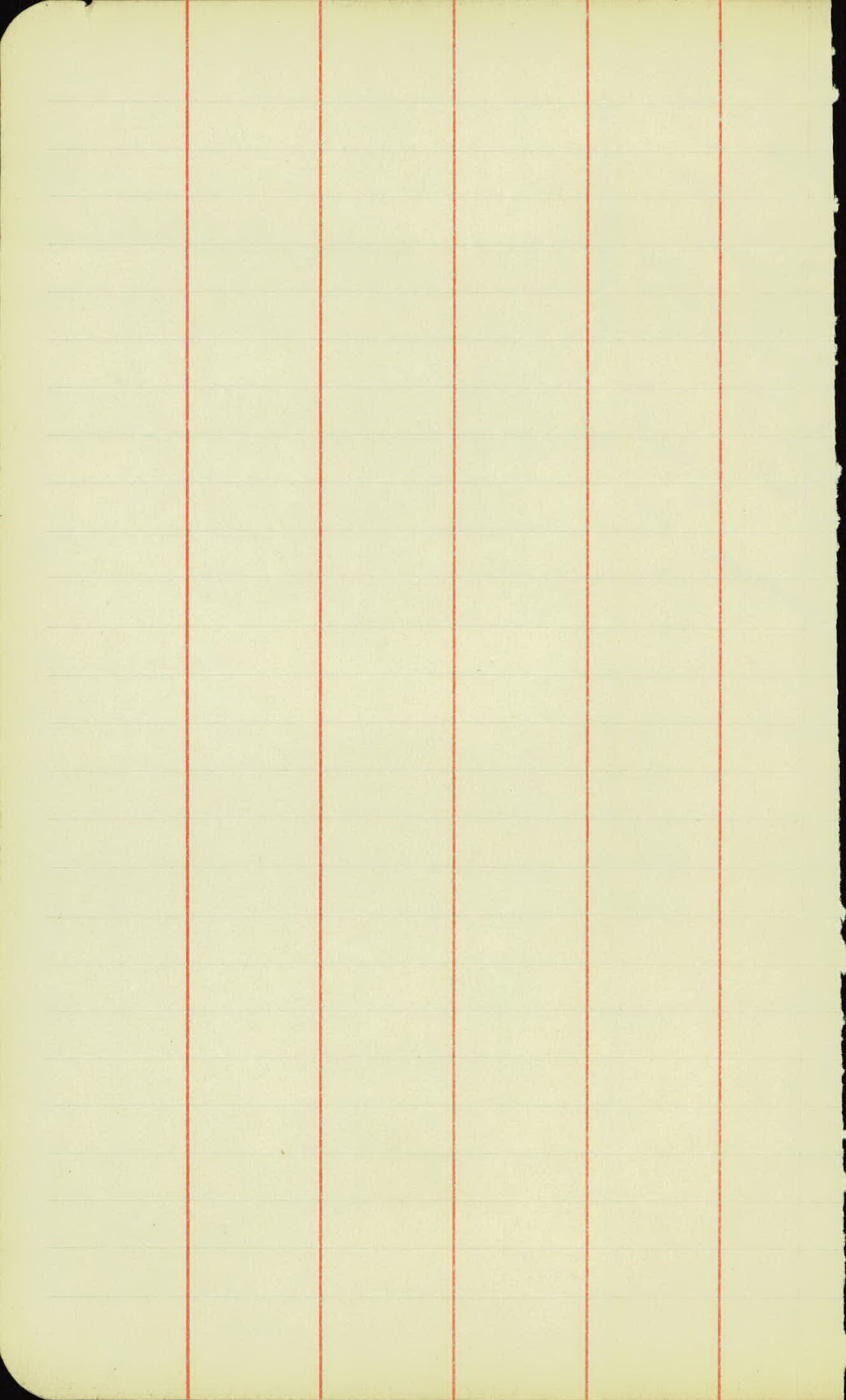

7
17
2
1

DISTANCES FROM CENTER OF ROADWAY FOR CROSS-SECTIONING.

ROADWAY 14 FEET WIDE. SIDE SLOPES 1 1/2 TO 1.

FOR SINGLE TRACK EMBANKMENT.

	0	.1	.2	.3	.4	.5	.6	.7	.8	.9	
0	7.0	7.2	7.3	7.5	7.6	7.8	7.9	8.1	8.2	8.4	0
1	8.5	8.7	8.8	9.0	9.1	9.3	9.4	9.6	9.7	9.9	1
2	10.0	10.2	10.3	10.5	10.6	10.8	10.9	11.1	11.2	11.4	2
3	11.5	11.7	11.8	12.0	12.1	12.3	12.4	12.6	12.7	12.9	3
4	13.0	13.2	13.3	13.5	13.6	13.8	13.9	14.1	14.2	14.4	4
5	14.5	14.7	14.8	15.0	15.1	15.3	15.4	15.6	15.7	15.9	5
6	16.0	16.2	16.3	16.5	16.6	16.8	16.9	17.1	17.2	17.4	6
7	17.5	17.7	17.8	18.0	18.1	18.3	18.4	18.6	18.7	18.9	7
8	19.0	19.2	19.3	19.5	19.6	19.8	19.9	20.1	20.2	20.4	8
9	20.5	20.7	20.8	21.0	21.1	21.3	21.4	21.6	21.7	21.9	9
10	22.0	22.2	22.3	22.5	22.6	22.8	22.9	23.1	23.2	23.4	10
11	23.5	23.7	23.8	24.0	24.1	24.3	24.4	24.6	24.7	24.9	11
12	25.0	25.2	25.3	25.5	25.6	25.8	25.9	26.1	26.2	26.4	12
13	26.5	26.7	26.8	27.0	27.1	27.3	27.4	27.6	27.7	27.9	13
14	28.0	28.2	28.3	28.5	28.6	28.8	28.9	29.1	29.2	29.4	14
15	29.5	29.7	29.8	30.0	30.1	30.3	30.4	30.6	30.7	30.9	15
16	31.0	31.2	31.3	31.5	31.6	31.8	31.9	32.1	32.2	32.4	16
17	32.5	32.7	32.8	33.0	33.1	33.3	33.4	33.6	33.7	33.9	17
18	34.0	34.2	34.3	34.5	34.6	34.8	34.9	35.1	35.2	35.4	18
19	35.5	35.7	35.8	36.0	36.1	36.3	36.4	36.6	36.7	36.9	19
20	37.0	37.2	37.3	37.5	37.6	37.8	37.9	38.1	38.2	38.4	20
21	38.5	38.7	38.8	39.0	39.1	39.3	39.4	39.6	39.7	39.9	21
22	40.0	40.2	40.3	40.5	40.6	40.8	40.9	41.1	41.2	41.4	22
23	41.5	41.7	41.8	42.0	42.1	42.3	42.4	42.6	42.7	42.9	23
24	43.0	43.2	43.3	43.5	43.6	43.8	43.9	44.1	44.2	44.4	24
25	44.5	44.7	44.8	45.0	45.1	45.3	45.4	45.6	45.7	45.9	25
26	46.0	46.2	46.3	46.5	46.6	46.8	46.9	47.1	47.2	47.4	26
27	47.5	47.7	47.8	48.0	48.1	48.3	48.4	48.6	48.7	48.9	27
28	49.0	49.2	49.3	49.5	49.6	49.8	49.9	50.1	50.2	50.4	28
29	50.5	50.7	50.8	51.0	51.1	51.3	51.4	51.6	51.7	51.9	29
30	52.0	52.2	52.3	52.5	52.6	52.8	52.9	53.1	53.2	53.4	30
31	53.5	53.7	53.8	54.0	54.1	54.3	54.4	54.6	54.7	54.9	31
32	55.0	55.2	55.3	55.5	55.6	55.8	55.9	56.1	56.2	56.4	32
33	56.5	56.7	56.8	57.0	57.1	57.3	57.4	57.6	57.7	57.9	33
34	58.0	58.2	58.3	58.5	58.6	58.8	58.9	59.1	59.2	59.4	34
35	59.5	59.7	59.8	60.0	60.1	60.3	60.4	60.6	60.7	60.9	35
36	61.0	61.2	61.3	61.5	61.6	61.8	61.9	62.1	62.2	62.4	36

Calculated by Julien A. Hall, M. Am. Soc. C. E.

MADE IN GERMANY.

02494