

Bk 69 Dr. 16

OFFICE OF COUNTY ENGINEER  
RAMSEY CO. MINN.

.....Survey

45th Parallel

Traverse & Calculations

From..... To.....

Road Acc't. No.....

Date Filed 6-11-41

File.....

①  
TRAVERSE & CALCULATIONS  
for Placing

pt. on 45<sup>th</sup> Parallel

Completed 10-17-40

Party  
R. Pease  
A. Moeschter  
L. Goldberg.  
C. Fewer.

2 Pages

Pt.	Inc. Lt.	Angle Rt.	Bearing Mag	Calc.	Dist.
-----	----------	-----------	-------------	-------	-------

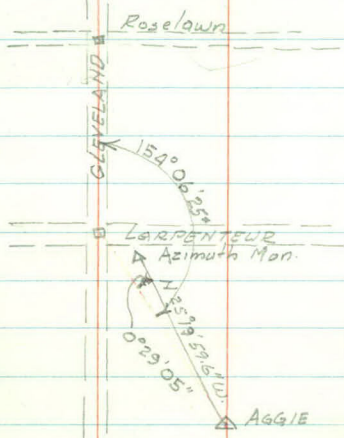

W 1/4 Cor. #16

N 7° 40' W

N 0° 04' 30.4" E

2634.20

S.W. Cor #16 154° 06' 25"

0° 29' 05"

N 33° 30' W

2001.68

N 25° 49' 04.6" W

Aggie

Azimuth 154° 40' 00.4" = N 25° 19' 59.6" W  
N 33° W

A.M.

Cos.	Log s.	Dist	Lat	Dep.	Diff
------	--------	------	-----	------	------

1 sec. Lat. = 30.870 meters at sea level

1 meter = 39.37 inches

1 sec Lat diff from sea level = 0.04 ft.

$$\frac{30.870 \times 39.37}{12} + 0.04 = 101.31' = 1 \text{ sec Lat.}$$

coordinates Aggie = Lat  $44^{\circ} 59' 12.458''$   
Long  $93^{\circ} 11' 00.785''$

$44^{\circ} 59' 59.990$

$44^{\circ} 59' 12.458$

$47.542$

$$47.542 \times 101.31 = 4816.48' \text{ in Lat.}$$

$4816.48$

$4436.08$

$\therefore$  Pt. in question is 380.40' North of W  $\frac{1}{4}$  sec 16

2634.20

4436.08

9.9543303

3.2557249  
3.3013946 1801.875

1801.875

0.00

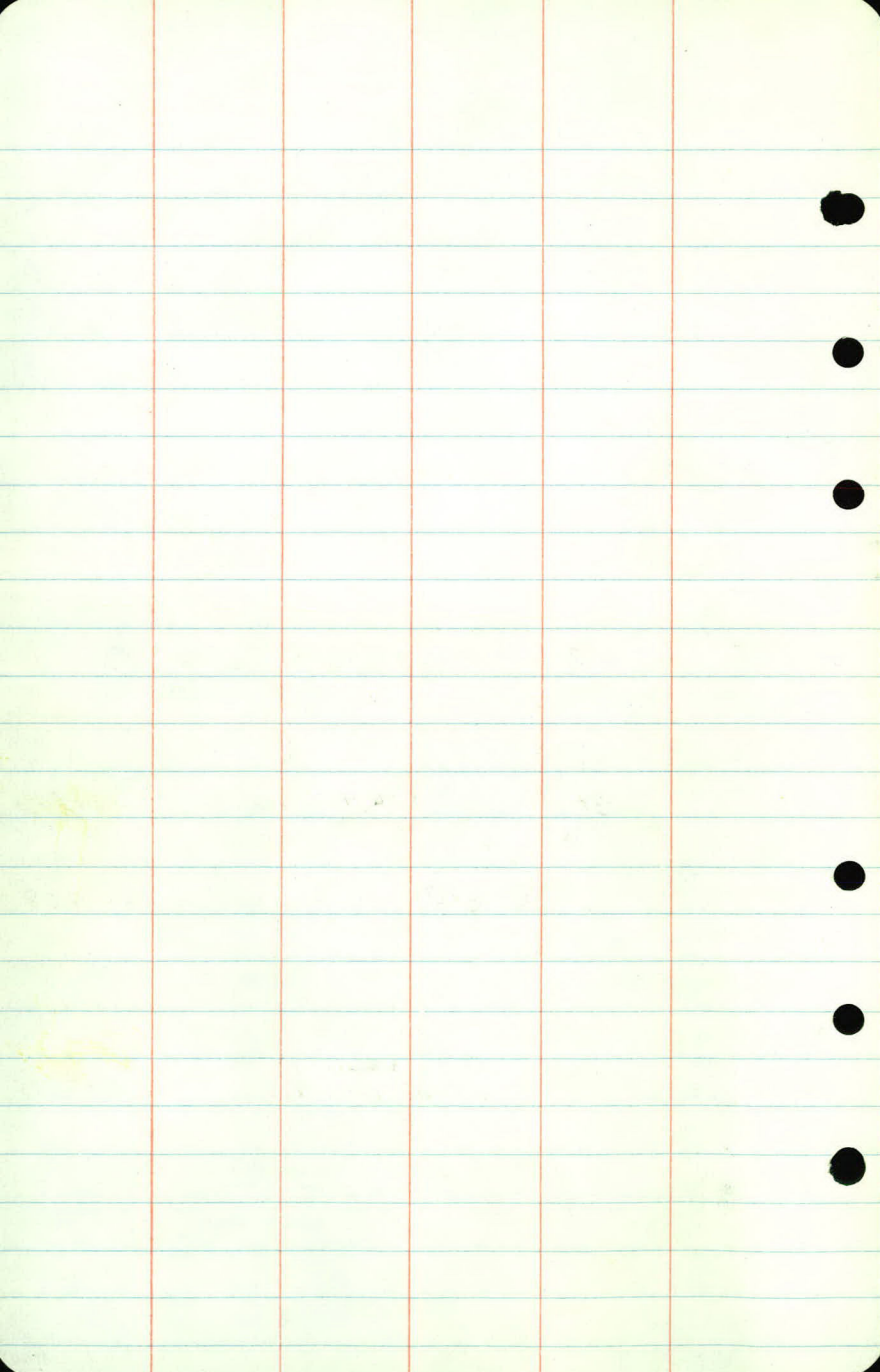



## Report on Determination of 45th Parallel

To Establish Point on Cleveland Avenue.

U.S.G.S. Triangulation Station "AGGIE" whose coordinates are:  
Latitude  $44^{\circ}59'12.458''$  and Longitude  $93^{\circ}11'00.785''$  and whose  
Azimuth Mark lies in azimuth of  $154^{\circ}40'00.4''$ .

Found Station "AGGIE" at top of slope north of U. of M. Farm Campus  
Building, known as "College Girls Dormitory." Also found Azimuth  
Mark at S.E. Corner of Larpenteur and Cleveland.

Occupied Station "AGGIE" and observed Azimuth Mark, turning angle, to  
the left, of  $0^{\circ}29'05''$ , twelve times (6 times normal and 6 times with  
telescope plunged) to S. W. Corner of Section 16 of Rose Township.  
Azimuth of  $154^{\circ}40'00.4''$  = bearing of  $N 25^{\circ}19'59.6'' W$ .  
Chained distance from "AGGIE" to S. W. Corner, Sec. 16, and found it  
to be 2001.68 ft.  
thence: "AGGIE" to S.W. Cor. is  $N 25^{\circ}49'04.6'' W$ . Dist. of 2001.68 ft.

Occupied S. W. Corner 16 and observed "AGGIE" turning angle, to the  
left, of  $154^{\circ}06'25''$ , twelve times (6 times normal and 6 times with  
telescope plunged) to W  $1/4$  Cor. 16.  
Chained distance from S.W. Cor. 16 to W  $1/4$  Cor. 16 and found it to  
be 2634.20 ft.  
thence: S.W. Cor. 16 to W  $1/4$  Cor. 16 is  $N 0^{\circ}04'30.4'' E$ . with  
distance of 2634.20 ft.

One second of Latitude is 30.870 meters at sea level.  
One meter is 39.37 inches  
Correction for 1000 ft. above sea level is  $+ 0.04''/\text{sec}$ .  
thence: One second of Latitude equals 101.31 ft.

If "AGGIE" is in  $44^{\circ}59'12.458''$  Latitude, there are 47.542 seconds required  
to reach 45 degree latitude.  
thence: Pt. on 45° Latitude must be 4816.48 ft. due North of U.S.G.S.  
Triangulation Point "AGGIE".

Then by computation found Latitude of S. W. Cor. 16 to be 1801.88 ft.  
due North of "AGGIE", and the Latitude of W.  $1/4$  Cor. 16 to be 4436.08  
ft. due north of "AGGIE".  
thence: Pt. on 45th Parallel on Cleveland Ave. must be 380.40 ft.  
due north of W.  $1/4$  Cor. Sec. 16.

This Point beyond reasonable doubt is within allowable error of seven feet.



To Establish Point in Vicinity of Keller Golf Course.

Visited P. J. McCauley at Minnesota State Highway Department and from his U. S. G. S. Maps of Mississippi River Control scaled distances from the following points in Sec. 16 of New Canada Twp.

1. Along west Line of Sec. 16 distance from center of R. R. track, north to  $45^\circ$ , found it to be 1320.0 ft.
2. Along north and south  $1/4$  line, distance from center of R. R. track, north to  $45^\circ$ , found it to be 116.67 ft.
3. Along east line of Sec. 16, distance from center of R. R. track, south to  $45^\circ$ , found it to be 326.67 ft.
4. Along Soo Line track, distance from East Line Sec. 16 to intersection of East & track of Northern Pacific R. R., found it to be 416.67 ft.

Chained distance along Soo Line & from East Line Sec. 16 to intersection East & track of Northern Pacific, found it chained 385.70 ft.

thence: 385.70 divided by 416.67 ft. gives constant which is ratio between scaled and measured distances.

Then chained above scaled distances applying ratio, and set three points, one on Arcade St., one on N. and S.  $1/4$  Line Sec. 16, one on Phalen Ave.

Then occupied pt. on N. & S.  $1/4$  Line Sec. 16, sighted on Point on Phalen Ave., plunged and checked pt. on Arcade St. within fifty feet.

Then set point on S.T.H. #61 on same line.

This point must be checked by solar or astronomic observations.