

CITY OF ST PAUL

Department of Public Works

CONSTRUCTION PLAN
FOR
GRADING & PAVING
OF

JOHNSON PARKWAY
FROM
PROSPERITY TO BEECH

CITY PROJECT NO. P-0559BI
MSA PROJECT NO. 164-129-08

GROSS LENGTH	4230	FEET	.80	MILES
BRIDGES LENGTH	—	FEET	—	MILES
EXCEPTIONS LENGTH	—	FEET	—	MILES
NET LENGTH	4230	FEET	.80	MILES

TRAFFIC COUNTS	PRESENT	20 YR. PROJECTION	2018
PROSP. AVE. to 7th ST.	14,850	16,000	72,200
7th ST. to MHAHA AVE.	9,400	10,000	45,450

DESIGN CRITERIA

DESIGN SPEED	30MPH	30MPH.
DESIGN LOAD	9 TON	9 TON
R FACTOR	25	10

VARIANCES TO STATE AID RULES 14 MCA § 1.0532 H.I.C. (DATED AUGUST 11, 1980) WERE GRANTED BY THE COMMISSIONER OF TRANSPORTATION AS FOLLOWS:

BETWEEN MINNEHAHA AVE AND E. 7th ST A 36' WIDE STREET IS PERMITTED IN LIEU OF A 52' WIDE STREET BY A VARIANCE DATED OCT 20, 1981

BETWEEN E. 7th ST AND CASE AVE. A 44' WIDE STREET IS PERMITTED IN LIEU OF A 52' WIDE STREET BY A VARIANCE DATED JUNE 2, 1981

BETWEEN CASE AVE. AND MAGNOLIA AVE A 36' WIDE STREET IS PERMITTED IN LIEU OF A 52' WIDE STREET BY A VARIANCE DATED JUNE 2, 1981

SPECIFICATIONS

THE 1978 EDITION OF THE MINNESOTA DEPARTMENT OF TRANSPORTATION "STANDARD SPECIFICATIONS FOR HIGHWAY CONSTRUCTION" SHALL GOVERN.

I HEREBY CERTIFY THAT THIS PLAN WAS PREPARED BY ME OR UNDER MY DIRECT SUPERVISION AND THAT I AM A DULY REGISTERED PROFESSIONAL ENGINEER UNDER THE LAWS OF THE STATE OF MINNESOTA.

Thomas Kuefeld
DATE 3/27/81 REG. NO. 10172

John W. Davis

Approved *Kent Schaefer* 3/27, 1981
Assistant City Engineer

Approved *Robert J. Peterson* 3/27, 1981
Assistant City Engineer

Approved *Richard J. Wheeler* 3-27, 1981
City Engineer

Approved *John J. ...* 7/11, 1981
Dist. State Aid Engineer

Approved *Robert D. ...* 10-22, 1981
State Aid Plans & Specifications Engineer

Approved *Harold M. ...* 10/22/81
Director Office of State Aid

Recommended For Approval

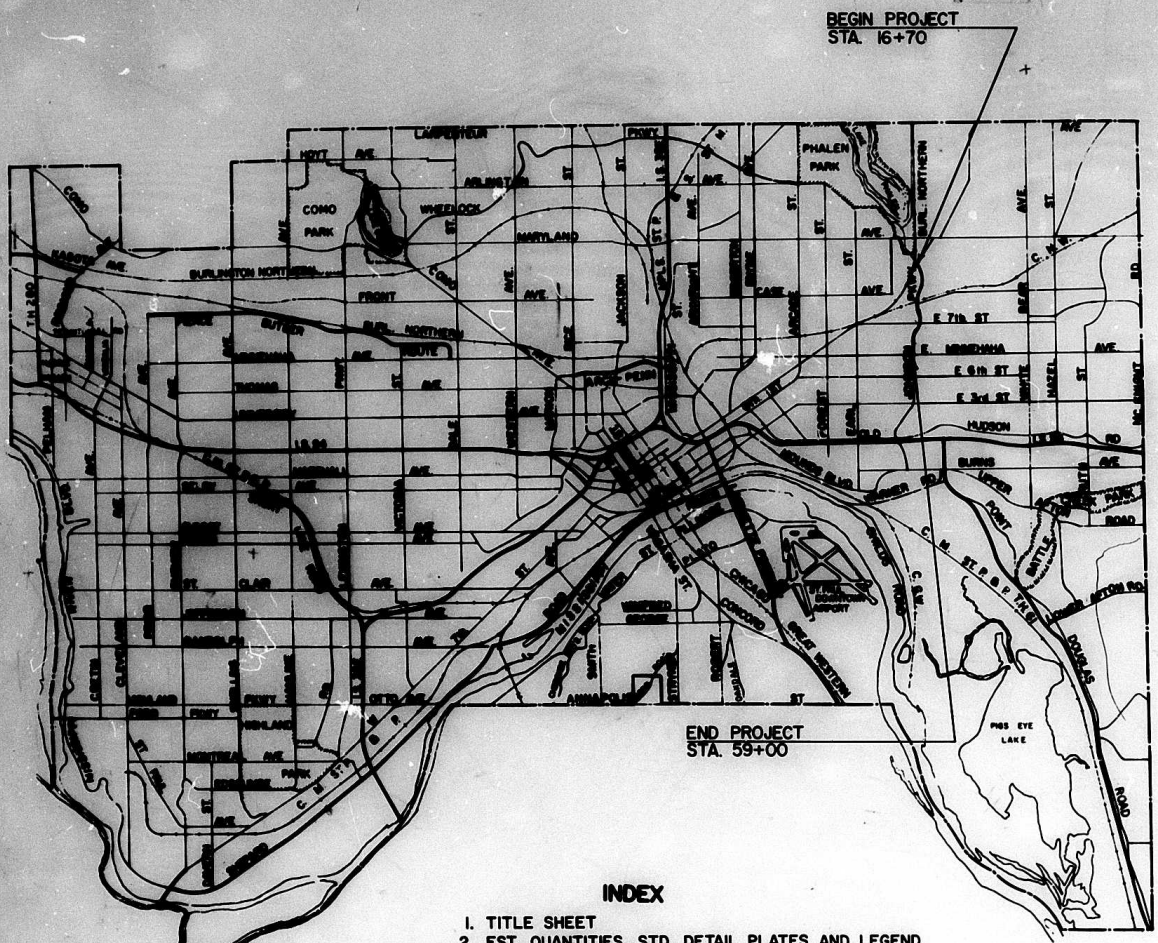

INDEX

1. TITLE SHEET
2. EST. QUANTITIES, STD. DETAIL PLATES AND LEGEND
3. SEWER CONSTRUCTION CHART
4. TYPICAL SECTION
- 5-9. PLAN SHEETS
- 10-17. CROSS SECTIONS

NO.	DESCRIPTION	UNIT	QUANTITY
2000.001	REMOVE CURB	LN. FT.	80
2000.002	REMOVE CONCRETE WALK OR DRIVEWAY	SQ. YD.	10344
2000.003	REMOVE REINFORCED PAVEMENT	SQ. YD.	10000
2000.004	REMOVE SIDE INLETS	EACH	8
2000.005	REMOVE SIDE INLETS	EACH	8
2000.006	REMOVE SIDE INLETS	EACH	8
2000.007	REMOVE SIDE INLETS	EACH	8
2000.008	REMOVE SIDE INLETS	EACH	8
2000.009	REMOVE SIDE INLETS	EACH	8
2000.010	REMOVE SIDE INLETS	EACH	8
2000.011	REMOVE SIDE INLETS	EACH	8
2000.012	REMOVE SIDE INLETS	EACH	8
2000.013	REMOVE SIDE INLETS	EACH	8
2000.014	REMOVE SIDE INLETS	EACH	8
2000.015	REMOVE SIDE INLETS	EACH	8
2000.016	REMOVE SIDE INLETS	EACH	8
2000.017	REMOVE SIDE INLETS	EACH	8
2000.018	REMOVE SIDE INLETS	EACH	8
2000.019	REMOVE SIDE INLETS	EACH	8
2000.020	REMOVE SIDE INLETS	EACH	8
2000.021	REMOVE SIDE INLETS	EACH	8
2000.022	REMOVE SIDE INLETS	EACH	8
2000.023	REMOVE SIDE INLETS	EACH	8
2000.024	REMOVE SIDE INLETS	EACH	8
2000.025	REMOVE SIDE INLETS	EACH	8
2000.026	REMOVE SIDE INLETS	EACH	8
2000.027	REMOVE SIDE INLETS	EACH	8
2000.028	REMOVE SIDE INLETS	EACH	8
2000.029	REMOVE SIDE INLETS	EACH	8
2000.030	REMOVE SIDE INLETS	EACH	8
2000.031	REMOVE SIDE INLETS	EACH	8
2000.032	REMOVE SIDE INLETS	EACH	8
2000.033	REMOVE SIDE INLETS	EACH	8
2000.034	REMOVE SIDE INLETS	EACH	8
2000.035	REMOVE SIDE INLETS	EACH	8
2000.036	REMOVE SIDE INLETS	EACH	8
2000.037	REMOVE SIDE INLETS	EACH	8
2000.038	REMOVE SIDE INLETS	EACH	8
2000.039	REMOVE SIDE INLETS	EACH	8
2000.040	REMOVE SIDE INLETS	EACH	8
2000.041	REMOVE SIDE INLETS	EACH	8
2000.042	REMOVE SIDE INLETS	EACH	8
2000.043	REMOVE SIDE INLETS	EACH	8
2000.044	REMOVE SIDE INLETS	EACH	8
2000.045	REMOVE SIDE INLETS	EACH	8
2000.046	REMOVE SIDE INLETS	EACH	8
2000.047	REMOVE SIDE INLETS	EACH	8
2000.048	REMOVE SIDE INLETS	EACH	8
2000.049	REMOVE SIDE INLETS	EACH	8
2000.050	REMOVE SIDE INLETS	EACH	8
2000.051	REMOVE SIDE INLETS	EACH	8
2000.052	REMOVE SIDE INLETS	EACH	8
2000.053	REMOVE SIDE INLETS	EACH	8
2000.054	REMOVE SIDE INLETS	EACH	8
2000.055	REMOVE SIDE INLETS	EACH	8
2000.056	REMOVE SIDE INLETS	EACH	8
2000.057	REMOVE SIDE INLETS	EACH	8
2000.058	REMOVE SIDE INLETS	EACH	8
2000.059	REMOVE SIDE INLETS	EACH	8
2000.060	REMOVE SIDE INLETS	EACH	8
2000.061	REMOVE SIDE INLETS	EACH	8
2000.062	REMOVE SIDE INLETS	EACH	8
2000.063	REMOVE SIDE INLETS	EACH	8
2000.064	REMOVE SIDE INLETS	EACH	8
2000.065	REMOVE SIDE INLETS	EACH	8
2000.066	REMOVE SIDE INLETS	EACH	8
2000.067	REMOVE SIDE INLETS	EACH	8
2000.068	REMOVE SIDE INLETS	EACH	8
2000.069	REMOVE SIDE INLETS	EACH	8
2000.070	REMOVE SIDE INLETS	EACH	8
2000.071	REMOVE SIDE INLETS	EACH	8
2000.072	REMOVE SIDE INLETS	EACH	8
2000.073	REMOVE SIDE INLETS	EACH	8
2000.074	REMOVE SIDE INLETS	EACH	8
2000.075	REMOVE SIDE INLETS	EACH	8
2000.076	REMOVE SIDE INLETS	EACH	8
2000.077	REMOVE SIDE INLETS	EACH	8
2000.078	REMOVE SIDE INLETS	EACH	8
2000.079	REMOVE SIDE INLETS	EACH	8
2000.080	REMOVE SIDE INLETS	EACH	8
2000.081	REMOVE SIDE INLETS	EACH	8
2000.082	REMOVE SIDE INLETS	EACH	8
2000.083	REMOVE SIDE INLETS	EACH	8
2000.084	REMOVE SIDE INLETS	EACH	8
2000.085	REMOVE SIDE INLETS	EACH	8
2000.086	REMOVE SIDE INLETS	EACH	8
2000.087	REMOVE SIDE INLETS	EACH	8
2000.088	REMOVE SIDE INLETS	EACH	8
2000.089	REMOVE SIDE INLETS	EACH	8
2000.090	REMOVE SIDE INLETS	EACH	8
2000.091	REMOVE SIDE INLETS	EACH	8
2000.092	REMOVE SIDE INLETS	EACH	8
2000.093	REMOVE SIDE INLETS	EACH	8
2000.094	REMOVE SIDE INLETS	EACH	8
2000.095	REMOVE SIDE INLETS	EACH	8
2000.096	REMOVE SIDE INLETS	EACH	8
2000.097	REMOVE SIDE INLETS	EACH	8
2000.098	REMOVE SIDE INLETS	EACH	8
2000.099	REMOVE SIDE INLETS	EACH	8
2000.100	REMOVE SIDE INLETS	EACH	8

STANDARD DETAIL PLATES	
NO.	DESCRIPTION
1000	REMOVE SIDEWALK, TYPE 1
1000A	CONCRETE DRIVEWAY, TYPE B
2000	CATCH BASIN INSTALLATION DETAILS
2000A	CATCH BASIN, DESIGN TYPE 2A
2201	FRAME CASTING 'A'
2202	COVER CASTING B, C & D
2205	CASTINGS E, F & J
2317	TYPES OF TRENCH BEDDING
3000	CONCRETE CURB
3000.5,6	PEDESTRIAN CURB RAMP FOR THE HEMLOCKER
3100	CONCRETE CURB & GUTTER
3103	SIDE INLET OPENING
3105	MODIFIED CURB & GUTTER
4010	BARRICADE DESIGNS
4030A	BARRICADES FOR STREET CLOSURE
4033	EXAMPLES OF CHANNELIZATION
4035	WARNING LIGHTS & CHANNELIZING DEVICES
6100	CONCRETE MIX FOR SEWERS
3000H	REINFORCED CONCRETE PIPE

EXISTING AND REMOVAL LEGEND

- EXISTING CURB
- EXISTING WALK (NO. REFERS TO SIZE & TYPE)
- HYDRANT
- UTILITY POLE
- LIGHT STANDARD
- TRAFFIC SIGNAL
- UTILITY MANHOLE
- EXISTING MANHOLE (NO. REFERS TO SEWER CONST. CHART)
- EXISTING CATCH BASIN (NO. REFERS TO SEWER CONST. CHART)
- EXISTING SEWER (NO. REFERS TO SIZE)
- EXISTING WATER MAIN
- VALVE
- EXISTING GAS MAIN
- EXISTING CONDUIT (L-LIGHTING, T-TELEPHONE, E-ELECTRIC, TS-TRAFFIC SIGNAL)
- BULKHEAD CATCH BASIN LEAD
- EXISTING RAILROAD TRACK
- EXISTING TREE (NO. REFERS TO SIZE)
- FENCE
- BUILDING
- AS IDENTIFIED ON PLAN
- REMOVE CURB
- REMOVE CONCRETE WALK OR DRIVEWAY
- REMOVE REINFORCED PAVEMENT
- REMOVE PAVEMENT
- REMOVE TREE

CONSTRUCTION LEGEND

- ① CONSTRUCT CURB & GUTTER (SEE TYPICAL SECTION FOR TYPE)
- ② ADJUST MANHOLE (NO. REFERS TO SEWER CONST. CHART)
- ③ CONSTRUCT MANHOLE (NO. REFERS TO SEWER CONST. CHART)
- CONSTRUCT CATCH BASIN (NO. REFERS TO SEWER CONST. CHART)
- CONSTRUCT CONCRETE WALK
- CONSTRUCT CONCRETE DRIVEWAY PAVEMENT
- ADJUST WATER GATE VALVE HOUSING
- CONSTRUCT PIPE SEWER (SEE SEWER CONST. CHART)
- BULKHEAD EXISTING SEWER
- CONSTRUCT BITUMINOUS PAVEMENT (SEE TYPICAL SECTION)
- PEDESTRIAN CURB RAMP

JOHNSON PARKWAY
ESTIMATED QUANTITIES,
STD. DETAIL PLATES
AND LEGEND

TYPICAL SECTION
JOHNSON PKWY.

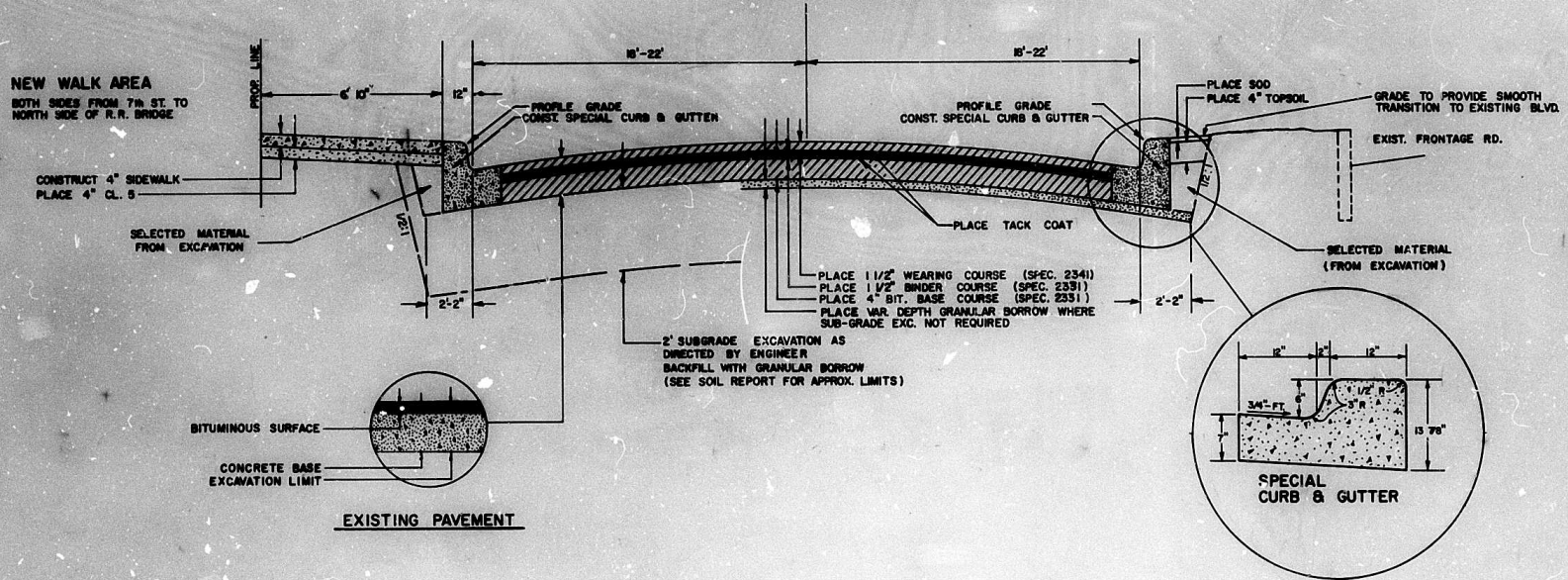

JOHNSON PARKWAY
TYPICAL SECTION

EXISTING & REMOVAL PLAN

JOHNSON PARKWAY

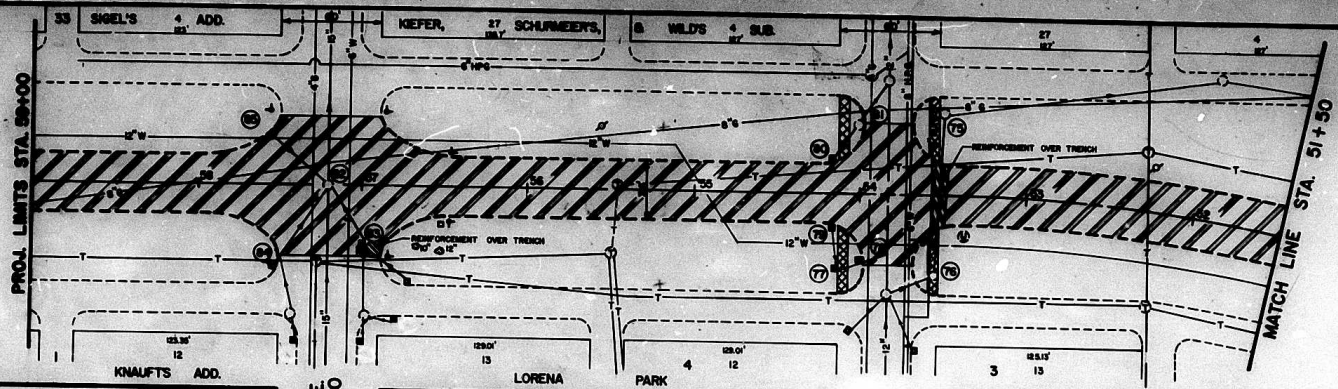

CONSTRUCTION PLAN

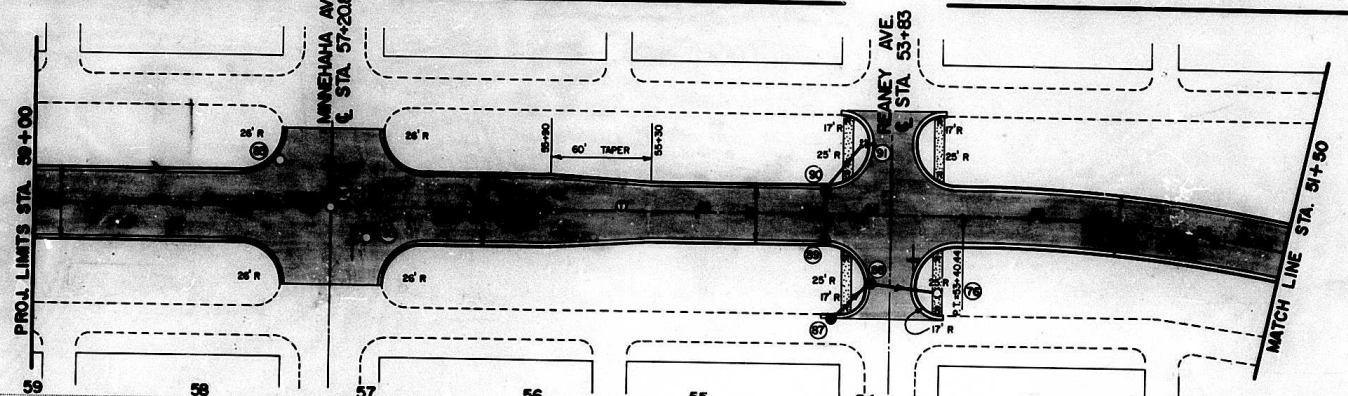

SCALE 1" = 40'

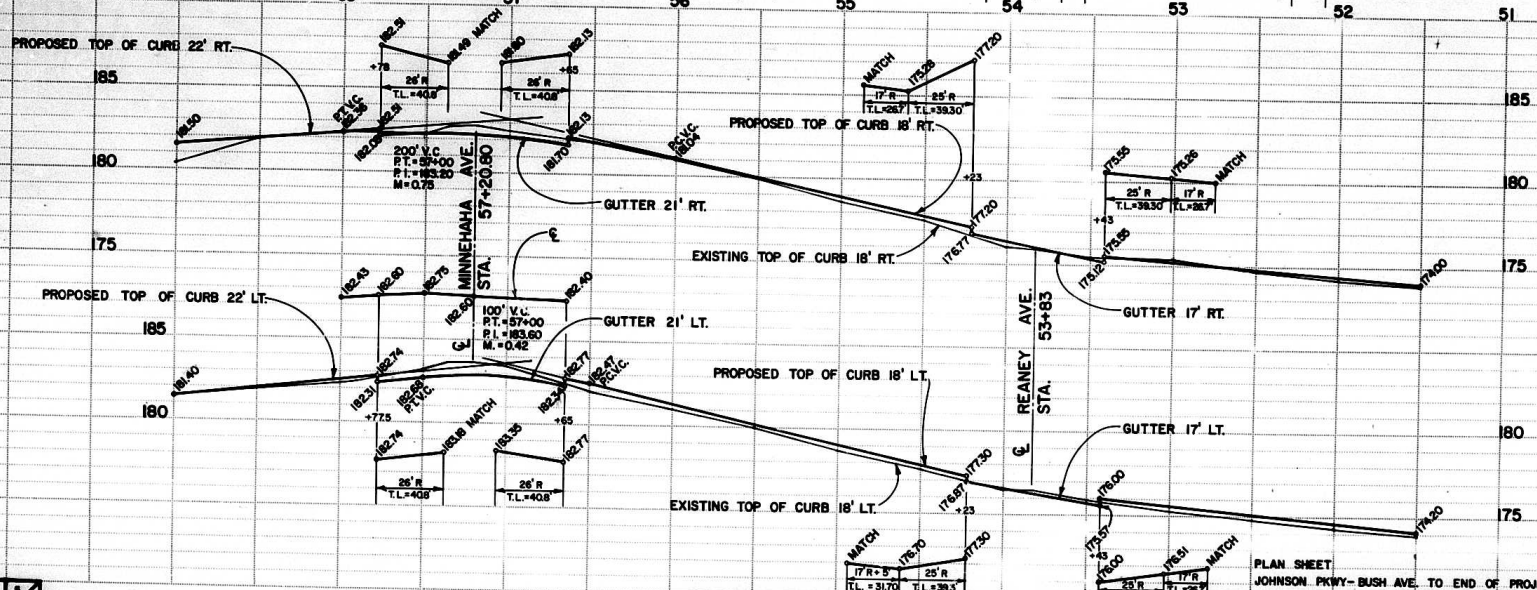

EXISTING & REMOVAL PLAN

HANSON PARKWAY

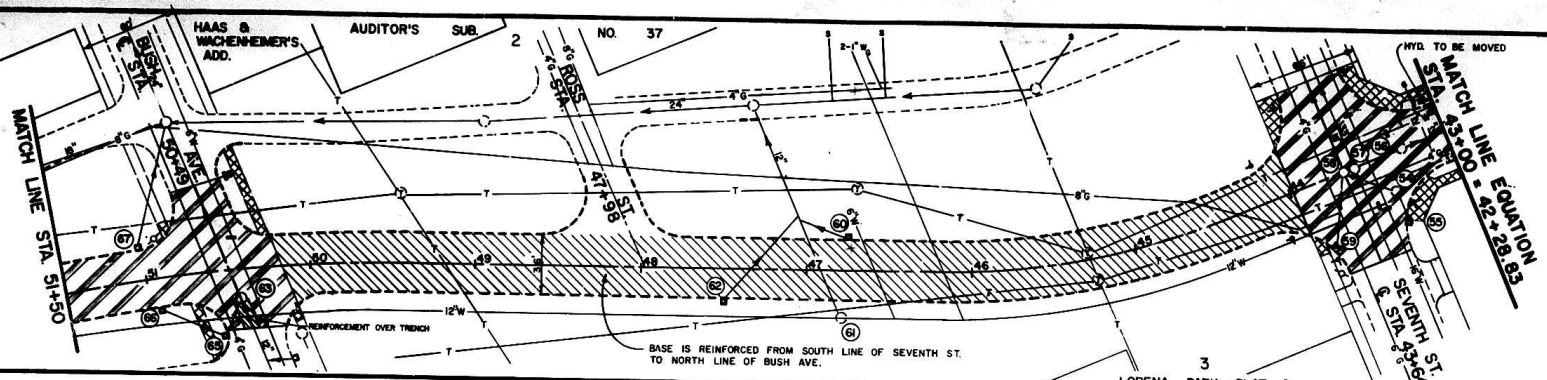

CONSTRUCTION PLAN

LORENA PARK PLAT 2

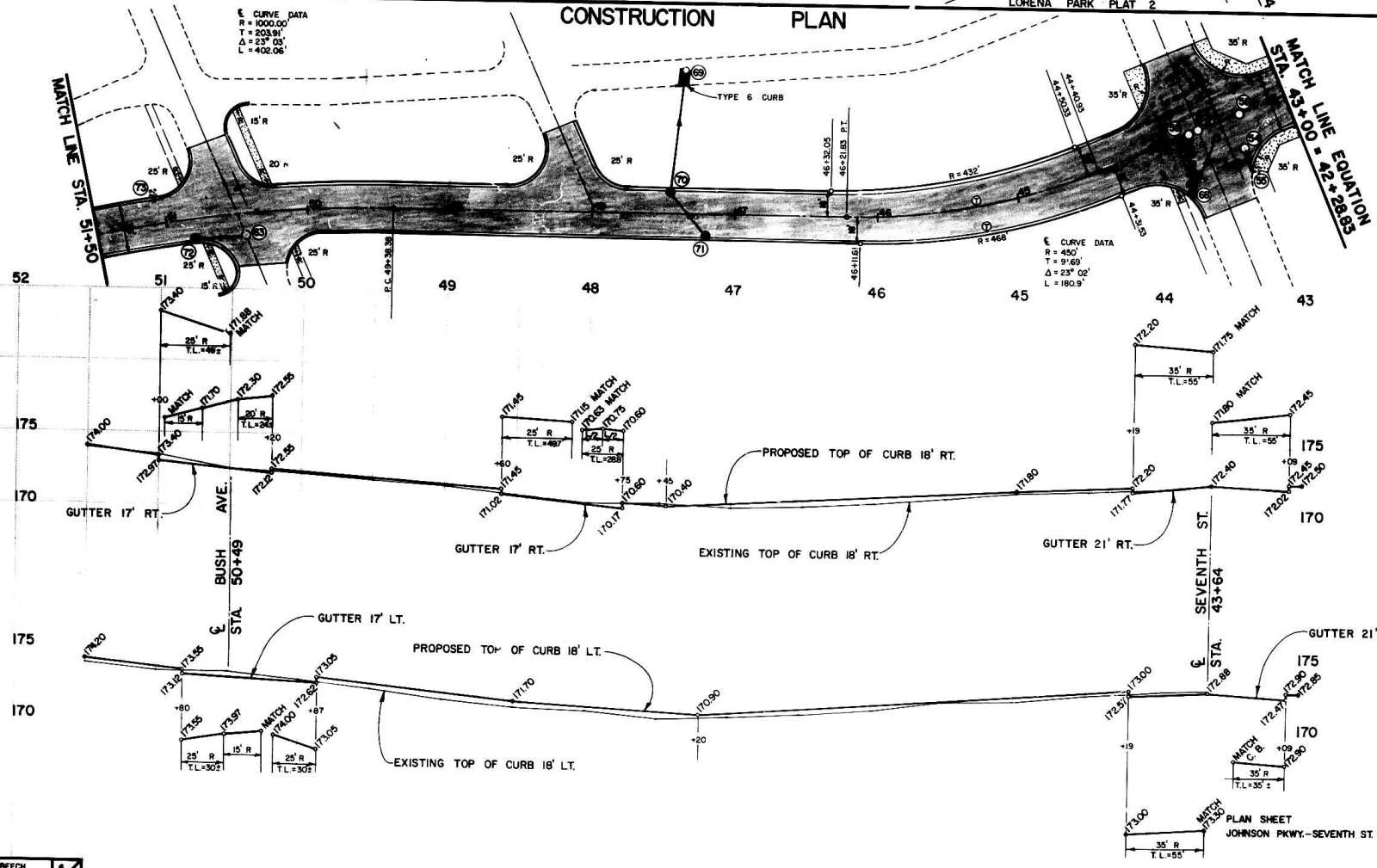

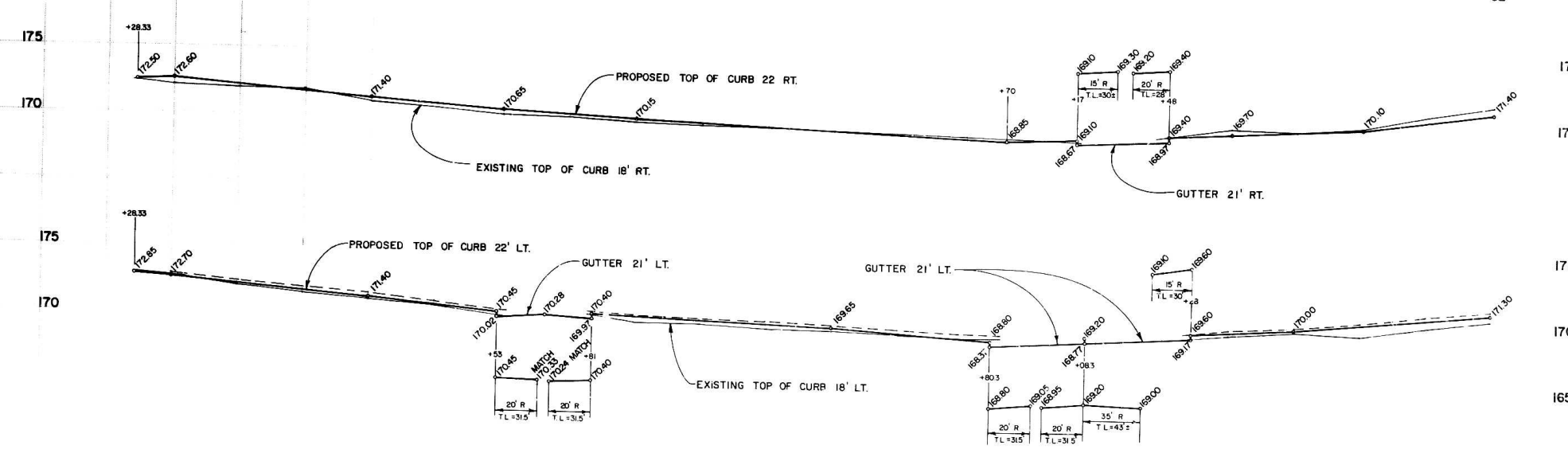
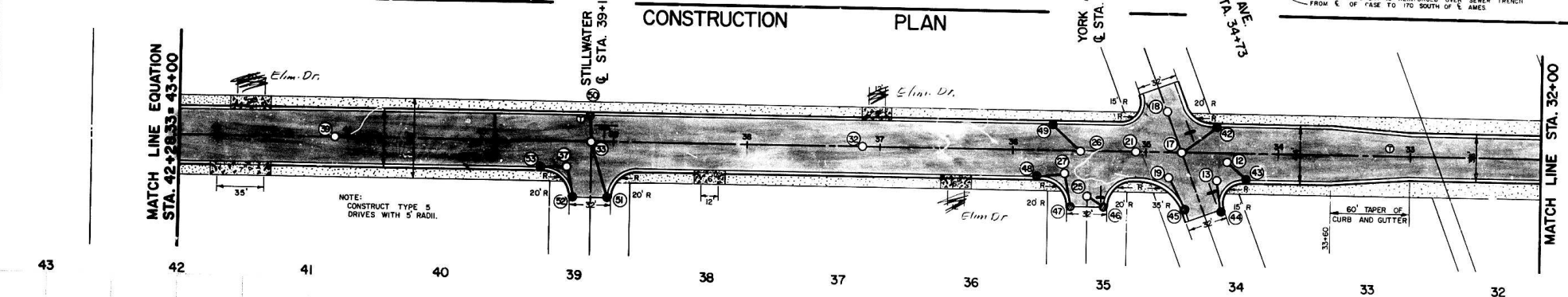
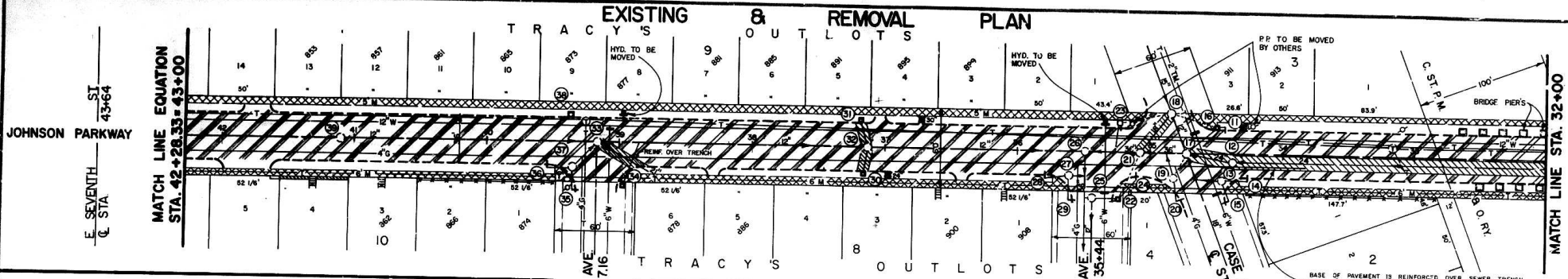

PLAN SHEET
JOHNSON PKWY. - CASE AVE. TO SEVENTH ST.

P-0559BI JOHNSON PKWY.-PROSPERITY TO BEECH
PAVING DR. 12 DRAWING NO. 1188

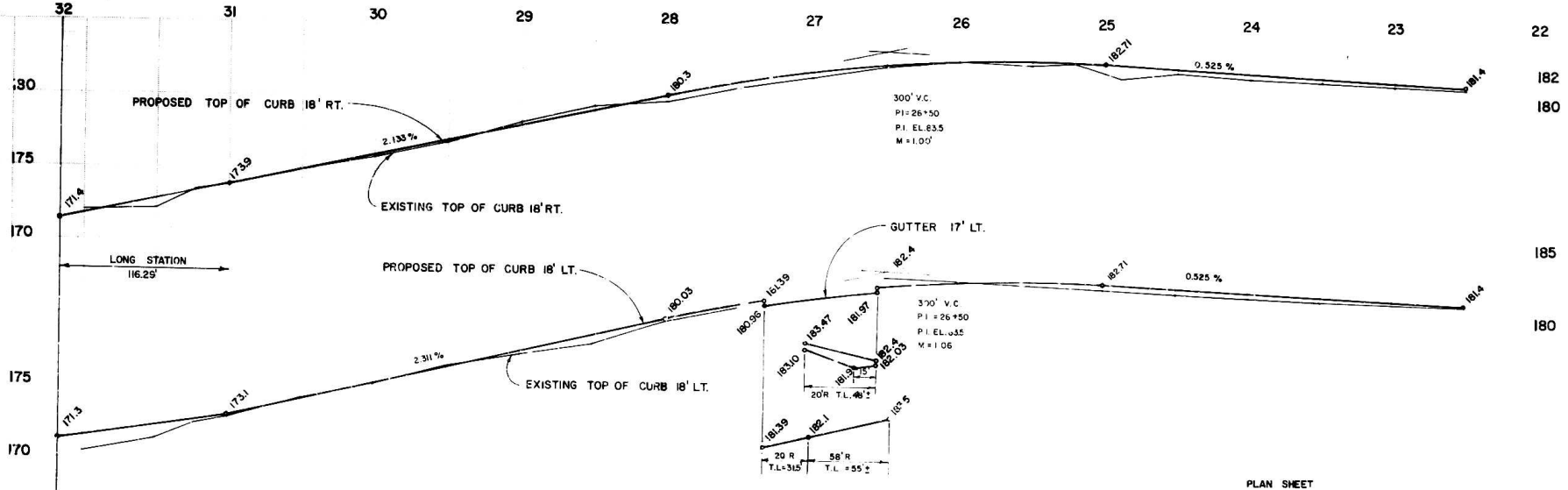
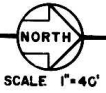
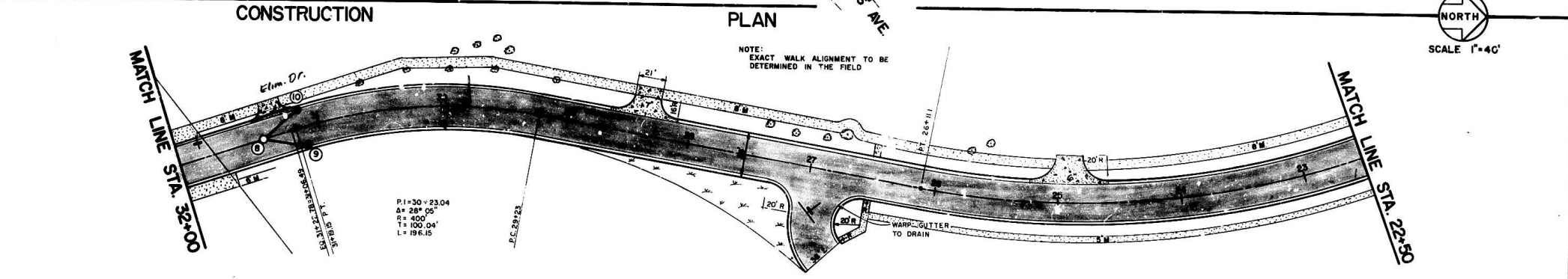
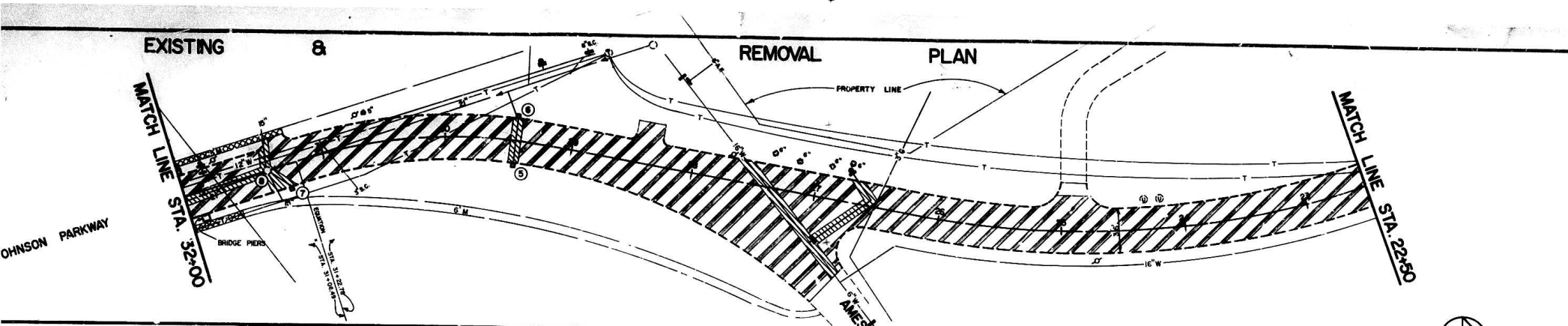

PLAN SHEET
JOHNSON PKWY.-500' NORTH & SOUTH OF AMES AVE.

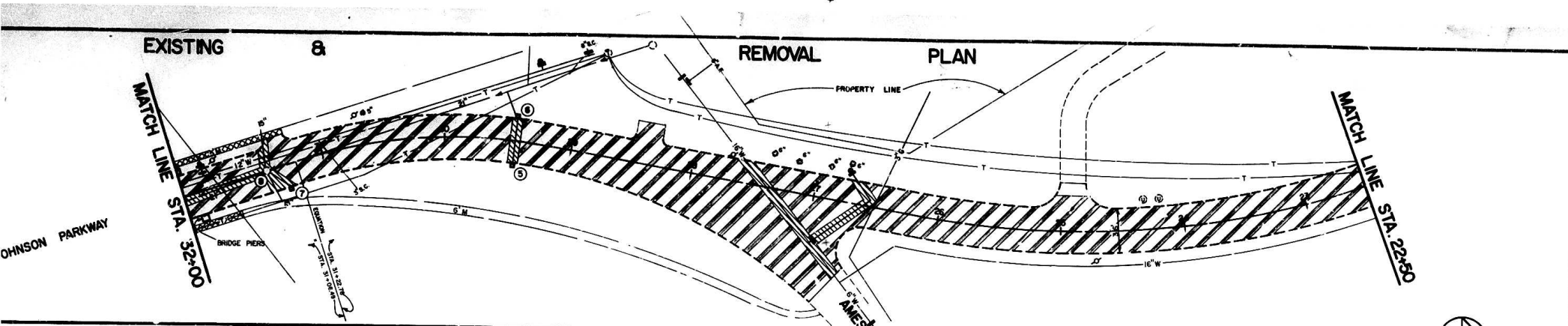

JOHNSON PARKWAY

CONSTRUCTION PLAN

NOTE: EXACT WALK ALIGNMENT TO BE DETERMINED IN THE FIELD

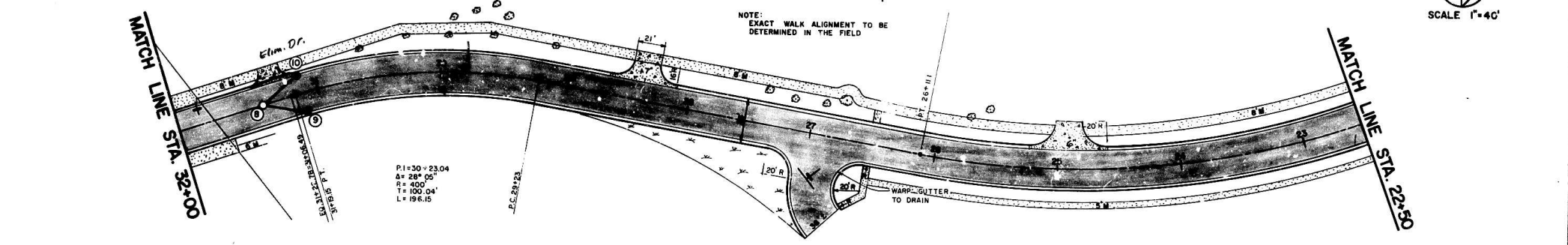

$PI = 30 + 23.04$
 $\Delta = 28^\circ 06'$
 $R = 400'$
 $T = 100.04'$
 $L = 196.15'$

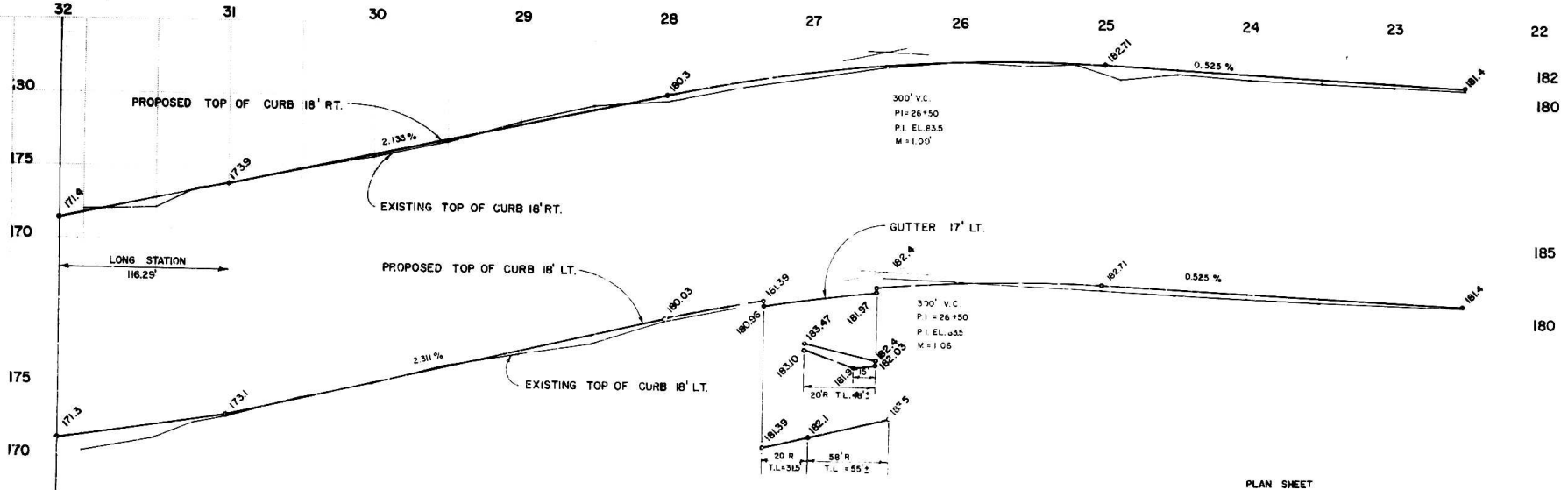

PLAN SHEET
JOHNSON PKWY. - 500' NORTH & SOUTH OF AMES AVE.

EXISTING & REMOVAL PLAN

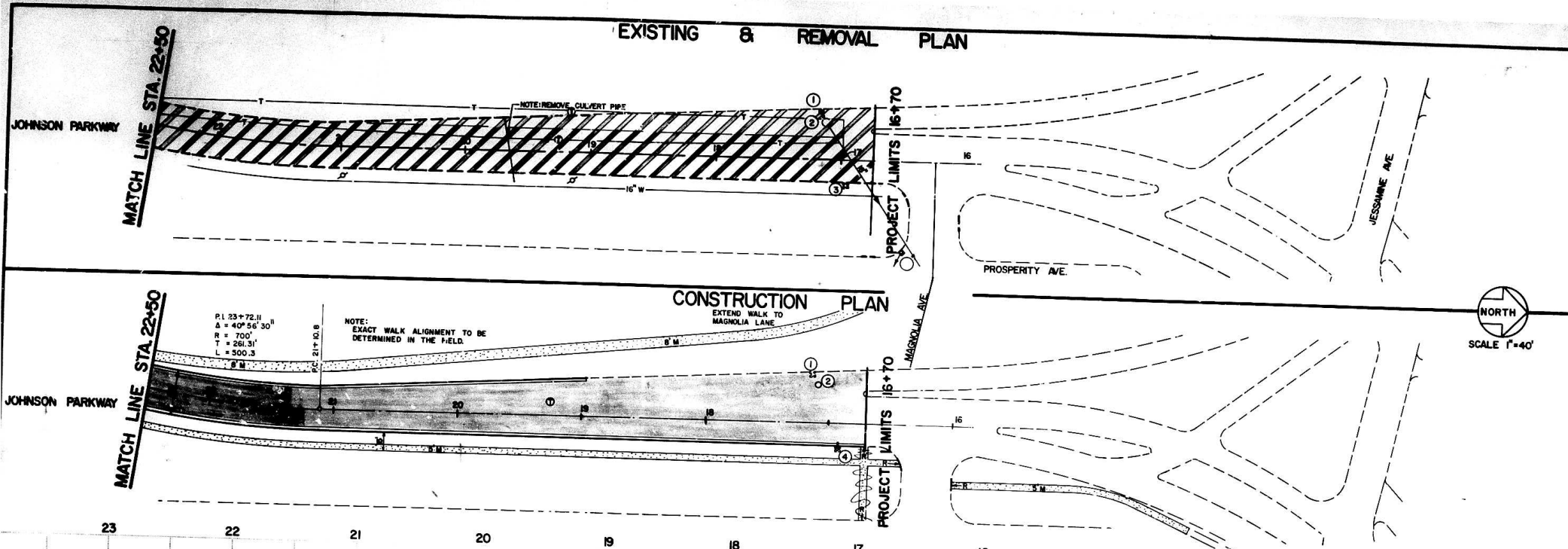

$P1\ 23+72.11$
 $\Delta = 40^\circ 56' 30''$
 $R = 700'$
 $T = 261.31'$
 $L = 500.3'$

NOTE: EXACT WALK ALIGNMENT TO BE DETERMINED IN THE FIELD.

CONSTRUCTION PLAN

EXTEND WALK TO MAGNOLIA LANE

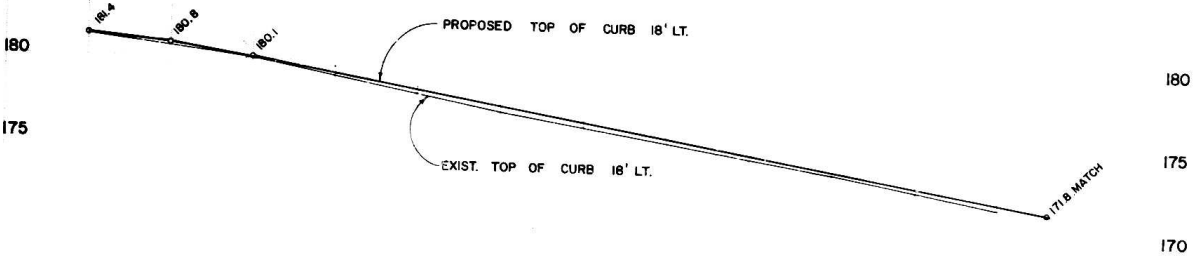
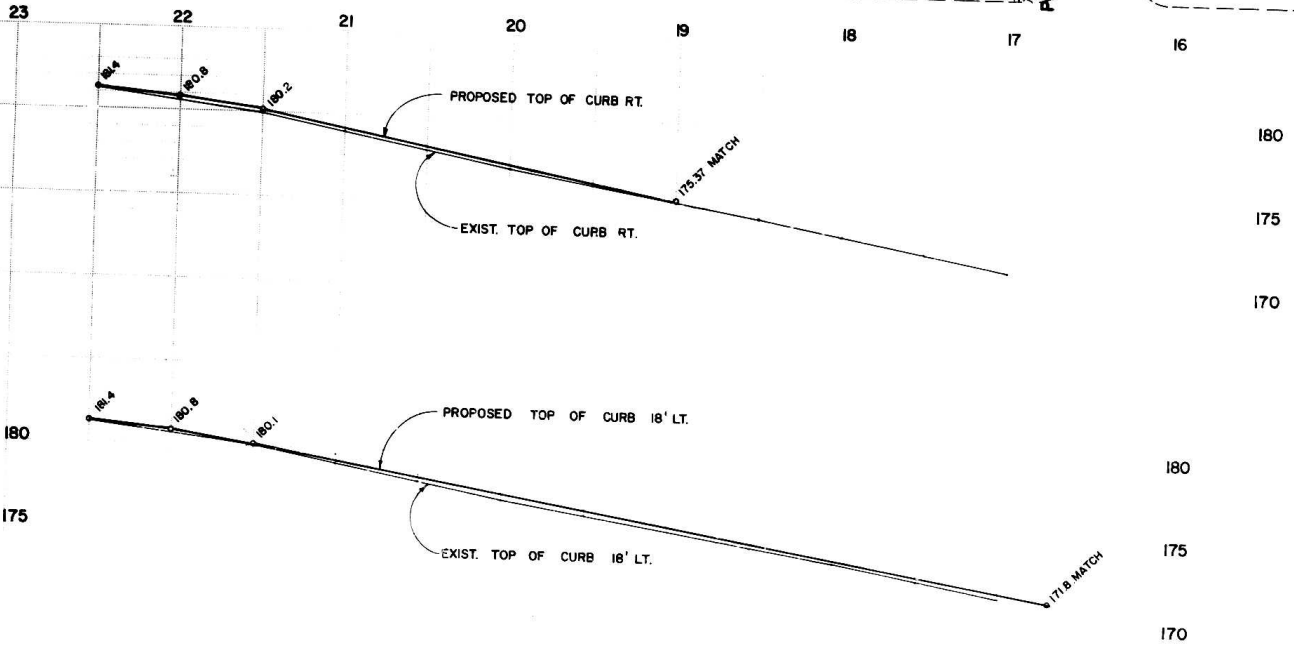

3598 JOHNSON PKWY-PROSPERITY TO BEECH
VG DR. 12 DRAWING NO. 1188



PLAN SHEET
JOHNSON PKWY.-PROSPERITY TO 550' SOUTH