

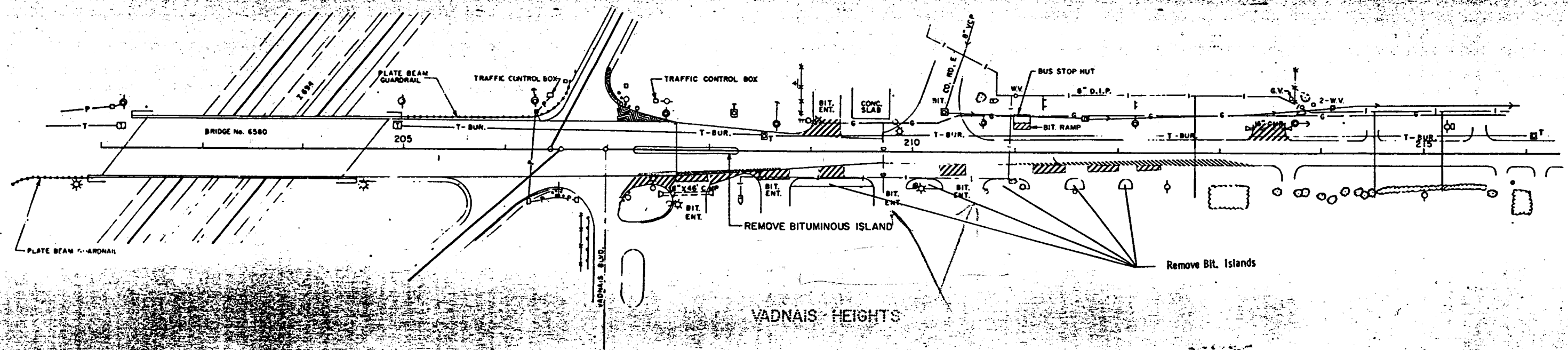



SHOREVIEW

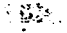
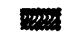

-  Remove Pavement
-  Remove Conc. Pavement
-  Remove Bit. Pavement
-  Remove Surfacing (Paid for as Roadway Excavation)

PAVEMENT REMOVALS  
EXISTING TOPOGRAPHY

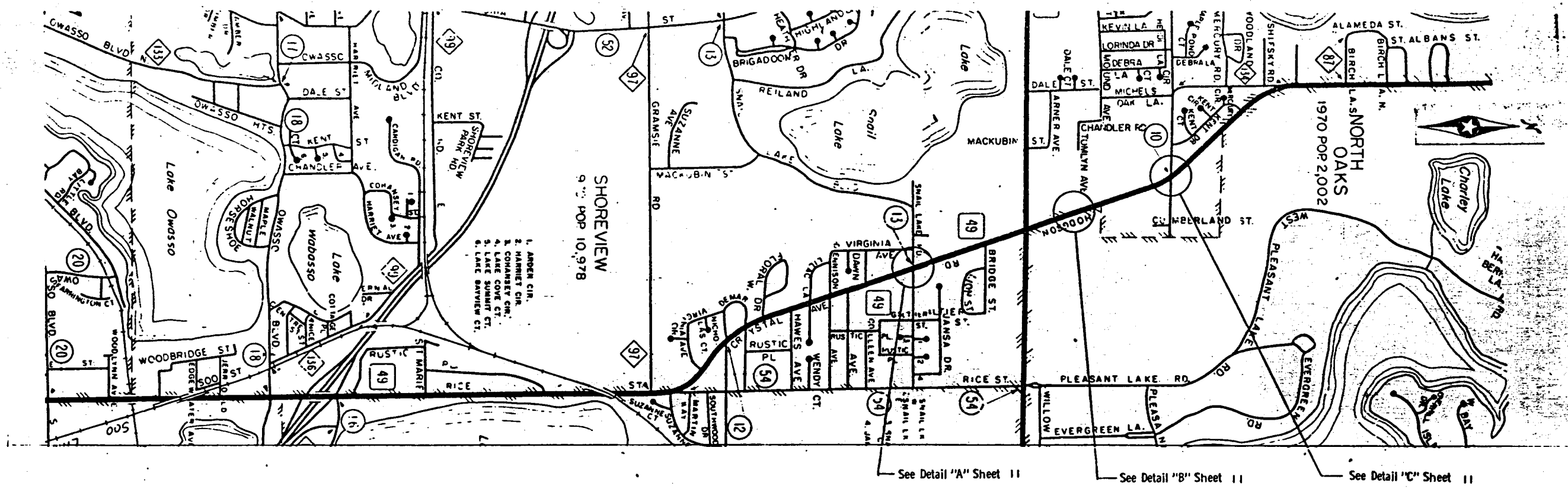

See Detail "A" Sheet 11

See Detail "B" Sheet 11

See Detail "C" Sheet 11

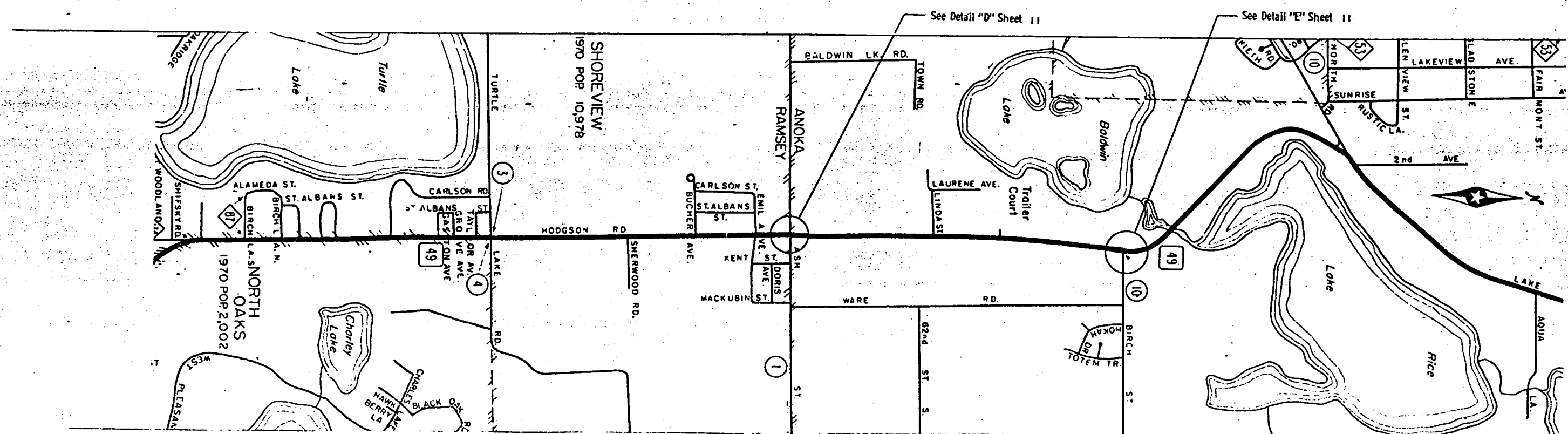

See Detail "D" Sheet 11

See Detail "E" Sheet 11

TURN LANE LOCATIONS

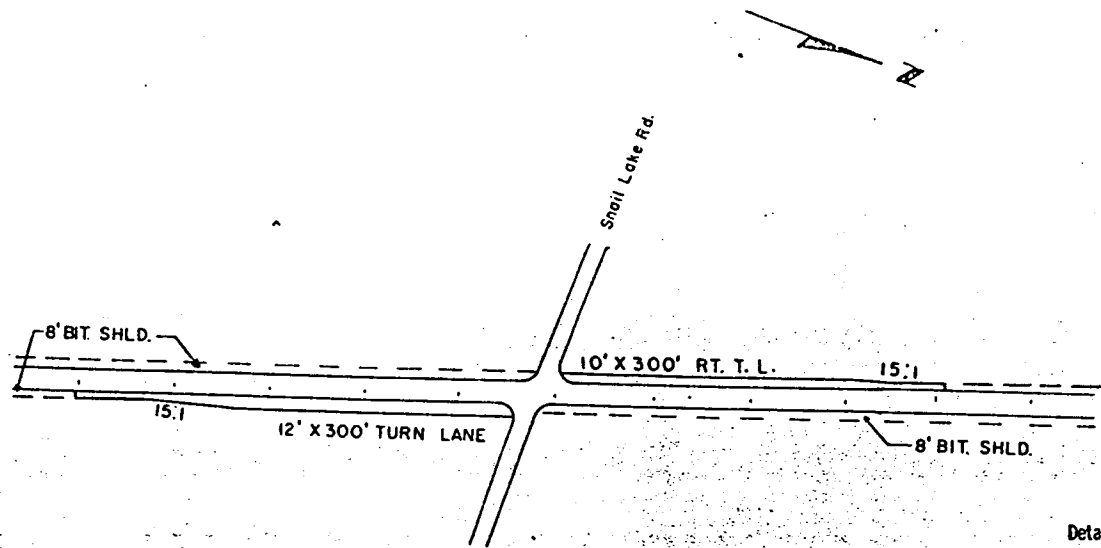

Detail "A"

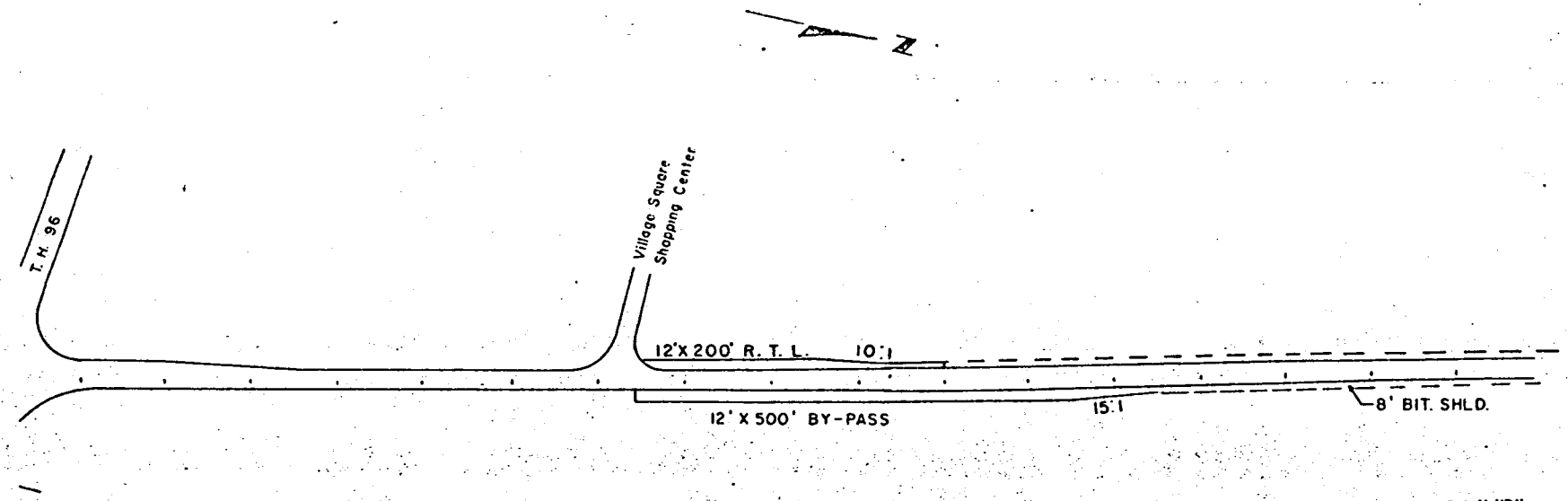

Detail "B"

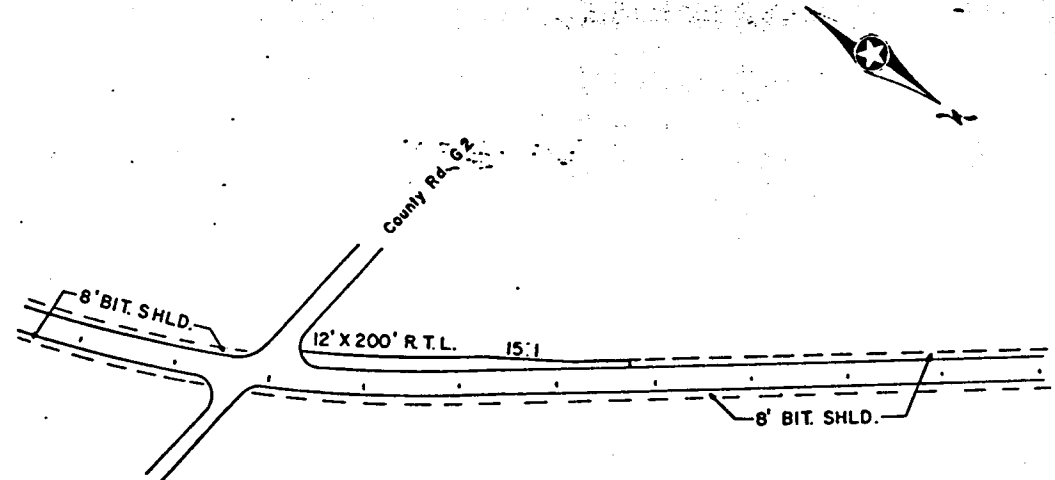

Detail "C"

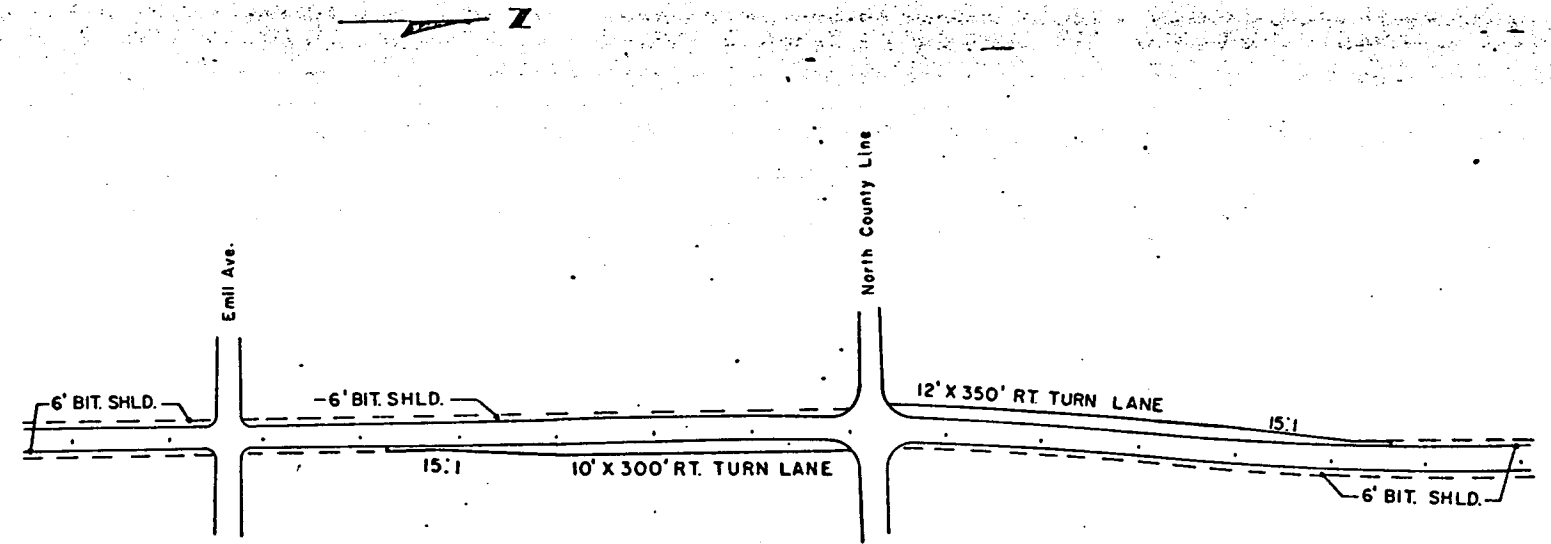

Detail "D"

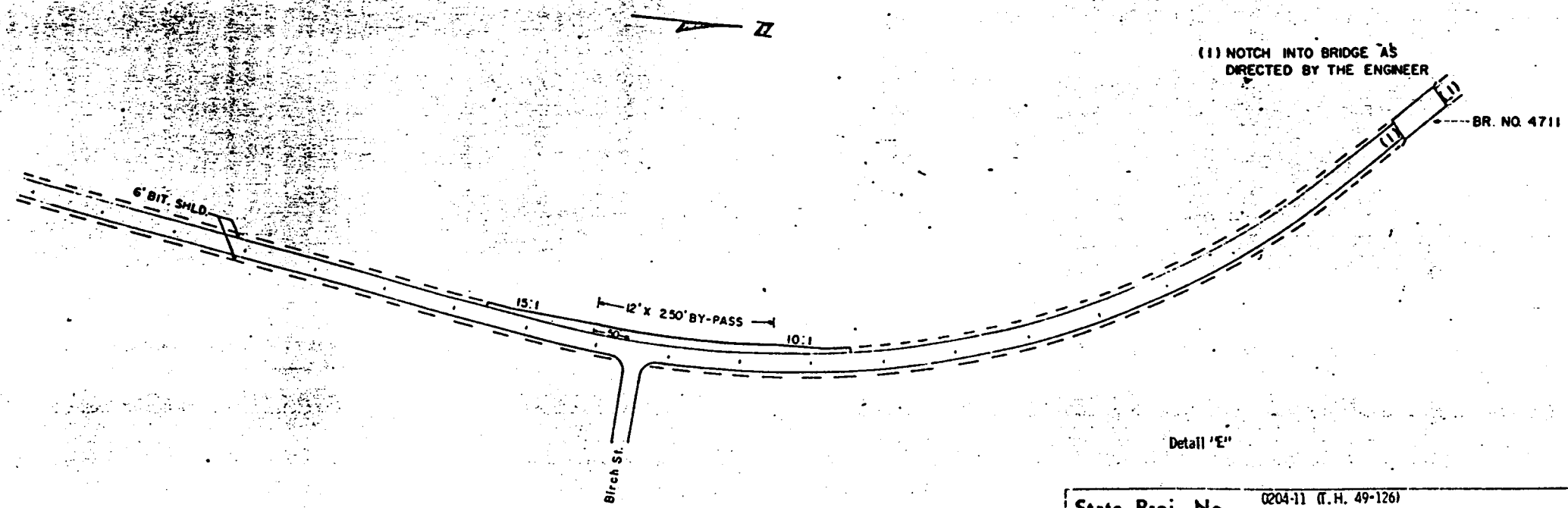

Detail "E"

SHOREVIEW

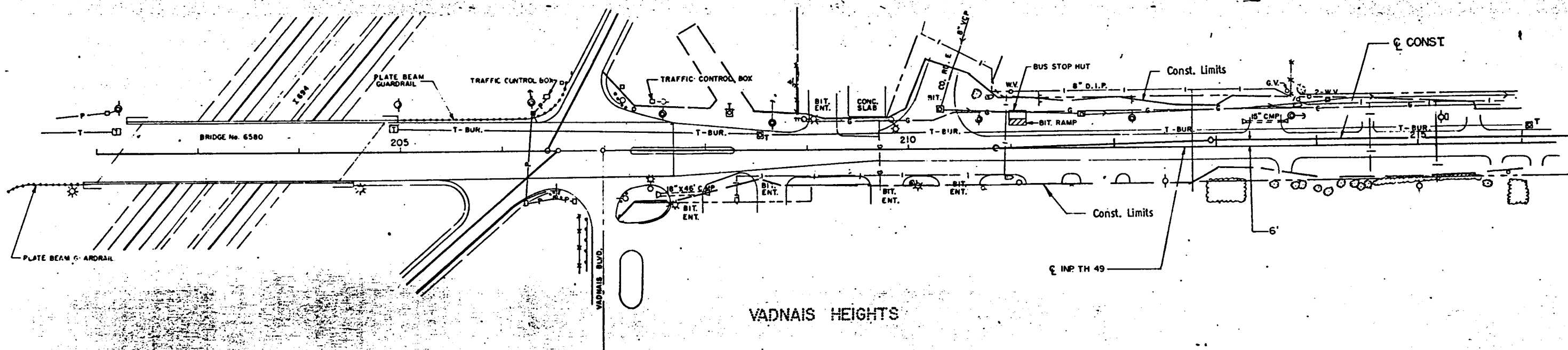

VADNAIS HEIGHTS

EXISTING TOPOGRAPHY

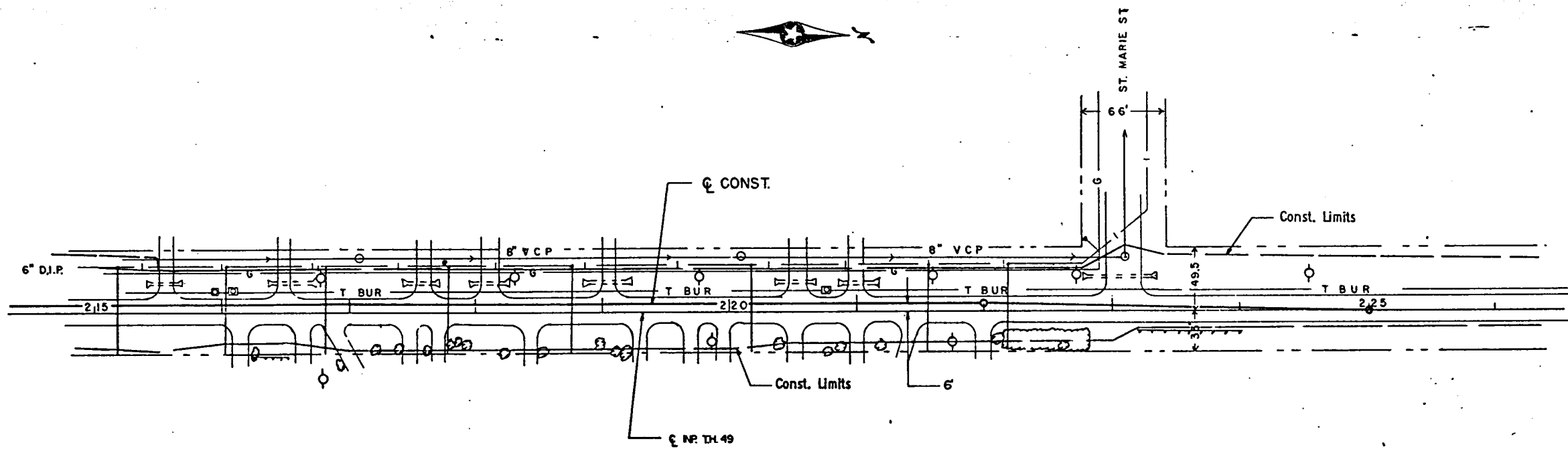

EXISTING TOPOGRAPHY

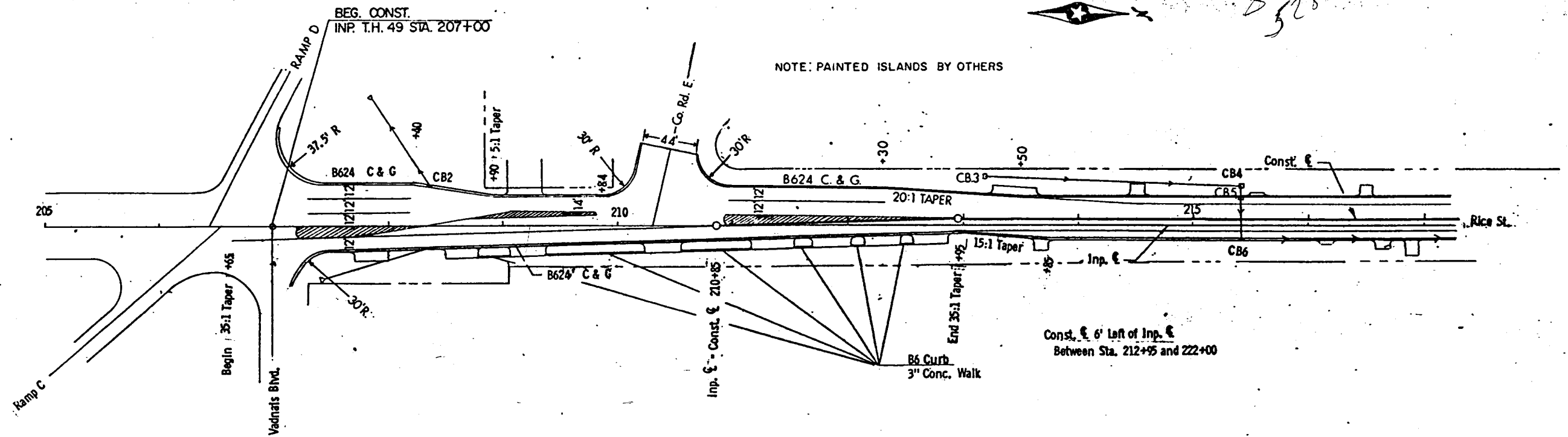

INDICATES STRIPED AREA BY OTHERS

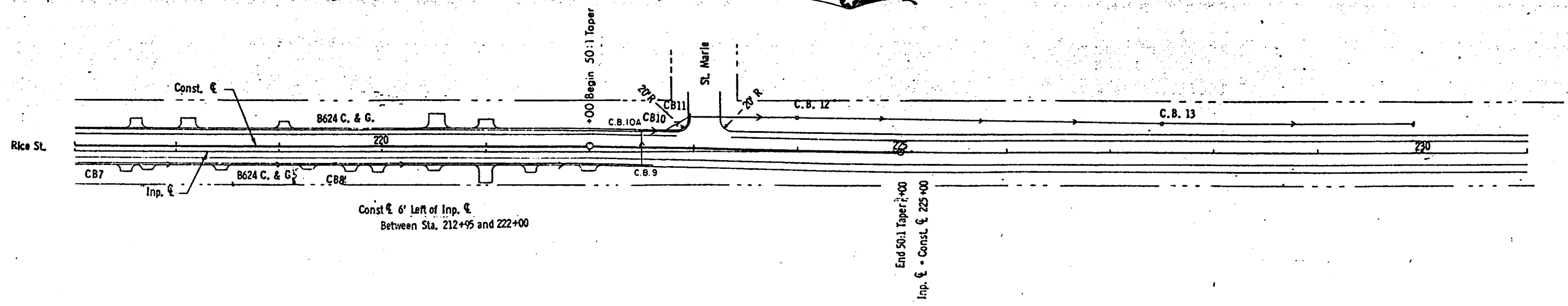

PLAN CONSTRUCTION

State Proj. No. 49-126

Sheet No. 14 of 24 Sheets

C.B. 2  
208+35, 37' LT.  
T.O.C. 926.99  
OUT. 923.96

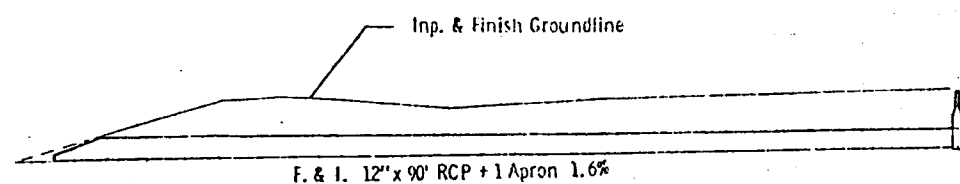

C.B. 1  
208+35, 22' RT.  
TOC 927.30  
OUT 924.30

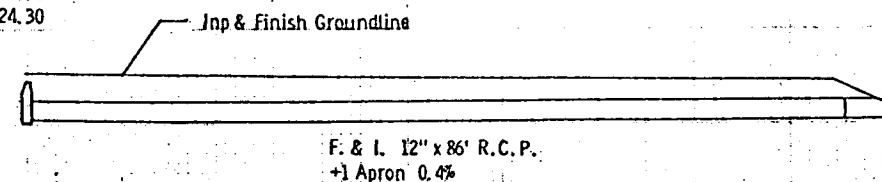

C.B. 12  
224+00, 26.5' LT.  
T.O.C. 911.60  
INL 908.33  
OUT. 908.23

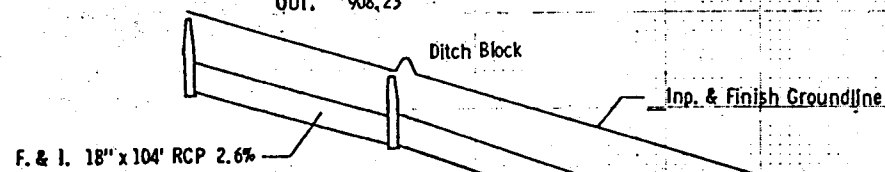

C.B. 13  
227+50, 27' LT.  
T.O.C. 899.90  
INL 896.33  
OUT. 896.23

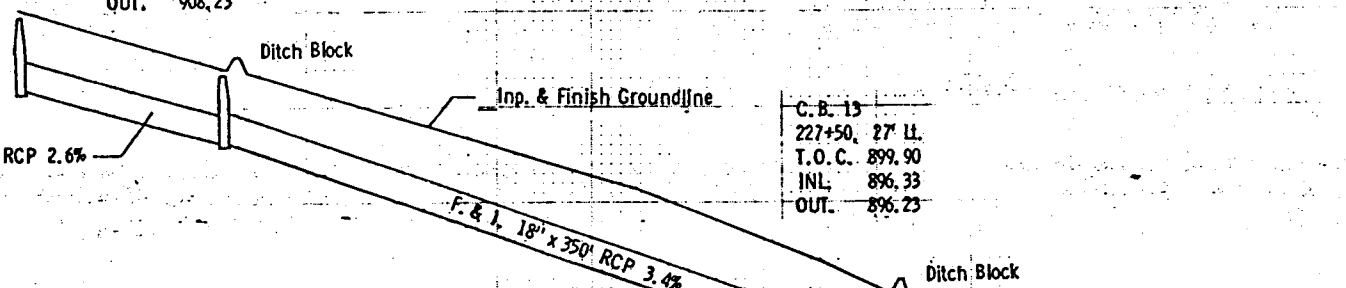

F. & I. 18" x 240' RCP 2%  
+1 Apron

2.9 cu. yd. Class "A" Riprap  
1.5 cu. yd. Type "1" Filter Blanket

C.B. 4  
215+43, 28' LT.  
T.O.C. 923.50  
INL 920.51  
OUT. 920.47

C.B. 5  
215+43, 19' LT.  
T.O.C. 924.08  
INL 920.38  
OUT. 920.34

C.B. 6  
215+43, 19' RT.  
T.O.C. 924.08  
INL 919.66  
OUT. 919.46

C.B. 7  
217+34, 19' RT.  
T.O.C. 921.98  
INL 917.55  
OUT. 917.51

C.B. 8  
219+54, 19' RT.  
T.O.C. 919.44  
INL 915.31  
OUT. 915.27

C.B. 9  
222+51, 19' RT.  
T.O.C. 915.52  
INL 912.30  
OUT. 912.26

C.B. 11  
222+96, 33.8' LT.  
T.O.C. 914.74  
INL 911.13  
OUT. 910.73

C.B. 10A  
222+51, 19' LT.  
T.O.C. 915.52  
INL 911.88  
OUT. 911.68

C.B. 10  
222+71, 19' LT.  
T.O.C. 915.22  
INL 911.48  
OUT. 911.44

C.B. 3  
213+18, 37' LT.  
T.O.C. 924.50  
OUT. 921.61

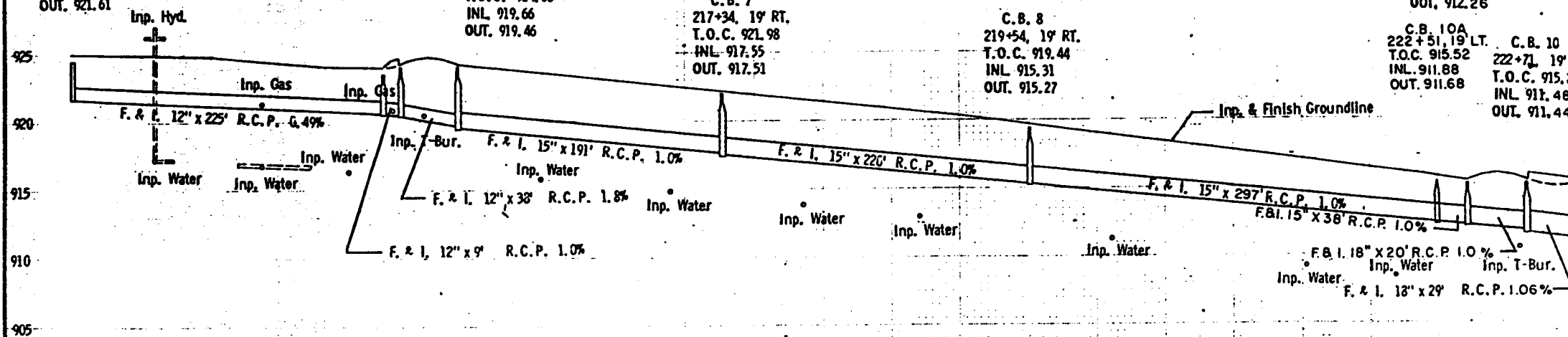

B.M. ELEV. 927.18  
Std. disc. S.E. Cor. Br. 6580

B.M. ELEV. 919.29  
Hyd. St. Marie

