

PLAN SYMBOLS

- STATE LINE
- COUNTY LINE
- TOWNSHIP OR RANGE LINE
- SECTION LINE
- QUARTER LINE
- SIXTEENTH LINE
- EXISTING RIGHT OF WAY LINE
- PROPOSED RIGHT OF WAY LINE
- PROPERTY LINE
- CORPORATE OR CITY LIMITS
- RAILROAD
- RAILROAD RIGHT-OF-WAY
- RIVER OF CREEK
- CULVERT
- GUARDRAIL
- WOOD FENCE
- BARBED WIRE FENCE
- WOVEN WIRE FENCE
- CHAIN LINK FENCE
- TIMBER WALL
- STONE WALL
- HEDGE
- RAILROAD CROSSING SIGN
- CROSSING GATE
- MEANDER CORNER
- SLOPE EASEMENT (CONST. LIMITS)

- MARSH
- DECIDUOUS TREE
- CONIFEROUS TREE
- BUSH OR SHRUB
- WOODS
- CATCH BASIN
- BRIDGE
- IRON PIPE OR ROD
- MONUMENT (STONE, CONCRETE OR METAL)
- WOODEN HUB

UTILITY SYMBOLS

- UTILITY POLE
- GUY OR ANCHOR
- STREET LIGHT
- TELEPHONE PEDESTAL
- GAS MAIN
- WATER MAIN
- TELEPHONE VAULT
- ELECTRIC VAULT
- TELEPHONE CABLE
- ELECTRIC CABLE
- STORM SEWER
- SANITARY SEWER
- SEWER MANHOLE
- GATE VALVE
- CONTROLLER CABINET
- EXISTING HYDRANT
- CABLE TELEVISION-BURIED
- FIBER OPTIC CABLE
- TRAFFIC SIGNAL LINE
- TRAFFIC SIGNAL HAND HOLE

FOR PLANS AND UTILITIES SYMBOLS SEE MN/DOT TECHNICAL MANUAL.

—GOVERNING SPECIFICATIONS—

THE 2014 EDITION OF THE MINNESOTA DEPARTMENT OF TRANSPORTATION "STANDARD SPECIFICATIONS FOR CONSTRUCTION" AND THE 2014 EDITION OF THE "MATERIALS LAB SUPPLEMENTAL SPECIFICATIONS FOR CONSTRUCTION" SHALL GOVERN.

ALL TRAFFIC CONTROL DEVICES AND SIGNING SHALL CONFORM TO THE MMUTCD, INCLUDING FIELD MANUAL FOR TEMPORARY TRAFFIC CONTROL ZONE LAYOUTS, SEE HTTP://WWW.DOT.STATE.MN.US/TRAFFICENG/

ALL APPLICABLE FEDERAL, STATE AND LOCAL LAWS AND ORDINANCES WILL BE COMPLIED WITH IN THE CONSTRUCTION OF THIS PROJECT.

SCALES IN FEET

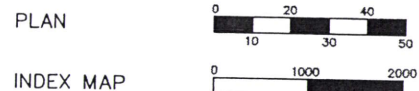

GROSS LENGTH 7073.00 FEET 1.34 MILES  
 BRIDGE LENGTH -----  
 EXCEPTIONS -----  
 NET LENGTH 7073.00 FEET 1.34 MILES



RAMSEY COUNTY  
 DEPARTMENT OF PUBLIC WORKS

PLAN FOR THE FULL DEPTH RECLAMATION OF

CENTERVILLE ROAD  
 S.A.P. No. 062-659-016

BETWEEN: COUNTY ROAD H2 & COUNTY ROAD J  
 COUNTY PROJECT P5002

INDEX

SHEET NO.	DESCRIPTION
1	TITLE SHEET
2	ESTIMATED QUANTITIES
3	TYPICAL SECTIONS
4	DETAILS
5-10	PLAN SHEETS
11-16	STRIPING PLAN

THIS PLAN CONTAINS 16 SHEETS

BEGIN S.A.P. 062-659-016  
 CENTERVILLE ROAD  
 STA. 9+38.00

END S.A.P. 062-659-016  
 CENTERVILLE ROAD  
 STA. 81+11.00

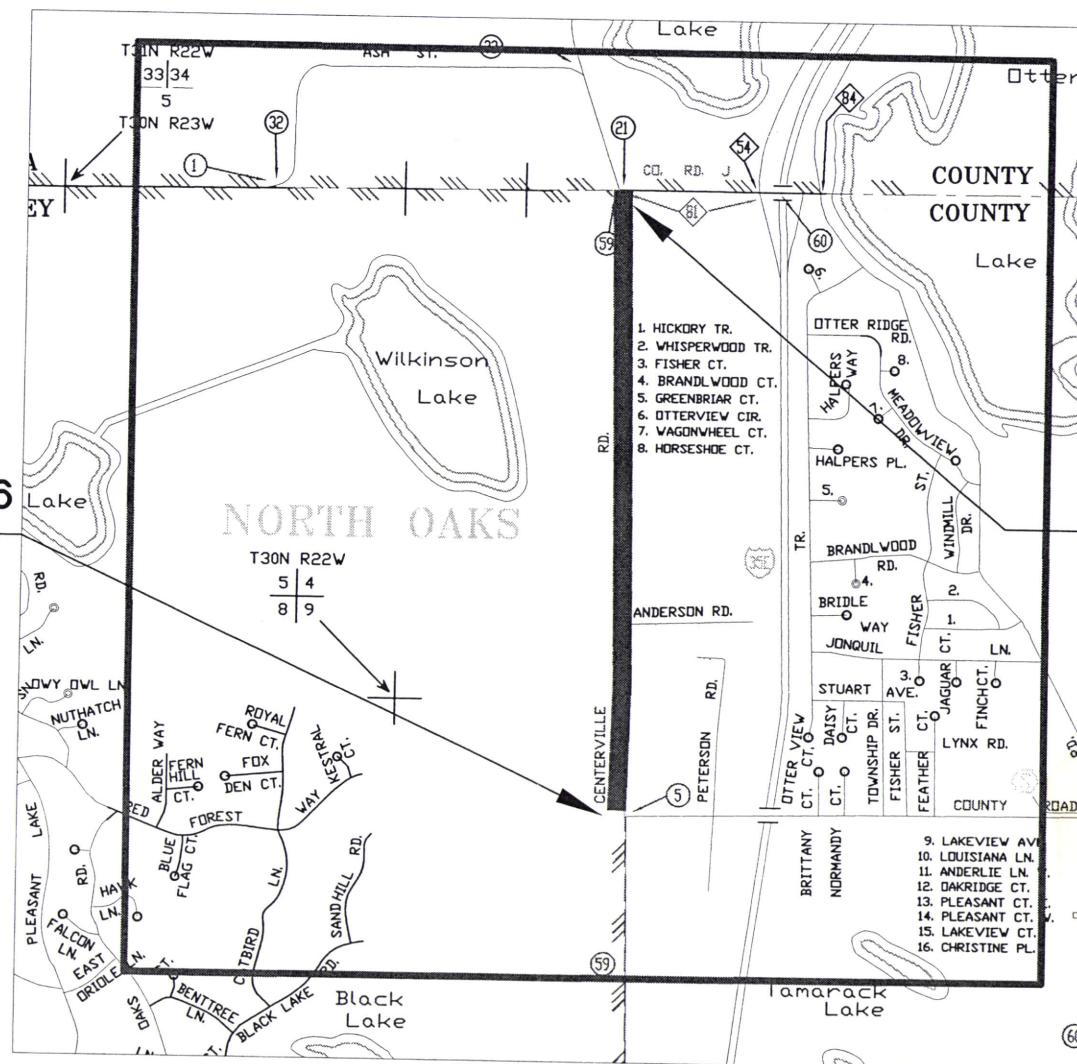

I HEREBY CERTIFY THAT THIS PLAN WAS PREPARED BY ME OR UNDER MY DIRECT SUPERVISION AND THAT I AM A DULY LICENSED PROFESSIONAL ENGINEER UNDER THE LAWS OF THE STATE OF MINNESOTA.

*Nicklaus Fischer*  
 NICKLAUS FISCHER REG. NO. 50791 DATE 4/30/2014

RECOMMENDED FOR APPROVAL *[Signature]* DATE 5/19/14  
 RAMSEY COUNTY ENGINEER

APPROVED *[Signature]* DATE 5/2/2014  
 WHITE BEAR TWP.

APPROVED *[Signature]* DATE 4/30/2014  
 CITY OF NORTH OAKS

DRAWN BY R. BUSSIERE DATE 4-22-14  
 CHECKED BY \_\_\_\_\_ DATE \_\_\_\_\_

DESIGN DESIGNATION

COUNTY ROAD H2 TO COUNTY RD J

PRESENT ADT (2014)	5450
PROJECTED ADT (2034)	6540
FUNCTIONAL CLASS	A MINOR EXPANDER
TRAFFIC LANES	2
PARKING LANES	0
SOILS R-VALUE	50

BASED ON STOPPING DISTANCE  
 HEIGHT OF EYE: 3.50 FEET  
 HEIGHT OF OBJECT: 2.00 FEET

PLAN REVISIONS		
DATE	SHEET NO. & DESCRIPTION	BY

MINNESOTA DEPARTMENT OF TRANSPORTATION

*Jane Drael*  
 DISTRICT STATE AID ENGINEER  
 REVIEWED FOR COMPLIANCE WITH STATE-AID RULES/POLICY  
 APPROVED *Jane Drael* DATE 5/19/14  
 APPROVED FOR STATE AID FUNDING: STATE AID ENGINEER





**STATEMENT OF ESTIMATED QUANTITIES**

**FULL DEPTH RECLAMATION  
S.A.P. 062-659-016**

Item Number	Item	Notes	Unit	Estimated Quantity 100% S.A.P. 062-659-017
2021.501	MOBILIZATION		L.S.	1
2104.501	REMOVE CURB & GUTTER		L.F.	100
2104.511	SAWCUT CONCRETE - FULL DEPTH		L.F.	100
2105.501	COMMON EXCAVATION (EV)	1	C.Y.	15
2123.610	STREET SWEEPER (WITH PICKUP BROOM)		Hour	20
2331.604	BITUMINOUS PAVEMENT RECLAMATION		S.Y.	31,134
2357.502	BITUMINOUS MATERIAL FOR TACK	3	GAL.	3,114
2360.501	TYPE SPWEB340C WEARING COURSE	4	TON	7,161
2360.505	BITUMINOUS MIXTURE FOR PATCHING	5	TON	100
2506.522	ADJUST FRAME RING & CASTING		EACH	22
2506.602	CONSTRUCT SURVEY CONTROL STRUCTURE		EACH	2
2531.501	CONCRETE CURB & GUTTER DESIGN D424		L.F.	100
2563.601	TRAFFIC CONTROL		L.S.	1
2573.530	STORM DRAIN INLET PROTECTION		EACH	20
2574.525	TOPSOIL BORROW (LV)	2	C.Y.	22
2575.571	RAPID STABILIZATION METHOD 3	6,7	M.GAL.	10
2582.501	PAVEMENT MESSAGE RT. ARROW - EPOXY		EACH	4
2582.502	4" SOLID LINE WHITE - EPOXY		L.F.	13,778
2582.502	12" SOLID LINE WHITE - EPOXY		L.F.	40
2582.502	4" SOLID LINE YELLOW - EPOXY		L.F.	1,775
2582.502	4" BROKEN LINE YELLOW - EPOXY		L.F.	1,262
2582.502	4" DOUBLE LINE YELLOW - EPOXY		L.F.	1,704

1. Common Excavation is measured 3 feet from the back of curb at a depth of 6 inches.
2. Topsoil is measured 3 feet from back of curb at a depth of 4 inches.
3. Tack coat is estimated at 0.05 gallons / square yard bituminous / lift
4. Bituminous is estimated at 115 lbs / square yard / inch of bituminous
5. Bituminous patching mix is SPWEB340C
6. Rapid stabilization method 3 is estimated at 6,000 gallons / acre
7. Only to be used on curb removal areas.

MNDOT STANDARD PLATES	
8000 I	STANDARD BARRICADES

NO.	REV-DATE	BY:	DESCRIPTION	I HEREBY CERTIFY THAT THIS PLAN WAS PREPARED BY ME OR UNDER MY DIRECT SUPERVISION AND THAT I AM A DULY LICENSED PROFESSIONAL ENGINEER UNDER THE LAWS OF THE STATE OF MINNESOTA. SIGNED: <i>William F. ...</i> REG NO: <u>50791</u> DATE: <u>4-30-2014</u>
1	xx-xx-xx	xx		

CENTERVILLE ROAD  
COUNTY ROAD H2 to COUNTY ROAD J

S.A.P. 062-659-016  
County Proj. P-5002



Estimated Quantities  
Sheet No. 2 of 16 Sheets

## TYPICAL SECTION - CENTERVILLE RD. STA. 9+38.00 TO STA. 81+11.00

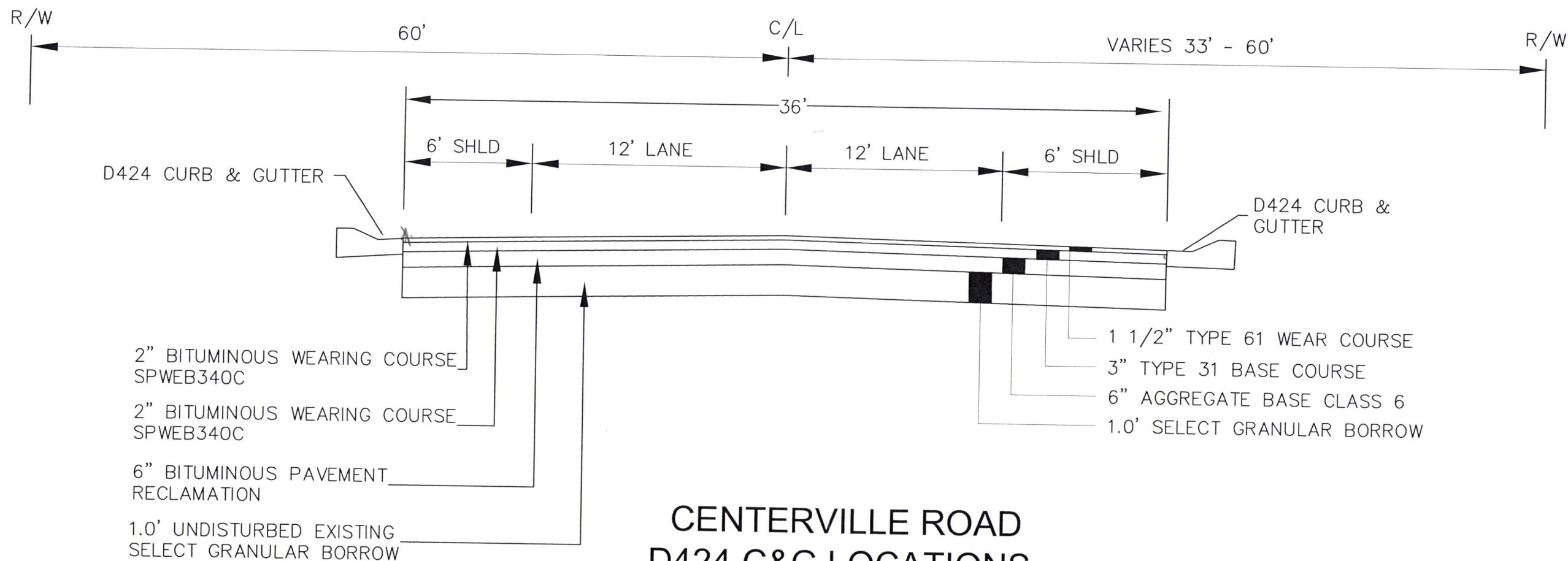

### CENTERVILLE ROAD D424 C&G LOCATIONS

- STA. 10+35 TO STA. 22+89 C&G ON LT
- STA. 10+85 TO STA. 17+85 C&G ON RT
- STA. 35+20 TO STA. 39+40 C&G ON RT
- STA. 50+25 TO STA. 54+50 C&G ON RT
- STA. 61+05 TO STA. 77+05 C&G ON RT

NO.	REV-DATE	BY:	DESCRIPTION	I HEREBY CERTIFY THAT THIS PLAN WAS PREPARED BY ME OR UNDER MY DIRECT SUPERVISION AND THAT I AM A DULY LICENSED PROFESSIONAL ENGINEER UNDER THE LAWS OF THE STATE OF MINNESOTA.	S.A.P. 062-659-016		Typical Section
				SIGNED: <i>[Signature]</i>	County Proj. P-5002		Sheet No. 3 of 16 Sheets
				REG NO: 50791 DATE: 4-30-2014			

CENTERVILLE ROAD  
CO RD H2 TO COUNTY RD J



# CONTROL STRUCTURE SURVEY MONUMENT MANHOLE

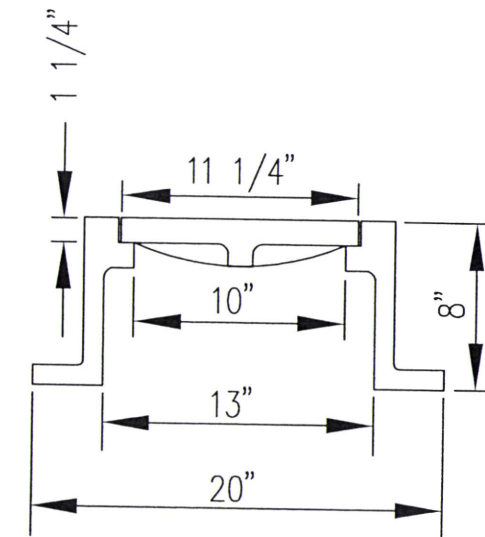
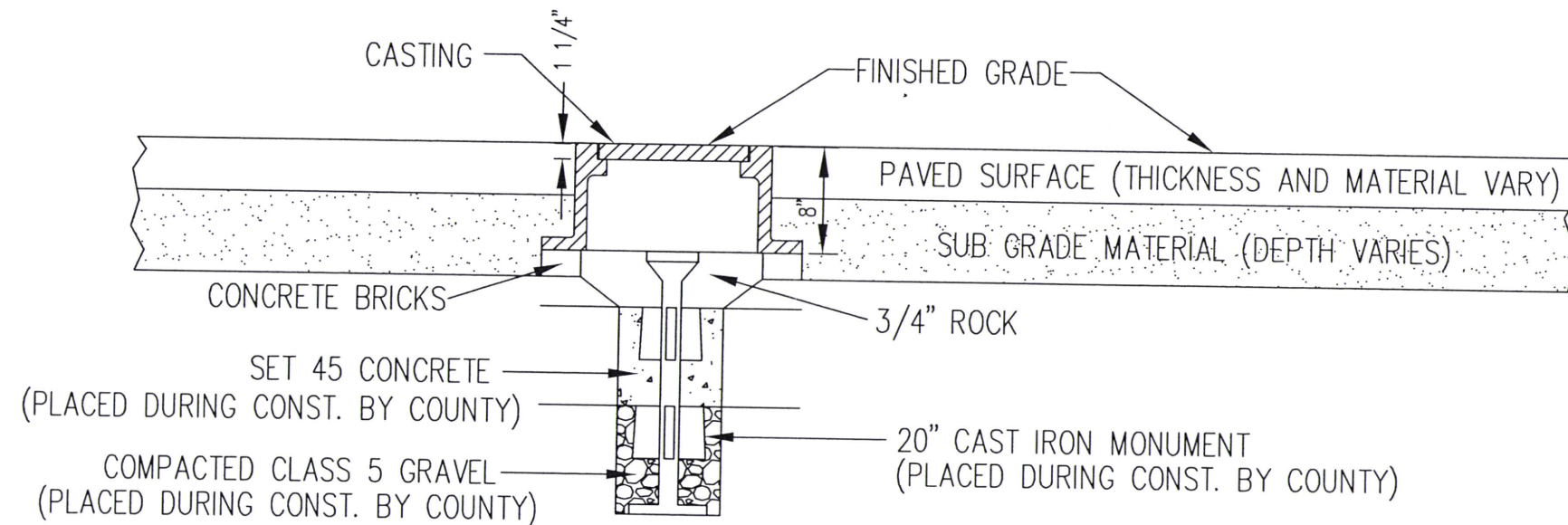

CAST IRON CASTING

WEIGHT = 95 lbs

NO. REV-DATE	BY:	DESCRIPTION	I HEREBY CERTIFY THAT THIS PLAN WAS PREPARED BY ME OR UNDER MY DIRECT SUPERVISION AND THAT I AM A DULY LICENSED PROFESSIONAL ENGINEER UNDER THE LAWS OF THE STATE OF MINNESOTA.	S.A.P. 062-659-016		Detail
			SIGNED: <i>Mark Fusler</i>	County Proj. P-5002		Sheet No. 4 of 16 Sheets
			REG NO: 50791 DATE: 4-30-2014			

CENTERVILLE ROAD  
CO RD H2 TO COUNTY RD J



BEGIN PROJECT  
 STA 9+38.00  
 S.A.P. 062-659-016  
 CENTERVILLE RD.

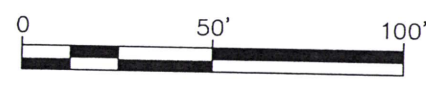

RIGHT OF WAY INFORMATION  
 FOR REFERENCE ONLY

R/W  
 FDR LIMITS

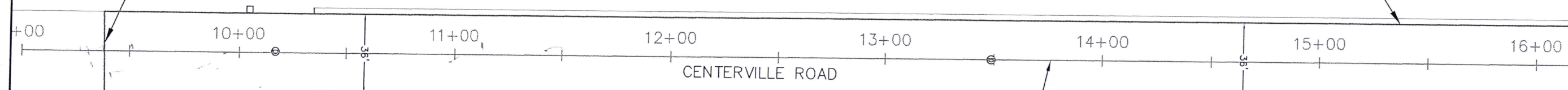

COUNTY ROAD H2

MILLING LIMITS

100'

1069

5398

5400

5440

FDR LIMITS

CONSTRUCTION C/L

R/W

FDR LIMITS

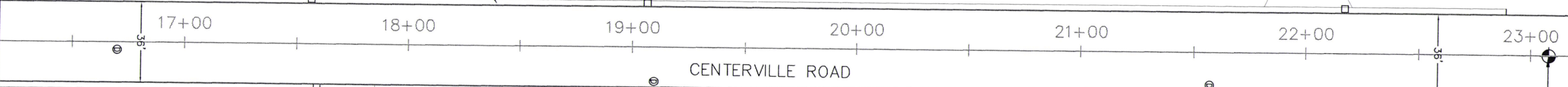

FDR LIMITS

RECONSTRUCT SURVEY MONUMENT  
 SEE DETAIL

RIGHT OF WAY INFORMATION  
 FOR REFERENCE ONLY

R/W

440

NO.	REV-DATE	BY:	DESCRIPTION

I HEREBY CERTIFY THAT THIS PLAN WAS PREPARED BY ME OR UNDER MY DIRECT SUPERVISION AND THAT I AM A DULY LICENSED PROFESSIONAL ENGINEER UNDER THE LAWS OF THE STATE OF MINNESOTA.  
 SIGNED: *Melissa Siskin*  
 REG NO: 50791 DATE: 5-16-2014

CENTERVILLE ROAD  
 CO RD H2 TO COUNTY RD J

S.A.P. 062-659-016  
 County Proj. P-5002

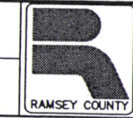

Roadway Plan  
 Sheet No. 5 of 16 Sheets

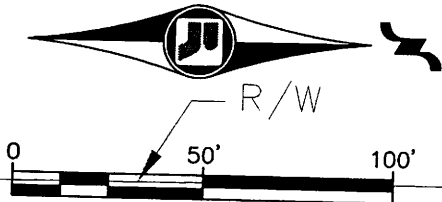

FDR LIMITS

RIGHT OF WAY INFORMATION  
FOR REFERENCE ONLY

CONSTRUCTION C/L

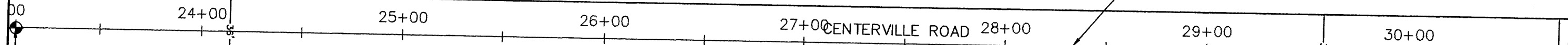

FDR LIMITS

R/W

FDR LIMITS

RIGHT OF WAY INFORMATION  
FOR REFERENCE ONLY

CONSTRUCTION C/L

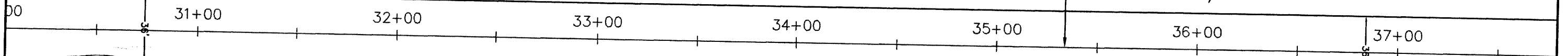

FDR LIMITS

R/W

ANDERSON LN

NO.	REV-DATE	BY:	DESCRIPTION
1	XX-XX-XX	XX	

I HEREBY CERTIFY THAT THIS PLAN WAS PREPARED BY ME OR UNDER MY DIRECT SUPERVISION AND THAT I AM A DULY LICENSED PROFESSIONAL ENGINEER UNDER THE LAWS OF THE STATE OF MINNESOTA.  
 SIGNED: *William J. Jahn*  
 REG NO: 50791 DATE: 4-30-2014

CENTERVILLE ROAD  
CO RD H2 TO COUNTY RD J

S.A.P. 062-659-016  
County Proj. P-5002



Roadway Plan  
Sheet No. 6 of 16 Sheets

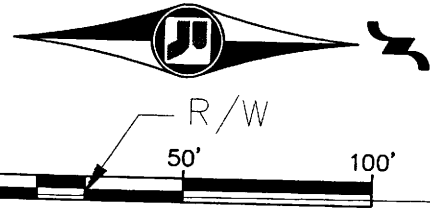

RIGHT OF WAY INFORMATION  
FOR REFERENCE ONLY

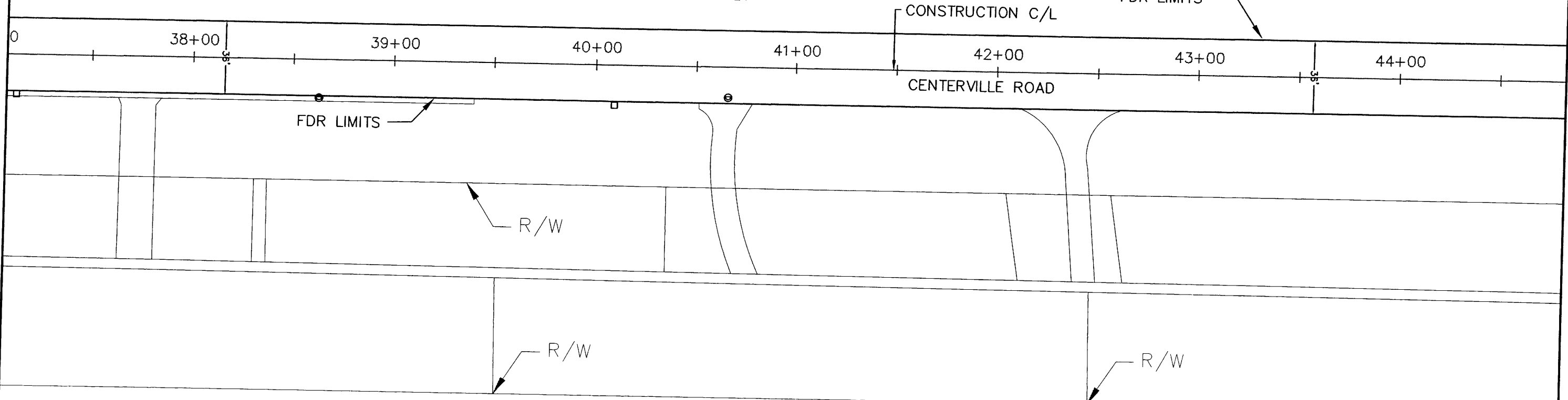

RIGHT OF WAY INFORMATION  
FOR REFERENCE ONLY

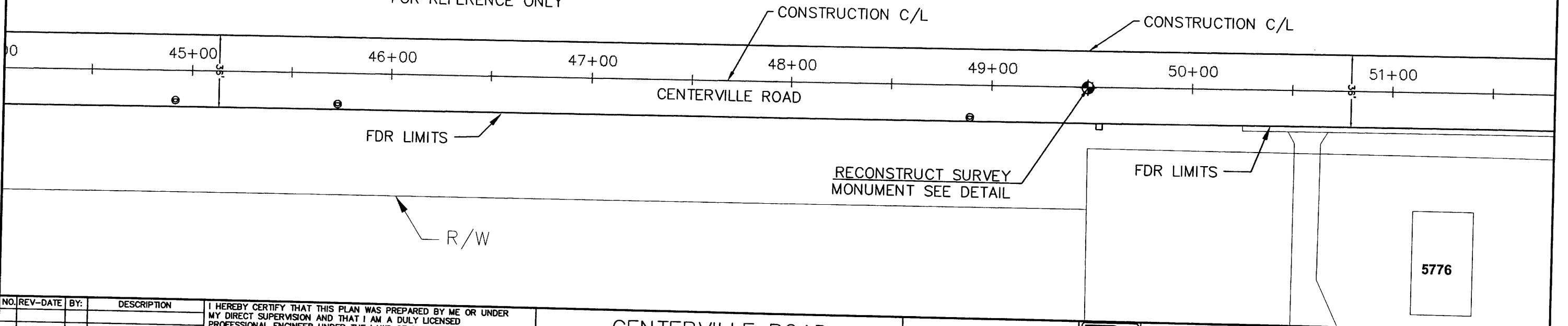

NO.	REV.	DATE	BY:	DESCRIPTION

I HEREBY CERTIFY THAT THIS PLAN WAS PREPARED BY ME OR UNDER MY DIRECT SUPERVISION AND THAT I AM A DULY LICENSED PROFESSIONAL ENGINEER UNDER THE LAWS OF THE STATE OF MINNESOTA.  
 SIGNED: *Pauline J. Leelan*  
 REG NO: *50791* DATE: *4-30-2014*

**CENTERVILLE ROAD**  
 CO RD H2 TO COUNTY RD J

S.A.P. 062-659-016  
 County Proj. P-5002



Roadway Plan  
 Sheet No. 7 of 16 Sheets

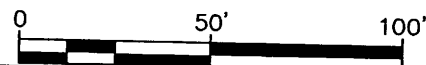

RIGHT OF WAY INFORMATION  
FOR REFERENCE ONLY

R/W

FDR LIMITS

CONSTRUCTION C/L

0 52+00 53+00 54+00 55+00 56+00 57+00 58+00

CENTERVILLE ROAD

FDR LIMITS

5776

R/W

KINSON LAKE BLVD

RIGHT OF WAY INFORMATION  
FOR REFERENCE ONLY

R/W

CONSTRUCTION C/L

FDR LIMITS

59+00 60+00 61+00 62+00 63+00 64+00 65+00

CENTERVILLE ROAD

FDR LIMITS

R/W

NO.	REV-DATE	BY:	DESCRIPTION

I HEREBY CERTIFY THAT THIS PLAN WAS PREPARED BY ME OR UNDER MY DIRECT SUPERVISION AND THAT I AM A DULY LICENSED PROFESSIONAL ENGINEER UNDER THE LAWS OF THE STATE OF MINNESOTA.  
 SIGNED: *Michael J. Fisher*  
 REG NO: 50791 DATE: 4-30-2014

CENTERVILLE ROAD  
 CO RD H2 TO COUNTY RD J

S.A.P. 062-659-016  
 County Proj. P-5002



Roadway Plan  
 Sheet No. 8 of 16 Sheets



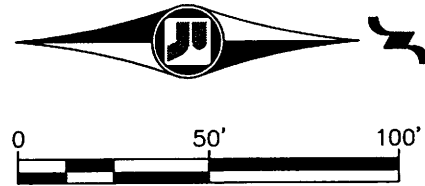

R/W  
 RIGHT OF WAY INFORMATION  
 FOR REFERENCE ONLY

CONSTRUCTION C/L

FDR LIMITS

66+00 67+00 68+00 69+00 70+00 71+00 72+00

CENTERVILLE ROAD

FDR LIMITS

5900

R/W

R/W

RIGHT OF WAY INFORMATION  
 FOR REFERENCE ONLY

FDR LIMITS

CONSTRUCTION C/L

79+00

78+00

BEGIN TAPER  
 78+35

1:5

77+00

76+00

75+00

74+00

73+00

72+00

CENTERVILLE ROAD

R/W

R/W  
 EXISTING BITUMINOUS EDGE

NO.	REV-DATE	BY:	DESCRIPTION

I HEREBY CERTIFY THAT THIS PLAN WAS PREPARED BY ME OR UNDER MY DIRECT SUPERVISION AND THAT I AM A DULY LICENSED PROFESSIONAL ENGINEER UNDER THE LAWS OF THE STATE OF MINNESOTA.  
 SIGNED: *Matthew J. ...*  
 REG NO: 50791 DATE: 4-30-2014

CENTERVILLE ROAD  
 CO RD H2 TO COUNTY RD J

S.A.P. 062-659-016  
 County Proj. P-5002



Roadway Plan  
 Sheet No. 9 of 16 Sheets

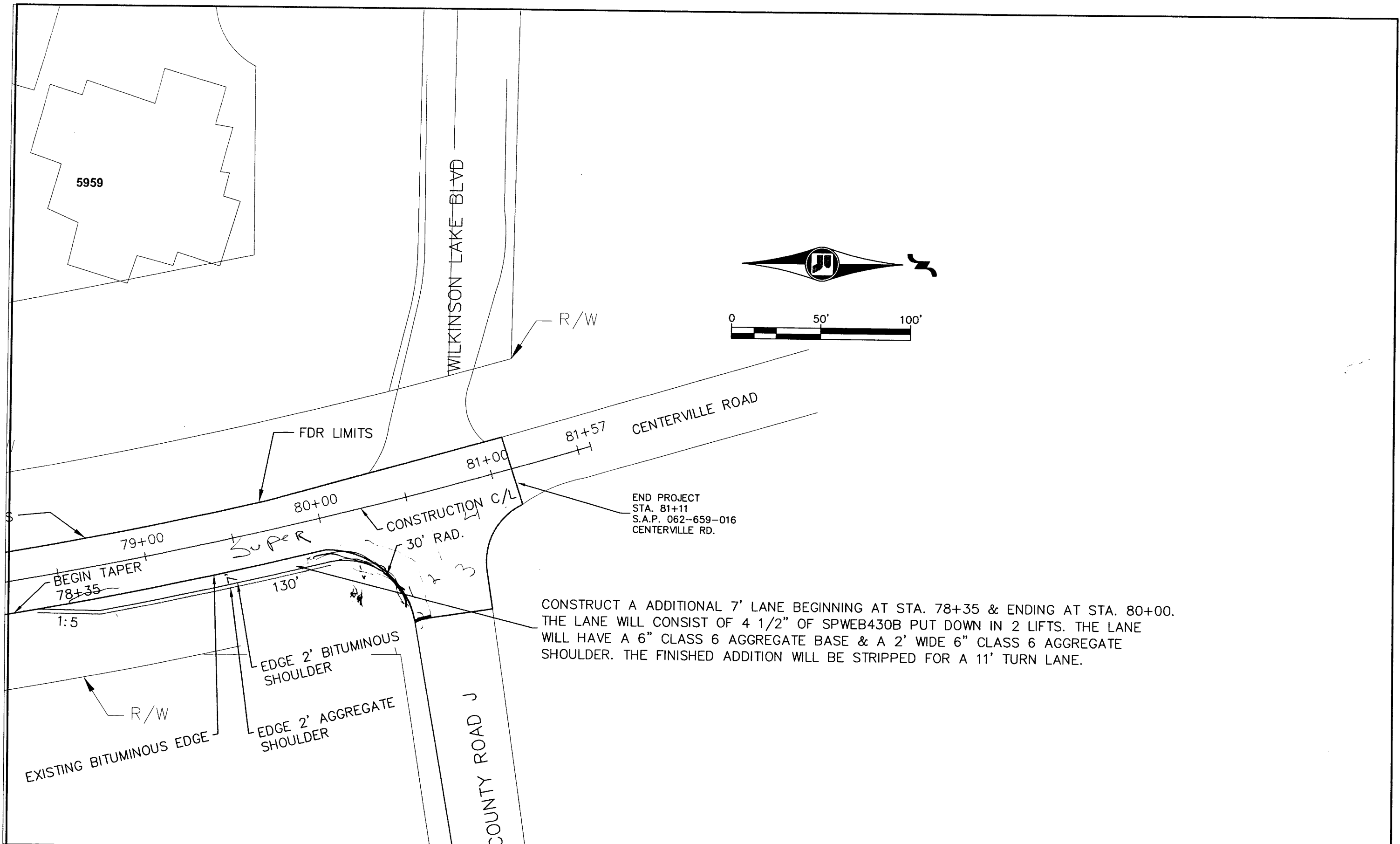

END PROJECT  
 STA. 81+11  
 S.A.P. 062-659-016  
 CENTERVILLE RD.

CONSTRUCT A ADDITIONAL 7' LANE BEGINNING AT STA. 78+35 & ENDING AT STA. 80+00. THE LANE WILL CONSIST OF 4 1/2" OF SPWEB430B PUT DOWN IN 2 LIFTS. THE LANE WILL HAVE A 6" CLASS 6 AGGREGATE BASE & A 2' WIDE 6" CLASS 6 AGGREGATE SHOULDER. THE FINISHED ADDITION WILL BE STRIPPED FOR A 11' TURN LANE.

NO.	REV-DATE	BY:	DESCRIPTION

I HEREBY CERTIFY THAT THIS PLAN WAS PREPARED BY ME OR UNDER MY DIRECT SUPERVISION AND THAT I AM A DULY LICENSED PROFESSIONAL ENGINEER UNDER THE LAWS OF THE STATE OF MINNESOTA.  
 SIGNED: *[Signature]*  
 REG NO: 50791 DATE: 5-16-2014

CENTERVILLE ROAD  
 CO RD H2 TO COUNTY RD J

S.A.P. 062-659-016  
 County Proj. P-5002



Roadway Plan  
 Sheet No. 10 of 16 Sheets

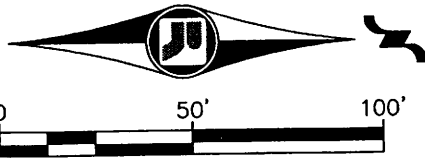

BEGIN PROJECT  
 STA 9+38.00  
 SAP 062-659-016  
 CENTERVILLE RD.

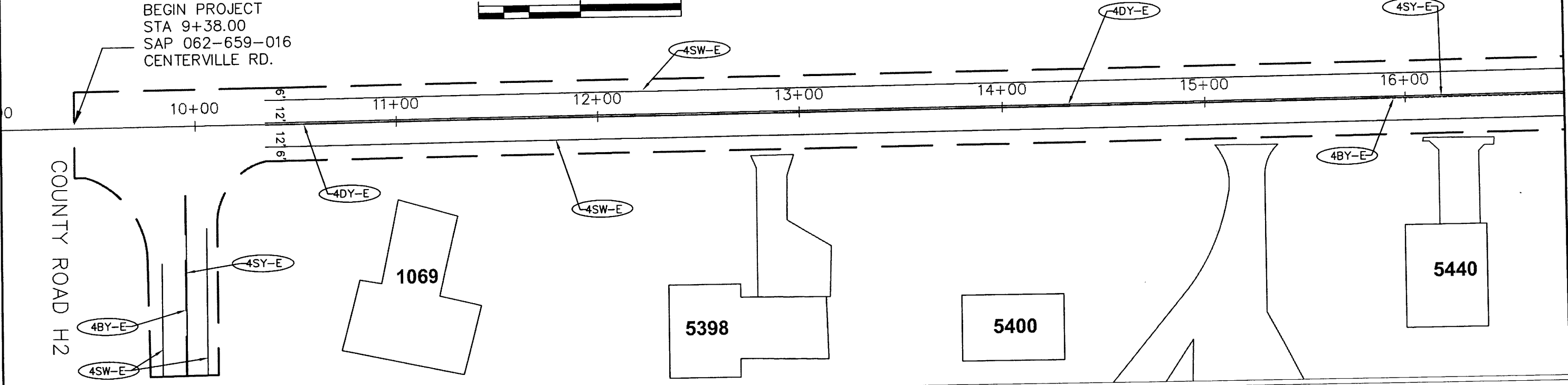

PAVEMENT MARKING LEGEND

- 4DY-E 4" DOUBLE SOLID LINE YELLOW-EPOXY
- 4SW-E 4" SOLID LINE WHITE-EPOXY
- 4SY-E 4" SOLID LINE YELLOW-EPOXY
- 4BY-E 4" BROKEN LINE YELLOW-EPOXY

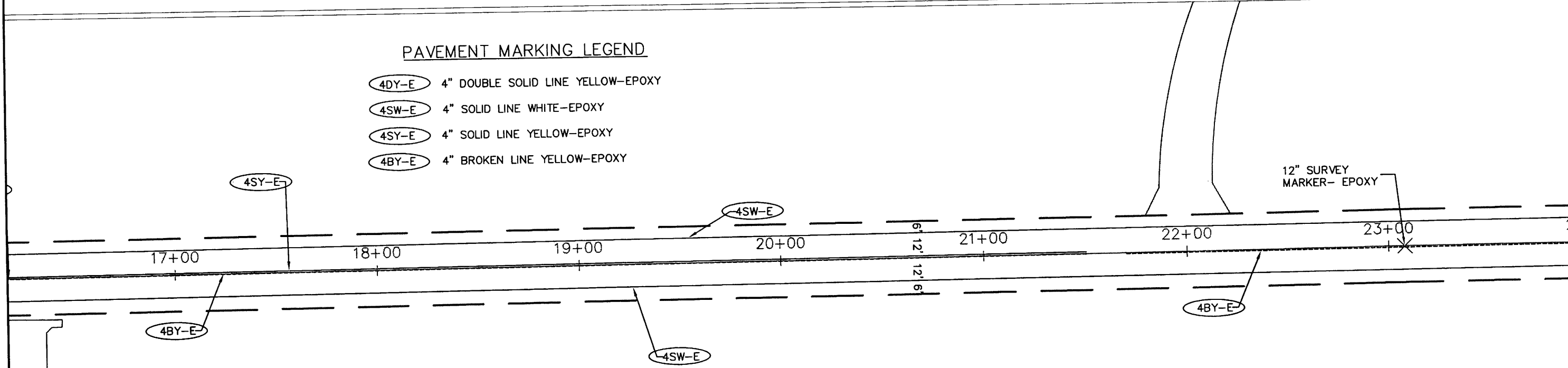

440

NO. REV-DATE BY: DESCRIPTION		I HEREBY CERTIFY THAT THIS PLAN WAS PREPARED BY ME OR UNDER MY DIRECT SUPERVISION AND THAT I AM A DULY LICENSED PROFESSIONAL ENGINEER UNDER THE LAWS OF THE STATE OF MINNESOTA. SIGNED: <i>[Signature]</i> REG NO: 50791 DATE: 5-16-2014	CENTERVILLE ROAD CO RD H2 TO COUNTY RD J	S.A.P. 062-659-016 County Proj. P-5002	 RAMSEY COUNTY	Pavement Marking Plan Sheet No. 11 of 16 Sheets



PAVEMENT MARKING LEGEND

- 4DY-E 4" DOUBLE SOLID LINE YELLOW-EPOXY
- 4SW-E 4" SOLID LINE WHITE-EPOXY
- 4SY-E 4" SOLID LINE YELLOW-EPOXY
- 4BY-E 4" BROKEN LINE YELLOW-EPOXY

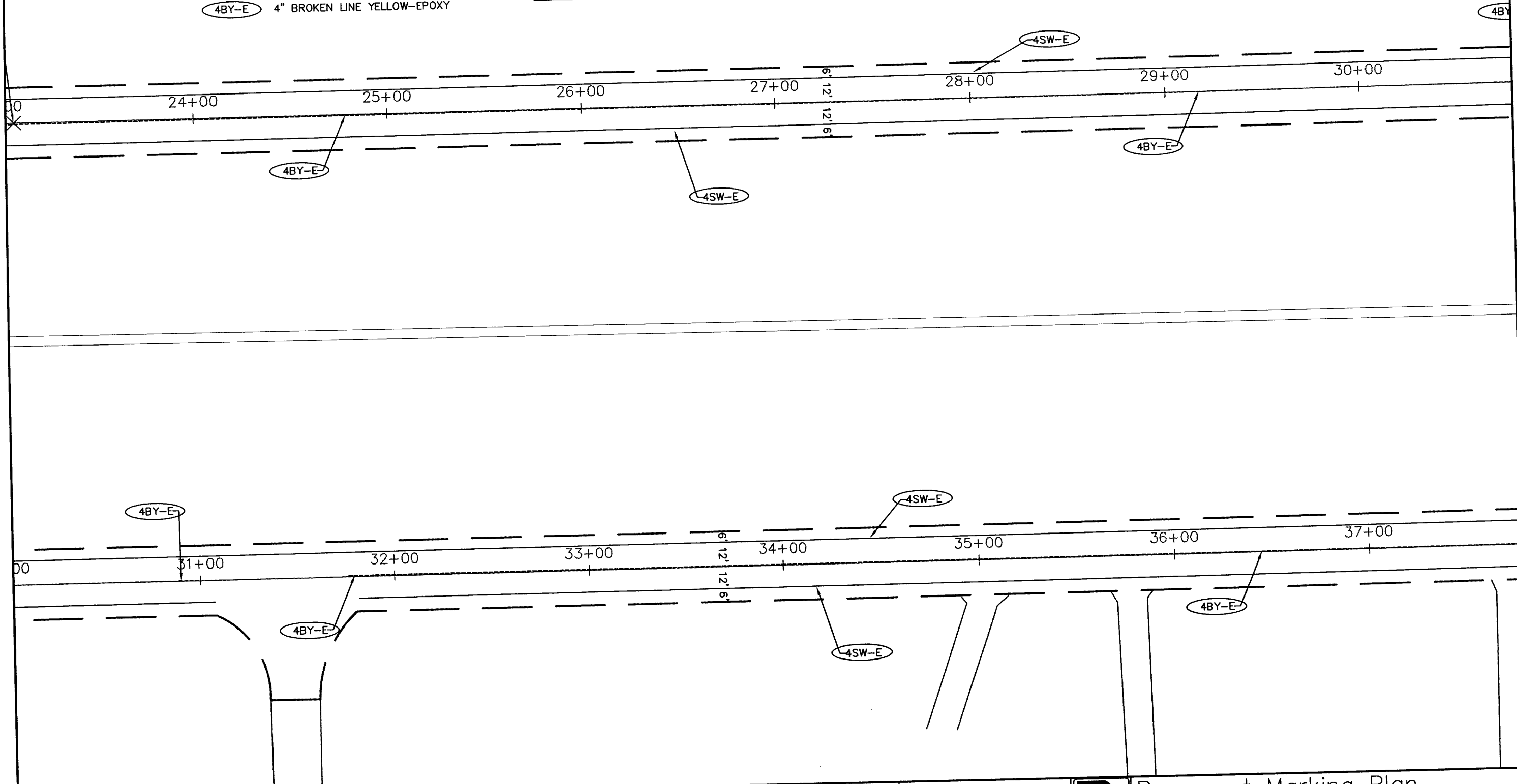
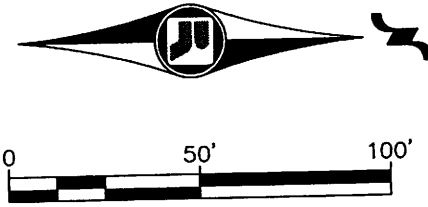

NO.	REV-DATE	BY:	DESCRIPTION
1	XX-XX-XX	XX	

I HEREBY CERTIFY THAT THIS PLAN WAS PREPARED BY ME OR UNDER MY DIRECT SUPERVISION AND THAT I AM A DULY LICENSED PROFESSIONAL ENGINEER UNDER THE LAWS OF THE STATE OF MINNESOTA.  
 SIGNED: *[Signature]*  
 REG NO: 20991 DATE: \_\_\_\_\_

CENTERVILLE ROAD  
 CO RD H2 TO COUNTY RD J

S.A.P. 062-659-016  
 \*County Proj. P-5002



Pavement Marking Plan  
 Sheet No. 12 of 16 Sheets

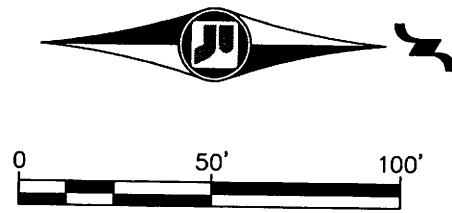

PAVEMENT MARKING LEGEND

- 4DY-E 4" DOUBLE SOLID LINE YELLOW-EPOXY
- 4SW-E 4" SOLID LINE WHITE-EPOXY
- 4SY-E 4" SOLID LINE YELLOW-EPOXY
- 4BY-E 4" BROKEN LINE YELLOW-EPOXY

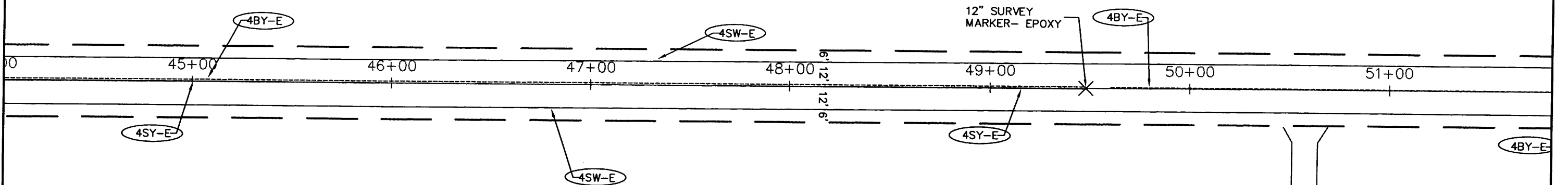
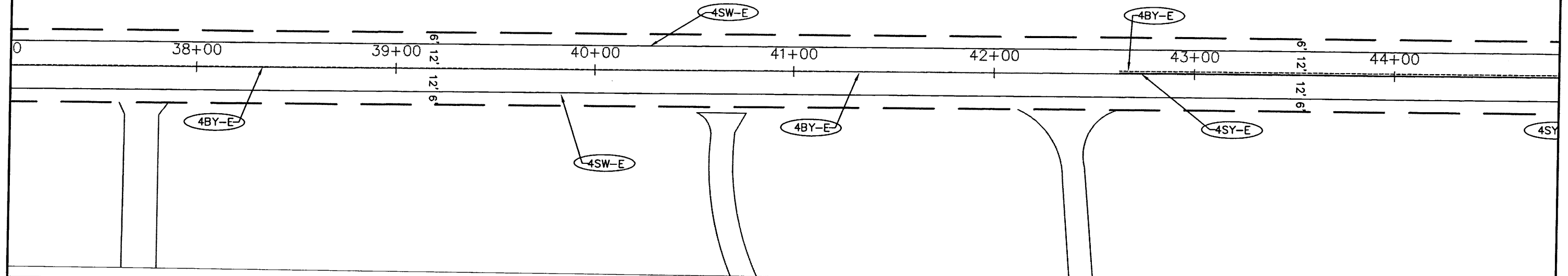

5776

NO.	REV-DATE	BY:	DESCRIPTION

I HEREBY CERTIFY THAT THIS PLAN WAS PREPARED BY ME OR UNDER MY DIRECT SUPERVISION AND THAT I AM A DULY LICENSED PROFESSIONAL ENGINEER UNDER THE LAWS OF THE STATE OF MINNESOTA.  
 SIGNED: *[Signature]*  
 REG NO: 50791 DATE: 4-30-2014

CENTERVILLE ROAD  
 CO RD H2 TO COUNTY RD J

S.A.P. 062-659-016  
 County Proj. P-5002



Pavement Marking Plan  
 Sheet No. 13 of 16 Sheets

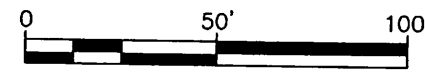

### PAVEMENT MARKING LEGEND

- 4DY-E 4" DOUBLE SOLID LINE YELLOW-EPOXY
- 4SW-E 4" SOLID LINE WHITE-EPOXY
- 4SY-E 4" SOLID LINE YELLOW-EPOXY
- 4BY-E 4" BROKEN LINE YELLOW-EPOXY

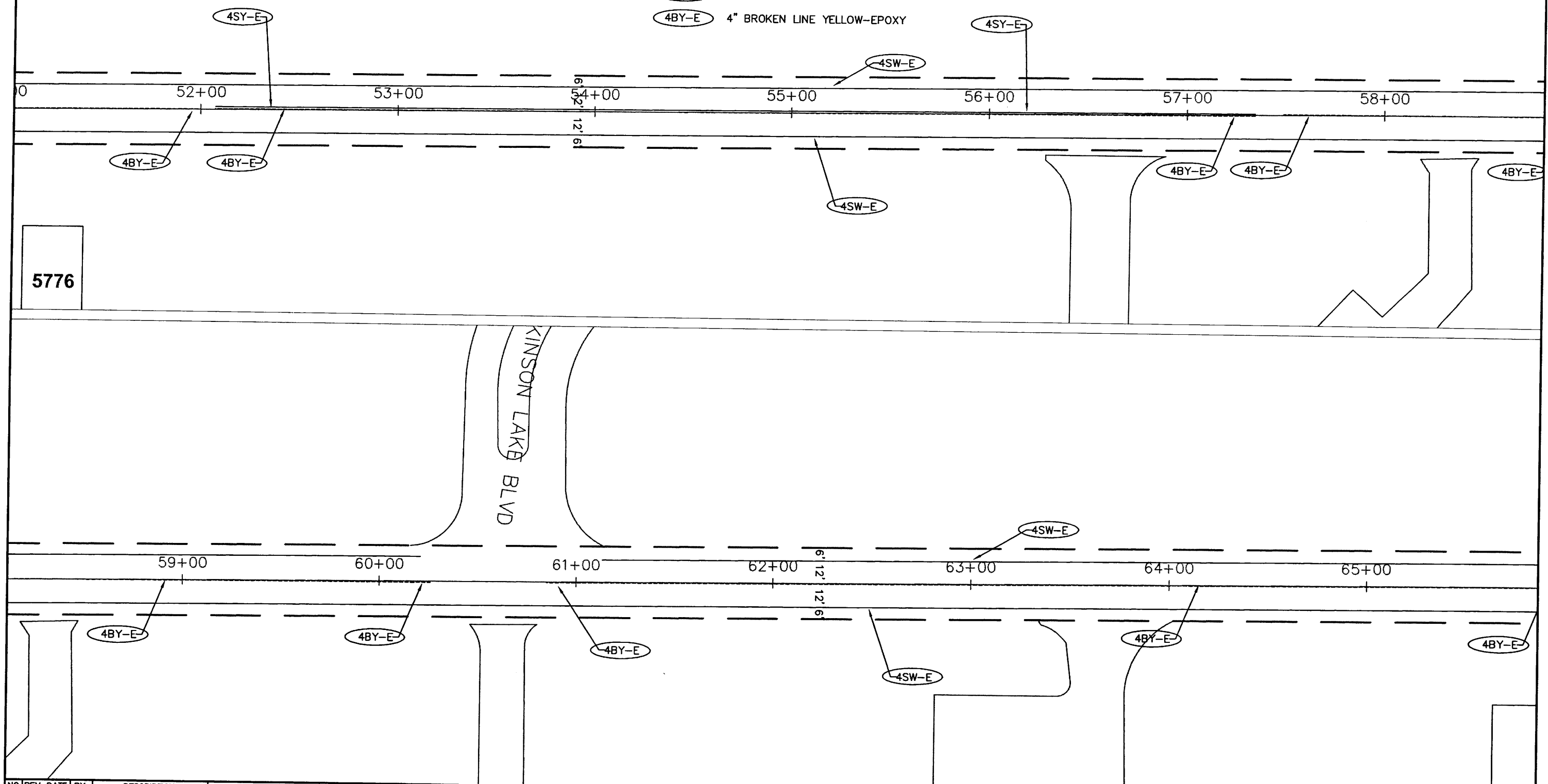

NO.	REV-DATE	BY:	DESCRIPTION

I HEREBY CERTIFY THAT THIS PLAN WAS PREPARED BY ME OR UNDER MY DIRECT SUPERVISION AND THAT I AM A DULY LICENSED PROFESSIONAL ENGINEER UNDER THE LAWS OF THE STATE OF MINNESOTA.  
 SIGNED: *Nicholas J. Schell*  
 REG NO: 50791 DATE: 4-30-2014

CENTERVILLE ROAD  
 CO RD H2 TO COUNTY RD J

S.A.P. 062-659-016  
 County Proj. P-5002

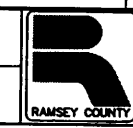

Pavement Marking Plan  
 Sheet No. 14 of 16 Sheets



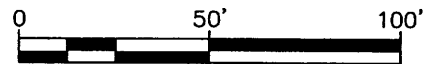

PAVEMENT MARKING LEGEND

- 4" DOUBLE SOLID LINE YELLOW-EPOXY
- 4" SOLID LINE WHITE-EPOXY
- 4" SOLID LINE YELLOW-EPOXY
- 4" BROKEN LINE YELLOW-EPOXY

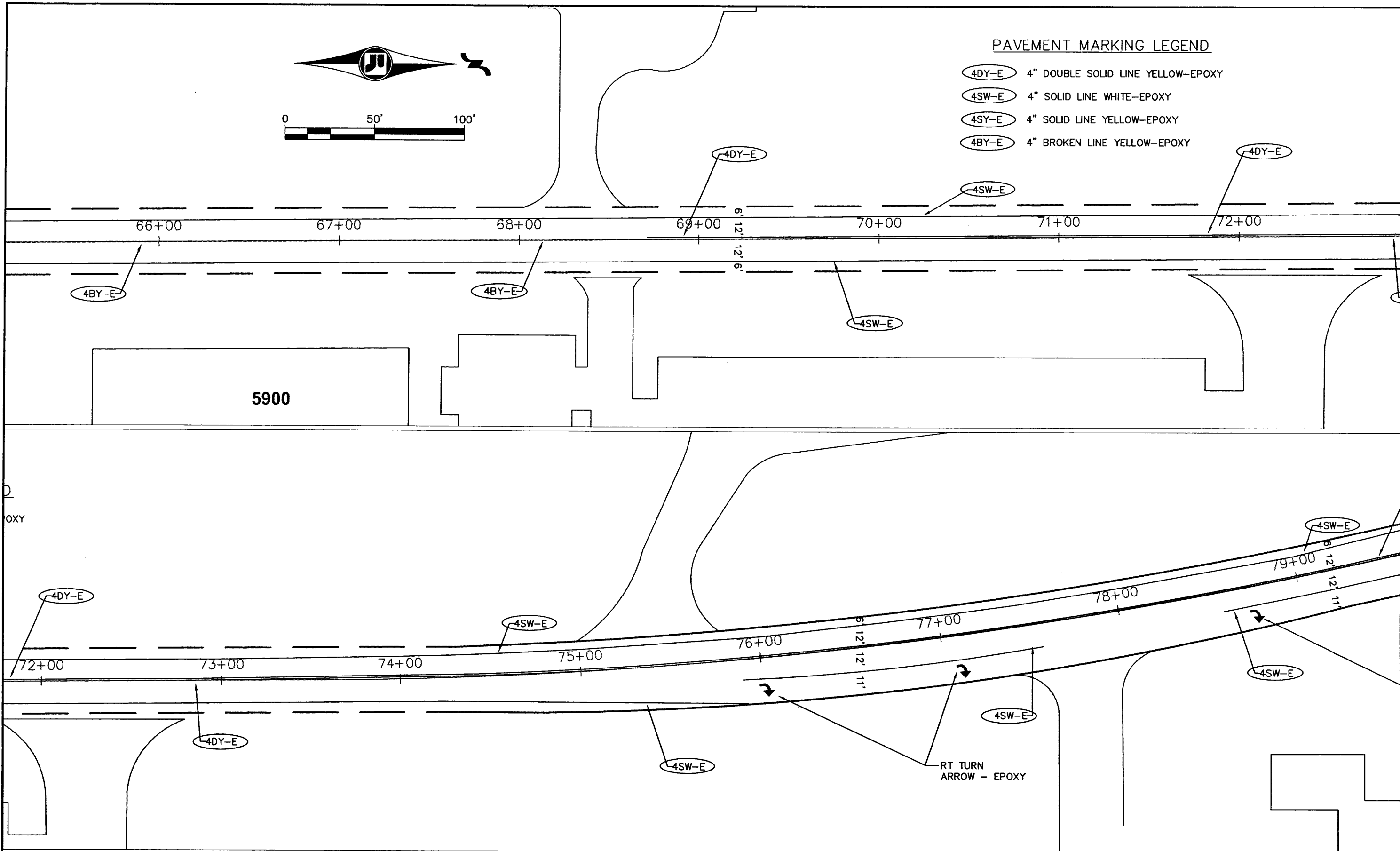

NO.	REV-DATE	BY:	DESCRIPTION

I HEREBY CERTIFY THAT THIS PLAN WAS PREPARED BY ME OR UNDER MY DIRECT SUPERVISION AND THAT I AM A DULY LICENSED PROFESSIONAL ENGINEER UNDER THE LAWS OF THE STATE OF MINNESOTA.  
 SIGNED: *William Fisher*  
 REG NO: 50791 DATE: 4-30-2014

CENTERVILLE ROAD  
 CO RD H2 TO COUNTY RD J

S.A.P. 062-659-016  
 County Proj. P-5002



Pavement Marking Plan  
 Sheet No. 15 of 16 Sheets

PAVEMENT MARKING LEGEND

- 4DY-E 4" DOUBLE SOLID LINE YELLOW-EPOXY
- 4SW-E 4" SOLID LINE WHITE-EPOXY
- 4SY-E 4" SOLID LINE YELLOW-EPOXY
- 4BY-E 4" BROKEN LINE YELLOW-EPOXY

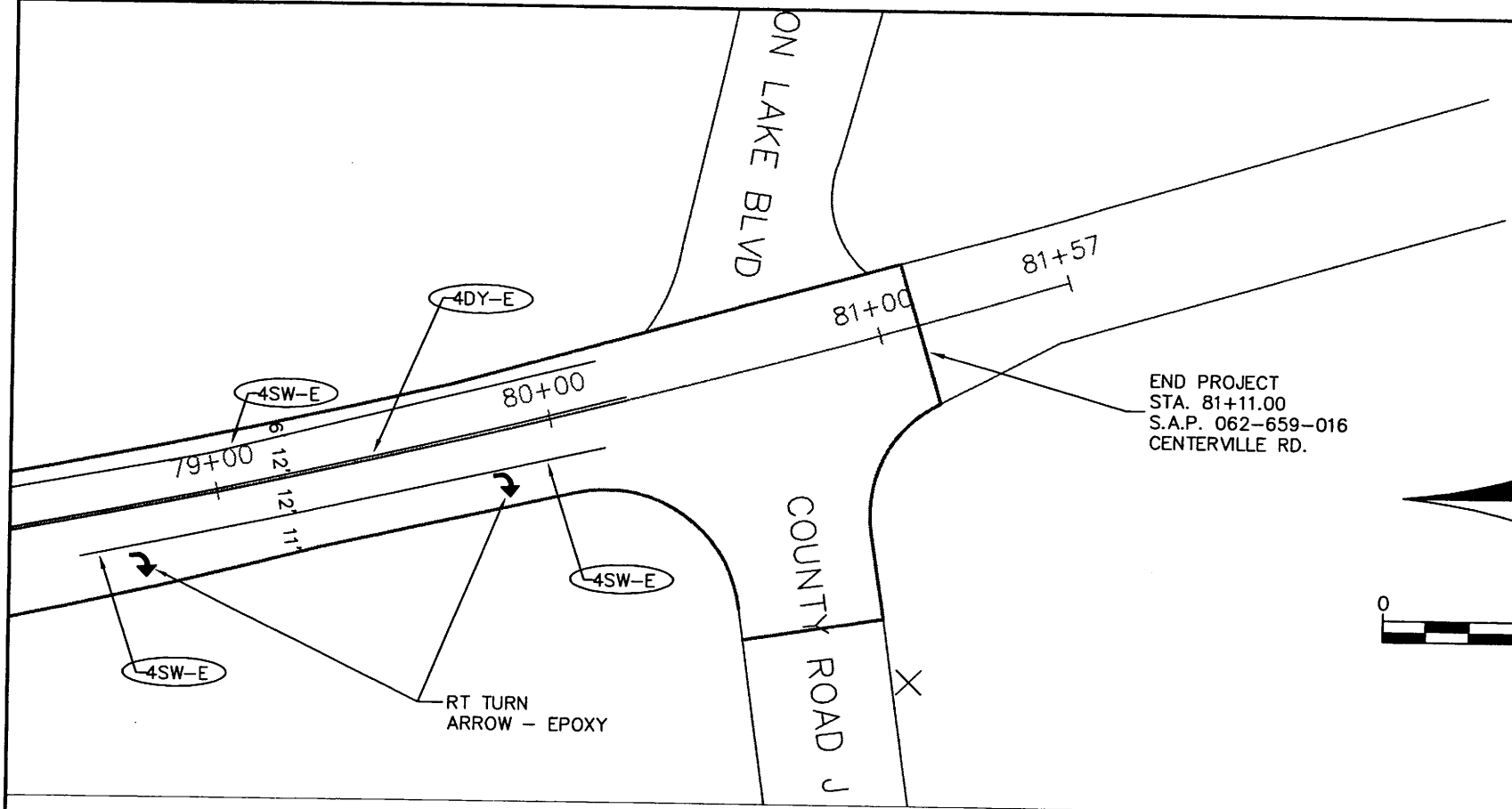

END PROJECT  
 STA. 81+11.00  
 S.A.P. 062-659-016  
 CENTERVILLE RD.

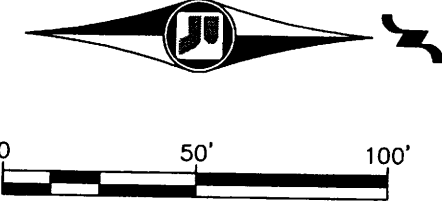

NO.	REV-DATE	BY:	DESCRIPTION

I HEREBY CERTIFY THAT THIS PLAN WAS PREPARED BY ME OR UNDER MY DIRECT SUPERVISION AND THAT I AM A DULY LICENSED PROFESSIONAL ENGINEER UNDER THE LAWS OF THE STATE OF MINNESOTA.  
 SIGNED: *Michelle F...*  
 REG NO: 50791 DATE: 5-16-2014

CENTERVILLE ROAD  
 CO RD H2 TO COUNTY RD J

S.A.P. 062-659-016  
 County Proj. P-5002



Pavement Marking Plan  
 Sheet No. 16 of 16 Sheets