

PLAN SYMBOLS

STATE LINE	=====
COUNTY LINE	=====
TOWNSHIP OR RANGE LINE	=====
SECTION LINE	=====
QUARTER LINE	=====
SIXTEENTH LINE	=====
EXISTING RIGHT OF WAY LINE	=====
PROPOSED RIGHT OF WAY LINE	=====
CORPORATE OR CITY LIMITS	=====
RAILROAD	=====
RAILROAD RIGHT-OF-WAY	=====
RAILROAD CROSSING SIGN	=====
CROSSING GATE	=====
MEANDER CORNER	=====
SLOPE EASEMENT (CONST. LIMITS)	=====
MARSH	=====
DECIDUOUS TREE	=====
CONIFEROUS TREE	=====
BUSH OR SHRUB	=====
WOODS	=====
CATCH BASIN	=====
BRIDGE	=====
IRON PIPE OR ROD	=====
MONUMENT (STONE, CONCRETE OR METAL)	=====
WOODEN HUB	=====

UTILITY SYMBOLS

UTILITY POLE	=====
GUY OR ANCHOR	=====
STREET LIGHT	=====
TELEPHONE PEDESTAL	=====
GAS MAIN	=====
WATER MAIN	=====
TELEPHONE VAULT	=====
ELECTRIC VAULT	=====
TELEPHONE CABLE	=====
ELECTRIC CABLE	=====
STORM SEWER	=====
SAUNTRY SEWER	=====
GATE VALVE	=====
CONTROLLED GABINET	=====
EXISTING HYDRANT	=====
CABLE TELEVISION-BURIED	=====
FIBER OPTIC CABLE	=====
TRAFFIC SIGNAL LINE	=====
TRAFFIC SIGNAL HAND HOLE	=====

FOR PLANS AND UTILITIES SYMBOLS SEE MN/DOT TECHNICAL MANUAL.

-GOVERNING SPECIFICATIONS-

THE 2005 EDITION OF THE MINNESOTA DEPARTMENT OF TRANSPORTATION "STANDARD SPECIFICATIONS FOR CONSTRUCTION" SHALL GOVERN.

ALL TRAFFIC CONTROL DEVICES AND SIGNING SHALL CONFORM TO THE MUTCD, INCLUDING FIELD MANUAL FOR TEMPORARY TRAFFIC CONTROL ZONE LAYOUTS, SEE HTTP://WWW.DOT.STATE.MN.US/TRAFFICENG/

ALL APPLICABLE FEDERAL, STATE AND LOCAL LAWS AND ORDINANCES WILL BE COMPLIED WITH IN THE CONSTRUCTION OF THIS PROJECT.



SCALES IN FEET

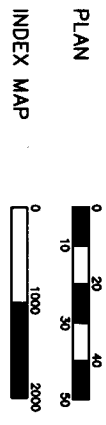

PLAN	0 10 20 30 40 50
INDEX MAP	0 1000 2000
GROSS LENGTH	2833.11 FEET
BRIDGE LENGTH	0.536 MILES
EXCEPTIONS	---
NET LENGTH	2833.11 FEET
	0.536 MILES

**BEGIN S.A.P. 062-648-018
FAIRVIEW AVENUE
STA. 0+15.53**

**END S.A.P. 062-648-018
FAIRVIEW AVENUE
STA. 28+48.64**

THIS PLAN CONTAINS 7 SHEETS

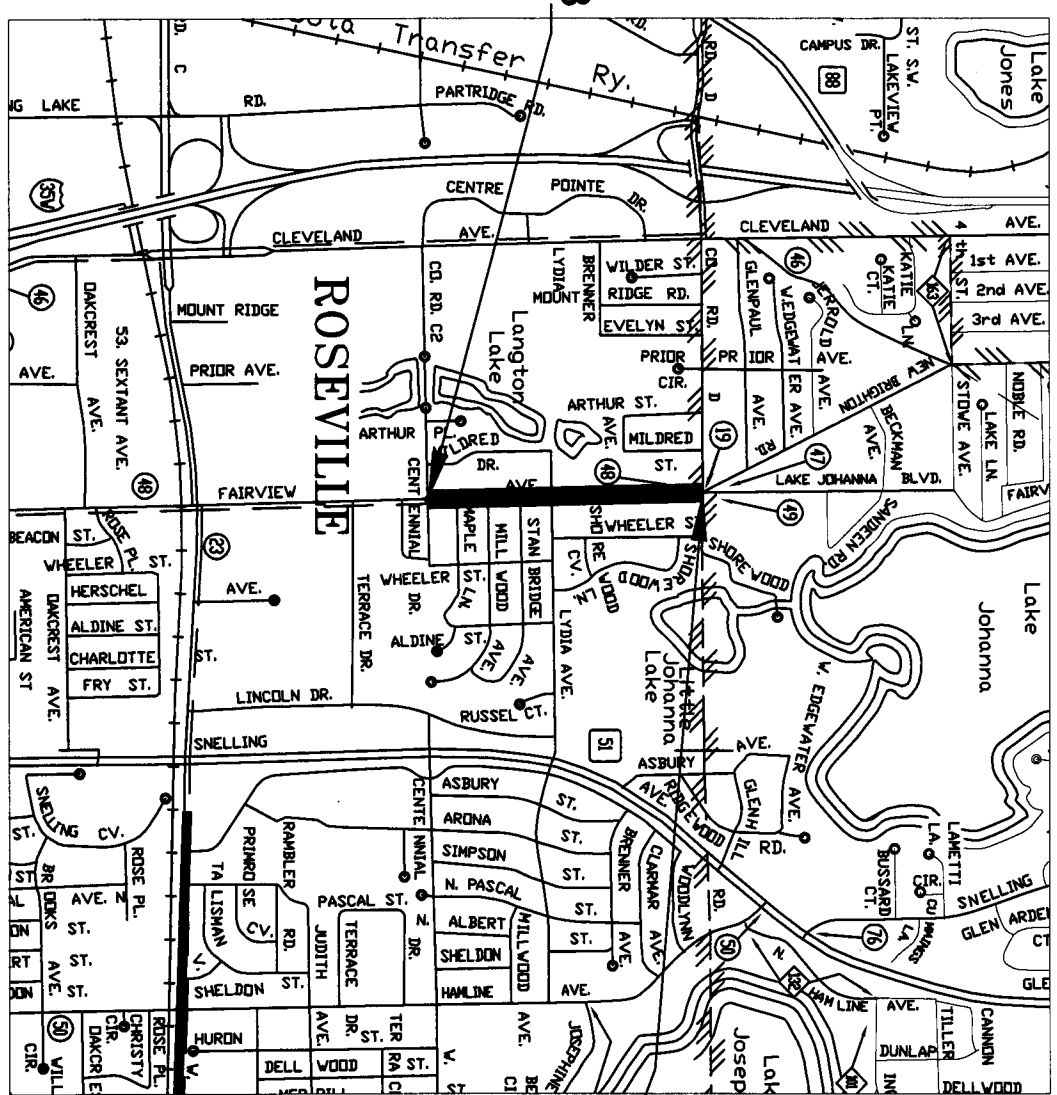

DESIGN DESIGNATION

County Road C2 to	7600
County Road D	9120
	A MINOR RELIEVER
	2
	0
	PARKING LANES

BASED ON STOPPING DISTANCE
HEIGHT OF EYE: 3.50 FEET
HEIGHT OF OBJECT: 2.00 FEET

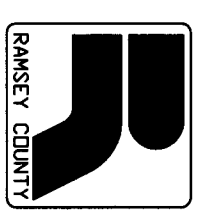

RAMSEY COUNTY
DEPARTMENT OF PUBLIC WORKS
PLAN FOR THE MILL AND BITUMINOUS OVERLAY OF
FAIRVIEW AVENUE
S.A.P. No. 062-648-018

BETWEEN: County Road C2 and County Road D

INDEX	
SHEET NO.	DESCRIPTION
1	TITLE SHEET
2	ESTIMATED QUANTITIES
3	TYPICAL SECTIONS
4-5	PLAN SHEETS
6-7	STRIPING PLAN

I HEREBY CERTIFY THAT THIS PLAN WAS PREPARED BY ME OR UNDER MY DIRECT SUPERVISION AND THAT I AM A DULY LICENSED PROFESSIONAL ENGINEER UNDER THE LAWS OF THE STATE OF MINNESOTA.

GERALD AUGER, REG. NO. 26511, DATE 5/3/2013

RECOMMENDED FOR APPROVAL: [Signature], RAMSEY COUNTY ENGINEER, DATE 5/3/13

APPROVED: [Signature], CITY OF ROSEVILLE, DATE 5/15/13

DRAWN BY: R. GAETZ, DATE 2-11-2013	
ORDERED BY: L. LORTIE, DATE 4-29-2013	
PLANNING	
DATE	SHEET NO. & DESCRIPTION

MINNESOTA DEPARTMENT OF TRANSPORTATION

APPROVED: [Signature], DATE 5/29/13

APPROVED: [Signature], DATE 5/29/13

APPROVED FOR STATE AND FUNDING STATE AND ENGINEER: [Signature], DATE 5/29/13

ESTIMATED QUANTITIES

Item Number	Item	Notes	Unit	Estimated Quantity 100% S.A.P. 62-648-018
2021.501	Mobilization		L.S.	1
2232.501	Mill Bituminous Surface (2")		S.Y.	14,631
2357.502	Bituminous Material for Tack Coat	1	Gal.	732
2360.501	Type SPWEB340E (2") Wearing Course Mixture	2	Ton	1,610
2360.505	Bituminous Mixture for Patching	3	Ton	100
2563.601	Traffic Control		L.S.	1
2573.530	Storm Drain Inlet Protection		Each	4
2582.502	4" Solid Line White - Epoxy		L.F.	5,050
2582.502	4" Solid Line Yellow - Epoxy		L.F.	1,800
2582.502	24" Solid Line Yellow - Epoxy		L.F.	24
2582.502	4" Broken Line Yellow - Epoxy		L.F.	650

QUANTITY NOTES

1. Tack coat is estimated at 0.05 gallons / square yard bituminous / lift
2. Bituminous is estimated at 110 lbs / square yard / inch of bituminous
3. Bituminous patching mix is SPWE340B

NO. REV-DATE	BY:	DESCRIPTION
I HEREBY CERTIFY THAT THIS PLAN WAS PREPARED BY ME OR UNDER MY DIRECT SUPERVISION AND THAT I AM A DULY LICENSED PROFESSIONAL ENGINEER UNDER THE LAWS OF THE STATE OF MINNESOTA.		
SIGNED:		
REG. NO.:	2651	
DATE:	5/3/2013	

FAIRVIEW AVENUE
COUNTY ROAD C2 TO COUNTY ROAD D

S.A.P. 062-648-018
COUNTY PROJ. P-3330



TYPICAL SECTION - FAIRVIEW AVENUE

STA. 0+15.53 TO STA. 28+50

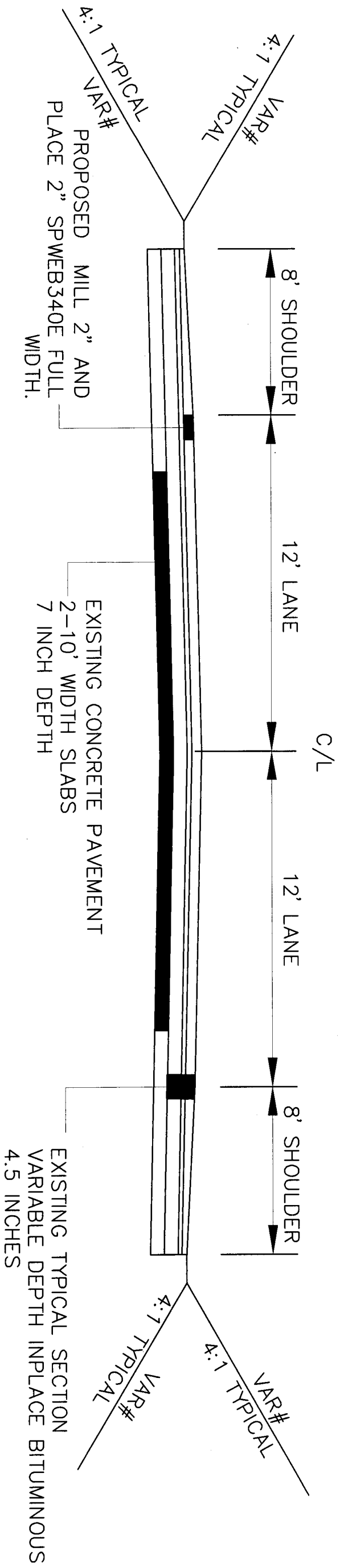

NO.	REV.	DATE	BY:	DESCRIPTION

I HEREBY CERTIFY THAT THIS PLAN WAS PREPARED BY ME OR UNDER MY DIRECT SUPERVISION AND THAT I AM A DULY LICENSED PROFESSIONAL ENGINEER UNDER THE LAWS OF THE STATE OF MINNESOTA.

SIGNED: *[Signature]* REG. NO.: 26571 DATE: 5/3/2013

FAIRVIEW AVENUE
COUNTY ROAD C2 TO COUNTY ROAD D

S.A.P. 062-648-018
COUNTY PROJ. P-3330



TYPICAL SECTIONS
SHEET 3 OF 7 SHEETS

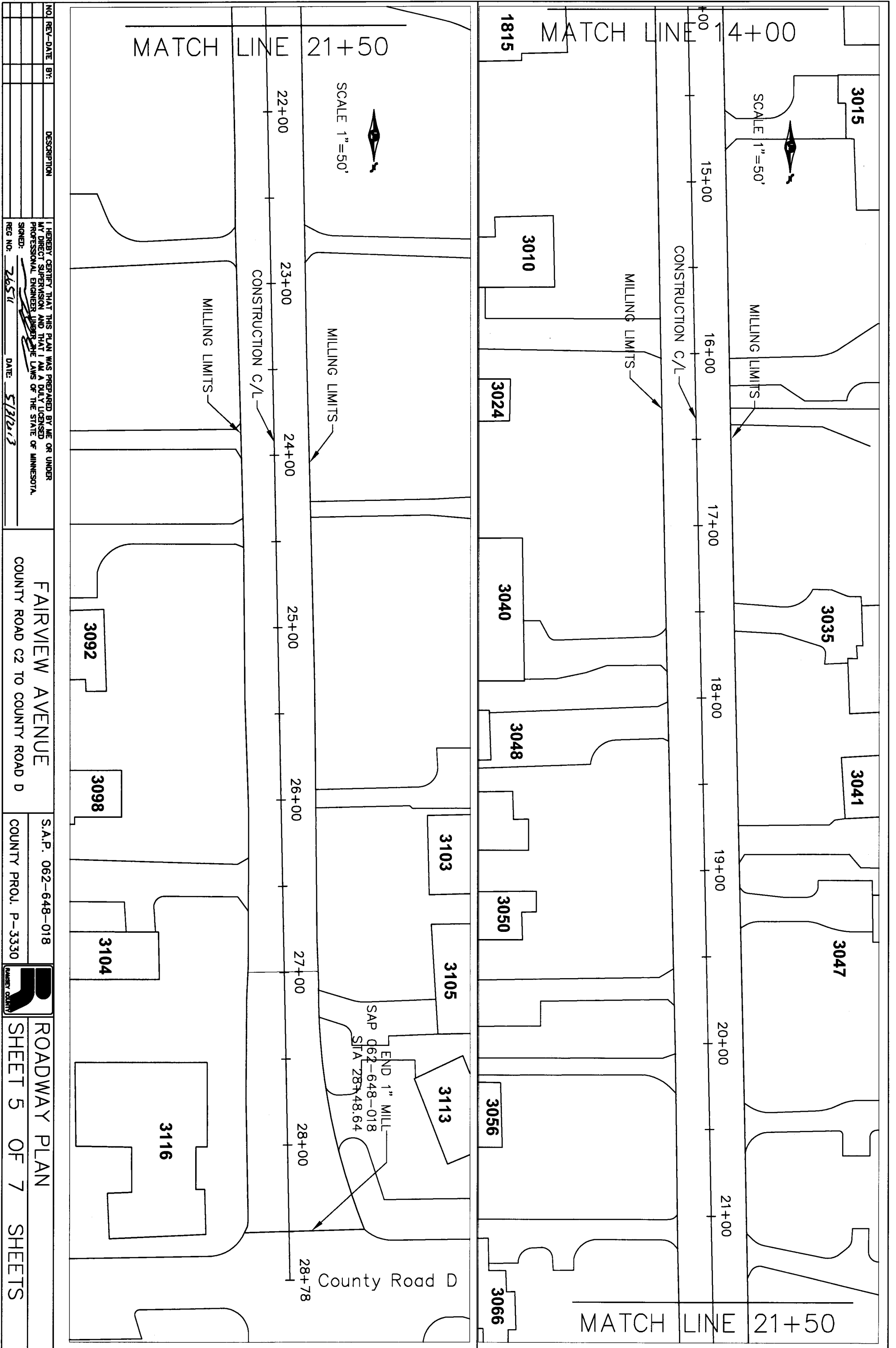

NO.	REV.	DATE	BY:	DESCRIPTION

I HEREBY CERTIFY THAT THIS PLAN WAS PREPARED BY ME OR UNDER MY DIRECT SUPERVISION AND THAT I AM A DULY LICENSED PROFESSIONAL ENGINEER UNDER THE LAWS OF THE STATE OF MINNESOTA.
 SIGNED: *[Signature]* REG. NO. 26511 DATE: 5/3/2013

FAIRVIEW AVENUE
 COUNTY ROAD C2 TO COUNTY ROAD D

S.A.P. 062-648-018
 COUNTY PROJ. P-3330



ROADWAY PLAN
 SHEET 5 OF 7 SHEETS

NO.	REV.	DATE	BY:	DESCRIPTION

I HEREBY CERTIFY THAT THIS PLAN WAS PREPARED BY ME OR UNDER MY DIRECT SUPERVISION AND THAT I AM A DULY LICENSED PROFESSIONAL ENGINEER UNDER THE LAWS OF THE STATE OF MINNESOTA.
 SIGNED:  DATE: 5/3/2013
 REG. NO.: 26511

FAIRVIEW AVENUE
 COUNTY ROAD C2 TO COUNTY ROAD D
 S.A.P. 062-648-018
 COUNTY PROJ. P-3330

 PAVEMENT MARKING PLAN
 SHEET 6 OF 7 SHEETS

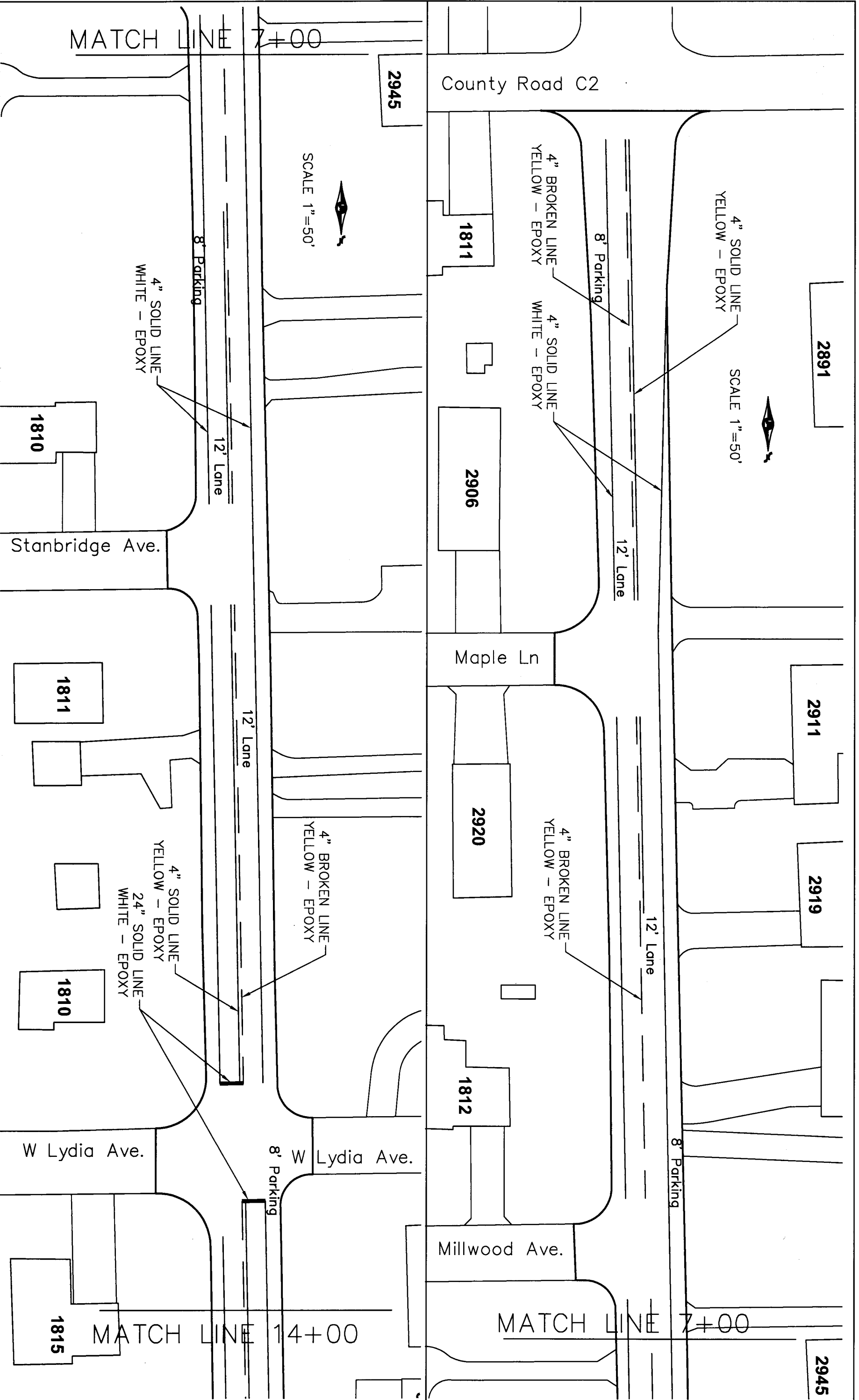

MATCH LINE 7+00

2891

4" SOLID LINE
YELLOW - EPOXY
SCALE 1"=50'

County Road C2

1811

4" BROKEN LINE
YELLOW - EPOXY
4" SOLID LINE
WHITE - EPOXY

8' Parking

2906

12' Lane

Stanbridge Ave.

1810

4" SOLID LINE
WHITE - EPOXY

8' Parking

12' Lane

SCALE 1"=50'

Maple Ln

2911

2919

2920

4" BROKEN LINE
YELLOW - EPOXY

12' Lane

1811

4" BROKEN LINE
YELLOW - EPOXY

12' Lane

4" SOLID LINE
YELLOW - EPOXY
24" SOLID LINE
WHITE - EPOXY

1810

W Lydia Ave.

1812

8' Parking

W Lydia Ave.

Millwood Ave.

2945

MATCH LINE 7+00

MATCH LINE 14+00

1815

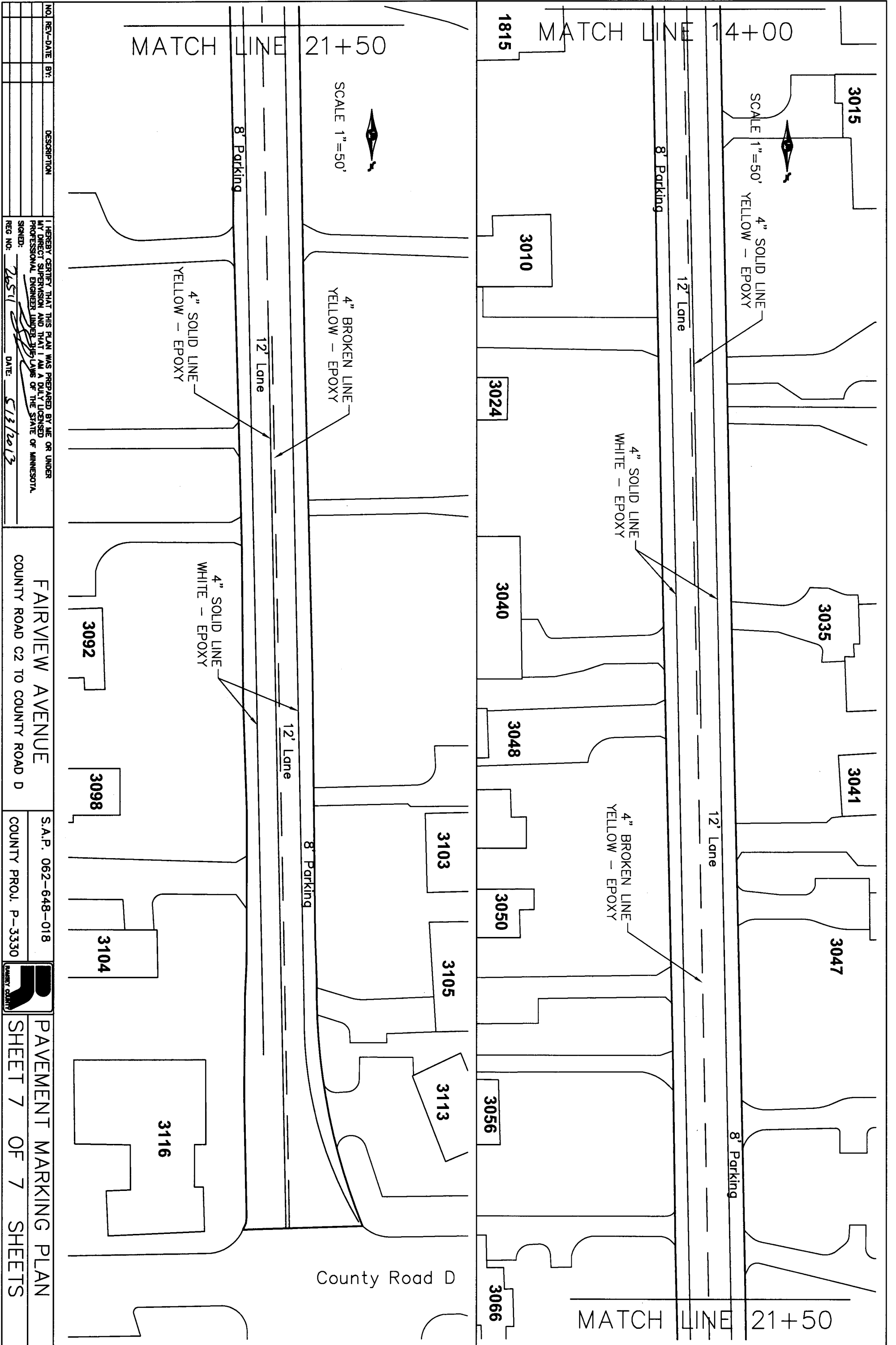

NO.	REV.	DATE	BY:	DESCRIPTION

I HEREBY CERTIFY THAT THIS PLAN WAS PREPARED BY ME OR UNDER MY DIRECT SUPERVISION AND THAT I AM A DULY LICENSED PROFESSIONAL ENGINEER UNDER THE LAWS OF THE STATE OF MINNESOTA.
 SIGNED: *[Signature]* DATE: 5/13/2013
 REG. NO.: 26511

FAIRVIEW AVENUE
 COUNTY ROAD C2 TO COUNTY ROAD D

S.A.P. 062-648-018
 COUNTY PROJ. P-3330

PAVEMENT MARKING PLAN
 SHEET 7 OF 7 SHEETS