

NORTH OAKS CHANNEL CROSSING

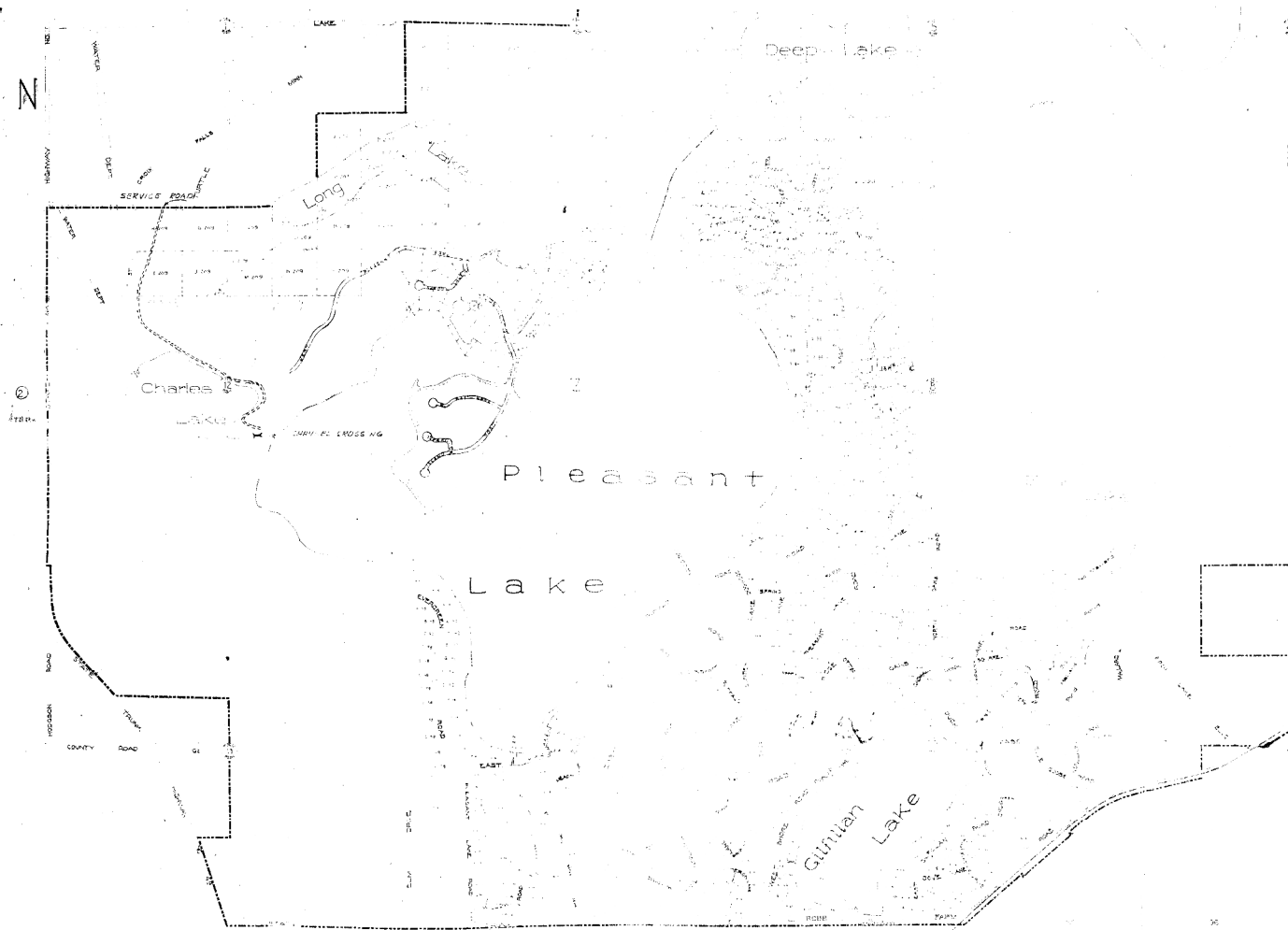

MILNER W. CARLEY & ASSOCIATES CONSULTING ENGINEERS	
500 W HWY 96 ST. PAUL, MN	
SURVEY BY _____ DESIGNED BY _____ DRAWN BY _____ APPROVED BY _____ SHEET OF SHEETS _____ Date _____	I hereby certify that this plan, specification, or report was prepared by me or under my direct supervision and that I am a duly registered Professional Engineer under the laws of the State of Minnesota. REVISIONS _____ COMM. NO. _____ Reg. No. _____

C h a r l e s
L a k e

P i e a s a n t
L a k e

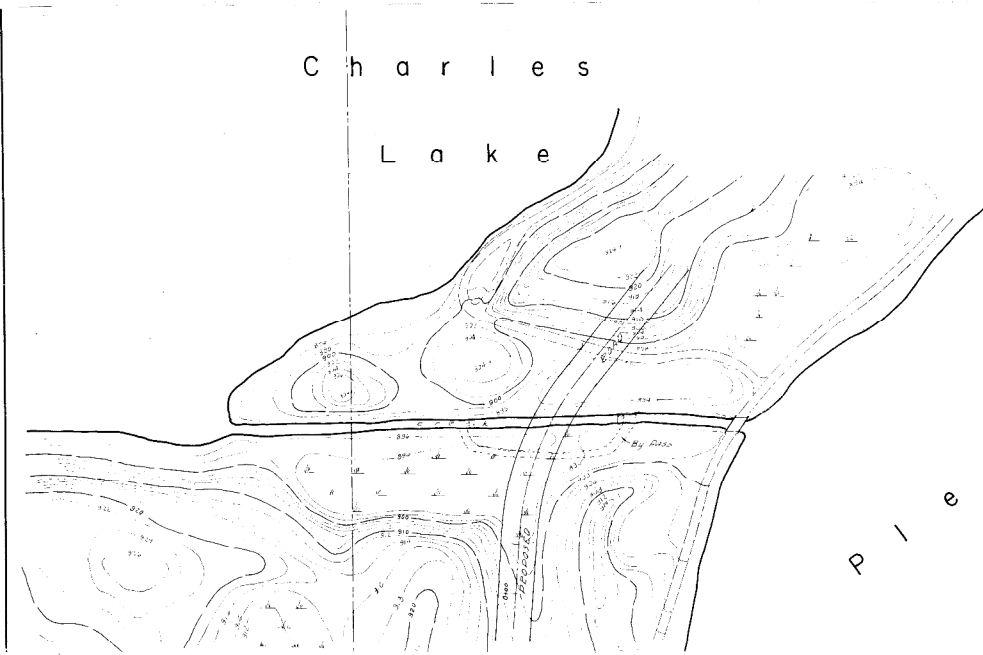

PROFILE MARKED
NOTE: SHOWN MARKS CHECKED
N.B. - DIMENSIONS SHOWN ON THIS
DRAWING ARE IN FEET

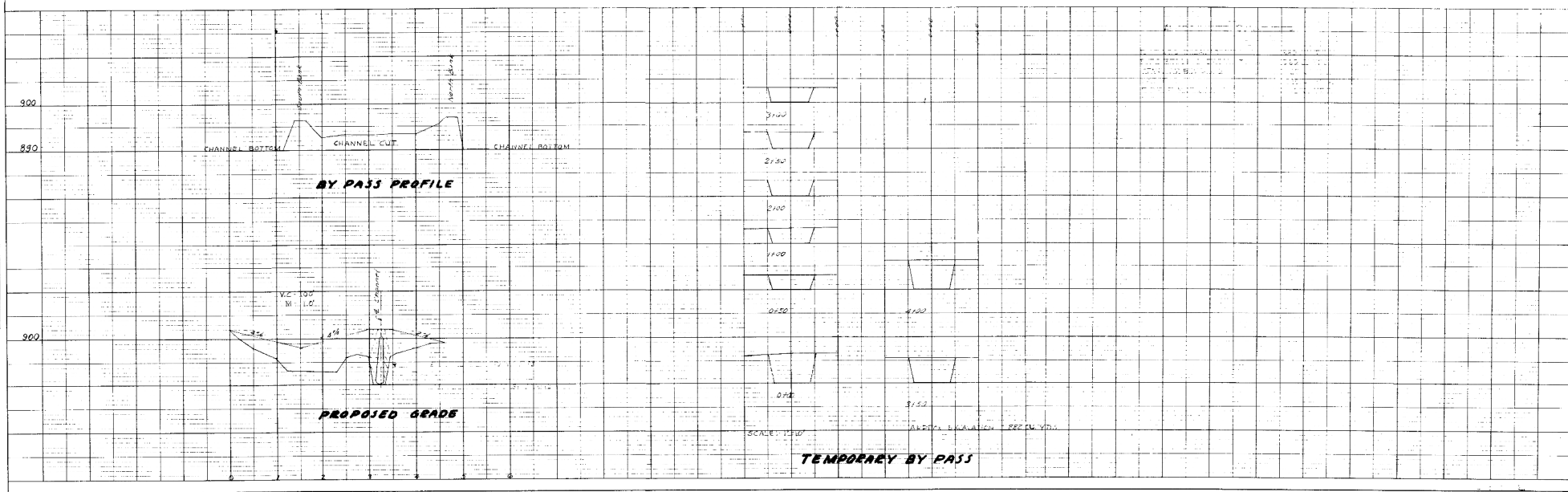
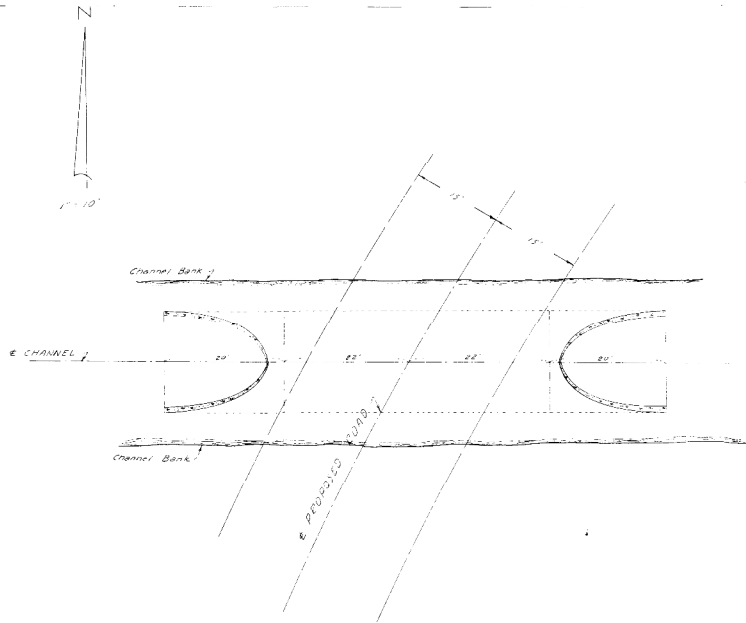
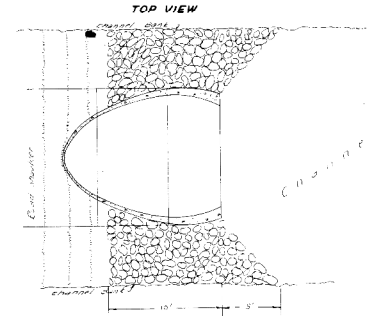

PLATE 1 PLAN-PROFILE C.I.P.A. & M.E. STANDARD
100% APPROVED FOR CONSTRUCTION AND PRINTED IN U.S.A.
EUGENE DIEBOLD CO.

L-5724



PLAN



GRouted RIP RAP DETAIL

Note: For apron dimensions see Standard Plate No. 314 C in specifications.

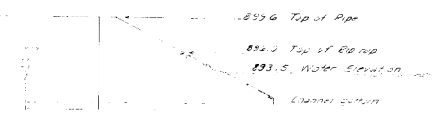

SIDE VIEW

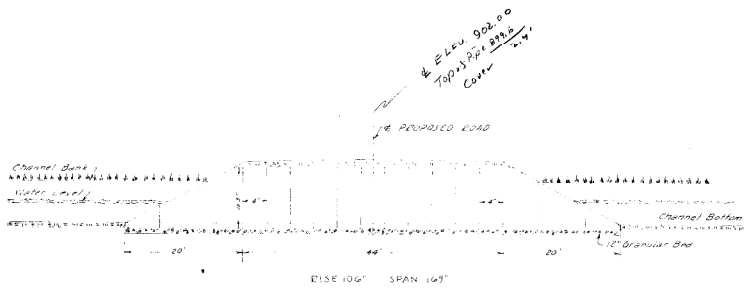

CROSS SECTION

Note: For pipe dimensions see Standard Plate No. 3014 E in specifications.

CONCRETE ARCH PIPE

MILNER W. CARLEY & ASSOCIATES
CONSULTING CIVIL ENGINEERS LAND SURVEYORS

500 W. WABY, 96 THEATRE BLDG. 214 6th St. 14 4th AVE. S.E.
ST. PAUL 12, MINN. MINNETONKA, MINN. SAUK CENTRE, MINN. ST. CLOUD, MINN.
488-3300 282-2900 267-2664 281-1751

SURVY BY	I hereby certify that this plan, specification, or report was prepared by me or under my direct supervision and that I am a duly registered Professional Engineer under the laws of the State of Minnesota.	REVISIONS
DESIGNED BY		
DRAWN BY		
APPROVED BY		
SHEET OF SHEETS	Date 5/11/57 Reg. No. 34227	5724 CONM. NO. 69-113