

5 ③ 10183.0530
5058.35

B-④ 10181.249
5355.35

14-⑤ 10043.2489
5355.21

7 ⑥ 10013.2489
5355.18

6 ⑦ 10095.0530
5058.22

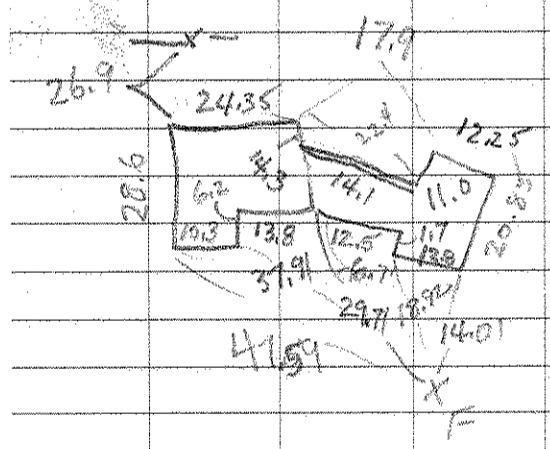

71	286°44'	93	8.0	B
72	269°54'	69	7.5	B
73	263°38'	59	6.5	
74	218°24'	45	7.6	
75	155°58'	81	7.1	Fence
76	173°15'	77	7.7	B
77	174°16'	107	7.2	IP 976.67
78	195°36'	101	5.9	
79	196°15'	71	7.1	
80	224°53'	83	5.8	
81	236°01'	68	7.1	477.77
82	253°21'	109	6.1	IP (E)
83	260°43'	123	6.5	
84	262°32'	130	5.4	N Fence
85	251°16'	158	5.2	"
86	236°20'	140	4.6	
87	234°39'	192	3.9	IP
88	225°57'	183	"	
89	221°48'	193	3.1	SW Fence
90	212°15'	191	3.5	
91	213°49'	180	3.9	79.97
92	215°32'	145	4.5	
93	196°40'	137	6.1	