

JOHN B. LITTLE
ENGINEER AND SURVEYOR
ROOM 418 GLOBE BLDG.
COR. FOURTH AND G ST.

Surveyed	2079.09
Subdivided	1399
Street Corders	2267.51
Made	261.81
Printing	87.27
Stationery	290.91
Total	4069.69

TELEPHONES
Office, Main 1234
Office, Main 1234
Residence, Main 1234
Office, 1234
Office, 1234

1317.40
1313.68
2631.08
1315.02

2638.25
2637.85
1318.93

1319.25
1318.18
2637.43
1318.74
3744

2637.85

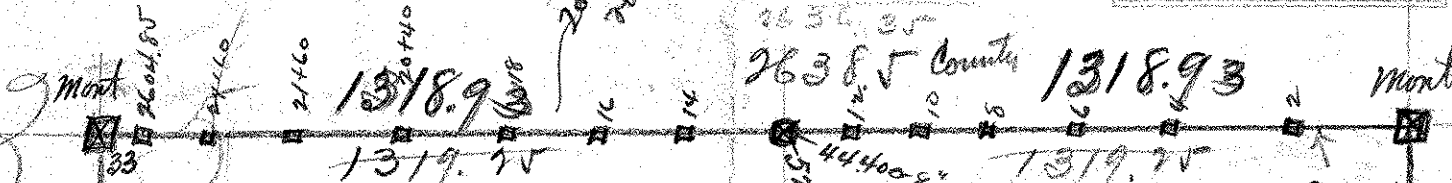

Angle. 2

NE 1/4 SE 1/4

2634.79
57.62
2631.07

1317.40

10-4.07
in 1399'
1318.71
1318.44

Mr. Brown
4.5'
1318.44
1318.71
1318.44

80.77
live need

1315.54

21.40
12" 100'
Random (see record above on plat)

1313.68

2627.36

1317.40

1317.95
1318.18

61.16

27.78
TP #720

1318.18

1317.95

2635.90
1317.95

183.45

32.35

27.78

2636.35
iron in S. wheel track
county

1313.68

1318.18
1317.95
52.20