

FROM THE OFFICE OF

# CHARLES O. GEORGI COMPANY

2215 West County Road B

Saint Paul 13, Minnesota

REGISTERED CIVIL ENGINEER AND LAND SURVEYOR

## Certificate of Survey

I Hereby Certify that this plat shows a survey made by me of the property described on this plat, and that the corners are correctly placed as shown, and that all locations have been correctly shown.

Surveyed For Mrs E. Murphy  
Date Sept 1965  
Scale 1" = 50'

By Charles O. Georgi  
REGISTERED LAND SURVEYOR

### Description:

The East 50.8 feet of the South 30 feet of Lot 13, and the North 25 feet of the East 50.8 feet of Lot 14, and the East 55.15 feet of Lot 14 and 15 except the North 25 feet of said Lot 14, Hager's Subdivision of Walcott's Addition to Cottage Homes. (5,000 Sq. Ft.)

The South 30 feet of Lot 13 except the East 50.8 feet thereof, and Lot 14 except the North 25 feet of the the East 50.8 feet thereof, and Lot 14 except the North 25 feet and except the East 55.15 feet thereof, and Lot 15 except the East 55.15 feet thereof, Hager's Subdivision of Walcott's Addition to Cottage Homes.

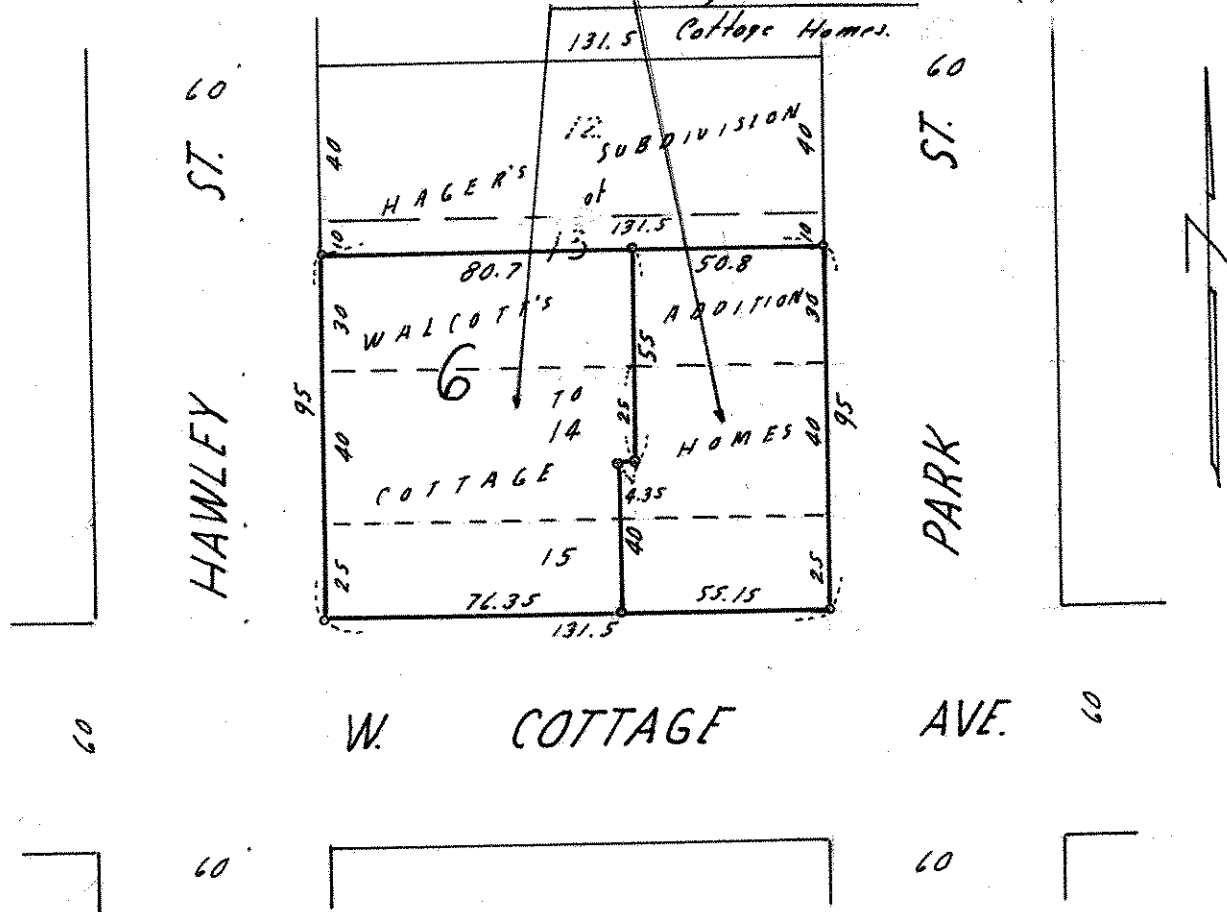

Note: Lots divided as shown to match existing house, garage & driveway.

o Denotes Iron Monument