

PLAT OF SURVEY

OF PROPERTY OF I. M. Reynolds,
DESCRIBED AS FOLLOWS Lot 18, Block 1, Mississippi View, being
Auditor's Subdivision No. 59, Ramsey County, Minn.
No. 429 So. Cretin Ave - St. Paul, Minn.

SCALE: 1 INCH 20 FEET.

T. J. WELCH, REGISTERED SURVEYOR
738 VAN BUREN PLACE, ST. PAUL, MINN.

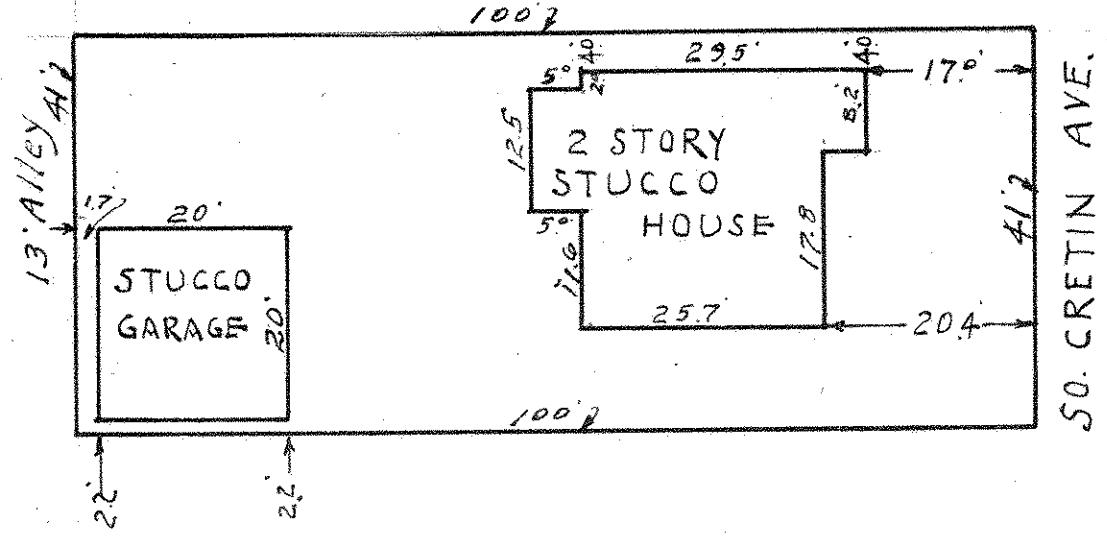

CERTIFICATE OF LOCATION OF BUILDING

I hereby certify that on Jan. 25, 1936
I made a survey of the location of the building on the above
described property and that the location of said building is
correctly shown on the above plat.

T. J. Welch

CERTIFICATE OF SURVEY

I hereby certify that on Jan. 25, 1936
I surveyed the property described above and that the above
plat is a correct representation of said survey.

T. J. Welch