

APPL. # 57903

TELEPHONE 776-0640

# PLAT OF SURVEY

OF PROPERTY OF Robert J. Meiers

DESCRIBED AS FOLLOWS Lot 1 and the Northerly 75 Feet of Lot 2, Block

4 Kentucky Terrace, Ramsey Co.

N<sup>o</sup>. 2184-86 W. 7th. St. Paul MN. 55116

SCALE: 1 INCH = 30 FEET

T. J. WELCH, REGISTERED SURVEYOR  
701 EAST 3RD STREET, ST. PAUL, MINN. 55106

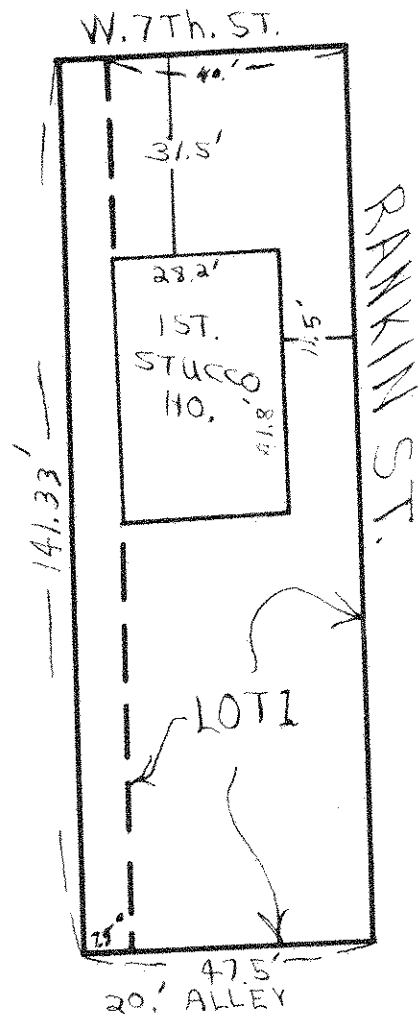

This survey is made exclusively for  
First Federal Savings and Loan Assn.  
of St. Paul, Minn. Lot lines are not  
guaranteed as this is survey for  
mortgage purposes only.

## CERTIFICATE OF SURVEY

I hereby certify that on June 4, 1974  
I surveyed the property described above and that the above  
plat is a correct representation of said survey.

J. J. Welch

355  
44