

MISSISSIPPI

RIVER

St. Paul Minn

June 28th 1902

I, hereby certify that this diagram correctly represents the acreage of the Mintzer Estate in Lot 4, Sec. 5, T. 28, R. 22 lying West of the West line of F. Amb's Add.

John B. Irvine
County Surveyor

Room 16 Court House.

200 feet per inch.

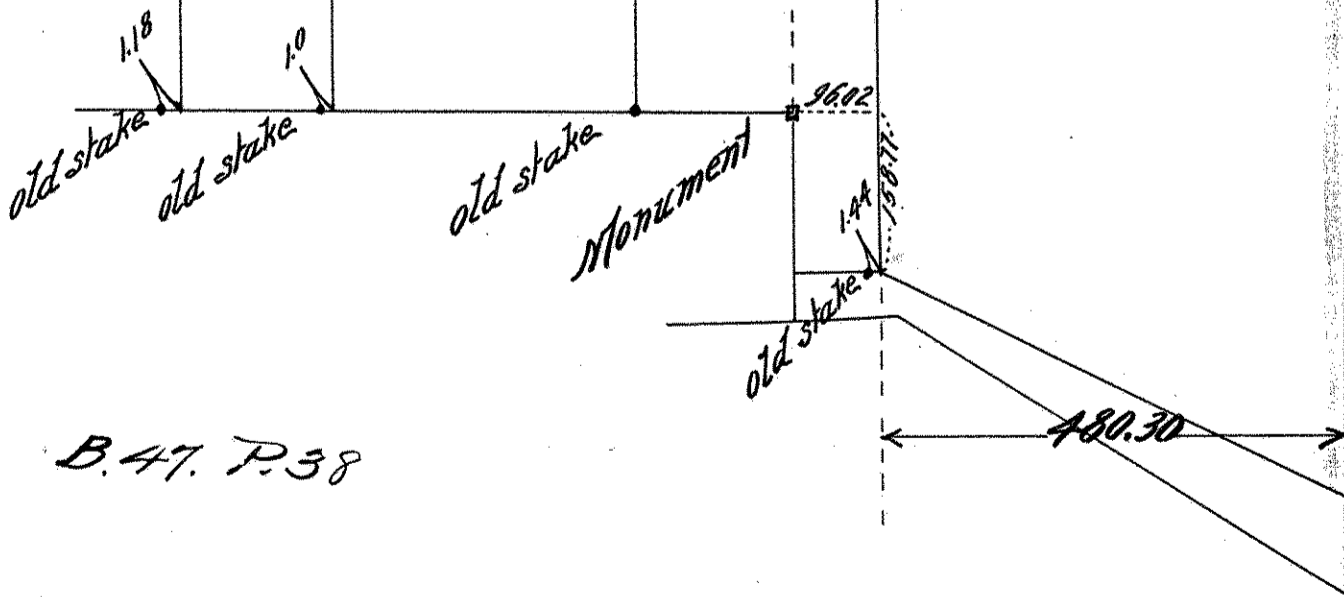

B. 47. P. 38

JOHN B. IRVINE
Co. Surveyor, R. 16, Court House