

PLAT OF SURVEY

OF PROPERTY OF E. M. Morberg
 DESCRIBED AS FOLLOWS Lot 3, Block 5 Boulevard Addition No 3
Subject to easement granted to Northern States
Power Company in 220 Misc. 75

SCALE: 1 INCH 20 FEET

○ Denotes Iron

T. J. WELCH, REGISTERED SURVEYOR
 738 SURREY AVENUE, ST. PAUL 6, MINN.

North

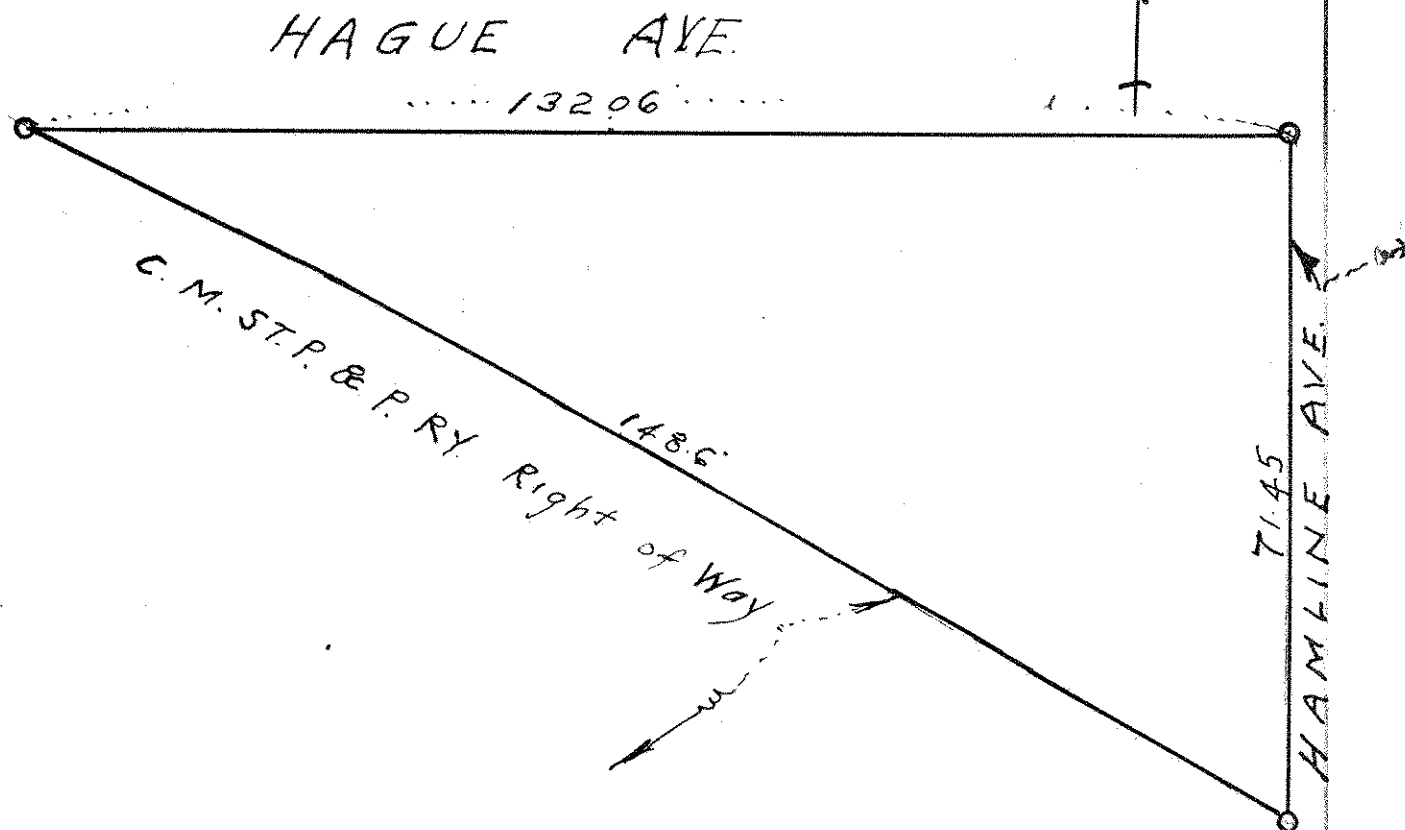

Note: 220 Misc. 75 gives right to place one
 "H" frame structure on Lots 1, 2, and 3 Block 5
 Boulevard Addition No. 3.
 Lots 1, and 2 taken for widening Hamline Ave.

CERTIFICATE OF SURVEY

I hereby certify that on Nov. 8, 1962
 I surveyed the property described above and that the above
 plat is a correct representation of said survey.

T. J. Welch