

PLAT OF SURVEY

OF PROPERTY OF Elsie Burns.

DESCRIBED AS FOLLOWS Lots 1, 2, 3, Block 5 Boulevard

Addition No 3

No. 1340 Hague Ave. St Paul Minnesota

SCALE: 1 INCH 40 FEET.

o Indicates Iron

T. J. WELCH, REGISTERED SURVEYOR
738 VAN BUREN PLACE, ST. PAUL, MINN.

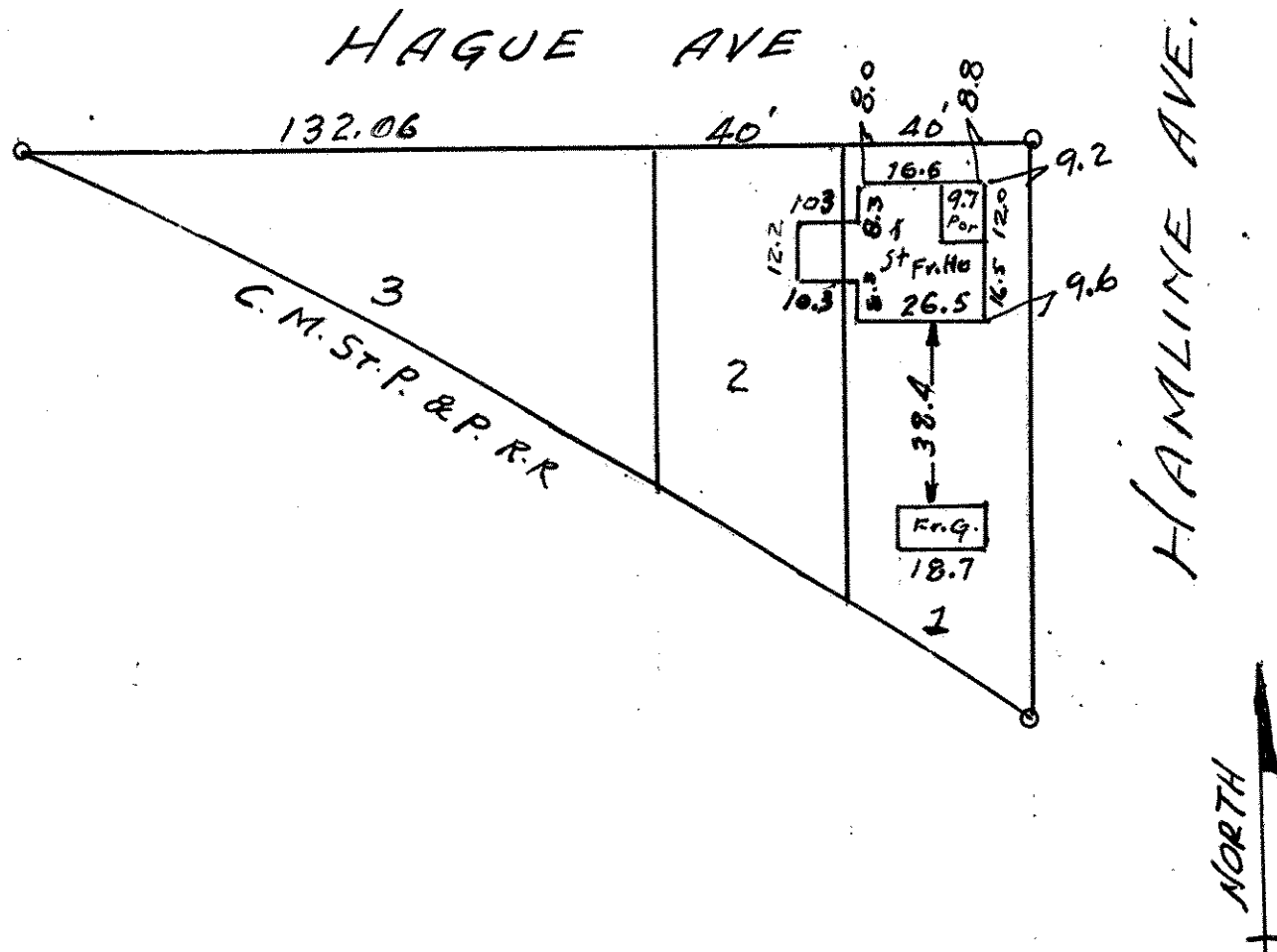

CERTIFICATE OF LOCATION OF BUILDING

I hereby certify that on May 3 1939
I made a survey of the location of the building on the above
described property and that the location of said building is
correctly shown on the above plat.

J. L. Welch

CERTIFICATE OF SURVEY

I hereby certify that on May 3 1939
I surveyed the property described above and that the above
plat is a correct representation of said survey.

T. J. Welch