

Appl. 55297

TELEPHONE 776-0640

PLAT OF SURVEY

OF PROPERTY OF Bruce A. Youngquist

DESCRIBED AS FOLLOWS Lot 4, Block 14, Boulevard Addition No 2
No 1384 Portland Ave, St. Paul, Minn.

SCALE: 1 INCH = 40 FEET

T. J. WELCH, REGISTERED SURVEYOR
701 EAST 3RD STREET, ST. PAUL, MINN. 55106

PORTLAND AVE.

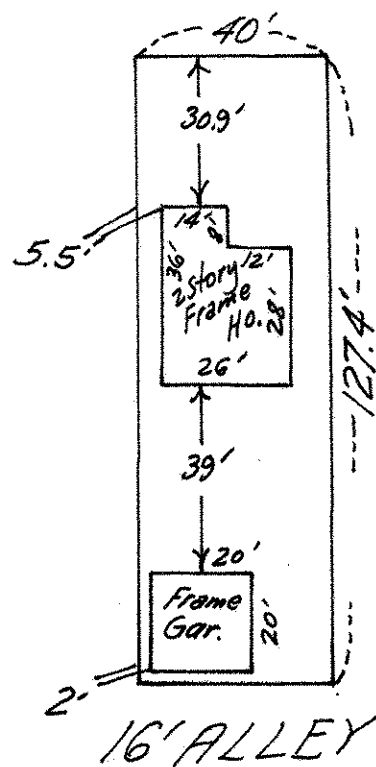

This survey is made exclusively for First Federal Savings and Loan Assn. of St. Paul, Minnesota. Lot lines are not guaranteed as this is survey for mortgage purposes only.

CERTIFICATE OF SURVEY

I hereby certify that on July 12, 1972
I surveyed the property described above and that the above plat is a correct representation of said survey.

T. J. Welch

350/32