

Appl. 34959

TELEPHONE PR 6-0640

PLAT OF SURVEY

OF PROPERTY OF Robert J. Bruski
DESCRIBED AS FOLLOWS Lot 4, Block 14, Boulevard Addition No 2
No 1384 Portland Ave, St. Paul, Minnesota.

SCALE: 1 INCH = 40 FEET

T. J. WELCH, REGISTERED SURVEYOR
738 SURREY AVENUE, ST. PAUL 6, MINN.

PORTLAND AVE.

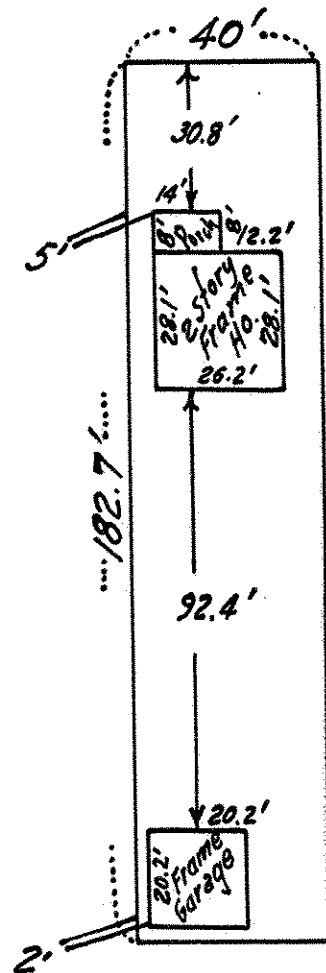

20' ALLEY

CERTIFICATE OF SURVEY

I hereby certify that on Nov. 18, 19 61
I surveyed the property described above and that the above
plat is a correct representation of said survey.

T. J. Welch

284/11