

FROM THE OFFICE OF

**CHARLES O. GEORGI COMPANY**

2215 West County Road B

Saint Paul, Minnesota 55113

REGISTERED CIVIL ENGINEER AND LAND SURVEYOR

# Certificate of Survey

I Hereby Certify that this plat shows a survey made by me of the property described on this plat, and that the corners are correctly placed as shown, and that all locations have been correctly shown.

Surveyed For *Michael P. Wordwell*

Date *Oct. 1967*

Scale *1"=30'*

By *Charles O. Georgi*  
REGISTERED LAND SURVEYOR

Description: *All of Lot 5 and the  
North 1/2 of Lot 6, St. Paul  
Academy Grounds*

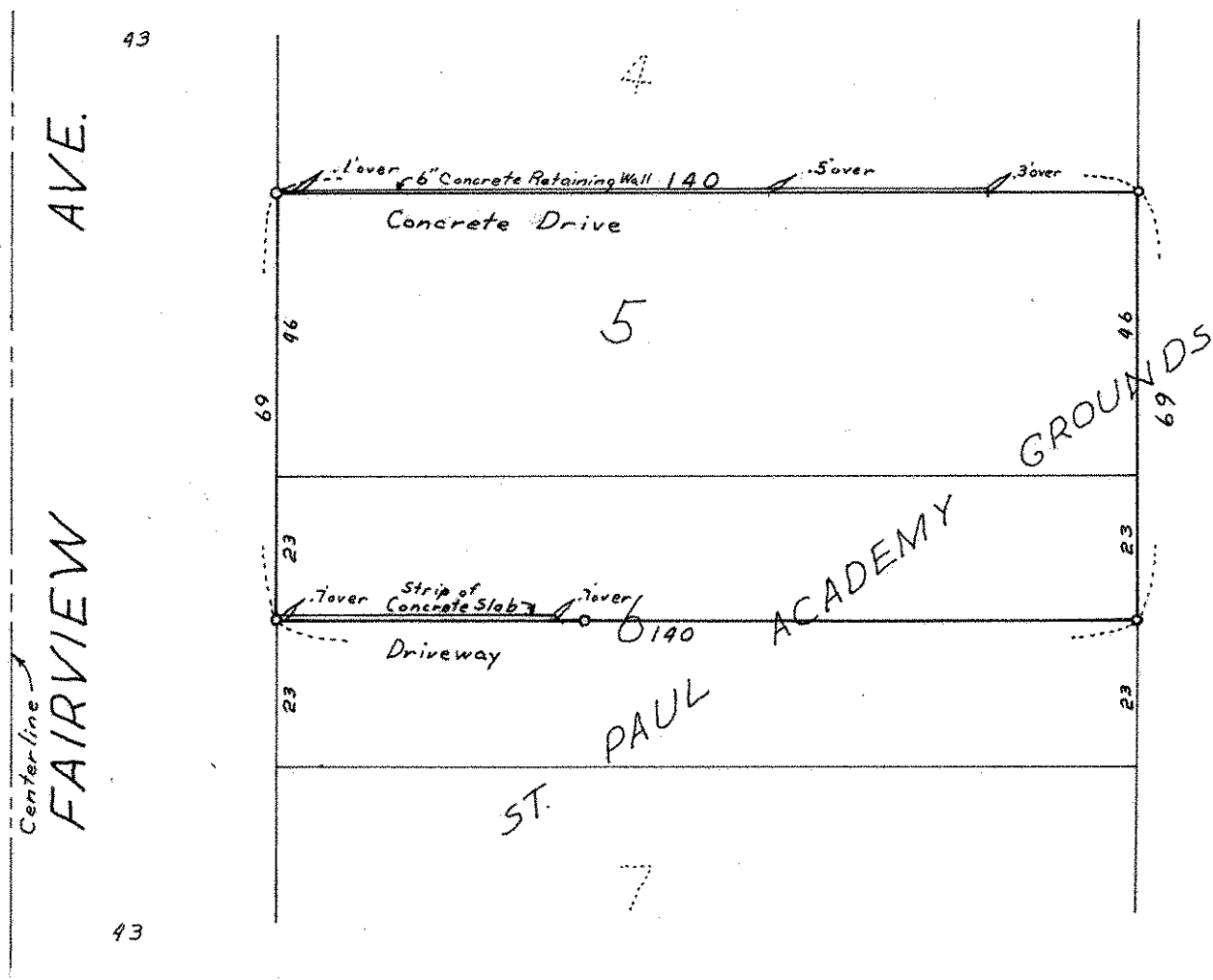

o denotes iron monument