

5412823

FROM THE OFFICE OF

# CHARLES O. GEORGI COMPANY

2215 West County Road B

Saint Paul, Minnesota 55113

REGISTERED CIVIL ENGINEER AND LAND SURVEYOR

## Certificate of Survey

I Hereby Certify that this plat shows a survey made by me of the property described on this plat, and that the corners are correctly placed as shown, and that all locations have been correctly shown.

Project No. Minn A-1-7  
Parcel No 59-1  
Area. 7,273 sq. ft. m.o.l.

Surveyed For *Housing Authority + Common Construction*

Date *August 1974*

Scale *1" = 40'*

By *Charles O. Georgi*  
REGISTERED LAND SURVEYOR

**Description:**

The South 55 feet of lot 3, Block 3  
Wille's Addition,  
Ramsey County,  
Minnesota.

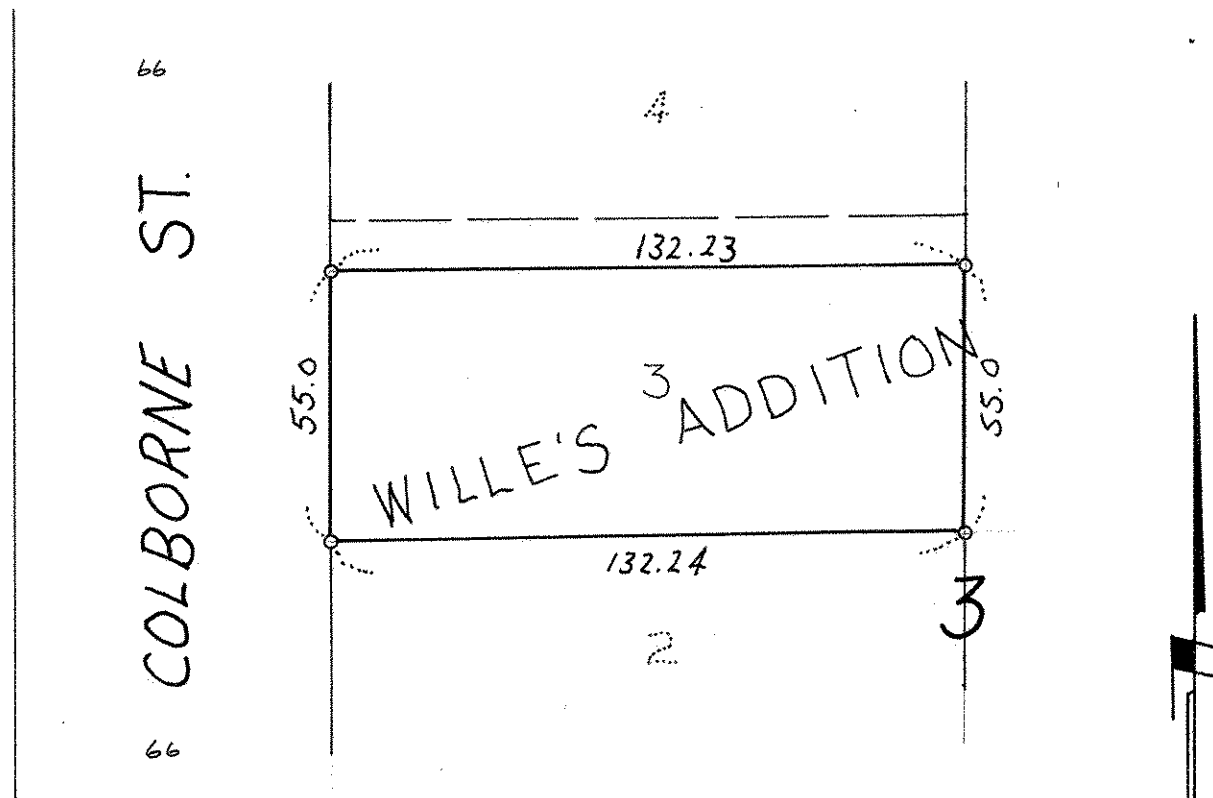

o denotes iron monument.