

FROM THE OFFICE OF

NE 2 28 23

CHARLES O. GEORGI COMPANY

2215 West County Road B

Saint Paul, Minnesota 55113

REGISTERED CIVIL ENGINEER AND LAND SURVEYOR

Certificate of Survey

I Hereby Certify that this plat shows a survey made by me of the property described on this plat, and that the corners are correctly placed as shown, and that all locations have been correctly shown.

Project No. Minn A-1-1
Parcel No 145-A
Area. 19,139 sq. ft. m.o.l.

Surveyed For Housing Authority

Date March 1974

Scale 1" = 40'

By

Charles O. Georgi
REGISTERED LAND SURVEYOR

Description:

Lots 6, 7, 8 and 9,
Block 9,
Nininger + Donnelly's Addition to Saint Paul
Ramsey County,
Minnesota.

SELBY AVE.

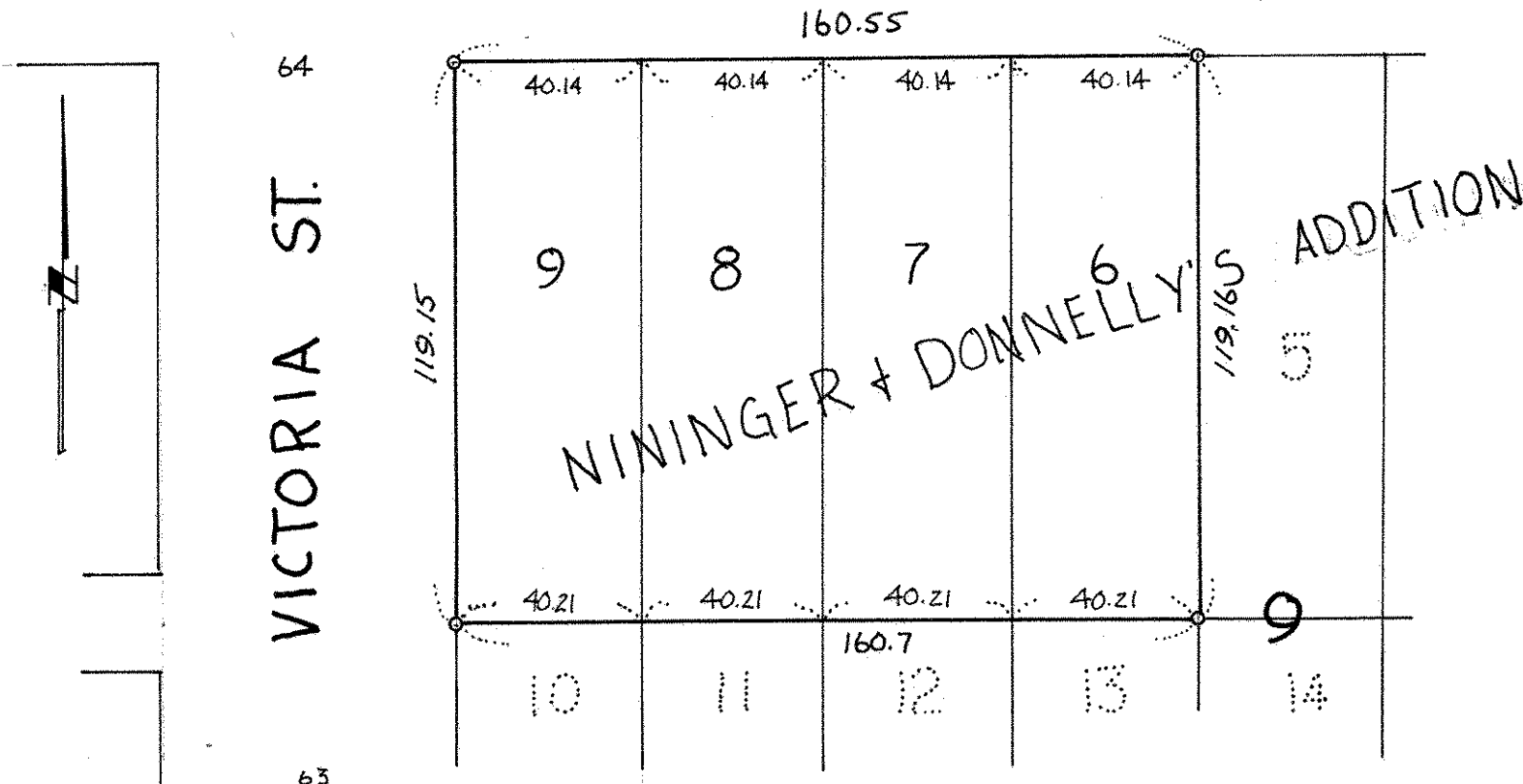

o denotes iron pipe monument.