

NE 2 28 23

FROM THE OFFICE OF

CHARLES O. GEORGI COMPANY

2215 West County Road B

Saint Paul, Minnesota 55113

REGISTERED CIVIL ENGINEER AND LAND SURVEYOR

Certificate of Survey

I Hereby Certify that this plat shows a survey made by me of the property described on this plat, and that the corners are correctly placed as shown, and that all locations have been correctly shown.

Project No. Minn A-1-1
Parcel No 158-B
Area 4,384 sq. ft. m.o.l.

Surveyed For Housing Authority

Date August 1973

Scale 1" = 40'

By Charles O. Georgi
REGISTERED LAND SURVEYOR

Description:

Lot 8, Block 8, Holcombes Addition
Ramsey County, Minnesota
Containing 4,384 sq. ft. m.o.l.

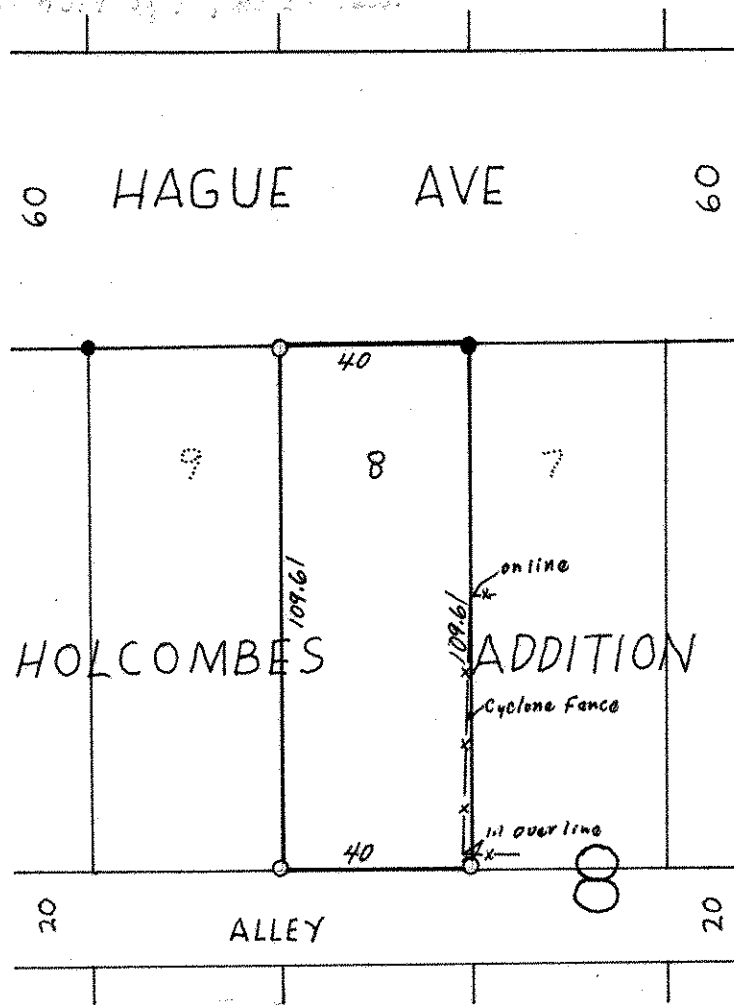

- Denotes Iron Monument
- Denotes Iron found in place