

FROM THE OFFICE OF

CHARLES O. GEORGI COMPANY

2215 West County Road B

Saint Paul, Minnesota 55113

REGISTERED CIVIL ENGINEER AND LAND SURVEYOR

**Certificate
of Survey**

I Hereby Certify that this plat shows a survey made by me of the property described on this plat, and that the corners are correctly placed as shown, and that all locations have been correctly shown.

Project No. Minn. A-1-1
Parcel No. 101-A
Area. 8,301 sq. ft. m.o.l.

Surveyed For *Housing Authority*
Date *August 1973*
Scale *1"=40'*

By *Charles O. Georgi*
REGISTERED LAND SURVEYOR

Description:

*Lot 4,
Block 81,
Dayton and Irvine's Addition
Ramsey County,
Minnesota.*

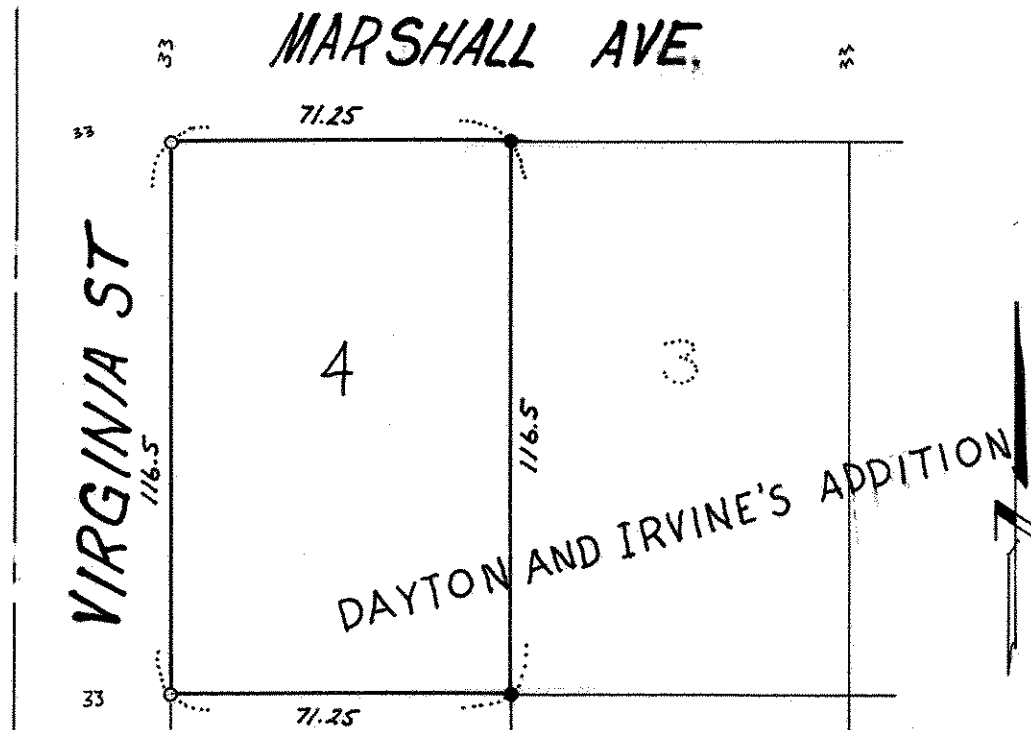

*o denotes iron pipe monument.
od denotes iron pipe monuments found in place.*