

PLAT OF SURVEY

OF PROPERTY OF *Mike Giampaolo.*

DESCRIBED AS FOLLOWS *Lot 1, Block 13, Town of Brooklyn*

No. 339 Tennessee St. - St. Paul, Minn.

SCALE: 1 INCH 30 FEET
○ Indicates Iron.

T. J. WELCH, REGISTERED SURVEYOR
738 SURREY AVENUE, ST. PAUL, MINN.

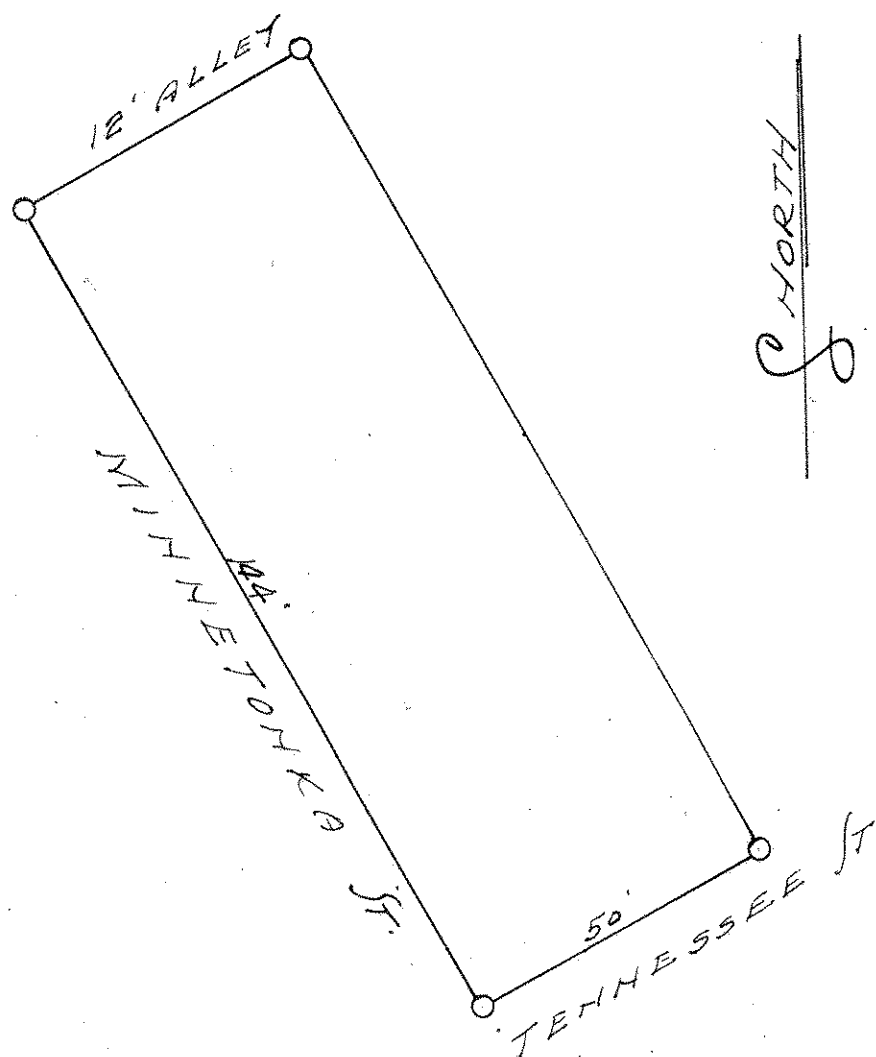

CERTIFICATE OF SURVEY

I hereby certify that on *July 5, 1944.*

I surveyed the property described above and that the above plat is a correct representation of said survey.

T. J. Welch