



DESCRIPTION: (Unfinished)  
 That part of Lots 5 and 6, Auditor's Subdivision No. 2, Section 23, T28N, R23W, Dakota County, described as follows: Commencing at the intersection of the West right-of-way line of Interstate 35E and the Northwest right-of-way line of Highway 13; thence Southwesterly along the Northwest right-of-way line of Highway 13 a distance of 235 feet; thence Southwesterly at right angles to the Northwest right-of-way line of Highway 13 a distance of 250 feet; thence Northwesterly at right angles a distance of 200 feet, more or less, to the West right-of-way line of Interstate 35E; thence Southwesterly along said right-of-way line to the point of beginning, subject to an easement of record in favor of the Northern Natural Gas Company over portions of the property.

DESCRIPTION: (Recommended)  
 That part of Lots 5 and 6, Auditor's Subdivision No. 2 in Section 23, T28N, R23W, Dakota County, described as follows: Commencing at the center of said Section 23; thence N. 0° 20' along the East line of Gov't Lot 3 a distance of 934.7 feet to the tangent of a curve on the center line of State Trunk Highway 13; thence N. 25° 45' E. along said tangent a distance of 5.74 feet to the beginning of curve; thence Southwesterly along aforesaid curve, Δ = 15° 38' 05" to the right, R = 572.96 feet (D = 10°), a distance of 156.35 feet to the point of beginning of the land to be described; thence continuing along said curve, Δ = 18° 25' 25" to the right, along the center line of Highway 13 a distance of 184.24 feet to the end of curve; thence S. 59° 48' 30" W. along the center line of Highway 13 a distance of 104.37 feet; thence N. 30° 11' 30" W. a distance of 233 feet; thence N. 59° 48' 30" E. a distance of 195.73 feet to the right-of-way line of Interstate Highway 35E; thence S. 34° 31' E. along said right-of-way a distance of 45.03 feet; thence S. 53° 47' E. along said right-of-way a distance of 127.03 feet to the Northwest right-of-way line of Highway 13; thence on a radial line S. 48° 36' 55" E. a distance of 33 feet to the point of beginning. Subject to State Trunk Highway No. 13. Subject to an easement of record in favor of the Northern Natural Gas Company over portions of the property.

NOTE:  
 Descriptions cover same parcel but recommended desc. ties it into retrace-able land lines and to the center line of Highway 13.

NOTE:  
 All Elev. are USGS Datum (Also Army Dept. Datum)  
 B.M. 814.55 Top of 40" boulder by SW cor of prop. on S. side of Hwy. 13.  
 B.M. 808.68 Spike in Power Pole 50' N. of SW cor of prop. on S. side of Hwy. 13.  
 79.1 Denotes Elev. 779.1  
 1.3 Denotes Elev. 801.3  
 No Sewer nor Water

**SHELL**  
**SITE MAP FOR SERVICE STATION**  
**HIGHWAYS 13 & 35E**  
**VILLAGE OF LILYDALE**  
**DAKOTA CO. MINN.**

SCALE 1"=20'

Charles O. Georgi Company  
 Civil Engineering & Land Surveying  
 2215 W. Co. Rd. B, St. Paul 13, Minn.

Sept. 1964

Alld R/W note on March 19, 1965

**S 1005**

I, Charles O. Georgi, a Registered Land Surveyor in and for the State of Minnesota, do hereby certify that this is a true and correct plat of a survey of lots shown herein; that said plat correctly shows the location of all buildings, structures and improvements on said described property; that there are no encroachments onto adjoining properties, streets or alleys by any of said buildings, structures or improvements; that there are no right-of-way or easements on said described property; and that there are no party walls or encroachments on said described property by buildings, structures or other improvements situated on adjoining property except as shown on said plat or survey.

Charles O. Georgi  
 Registered Land Surveyor  
 Minn. Certification No. 3840

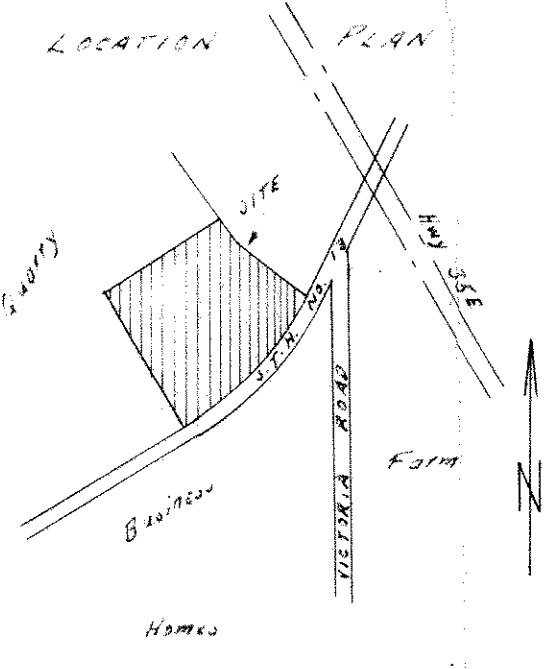

o Denotes Iron Monument  
 P.P. Denotes Power Pole