

THIRD ST.

CLARK AVE.

BANNING AVE.

SECOND ST.

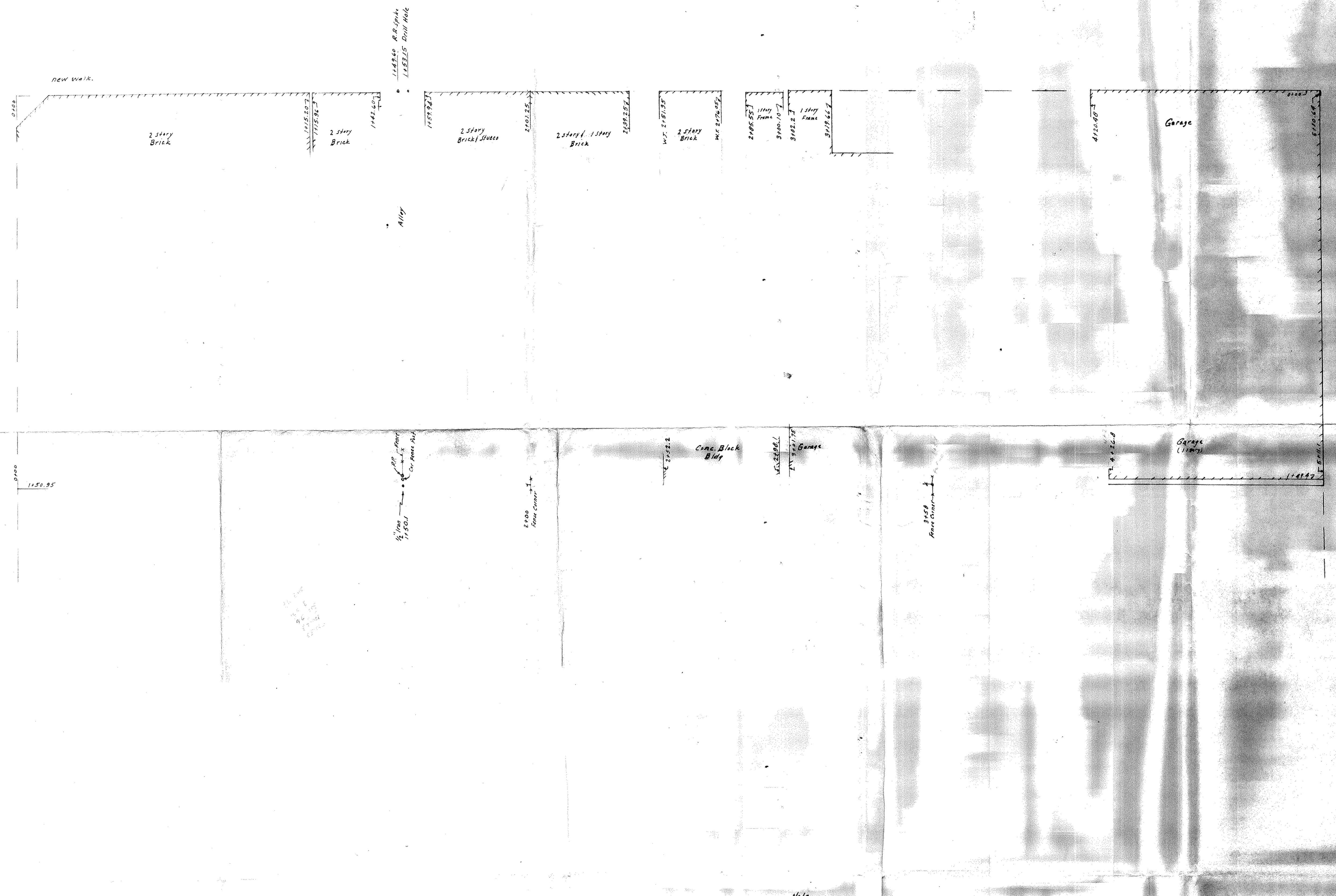

Note
 The Monuments that were found along the North of Block 60, White Bear are shown hereon.
 All lot lines have been left off of this map.

BLDG'S MONUMENTS
N 1/2 BLOCK 60
WHITE BEAR

Scale 1" = 20'

Charles O. George Company
 Civil Engineering & Land Surveying
 2215 W. County Rd. B, St. Paul, Minn.
 August 1957